



# Rogers

## Assessment Property Record Card for Tax Year 2026

Data provided by LISA DELOZIER County Assessor

Date 04/16/2026  
Time 21:33:56  
Page 1

Assessment Data					Primary Image																																																																																																																				
<b>Account</b> 660019074 <b>Parcel ID</b> 000000-00-0-00369-001-0002 <b>Cadastral ID</b> 22-21-14-01420 <b>Property Type</b> REAL - Real Property <b>Property Class</b> RRP VI Area 4 <b>Tax Area</b> 3 - OWASSO RURAL/NO FIRE <b>Name ID</b> 316340 THOMPSON, ANDREW C  14519 E 94TH ST N OWASSO OK 74055-0000  <b>Parcel Location</b> <b>Situs</b> 14519 E 94TH ST N <b>Subdivision</b> HI-VIEW ESTATES <b>Lot/Block</b> 0002 / 0001 <b>Parcel Size</b> .9 - Lots <b>Sec/Twn/Rng</b> 22 / 21 / 14 / 5 <b>Neighborhood</b> 1069 - R-V04-SW OWASSO <b>School District</b> S021 - OWASSO SCHOOLS					<p style="text-align: right; color: orange;">08/19/2022 13:22</p> <p>\\tsclient\TCASEY\CASEY BOOTH RESIDENTIAL VI\2022-8-19\ 8/19/2022</p>																																																																																																																				
<b>Legal Description</b> Lat/Long: 36.29210128 -95.81179620 LOT 2 BLOCK 1 HI-VIEW ESTATES LESS TR TO CITY DESC 2024 004552 AS BEG NW/C LOT 2 BLOCK 1 HI-VIEW ESTATES; N88.4514E 15'; S01.1926E 265.25'; S88.4514W 15'; N01.1926W 265.25' TO POB.																																																																																																																									
<b>Exemptions</b> <table border="1"> <thead> <tr> <th>Code</th> <th>Type</th> <th>Active</th> <th>Maximum</th> <th>Exemption</th> </tr> </thead> <tbody> <tr> <td>H</td> <td>Homestead</td> <td>Yes</td> <td>1,000</td> <td>1,000</td> </tr> </tbody> </table>					Code	Type	Active	Maximum	Exemption	H	Homestead	Yes	1,000	1,000	<b>Building Permits</b> <table border="1"> <thead> <tr> <th>Number</th> <th>Description</th> <th>Opened</th> <th>Closed</th> <th>Amount</th> </tr> </thead> <tbody> <tr> <td> </td> <td> </td> <td> </td> <td> </td> <td> </td> </tr> </tbody> </table>					Number	Description	Opened	Closed	Amount																																																																																																	
Code	Type	Active	Maximum	Exemption																																																																																																																					
H	Homestead	Yes	1,000	1,000																																																																																																																					
Number	Description	Opened	Closed	Amount																																																																																																																					
<b>Parcel Valuation</b> <table border="1"> <thead> <tr> <th>Source</th> <th>REAL</th> <th>Fair Cash</th> <th>Capped</th> <th>Asmnt Level</th> <th>Assessed</th> <th>Levy Rate</th> <th>97.960</th> <th>Current Tax</th> </tr> </thead> <tbody> <tr> <td>Remove Cap</td> <td>2016</td> <td>Land Value</td> <td>46,550</td> <td>44,980</td> <td>11%</td> <td>4,948</td> <td>Assessed</td> <td>20,139 1,972.82</td> </tr> <tr> <td>Year Frozen</td> <td>0</td> <td>Improvements</td> <td>138,094</td> <td>138,094</td> <td></td> <td>15,191</td> <td>Penalty</td> <td>0</td> </tr> <tr> <td>Uncapped Value</td> <td>0</td> <td>Mobile Home</td> <td>0</td> <td>0</td> <td></td> <td>0</td> <td>Exemption</td> <td>1,000 -98.00</td> </tr> <tr> <td>TIF Project ID</td> <td>0</td> <td>Total Value</td> <td>184,644</td> <td>183,074</td> <td></td> <td>20,139</td> <td>Total Taxable</td> <td>19,139 1,875.00</td> </tr> </tbody> </table>					Source	REAL	Fair Cash	Capped	Asmnt Level	Assessed	Levy Rate	97.960	Current Tax	Remove Cap	2016	Land Value	46,550	44,980	11%	4,948	Assessed	20,139 1,972.82	Year Frozen	0	Improvements	138,094	138,094		15,191	Penalty	0	Uncapped Value	0	Mobile Home	0	0		0	Exemption	1,000 -98.00	TIF Project ID	0	Total Value	184,644	183,074		20,139	Total Taxable	19,139 1,875.00	<b>Sale History</b> <table border="1"> <thead> <tr> <th>Bk/Pg</th> <th>Grantor</th> <th>Date</th> <th>Price</th> <th>Code</th> </tr> </thead> <tbody> <tr> <td>2502/381</td> <td>MATLOCK, DANIEL W TRUST</td> <td>09/24/2015</td> <td>163,000</td> <td>YES</td> </tr> <tr> <td>2502/371</td> <td>MATLOCK, DANIEL W &amp;</td> <td>09/19/2015</td> <td>0</td> <td>4</td> </tr> <tr> <td>959/327</td> <td>MOREE, STEVEN R</td> <td>06/10/1994</td> <td>89,000</td> <td>Yes</td> </tr> </tbody> </table>					Bk/Pg	Grantor	Date	Price	Code	2502/381	MATLOCK, DANIEL W TRUST	09/24/2015	163,000	YES	2502/371	MATLOCK, DANIEL W &	09/19/2015	0	4	959/327	MOREE, STEVEN R	06/10/1994	89,000	Yes																																															
Source	REAL	Fair Cash	Capped	Asmnt Level	Assessed	Levy Rate	97.960	Current Tax																																																																																																																	
Remove Cap	2016	Land Value	46,550	44,980	11%	4,948	Assessed	20,139 1,972.82																																																																																																																	
Year Frozen	0	Improvements	138,094	138,094		15,191	Penalty	0																																																																																																																	
Uncapped Value	0	Mobile Home	0	0		0	Exemption	1,000 -98.00																																																																																																																	
TIF Project ID	0	Total Value	184,644	183,074		20,139	Total Taxable	19,139 1,875.00																																																																																																																	
Bk/Pg	Grantor	Date	Price	Code																																																																																																																					
2502/381	MATLOCK, DANIEL W TRUST	09/24/2015	163,000	YES																																																																																																																					
2502/371	MATLOCK, DANIEL W &	09/19/2015	0	4																																																																																																																					
959/327	MOREE, STEVEN R	06/10/1994	89,000	Yes																																																																																																																					
<b>Assessment History</b> <table border="1"> <thead> <tr> <th>Tax Year</th> <th>Statement Number</th> <th>Billed Owner</th> <th>Tax Area</th> <th>Total Value</th> <th>Exemptions</th> <th>Taxable Value</th> <th>Billed Tax</th> </tr> </thead> <tbody> <tr><td>2025</td><td>2025-660019074</td><td>THOMPSON, ANDREW C</td><td>3</td><td>182,689</td><td>1000</td><td>18,552</td><td>1,817.00</td></tr> <tr><td>2024</td><td>2024-660019074</td><td>THOMPSON, ANDREW C</td><td>3</td><td>205,488</td><td>1000</td><td>17,982</td><td>1,728.00</td></tr> <tr><td>2023</td><td>2023-660019074</td><td>THOMPSON, ANDREW C</td><td>3</td><td>199,298</td><td>1000</td><td>17,841</td><td>1,672.00</td></tr> <tr><td>2022</td><td>2022-660019074</td><td>THOMPSON, ANDREW C</td><td>3</td><td>166,293</td><td>1000</td><td>17,292</td><td>1,694.00</td></tr> <tr><td>2021</td><td>2021-660019074</td><td>THOMPSON, ANDREW C</td><td>3</td><td>175,426</td><td>1000</td><td>18,297</td><td>1,770.00</td></tr> <tr><td>2020</td><td>2020-660019074</td><td>THOMPSON, ANDREW C</td><td>3</td><td>174,500</td><td>1000</td><td>17,840</td><td>1,723.00</td></tr> <tr><td>2019</td><td>2019-660019074</td><td>THOMPSON, ANDREW C</td><td>3</td><td>166,288</td><td>1000</td><td>17,292</td><td>1,672.00</td></tr> <tr><td>2018</td><td>2018-660019074</td><td>THOMPSON, ANDREW C</td><td>3</td><td>172,001</td><td>1000</td><td>17,920</td><td>1,668.00</td></tr> <tr><td>2017</td><td>2017-660019074</td><td>THOMPSON, ANDREW C</td><td>3</td><td>170,437</td><td>1000</td><td>17,748</td><td>1,669.00</td></tr> <tr><td>2016</td><td>2016-660019074</td><td>THOMPSON, ANDREW C</td><td>3</td><td>166,507</td><td>1000</td><td>17,316</td><td>1,630.00</td></tr> <tr><td>2015</td><td>2015-660019074</td><td>THOMPSON, ANDREW C</td><td>3</td><td>161,778</td><td>0</td><td>16,210</td><td>1,537.00</td></tr> <tr><td>2014</td><td>2014-660019074</td><td>MATLOCK, DANIEL W &amp;</td><td>3</td><td>164,667</td><td>0</td><td>15,438</td><td>1,478.00</td></tr> <tr><td>2013</td><td>2013-660019074</td><td>MATLOCK, DANIEL W &amp;</td><td>3</td><td>157,110</td><td>1000</td><td>13,703</td><td>1,284.00</td></tr> </tbody> </table>										Tax Year	Statement Number	Billed Owner	Tax Area	Total Value	Exemptions	Taxable Value	Billed Tax	2025	2025-660019074	THOMPSON, ANDREW C	3	182,689	1000	18,552	1,817.00	2024	2024-660019074	THOMPSON, ANDREW C	3	205,488	1000	17,982	1,728.00	2023	2023-660019074	THOMPSON, ANDREW C	3	199,298	1000	17,841	1,672.00	2022	2022-660019074	THOMPSON, ANDREW C	3	166,293	1000	17,292	1,694.00	2021	2021-660019074	THOMPSON, ANDREW C	3	175,426	1000	18,297	1,770.00	2020	2020-660019074	THOMPSON, ANDREW C	3	174,500	1000	17,840	1,723.00	2019	2019-660019074	THOMPSON, ANDREW C	3	166,288	1000	17,292	1,672.00	2018	2018-660019074	THOMPSON, ANDREW C	3	172,001	1000	17,920	1,668.00	2017	2017-660019074	THOMPSON, ANDREW C	3	170,437	1000	17,748	1,669.00	2016	2016-660019074	THOMPSON, ANDREW C	3	166,507	1000	17,316	1,630.00	2015	2015-660019074	THOMPSON, ANDREW C	3	161,778	0	16,210	1,537.00	2014	2014-660019074	MATLOCK, DANIEL W &	3	164,667	0	15,438	1,478.00	2013	2013-660019074	MATLOCK, DANIEL W &	3	157,110	1000	13,703	1,284.00
Tax Year	Statement Number	Billed Owner	Tax Area	Total Value	Exemptions	Taxable Value	Billed Tax																																																																																																																		
2025	2025-660019074	THOMPSON, ANDREW C	3	182,689	1000	18,552	1,817.00																																																																																																																		
2024	2024-660019074	THOMPSON, ANDREW C	3	205,488	1000	17,982	1,728.00																																																																																																																		
2023	2023-660019074	THOMPSON, ANDREW C	3	199,298	1000	17,841	1,672.00																																																																																																																		
2022	2022-660019074	THOMPSON, ANDREW C	3	166,293	1000	17,292	1,694.00																																																																																																																		
2021	2021-660019074	THOMPSON, ANDREW C	3	175,426	1000	18,297	1,770.00																																																																																																																		
2020	2020-660019074	THOMPSON, ANDREW C	3	174,500	1000	17,840	1,723.00																																																																																																																		
2019	2019-660019074	THOMPSON, ANDREW C	3	166,288	1000	17,292	1,672.00																																																																																																																		
2018	2018-660019074	THOMPSON, ANDREW C	3	172,001	1000	17,920	1,668.00																																																																																																																		
2017	2017-660019074	THOMPSON, ANDREW C	3	170,437	1000	17,748	1,669.00																																																																																																																		
2016	2016-660019074	THOMPSON, ANDREW C	3	166,507	1000	17,316	1,630.00																																																																																																																		
2015	2015-660019074	THOMPSON, ANDREW C	3	161,778	0	16,210	1,537.00																																																																																																																		
2014	2014-660019074	MATLOCK, DANIEL W &	3	164,667	0	15,438	1,478.00																																																																																																																		
2013	2013-660019074	MATLOCK, DANIEL W &	3	157,110	1000	13,703	1,284.00																																																																																																																		



# Rogers

## Assessment Property Record Card for Tax Year 2026

Data provided by LISA DELOZIER County Assessor

Date 04/16/2026  
Time 21:33:56  
Page 2

Lot Data		Square-Foot - NBHD 1069 #1		Primary Image				
Lot Size								
Lot Count								
Units Buildable								
Non-Ag Acres	0							
Topography								
Street Access								
Utilities								
Amenities	LAND QUALITY							
Method	Square-Foot							
Base Lot Value	35,808.00 x 1.30 = 46,550							
Factor Value								
Adjustments	1.0000							
Lot Value	46,550							
<b>Residential Data</b>								
Type	1 Single Family Residence							
Condition	3 - Average							
Quality	2.5 - Fair							
Architecture								
Style	100% One Story							
Exterior Wall	90% Veneer, Masonry 10% Veneer, Stone							
Base/Total Area	1,720 / 1,720							
Style	100% One Story							
HVAC	100% Warmed & Cooled Air							
Roof Cover	1 Composition Shingle							
Area on Slab	1,720							
Fixture/RghIn	11 /							
Bed/F/H Bath	3 / 2.0 /							
Basement Area								
Garage Type	504 Attached Garage - Unfinished							
Remodel								
Year/Eff Age	1976 / 38							
<b>Cost Approach</b>								
Manual : 01/2025								
Base Cost	104.52	Total Misc Impr	+	13,436				
Roofing Adj	+ 4.40	Garage Cost	+	13,810				
Subfloor Adj	+ -1.15	Total RCN	=	246,426				
Heat/Cool Adj	+ 11.47	Depreciation ( 47%)	-	115,820				
Plumbing Adj	+ 8.19	Lump Sums	+	0				
Basement Adj	+ 0.00	RCNLD	=	130,606				
Adj Base Cost	= 127.43	Lot Value	+	46,550				
Total Area	x 1,720	Indicated Value	=	177,156				
Adjusted Cost	= 219,180	Value Per SqFt		103.00				
<b>Value Reconciliation</b>								
Selected Approach	Cost Approach							
Improvements	130,606							
Lot Value	46,550							
Indicated Value	177,156							
Agland Value	103.00 Per SqFt							
Site Improvements	7,488							
Total Value	184,644							
	107.35 Total Value Per SqFt							
<b>Miscellaneous Improvements</b>								
Code	Description	Sketch ID	Size	Year	Units	Unit Cost	Depr	Value
FPR1	FIREPLACE - RESIDENTIAL 1 STORY	0		1	1	5,095.98		5,096
SHLT	STORM SHELTER	0		1	2015	0.00		
PRCH	SLAB PORCH - COVERED	45945	17x6		102	23.95		2,443
PRCH	SLAB PORCH - COVERED	45946	18x14		252	23.40		5,897



# Rogers

## Assessment Property Record Card for Tax Year 2026

Data provided by LISA DELOZIER County Assessor

Date 04/16/2026

Time 21:33:56

Page 3

### Sketch Image

660019074

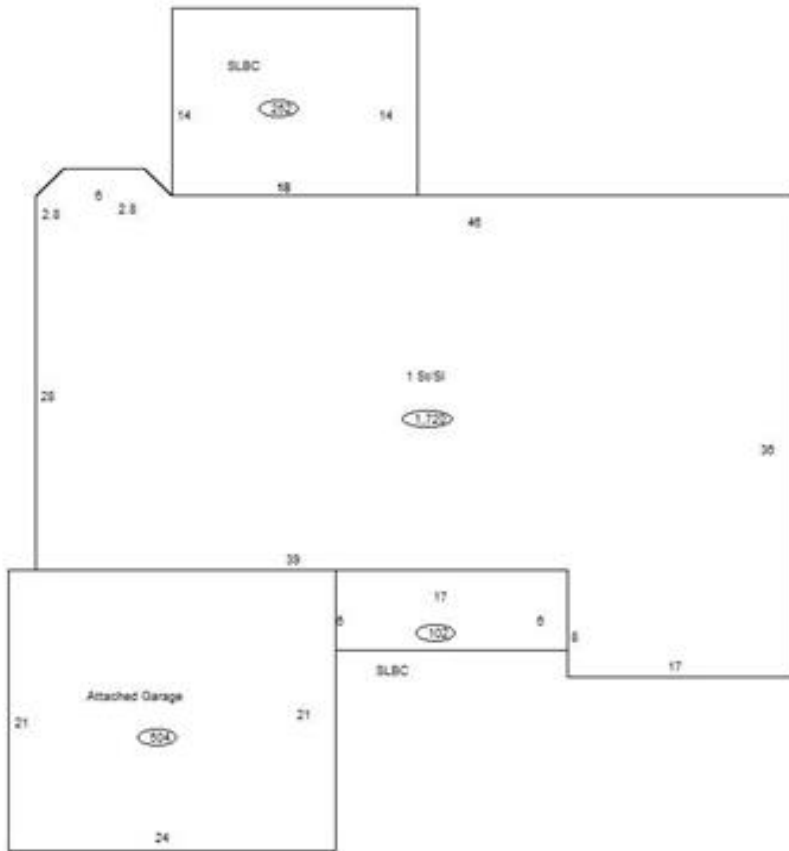

### Sketch Vector Information

Sequence	Code	Type	Built Over	Scale	Section Label	Base Area	Multiplier	Total Area
1	R	1	Slab	10	1 St/SI	1,720	1.000	1,720
2	G	1		10	Attached Garage	504	1.000	504
3	M	PRCH		10	SLBC	102	1.000	102
4	M	PRCH		10	SLBC	252	1.000	252
<b>Total Building Area</b>						<b>1,720</b>		<b>1,720</b>



# Rogers



## Assessment Property Record Card for Tax Year 2026

Data provided by LISA DELOZIER County Assessor

Date 04/16/2026  
Time 21:33:56  
Page 4

660019074

### Outbuildings/Site Improvements

Building Image	Code	Description	Dimensions	Floor	Roofing	Total Units
	DTGF	DETACHED GARAGE FAIR	24x30x0			720
	Qual 2	Cond 3	Year	Eff Age		
	<b>Valuation Summary</b>		<b>Modifier Total</b>	<b>RCN</b>	<b>Depr (35% Phys/ % Func)</b>	<b>RCNLD</b>
	Base Cost (16.00 x 720)		11,520	11,520	4,032	7,488
	STF	STG FAIR	10x16x0			160
	Qual 2	Cond 3	Year	Eff Age	1520	
	<b>Valuation Summary</b>		<b>Modifier Total</b>	<b>RCN</b>	<b>Depr (100% Phys/ % Func)</b>	<b>RCNLD</b>
	Base Cost (4.68 x 160)		749	749	749	