



Rogers

Assessment Property Record Card for Tax Year 2026

Data provided by LISA DELOZIER County Assessor

Date 04/16/2026
 Time 22:29:39
 Page 1

Assessment Data					Primary Image																																																																																																																				
Account 660019099 Parcel ID 000000-00-0-00573-001-0010 Cadastral ID 22-21-14-01670 Property Type REAL - Real Property Property Class RRP VI Area 4 Tax Area 3 - OWASSO RURAL/NO FIRE Name ID 347497 HARRIS, MICHAEL DUANE JR 15535 E 94TH ST N OWASSO OK 74055-0000 Parcel Location Situs 15535 94TH ST Subdivision PARADISE VALLEY Lot/Block 0010 / 0001 Parcel Size 1 - Lots Sec/Twn/Rng 22 / 21 / 14 / 5 Neighborhood 1118 - R-V04-SW OWASSO School District S021 - OWASSO SCHOOLS																																																																																																																									
Legal Description Lot/Long: 36.29146039 -95.79928470																																																																																																																									
Legal Description LOT 10-A BLOCK 1 PARADISE VALLEY					Building Permits <table border="1"> <thead> <tr> <th>Number</th> <th>Description</th> <th>Opened</th> <th>Closed</th> <th>Amount</th> </tr> </thead> <tbody> <tr> <td> </td> <td> </td> <td> </td> <td> </td> <td> </td> </tr> </tbody> </table>					Number	Description	Opened	Closed	Amount																																																																																																											
Number	Description	Opened	Closed	Amount																																																																																																																					
Exemptions <table border="1"> <thead> <tr> <th>Code</th> <th>Type</th> <th>Active</th> <th>Maximum</th> <th>Exemption</th> </tr> </thead> <tbody> <tr> <td> </td> <td> </td> <td> </td> <td> </td> <td> </td> </tr> </tbody> </table>					Code	Type	Active	Maximum	Exemption						Sale History <table border="1"> <thead> <tr> <th>Bk/Pg</th> <th>Grantor</th> <th>Date</th> <th>Price</th> <th>Code</th> </tr> </thead> <tbody> <tr> <td>/</td> <td>BOOTH, DEREK W & MICHELLE L</td> <td>07/10/2025</td> <td>390,000</td> <td>YES</td> </tr> <tr> <td>1326/451</td> <td>LEGG, KEVIN L & MANDI J</td> <td>08/15/2001</td> <td>156,000</td> <td>YES</td> </tr> <tr> <td>1181/570</td> <td>SAUNDERS, BRADLEY & LEANNE</td> <td>06/30/1999</td> <td>161,500</td> <td>Yes</td> </tr> <tr> <td>920/496</td> <td>HARRISON, CARL R JR</td> <td>06/30/1993</td> <td>98,500</td> <td>Yes</td> </tr> </tbody> </table>					Bk/Pg	Grantor	Date	Price	Code	/	BOOTH, DEREK W & MICHELLE L	07/10/2025	390,000	YES	1326/451	LEGG, KEVIN L & MANDI J	08/15/2001	156,000	YES	1181/570	SAUNDERS, BRADLEY & LEANNE	06/30/1999	161,500	Yes	920/496	HARRISON, CARL R JR	06/30/1993	98,500	Yes																																																																													
Code	Type	Active	Maximum	Exemption																																																																																																																					
Bk/Pg	Grantor	Date	Price	Code																																																																																																																					
/	BOOTH, DEREK W & MICHELLE L	07/10/2025	390,000	YES																																																																																																																					
1326/451	LEGG, KEVIN L & MANDI J	08/15/2001	156,000	YES																																																																																																																					
1181/570	SAUNDERS, BRADLEY & LEANNE	06/30/1999	161,500	Yes																																																																																																																					
920/496	HARRISON, CARL R JR	06/30/1993	98,500	Yes																																																																																																																					
Parcel Valuation <table border="1"> <thead> <tr> <th>Source</th> <th>REAL</th> <th>Fair Cash</th> <th>Capped</th> <th>Asmnt Level</th> <th>Assessed</th> <th>Levy Rate</th> <th>97.960</th> <th>Current Tax</th> </tr> </thead> <tbody> <tr> <td>Remove Cap</td> <td>2026</td> <td>Land Value 182,172</td> <td>182,172</td> <td>11%</td> <td>20,039</td> <td>Assessed</td> <td>42,901</td> <td>4,202.58</td> </tr> <tr> <td>Year Frozen</td> <td>0</td> <td>Improvements 207,837</td> <td>207,837</td> <td></td> <td>22,862</td> <td>Penalty</td> <td>0</td> <td></td> </tr> <tr> <td>Uncapped Value</td> <td>0</td> <td>Mobile Home 0</td> <td>0</td> <td></td> <td>0</td> <td>Exemption</td> <td>0</td> <td>0.00</td> </tr> <tr> <td>TIF Project ID</td> <td>0</td> <td>Total Value 390,009</td> <td>390,009</td> <td></td> <td>42,901</td> <td>Total Taxable</td> <td>42,901</td> <td>4,203.00</td> </tr> </tbody> </table>										Source	REAL	Fair Cash	Capped	Asmnt Level	Assessed	Levy Rate	97.960	Current Tax	Remove Cap	2026	Land Value 182,172	182,172	11%	20,039	Assessed	42,901	4,202.58	Year Frozen	0	Improvements 207,837	207,837		22,862	Penalty	0		Uncapped Value	0	Mobile Home 0	0		0	Exemption	0	0.00	TIF Project ID	0	Total Value 390,009	390,009		42,901	Total Taxable	42,901	4,203.00																																																																			
Source	REAL	Fair Cash	Capped	Asmnt Level	Assessed	Levy Rate	97.960	Current Tax																																																																																																																	
Remove Cap	2026	Land Value 182,172	182,172	11%	20,039	Assessed	42,901	4,202.58																																																																																																																	
Year Frozen	0	Improvements 207,837	207,837		22,862	Penalty	0																																																																																																																		
Uncapped Value	0	Mobile Home 0	0		0	Exemption	0	0.00																																																																																																																	
TIF Project ID	0	Total Value 390,009	390,009		42,901	Total Taxable	42,901	4,203.00																																																																																																																	
Assessment History <table border="1"> <thead> <tr> <th>Tax Year</th> <th>Statement Number</th> <th>Billed Owner</th> <th>Tax Area</th> <th>Total Value</th> <th>Exemptions</th> <th>Taxable Value</th> <th>Billed Tax</th> </tr> </thead> <tbody> <tr><td>2025</td><td>2025-660019099</td><td>HARRIS, MICHAEL DUANE JR</td><td>3</td><td>252,432</td><td>0</td><td>23,778</td><td>2,329.00</td></tr> <tr><td>2024</td><td>2024-660019099</td><td>BOOTH, DEREK W & MICHELLE L</td><td>3</td><td>263,327</td><td>0</td><td>22,646</td><td>2,176.00</td></tr> <tr><td>2023</td><td>2023-660019099</td><td>BOOTH, DEREK W & MICHELLE L</td><td>3</td><td>200,023</td><td>0</td><td>21,568</td><td>2,021.00</td></tr> <tr><td>2022</td><td>2022-660019099</td><td>BOOTH, DEREK W & MICHELLE L</td><td>3</td><td>186,731</td><td>0</td><td>20,540</td><td>2,012.00</td></tr> <tr><td>2021</td><td>2021-660019099</td><td>BOOTH, DEREK W & MICHELLE L</td><td>3</td><td>197,861</td><td>0</td><td>21,765</td><td>2,106.00</td></tr> <tr><td>2020</td><td>2020-660019099</td><td>BOOTH, DEREK W & MICHELLE L</td><td>3</td><td>194,682</td><td>0</td><td>21,415</td><td>2,069.00</td></tr> <tr><td>2019</td><td>2019-660019099</td><td>BOOTH, DEREK W & MICHELLE L</td><td>3</td><td>186,807</td><td>0</td><td>20,549</td><td>1,986.00</td></tr> <tr><td>2018</td><td>2018-660019099</td><td>BOOTH, DEREK W & MICHELLE L</td><td>3</td><td>194,294</td><td>0</td><td>21,372</td><td>1,989.00</td></tr> <tr><td>2017</td><td>2017-660019099</td><td>BOOTH, DEREK W & MICHELLE L</td><td>3</td><td>191,980</td><td>0</td><td>21,118</td><td>1,986.00</td></tr> <tr><td>2016</td><td>2016-660019099</td><td>BOOTH, DEREK W & MICHELLE L</td><td>3</td><td>187,791</td><td>0</td><td>20,657</td><td>1,945.00</td></tr> <tr><td>2015</td><td>2015-660019099</td><td>BOOTH, DEREK W & MICHELLE L</td><td>3</td><td>182,367</td><td>0</td><td>20,060</td><td>1,902.00</td></tr> <tr><td>2014</td><td>2014-660019099</td><td>BOOTH, DEREK W & MICHELLE L</td><td>3</td><td>184,066</td><td>0</td><td>20,220</td><td>1,935.00</td></tr> <tr><td>2013</td><td>2013-660019099</td><td>BOOTH, DEREK W & MICHELLE L</td><td>3</td><td>175,062</td><td>0</td><td>19,257</td><td>1,804.00</td></tr> </tbody> </table>										Tax Year	Statement Number	Billed Owner	Tax Area	Total Value	Exemptions	Taxable Value	Billed Tax	2025	2025-660019099	HARRIS, MICHAEL DUANE JR	3	252,432	0	23,778	2,329.00	2024	2024-660019099	BOOTH, DEREK W & MICHELLE L	3	263,327	0	22,646	2,176.00	2023	2023-660019099	BOOTH, DEREK W & MICHELLE L	3	200,023	0	21,568	2,021.00	2022	2022-660019099	BOOTH, DEREK W & MICHELLE L	3	186,731	0	20,540	2,012.00	2021	2021-660019099	BOOTH, DEREK W & MICHELLE L	3	197,861	0	21,765	2,106.00	2020	2020-660019099	BOOTH, DEREK W & MICHELLE L	3	194,682	0	21,415	2,069.00	2019	2019-660019099	BOOTH, DEREK W & MICHELLE L	3	186,807	0	20,549	1,986.00	2018	2018-660019099	BOOTH, DEREK W & MICHELLE L	3	194,294	0	21,372	1,989.00	2017	2017-660019099	BOOTH, DEREK W & MICHELLE L	3	191,980	0	21,118	1,986.00	2016	2016-660019099	BOOTH, DEREK W & MICHELLE L	3	187,791	0	20,657	1,945.00	2015	2015-660019099	BOOTH, DEREK W & MICHELLE L	3	182,367	0	20,060	1,902.00	2014	2014-660019099	BOOTH, DEREK W & MICHELLE L	3	184,066	0	20,220	1,935.00	2013	2013-660019099	BOOTH, DEREK W & MICHELLE L	3	175,062	0	19,257	1,804.00
Tax Year	Statement Number	Billed Owner	Tax Area	Total Value	Exemptions	Taxable Value	Billed Tax																																																																																																																		
2025	2025-660019099	HARRIS, MICHAEL DUANE JR	3	252,432	0	23,778	2,329.00																																																																																																																		
2024	2024-660019099	BOOTH, DEREK W & MICHELLE L	3	263,327	0	22,646	2,176.00																																																																																																																		
2023	2023-660019099	BOOTH, DEREK W & MICHELLE L	3	200,023	0	21,568	2,021.00																																																																																																																		
2022	2022-660019099	BOOTH, DEREK W & MICHELLE L	3	186,731	0	20,540	2,012.00																																																																																																																		
2021	2021-660019099	BOOTH, DEREK W & MICHELLE L	3	197,861	0	21,765	2,106.00																																																																																																																		
2020	2020-660019099	BOOTH, DEREK W & MICHELLE L	3	194,682	0	21,415	2,069.00																																																																																																																		
2019	2019-660019099	BOOTH, DEREK W & MICHELLE L	3	186,807	0	20,549	1,986.00																																																																																																																		
2018	2018-660019099	BOOTH, DEREK W & MICHELLE L	3	194,294	0	21,372	1,989.00																																																																																																																		
2017	2017-660019099	BOOTH, DEREK W & MICHELLE L	3	191,980	0	21,118	1,986.00																																																																																																																		
2016	2016-660019099	BOOTH, DEREK W & MICHELLE L	3	187,791	0	20,657	1,945.00																																																																																																																		
2015	2015-660019099	BOOTH, DEREK W & MICHELLE L	3	182,367	0	20,060	1,902.00																																																																																																																		
2014	2014-660019099	BOOTH, DEREK W & MICHELLE L	3	184,066	0	20,220	1,935.00																																																																																																																		
2013	2013-660019099	BOOTH, DEREK W & MICHELLE L	3	175,062	0	19,257	1,804.00																																																																																																																		



Rogers

Assessment Property Record Card for Tax Year 2026

Data provided by LISA DELOZIER County Assessor

Date 04/16/2026
Time 22:29:39
Page 2

Lot Data		Square-Foot - NBHD 1118 #1	
Lot Size			
Lot Count	1		
Units Buildable	1		
Non-Ag Acres	1.2648		
Topography			
Street Access			
Utilities			
Amenities	LAND QUALITY	0	0
Method	Square-Foot		
Base Lot Value	55,095.00 x 1.53 = 84,292		
Factor Value			
Adjustments	2.1612		
Lot Value	182,172		



\\tsclient\TCASEY\CASEY BOOTH RESIDENTIAL VI\2022-8-19\ 8/19/2022

Residential Data	
Type	1 Single Family Residence
Condition	4 - Good
Quality	3 - Average
Architecture	
Style	100% One Story
Exterior Wall	100% Veneer, Masonry
Base/Total Area	1,902 / 1,902
Style	100% One Story
HVAC	100% Warmed & Cooled Air
Roof Cover	1 Composition Shingle
Area on Slab	1,902
Fixture/RghIn	14 /
Bed/F/H Bath	3 / 2.5 /
Basement Area	
Garage Type	568 Attached Garage - Unfinished
Remodel	LARGE -
Year/Eff Age	1977 / 25

GRM Approach

GRM Code	
Gross Rent	0.00
Indicated Value	

Multiple Regression

MRA Code	1 Test
Adjusted R	0.8445
Indicated Value	230,305 121.09 Per SqFt

Direct Comparables

Selection Model	A Adam Test
Adjustment Model	1 2022 Residential
Comparables	8
Indicated Value	296,860 Per SqFt

Value Reconciliation

Selected Approach	Cost Approach
Improvements	192,237
Lot Value	182,172
Indicated Value	374,409 196.85 Per SqFt
Agland Value	
Site Improvements	15,600
Total Value	390,009 205.05 Total Value Per SqFt

Cost Approach		Manual : 01/2025	
Base Cost	108.64	Total Misc Impr	+ 6,045
Roofing Adj	+ 4.75	Garage Cost	+ 17,597
Subfloor Adj	+ -2.25	Total RCN	= 278,605
Heat/Cool Adj	+ 12.64	Depreciation (31%)	- 86,368
Plumbing Adj	+ 10.27	Lump Sums	+ 0
Basement Adj	+ 0.00	RCNLD	= 192,237
Adj Base Cost	= 134.05	Lot Value	+ 182,172
Total Area	x 1,902	Indicated Value	= 374,409
Adjusted Cost	= 254,963	Value Per SqFt	196.85

Miscellaneous Improvements

Code	Description	Sketch ID	Size	Year	Units	Unit Cost	Depr	Value
FPR1	FIREPLACE - RESIDENTIAL 1 STORY	0		1	1	5,615.40		5,615
PRCH	SLAB PORCH - COVERED	46069	4x4		16	26.88		430



Rogers

Assessment Property Record Card for Tax Year 2026

Data provided by LISA DELOZIER County Assessor

Date 04/16/2026

Time 22:29:39

Page 3

Sketch Image

660019099

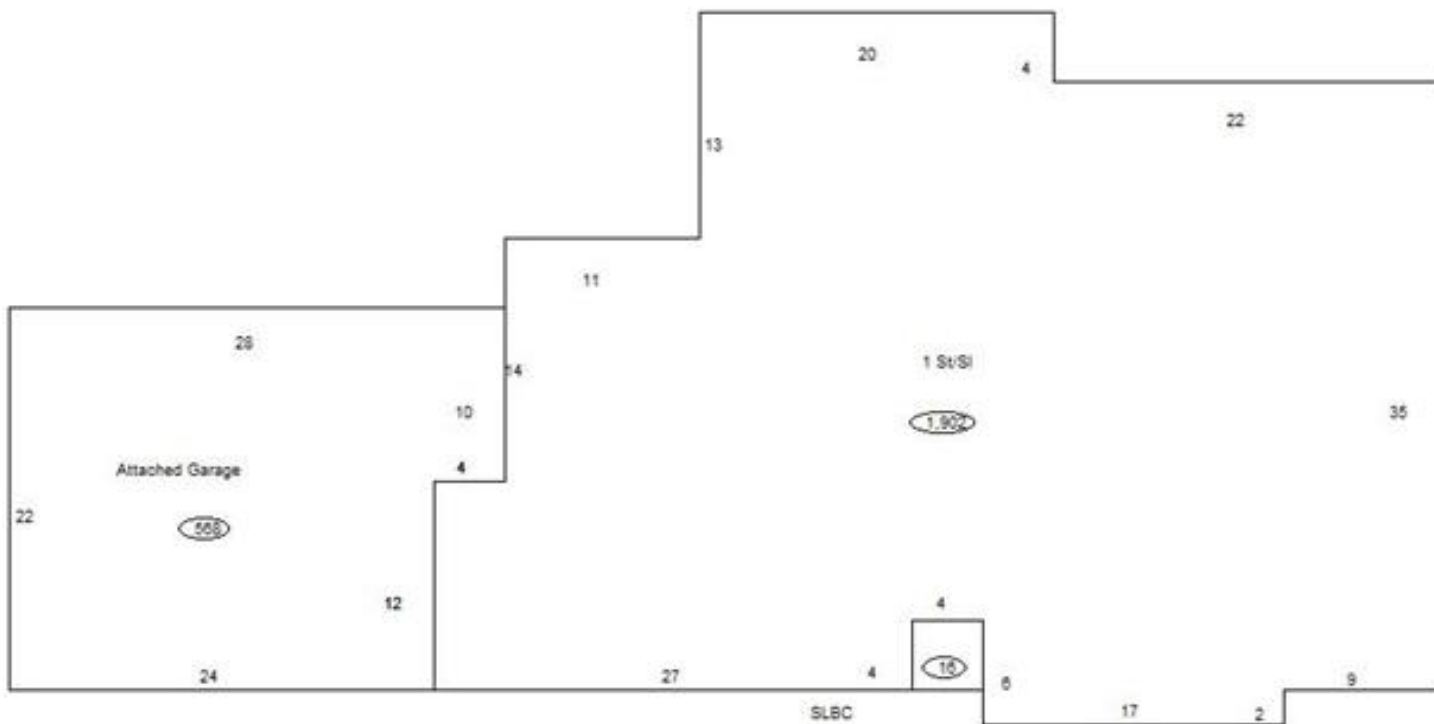

Sketch Vector Information

Sequence	Code	Type	Built Over	Scale	Section Label	Base Area	Multiplier	Total Area
1	R	1	Slab	10	1 St/SI	1,902	1.000	1,902
2	G	1		10	Attached Garage	568	1.000	568
3	M	PRCH		10	SLBC	16	1.000	16
Total Building Area						1,902		1,902



Rogers

Assessment Property Record Card for Tax Year 2026

Data provided by LISA DELOZIER County Assessor

Date 04/16/2026
 Time 22:29:39
 Page 4

660019099

Outbuildings/Site Improvements

Building Image	Code	Description	Dimensions	Floor	Roofing	Total Units
	DTGF	DETACHED GARAGE FAIR	25x25x0			625
	Qual 2	Cond 3	Year 2000	Eff Age	20	
	Valuation Summary Base Cost (16.00 x 625) 10,000		Modifier Total	RCN 10,000	Depr (49% Phys/ % Func) 4,900	RCNLD 5,100
	SG	SWIM-GUNITE	0x0x0			1
	Qual 3	Cond 3	Year 2000	Eff Age	20	
	Valuation Summary Base Cost (30,000.00 x 1) 30,000		Modifier Total	RCN 30,000	Depr (65% Phys/ % Func) 19,500	RCNLD 10,500