



Rogers

Assessment Property Record Card for Tax Year 2026

Data provided by LISA DELOZIER County Assessor

Date 04/16/2026
Time 22:06:59
Page 1

Assessment Data					Primary Image																																																																																																																				
Account 660019130 Parcel ID 000000-00-0-00573-003-0011 Cadastral ID 22-21-14-01980 Property Type REAL - Real Property Property Class RRP VI Area 4 Tax Area 3 - OWASSO RURAL/NO FIRE Name ID 341828 ORR, MASON & KIMBERLIE 9333 N 154TH E AVE OWASSO OK 74055-0000 Parcel Location Situs 09333 N 154TH E AVE Subdivision PARADISE VALLEY Lot/Block 0011 / 0003 Parcel Size 1 - Lots Sec/Twn/Rng 22 / 21 / 14 / 5 Neighborhood 1118 - R-V04-SW OWASSO School District S021 - OWASSO SCHOOLS																																																																																																																									
Legal Description Lot/Long: 36.28963976 -95.80190486 LOT 11-B BLOCK 3 PARADISE VALLEY																																																																																																																									
Exemptions <table border="1"> <thead> <tr> <th>Code</th> <th>Type</th> <th>Active</th> <th>Maximum</th> <th>Exemption</th> </tr> </thead> <tbody> <tr> <td>H</td> <td>Homestead</td> <td>No</td> <td>1,000</td> <td></td> </tr> </tbody> </table>					Code	Type	Active	Maximum	Exemption	H	Homestead	No	1,000		Building Permits <table border="1"> <thead> <tr> <th>Number</th> <th>Description</th> <th>Opened</th> <th>Closed</th> <th>Amount</th> </tr> </thead> <tbody> <tr> <td></td> <td></td> <td></td> <td></td> <td></td> </tr> </tbody> </table>					Number	Description	Opened	Closed	Amount																																																																																																	
Code	Type	Active	Maximum	Exemption																																																																																																																					
H	Homestead	No	1,000																																																																																																																						
Number	Description	Opened	Closed	Amount																																																																																																																					
Parcel Valuation <table border="1"> <thead> <tr> <th>Source</th> <th>REAL</th> <th>Fair Cash</th> <th>Capped</th> <th>Asmnt Level</th> <th>Assessed</th> <th>Levy Rate</th> <th>97.960</th> <th>Current Tax</th> </tr> </thead> <tbody> <tr> <td>Remove Cap</td> <td>2024</td> <td>Land Value</td> <td>141,497</td> <td>141,497</td> <td>11%</td> <td>15,565</td> <td>Assessed</td> <td>40,902 4,006.76</td> </tr> <tr> <td>Year Frozen</td> <td>0</td> <td>Improvements</td> <td>230,338</td> <td>230,338</td> <td></td> <td>25,337</td> <td>Penalty</td> <td>0</td> </tr> <tr> <td>Uncapped Value</td> <td>0</td> <td>Mobile Home</td> <td>0</td> <td>0</td> <td></td> <td>0</td> <td>Exemption</td> <td>0 0.00</td> </tr> <tr> <td>TIF Project ID</td> <td>0</td> <td>Total Value</td> <td>371,835</td> <td>371,835</td> <td></td> <td>40,902</td> <td>Total Taxable</td> <td>40,902 4,007.00</td> </tr> </tbody> </table>					Source	REAL	Fair Cash	Capped	Asmnt Level	Assessed	Levy Rate	97.960	Current Tax	Remove Cap	2024	Land Value	141,497	141,497	11%	15,565	Assessed	40,902 4,006.76	Year Frozen	0	Improvements	230,338	230,338		25,337	Penalty	0	Uncapped Value	0	Mobile Home	0	0		0	Exemption	0 0.00	TIF Project ID	0	Total Value	371,835	371,835		40,902	Total Taxable	40,902 4,007.00	Sale History <table border="1"> <thead> <tr> <th>Bk/Pg</th> <th>Grantor</th> <th>Date</th> <th>Price</th> <th>Code</th> </tr> </thead> <tbody> <tr> <td>/</td> <td>SANCLAN FAMILY TRUST</td> <td>06/16/2023</td> <td>386,000</td> <td>YES</td> </tr> <tr> <td>/</td> <td>MCMANES, ALLEN & JAMIE</td> <td>07/05/2022</td> <td>330,000</td> <td>YES</td> </tr> <tr> <td>1120/944</td> <td>WEBB, RAY A &</td> <td>06/30/1998</td> <td>152,000</td> <td>No</td> </tr> </tbody> </table>					Bk/Pg	Grantor	Date	Price	Code	/	SANCLAN FAMILY TRUST	06/16/2023	386,000	YES	/	MCMANES, ALLEN & JAMIE	07/05/2022	330,000	YES	1120/944	WEBB, RAY A &	06/30/1998	152,000	No																																															
Source	REAL	Fair Cash	Capped	Asmnt Level	Assessed	Levy Rate	97.960	Current Tax																																																																																																																	
Remove Cap	2024	Land Value	141,497	141,497	11%	15,565	Assessed	40,902 4,006.76																																																																																																																	
Year Frozen	0	Improvements	230,338	230,338		25,337	Penalty	0																																																																																																																	
Uncapped Value	0	Mobile Home	0	0		0	Exemption	0 0.00																																																																																																																	
TIF Project ID	0	Total Value	371,835	371,835		40,902	Total Taxable	40,902 4,007.00																																																																																																																	
Bk/Pg	Grantor	Date	Price	Code																																																																																																																					
/	SANCLAN FAMILY TRUST	06/16/2023	386,000	YES																																																																																																																					
/	MCMANES, ALLEN & JAMIE	07/05/2022	330,000	YES																																																																																																																					
1120/944	WEBB, RAY A &	06/30/1998	152,000	No																																																																																																																					
Assessment History <table border="1"> <thead> <tr> <th>Tax Year</th> <th>Statement Number</th> <th>Billed Owner</th> <th>Tax Area</th> <th>Total Value</th> <th>Exemptions</th> <th>Taxable Value</th> <th>Billed Tax</th> </tr> </thead> <tbody> <tr><td>2025</td><td>2025-660019130</td><td>ORR, MASON & KIMBERLIE</td><td>3</td><td>370,189</td><td>0</td><td>40,721</td><td>3,989.00</td></tr> <tr><td>2024</td><td>2024-660019130</td><td>ORR, MASON & KIMBERLIE</td><td>3</td><td>386,231</td><td>0</td><td>42,486</td><td>4,082.00</td></tr> <tr><td>2023</td><td>2023-660019130</td><td>ORR, MASON & KIMBERLIE</td><td>3</td><td>330,000</td><td>0</td><td>36,300</td><td>3,402.00</td></tr> <tr><td>2022</td><td>2022-660019130</td><td>SANCLAN FAMILY TRUST</td><td>3</td><td>192,849</td><td>1000</td><td>19,600</td><td>1,920.00</td></tr> <tr><td>2021</td><td>2021-660019130</td><td>MCMANES, ALLEN & JAMIE</td><td>3</td><td>215,974</td><td>1000</td><td>19,000</td><td>1,838.00</td></tr> <tr><td>2020</td><td>2020-660019130</td><td>MCMANES, ALLEN & JAMIE</td><td>3</td><td>214,724</td><td>1000</td><td>18,419</td><td>1,779.00</td></tr> <tr><td>2019</td><td>2019-660019130</td><td>MCMANES, ALLEN & JAMIE</td><td>3</td><td>203,946</td><td>1000</td><td>17,853</td><td>1,726.00</td></tr> <tr><td>2018</td><td>2018-660019130</td><td>MCMANES, ALLEN & JAMIE</td><td>3</td><td>211,270</td><td>1000</td><td>17,304</td><td>1,611.00</td></tr> <tr><td>2017</td><td>2017-660019130</td><td>MCMANES, ALLEN & JAMIE</td><td>3</td><td>209,183</td><td>1000</td><td>16,771</td><td>1,577.00</td></tr> <tr><td>2016</td><td>2016-660019130</td><td>MCMANES, ALLEN & JAMIE</td><td>3</td><td>204,140</td><td>1000</td><td>16,253</td><td>1,530.00</td></tr> <tr><td>2015</td><td>2015-660019130</td><td>MCMANES, ALLEN & JAMIE</td><td>3</td><td>198,228</td><td>1000</td><td>15,751</td><td>1,494.00</td></tr> <tr><td>2014</td><td>2014-660019130</td><td>MCMANES, ALLEN & JAMIE</td><td>3</td><td>201,999</td><td>1000</td><td>15,263</td><td>1,461.00</td></tr> <tr><td>2013</td><td>2013-660019130</td><td>MCMANES, ALLEN & JAMIE</td><td>3</td><td>190,746</td><td>1000</td><td>14,789</td><td>1,385.00</td></tr> </tbody> </table>										Tax Year	Statement Number	Billed Owner	Tax Area	Total Value	Exemptions	Taxable Value	Billed Tax	2025	2025-660019130	ORR, MASON & KIMBERLIE	3	370,189	0	40,721	3,989.00	2024	2024-660019130	ORR, MASON & KIMBERLIE	3	386,231	0	42,486	4,082.00	2023	2023-660019130	ORR, MASON & KIMBERLIE	3	330,000	0	36,300	3,402.00	2022	2022-660019130	SANCLAN FAMILY TRUST	3	192,849	1000	19,600	1,920.00	2021	2021-660019130	MCMANES, ALLEN & JAMIE	3	215,974	1000	19,000	1,838.00	2020	2020-660019130	MCMANES, ALLEN & JAMIE	3	214,724	1000	18,419	1,779.00	2019	2019-660019130	MCMANES, ALLEN & JAMIE	3	203,946	1000	17,853	1,726.00	2018	2018-660019130	MCMANES, ALLEN & JAMIE	3	211,270	1000	17,304	1,611.00	2017	2017-660019130	MCMANES, ALLEN & JAMIE	3	209,183	1000	16,771	1,577.00	2016	2016-660019130	MCMANES, ALLEN & JAMIE	3	204,140	1000	16,253	1,530.00	2015	2015-660019130	MCMANES, ALLEN & JAMIE	3	198,228	1000	15,751	1,494.00	2014	2014-660019130	MCMANES, ALLEN & JAMIE	3	201,999	1000	15,263	1,461.00	2013	2013-660019130	MCMANES, ALLEN & JAMIE	3	190,746	1000	14,789	1,385.00
Tax Year	Statement Number	Billed Owner	Tax Area	Total Value	Exemptions	Taxable Value	Billed Tax																																																																																																																		
2025	2025-660019130	ORR, MASON & KIMBERLIE	3	370,189	0	40,721	3,989.00																																																																																																																		
2024	2024-660019130	ORR, MASON & KIMBERLIE	3	386,231	0	42,486	4,082.00																																																																																																																		
2023	2023-660019130	ORR, MASON & KIMBERLIE	3	330,000	0	36,300	3,402.00																																																																																																																		
2022	2022-660019130	SANCLAN FAMILY TRUST	3	192,849	1000	19,600	1,920.00																																																																																																																		
2021	2021-660019130	MCMANES, ALLEN & JAMIE	3	215,974	1000	19,000	1,838.00																																																																																																																		
2020	2020-660019130	MCMANES, ALLEN & JAMIE	3	214,724	1000	18,419	1,779.00																																																																																																																		
2019	2019-660019130	MCMANES, ALLEN & JAMIE	3	203,946	1000	17,853	1,726.00																																																																																																																		
2018	2018-660019130	MCMANES, ALLEN & JAMIE	3	211,270	1000	17,304	1,611.00																																																																																																																		
2017	2017-660019130	MCMANES, ALLEN & JAMIE	3	209,183	1000	16,771	1,577.00																																																																																																																		
2016	2016-660019130	MCMANES, ALLEN & JAMIE	3	204,140	1000	16,253	1,530.00																																																																																																																		
2015	2015-660019130	MCMANES, ALLEN & JAMIE	3	198,228	1000	15,751	1,494.00																																																																																																																		
2014	2014-660019130	MCMANES, ALLEN & JAMIE	3	201,999	1000	15,263	1,461.00																																																																																																																		
2013	2013-660019130	MCMANES, ALLEN & JAMIE	3	190,746	1000	14,789	1,385.00																																																																																																																		



Rogers

Assessment Property Record Card for Tax Year 2026

Data provided by LISA DELOZIER County Assessor

Date 04/16/2026
 Time 22:06:59
 Page 2

Lot Data		Square-Foot - NBHD 1118 #1	
Lot Size			
Lot Count	1		
Units Buildable	1		
Non-Ag Acres	0.9906		
Topography			
Street Access			
Utilities			
Amenities	LAND QUALITY	0	
		0	
Method	Square-Foot		
Base Lot Value	43,149.00 x 1.71 = 73,785		
Factor Value			
Adjustments	1.9177		
Lot Value	141,497		

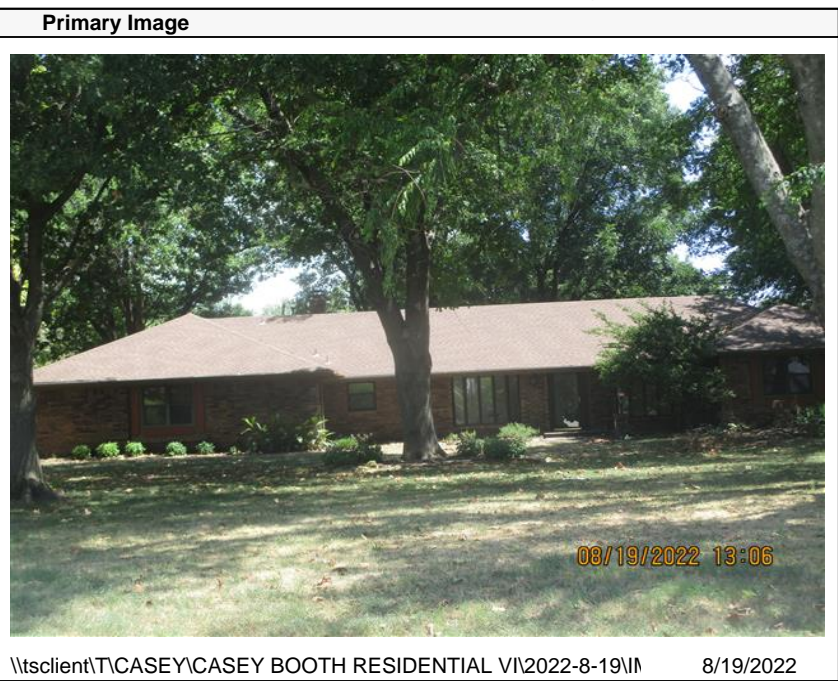

\\tsclient\TCASEY\CASEY BOOTH RESIDENTIAL VI\2022-8-19\ 8/19/2022

Residential Data	
Type	1 Single Family Residence
Condition	3 - Average
Quality	3 - Average
Architecture	
Style	100% One Story
Exterior Wall	85% Veneer, Masonry 15% Frame, Siding, Wood
Base/Total Area	2,091 / 2,091
Style	100% One Story
HVAC	100% Warmed & Cooled Air
Roof Cover	1 Composition Shingle
Area on Slab	2,091
Fixture/RghIn	14 /
Bed/F/H Bath	3 / 2.5 /
Basement Area	
Garage Type	682 Attached Garage - Unfinished
Remodel	RMA -
Year/Eff Age	1976 / 21

GRM Approach

GRM Code	
Gross Rent	0.00
Indicated Value	

Multiple Regression

MRA Code	1 Test
Adjusted R	0.8445
Indicated Value	245,235 117.28 Per SqFt

Direct Comparables

Selection Model	A Adam Test
Adjustment Model	1 2022 Residential
Comparables	8
Indicated Value	322,110 Per SqFt

Value Reconciliation

Selected Approach	Cost Approach
Improvements	222,994
Lot Value	141,497
Indicated Value	364,491 174.31 Per SqFt
Agland Value	
Site Improvements	7,344
Total Value	371,835 177.83 Total Value Per SqFt

Cost Approach		Manual : 01/2025	
Base Cost	105.17	Total Misc Impr	+ 5,830
Roofing Adj	+ 4.65	Garage Cost	+ 20,480
Subfloor Adj	+ -2.19	Total RCN	= 297,325
Heat/Cool Adj	+ 12.64	Depreciation (25%)	- 74,331
Plumbing Adj	+ 9.34	Lump Sums	+ 0
Basement Adj	+ 0.00	RCNLD	= 222,994
Adj Base Cost	= 129.61	Lot Value	+ 141,497
Total Area	x 2,091	Indicated Value	= 364,491
Adjusted Cost	= 271,015	Value Per SqFt	174.31

Miscellaneous Improvements

Code	Description	Sketch ID	Size	Year	Units	Unit Cost	Depr	Value
FPR1	FIREPLACE - RESIDENTIAL 1 STORY	0		1	1	5,615.40		5,615
SHLT	STORM SHELTER	0		1 2015	1	0.00		
PRCH	SLAB PORCH - COVERED	46206	4x2		8	26.90		215



Rogers

Assessment Property Record Card for Tax Year 2026

Data provided by LISA DELOZIER County Assessor

Date 04/16/2026
 Time 22:06:59
 Page 3

Sketch Image

660019130

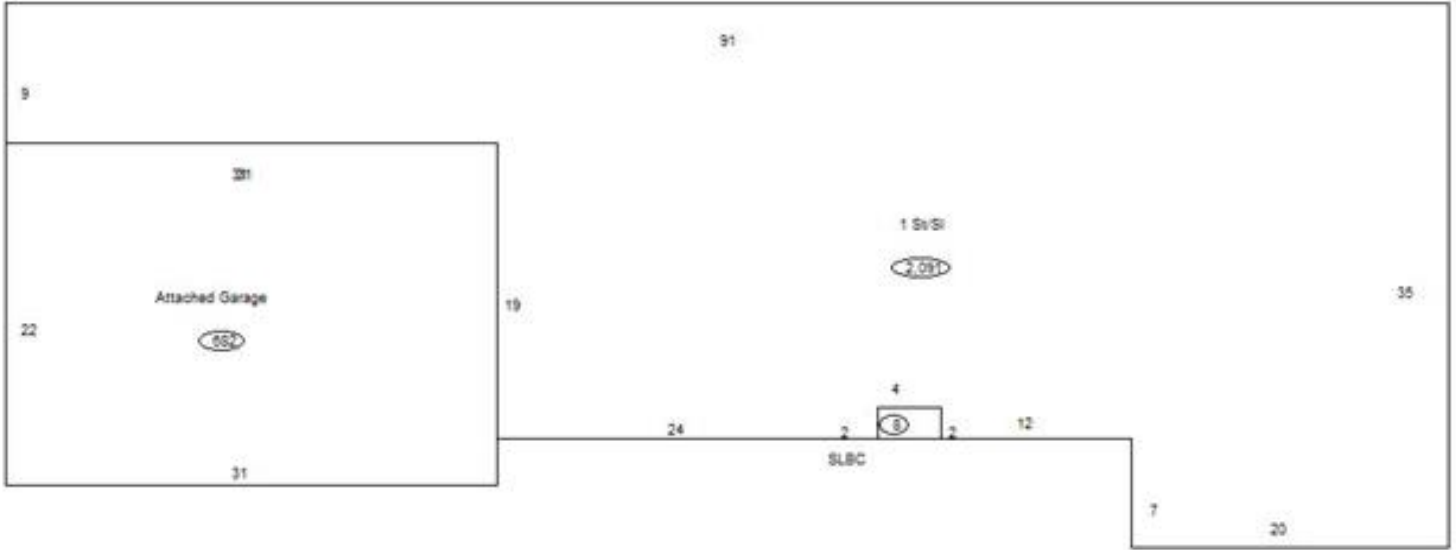

Sketch Vector Information

Sequence	Code	Type	Built Over	Scale	Section Label	Base Area	Multiplier	Total Area
1	R	1	Slab	10	1 St/Sl	2,091	1.000	2,091
2	G	1		10	Attached Garage	682	1.000	682
3	M	PRCH		10	SLBC	8	1.000	8
Total Building Area						2,091		2,091



Rogers

Assessment Property Record Card for Tax Year 2026

Data provided by LISA DELOZIER County Assessor

Date 04/16/2026
Time 22:06:59
Page 4

660019130

Outbuildings/Site Improvements

Building Image	Code	Description	Dimensions	Floor	Roofing	Total Units
	DTGF	DETACHED GARAGE FAIR	30x30x0			900
	Qual 2	Cond 3	Year 2000	Eff Age 20		
Valuation Summary		Modifier Total	RCN	Depr (49% Phys/ % Func)		RCNLD
Base Cost (16.00 x 900)		14,400	14,400	7,056		7,344