



Rogers

Assessment Property Record Card for Tax Year 2026

Data provided by LISA DELOZIER County Assessor

Date 04/18/2026
Time 06:56:57
Page 1

Assessment Data					Primary Image														
Account 660019200 Parcel ID 000000-00-0-00915-003-0005 Cadastral ID 22-21-14-02680 Property Type REAL - Real Property Property Class RRP VI Area 4 Tax Area 3 - OWASSO RURAL/NO FIRE Name ID 304661 KIMMITT, JONATHAN & KATHERINE SUE 9151 N 153RD E AVE OWASSO OK 74055-0000																			
Parcel Location Situs 09151 N 153RD E AVE Subdivision WHISPERING PINES 2 Lot/Block 0005 / 0003 Parcel Size 1 - Lots Sec/Twn/Rng 22 / 21 / 14 / 5 Neighborhood 1069 - R-V04-SW OWASSO School District S021 - OWASSO SCHOOLS																			
Legal Description Lot/Long: 36.28802576 -95.80369055					Building Permits														
LOT 5 BLOCK 3 WHISPERING PINES 2					<table border="1"> <thead> <tr> <th>Number</th> <th>Description</th> <th>Opened</th> <th>Closed</th> <th>Amount</th> </tr> </thead> <tbody> <tr> <td> </td> <td> </td> <td> </td> <td> </td> <td> </td> </tr> </tbody> </table>					Number	Description	Opened	Closed	Amount					
Number	Description	Opened	Closed	Amount															
Exemptions					Sale History														
Code	Type	Active	Maximum	Exemption	Bk/Pg	Grantor	Date	Price	Code										
H	Homestead	Yes	1,000	1,000	2166/486	DALEY, KEN	04/06/2011	155,000	YES										
					1833/324	RAE, ALTON & CHARLA	12/15/2006	166,000	YES										
					1178/9	MILLER, SCOTT C	07/16/1999	124,000	Yes										
Parcel Valuation																			
Source	REAL		Fair Cash	Capped	Asmnt Level	Assessed	Levy Rate	97.960	Current Tax										
Remove Cap	0	Land Value	67,212	51,054	11%	5,616	Assessed	22,067	2,161.68										
Year Frozen	0	Improvements	161,439	149,553		16,451	Penalty	0											
Uncapped Value	0	Mobile Home	0	0		0	Exemption	1,000	-98.00										
TIF Project ID	0	Total Value	228,651	200,607		22,067	Total Taxable	21,067	2,064.00										
Assessment History																			
Tax Year	Statement Number	Billed Owner			Tax Area	Total Value	Exemptions	Taxable Value	Billed Tax										
2025	2025-660019200	KIMMITT, JONATHAN &			3	221,910	1000	20,424	2,001.00										
2024	2024-660019200	KIMMITT, JONATHAN &			3	254,197	1000	19,800	1,902.00										
2023	2023-660019200	KIMMITT, JONATHAN &			3	207,149	1000	19,195	1,799.00										
2022	2022-660019200	KIMMITT, JONATHAN &			3	178,239	1000	18,606	1,823.00										
2021	2021-660019200	KIMMITT, JONATHAN &			3	176,222	1000	18,384	1,778.00										
2020	2020-660019200	KIMMITT, JONATHAN &			3	173,794	1000	18,044	1,743.00										
2019	2019-660019200	KIMMITT, JONATHAN &			3	168,085	1000	17,489	1,691.00										
2018	2018-660019200	KIMMITT, JONATHAN &			3	175,359	1000	18,289	1,702.00										
2017	2017-660019200	KIMMITT, JONATHAN &			3	174,079	1000	18,149	1,707.00										
2016	2016-660019200	KIMMITT, JONATHAN &			3	170,375	1000	17,741	1,670.00										
2015	2015-660019200	KIMMITT, JONATHAN &			3	167,202	1000	17,392	1,649.00										
2014	2014-660019200	KIMMITT, JONATHAN &			3	180,864	1000	17,633	1,688.00										
2013	2013-660019200	KIMMITT, JONATHAN &			3	171,864	1000	17,090	1,601.00										



Rogers

Assessment Property Record Card for Tax Year 2026

Data provided by LISA DELOZIER County Assessor

Date 04/18/2026
Time 06:56:57
Page 2

Lot Data		Square-Foot - NBHD 1069 #1		Primary Image				
Lot Size								
Lot Count	1							
Units Buildable	1							
Non-Ag Acres	1.405							
Topography								
Street Access								
Utilities								
Amenities	LAND QUALITY	0	0					
Method	Square-Foot							
Base Lot Value	61,200.00 x 1.10 = 67,212							
Factor Value								
Adjustments	1.0000							
Lot Value	67,212							
Residential Data								
Type	1 Single Family Residence							
Condition	3 - Average							
Quality	2.5 - Fair							
Architecture								
Style	100% One Story							
Exterior Wall	100% Veneer, Stone							
Base/Total Area	1,792 / 1,792							
Style	100% One Story							
HVAC	100% Warmed & Cooled Air							
Roof Cover	1 Composition Shingle							
Area on Slab	1,792							
Fixture/RghIn	11 /							
Bed/F/H Bath	3 / 2.0 /							
Basement Area								
Garage Type	600 Attached Garage - Unfinished							
Remodel								
Year/Eff Age	1981 / 34							
Cost Approach Manual : 01/2025								
Base Cost	108.71	Total Misc Impr	+	7,112				
Roofing Adj	+ 4.37	Garage Cost	+	15,792				
Subfloor Adj	+ -1.15	Total RCN	=	258,122				
Heat/Cool Adj	+ 11.47	Depreciation (44%)	-	113,574				
Plumbing Adj	+ 7.86	Lump Sums	+	0				
Basement Adj	+ 0.00	RCNLD	=	144,548				
Adj Base Cost	= 131.26	Lot Value	+	67,212				
Total Area	x 1,792	Indicated Value	=	211,760				
Adjusted Cost	= 235,218	Value Per SqFt		118.17				
GRM Approach								
GRM Code								
Gross Rent	0.00							
Indicated Value								
Multiple Regression								
MRA Code	1 Test							
Adusted R	0.8445							
Indicated Value	208,129	116.14	Per SqFt					
Direct Comparables								
Selection Model	A Adam Test							
Adjustment Model	1 2022 Residential							
Comparables	8							
Indicated Value	258,340	Per SqFt						
Value Reconciliation								
Selected Approach	Cost Approach							
Improvements	144,548							
Lot Value	67,212							
Indicated Value	211,760	118.17	Per SqFt					
Agland Value								
Site Improvements	16,891							
Total Value	228,651	127.60	Total Value Per SqFt					
Miscellaneous Improvements								
Code	Description	Sketch ID	Size	Year	Units	Unit Cost	Depr	Value
FPR1	FIREPLACE - RESIDENTIAL 1 STORY	0		1	1	5,095.98		5,096
PRCH	SLAB PORCH - COVERED	46527	12x7		84	24.00		2,016

\\tsclient\TCASEY\CASEY BOOTH RESIDENTIAL VI\2022-8-22\ 8/22/2022



Rogers

Assessment Property Record Card for Tax Year 2026

Data provided by LISA DELOZIER County Assessor

Date 04/18/2026
 Time 06:56:57
 Page 3

Sketch Image

660019200

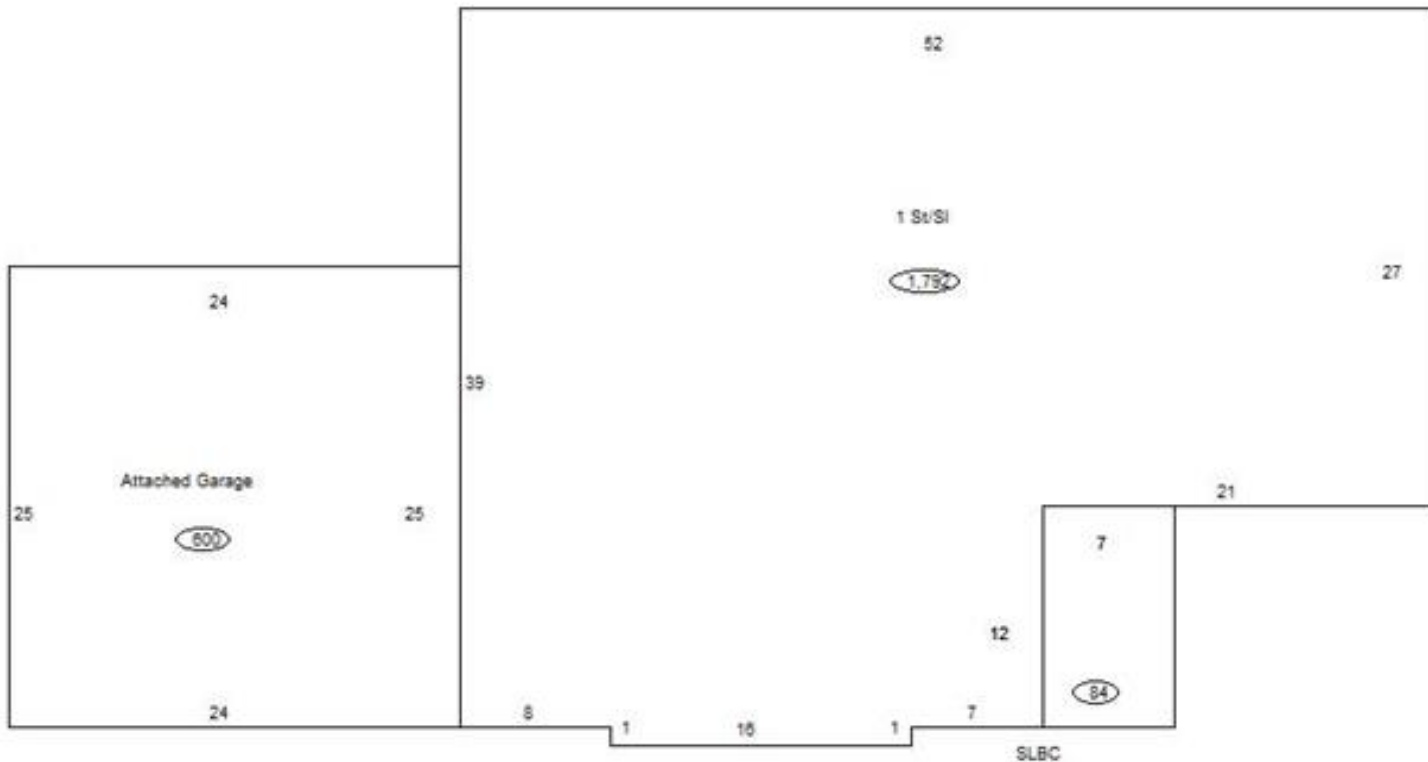

Sketch Vector Information

Sequence	Code	Type	Built Over	Scale	Section Label	Base Area	Multiplier	Total Area
1	R	1	Slab	10	1 St/Sl	1,792	1.000	1,792
2	G	1		10	Attached Garage	600	1.000	600
3	M	PRCH		10	SLBC	84	1.000	84
Total Building Area						1,792		1,792



Rogers

Assessment Property Record Card for Tax Year 2026

Data provided by LISA DELOZIER County Assessor

Date 04/18/2026
Time 06:56:57
Page 4

660019200

Outbuildings/Site Improvements

Building Image	Code	Description	Dimensions	Floor	Roofing	Total Units
	UTIL	SHOP BUILDING	0x0x0			900
	Qual 2	Cond 3	Year 2003	Eff Age 17		
		Valuation Summary	Modifier Total	RCN	Depr (40% Phys/ % Func)	RCNLD
		Base Cost (31.28 x 900)	28,152	28,152	11,261	16,891