



Rogers

Assessment Property Record Card for Tax Year 2026

Data provided by LISA DELOZIER County Assessor

Date 04/16/2026
Time 21:35:39
Page 1

Assessment Data					Primary Image																																																																																																																				
Account 660019204 Parcel ID 000000-00-0-00915-003-0009 Cadastral ID 22-21-14-02720 Property Type REAL - Real Property Property Class RRP VI Area 4 Tax Area 3 - OWASSO RURAL/NO FIRE Name ID 338201 ALBARRAN-SANCHEZ, VICENTE 15345 E 91ST ST N OWASSO OK 74055-0000 Parcel Location Situs 15345 E 91ST ST N Subdivision WHISPERING PINES 2 Lot/Block 0009 / 0003 Parcel Size 1 - Lots Sec/Twn/Rng 22 / 21 / 14 / 5 Neighborhood 1069 - R-V04-SW OWASSO School District S021 - OWASSO SCHOOLS																																																																																																																									
Legal Description Lot/Long: 36.28701363 -95.80403869 LOT 9 BLOCK 3 WHISPERING PINES 2																																																																																																																									
Exemptions <table border="1"> <thead> <tr> <th>Code</th> <th>Type</th> <th>Active</th> <th>Maximum</th> <th>Exemption</th> </tr> </thead> <tbody> <tr> <td>H</td> <td>Homestead</td> <td>No</td> <td>1,000</td> <td></td> </tr> </tbody> </table>					Code	Type	Active	Maximum	Exemption	H	Homestead	No	1,000		Building Permits <table border="1"> <thead> <tr> <th>Number</th> <th>Description</th> <th>Opened</th> <th>Closed</th> <th>Amount</th> </tr> </thead> <tbody> <tr> <td colspan="5"> </td> </tr> </tbody> </table>					Number	Description	Opened	Closed	Amount																																																																																																	
Code	Type	Active	Maximum	Exemption																																																																																																																					
H	Homestead	No	1,000																																																																																																																						
Number	Description	Opened	Closed	Amount																																																																																																																					
Parcel Valuation <table border="1"> <thead> <tr> <th>Source</th> <th>REAL</th> <th>Fair Cash</th> <th>Capped</th> <th>Asmnt Level</th> <th>Assessed</th> <th>Levy Rate</th> <th>97.960</th> <th>Current Tax</th> </tr> </thead> <tbody> <tr> <td>Remove Cap</td> <td>2023</td> <td>Land Value 88,974</td> <td>88,974</td> <td>11%</td> <td>9,787</td> <td>Assessed</td> <td>30,140</td> <td>2,952.51</td> </tr> <tr> <td>Year Frozen</td> <td>0</td> <td>Improvements 185,029</td> <td>185,029</td> <td></td> <td>20,353</td> <td>Penalty</td> <td>0</td> <td></td> </tr> <tr> <td>Uncapped Value</td> <td>0</td> <td>Mobile Home 0</td> <td>0</td> <td></td> <td>0</td> <td>Exemption</td> <td>0</td> <td>0.00</td> </tr> <tr> <td>TIF Project ID</td> <td>0</td> <td>Total Value 274,003</td> <td>274,003</td> <td></td> <td>30,140</td> <td>Total Taxable</td> <td>30,140</td> <td>2,953.00</td> </tr> </tbody> </table>					Source	REAL	Fair Cash	Capped	Asmnt Level	Assessed	Levy Rate	97.960	Current Tax	Remove Cap	2023	Land Value 88,974	88,974	11%	9,787	Assessed	30,140	2,952.51	Year Frozen	0	Improvements 185,029	185,029		20,353	Penalty	0		Uncapped Value	0	Mobile Home 0	0		0	Exemption	0	0.00	TIF Project ID	0	Total Value 274,003	274,003		30,140	Total Taxable	30,140	2,953.00	Sale History <table border="1"> <thead> <tr> <th>Bk/Pg</th> <th>Grantor</th> <th>Date</th> <th>Price</th> <th>Code</th> </tr> </thead> <tbody> <tr> <td>/</td> <td>WARD, CHRISTOPHER J &</td> <td>04/12/2022</td> <td>285,000</td> <td>YES</td> </tr> <tr> <td>2700/53</td> <td>BOKF NA</td> <td>03/23/2018</td> <td>196,500</td> <td>YES</td> </tr> <tr> <td>2647/72</td> <td>RAINEY, SAM J</td> <td>07/13/2017</td> <td>0</td> <td>10</td> </tr> <tr> <td>1719/828</td> <td>GRAND LAKE BANK</td> <td>10/04/2005</td> <td>145,000</td> <td>3</td> </tr> <tr> <td>1602/437</td> <td>FOWLER, KIMBERLY S</td> <td>06/15/2004</td> <td>0</td> <td>9</td> </tr> <tr> <td>1233/444</td> <td>FEDERAL HOME LOAN MORTGAGE-C</td> <td>06/25/2000</td> <td>0</td> <td>No</td> </tr> </tbody> </table>					Bk/Pg	Grantor	Date	Price	Code	/	WARD, CHRISTOPHER J &	04/12/2022	285,000	YES	2700/53	BOKF NA	03/23/2018	196,500	YES	2647/72	RAINEY, SAM J	07/13/2017	0	10	1719/828	GRAND LAKE BANK	10/04/2005	145,000	3	1602/437	FOWLER, KIMBERLY S	06/15/2004	0	9	1233/444	FEDERAL HOME LOAN MORTGAGE-C	06/25/2000	0	No																																
Source	REAL	Fair Cash	Capped	Asmnt Level	Assessed	Levy Rate	97.960	Current Tax																																																																																																																	
Remove Cap	2023	Land Value 88,974	88,974	11%	9,787	Assessed	30,140	2,952.51																																																																																																																	
Year Frozen	0	Improvements 185,029	185,029		20,353	Penalty	0																																																																																																																		
Uncapped Value	0	Mobile Home 0	0		0	Exemption	0	0.00																																																																																																																	
TIF Project ID	0	Total Value 274,003	274,003		30,140	Total Taxable	30,140	2,953.00																																																																																																																	
Bk/Pg	Grantor	Date	Price	Code																																																																																																																					
/	WARD, CHRISTOPHER J &	04/12/2022	285,000	YES																																																																																																																					
2700/53	BOKF NA	03/23/2018	196,500	YES																																																																																																																					
2647/72	RAINEY, SAM J	07/13/2017	0	10																																																																																																																					
1719/828	GRAND LAKE BANK	10/04/2005	145,000	3																																																																																																																					
1602/437	FOWLER, KIMBERLY S	06/15/2004	0	9																																																																																																																					
1233/444	FEDERAL HOME LOAN MORTGAGE-C	06/25/2000	0	No																																																																																																																					
Assessment History <table border="1"> <thead> <tr> <th>Tax Year</th> <th>Statement Number</th> <th>Billed Owner</th> <th>Tax Area</th> <th>Total Value</th> <th>Exemptions</th> <th>Taxable Value</th> <th>Billed Tax</th> </tr> </thead> <tbody> <tr><td>2025</td><td>2025-660019204</td><td>ALBARRAN-SANCHEZ, VICENTE</td><td>3</td><td>272,145</td><td>0</td><td>29,936</td><td>2,933.00</td></tr> <tr><td>2024</td><td>2024-660019204</td><td>ALBARRAN-SANCHEZ, VICENTE</td><td>3</td><td>285,000</td><td>0</td><td>31,350</td><td>3,012.00</td></tr> <tr><td>2023</td><td>2023-660019204</td><td>ALBARRAN-SANCHEZ, VICENTE</td><td>3</td><td>285,000</td><td>0</td><td>31,350</td><td>2,938.00</td></tr> <tr><td>2022</td><td>2022-660019204</td><td>ALBARRAN-SANCHEZ, VICENTE</td><td>3</td><td>227,697</td><td>1000</td><td>22,760</td><td>2,230.00</td></tr> <tr><td>2021</td><td>2021-660019204</td><td>WARD, CHRISTOPHER J &</td><td>3</td><td>209,707</td><td>1000</td><td>22,068</td><td>2,135.00</td></tr> <tr><td>2020</td><td>2020-660019204</td><td>WARD, CHRISTOPHER J &</td><td>3</td><td>208,377</td><td>0</td><td>22,921</td><td>2,214.00</td></tr> <tr><td>2019</td><td>2019-660019204</td><td>WARD, CHRISTOPHER J &</td><td>3</td><td>198,666</td><td>0</td><td>21,853</td><td>2,113.00</td></tr> <tr><td>2018</td><td>2018-660019204</td><td>WARD, CHRISTOPHER J &</td><td>3</td><td>176,312</td><td>0</td><td>19,394</td><td>1,805.00</td></tr> <tr><td>2017</td><td>2017-660019204</td><td>BOKF NA</td><td>3</td><td>174,689</td><td>0</td><td>19,216</td><td>1,807.00</td></tr> <tr><td>2016</td><td>2016-660019204</td><td>RAINEY, SAM J</td><td>3</td><td>171,036</td><td>0</td><td>18,814</td><td>1,771.00</td></tr> <tr><td>2015</td><td>2015-660019204</td><td>RAINEY, SAM J</td><td>3</td><td>169,527</td><td>0</td><td>18,648</td><td>1,768.00</td></tr> <tr><td>2014</td><td>2014-660019204</td><td>RAINEY, SAM J</td><td>3</td><td>181,599</td><td>0</td><td>18,853</td><td>1,805.00</td></tr> <tr><td>2013</td><td>2013-660019204</td><td>RAINEY, SAM J</td><td>3</td><td>173,887</td><td>0</td><td>17,955</td><td>1,682.00</td></tr> </tbody> </table>										Tax Year	Statement Number	Billed Owner	Tax Area	Total Value	Exemptions	Taxable Value	Billed Tax	2025	2025-660019204	ALBARRAN-SANCHEZ, VICENTE	3	272,145	0	29,936	2,933.00	2024	2024-660019204	ALBARRAN-SANCHEZ, VICENTE	3	285,000	0	31,350	3,012.00	2023	2023-660019204	ALBARRAN-SANCHEZ, VICENTE	3	285,000	0	31,350	2,938.00	2022	2022-660019204	ALBARRAN-SANCHEZ, VICENTE	3	227,697	1000	22,760	2,230.00	2021	2021-660019204	WARD, CHRISTOPHER J &	3	209,707	1000	22,068	2,135.00	2020	2020-660019204	WARD, CHRISTOPHER J &	3	208,377	0	22,921	2,214.00	2019	2019-660019204	WARD, CHRISTOPHER J &	3	198,666	0	21,853	2,113.00	2018	2018-660019204	WARD, CHRISTOPHER J &	3	176,312	0	19,394	1,805.00	2017	2017-660019204	BOKF NA	3	174,689	0	19,216	1,807.00	2016	2016-660019204	RAINEY, SAM J	3	171,036	0	18,814	1,771.00	2015	2015-660019204	RAINEY, SAM J	3	169,527	0	18,648	1,768.00	2014	2014-660019204	RAINEY, SAM J	3	181,599	0	18,853	1,805.00	2013	2013-660019204	RAINEY, SAM J	3	173,887	0	17,955	1,682.00
Tax Year	Statement Number	Billed Owner	Tax Area	Total Value	Exemptions	Taxable Value	Billed Tax																																																																																																																		
2025	2025-660019204	ALBARRAN-SANCHEZ, VICENTE	3	272,145	0	29,936	2,933.00																																																																																																																		
2024	2024-660019204	ALBARRAN-SANCHEZ, VICENTE	3	285,000	0	31,350	3,012.00																																																																																																																		
2023	2023-660019204	ALBARRAN-SANCHEZ, VICENTE	3	285,000	0	31,350	2,938.00																																																																																																																		
2022	2022-660019204	ALBARRAN-SANCHEZ, VICENTE	3	227,697	1000	22,760	2,230.00																																																																																																																		
2021	2021-660019204	WARD, CHRISTOPHER J &	3	209,707	1000	22,068	2,135.00																																																																																																																		
2020	2020-660019204	WARD, CHRISTOPHER J &	3	208,377	0	22,921	2,214.00																																																																																																																		
2019	2019-660019204	WARD, CHRISTOPHER J &	3	198,666	0	21,853	2,113.00																																																																																																																		
2018	2018-660019204	WARD, CHRISTOPHER J &	3	176,312	0	19,394	1,805.00																																																																																																																		
2017	2017-660019204	BOKF NA	3	174,689	0	19,216	1,807.00																																																																																																																		
2016	2016-660019204	RAINEY, SAM J	3	171,036	0	18,814	1,771.00																																																																																																																		
2015	2015-660019204	RAINEY, SAM J	3	169,527	0	18,648	1,768.00																																																																																																																		
2014	2014-660019204	RAINEY, SAM J	3	181,599	0	18,853	1,805.00																																																																																																																		
2013	2013-660019204	RAINEY, SAM J	3	173,887	0	17,955	1,682.00																																																																																																																		



Rogers

Assessment Property Record Card for Tax Year 2026

Data provided by LISA DELOZIER County Assessor

Date 04/16/2026
Time 21:35:39
Page 2

Lot Data	Square-Foot - NBHD 1069 #1	Primary Image
Lot Size		
Lot Count	1	
Units Buildable	1	
Non-Ag Acres	1.0012	
Topography		
Street Access		
Utilities		
Amenities	LAND QUALITY	
	0	
	0	
Method	Square-Foot	
Base Lot Value	43,611.00 x 1.30 = 56,659	
Factor Value		
Adjustments	1.5704	
Lot Value	88,974	

Residential Data	
Type	1 Single Family Residence
Condition	3 - Average
Quality	3 - Average
Architecture	
Style	100% 1 1/2 Story Finished
Exterior Wall	90% Veneer, Stone 10% Frame, Siding, Wood
Base/Total Area	952 / 1,836
Style	100% 1 1/2 Story Finished
HVAC	100% Warmed & Cooled Air
Roof Cover	1 Composition Shingle
Area on Slab	952
Fixture/RghIn	14 /
Bed/F/H Bath	3 / 2.5 /
Basement Area	
Garage Type	456 Attached Garage - Unfinished
Remodel	RMA -
Year/Eff Age	1982 / 22



\\tsclient\TCASEY\CASEY BOOTH RESIDENTIAL VI\2022-8-22\ 8/22/2022

GRM Approach	
GRM Code	
Gross Rent	0.00
Indicated Value	

Multiple Regression			
MRA Code	1	Test	
Adjusted R	0.8445		
Indicated Value	204,560	111.42	Per SqFt

Direct Comparables			
Selection Model	A	Adam Test	
Adjustment Model	1	2022 Residential	
Comparables	2		
Indicated Value	301,610		Per SqFt

Cost Approach				Manual : 01/2025			
Base Cost	96.97	Total Misc Impr	+	5,615			
Roofing Adj	+ 2.78	Garage Cost	+	14,875			
Subfloor Adj	+ -1.32	Total RCN	=	243,931			
Heat/Cool Adj	+ 12.64	Depreciation (26%)	-	63,422			
Plumbing Adj	+ 10.63	Lump Sums	+	4,520			
Basement Adj	+ 0.00	RCNLD	=	185,029			
Adj Base Cost	= 121.70	Lot Value	+	88,974			
Total Area	x 1,836	Indicated Value	=	274,003			
Adjusted Cost	= 223,441	Value Per SqFt		149.24			

Value Reconciliation			
Selected Approach	Cost Approach		
Improvements	185,029		
Lot Value	88,974		
Indicated Value	274,003	149.24	Per SqFt
Agland Value			
Site Improvements			
Total Value	274,003	149.24	Total Value Per SqFt

Miscellaneous Improvements								
Code	Description	Sketch ID	Size	Year	Units	Unit Cost	Depr	Value
FPR1	FIREPLACE - RESIDENTIAL 1 STORY	0		1	1	5,615.40		5,615
WODO	WOOD DECK - OPEN	46545	24x20		480	16.96	50%	4,070
WODO	Wood Deck - Open		8x10		80	28.11	80%	450



Rogers

Assessment Property Record Card for Tax Year 2026

Data provided by LISA DELOZIER County Assessor

Date 04/16/2026
 Time 21:35:39
 Page 3

Sketch Image

660019204

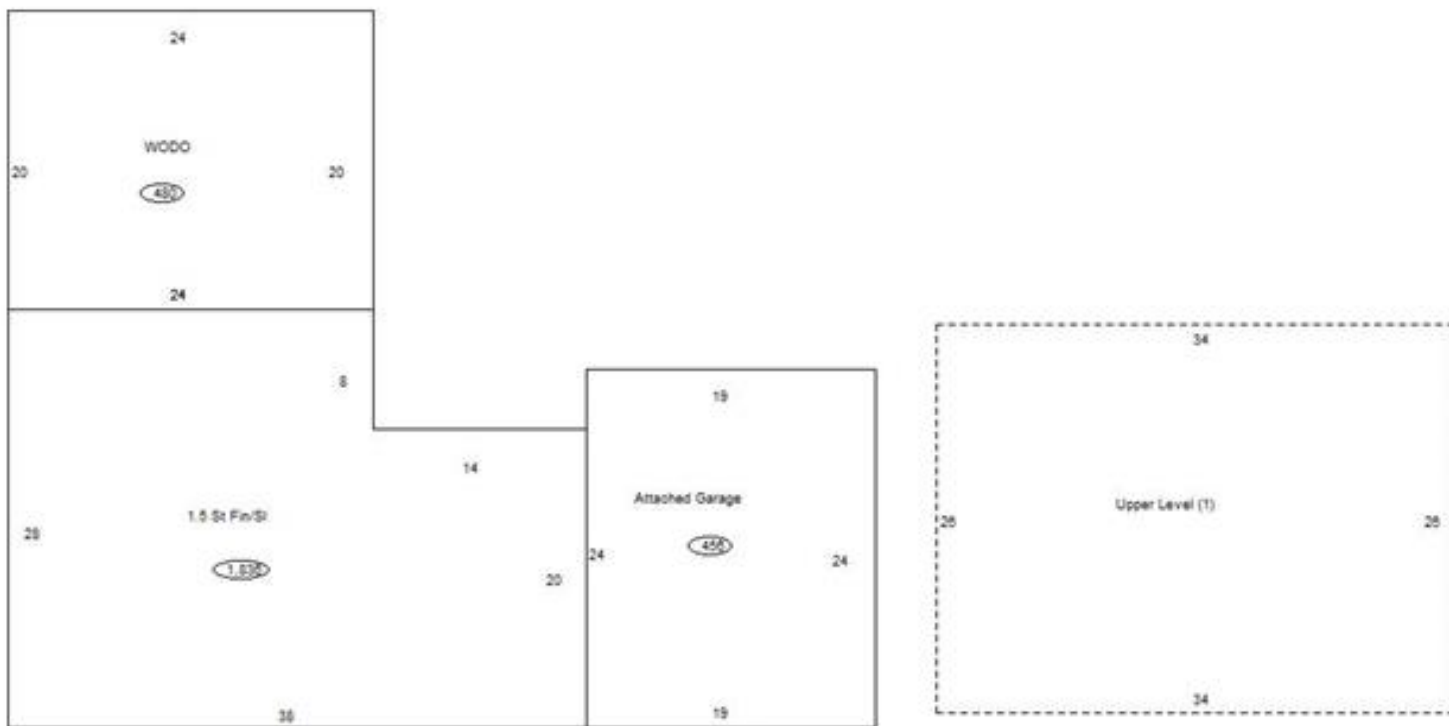

Sketch Vector Information

Sequence	Code	Type	Built Over	Scale	Section Label	Base Area	Multiplier	Total Area
1	R	5	Slab	10	1.5 St Fin/Sl	952	1.929	1,836
2	G	1		10	Attached Garage	456	1.000	456
3	M	WODO		10	WODO	480	1.000	480
4	U	^UL		10	Upper Level (1)	884	1.000	884
Total Building Area						952		1,836



Rogers

Assessment Property Record Card for Tax Year 2026

Data provided by LISA DELOZIER County Assessor

Date 04/16/2026
Time 21:35:39
Page 4

660019204

Outbuildings/Site Improvements

Building Image	Code	Description	Dimensions	Floor	Roofing	Total Units
	STF	STG FAIR	10x22x0			220
	Qual	2	Cond 2	Year	Eff Age 2026	
		Valuation Summary	Modifier Total	RCN	Depr (100% Phys/ % Func)	RCNLD
		Base Cost (4.68 x 220)	1,030		1,030	1,030