



# Rogers

## Assessment Property Record Card for Tax Year 2026

Data provided by LISA DELOZIER County Assessor

Date 04/17/2026  
 Time 16:16:37  
 Page 1

Assessment Data					Primary Image																																																																																																																				
<b>Account</b> 660019236 <b>Parcel ID</b> 000000-00-0-00918-002-0010 <b>Cadastral ID</b> 22-21-14-03050 <b>Property Type</b> REAL - Real Property <b>Property Class</b> RRP VI Area 4 <b>Tax Area</b> 3 - OWASSO RURAL/NO FIRE <b>Name ID</b> 298615 TUCKER, JERRY W &  SHELLY L 9121 N 145TH E AVE OWASSO OK 74055-0000																																																																																																																									
<b>Parcel Location</b> <b>Situs</b> 09121 N 145TH E AVE <b>Subdivision</b> WHISPERING PINES 3 <b>Lot/Block</b> 0010 / 0002 <b>Parcel Size</b> 1 - Lots <b>Sec/Twn/Rng</b> 22 / 21 / 14 / 5 <b>Neighborhood</b> 1069 - R-V04-SW OWASSO <b>School District</b> S021 - OWASSO SCHOOLS																																																																																																																									
<b>Legal Description</b> Lot/Long: 36.28733137 -95.81163350					<b>Building Permits</b> <table border="1"> <thead> <tr> <th>Number</th> <th>Description</th> <th>Opened</th> <th>Closed</th> <th>Amount</th> </tr> </thead> <tbody> <tr> <td>R24 050</td> <td>NEW POOL</td> <td>08/2024</td> <td>08/2024</td> <td>40,000</td> </tr> </tbody> </table>					Number	Description	Opened	Closed	Amount	R24 050	NEW POOL	08/2024	08/2024	40,000																																																																																																						
Number	Description	Opened	Closed	Amount																																																																																																																					
R24 050	NEW POOL	08/2024	08/2024	40,000																																																																																																																					
<b>Exemptions</b> <table border="1"> <thead> <tr> <th>Code</th> <th>Type</th> <th>Active</th> <th>Maximum</th> <th>Exemption</th> </tr> </thead> <tbody> <tr> <td>H</td> <td>Homestead</td> <td>Yes</td> <td>1,000</td> <td>1,000</td> </tr> </tbody> </table>					Code	Type	Active	Maximum	Exemption	H	Homestead	Yes	1,000	1,000	<b>Sale History</b> <table border="1"> <thead> <tr> <th>Bk/Pg</th> <th>Grantor</th> <th>Date</th> <th>Price</th> <th>Code</th> </tr> </thead> <tbody> <tr> <td>1971/419</td> <td>US BANK NATL ASSOC</td> <td>06/27/2008</td> <td>132,000</td> <td>YES</td> </tr> <tr> <td>1947/601</td> <td>BADGWELL, ERIC &amp;</td> <td>04/09/2008</td> <td>0</td> <td>10</td> </tr> <tr> <td>1599/129</td> <td>SAILOR, RODNEY J &amp;</td> <td>06/18/2004</td> <td>135,000</td> <td>YES</td> </tr> <tr> <td>902/313</td> <td>ECKERD, SIDNEY B &amp;</td> <td>12/15/1992</td> <td>96,000</td> <td>Yes</td> </tr> </tbody> </table>					Bk/Pg	Grantor	Date	Price	Code	1971/419	US BANK NATL ASSOC	06/27/2008	132,000	YES	1947/601	BADGWELL, ERIC &	04/09/2008	0	10	1599/129	SAILOR, RODNEY J &	06/18/2004	135,000	YES	902/313	ECKERD, SIDNEY B &	12/15/1992	96,000	Yes																																																																													
Code	Type	Active	Maximum	Exemption																																																																																																																					
H	Homestead	Yes	1,000	1,000																																																																																																																					
Bk/Pg	Grantor	Date	Price	Code																																																																																																																					
1971/419	US BANK NATL ASSOC	06/27/2008	132,000	YES																																																																																																																					
1947/601	BADGWELL, ERIC &	04/09/2008	0	10																																																																																																																					
1599/129	SAILOR, RODNEY J &	06/18/2004	135,000	YES																																																																																																																					
902/313	ECKERD, SIDNEY B &	12/15/1992	96,000	Yes																																																																																																																					
<b>Parcel Valuation</b> <table border="1"> <thead> <tr> <th>Source</th> <th>REAL</th> <th>Fair Cash</th> <th>Capped</th> <th>Asmnt Level</th> <th>Assessed</th> <th>Levy Rate</th> <th>97.960</th> <th>Current Tax</th> </tr> </thead> <tbody> <tr> <td>Remove Cap</td> <td>2009</td> <td>Land Value 57,119</td> <td>42,131</td> <td>11%</td> <td>4,634</td> <td>Assessed</td> <td>22,113</td> <td>2,166.19</td> </tr> <tr> <td>Year Frozen</td> <td>0</td> <td>Improvements 165,838</td> <td>158,902</td> <td></td> <td>17,479</td> <td>Penalty</td> <td>0</td> <td></td> </tr> <tr> <td>Uncapped Value</td> <td>0</td> <td>Mobile Home 0</td> <td>0</td> <td></td> <td>0</td> <td>Exemption</td> <td>1,000</td> <td>-98.00</td> </tr> <tr> <td>TIF Project ID</td> <td>0</td> <td>Total Value 222,957</td> <td>201,033</td> <td></td> <td>22,113</td> <td>Total Taxable</td> <td>21,113</td> <td>2,068.00</td> </tr> </tbody> </table>										Source	REAL	Fair Cash	Capped	Asmnt Level	Assessed	Levy Rate	97.960	Current Tax	Remove Cap	2009	Land Value 57,119	42,131	11%	4,634	Assessed	22,113	2,166.19	Year Frozen	0	Improvements 165,838	158,902		17,479	Penalty	0		Uncapped Value	0	Mobile Home 0	0		0	Exemption	1,000	-98.00	TIF Project ID	0	Total Value 222,957	201,033		22,113	Total Taxable	21,113	2,068.00																																																																			
Source	REAL	Fair Cash	Capped	Asmnt Level	Assessed	Levy Rate	97.960	Current Tax																																																																																																																	
Remove Cap	2009	Land Value 57,119	42,131	11%	4,634	Assessed	22,113	2,166.19																																																																																																																	
Year Frozen	0	Improvements 165,838	158,902		17,479	Penalty	0																																																																																																																		
Uncapped Value	0	Mobile Home 0	0		0	Exemption	1,000	-98.00																																																																																																																	
TIF Project ID	0	Total Value 222,957	201,033		22,113	Total Taxable	21,113	2,068.00																																																																																																																	
<b>Assessment History</b> <table border="1"> <thead> <tr> <th>Tax Year</th> <th>Statement Number</th> <th>Billed Owner</th> <th>Tax Area</th> <th>Total Value</th> <th>Exemptions</th> <th>Taxable Value</th> <th>Billed Tax</th> </tr> </thead> <tbody> <tr><td>2025</td><td>2025-660019236</td><td>TUCKER, JERRY W &amp;</td><td>3</td><td>222,197</td><td>1000</td><td>20,469</td><td>2,005.00</td></tr> <tr><td>2024</td><td>2024-660019236</td><td>TUCKER, JERRY W &amp;</td><td>3</td><td>222,175</td><td>1000</td><td>16,961</td><td>1,629.00</td></tr> <tr><td>2023</td><td>2023-660019236</td><td>TUCKER, JERRY W &amp;</td><td>3</td><td>188,414</td><td>1000</td><td>16,437</td><td>1,540.00</td></tr> <tr><td>2022</td><td>2022-660019236</td><td>TUCKER, JERRY W &amp;</td><td>3</td><td>153,908</td><td>1000</td><td>15,930</td><td>1,561.00</td></tr> <tr><td>2021</td><td>2021-660019236</td><td>TUCKER, JERRY W &amp;</td><td>3</td><td>162,217</td><td>1000</td><td>16,844</td><td>1,629.00</td></tr> <tr><td>2020</td><td>2020-660019236</td><td>TUCKER, JERRY W &amp;</td><td>3</td><td>159,771</td><td>1000</td><td>16,441</td><td>1,588.00</td></tr> <tr><td>2019</td><td>2019-660019236</td><td>TUCKER, JERRY W &amp;</td><td>3</td><td>153,934</td><td>1000</td><td>15,933</td><td>1,540.00</td></tr> <tr><td>2018</td><td>2018-660019236</td><td>TUCKER, JERRY W &amp;</td><td>3</td><td>161,492</td><td>1000</td><td>16,764</td><td>1,560.00</td></tr> <tr><td>2017</td><td>2017-660019236</td><td>TUCKER, JERRY W &amp;</td><td>3</td><td>160,047</td><td>1000</td><td>16,605</td><td>1,562.00</td></tr> <tr><td>2016</td><td>2016-660019236</td><td>TUCKER, JERRY W &amp;</td><td>3</td><td>156,468</td><td>1000</td><td>16,211</td><td>1,526.00</td></tr> <tr><td>2015</td><td>2015-660019236</td><td>TUCKER, JERRY W &amp;</td><td>3</td><td>153,405</td><td>1000</td><td>15,875</td><td>1,505.00</td></tr> <tr><td>2014</td><td>2014-660019236</td><td>TUCKER, JERRY W &amp;</td><td>3</td><td>154,643</td><td>1000</td><td>15,685</td><td>1,501.00</td></tr> <tr><td>2013</td><td>2013-660019236</td><td>TUCKER, JERRY W &amp;</td><td>3</td><td>147,262</td><td>1000</td><td>15,199</td><td>1,424.00</td></tr> </tbody> </table>										Tax Year	Statement Number	Billed Owner	Tax Area	Total Value	Exemptions	Taxable Value	Billed Tax	2025	2025-660019236	TUCKER, JERRY W &	3	222,197	1000	20,469	2,005.00	2024	2024-660019236	TUCKER, JERRY W &	3	222,175	1000	16,961	1,629.00	2023	2023-660019236	TUCKER, JERRY W &	3	188,414	1000	16,437	1,540.00	2022	2022-660019236	TUCKER, JERRY W &	3	153,908	1000	15,930	1,561.00	2021	2021-660019236	TUCKER, JERRY W &	3	162,217	1000	16,844	1,629.00	2020	2020-660019236	TUCKER, JERRY W &	3	159,771	1000	16,441	1,588.00	2019	2019-660019236	TUCKER, JERRY W &	3	153,934	1000	15,933	1,540.00	2018	2018-660019236	TUCKER, JERRY W &	3	161,492	1000	16,764	1,560.00	2017	2017-660019236	TUCKER, JERRY W &	3	160,047	1000	16,605	1,562.00	2016	2016-660019236	TUCKER, JERRY W &	3	156,468	1000	16,211	1,526.00	2015	2015-660019236	TUCKER, JERRY W &	3	153,405	1000	15,875	1,505.00	2014	2014-660019236	TUCKER, JERRY W &	3	154,643	1000	15,685	1,501.00	2013	2013-660019236	TUCKER, JERRY W &	3	147,262	1000	15,199	1,424.00
Tax Year	Statement Number	Billed Owner	Tax Area	Total Value	Exemptions	Taxable Value	Billed Tax																																																																																																																		
2025	2025-660019236	TUCKER, JERRY W &	3	222,197	1000	20,469	2,005.00																																																																																																																		
2024	2024-660019236	TUCKER, JERRY W &	3	222,175	1000	16,961	1,629.00																																																																																																																		
2023	2023-660019236	TUCKER, JERRY W &	3	188,414	1000	16,437	1,540.00																																																																																																																		
2022	2022-660019236	TUCKER, JERRY W &	3	153,908	1000	15,930	1,561.00																																																																																																																		
2021	2021-660019236	TUCKER, JERRY W &	3	162,217	1000	16,844	1,629.00																																																																																																																		
2020	2020-660019236	TUCKER, JERRY W &	3	159,771	1000	16,441	1,588.00																																																																																																																		
2019	2019-660019236	TUCKER, JERRY W &	3	153,934	1000	15,933	1,540.00																																																																																																																		
2018	2018-660019236	TUCKER, JERRY W &	3	161,492	1000	16,764	1,560.00																																																																																																																		
2017	2017-660019236	TUCKER, JERRY W &	3	160,047	1000	16,605	1,562.00																																																																																																																		
2016	2016-660019236	TUCKER, JERRY W &	3	156,468	1000	16,211	1,526.00																																																																																																																		
2015	2015-660019236	TUCKER, JERRY W &	3	153,405	1000	15,875	1,505.00																																																																																																																		
2014	2014-660019236	TUCKER, JERRY W &	3	154,643	1000	15,685	1,501.00																																																																																																																		
2013	2013-660019236	TUCKER, JERRY W &	3	147,262	1000	15,199	1,424.00																																																																																																																		



# Rogers

## Assessment Property Record Card for Tax Year 2026

Data provided by LISA DELOZIER County Assessor

Date 04/17/2026  
Time 16:16:37  
Page 2

Lot Data	Square-Foot - NBHD 1069 #1	Primary Image
Lot Size		
Lot Count	1	
Units Buildable	1	
Non-Ag Acres	1.0188	
Topography		
Street Access		
Utilities		
Amenities	LAND QUALITY 0	
	0	
Method	Square-Foot	
Base Lot Value	44,379.00 x 1.29 = 57,119	
Factor Value		
Adjustments	1.0000	
Lot Value	57,119	

Residential Data	
Type	1 Single Family Residence
Condition	3 - Average
Quality	2.5 - Fair
Architecture	
Style	100% 1 1/2 Story Finished
Exterior Wall	100% Veneer, Masonry
Base/Total Area	1,085 / 1,910
Style	100% 1 1/2 Story Finished
HVAC	100% Warmed & Cooled Air
Roof Cover	1 Composition Shingle
Area on Slab	1,085
Fixture/RghIn	11 /
Bed/F/H Bath	3 / 2.0 /
Basement Area	
Garage Type	455 Attached Garage - Unfinished
Remodel	
Year/Eff Age	1981 / 34



\\tsclient\TCASEY\CASEY BOOTH RESIDENTIAL VI\2022-8-22\ 8/22/2022

GRM Approach	
GRM Code	
Gross Rent	0.00
Indicated Value	

Multiple Regression			
MRA Code	1	Test	
Adjusted R	0.8445		
Indicated Value	218,542	114.42	Per SqFt

Direct Comparables			
Selection Model	A	Adam Test	
Adjustment Model	1	2022 Residential	
Comparables	8		
Indicated Value	244,550		Per SqFt

Value Reconciliation			
Selected Approach	Cost Approach		
Improvements	132,815		
Lot Value	57,119		
Indicated Value	189,934	99.44	Per SqFt
Agland Value			
Site Improvements	33,023		
Total Value	222,957	116.73	Total Value Per SqFt

Cost Approach				Manual : 01/2025			
Base Cost	91.71	Total Misc Impr	+	9,276			
Roofing Adj	+ 2.80	Garage Cost	+	12,790			
Subfloor Adj	+ -0.73	Total RCN	=	237,170			
Heat/Cool Adj	+ 11.47	Depreciation ( 44%)	-	104,355			
Plumbing Adj	+ 7.37	Lump Sums	+	0			
Basement Adj	+ 0.00	RCNLD	=	132,815			
Adj Base Cost	= 112.62	Lot Value	+	57,119			
Total Area	x 1,910	Indicated Value	=	189,934			
Adjusted Cost	= 215,104	Value Per SqFt		99.44			

Miscellaneous Improvements								
Code	Description	Sketch ID	Size	Year	Units	Unit Cost	Depr	Value
FPR1	FIREPLACE - RESIDENTIAL 1 STORY	0		1	1	5,095.98		5,096
PRCH	SLAB PORCH - COVERED	46690		7x2	14	24.22		339
PRCH	SLAB PORCH - COVERED	46691		162	162	23.71		3,841



# Rogers

## Assessment Property Record Card for Tax Year 2026

Data provided by LISA DELOZIER County Assessor

Date 04/17/2026  
 Time 16:16:37  
 Page 3

### Sketch Image

660019236

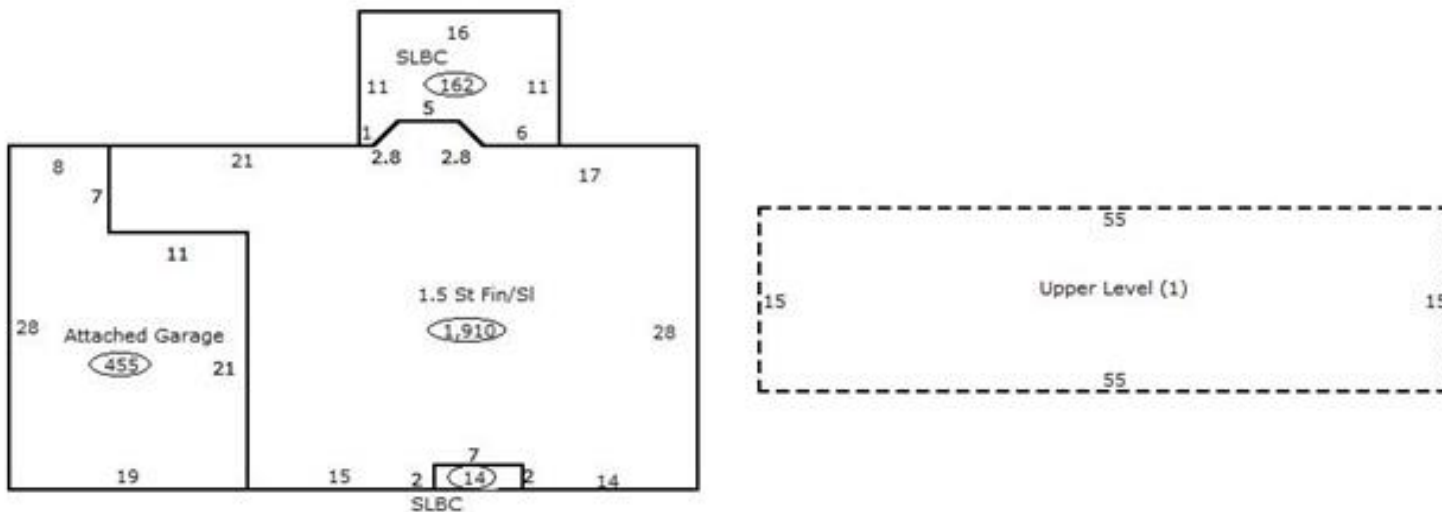

### Sketch Vector Information

Sequence	Code	Type	Built Over	Scale	Section Label	Base Area	Multiplier	Total Area
1	R	5	Slab	13	1.5 St Fin/SI	1,085	1.760	1,910
2	G	1		13	Attached Garage	455	1.000	455
3	M	PRCH		13	SLBC	14	1.000	14
4	M	PRCH		13	SLBC	162	1.000	162
5	U	^UL		13	Upper Level (1)	825	1.000	825
<b>Total Building Area</b>						<b>1,085</b>		<b>1,910</b>



# Rogers



## Assessment Property Record Card for Tax Year 2026

Data provided by LISA DELOZIER County Assessor

Date 04/17/2026  
 Time 16:16:37  
 Page 4

660019236

### Outbuildings/Site Improvements

Building Image	Code	Description	Dimensions	Floor	Roofing	Total Units	
	SF	Fiberglass Inground Pool	0x0x0			1	
	Qual	6	Cond 6	Year 2024	Eff Age 1		
	<b>Valuation Summary</b>		<b>Modifier Total</b>		<b>RCN</b>	<b>Depr (5% Phys/ % Func)</b>	<b>RCNLD</b>
		Base Cost (27,000.00 x 1)	27,000		27,000	1,350	25,650
	DTGF	DETACHED GARAGE FAIR	0x0x0			576	
	Qual	2	Cond 3	Year	Eff Age		
	<b>Valuation Summary</b>		<b>Modifier Total</b>		<b>RCN</b>	<b>Depr (20% Phys/ % Func)</b>	<b>RCNLD</b>
		Base Cost (16.00 x 576)	9,216		9,216	1,843	7,373
	STF	STG FAIR	8x10x0			80	
	Qual	2	Cond 3	Year	Eff Age 1520		
	<b>Valuation Summary</b>		<b>Modifier Total</b>		<b>RCN</b>	<b>Depr (100% Phys/ % Func)</b>	<b>RCNLD</b>
		Base Cost (4.68 x 80)	374		374	374	