



Rogers

Assessment Property Record Card for Tax Year 2026

Data provided by LISA DELOZIER County Assessor

Date 04/17/2026
 Time 00:34:45
 Page 1

Assessment Data					Primary Image																																																																																																																				
Account 660019514 Parcel ID 23N17E-22-1-00000-000-0000 Cadastral ID 22-23-17-00200 Property Type REAL - Real Property Property Class RR VI Area 2 Tax Area 71 - CHELSEA RURAL/FOYIL FIRE Name ID 300299 SCHUMACHER, DALE A & SHEREE RONNA 19682 E 380 RD CHELSEA OK 74016-0000 Parcel Location Situs 19682 E 380 RD Subdivision Lot/Block / Parcel Size 5 - Acres Sec/Twn/Rng 22 / 23 / 17 / 1 Neighborhood 4070 - FOYIL SEQUOYAH AREA School District S003 - CHELSEA SCHOOLS					<p>660019514_003.JPG 2/22/2025</p>																																																																																																																				
Legal Description Lat/Long: 36.46589045 -95.47660287 E2 NE NW NE																																																																																																																									
Exemptions <table border="1"> <thead> <tr> <th>Code</th> <th>Type</th> <th>Active</th> <th>Maximum</th> <th>Exemption</th> </tr> </thead> <tbody> <tr> <td>H</td> <td>Homestead</td> <td>Yes</td> <td>1,000</td> <td>1,000</td> </tr> </tbody> </table>					Code	Type	Active	Maximum	Exemption	H	Homestead	Yes	1,000	1,000	Building Permits <table border="1"> <thead> <tr> <th>Number</th> <th>Description</th> <th>Opened</th> <th>Closed</th> <th>Amount</th> </tr> </thead> <tbody> <tr> <td></td> <td></td> <td></td> <td></td> <td></td> </tr> </tbody> </table>					Number	Description	Opened	Closed	Amount																																																																																																	
Code	Type	Active	Maximum	Exemption																																																																																																																					
H	Homestead	Yes	1,000	1,000																																																																																																																					
Number	Description	Opened	Closed	Amount																																																																																																																					
Parcel Valuation <table border="1"> <thead> <tr> <th>Source</th> <th>REAL</th> <th>Fair Cash</th> <th>Capped</th> <th>Asmnt Level</th> <th>Assessed</th> <th>Levy Rate</th> <th>95.740</th> <th>Current Tax</th> </tr> </thead> <tbody> <tr> <td>Remove Cap</td> <td>0</td> <td>Land Value 76,175</td> <td>44,305</td> <td>11%</td> <td>4,874</td> <td>Assessed</td> <td>23,456</td> <td>2,245.68</td> </tr> <tr> <td>Year Frozen</td> <td>0</td> <td>Improvements 224,389</td> <td>168,924</td> <td></td> <td>18,582</td> <td>Penalty</td> <td>0</td> <td></td> </tr> <tr> <td>Uncapped Value</td> <td>0</td> <td>Mobile Home 0</td> <td>0</td> <td></td> <td>0</td> <td>Exemption</td> <td>1,000</td> <td>-83.00</td> </tr> <tr> <td>TIF Project ID</td> <td>0</td> <td>Total Value 300,564</td> <td>213,229</td> <td></td> <td>23,456</td> <td>Total Taxable</td> <td>22,456</td> <td>2,163.00</td> </tr> </tbody> </table>					Source	REAL	Fair Cash	Capped	Asmnt Level	Assessed	Levy Rate	95.740	Current Tax	Remove Cap	0	Land Value 76,175	44,305	11%	4,874	Assessed	23,456	2,245.68	Year Frozen	0	Improvements 224,389	168,924		18,582	Penalty	0		Uncapped Value	0	Mobile Home 0	0		0	Exemption	1,000	-83.00	TIF Project ID	0	Total Value 300,564	213,229		23,456	Total Taxable	22,456	2,163.00	Sale History <table border="1"> <thead> <tr> <th>Bk/Pg</th> <th>Grantor</th> <th>Date</th> <th>Price</th> <th>Code</th> </tr> </thead> <tbody> <tr> <td>/</td> <td>SCHUMACHER, DALE A</td> <td>02/22/2019</td> <td>0</td> <td>4</td> </tr> <tr> <td>2020/678</td> <td>SCHUMACHER, DALE A & HOLLY-L</td> <td>04/23/2009</td> <td>0</td> <td>4</td> </tr> <tr> <td>832/137</td> <td></td> <td></td> <td>27,000</td> <td>No</td> </tr> </tbody> </table>					Bk/Pg	Grantor	Date	Price	Code	/	SCHUMACHER, DALE A	02/22/2019	0	4	2020/678	SCHUMACHER, DALE A & HOLLY-L	04/23/2009	0	4	832/137			27,000	No																																															
Source	REAL	Fair Cash	Capped	Asmnt Level	Assessed	Levy Rate	95.740	Current Tax																																																																																																																	
Remove Cap	0	Land Value 76,175	44,305	11%	4,874	Assessed	23,456	2,245.68																																																																																																																	
Year Frozen	0	Improvements 224,389	168,924		18,582	Penalty	0																																																																																																																		
Uncapped Value	0	Mobile Home 0	0		0	Exemption	1,000	-83.00																																																																																																																	
TIF Project ID	0	Total Value 300,564	213,229		23,456	Total Taxable	22,456	2,163.00																																																																																																																	
Bk/Pg	Grantor	Date	Price	Code																																																																																																																					
/	SCHUMACHER, DALE A	02/22/2019	0	4																																																																																																																					
2020/678	SCHUMACHER, DALE A & HOLLY-L	04/23/2009	0	4																																																																																																																					
832/137			27,000	No																																																																																																																					
Assessment History <table border="1"> <thead> <tr> <th>Tax Year</th> <th>Statement Number</th> <th>Billed Owner</th> <th>Tax Area</th> <th>Total Value</th> <th>Exemptions</th> <th>Taxable Value</th> <th>Billed Tax</th> </tr> </thead> <tbody> <tr><td>2025</td><td>2025-660019514</td><td>SCHUMACHER, DALE A &</td><td>71</td><td>291,007</td><td>1000</td><td>21,772</td><td>2,098.00</td></tr> <tr><td>2024</td><td>2024-660019514</td><td>SCHUMACHER, DALE A &</td><td>71</td><td>259,580</td><td>1000</td><td>17,917</td><td>1,762.00</td></tr> <tr><td>2023</td><td>2023-660019514</td><td>SCHUMACHER, DALE A &</td><td>71</td><td>209,792</td><td>1000</td><td>17,365</td><td>1,726.00</td></tr> <tr><td>2022</td><td>2022-660019514</td><td>SCHUMACHER, DALE A &</td><td>71</td><td>198,438</td><td>1000</td><td>16,831</td><td>1,682.00</td></tr> <tr><td>2021</td><td>2021-660019514</td><td>SCHUMACHER, DALE A &</td><td>71</td><td>173,519</td><td>1000</td><td>16,312</td><td>1,644.00</td></tr> <tr><td>2020</td><td>2020-660019514</td><td>SCHUMACHER, DALE A &</td><td>71</td><td>159,786</td><td>1000</td><td>15,808</td><td>1,610.00</td></tr> <tr><td>2019</td><td>2019-660019514</td><td>SCHUMACHER, DALE A &</td><td>71</td><td>148,344</td><td>1000</td><td>15,318</td><td>1,586.00</td></tr> <tr><td>2018</td><td>2018-660019514</td><td>SCHUMACHER, DALE A</td><td>71</td><td>151,742</td><td>1000</td><td>15,318</td><td>1,570.00</td></tr> <tr><td>2017</td><td>2017-660019514</td><td>SCHUMACHER, DALE A</td><td>71</td><td>150,612</td><td>1000</td><td>14,843</td><td>1,538.00</td></tr> <tr><td>2016</td><td>2016-660019514</td><td>SCHUMACHER, DALE A</td><td>71</td><td>139,828</td><td>1000</td><td>14,381</td><td>1,513.00</td></tr> <tr><td>2015</td><td>2015-660019514</td><td>SCHUMACHER, DALE A</td><td>71</td><td>151,081</td><td>1000</td><td>15,619</td><td>1,622.00</td></tr> <tr><td>2014</td><td>2014-660019514</td><td>SCHUMACHER, DALE A</td><td>71</td><td>148,623</td><td>1000</td><td>15,348</td><td>1,644.00</td></tr> <tr><td>2013</td><td>2013-660019514</td><td>SCHUMACHER, DALE A</td><td>71</td><td>148,623</td><td>1000</td><td>15,348</td><td>1,622.00</td></tr> </tbody> </table>										Tax Year	Statement Number	Billed Owner	Tax Area	Total Value	Exemptions	Taxable Value	Billed Tax	2025	2025-660019514	SCHUMACHER, DALE A &	71	291,007	1000	21,772	2,098.00	2024	2024-660019514	SCHUMACHER, DALE A &	71	259,580	1000	17,917	1,762.00	2023	2023-660019514	SCHUMACHER, DALE A &	71	209,792	1000	17,365	1,726.00	2022	2022-660019514	SCHUMACHER, DALE A &	71	198,438	1000	16,831	1,682.00	2021	2021-660019514	SCHUMACHER, DALE A &	71	173,519	1000	16,312	1,644.00	2020	2020-660019514	SCHUMACHER, DALE A &	71	159,786	1000	15,808	1,610.00	2019	2019-660019514	SCHUMACHER, DALE A &	71	148,344	1000	15,318	1,586.00	2018	2018-660019514	SCHUMACHER, DALE A	71	151,742	1000	15,318	1,570.00	2017	2017-660019514	SCHUMACHER, DALE A	71	150,612	1000	14,843	1,538.00	2016	2016-660019514	SCHUMACHER, DALE A	71	139,828	1000	14,381	1,513.00	2015	2015-660019514	SCHUMACHER, DALE A	71	151,081	1000	15,619	1,622.00	2014	2014-660019514	SCHUMACHER, DALE A	71	148,623	1000	15,348	1,644.00	2013	2013-660019514	SCHUMACHER, DALE A	71	148,623	1000	15,348	1,622.00
Tax Year	Statement Number	Billed Owner	Tax Area	Total Value	Exemptions	Taxable Value	Billed Tax																																																																																																																		
2025	2025-660019514	SCHUMACHER, DALE A &	71	291,007	1000	21,772	2,098.00																																																																																																																		
2024	2024-660019514	SCHUMACHER, DALE A &	71	259,580	1000	17,917	1,762.00																																																																																																																		
2023	2023-660019514	SCHUMACHER, DALE A &	71	209,792	1000	17,365	1,726.00																																																																																																																		
2022	2022-660019514	SCHUMACHER, DALE A &	71	198,438	1000	16,831	1,682.00																																																																																																																		
2021	2021-660019514	SCHUMACHER, DALE A &	71	173,519	1000	16,312	1,644.00																																																																																																																		
2020	2020-660019514	SCHUMACHER, DALE A &	71	159,786	1000	15,808	1,610.00																																																																																																																		
2019	2019-660019514	SCHUMACHER, DALE A &	71	148,344	1000	15,318	1,586.00																																																																																																																		
2018	2018-660019514	SCHUMACHER, DALE A	71	151,742	1000	15,318	1,570.00																																																																																																																		
2017	2017-660019514	SCHUMACHER, DALE A	71	150,612	1000	14,843	1,538.00																																																																																																																		
2016	2016-660019514	SCHUMACHER, DALE A	71	139,828	1000	14,381	1,513.00																																																																																																																		
2015	2015-660019514	SCHUMACHER, DALE A	71	151,081	1000	15,619	1,622.00																																																																																																																		
2014	2014-660019514	SCHUMACHER, DALE A	71	148,623	1000	15,348	1,644.00																																																																																																																		
2013	2013-660019514	SCHUMACHER, DALE A	71	148,623	1000	15,348	1,622.00																																																																																																																		



Rogers

Assessment Property Record Card for Tax Year 2026

Data provided by LISA DELOZIER County Assessor

Date 04/17/2026
 Time 00:34:45
 Page 2

Lot Data		Square-Foot - NBHD 4070 #1	
Lot Size			
Lot Count			
Units Buildable	5		
Non-Ag Acres	4.9949		
Topography			
Street Access			
Utilities			
Amenities	LAND QUALITY	0	0
Method	Square-Foot		
Base Lot Value	217,578.00 x .35 = 76,175		
Factor Value			
Adjustments	1.0000		
Lot Value	76,175		



660019514_003.JPG 2/22/2025

Residential Data	
Type	
Condition	-
Quality	-
Architecture	
Style	
Exterior Wall	
Base/Total Area	/
Style	
HVAC	
Roof Cover	
Area on Slab	
Fixture/RghIn	/
Bed/F/H Bath	//
Basement Area	
Garage Type	
Remodel	
Year/Eff Age	/

GRM Approach	
GRM Code	
Gross Rent	0.00
Indicated Value	

Multiple Regression	
MRA Code	
Adjusted R	
Indicated Value	

Direct Comparables	
Selection Model	1 Res
Adjustment Model	A2 AO Test
Comparables	
Indicated Value	

Cost Approach		Manual : 01/2025	
Base Cost	0.00	Total Misc Impr	+ 0
Roofing Adj	+ 0.00	Garage Cost	+ 0
Subfloor Adj	+ 0.00	Total RCN	= 0
Heat/Cool Adj	+ 0.00	Depreciation (0%)	- 0
Plumbing Adj	+ 0.00	Lump Sums	+ 0
Basement Adj	+ 0.00	RCNLD	= 0
Adj Base Cost	= 0.00	Lot Value	+ 76,175
Total Area	x	Indicated Value	= 76,175
Adjusted Cost	= 0	Value Per SqFt	0.00

Value Reconciliation			
Selected Approach	Cost Approach		
Improvements			
Lot Value	76,175		
Indicated Value	76,175	0.00	Per SqFt
Agland Value			
Site Improvements	96,506		
Total Value	172,681	0.00	Total Value Per SqFt

Miscellaneous Improvements							
Code	Description	Sketch ID	Size	Year	Units	Unit Cost	Depr Value
SHLT	STORM SHELTER			1	2017	1	0.00



Rogers





Assessment Property Record Card for Tax Year 2026

Data provided by LISA DELOZIER County Assessor

Date 04/17/2026
 Time 00:34:45
 Page 3

660019514

Outbuildings/Site Improvements

Building Image	Code	Description	Dimensions	Floor	Roofing	Total Units
	GRDT	Garage - Detached	30x40x10	Concrete	Formed Metal	1,200
	Qual 3	Cond 3	Year 2022	Eff Age 3		
	Valuation Summary		Modifier Total	RCN	Depr (5% Phys/ % Func)	RCNLD
	Base Cost (27.24 x 1,200)		32,688	32,688	1,634	31,054
	UTIL	SHOP BUILDING	32x50x10	Concrete	Galvanized Metal	1,600
	Qual 2	Cond 3	Year 2021	Eff Age 4		
	Valuation Summary		Modifier Total	RCN	Depr (7% Phys/ % Func)	RCNLD
	Base Cost (28.41 x 1,600)		45,456	45,456	3,182	42,274
	UTIL	Utility Building	14x16x8	Plank	Formed Metal	224
	Qual 3	Cond 3	Year 2021	Eff Age 4		
	Valuation Summary		Modifier Total	RCN	Depr (7% Phys/ % Func)	RCNLD
	Base Cost (31.90 x 224)		7,146	14,720	1,030	13,690
	Interior Finish (Residential)		Finished Area	Fixture Count		7,574
	SHDS	Shed - Small	8x8x6	Dirt	Formed Metal	64
	Qual 2	Cond 2	Year 2000	Eff Age 26		
	Valuation Summary		Modifier Total	RCN	Depr (70% Phys/ % Func)	RCNLD
	Base Cost (21.02 x 64)		1,345	1,345	942	403
	BNGP	Barn - General Purpose	32x40x10	Dirt	Galvanized Metal	1,280
	Qual 3	Cond 2.5	Year 1980	Eff Age 41		
	Valuation Summary		Modifier Total	RCN	Depr (65% Phys/ % Func)	RCNLD
	Base Cost (20.28 x 1,280)		25,958	25,958	16,873	9,085



Rogers

Assessment Property Record Card for Tax Year 2026

Data provided by LISA DELOZIER County Assessor

Date 04/17/2026
 Time 00:34:45
 Page 4

Lot Data	Primary Image
Lot Size Lot Count Units Buildable Non-Ag Acres Topography Street Access Utilities Amenities LAND QUALITY Method Base Lot Value Factor Value Adjustments Lot Value	

Residential Data	
Type	6 Mobile Home 82 x 32
Condition	4 - Good
Quality	5.5 - Very Good
Architecture	6 MS ADJ
Style	100% Double Wide
Exterior Wall	100% Hardboard Lap
Base/Total Area	2,624 / 2,624
Style	100% Double Wide
HVAC	100% Warmed & Cooled Air
Roof Cover	1 Composition Shingle
Area on Slab	0
Fixture/RghIn	14 /
Bed/F/H Bath	3 / 2.0 /
Basement Area	
Garage Type	
Remodel	
Year/Eff Age	2012 / 8

GRM Approach	
GRM Code	
Gross Rent	0.00
Indicated Value	

Multiple Regression		
MRA Code	1 Test	
Adusted R	0.8445	
Indicated Value	420,029	160.07 Per SqFt

Direct Comparables	
Selection Model	1 Res
Adjustment Model	A2 AO Test
Comparables	
Indicated Value	

Cost Approach				Manual : 01/2025			
Base Cost	42.68	Total Misc Impr	+	0			
Roofing Adj	+ 4.01	Garage Cost	+				
Subfloor Adj	+ 0.00	Total RCN	=	160,982			
Heat/Cool Adj	+ 2.83	Depreciation (29%)	-	46,685			
Plumbing Adj	+ 11.83	Lump Sums	+	13,586			
Basement Adj	+ 0.00	RCNLD	=	127,883			
Adj Base Cost	= 61.35	Lot Value	+				
Total Area	x 2,624	Indicated Value	=	127,883			
Adjusted Cost	= 160,982	Value Per SqFt		48.74			

Value Reconciliation		
Selected Approach	Cost Approach	
Improvements	127,883	
Lot Value		
Indicated Value	127,883	48.74 Per SqFt
Agland Value		
Site Improvements		
Total Value	127,883	48.74 Total Value Per SqFt

Miscellaneous Improvements								
Code	Description	Sketch ID	Size	Year	Units	Unit Cost	Depr	Value
WODC	WOOD DECK - COVERED	147763	22x14		308	44.11		13,586



Rogers

Assessment Property Record Card for Tax Year 2026

Data provided by LISA DELOZIER County Assessor

Date 04/17/2026

Time 00:34:45

Page 5

Sketch Image

660019514

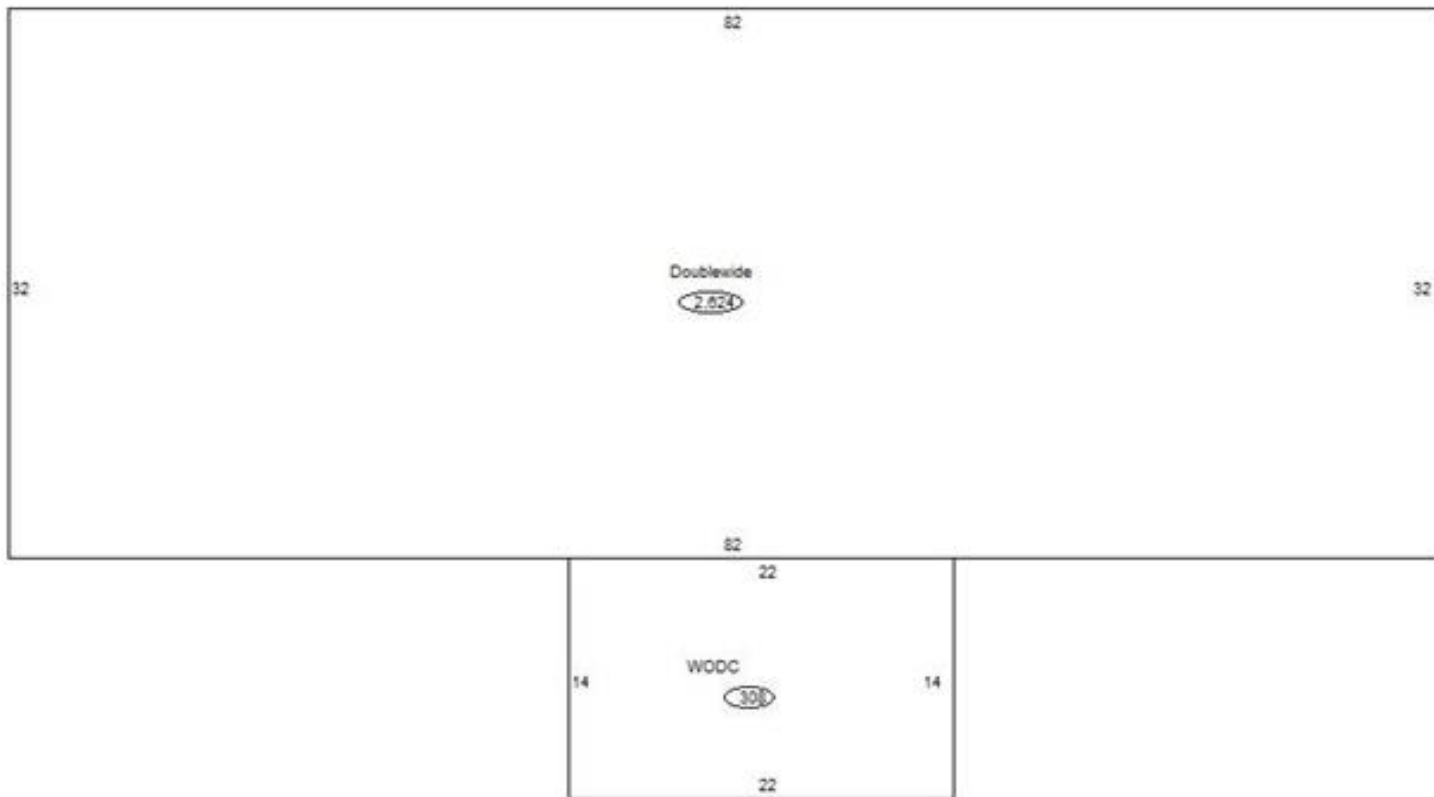

Sketch Vector Information

Sequence	Code	Type	Built Over	Scale	Section Label	Base Area	Multiplier	Total Area
1	R	14		10	Doublewide	2,624	1.000	2,624
2	M	WODC		10	WODC	308	1.000	308
Total Building Area						2,624		2,624