



Rogers

Assessment Property Record Card for Tax Year 2026

Data provided by LISA DELOZIER County Assessor

Date 04/18/2026
Time 07:34:40
Page 1

Assessment Data					Primary Image																																																																																																																				
Account 660019572 Parcel ID 24N18E-22-3-00000-000-0000 Cadastral ID 22-24-18-00700 Property Type REAL - Real Property Property Class RC VI Area 2 Tax Area 14 - CHELSEA RURAL Name ID 312225 HAGGARD, BRIAN & KENNY WEAST 3161 S 4260 RD CHELSEA OK 74016-0000 Parcel Location Situs 25062 S HWY 66 Subdivision Lot/Block / Parcel Size 1 - Acres Sec/Twn/Rng 22 / 24 / 18 / 3 Neighborhood 5001 - TASC 2016 School District S003 - CHELSEA SCHOOLS																																																																																																																									
Legal Description Lat/Long: 36.54384255 -95.38052800																																																																																																																									
Building Permits					<table border="1"> <thead> <tr> <th>Number</th> <th>Description</th> <th>Opened</th> <th>Closed</th> <th>Amount</th> </tr> </thead> <tbody> <tr> <td> </td> <td> </td> <td> </td> <td> </td> <td> </td> </tr> </tbody> </table>					Number	Description	Opened	Closed	Amount																																																																																																											
Number	Description	Opened	Closed	Amount																																																																																																																					
Exemptions					Sale History																																																																																																																				
<table border="1"> <thead> <tr> <th>Code</th> <th>Type</th> <th>Active</th> <th>Maximum</th> <th>Exemption</th> </tr> </thead> <tbody> <tr> <td> </td> <td> </td> <td> </td> <td> </td> <td> </td> </tr> </tbody> </table>					Code	Type	Active	Maximum	Exemption						<table border="1"> <thead> <tr> <th>Bk/Pg</th> <th>Grantor</th> <th>Date</th> <th>Price</th> <th>Code</th> </tr> </thead> <tbody> <tr> <td>2399/921</td> <td>TAYLOR, ROSE</td> <td>05/07/2014</td> <td>28,500</td> <td>YES</td> </tr> <tr> <td>1909/396</td> <td>TAYLOR, WILLIAM E & ROSE</td> <td>10/25/2007</td> <td>0</td> <td>4</td> </tr> <tr> <td>963/790</td> <td>PIERCE, LEO</td> <td>07/27/1994</td> <td>13,300</td> <td>Yes</td> </tr> <tr> <td>840/579</td> <td> </td> <td> </td> <td>15,000</td> <td>No</td> </tr> </tbody> </table>					Bk/Pg	Grantor	Date	Price	Code	2399/921	TAYLOR, ROSE	05/07/2014	28,500	YES	1909/396	TAYLOR, WILLIAM E & ROSE	10/25/2007	0	4	963/790	PIERCE, LEO	07/27/1994	13,300	Yes	840/579			15,000	No																																																																													
Code	Type	Active	Maximum	Exemption																																																																																																																					
Bk/Pg	Grantor	Date	Price	Code																																																																																																																					
2399/921	TAYLOR, ROSE	05/07/2014	28,500	YES																																																																																																																					
1909/396	TAYLOR, WILLIAM E & ROSE	10/25/2007	0	4																																																																																																																					
963/790	PIERCE, LEO	07/27/1994	13,300	Yes																																																																																																																					
840/579			15,000	No																																																																																																																					
Parcel Valuation																																																																																																																									
<table border="1"> <thead> <tr> <th>Source</th> <th>REAL</th> <th>Fair Cash</th> <th>Capped</th> <th>Asmnt Level</th> <th>Assessed</th> <th>Levy Rate</th> <th>82.750</th> <th>Current Tax</th> </tr> </thead> <tbody> <tr> <td>Remove Cap</td> <td>2015</td> <td>29,063</td> <td>29,063</td> <td>11%</td> <td>3,197</td> <td>Assessed</td> <td>7,541</td> <td>624.02</td> </tr> <tr> <td>Year Frozen</td> <td>0</td> <td>41,422</td> <td>39,487</td> <td> </td> <td>4,344</td> <td>Penalty</td> <td>0</td> <td> </td> </tr> <tr> <td>Uncapped Value</td> <td>0</td> <td>0</td> <td>0</td> <td> </td> <td>0</td> <td>Exemption</td> <td>0</td> <td>0.00</td> </tr> <tr> <td>TIF Project ID</td> <td>0</td> <td>70,485</td> <td>68,550</td> <td> </td> <td>7,541</td> <td>Total Taxable</td> <td>7,541</td> <td>624.00</td> </tr> </tbody> </table>		Source	REAL	Fair Cash	Capped	Asmnt Level	Assessed	Levy Rate	82.750	Current Tax	Remove Cap	2015	29,063	29,063	11%	3,197	Assessed	7,541	624.02	Year Frozen	0	41,422	39,487		4,344	Penalty	0		Uncapped Value	0	0	0		0	Exemption	0	0.00	TIF Project ID	0	70,485	68,550		7,541	Total Taxable	7,541	624.00																																																																											
Source	REAL	Fair Cash	Capped	Asmnt Level	Assessed	Levy Rate	82.750	Current Tax																																																																																																																	
Remove Cap	2015	29,063	29,063	11%	3,197	Assessed	7,541	624.02																																																																																																																	
Year Frozen	0	41,422	39,487		4,344	Penalty	0																																																																																																																		
Uncapped Value	0	0	0		0	Exemption	0	0.00																																																																																																																	
TIF Project ID	0	70,485	68,550		7,541	Total Taxable	7,541	624.00																																																																																																																	
Assessment History																																																																																																																									
<table border="1"> <thead> <tr> <th>Tax Year</th> <th>Statement Number</th> <th>Billed Owner</th> <th>Tax Area</th> <th>Total Value</th> <th>Exemptions</th> <th>Taxable Value</th> <th>Billed Tax</th> </tr> </thead> <tbody> <tr> <td>2025</td> <td>2025-660019572</td> <td>HAGGARD, BRIAN &</td> <td>14</td> <td>69,258</td> <td>0</td> <td>7,182</td> <td>594.00</td> </tr> <tr> <td>2024</td> <td>2024-660019572</td> <td>HAGGARD, BRIAN &</td> <td>14</td> <td>62,848</td> <td>0</td> <td>6,840</td> <td>577.00</td> </tr> <tr> <td>2023</td> <td>2023-660019572</td> <td>HAGGARD, BRIAN &</td> <td>14</td> <td>59,218</td> <td>0</td> <td>6,514</td> <td>555.00</td> </tr> <tr> <td>2022</td> <td>2022-660019572</td> <td>HAGGARD, BRIAN &</td> <td>14</td> <td>59,218</td> <td>0</td> <td>6,514</td> <td>551.00</td> </tr> <tr> <td>2021</td> <td>2021-660019572</td> <td>HAGGARD, BRIAN &</td> <td>14</td> <td>57,537</td> <td>0</td> <td>6,329</td> <td>536.00</td> </tr> <tr> <td>2020</td> <td>2020-660019572</td> <td>HAGGARD, BRIAN &</td> <td>14</td> <td>62,253</td> <td>0</td> <td>6,218</td> <td>527.00</td> </tr> <tr> <td>2019</td> <td>2019-660019572</td> <td>HAGGARD, BRIAN &</td> <td>14</td> <td>62,253</td> <td>0</td> <td>5,921</td> <td>508.00</td> </tr> <tr> <td>2018</td> <td>2018-660019572</td> <td>HAGGARD, BRIAN &</td> <td>14</td> <td>62,045</td> <td>0</td> <td>5,640</td> <td>482.00</td> </tr> <tr> <td>2017</td> <td>2017-660019572</td> <td>HAGGARD, BRIAN &</td> <td>14</td> <td>62,045</td> <td>0</td> <td>5,371</td> <td>461.00</td> </tr> <tr> <td>2016</td> <td>2016-660019572</td> <td>HAGGARD, BRIAN &</td> <td>14</td> <td>62,045</td> <td>0</td> <td>5,115</td> <td>446.00</td> </tr> <tr> <td>2015</td> <td>2015-660019572</td> <td>HAGGARD, BRIAN &</td> <td>14</td> <td>44,290</td> <td>0</td> <td>4,872</td> <td>420.00</td> </tr> <tr> <td>2014</td> <td>2014-660019572</td> <td>HAGGARD, BRIAN &</td> <td>14</td> <td>44,290</td> <td>0</td> <td>3,790</td> <td>338.00</td> </tr> <tr> <td>2013</td> <td>2013-660019572</td> <td>TAYLOR, ROSE & MIKE J EVERETT &</td> <td>14</td> <td>40,012</td> <td>0</td> <td>3,609</td> <td>320.00</td> </tr> </tbody> </table>										Tax Year	Statement Number	Billed Owner	Tax Area	Total Value	Exemptions	Taxable Value	Billed Tax	2025	2025-660019572	HAGGARD, BRIAN &	14	69,258	0	7,182	594.00	2024	2024-660019572	HAGGARD, BRIAN &	14	62,848	0	6,840	577.00	2023	2023-660019572	HAGGARD, BRIAN &	14	59,218	0	6,514	555.00	2022	2022-660019572	HAGGARD, BRIAN &	14	59,218	0	6,514	551.00	2021	2021-660019572	HAGGARD, BRIAN &	14	57,537	0	6,329	536.00	2020	2020-660019572	HAGGARD, BRIAN &	14	62,253	0	6,218	527.00	2019	2019-660019572	HAGGARD, BRIAN &	14	62,253	0	5,921	508.00	2018	2018-660019572	HAGGARD, BRIAN &	14	62,045	0	5,640	482.00	2017	2017-660019572	HAGGARD, BRIAN &	14	62,045	0	5,371	461.00	2016	2016-660019572	HAGGARD, BRIAN &	14	62,045	0	5,115	446.00	2015	2015-660019572	HAGGARD, BRIAN &	14	44,290	0	4,872	420.00	2014	2014-660019572	HAGGARD, BRIAN &	14	44,290	0	3,790	338.00	2013	2013-660019572	TAYLOR, ROSE & MIKE J EVERETT &	14	40,012	0	3,609	320.00
Tax Year	Statement Number	Billed Owner	Tax Area	Total Value	Exemptions	Taxable Value	Billed Tax																																																																																																																		
2025	2025-660019572	HAGGARD, BRIAN &	14	69,258	0	7,182	594.00																																																																																																																		
2024	2024-660019572	HAGGARD, BRIAN &	14	62,848	0	6,840	577.00																																																																																																																		
2023	2023-660019572	HAGGARD, BRIAN &	14	59,218	0	6,514	555.00																																																																																																																		
2022	2022-660019572	HAGGARD, BRIAN &	14	59,218	0	6,514	551.00																																																																																																																		
2021	2021-660019572	HAGGARD, BRIAN &	14	57,537	0	6,329	536.00																																																																																																																		
2020	2020-660019572	HAGGARD, BRIAN &	14	62,253	0	6,218	527.00																																																																																																																		
2019	2019-660019572	HAGGARD, BRIAN &	14	62,253	0	5,921	508.00																																																																																																																		
2018	2018-660019572	HAGGARD, BRIAN &	14	62,045	0	5,640	482.00																																																																																																																		
2017	2017-660019572	HAGGARD, BRIAN &	14	62,045	0	5,371	461.00																																																																																																																		
2016	2016-660019572	HAGGARD, BRIAN &	14	62,045	0	5,115	446.00																																																																																																																		
2015	2015-660019572	HAGGARD, BRIAN &	14	44,290	0	4,872	420.00																																																																																																																		
2014	2014-660019572	HAGGARD, BRIAN &	14	44,290	0	3,790	338.00																																																																																																																		
2013	2013-660019572	TAYLOR, ROSE & MIKE J EVERETT &	14	40,012	0	3,609	320.00																																																																																																																		



Rogers

Assessment Property Record Card for Tax Year 2026

Data provided by LISA DELOZIER County Assessor

Date 04/18/2026

Time 07:34:40

Page 3

Sketch Image

660019572

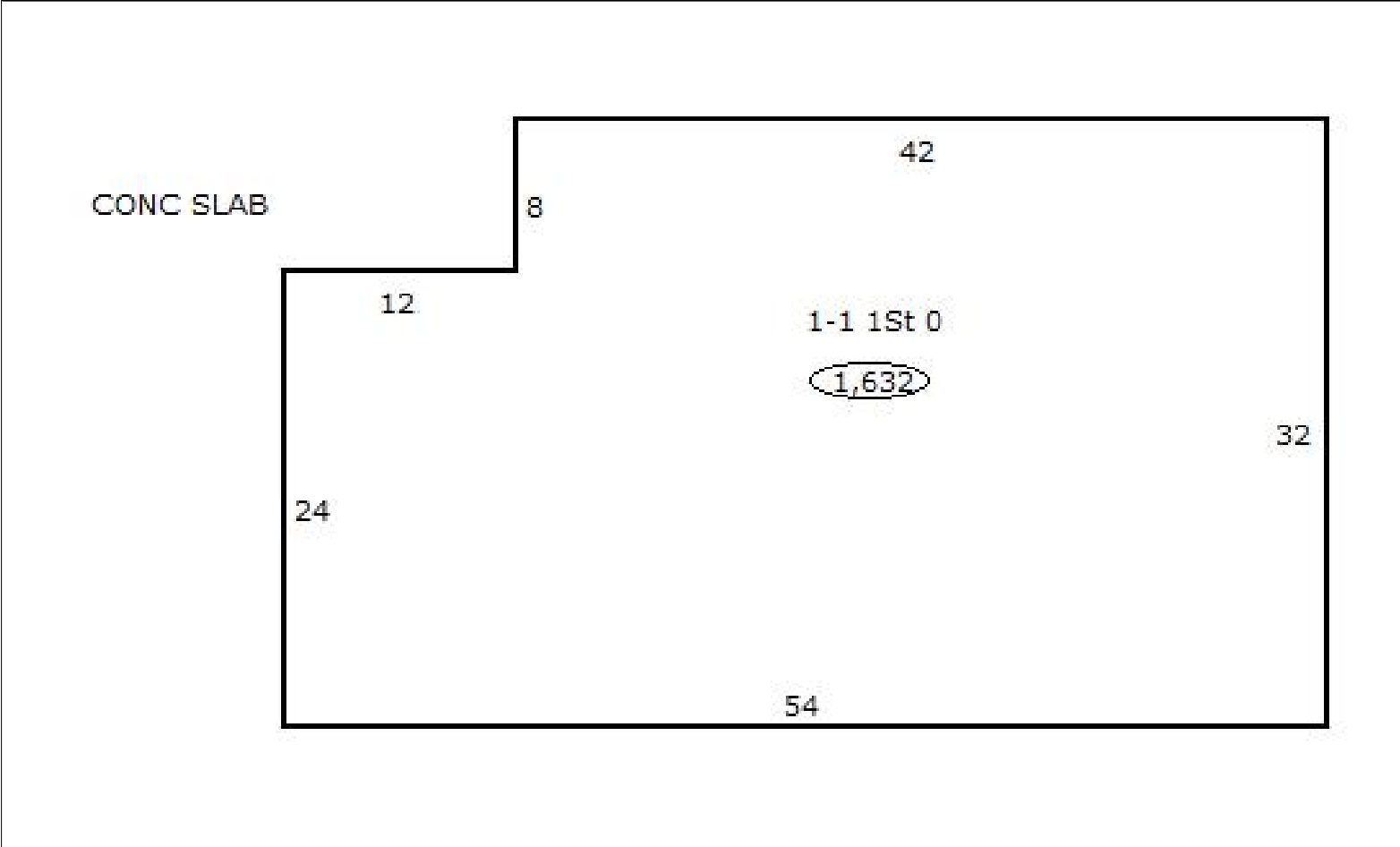

Sketch Vector Information

Sequence	Code	Type	Built Over	Scale	Section Label	Base Area	Multiplier	Total Area
1	C	442		13	1-1 1St 0	1,632	1.000	1,632
2	N	0		13	CONC SLAB		0.000	
Total Building Area						1,632		1,632



Rogers

Assessment Property Record Card for Tax Year 2026

Data provided by LISA DELOZIER County Assessor

Date 04/18/2026
Time 07:34:40
Page 4

Account 660019572
Parcel ID 24N18E-22-3-00000-000-0000
Cadastral ID 22-24-18-00700

Tax Area Code 14
Property Class RC
Owners Name HAGGARD, BRIAN &

Building Data

Building ID 1028
Building Sequence 1
Occupancy 1 442 Bar/Tavern 100%
Occupancy 2
Occupancy 3
Total Floor Area 1,632
Average Perimeter 172
Number Of Storys 1.00
Average Wall Ht 8.00
Year Built 1970
Effective Age 48
Construction Class 3 - Unreinforced Masonry Walls, Wood Joists
Quality 1 - Low
Condition 1 - Low
Exterior Wall 12 - Concrete Block
Heating/Cooling 7 - Package Unit
Roof Type Gable
Roof Cover

Basement Area
Basement Levels
Basement Finish
Finish Code - 1
Finish Area - 1
Finish Code - 2
Finish Area - 2

Building Image

Image Information

Image Name
Image Date
Image Name
Description

Cost Calculations

Appraisal Zone 2
Zone Description
Base Cost 68.54
Wall Cost 35.36
HVAC Cost 15.05
Basement Cost 0.00
Total Base Cost 118.95
Total Area 1,632
Base RCN 194,126
Misc Impr Value

Manual Date 01/2025
Base Year 2026
Modifier Value
Total Replacement Cost 194,126
Physical Depreciation 80%
Functional Depreciation
Total Depreciation 80% (155,301)
Total RCNLD 38,825
Lump Sums
Total Building Value 38,825 \$ 23.79 Per SqFt



Rogers

Assessment Property Record Card for Tax Year 2026

Data provided by LISA DELOZIER County Assessor

Date 04/18/2026

Time 07:34:40

Page 5

660019572

Outbuildings/Site Improvements

Building Image	Code	Description	Dimensions	Floor	Roofing	Total Units
	FLV	CONC SLAB 352SF	0x0x0			1,760
	Qual	Cond	Year	Eff Age		
		Valuation Summary	Modifier Total	RCN	Depr (% Phys/ % Func)	RCNLD
		Base Cost (1.00 x 1,760)		1,760	950	810
	FLV	DB F PLASTIC ILL SIGN 3*4	0x0x0			2,700
	Qual	Cond	Year	Eff Age		
		Valuation Summary	Modifier Total	RCN	Depr (% Phys/ % Func)	RCNLD
		Base Cost (1.00 x 2,700)		2,700	1,458	1,242
	FLV	MTL SIGN POLE 6" @ 16'	0x0x0			1,184
	Qual	Cond	Year	Eff Age		
		Valuation Summary	Modifier Total	RCN	Depr (% Phys/ % Func)	RCNLD
		Base Cost (1.00 x 1,184)		1,184	639	545
Total Site Improvement Value						2,597