



Rogers

Assessment Property Record Card for Tax Year 2026

Data provided by LISA DELOZIER County Assessor

Date 04/16/2026
Time 21:36:34
Page 1

Assessment Data					Primary Image																																																																																																																				
Account 660019642 Parcel ID 000000-00-0-00345-001-0001 Cadastral ID 23-21-14-01910 Property Type REAL - Real Property Property Class RRP VI Area 4 Tax Area 3 - OWASSO RURAL/NO FIRE Name ID 337872 REESE, CALEB & RACHEL 17596 E 90TH ST N OWASSO OK 74055-0000 Parcel Location Situs 17596 E 90TH ST N Subdivision GREEN MEADOWS 1 Lot/Block 0001 / 0001 Parcel Size 1 - Lots Sec/Twn/Rng 23 / 21 / 14 / 5 Neighborhood 1212 - R-V04-SW OWASSO School District S021 - OWASSO SCHOOLS																																																																																																																									
Legal Description Lot/Long: 36.28422472 -95.77679255																																																																																																																									
Legal Description LOT 1 BLOCK 1 GREEN MEADOWS EST. 1					Building Permits <table border="1"> <thead> <tr> <th>Number</th> <th>Description</th> <th>Opened</th> <th>Closed</th> <th>Amount</th> </tr> </thead> <tbody> <tr> <td colspan="5" style="height: 100px;"> </td> </tr> </tbody> </table>					Number	Description	Opened	Closed	Amount																																																																																																											
Number	Description	Opened	Closed	Amount																																																																																																																					
Exemptions <table border="1"> <thead> <tr> <th>Code</th> <th>Type</th> <th>Active</th> <th>Maximum</th> <th>Exemption</th> </tr> </thead> <tbody> <tr> <td>H</td> <td>Homestead</td> <td>Yes</td> <td>1,000</td> <td>1,000</td> </tr> </tbody> </table>					Code	Type	Active	Maximum	Exemption	H	Homestead	Yes	1,000	1,000	Sale History <table border="1"> <thead> <tr> <th>Bk/Pg</th> <th>Grantor</th> <th>Date</th> <th>Price</th> <th>Code</th> </tr> </thead> <tbody> <tr> <td>/</td> <td>KAASE, VINCENT W & WILLABY, PHILLIP M</td> <td>04/04/2022</td> <td>260,000</td> <td>YES</td> </tr> <tr> <td>1836/682</td> <td></td> <td>12/27/2006</td> <td>140,000</td> <td>YES</td> </tr> </tbody> </table>					Bk/Pg	Grantor	Date	Price	Code	/	KAASE, VINCENT W & WILLABY, PHILLIP M	04/04/2022	260,000	YES	1836/682		12/27/2006	140,000	YES																																																																																							
Code	Type	Active	Maximum	Exemption																																																																																																																					
H	Homestead	Yes	1,000	1,000																																																																																																																					
Bk/Pg	Grantor	Date	Price	Code																																																																																																																					
/	KAASE, VINCENT W & WILLABY, PHILLIP M	04/04/2022	260,000	YES																																																																																																																					
1836/682		12/27/2006	140,000	YES																																																																																																																					
Parcel Valuation <table border="1"> <thead> <tr> <th>Source</th> <th>REAL</th> <th>Fair Cash</th> <th>Capped</th> <th>Asmnt Level</th> <th>Assessed</th> <th>Levy Rate</th> <th>97.960</th> <th>Current Tax</th> </tr> </thead> <tbody> <tr> <td>Remove Cap</td> <td>2023</td> <td>Land Value 137,302</td> <td>137,302</td> <td>11%</td> <td>15,103</td> <td>Assessed</td> <td>29,862</td> <td>2,925.28</td> </tr> <tr> <td>Year Frozen</td> <td>0</td> <td>Improvements 134,176</td> <td>134,176</td> <td></td> <td>14,759</td> <td>Penalty</td> <td>0</td> <td></td> </tr> <tr> <td>Uncapped Value</td> <td>0</td> <td>Mobile Home 0</td> <td>0</td> <td></td> <td>0</td> <td>Exemption</td> <td>1,000</td> <td>-98.00</td> </tr> <tr> <td>TIF Project ID</td> <td>0</td> <td>Total Value 271,478</td> <td>271,478</td> <td></td> <td>29,862</td> <td>Total Taxable</td> <td>28,862</td> <td>2,827.00</td> </tr> </tbody> </table>										Source	REAL	Fair Cash	Capped	Asmnt Level	Assessed	Levy Rate	97.960	Current Tax	Remove Cap	2023	Land Value 137,302	137,302	11%	15,103	Assessed	29,862	2,925.28	Year Frozen	0	Improvements 134,176	134,176		14,759	Penalty	0		Uncapped Value	0	Mobile Home 0	0		0	Exemption	1,000	-98.00	TIF Project ID	0	Total Value 271,478	271,478		29,862	Total Taxable	28,862	2,827.00																																																																			
Source	REAL	Fair Cash	Capped	Asmnt Level	Assessed	Levy Rate	97.960	Current Tax																																																																																																																	
Remove Cap	2023	Land Value 137,302	137,302	11%	15,103	Assessed	29,862	2,925.28																																																																																																																	
Year Frozen	0	Improvements 134,176	134,176		14,759	Penalty	0																																																																																																																		
Uncapped Value	0	Mobile Home 0	0		0	Exemption	1,000	-98.00																																																																																																																	
TIF Project ID	0	Total Value 271,478	271,478		29,862	Total Taxable	28,862	2,827.00																																																																																																																	
Assessment History <table border="1"> <thead> <tr> <th>Tax Year</th> <th>Statement Number</th> <th>Billed Owner</th> <th>Tax Area</th> <th>Total Value</th> <th>Exemptions</th> <th>Taxable Value</th> <th>Billed Tax</th> </tr> </thead> <tbody> <tr><td>2025</td><td>2025-660019642</td><td>REESE, CALEB & RACHEL</td><td>3</td><td>269,285</td><td>1000</td><td>28,458</td><td>2,788.00</td></tr> <tr><td>2024</td><td>2024-660019642</td><td>REESE, CALEB & RACHEL</td><td>3</td><td>260,000</td><td>0</td><td>28,600</td><td>2,748.00</td></tr> <tr><td>2023</td><td>2023-660019642</td><td>REESE, CALEB & RACHEL</td><td>3</td><td>260,000</td><td>0</td><td>28,600</td><td>2,680.00</td></tr> <tr><td>2022</td><td>2022-660019642</td><td>REESE, CALEB & RACHEL</td><td>3</td><td>167,433</td><td>1000</td><td>17,418</td><td>1,706.00</td></tr> <tr><td>2021</td><td>2021-660019642</td><td>KAASE, VINCENT W &</td><td>3</td><td>170,969</td><td>1000</td><td>17,807</td><td>1,723.00</td></tr> <tr><td>2020</td><td>2020-660019642</td><td>KAASE, VINCENT W &</td><td>3</td><td>168,442</td><td>1000</td><td>17,393</td><td>1,680.00</td></tr> <tr><td>2019</td><td>2019-660019642</td><td>KAASE, VINCENT W &</td><td>3</td><td>162,338</td><td>1000</td><td>16,857</td><td>1,630.00</td></tr> <tr><td>2018</td><td>2018-660019642</td><td>KAASE, VINCENT W &</td><td>3</td><td>168,131</td><td>1000</td><td>17,494</td><td>1,628.00</td></tr> <tr><td>2017</td><td>2017-660019642</td><td>KAASE, VINCENT W &</td><td>3</td><td>166,833</td><td>1000</td><td>17,160</td><td>1,614.00</td></tr> <tr><td>2016</td><td>2016-660019642</td><td>KAASE, VINCENT W &</td><td>3</td><td>162,847</td><td>1000</td><td>16,632</td><td>1,566.00</td></tr> <tr><td>2015</td><td>2015-660019642</td><td>KAASE, VINCENT W &</td><td>3</td><td>159,112</td><td>1000</td><td>16,118</td><td>1,528.00</td></tr> <tr><td>2014</td><td>2014-660019642</td><td>KAASE, VINCENT W &</td><td>3</td><td>160,315</td><td>1000</td><td>15,620</td><td>1,495.00</td></tr> <tr><td>2013</td><td>2013-660019642</td><td>KAASE, VINCENT W &</td><td>3</td><td>151,974</td><td>1000</td><td>15,136</td><td>1,418.00</td></tr> </tbody> </table>										Tax Year	Statement Number	Billed Owner	Tax Area	Total Value	Exemptions	Taxable Value	Billed Tax	2025	2025-660019642	REESE, CALEB & RACHEL	3	269,285	1000	28,458	2,788.00	2024	2024-660019642	REESE, CALEB & RACHEL	3	260,000	0	28,600	2,748.00	2023	2023-660019642	REESE, CALEB & RACHEL	3	260,000	0	28,600	2,680.00	2022	2022-660019642	REESE, CALEB & RACHEL	3	167,433	1000	17,418	1,706.00	2021	2021-660019642	KAASE, VINCENT W &	3	170,969	1000	17,807	1,723.00	2020	2020-660019642	KAASE, VINCENT W &	3	168,442	1000	17,393	1,680.00	2019	2019-660019642	KAASE, VINCENT W &	3	162,338	1000	16,857	1,630.00	2018	2018-660019642	KAASE, VINCENT W &	3	168,131	1000	17,494	1,628.00	2017	2017-660019642	KAASE, VINCENT W &	3	166,833	1000	17,160	1,614.00	2016	2016-660019642	KAASE, VINCENT W &	3	162,847	1000	16,632	1,566.00	2015	2015-660019642	KAASE, VINCENT W &	3	159,112	1000	16,118	1,528.00	2014	2014-660019642	KAASE, VINCENT W &	3	160,315	1000	15,620	1,495.00	2013	2013-660019642	KAASE, VINCENT W &	3	151,974	1000	15,136	1,418.00
Tax Year	Statement Number	Billed Owner	Tax Area	Total Value	Exemptions	Taxable Value	Billed Tax																																																																																																																		
2025	2025-660019642	REESE, CALEB & RACHEL	3	269,285	1000	28,458	2,788.00																																																																																																																		
2024	2024-660019642	REESE, CALEB & RACHEL	3	260,000	0	28,600	2,748.00																																																																																																																		
2023	2023-660019642	REESE, CALEB & RACHEL	3	260,000	0	28,600	2,680.00																																																																																																																		
2022	2022-660019642	REESE, CALEB & RACHEL	3	167,433	1000	17,418	1,706.00																																																																																																																		
2021	2021-660019642	KAASE, VINCENT W &	3	170,969	1000	17,807	1,723.00																																																																																																																		
2020	2020-660019642	KAASE, VINCENT W &	3	168,442	1000	17,393	1,680.00																																																																																																																		
2019	2019-660019642	KAASE, VINCENT W &	3	162,338	1000	16,857	1,630.00																																																																																																																		
2018	2018-660019642	KAASE, VINCENT W &	3	168,131	1000	17,494	1,628.00																																																																																																																		
2017	2017-660019642	KAASE, VINCENT W &	3	166,833	1000	17,160	1,614.00																																																																																																																		
2016	2016-660019642	KAASE, VINCENT W &	3	162,847	1000	16,632	1,566.00																																																																																																																		
2015	2015-660019642	KAASE, VINCENT W &	3	159,112	1000	16,118	1,528.00																																																																																																																		
2014	2014-660019642	KAASE, VINCENT W &	3	160,315	1000	15,620	1,495.00																																																																																																																		
2013	2013-660019642	KAASE, VINCENT W &	3	151,974	1000	15,136	1,418.00																																																																																																																		



Rogers

Assessment Property Record Card for Tax Year 2026

Data provided by LISA DELOZIER County Assessor

Date 04/16/2026
Time 21:36:34
Page 2

Lot Data	Square-Foot - NBHD 1212 #1	Primary Image
Lot Size		
Lot Count		
Units Buildable	1	
Non-Ag Acres	1.0149	
Topography		
Street Access		
Utilities		
Amenities	LAND QUALITY	
	0	
	0	
Method	Square-Foot	
Base Lot Value	44,208.00 x 2.68 = 118,292	
Factor Value		
Adjustments	1.1607	
Lot Value	137,302	

Residential Data	
Type	1 Single Family Residence
Condition	3 - Average
Quality	2.5 - Fair
Architecture	
Style	100% One Story
Exterior Wall	40% Veneer, Stone 60% Frame, Siding, Wood
Base/Total Area	1,762 / 1,762
Style	100% One Story
HVAC	100% Warmed & Cooled Air
Roof Cover	1 Composition Shingle
Area on Slab	1,762
Fixture/RghIn	11 /
Bed/F/H Bath	3 / 2.0 /
Basement Area	
Garage Type	528 Attached Garage - Unfinished
Remodel	
Year/Eff Age	1981 / 34

Cost Approach		Manual : 01/2025	
Base Cost	100.63	Total Misc Impr	+ 7,985
Roofing Adj	+ 4.38	Garage Cost	+ 14,325
Subfloor Adj	+ -1.15	Total RCN	= 239,600
Heat/Cool Adj	+ 11.47	Depreciation (44%)	- 105,424
Plumbing Adj	+ 7.99	Lump Sums	+ 0
Basement Adj	+ 0.00	RCNLD	= 134,176
Adj Base Cost	= 123.32	Lot Value	+ 137,302
Total Area	x 1,762	Indicated Value	= 271,478
Adjusted Cost	= 217,290	Value Per SqFt	154.07

GRM Approach	
GRM Code	
Gross Rent	0.00
Indicated Value	

Multiple Regression	
MRA Code	1 Test
Adjusted R	0.8445
Indicated Value	182,963 103.84 Per SqFt

Direct Comparables	
Selection Model	A Adam Test
Adjustment Model	1 2022 Residential
Comparables	2
Indicated Value	260,000 Per SqFt

Value Reconciliation	
Selected Approach	Cost Approach
Improvements	134,176
Lot Value	137,302
Indicated Value	271,478 154.07 Per SqFt
Agland Value	
Site Improvements	
Total Value	271,478 154.07 Total Value Per SqFt

Miscellaneous Improvements								
Code	Description	Sketch ID	Size	Year	Units	Unit Cost	Depr	Value
FPR1	FIREPLACE - RESIDENTIAL 1 STORY	0		1	1	5,095.98		5,096
PRCH	SLAB PORCH - COVERED	47566		8x6	48	24.12		1,158
PRCH	SLAB PORCH - COVERED	47567		12x6	72	24.04		1,731



Rogers

Assessment Property Record Card for Tax Year 2026

Data provided by LISA DELOZIER County Assessor

Date 04/16/2026

Time 21:36:34

Page 3

Sketch Image

660019642

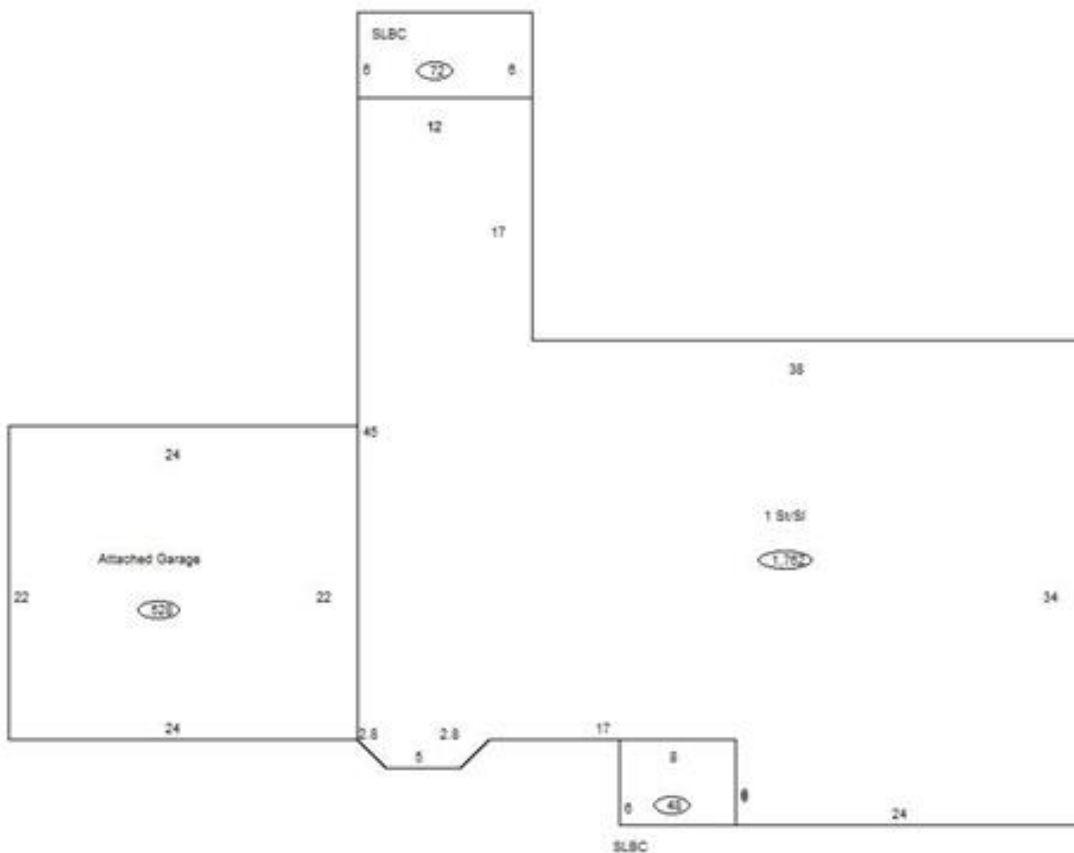

Sketch Vector Information

Sequence	Code	Type	Built Over	Scale	Section Label	Base Area	Multiplier	Total Area
1	R	1	Slab	10	1 St/SI	1,762	1.000	1,762
2	G	1		10	Attached Garage	528	1.000	528
3	M	PRCH		10	SLBC	48	1.000	48
4	M	PRCH		10	SLBC	72	1.000	72
Total Building Area						1,762		1,762