



Rogers

Assessment Property Record Card for Tax Year 2026

Data provided by LISA DELOZIER County Assessor

Date 04/16/2026
Time 21:36:37
Page 1

Assessment Data					Primary Image																																																																																																																				
Account 660019645 Parcel ID 000000-00-0-00345-001-0004 Cadastral ID 23-21-14-01940 Property Type REAL - Real Property Property Class RRP VI Area 4 Tax Area 3 - OWASSO RURAL/NO FIRE Name ID 129694 GRAVES, ROBERT R & REGINA F-TRUSTEES 9302 N 103RD E AVE OWASSO OK 74055-0000 Parcel Location Situs 17566 E 90TH ST N Subdivision GREEN MEADOWS 1 Lot/Block 0004 / 0001 Parcel Size 1 - Lots Sec/Twn/Rng 23 / 21 / 14 / 5 Neighborhood 1212 - R-V04-SW OWASSO School District S021 - OWASSO SCHOOLS																																																																																																																									
Legal Description Lot/Long: 36.28423443 -95.77904260																																																																																																																									
Building Permits					<table border="1"> <thead> <tr> <th>Number</th> <th>Description</th> <th>Opened</th> <th>Closed</th> <th>Amount</th> </tr> </thead> <tbody> <tr> <td colspan="5" style="height: 100px;"> </td> </tr> </tbody> </table>					Number	Description	Opened	Closed	Amount																																																																																																											
Number	Description	Opened	Closed	Amount																																																																																																																					
Exemptions					Sale History																																																																																																																				
<table border="1"> <thead> <tr> <th>Code</th> <th>Type</th> <th>Active</th> <th>Maximum</th> <th>Exemption</th> </tr> </thead> <tbody> <tr> <td colspan="5" style="height: 100px;"> </td> </tr> </tbody> </table>					Code	Type	Active	Maximum	Exemption						<table border="1"> <thead> <tr> <th>Bk/Pg</th> <th>Grantor</th> <th>Date</th> <th>Price</th> <th>Code</th> </tr> </thead> <tbody> <tr> <td>2521/210</td> <td>GRAVES, ROBERT R</td> <td>12/02/2015</td> <td>0</td> <td>4</td> </tr> </tbody> </table>					Bk/Pg	Grantor	Date	Price	Code	2521/210	GRAVES, ROBERT R	12/02/2015	0	4																																																																																												
Code	Type	Active	Maximum	Exemption																																																																																																																					
Bk/Pg	Grantor	Date	Price	Code																																																																																																																					
2521/210	GRAVES, ROBERT R	12/02/2015	0	4																																																																																																																					
Parcel Valuation																																																																																																																									
<table border="1"> <thead> <tr> <th>Source</th> <th>REAL</th> <th>Fair Cash</th> <th>Capped</th> <th>Asmnt Level</th> <th>Assessed</th> <th>Levy Rate</th> <th>97.960</th> <th>Current Tax</th> </tr> </thead> <tbody> <tr> <td>Remove Cap</td> <td>0</td> <td>Land Value 116,753</td> <td>57,074</td> <td>11%</td> <td>6,278</td> <td>Assessed</td> <td>23,429</td> <td>2,295.10</td> </tr> <tr> <td>Year Frozen</td> <td>0</td> <td>Improvements 158,389</td> <td>155,922</td> <td></td> <td>17,151</td> <td>Penalty</td> <td>0</td> <td></td> </tr> <tr> <td>Uncapped Value</td> <td>0</td> <td>Mobile Home 0</td> <td>0</td> <td></td> <td>0</td> <td>Exemption</td> <td>0</td> <td>0.00</td> </tr> <tr> <td>TIF Project ID</td> <td>0</td> <td>Total Value 275,142</td> <td>212,996</td> <td></td> <td>23,429</td> <td>Total Taxable</td> <td>23,429</td> <td>2,295.00</td> </tr> </tbody> </table>										Source	REAL	Fair Cash	Capped	Asmnt Level	Assessed	Levy Rate	97.960	Current Tax	Remove Cap	0	Land Value 116,753	57,074	11%	6,278	Assessed	23,429	2,295.10	Year Frozen	0	Improvements 158,389	155,922		17,151	Penalty	0		Uncapped Value	0	Mobile Home 0	0		0	Exemption	0	0.00	TIF Project ID	0	Total Value 275,142	212,996		23,429	Total Taxable	23,429	2,295.00																																																																			
Source	REAL	Fair Cash	Capped	Asmnt Level	Assessed	Levy Rate	97.960	Current Tax																																																																																																																	
Remove Cap	0	Land Value 116,753	57,074	11%	6,278	Assessed	23,429	2,295.10																																																																																																																	
Year Frozen	0	Improvements 158,389	155,922		17,151	Penalty	0																																																																																																																		
Uncapped Value	0	Mobile Home 0	0		0	Exemption	0	0.00																																																																																																																	
TIF Project ID	0	Total Value 275,142	212,996		23,429	Total Taxable	23,429	2,295.00																																																																																																																	
Assessment History																																																																																																																									
<table border="1"> <thead> <tr> <th>Tax Year</th> <th>Statement Number</th> <th>Billed Owner</th> <th>Tax Area</th> <th>Total Value</th> <th>Exemptions</th> <th>Taxable Value</th> <th>Billed Tax</th> </tr> </thead> <tbody> <tr><td>2025</td><td>2025-660019645</td><td>GRAVES, ROBERT R &</td><td>3</td><td>272,344</td><td>0</td><td>22,314</td><td>2,186.00</td></tr> <tr><td>2024</td><td>2024-660019645</td><td>GRAVES, ROBERT R &</td><td>3</td><td>249,449</td><td>0</td><td>21,251</td><td>2,042.00</td></tr> <tr><td>2023</td><td>2023-660019645</td><td>GRAVES, ROBERT R &</td><td>3</td><td>195,242</td><td>0</td><td>20,239</td><td>1,897.00</td></tr> <tr><td>2022</td><td>2022-660019645</td><td>GRAVES, ROBERT R &</td><td>3</td><td>175,235</td><td>0</td><td>19,276</td><td>1,888.00</td></tr> <tr><td>2021</td><td>2021-660019645</td><td>GRAVES, ROBERT R &</td><td>3</td><td>181,365</td><td>0</td><td>19,950</td><td>1,930.00</td></tr> <tr><td>2020</td><td>2020-660019645</td><td>GRAVES, ROBERT R &</td><td>3</td><td>180,457</td><td>0</td><td>19,850</td><td>1,918.00</td></tr> <tr><td>2019</td><td>2019-660019645</td><td>GRAVES, ROBERT R &</td><td>3</td><td>172,056</td><td>0</td><td>18,926</td><td>1,830.00</td></tr> <tr><td>2018</td><td>2018-660019645</td><td>GRAVES, ROBERT R &</td><td>3</td><td>176,675</td><td>0</td><td>19,253</td><td>1,792.00</td></tr> <tr><td>2017</td><td>2017-660019645</td><td>GRAVES, ROBERT R &</td><td>3</td><td>175,332</td><td>0</td><td>18,336</td><td>1,725.00</td></tr> <tr><td>2016</td><td>2016-660019645</td><td>GRAVES, ROBERT R &</td><td>3</td><td>171,107</td><td>0</td><td>17,463</td><td>1,644.00</td></tr> <tr><td>2015</td><td>2015-660019645</td><td>GRAVES, ROBERT R</td><td>3</td><td>166,487</td><td>0</td><td>16,631</td><td>1,577.00</td></tr> <tr><td>2014</td><td>2014-660019645</td><td>GRAVES, ROBERT R</td><td>3</td><td>170,989</td><td>0</td><td>15,840</td><td>1,516.00</td></tr> <tr><td>2013</td><td>2013-660019645</td><td>GRAVES, ROBERT R</td><td>3</td><td>162,454</td><td>0</td><td>15,085</td><td>1,413.00</td></tr> </tbody> </table>										Tax Year	Statement Number	Billed Owner	Tax Area	Total Value	Exemptions	Taxable Value	Billed Tax	2025	2025-660019645	GRAVES, ROBERT R &	3	272,344	0	22,314	2,186.00	2024	2024-660019645	GRAVES, ROBERT R &	3	249,449	0	21,251	2,042.00	2023	2023-660019645	GRAVES, ROBERT R &	3	195,242	0	20,239	1,897.00	2022	2022-660019645	GRAVES, ROBERT R &	3	175,235	0	19,276	1,888.00	2021	2021-660019645	GRAVES, ROBERT R &	3	181,365	0	19,950	1,930.00	2020	2020-660019645	GRAVES, ROBERT R &	3	180,457	0	19,850	1,918.00	2019	2019-660019645	GRAVES, ROBERT R &	3	172,056	0	18,926	1,830.00	2018	2018-660019645	GRAVES, ROBERT R &	3	176,675	0	19,253	1,792.00	2017	2017-660019645	GRAVES, ROBERT R &	3	175,332	0	18,336	1,725.00	2016	2016-660019645	GRAVES, ROBERT R &	3	171,107	0	17,463	1,644.00	2015	2015-660019645	GRAVES, ROBERT R	3	166,487	0	16,631	1,577.00	2014	2014-660019645	GRAVES, ROBERT R	3	170,989	0	15,840	1,516.00	2013	2013-660019645	GRAVES, ROBERT R	3	162,454	0	15,085	1,413.00
Tax Year	Statement Number	Billed Owner	Tax Area	Total Value	Exemptions	Taxable Value	Billed Tax																																																																																																																		
2025	2025-660019645	GRAVES, ROBERT R &	3	272,344	0	22,314	2,186.00																																																																																																																		
2024	2024-660019645	GRAVES, ROBERT R &	3	249,449	0	21,251	2,042.00																																																																																																																		
2023	2023-660019645	GRAVES, ROBERT R &	3	195,242	0	20,239	1,897.00																																																																																																																		
2022	2022-660019645	GRAVES, ROBERT R &	3	175,235	0	19,276	1,888.00																																																																																																																		
2021	2021-660019645	GRAVES, ROBERT R &	3	181,365	0	19,950	1,930.00																																																																																																																		
2020	2020-660019645	GRAVES, ROBERT R &	3	180,457	0	19,850	1,918.00																																																																																																																		
2019	2019-660019645	GRAVES, ROBERT R &	3	172,056	0	18,926	1,830.00																																																																																																																		
2018	2018-660019645	GRAVES, ROBERT R &	3	176,675	0	19,253	1,792.00																																																																																																																		
2017	2017-660019645	GRAVES, ROBERT R &	3	175,332	0	18,336	1,725.00																																																																																																																		
2016	2016-660019645	GRAVES, ROBERT R &	3	171,107	0	17,463	1,644.00																																																																																																																		
2015	2015-660019645	GRAVES, ROBERT R	3	166,487	0	16,631	1,577.00																																																																																																																		
2014	2014-660019645	GRAVES, ROBERT R	3	170,989	0	15,840	1,516.00																																																																																																																		
2013	2013-660019645	GRAVES, ROBERT R	3	162,454	0	15,085	1,413.00																																																																																																																		



Rogers

Assessment Property Record Card for Tax Year 2026

Data provided by LISA DELOZIER County Assessor

Date 04/16/2026
Time 21:36:37
Page 2

Lot Data	Square-Foot - NBHD 1212 #1	Primary Image
Lot Size Lot Count Units Buildable 1 Non-Ag Acres 0.9927 Topography Street Access Utilities Amenities LAND QUALITY 0 0 Method Square-Foot Base Lot Value 43,242.00 x 2.70 = 116,753 Factor Value Adjustments 1.0000 Lot Value 116,753		

Residential Data	
Type	1 Single Family Residence
Condition	3 - Average
Quality	3 - Average
Architecture	
Style	100% One Story
Exterior Wall	80% Veneer, Masonry 20% Frame, Siding, Wood
Base/Total Area	1,868 / 1,868
Style	100% One Story
HVAC	100% Warmed & Cooled Air
Roof Cover	1 Composition Shingle
Area on Slab	1,868
Fixture/RghIn	11 /
Bed/F/H Bath	3 / 2.0 /
Basement Area	
Garage Type	596 Attached Garage - Unfinished
Remodel	
Year/Eff Age	1980 / 35



\\tsclient\TCASEY\CASEY BOOTH RESIDENTIAL VI\2022-8-16\ 8/17/2022

GRM Approach	
GRM Code	
Gross Rent	0.00
Indicated Value	

Multiple Regression			
MRA Code	1	Test	
Adjusted R	0.8445		
Indicated Value	217,507	116.44	Per SqFt

Direct Comparables	
Selection Model	A Adam Test
Adjustment Model	1 2022 Residential
Comparables	8
Indicated Value	266,300 Per SqFt

Cost Approach				Manual : 01/2025			
Base Cost	107.40	Total Misc Impr	+ 15,209				
Roofing Adj	+ 4.77	Garage Cost	+ 18,238				
Subfloor Adj	+ -2.27	Total RCN	= 277,875				
Heat/Cool Adj	+ 12.64	Depreciation (43%)	- 119,486				
Plumbing Adj	+ 8.31	Lump Sums	+ 0				
Basement Adj	+ 0.00	RCNLD	= 158,389				
Adj Base Cost	= 130.85	Lot Value	+ 116,753				
Total Area	x 1,868	Indicated Value	= 275,142				
Adjusted Cost	= 244,428	Value Per SqFt	147.29				

Value Reconciliation			
Selected Approach	Cost Approach		
Improvements	158,389		
Lot Value	116,753		
Indicated Value	275,142	147.29	Per SqFt
Agland Value			
Site Improvements			
Total Value	275,142	147.29	Total Value Per SqFt

Miscellaneous Improvements								
Code	Description	Sketch ID	Size	Year	Units	Unit Cost	Depr	Value
FPR1	FIREPLACE - RESIDENTIAL 1 STORY	0		1	1	5,615.40		5,615
PRCH	SLAB PORCH - COVERED	47579	46x6		276	26.07		7,195
PRCH	SLAB PORCH - COVERED	47580	90		90	26.65		2,399



Rogers

Assessment Property Record Card for Tax Year 2026

Data provided by LISA DELOZIER County Assessor

Date 04/16/2026
 Time 21:36:37
 Page 3

Sketch Image

660019645

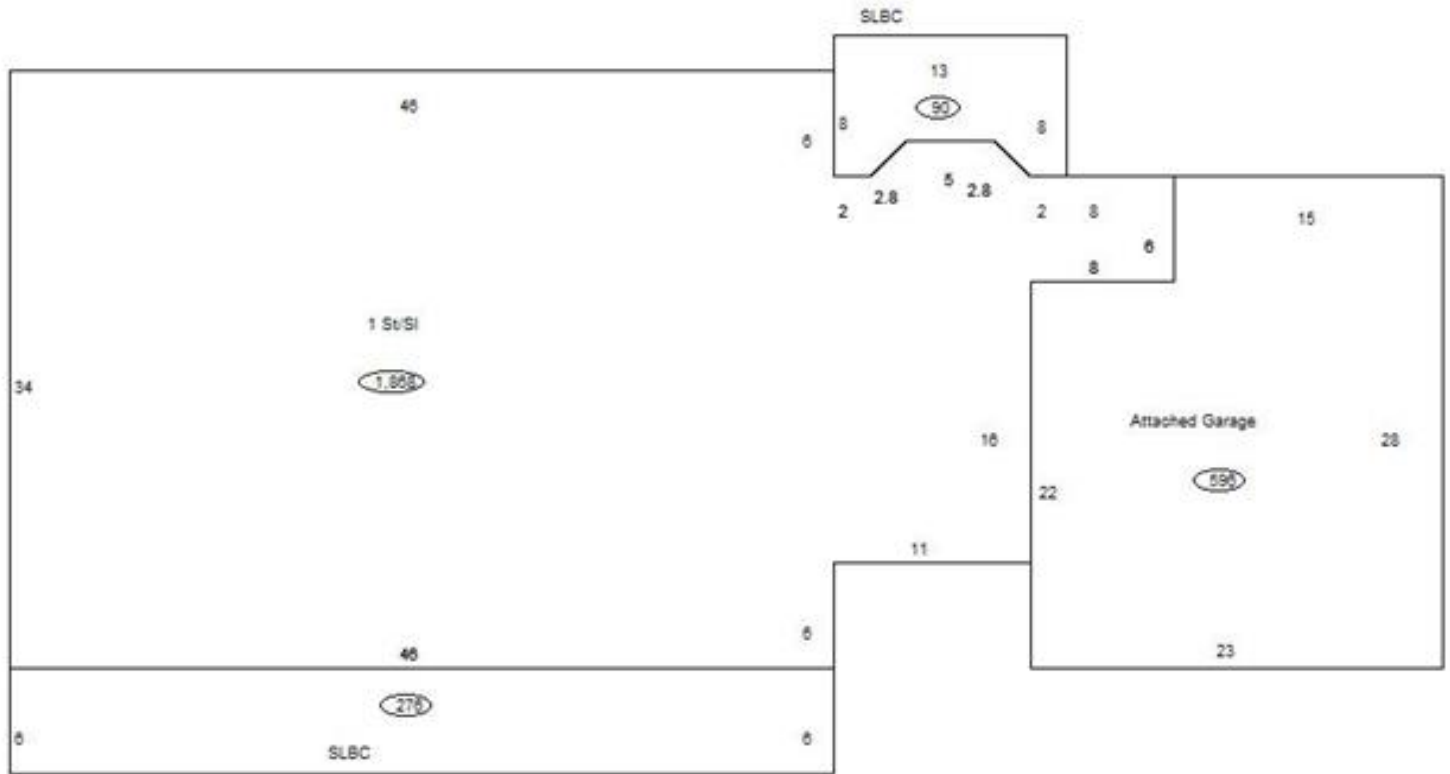

Sketch Vector Information

Sequence	Code	Type	Built Over	Scale	Section Label	Base Area	Multiplier	Total Area
1	R	1	Slab	10	1 St/SI	1,868	1.000	1,868
2	G	1		10	Attached Garage	596	1.000	596
3	M	PRCH		10	SLBC	276	1.000	276
4	M	PRCH		10	SLBC	90	1.000	90
Total Building Area						1,868		1,868