



# Rogers

## Assessment Property Record Card for Tax Year 2026

Data provided by LISA DELOZIER County Assessor

Date 04/17/2026  
Time 08:00:23  
Page 1

Assessment Data					Primary Image																																																																																																																				
<b>Account</b> 660019768 <b>Parcel ID</b> 000000-00-0-00522-001-0004 <b>Cadastral ID</b> 23-21-14-03160 <b>Property Type</b> REAL - Real Property <b>Property Class</b> RRP VI Area 4 <b>Tax Area</b> 3 - OWASSO RURAL/NO FIRE <b>Name ID</b> 335120 LEWIS, LOREN DWAYNE  9115 N 161ST E AVE OWASSO OK 74055-0000  <b>Parcel Location</b> <b>Situs</b> 09115 N 161ST E AVE <b>Subdivision</b> MORGANS ACRES 2 <b>Lot/Block</b> 0004 / 0001 <b>Parcel Size</b> .53 - Lots <b>Sec/Twn/Rng</b> 23 / 21 / 14 / 5 <b>Neighborhood</b> 1069 - R-V04-SW OWASSO <b>School District</b> S021 - OWASSO SCHOOLS																																																																																																																									
<b>Legal Description</b> Lat/Long: 36.28713249 -95.79311766 LOT 4, LESS S 300' OF W 363' THEREOF AND LESS S 330.19' OF E 296 11' BLOCK 1 MORGANS ACRES 2																																																																																																																									
<b>Exemptions</b> <table border="1"> <thead> <tr> <th>Code</th> <th>Type</th> <th>Active</th> <th>Maximum</th> <th>Exemption</th> </tr> </thead> <tbody> <tr> <td>H</td> <td>Homestead</td> <td>Yes</td> <td>1,000</td> <td>1,000</td> </tr> <tr> <td>PD</td> <td>Add-Homestead</td> <td>Yes</td> <td>1,000</td> <td>1,000</td> </tr> <tr> <td>H</td> <td>Homestead</td> <td>No</td> <td>1,000</td> <td></td> </tr> </tbody> </table>					Code	Type	Active	Maximum	Exemption	H	Homestead	Yes	1,000	1,000	PD	Add-Homestead	Yes	1,000	1,000	H	Homestead	No	1,000		<b>Building Permits</b> <table border="1"> <thead> <tr> <th>Number</th> <th>Description</th> <th>Opened</th> <th>Closed</th> <th>Amount</th> </tr> </thead> <tbody> <tr> <td></td> <td></td> <td></td> <td></td> <td></td> </tr> </tbody> </table>					Number	Description	Opened	Closed	Amount																																																																																							
Code	Type	Active	Maximum	Exemption																																																																																																																					
H	Homestead	Yes	1,000	1,000																																																																																																																					
PD	Add-Homestead	Yes	1,000	1,000																																																																																																																					
H	Homestead	No	1,000																																																																																																																						
Number	Description	Opened	Closed	Amount																																																																																																																					
<b>Parcel Valuation</b> <table border="1"> <thead> <tr> <th>Source</th> <th>REAL</th> <th>Fair Cash</th> <th>Capped</th> <th>Asmnt Level</th> <th>Assessed</th> <th>Levy Rate</th> <th>97.960</th> <th>Current Tax</th> </tr> </thead> <tbody> <tr> <td>Remove Cap</td> <td>2022</td> <td>Land Value 130,922</td> <td>115,174</td> <td>11%</td> <td>12,669</td> <td>Assessed</td> <td>25,299</td> <td>2,478.29</td> </tr> <tr> <td>Year Frozen</td> <td>2022</td> <td>Improvements 130,526</td> <td>114,826</td> <td></td> <td>12,630</td> <td>Penalty</td> <td>0</td> <td></td> </tr> <tr> <td>Uncapped Value</td> <td>0</td> <td>Mobile Home 0</td> <td>0</td> <td></td> <td>0</td> <td>Exemption</td> <td>2,000</td> <td>-196.00</td> </tr> <tr> <td>TIF Project ID</td> <td>0</td> <td>Total Value 261,448</td> <td>230,000</td> <td></td> <td>25,299</td> <td>Total Taxable</td> <td>23,299</td> <td>2,282.00</td> </tr> </tbody> </table>					Source	REAL	Fair Cash	Capped	Asmnt Level	Assessed	Levy Rate	97.960	Current Tax	Remove Cap	2022	Land Value 130,922	115,174	11%	12,669	Assessed	25,299	2,478.29	Year Frozen	2022	Improvements 130,526	114,826		12,630	Penalty	0		Uncapped Value	0	Mobile Home 0	0		0	Exemption	2,000	-196.00	TIF Project ID	0	Total Value 261,448	230,000		25,299	Total Taxable	23,299	2,282.00	<b>Sale History</b> <table border="1"> <thead> <tr> <th>Bk/Pg</th> <th>Grantor</th> <th>Date</th> <th>Price</th> <th>Code</th> </tr> </thead> <tbody> <tr> <td>/</td> <td>SANDERS FAMILY TRUST</td> <td>07/20/2021</td> <td>230,000</td> <td>YES</td> </tr> </tbody> </table>					Bk/Pg	Grantor	Date	Price	Code	/	SANDERS FAMILY TRUST	07/20/2021	230,000	YES																																																									
Source	REAL	Fair Cash	Capped	Asmnt Level	Assessed	Levy Rate	97.960	Current Tax																																																																																																																	
Remove Cap	2022	Land Value 130,922	115,174	11%	12,669	Assessed	25,299	2,478.29																																																																																																																	
Year Frozen	2022	Improvements 130,526	114,826		12,630	Penalty	0																																																																																																																		
Uncapped Value	0	Mobile Home 0	0		0	Exemption	2,000	-196.00																																																																																																																	
TIF Project ID	0	Total Value 261,448	230,000		25,299	Total Taxable	23,299	2,282.00																																																																																																																	
Bk/Pg	Grantor	Date	Price	Code																																																																																																																					
/	SANDERS FAMILY TRUST	07/20/2021	230,000	YES																																																																																																																					
<b>Assessment History</b> <table border="1"> <thead> <tr> <th>Tax Year</th> <th>Statement Number</th> <th>Billed Owner</th> <th>Tax Area</th> <th>Total Value</th> <th>Exemptions</th> <th>Taxable Value</th> <th>Billed Tax</th> </tr> </thead> <tbody> <tr><td>2025</td><td>2025-660019768</td><td>LEWIS, LOREN DWAYNE</td><td>3</td><td>257,389</td><td>2000</td><td>23,300</td><td>2,282.00</td></tr> <tr><td>2024</td><td>2024-660019768</td><td>LEWIS, LOREN DWAYNE</td><td>3</td><td>265,418</td><td>2000</td><td>23,301</td><td>2,239.00</td></tr> <tr><td>2023</td><td>2023-660019768</td><td>LEWIS, LOREN DWAYNE</td><td>3</td><td>230,000</td><td>2000</td><td>23,300</td><td>2,183.00</td></tr> <tr><td>2022</td><td>2022-660019768</td><td>LEWIS, LOREN DWAYNE</td><td>3</td><td>230,000</td><td>2000</td><td>23,300</td><td>2,283.00</td></tr> <tr><td>2021</td><td>2021-660019768</td><td>LEWIS, LOREN DWAYNE</td><td>3</td><td>160,611</td><td>1000</td><td>5,978</td><td>578.00</td></tr> <tr><td>2020</td><td>2020-660019768</td><td>SANDERS, LEROY CARL</td><td>3</td><td>161,705</td><td>1000</td><td>5,978</td><td>577.00</td></tr> <tr><td>2019</td><td>2019-660019768</td><td>SANDERS, LEROY CARL</td><td>3</td><td>154,974</td><td>1000</td><td>5,978</td><td>578.00</td></tr> <tr><td>2018</td><td>2018-660019768</td><td>SANDERS, LEROY CARL</td><td>3</td><td>162,099</td><td>1000</td><td>5,978</td><td>556.00</td></tr> <tr><td>2017</td><td>2017-660019768</td><td>SANDERS, LEROY CARL</td><td>3</td><td>160,768</td><td>1000</td><td>5,978</td><td>562.00</td></tr> <tr><td>2016</td><td>2016-660019768</td><td>SANDERS, LEROY CARL</td><td>3</td><td>157,471</td><td>1000</td><td>5,978</td><td>563.00</td></tr> <tr><td>2015</td><td>2015-660019768</td><td>SANDERS, LEROY CARL</td><td>3</td><td>156,338</td><td>1000</td><td>5,979</td><td>567.00</td></tr> <tr><td>2014</td><td>2014-660019768</td><td>SANDERS, LEROY CARL</td><td>3</td><td>157,932</td><td>1000</td><td>5,978</td><td>572.00</td></tr> <tr><td>2013</td><td>2013-660019768</td><td>SANDERS, LEROY CARL</td><td>3</td><td>152,836</td><td>1000</td><td>5,979</td><td>560.00</td></tr> </tbody> </table>										Tax Year	Statement Number	Billed Owner	Tax Area	Total Value	Exemptions	Taxable Value	Billed Tax	2025	2025-660019768	LEWIS, LOREN DWAYNE	3	257,389	2000	23,300	2,282.00	2024	2024-660019768	LEWIS, LOREN DWAYNE	3	265,418	2000	23,301	2,239.00	2023	2023-660019768	LEWIS, LOREN DWAYNE	3	230,000	2000	23,300	2,183.00	2022	2022-660019768	LEWIS, LOREN DWAYNE	3	230,000	2000	23,300	2,283.00	2021	2021-660019768	LEWIS, LOREN DWAYNE	3	160,611	1000	5,978	578.00	2020	2020-660019768	SANDERS, LEROY CARL	3	161,705	1000	5,978	577.00	2019	2019-660019768	SANDERS, LEROY CARL	3	154,974	1000	5,978	578.00	2018	2018-660019768	SANDERS, LEROY CARL	3	162,099	1000	5,978	556.00	2017	2017-660019768	SANDERS, LEROY CARL	3	160,768	1000	5,978	562.00	2016	2016-660019768	SANDERS, LEROY CARL	3	157,471	1000	5,978	563.00	2015	2015-660019768	SANDERS, LEROY CARL	3	156,338	1000	5,979	567.00	2014	2014-660019768	SANDERS, LEROY CARL	3	157,932	1000	5,978	572.00	2013	2013-660019768	SANDERS, LEROY CARL	3	152,836	1000	5,979	560.00
Tax Year	Statement Number	Billed Owner	Tax Area	Total Value	Exemptions	Taxable Value	Billed Tax																																																																																																																		
2025	2025-660019768	LEWIS, LOREN DWAYNE	3	257,389	2000	23,300	2,282.00																																																																																																																		
2024	2024-660019768	LEWIS, LOREN DWAYNE	3	265,418	2000	23,301	2,239.00																																																																																																																		
2023	2023-660019768	LEWIS, LOREN DWAYNE	3	230,000	2000	23,300	2,183.00																																																																																																																		
2022	2022-660019768	LEWIS, LOREN DWAYNE	3	230,000	2000	23,300	2,283.00																																																																																																																		
2021	2021-660019768	LEWIS, LOREN DWAYNE	3	160,611	1000	5,978	578.00																																																																																																																		
2020	2020-660019768	SANDERS, LEROY CARL	3	161,705	1000	5,978	577.00																																																																																																																		
2019	2019-660019768	SANDERS, LEROY CARL	3	154,974	1000	5,978	578.00																																																																																																																		
2018	2018-660019768	SANDERS, LEROY CARL	3	162,099	1000	5,978	556.00																																																																																																																		
2017	2017-660019768	SANDERS, LEROY CARL	3	160,768	1000	5,978	562.00																																																																																																																		
2016	2016-660019768	SANDERS, LEROY CARL	3	157,471	1000	5,978	563.00																																																																																																																		
2015	2015-660019768	SANDERS, LEROY CARL	3	156,338	1000	5,979	567.00																																																																																																																		
2014	2014-660019768	SANDERS, LEROY CARL	3	157,932	1000	5,978	572.00																																																																																																																		
2013	2013-660019768	SANDERS, LEROY CARL	3	152,836	1000	5,979	560.00																																																																																																																		



# Rogers

## Assessment Property Record Card for Tax Year 2026

Data provided by LISA DELOZIER County Assessor

Date 04/17/2026  
 Time 08:00:24  
 Page 2

Lot Data	Square-Foot - NBHD 1069 #1	Primary Image
Lot Size		
Lot Count		
Units Buildable		
Non-Ag Acres	0	
Topography		
Street Access		
Utilities		
Amenities	LAND QUALITY	
	0	
	0	
Method	Square-Foot	
Base Lot Value	228,762.00 x .57 = 130,922	
Factor Value		
Adjustments	1.0000	
Lot Value	130,922	

Residential Data	
Type	1 Single Family Residence
Condition	3 - Average
Quality	2.5 - Fair
Architecture	
Style	100% One Story
Exterior Wall	100% Veneer, Masonry
Base/Total Area	1,735 / 1,735
Style	100% One Story
HVAC	100% Warmed & Cooled Air
Roof Cover	1 Composition Shingle
Area on Slab	0
Fixture/RghIn	8 /
Bed/F/H Bath	3 / 2.0 /
Basement Area	
Garage Type	541 Attached Garage - Unfinished
Remodel	
Year/Eff Age	1970 / 42



\\tsclient\TCASEY\CASEY BOOTH RESIDENTIAL VI\2022-8-17\ 8/18/2022

GRM Approach	
GRM Code	
Gross Rent	0.00
Indicated Value	

Multiple Regression			
MRA Code	1	Test	
Adjusted R	0.8445		
Indicated Value	180,220	103.87	Per SqFt

Direct Comparables			
Selection Model	A	Adam Test	
Adjustment Model	1	2022 Residential	
Comparables	8		
Indicated Value	274,900		Per SqFt

Value Reconciliation			
Selected Approach	Cost Approach		
Improvements	122,792		
Lot Value	130,922		
Indicated Value	253,714	146.23	Per SqFt
Agland Value			
Site Improvements	7,734		
Total Value	261,448	150.69	Total Value Per SqFt

Cost Approach				Manual : 01/2025			
Base Cost	103.77	Total Misc Impr	+	10,991			
Roofing Adj	+ 4.39	Garage Cost	+	14,596			
Subfloor Adj	+ 1.15	Total RCN	=	245,585			
Heat/Cool Adj	+ 11.47	Depreciation ( 50%)	-	122,793			
Plumbing Adj	+ 6.02	Lump Sums	+	0			
Basement Adj	+ 0.00	RCNLD	=	122,792			
Adj Base Cost	= 126.80	Lot Value	+	130,922			
Total Area	x 1,735	Indicated Value	=	253,714			
Adjusted Cost	= 219,998	Value Per SqFt		146.23			

Miscellaneous Improvements								
Code	Description	Sketch ID	Size	Year	Units	Unit Cost	Depr	Value
FPR1	FIREPLACE - RESIDENTIAL 1 STORY	0		1	1	5,095.98		5,096
PRCH	SLAB PORCH - COVERED	48116	12x6		72	24.04		1,731
PRCH	SLAB PORCH - COVERED	48117	16x11		176	23.66		4,164



# Rogers

## Assessment Property Record Card for Tax Year 2026

Data provided by LISA DELOZIER County Assessor

Date 04/17/2026  
 Time 08:00:24  
 Page 3

Sketch Image

660019768

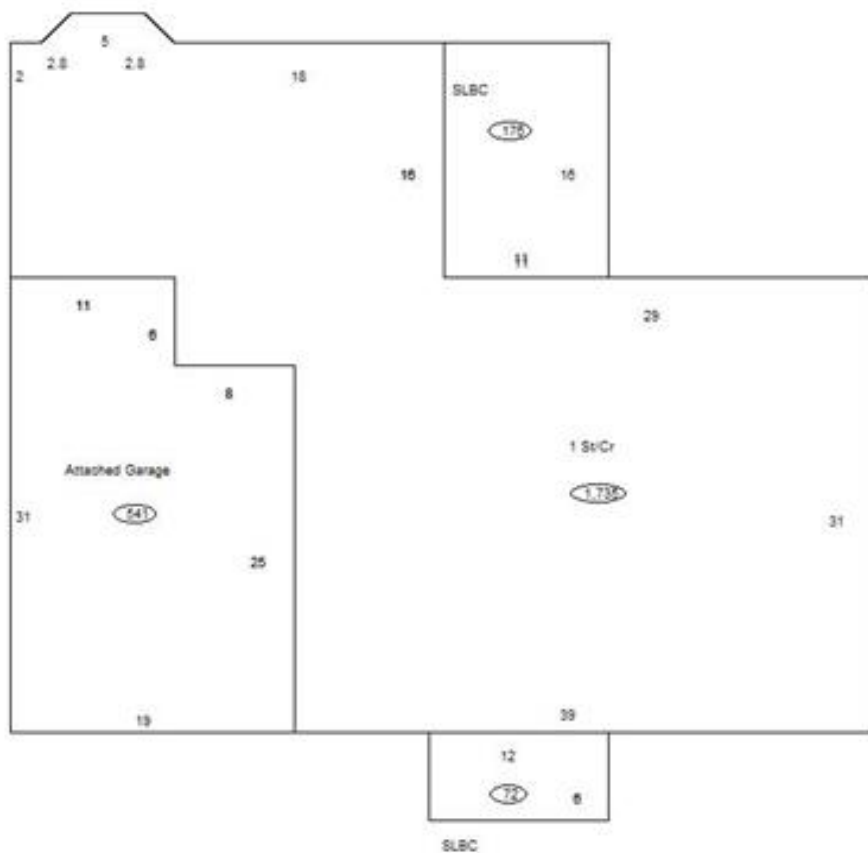

### Sketch Vector Information

Sequence	Code	Type	Built Over	Scale	Section Label	Base Area	Multiplier	Total Area
1	R	1	Crawl	10	1 St/Cr	1,735	1.000	1,735
2	G	1		10	Attached Garage	541	1.000	541
3	M	PRCH		10	SLBC	72	1.000	72
4	M	PRCH		10	SLBC	176	1.000	176
<b>Total Building Area</b>						<b>1,735</b>		<b>1,735</b>



# Rogers

## Assessment Property Record Card for Tax Year 2026

Data provided by LISA DELOZIER County Assessor

Date 04/17/2026  
 Time 08:00:24  
 Page 4

660019768

### Outbuildings/Site Improvements

Building Image	Code	Description	Dimensions	Floor	Roofing	Total Units
	DTGF	DETACHED GARAGE FAIR	20x30x0			600
	Qual 2	Cond 3	Year	Eff Age		
	<b>Valuation Summary</b>		<b>Modifier Total</b>	<b>RCN</b>	<b>Depr (45% Phys/ % Func)</b>	<b>RCNLD</b>
	Base Cost (16.00 x 600)		9,600	9,600	4,320	5,280
	BARN	BARN	16x30x0			480
	Qual 3	Cond 2	Year	Eff Age 2026		
	<b>Valuation Summary</b>		<b>Modifier Total</b>	<b>RCN</b>	<b>Depr (70% Phys/ % Func)</b>	<b>RCNLD</b>
	Base Cost (10.48 x 480)		5,030	5,030	3,521	1,509
	LT	LEAN-TO	12x30x0			360
	Qual 3	Cond 2	Year	Eff Age		
	<b>Valuation Summary</b>		<b>Modifier Total</b>	<b>RCN</b>	<b>Depr (70% Phys/ % Func)</b>	<b>RCNLD</b>
	Base Cost (2.92 x 360)		1,051	1,051	736	315
	CP	CARPORT DIRT	12x30x0			360
	Qual 2	Cond 3	Year	Eff Age		
	<b>Valuation Summary</b>		<b>Modifier Total</b>	<b>RCN</b>	<b>Depr (50% Phys/ % Func)</b>	<b>RCNLD</b>
	Base Cost (3.50 x 360)		1,260	1,260	630	630