



Rogers

Assessment Property Record Card for Tax Year 2026

Data provided by LISA DELOZIER County Assessor

Date 04/16/2026
Time 22:07:16
Page 1

Assessment Data					Primary Image																																																	
Account 660019836 Parcel ID 000000-00-0-00864-002-0006 Cadastral ID 23-21-14-03820 Property Type REAL - Real Property Property Class RRP VI Area 4 Tax Area 3 - OWASSO RURAL/NO FIRE Name ID 326464 STRICKLAND, DANE COREY TRUSTEE DANE STRICKLAND REVOC TRUST 8755 N 162ND E AVE OWASSO OK 74055-0000 Parcel Location Situs 08755 N 162ND E AVE Subdivision VAN LEE Lot/Block 0006 / 0002 Parcel Size 1 - Lots Sec/Twn/Rng 23 / 21 / 14 / 5 Neighborhood 1212 - R-V04-SW OWASSO School District S021 - OWASSO SCHOOLS																																																						
Legal Description Lot/Long: 36.28104295 -95.79200074																																																						
Building Permits					<table border="1"> <thead> <tr> <th>Number</th> <th>Description</th> <th>Opened</th> <th>Closed</th> <th>Amount</th> </tr> </thead> <tbody> <tr> <td colspan="5"> </td> </tr> </tbody> </table>					Number	Description	Opened	Closed	Amount																																								
Number	Description	Opened	Closed	Amount																																																		
Exemptions					Sale History																																																	
Code	Type	Active	Maximum	Exemption	Bk/Pg	Grantor	Date	Price	Code																																													
H	Homestead	Yes	1,000	1,000	/	STRICKLAND, DANE C	12/10/2018	0	4																																													
					1664/682	D & K INVESTMENTS INC	03/16/2005	141,000	YES																																													
					1651/233	PAYNE, SHAWN F	01/21/2005	116,000	10																																													
					1481/420	ARNOLD, CHERYL	05/21/2003	142,333	YES																																													
					1248/11	DOUGLAS & COMPANY	09/13/2000	135,000	Yes																																													
					1175/611	LEAKE, BILL W	06/03/1999	32,000	No																																													
Parcel Valuation					<table border="1"> <thead> <tr> <th>Source</th> <th>REAL</th> <th>Fair Cash</th> <th>Capped</th> <th>Asmnt Level</th> <th>Assessed</th> <th>Levy Rate</th> <th>97.960</th> <th>Current Tax</th> </tr> </thead> <tbody> <tr> <td>Remove Cap</td> <td>2006</td> <td>Land Value 96,004</td> <td>42,342</td> <td>11%</td> <td>4,658</td> <td>Assessed</td> <td>22,829</td> <td>2,236.33</td> </tr> <tr> <td>Year Frozen</td> <td>0</td> <td>Improvements 183,452</td> <td>165,187</td> <td></td> <td>18,171</td> <td>Penalty</td> <td>0</td> <td></td> </tr> <tr> <td>Uncapped Value</td> <td>0</td> <td>Mobile Home 0</td> <td>0</td> <td></td> <td>0</td> <td>Exemption</td> <td>1,000</td> <td>-98.00</td> </tr> <tr> <td>TIF Project ID</td> <td>0</td> <td>Total Value 279,456</td> <td>207,529</td> <td></td> <td>22,829</td> <td>Total Taxable</td> <td>21,829</td> <td>2,138.00</td> </tr> </tbody> </table>					Source	REAL	Fair Cash	Capped	Asmnt Level	Assessed	Levy Rate	97.960	Current Tax	Remove Cap	2006	Land Value 96,004	42,342	11%	4,658	Assessed	22,829	2,236.33	Year Frozen	0	Improvements 183,452	165,187		18,171	Penalty	0		Uncapped Value	0	Mobile Home 0	0		0	Exemption	1,000	-98.00	TIF Project ID	0	Total Value 279,456	207,529		22,829	Total Taxable	21,829	2,138.00
Source	REAL	Fair Cash	Capped	Asmnt Level	Assessed	Levy Rate	97.960	Current Tax																																														
Remove Cap	2006	Land Value 96,004	42,342	11%	4,658	Assessed	22,829	2,236.33																																														
Year Frozen	0	Improvements 183,452	165,187		18,171	Penalty	0																																															
Uncapped Value	0	Mobile Home 0	0		0	Exemption	1,000	-98.00																																														
TIF Project ID	0	Total Value 279,456	207,529		22,829	Total Taxable	21,829	2,138.00																																														
Assessment History																																																						
Tax Year	Statement Number	Billed Owner	Tax Area	Total Value	Exemptions	Taxable Value	Billed Tax																																															
2025	2025-660019836	STRICKLAND, DANE COREY	3	277,015	1000	21,163	2,073.00																																															
2024	2024-660019836	STRICKLAND, DANE COREY	3	277,124	1000	20,518	1,971.00																																															
2023	2023-660019836	STRICKLAND, DANE COREY	3	215,499	1000	19,891	1,864.00																																															
2022	2022-660019836	STRICKLAND, DANE COREY	3	193,494	1000	19,283	1,889.00																																															
2021	2021-660019836	STRICKLAND, DANE COREY	3	179,019	1000	18,692	1,808.00																																															
2020	2020-660019836	STRICKLAND, DANE COREY	3	176,287	1000	18,207	1,759.00																																															
2019	2019-660019836	STRICKLAND, DANE COREY	3	169,525	1000	17,648	1,706.00																																															
2018	2018-660019836	STRICKLAND, DANE C	3	175,276	1000	18,280	1,702.00																																															
2017	2017-660019836	STRICKLAND, DANE C	3	173,891	1000	18,100	1,702.00																																															
2016	2016-660019836	STRICKLAND, DANE C	3	169,690	1000	17,544	1,652.00																																															
2015	2015-660019836	STRICKLAND, DANE C	3	165,887	1000	17,004	1,612.00																																															
2014	2014-660019836	STRICKLAND, DANE C &	3	167,172	1000	16,479	1,577.00																																															
2013	2013-660019836	STRICKLAND, DANE C &	3	157,854	1000	15,970	1,496.00																																															



Rogers

Assessment Property Record Card for Tax Year 2026

Data provided by LISA DELOZIER County Assessor

Date 04/16/2026
Time 22:07:16
Page 2

Lot Data	Square-Foot - NBHD 1212 #1	Primary Image
Lot Size Lot Count Units Buildable 1 Non-Ag Acres 0.8163 Topography Street Access Utilities Amenities LAND QUALITY 0 0 Method Square-Foot Base Lot Value 35,557.00 x 2.70 = 96,004 Factor Value Adjustments 1.0000 Lot Value 96,004		

Residential Data	
Type	1 Single Family Residence
Condition	3 - Average
Quality	2.5 - Fair
Architecture	
Style	100% One Story
Exterior Wall	70% Frame, Siding, Wood 30% Veneer, Masonry
Base/Total Area	1,856 / 1,856
Style	100% One Story
HVAC	100% Warmed & Cooled Air
Roof Cover	1 Composition Shingle
Area on Slab	1,856
Fixture/RghIn	11 /
Bed/F/H Bath	3 / 2.0 /
Basement Area	
Garage Type	560 Attached Garage - Unfinished
Remodel	
Year/Eff Age	2001 / 19



\\tsclient\TCASEY\CASEY BOOTH RESIDENTIAL VI\2022-8-17\ 8/17/2022

GRM Approach	
GRM Code	
Gross Rent	0.00
Indicated Value	

Multiple Regression			
MRA Code	1	Test	
Adjusted R	0.8445		
Indicated Value	213,589	115.08	Per SqFt

Direct Comparables			
Selection Model	A	Adam Test	
Adjustment Model	1	2022 Residential	
Comparables	2		
Indicated Value	283,820		Per SqFt

Cost Approach				Manual : 01/2025			
Base Cost	96.47	Total Misc Impr	+	6,054			
Roofing Adj	+ 4.33	Garage Cost	+	14,986			
Subfloor Adj	+ -1.14	Total RCN	=	241,384			
Heat/Cool Adj	+ 11.47	Depreciation (24%)	-	57,932			
Plumbing Adj	+ 7.59	Lump Sums	+	0			
Basement Adj	+ 0.00	RCNLD	=	183,452			
Adj Base Cost	= 118.72	Lot Value	+	96,004			
Total Area	x 1,856	Indicated Value	=	279,456			
Adjusted Cost	= 220,344	Value Per SqFt		150.57			

Value Reconciliation			
Selected Approach	Cost Approach		
Improvements	183,452		
Lot Value	96,004		
Indicated Value	279,456	150.57	Per SqFt
Agland Value			
Site Improvements			
Total Value	279,456	150.57	Total Value Per SqFt

Miscellaneous Improvements								
Code	Description	Sketch ID	Size	Year	Units	Unit Cost	Depr	Value
PRCH	SLAB PORCH - COVERED	48370	22x6		132	23.83		3,146
EPKS	ENCLOSED PORCH - KNEEWALL SCREEN	48371	11x10		110	26.44		2,908



Rogers

Assessment Property Record Card for Tax Year 2026

Data provided by LISA DELOZIER County Assessor

Date 04/16/2026

Time 22:07:16

Page 3

Sketch Image

660019836

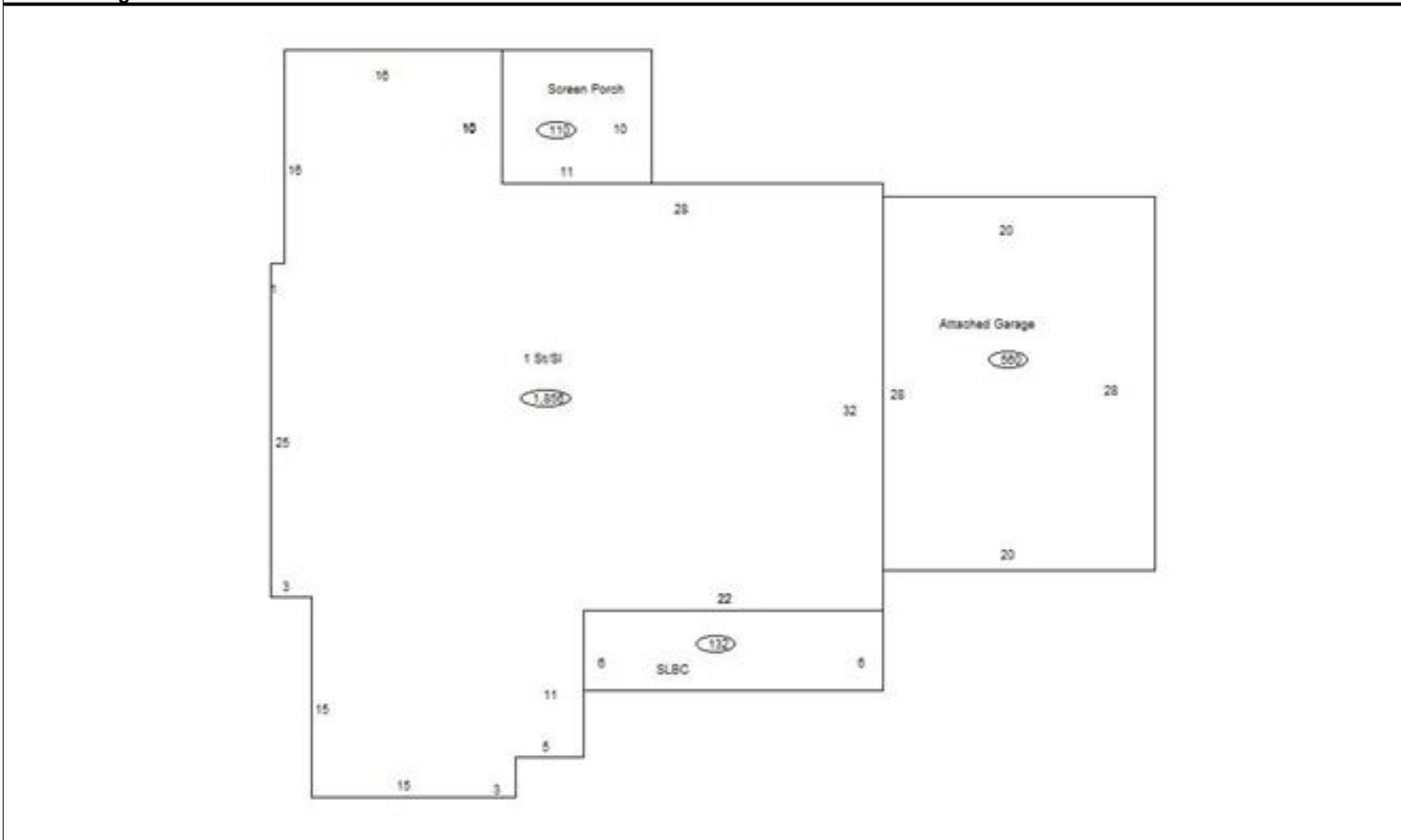

Sketch Vector Information

Sequence	Code	Type	Built Over	Scale	Section Label	Base Area	Multiplier	Total Area
1	R	1	Slab	10	1 St/SI	1,856	1.000	1,856
2	G	1		10	Attached Garage	560	1.000	560
3	M	PRCH		10	SLBC	132	1.000	132
4	M	EPKS		10	Screen Porch	110	1.000	110
Total Building Area						1,856		1,856