



# Rogers

## Assessment Property Record Card for Tax Year 2026

Data provided by LISA DELOZIER County Assessor

Date 04/16/2026  
Time 21:57:41  
Page 1

Assessment Data					Primary Image																																																																																																																				
<b>Account</b> 660019872 <b>Parcel ID</b> 000000-00-0-00393-003-0002 <b>Cadastral ID</b> 23-21-14-04180 <b>Property Type</b> REAL - Real Property <b>Property Class</b> RRP VI Area 4 <b>Tax Area</b> 3 - OWASSO RURAL/NO FIRE <b>Name ID</b> 323766 COLLINS, THOMAS J & MARJORIE A  16118 E 89TH ST N OWASSO OK 74055-0000  <b>Parcel Location</b> <b>Situs</b> 16118 E 89TH ST N <b>Subdivision</b> HUNTERS GLEN ESTATES <b>Lot/Block</b> 0002 / 0003 Parcel Size 1 - Lots <b>Sec/Twn/Rng</b> 23 / 21 / 14 / 5 <b>Neighborhood</b> 1212 - R-V04-SW OWASSO <b>School District</b> S021 - OWASSO SCHOOLS																																																																																																																									
<b>Legal Description</b> Lot/Long: 36.28258591 -95.79334194																																																																																																																									
<b>Legal Description</b> LOT 2 BLOCK 3 HUNTERS GLEN ESTATES					<b>Building Permits</b> <table border="1"> <thead> <tr> <th>Number</th> <th>Description</th> <th>Opened</th> <th>Closed</th> <th>Amount</th> </tr> </thead> <tbody> <tr> <td colspan="5"> </td> </tr> </tbody> </table>					Number	Description	Opened	Closed	Amount																																																																																																											
Number	Description	Opened	Closed	Amount																																																																																																																					
<b>Exemptions</b> <table border="1"> <thead> <tr> <th>Code</th> <th>Type</th> <th>Active</th> <th>Maximum</th> <th>Exemption</th> </tr> </thead> <tbody> <tr> <td>H</td> <td>Homestead</td> <td>No</td> <td>1,000</td> <td></td> </tr> </tbody> </table>					Code	Type	Active	Maximum	Exemption	H	Homestead	No	1,000		<b>Sale History</b> <table border="1"> <thead> <tr> <th>Bk/Pg</th> <th>Grantor</th> <th>Date</th> <th>Price</th> <th>Code</th> </tr> </thead> <tbody> <tr> <td>2690/800</td> <td>GANN, KENDAL &amp;</td> <td>01/30/2018</td> <td>260,000</td> <td>YES</td> </tr> <tr> <td>2595/930</td> <td>BROWN, DENNIS E &amp; KIM UN</td> <td>11/16/2016</td> <td>225,000</td> <td>YES</td> </tr> <tr> <td>883/861</td> <td>MAJETTA PROPERTIES INC</td> <td>06/09/1992</td> <td>83,500</td> <td>Yes</td> </tr> </tbody> </table>					Bk/Pg	Grantor	Date	Price	Code	2690/800	GANN, KENDAL &	01/30/2018	260,000	YES	2595/930	BROWN, DENNIS E & KIM UN	11/16/2016	225,000	YES	883/861	MAJETTA PROPERTIES INC	06/09/1992	83,500	Yes																																																																																		
Code	Type	Active	Maximum	Exemption																																																																																																																					
H	Homestead	No	1,000																																																																																																																						
Bk/Pg	Grantor	Date	Price	Code																																																																																																																					
2690/800	GANN, KENDAL &	01/30/2018	260,000	YES																																																																																																																					
2595/930	BROWN, DENNIS E & KIM UN	11/16/2016	225,000	YES																																																																																																																					
883/861	MAJETTA PROPERTIES INC	06/09/1992	83,500	Yes																																																																																																																					
<b>Parcel Valuation</b> <table border="1"> <thead> <tr> <th>Source</th> <th>REAL</th> <th>Fair Cash</th> <th>Capped</th> <th>Asmnt Level</th> <th>Assessed</th> <th>Levy Rate</th> <th>97.960</th> <th>Current Tax</th> </tr> </thead> <tbody> <tr> <td>Remove Cap</td> <td>2019</td> <td>Land Value</td> <td>122,848</td> <td>89,619</td> <td>11%</td> <td>9,858</td> <td>Assessed</td> <td>38,785 3,799.38</td> </tr> <tr> <td>Year Frozen</td> <td>0</td> <td>Improvements</td> <td>268,644</td> <td>262,977</td> <td></td> <td>28,927</td> <td>Penalty</td> <td>0</td> </tr> <tr> <td>Uncapped Value</td> <td>0</td> <td>Mobile Home</td> <td>0</td> <td>0</td> <td></td> <td>0</td> <td>Exemption</td> <td>0 0.00</td> </tr> <tr> <td>TIF Project ID</td> <td>0</td> <td>Total Value</td> <td>391,492</td> <td>352,596</td> <td></td> <td>38,785</td> <td>Total Taxable</td> <td>38,785 3,799.00</td> </tr> </tbody> </table>										Source	REAL	Fair Cash	Capped	Asmnt Level	Assessed	Levy Rate	97.960	Current Tax	Remove Cap	2019	Land Value	122,848	89,619	11%	9,858	Assessed	38,785 3,799.38	Year Frozen	0	Improvements	268,644	262,977		28,927	Penalty	0	Uncapped Value	0	Mobile Home	0	0		0	Exemption	0 0.00	TIF Project ID	0	Total Value	391,492	352,596		38,785	Total Taxable	38,785 3,799.00																																																																			
Source	REAL	Fair Cash	Capped	Asmnt Level	Assessed	Levy Rate	97.960	Current Tax																																																																																																																	
Remove Cap	2019	Land Value	122,848	89,619	11%	9,858	Assessed	38,785 3,799.38																																																																																																																	
Year Frozen	0	Improvements	268,644	262,977		28,927	Penalty	0																																																																																																																	
Uncapped Value	0	Mobile Home	0	0		0	Exemption	0 0.00																																																																																																																	
TIF Project ID	0	Total Value	391,492	352,596		38,785	Total Taxable	38,785 3,799.00																																																																																																																	
<b>Assessment History</b> <table border="1"> <thead> <tr> <th>Tax Year</th> <th>Statement Number</th> <th>Billed Owner</th> <th>Tax Area</th> <th>Total Value</th> <th>Exemptions</th> <th>Taxable Value</th> <th>Billed Tax</th> </tr> </thead> <tbody> <tr><td>2025</td><td>2025-660019872</td><td>COLLINS, THOMAS J &amp;</td><td>3</td><td>386,775</td><td>0</td><td>36,940</td><td>3,619.00</td></tr> <tr><td>2024</td><td>2024-660019872</td><td>COLLINS, THOMAS J &amp;</td><td>3</td><td>365,703</td><td>0</td><td>35,180</td><td>3,380.00</td></tr> <tr><td>2023</td><td>2023-660019872</td><td>COLLINS, THOMAS J &amp;</td><td>3</td><td>313,584</td><td>0</td><td>33,505</td><td>3,140.00</td></tr> <tr><td>2022</td><td>2022-660019872</td><td>COLLINS, THOMAS J &amp;</td><td>3</td><td>293,806</td><td>0</td><td>31,909</td><td>3,126.00</td></tr> <tr><td>2021</td><td>2021-660019872</td><td>COLLINS, THOMAS J &amp;</td><td>3</td><td>276,270</td><td>0</td><td>30,390</td><td>2,940.00</td></tr> <tr><td>2020</td><td>2020-660019872</td><td>COLLINS, THOMAS J &amp;</td><td>3</td><td>271,780</td><td>0</td><td>29,896</td><td>2,888.00</td></tr> <tr><td>2019</td><td>2019-660019872</td><td>COLLINS, THOMAS J &amp;</td><td>3</td><td>260,251</td><td>0</td><td>28,628</td><td>2,767.00</td></tr> <tr><td>2018</td><td>2018-660019872</td><td>COLLINS, THOMAS J &amp;</td><td>3</td><td>231,193</td><td>0</td><td>25,431</td><td>2,367.00</td></tr> <tr><td>2017</td><td>2017-660019872</td><td>GANN, KENDAL &amp;</td><td>3</td><td>228,290</td><td>0</td><td>25,112</td><td>2,362.00</td></tr> <tr><td>2016</td><td>2016-660019872</td><td>BROWN, DENNIS E &amp; KIM UN</td><td>3</td><td>216,083</td><td>1000</td><td>18,140</td><td>1,708.00</td></tr> <tr><td>2015</td><td>2015-660019872</td><td>BROWN, DENNIS E &amp; KIM UN</td><td>3</td><td>210,529</td><td>1000</td><td>17,582</td><td>1,667.00</td></tr> <tr><td>2014</td><td>2014-660019872</td><td>BROWN, DENNIS E &amp; KIM UN</td><td>3</td><td>212,636</td><td>1000</td><td>17,041</td><td>1,631.00</td></tr> <tr><td>2013</td><td>2013-660019872</td><td>BROWN, DENNIS E &amp; KIM UN</td><td>3</td><td>202,407</td><td>1000</td><td>16,515</td><td>1,547.00</td></tr> </tbody> </table>										Tax Year	Statement Number	Billed Owner	Tax Area	Total Value	Exemptions	Taxable Value	Billed Tax	2025	2025-660019872	COLLINS, THOMAS J &	3	386,775	0	36,940	3,619.00	2024	2024-660019872	COLLINS, THOMAS J &	3	365,703	0	35,180	3,380.00	2023	2023-660019872	COLLINS, THOMAS J &	3	313,584	0	33,505	3,140.00	2022	2022-660019872	COLLINS, THOMAS J &	3	293,806	0	31,909	3,126.00	2021	2021-660019872	COLLINS, THOMAS J &	3	276,270	0	30,390	2,940.00	2020	2020-660019872	COLLINS, THOMAS J &	3	271,780	0	29,896	2,888.00	2019	2019-660019872	COLLINS, THOMAS J &	3	260,251	0	28,628	2,767.00	2018	2018-660019872	COLLINS, THOMAS J &	3	231,193	0	25,431	2,367.00	2017	2017-660019872	GANN, KENDAL &	3	228,290	0	25,112	2,362.00	2016	2016-660019872	BROWN, DENNIS E & KIM UN	3	216,083	1000	18,140	1,708.00	2015	2015-660019872	BROWN, DENNIS E & KIM UN	3	210,529	1000	17,582	1,667.00	2014	2014-660019872	BROWN, DENNIS E & KIM UN	3	212,636	1000	17,041	1,631.00	2013	2013-660019872	BROWN, DENNIS E & KIM UN	3	202,407	1000	16,515	1,547.00
Tax Year	Statement Number	Billed Owner	Tax Area	Total Value	Exemptions	Taxable Value	Billed Tax																																																																																																																		
2025	2025-660019872	COLLINS, THOMAS J &	3	386,775	0	36,940	3,619.00																																																																																																																		
2024	2024-660019872	COLLINS, THOMAS J &	3	365,703	0	35,180	3,380.00																																																																																																																		
2023	2023-660019872	COLLINS, THOMAS J &	3	313,584	0	33,505	3,140.00																																																																																																																		
2022	2022-660019872	COLLINS, THOMAS J &	3	293,806	0	31,909	3,126.00																																																																																																																		
2021	2021-660019872	COLLINS, THOMAS J &	3	276,270	0	30,390	2,940.00																																																																																																																		
2020	2020-660019872	COLLINS, THOMAS J &	3	271,780	0	29,896	2,888.00																																																																																																																		
2019	2019-660019872	COLLINS, THOMAS J &	3	260,251	0	28,628	2,767.00																																																																																																																		
2018	2018-660019872	COLLINS, THOMAS J &	3	231,193	0	25,431	2,367.00																																																																																																																		
2017	2017-660019872	GANN, KENDAL &	3	228,290	0	25,112	2,362.00																																																																																																																		
2016	2016-660019872	BROWN, DENNIS E & KIM UN	3	216,083	1000	18,140	1,708.00																																																																																																																		
2015	2015-660019872	BROWN, DENNIS E & KIM UN	3	210,529	1000	17,582	1,667.00																																																																																																																		
2014	2014-660019872	BROWN, DENNIS E & KIM UN	3	212,636	1000	17,041	1,631.00																																																																																																																		
2013	2013-660019872	BROWN, DENNIS E & KIM UN	3	202,407	1000	16,515	1,547.00																																																																																																																		



# Rogers

## Assessment Property Record Card for Tax Year 2026

Data provided by LISA DELOZIER County Assessor

Date 04/16/2026  
 Time 21:57:41  
 Page 2

Lot Data	Square-Foot - NBHD 1212 #1	Primary Image
<b>Lot Size</b> <b>Lot Count</b> <b>Units Buildable</b> 1 <b>Non-Ag Acres</b> 1.1145 <b>Topography</b> <b>Street Access</b> <b>Utilities</b> <b>Amenities</b> LAND QUALITY 0 0 <b>Method</b> Square-Foot <b>Base Lot Value</b> 48,547.00 x 2.53 = 122,848 <b>Factor Value</b> <b>Adjustments</b> 1.0000 <b>Lot Value</b> 122,848		

Residential Data	
<b>Type</b>	1 Single Family Residence
<b>Condition</b>	3 - Average
<b>Quality</b>	3 - Average
<b>Architecture</b>	
<b>Style</b>	100% 1 1/2 Story Finished
<b>Exterior Wall</b>	50% Veneer, Masonry 50% Frame, Siding, Wood
<b>Base/Total Area</b>	1,226 / 2,126
<b>Style</b>	100% 1 1/2 Story Finished
<b>HVAC</b>	100% Warmed & Cooled Air
<b>Roof Cover</b>	1 Composition Shingle
<b>Area on Slab</b>	1,226
<b>Fixture/RghIn</b>	15 /
<b>Bed/F/H Bath</b>	4 / 2.5 /
<b>Basement Area</b>	
<b>Garage Type</b>	660 Attached Garage - Unfinished
<b>Remodel</b>	RMA -
<b>Year/Eff Age</b>	1992 / 17



\\tsclient\TCASEY\CASEY BOOTH RESIDENTIAL VI\2022-8-17\ 8/18/2022

GRM Approach	
<b>GRM Code</b>	
<b>Gross Rent</b>	0.00
<b>Indicated Value</b>	

Multiple Regression			
<b>MRA Code</b>	1	Test	
<b>Adjusted R</b>	0.8445		
<b>Indicated Value</b>	298,334	140.33	Per SqFt

Direct Comparables			
<b>Selection Model</b>	A	Adam Test	
<b>Adjustment Model</b>	1	2022 Residential	
<b>Comparables</b>	4		
<b>Indicated Value</b>	417,190		Per SqFt

Cost Approach				Manual : 01/2025			
<b>Base Cost</b>	92.73	<b>Total Misc Impr</b>	+ 9,301				
<b>Roofing Adj</b>	+ 3.00	<b>Garage Cost</b>	+ 19,912				
<b>Subfloor Adj</b>	+ -1.40	<b>Total RCN</b>	= 277,509				
<b>Heat/Cool Adj</b>	+ 12.64	<b>Depreciation ( 19%)</b>	- 52,727				
<b>Plumbing Adj</b>	+ 9.82	<b>Lump Sums</b>	+ 0				
<b>Basement Adj</b>	+ 0.00	<b>RCNLD</b>	= 224,782				
<b>Adj Base Cost</b>	= 116.79	<b>Lot Value</b>	+ 122,848				
<b>Total Area</b>	x 2,126	<b>Indicated Value</b>	= 347,630				
<b>Adjusted Cost</b>	= 248,296	<b>Value Per SqFt</b>	163.51				

Value Reconciliation			
<b>Selected Approach</b>	Cost Approach		
<b>Improvements</b>	224,782		
<b>Lot Value</b>	122,848		
<b>Indicated Value</b>	347,630	163.51	Per SqFt
<b>Agland Value</b>			
<b>Site Improvements</b>	43,862		
<b>Total Value</b>	391,492	184.14	Total Value Per SqFt

Miscellaneous Improvements								
Code	Description	Sketch ID	Size	Year	Units	Unit Cost	Depr	Value
FPR1	FIREPLACE - RESIDENTIAL 1 STORY	0		1	1	5,615.40		5,615
PRCH	SLAB PORCH - COVERED	48497	18x4		72	26.70		1,922
PRCH	SLAB PORCH - COVERED	48498	66		66	26.72		1,764



**Rogers**  
**Assessment Property Record Card for Tax Year 2026**  
 Data provided by LISA DELOZIER County Assessor

Date 04/16/2026  
 Time 21:57:41  
 Page 3

Sketch Image

660019872

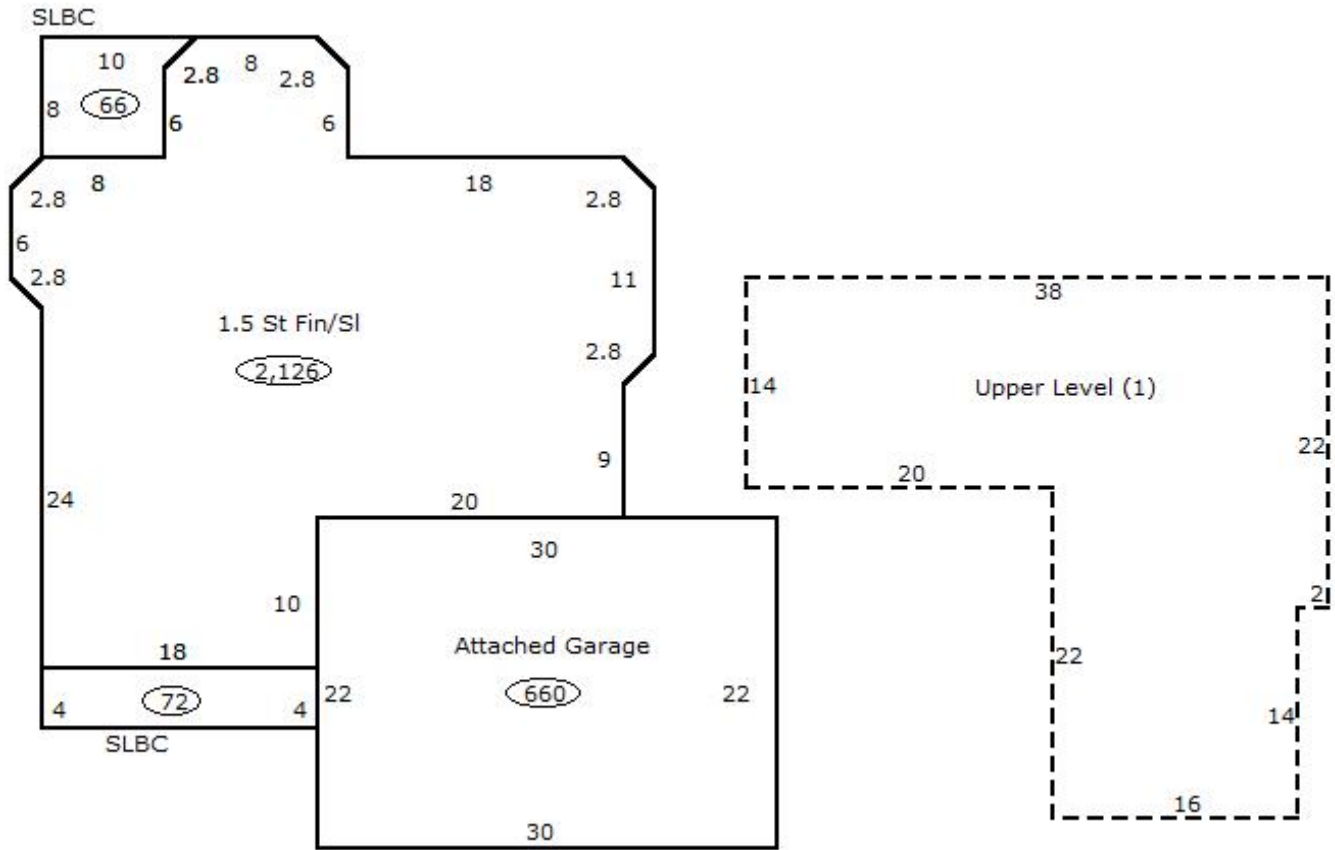

**Sketch Vector Information**

Sequence	Code	Type	Built Over	Scale	Section Label	Base Area	Multiplier	Total Area
1	R	5	Slab	13	1.5 St Fin/Sl	1,226	1.734	2,126
2	G	1		13	Attached Garage	660	1.000	660
3	M	PRCH		13	SLBC	72	1.000	72
4	M	PRCH		13	SLBC	66	1.000	66
5	U	^UL		13	Upper Level (1)	900	1.000	900
<b>Total Building Area</b>						1,226		2,126



# Rogers

## Assessment Property Record Card for Tax Year 2026

Data provided by LISA DELOZIER County Assessor

Date 04/16/2026  
 Time 21:57:42  
 Page 4

660019872

### Outbuildings/Site Improvements

Building Image	Code	Description	Dimensions	Floor	Roofing	Total Units
	GF	GAZEBO FAIR	0x0x0			1
	Qual 2	Cond 3	Year 2018	Eff Age		
	<b>Valuation Summary</b> Base Cost (2,950.00 x 1) 2,950		<b>Modifier Total</b>	<b>RCN</b> 2,950	<b>Depr (0% Phys/ % Func)</b>	<b>RCNLD</b> 2,950
	GRDT	GARAGE - DETACHED	30x40x0			1,200
	Qual 3	Cond 3	Year	Eff Age		
	<b>Valuation Summary</b> Base Cost (27.24 x 1,200) 32,688		<b>Modifier Total</b>	<b>RCN</b> 32,688	<b>Depr (10% Phys/ % Func)</b> 3,269	<b>RCNLD</b> 29,419
	SV	SWIM VINYL	0x0x0			1
	Qual 3	Cond 3	Year	Eff Age		
	<b>Valuation Summary</b> Base Cost (25,000.00 x 1) 25,000		<b>Modifier Total</b>	<b>RCN</b> 25,000	<b>Depr (60% Phys/ % Func)</b> 15,000	<b>RCNLD</b> 10,000
	STF	STG FAIR	14x24x0			336
	Qual 2	Cond 3	Year	Eff Age 1520		
	<b>Valuation Summary</b> Base Cost (4.68 x 336) 1,572		<b>Modifier Total</b>	<b>RCN</b> 1,572	<b>Depr (5% Phys/ % Func)</b> 79	<b>RCNLD</b> 1,493