



Rogers

Assessment Property Record Card for Tax Year 2026

Data provided by LISA DELOZIER County Assessor

Date 04/17/2026
Time 14:55:32
Page 1

Assessment Data					Primary Image																																																																																																																				
Account 660020041 Parcel ID 22N16E-23-4-00000-000-0000 Cadastral ID 23-22-16-04100 Property Type REAL - Real Property Property Class RR VI Area 1 Tax Area 75 - SEQUOYAH/FOYIL FD Name ID 260884 MUNS, JAMES B & MARY 14741 E 450 RD CLAREMORE OK 74017-0607 Parcel Location Situs 14741 E 450 RD Subdivision Lot/Block / Parcel Size 1 - Acres Sec/Twn/Rng 23 / 22 / 16 / 4 Neighborhood 6050 - UNPLATTED School District S006 - SEQUOYAH SCHOOLS																																																																																																																									
Legal Description Lat/Long: 36.36564221 -95.56514649 PT SW SE SE BEG; SW/C; N ALG W/L 208.7'; E PAR S/L 208.7'; S PAR W/L 208.7' W ALG S/L 208.7' TO POB																																																																																																																									
Building Permits					<table border="1"> <thead> <tr> <th>Number</th> <th>Description</th> <th>Opened</th> <th>Closed</th> <th>Amount</th> </tr> </thead> <tbody> <tr> <td>R21 000366</td> <td>R22- NEW 20X25 DTCH ACC BLDG</td> <td>09/2021</td> <td>12/2021</td> <td>10,000</td> </tr> </tbody> </table>					Number	Description	Opened	Closed	Amount	R21 000366	R22- NEW 20X25 DTCH ACC BLDG	09/2021	12/2021	10,000																																																																																																						
Number	Description	Opened	Closed	Amount																																																																																																																					
R21 000366	R22- NEW 20X25 DTCH ACC BLDG	09/2021	12/2021	10,000																																																																																																																					
Exemptions					Sale History																																																																																																																				
<table border="1"> <thead> <tr> <th>Code</th> <th>Type</th> <th>Active</th> <th>Maximum</th> <th>Exemption</th> </tr> </thead> <tbody> <tr> <td></td> <td></td> <td></td> <td></td> <td></td> </tr> </tbody> </table>					Code	Type	Active	Maximum	Exemption						<table border="1"> <thead> <tr> <th>Bk/Pg</th> <th>Grantor</th> <th>Date</th> <th>Price</th> <th>Code</th> </tr> </thead> <tbody> <tr> <td>1931/58</td> <td>SHELTON, KATHRYN C ESTATE</td> <td>02/01/2008</td> <td>45,000</td> <td>YES</td> </tr> <tr> <td>1873/501</td> <td>LEWIS, MARY K</td> <td>06/04/2007</td> <td>0</td> <td>4</td> </tr> <tr> <td>1867/699</td> <td>SHELTON, KATHRYN C</td> <td>05/11/2007</td> <td>0</td> <td>4</td> </tr> </tbody> </table>					Bk/Pg	Grantor	Date	Price	Code	1931/58	SHELTON, KATHRYN C ESTATE	02/01/2008	45,000	YES	1873/501	LEWIS, MARY K	06/04/2007	0	4	1867/699	SHELTON, KATHRYN C	05/11/2007	0	4																																																																																		
Code	Type	Active	Maximum	Exemption																																																																																																																					
Bk/Pg	Grantor	Date	Price	Code																																																																																																																					
1931/58	SHELTON, KATHRYN C ESTATE	02/01/2008	45,000	YES																																																																																																																					
1873/501	LEWIS, MARY K	06/04/2007	0	4																																																																																																																					
1867/699	SHELTON, KATHRYN C	05/11/2007	0	4																																																																																																																					
Parcel Valuation																																																																																																																									
Source REAL		Fair Cash		Capped		Asmnt Level		Assessed		Levy Rate 101.310		Current Tax																																																																																																													
Remove Cap 2009		Land Value 29,817		29,511		11%		3,246		Assessed 24,055		2,437.01																																																																																																													
Year Frozen 0		Improvements 241,120		189,177				20,809		Penalty 0																																																																																																															
Uncapped Value 0		Mobile Home 0		0				0		Exemption 0		0.00																																																																																																													
TIF Project ID 0		Total Value 270,937		218,688				24,055		Total Taxable 24,055		2,437.00																																																																																																													
Assessment History																																																																																																																									
<table border="1"> <thead> <tr> <th>Tax Year</th> <th>Statement Number</th> <th>Billed Owner</th> <th>Tax Area</th> <th>Total Value</th> <th>Exemptions</th> <th>Taxable Value</th> <th>Billed Tax</th> </tr> </thead> <tbody> <tr><td>2025</td><td>2025-660020041</td><td>MUNS, JAMES B & MARY</td><td>75</td><td>261,913</td><td>0</td><td>22,911</td><td>2,321.00</td></tr> <tr><td>2024</td><td>2024-660020041</td><td>MUNS, JAMES B & MARY</td><td>75</td><td>276,529</td><td>0</td><td>21,819</td><td>2,223.00</td></tr> <tr><td>2023</td><td>2023-660020041</td><td>MUNS, JAMES B & MARY</td><td>75</td><td>197,836</td><td>0</td><td>20,780</td><td>2,164.00</td></tr> <tr><td>2022</td><td>2022-660020041</td><td>MUNS, JAMES B & MARY</td><td>75</td><td>198,752</td><td>0</td><td>19,791</td><td>2,104.00</td></tr> <tr><td>2021</td><td>2021-660020041</td><td>MUNS, JAMES B & MARY</td><td>75</td><td>164,626</td><td>0</td><td>17,969</td><td>1,856.00</td></tr> <tr><td>2020</td><td>2020-660020041</td><td>MUNS, JAMES B & MARY</td><td>75</td><td>163,435</td><td>0</td><td>17,113</td><td>1,832.00</td></tr> <tr><td>2019</td><td>2019-660020041</td><td>MUNS, JAMES B & MARY</td><td>75</td><td>148,170</td><td>0</td><td>16,299</td><td>1,730.00</td></tr> <tr><td>2018</td><td>2018-660020041</td><td>MUNS, JAMES B & MARY</td><td>75</td><td>152,069</td><td>0</td><td>16,728</td><td>1,784.00</td></tr> <tr><td>2017</td><td>2017-660020041</td><td>MUNS, JAMES B & MARY</td><td>9</td><td>150,796</td><td>0</td><td>16,588</td><td>1,481.00</td></tr> <tr><td>2016</td><td>2016-660020041</td><td>MUNS, JAMES B & MARY</td><td>9</td><td>146,951</td><td>0</td><td>16,165</td><td>1,436.00</td></tr> <tr><td>2015</td><td>2015-660020041</td><td>MUNS, JAMES B & MARY</td><td>9</td><td>143,365</td><td>0</td><td>15,770</td><td>1,435.00</td></tr> <tr><td>2014</td><td>2014-660020041</td><td>MUNS, JAMES B & MARY</td><td>9</td><td>145,809</td><td>0</td><td>15,750</td><td>1,453.00</td></tr> <tr><td>2013</td><td>2013-660020041</td><td>MUNS, JAMES B & MARY</td><td>9</td><td>136,908</td><td>0</td><td>15,000</td><td>1,361.00</td></tr> </tbody> </table>										Tax Year	Statement Number	Billed Owner	Tax Area	Total Value	Exemptions	Taxable Value	Billed Tax	2025	2025-660020041	MUNS, JAMES B & MARY	75	261,913	0	22,911	2,321.00	2024	2024-660020041	MUNS, JAMES B & MARY	75	276,529	0	21,819	2,223.00	2023	2023-660020041	MUNS, JAMES B & MARY	75	197,836	0	20,780	2,164.00	2022	2022-660020041	MUNS, JAMES B & MARY	75	198,752	0	19,791	2,104.00	2021	2021-660020041	MUNS, JAMES B & MARY	75	164,626	0	17,969	1,856.00	2020	2020-660020041	MUNS, JAMES B & MARY	75	163,435	0	17,113	1,832.00	2019	2019-660020041	MUNS, JAMES B & MARY	75	148,170	0	16,299	1,730.00	2018	2018-660020041	MUNS, JAMES B & MARY	75	152,069	0	16,728	1,784.00	2017	2017-660020041	MUNS, JAMES B & MARY	9	150,796	0	16,588	1,481.00	2016	2016-660020041	MUNS, JAMES B & MARY	9	146,951	0	16,165	1,436.00	2015	2015-660020041	MUNS, JAMES B & MARY	9	143,365	0	15,770	1,435.00	2014	2014-660020041	MUNS, JAMES B & MARY	9	145,809	0	15,750	1,453.00	2013	2013-660020041	MUNS, JAMES B & MARY	9	136,908	0	15,000	1,361.00
Tax Year	Statement Number	Billed Owner	Tax Area	Total Value	Exemptions	Taxable Value	Billed Tax																																																																																																																		
2025	2025-660020041	MUNS, JAMES B & MARY	75	261,913	0	22,911	2,321.00																																																																																																																		
2024	2024-660020041	MUNS, JAMES B & MARY	75	276,529	0	21,819	2,223.00																																																																																																																		
2023	2023-660020041	MUNS, JAMES B & MARY	75	197,836	0	20,780	2,164.00																																																																																																																		
2022	2022-660020041	MUNS, JAMES B & MARY	75	198,752	0	19,791	2,104.00																																																																																																																		
2021	2021-660020041	MUNS, JAMES B & MARY	75	164,626	0	17,969	1,856.00																																																																																																																		
2020	2020-660020041	MUNS, JAMES B & MARY	75	163,435	0	17,113	1,832.00																																																																																																																		
2019	2019-660020041	MUNS, JAMES B & MARY	75	148,170	0	16,299	1,730.00																																																																																																																		
2018	2018-660020041	MUNS, JAMES B & MARY	75	152,069	0	16,728	1,784.00																																																																																																																		
2017	2017-660020041	MUNS, JAMES B & MARY	9	150,796	0	16,588	1,481.00																																																																																																																		
2016	2016-660020041	MUNS, JAMES B & MARY	9	146,951	0	16,165	1,436.00																																																																																																																		
2015	2015-660020041	MUNS, JAMES B & MARY	9	143,365	0	15,770	1,435.00																																																																																																																		
2014	2014-660020041	MUNS, JAMES B & MARY	9	145,809	0	15,750	1,453.00																																																																																																																		
2013	2013-660020041	MUNS, JAMES B & MARY	9	136,908	0	15,000	1,361.00																																																																																																																		



Rogers

Assessment Property Record Card for Tax Year 2026

Data provided by LISA DELOZIER County Assessor

Date 04/17/2026
Time 14:55:32
Page 2

Lot Data		Square-Foot - NBHD 6050 #1		Primary Image				
Lot Size								
Lot Count								
Units Buildable	1							
Non-Ag Acres	0.9779							
Topography								
Street Access								
Utilities								
Amenities	LAND QUALITY					0		
						0		
Method	Square-Foot							
Base Lot Value	42,596.00 x .70 = 29,817			\\tsclient\T\LOGAN\LOGAN RESIDENTIAL VI\2022-12-19\IMG_00		12/20/2022		
Factor Value				GRM Approach				
Adjustments	1.0000			GRM Code				
Lot Value	29,817			Gross Rent 0.00				
Residential Data				Indicated Value				
Type	1 Single Family Residence			Multiple Regression				
Condition	3 - Average			MRA Code 1 Test				
Quality	3 - Average			Adusted R 0.8445				
Architecture				Indicated Value 237,080 110.42 Per SqFt				
Style	100% 1 1/2 Story Finished			Direct Comparables				
Exterior Wall	30% Veneer, Masonry 70% Frame, Siding, Wood			Selection Model 1 Res				
Base/Total Area	1,562 / 2,147			Adjustment Model A2 AO Test				
Style	100% 1 1/2 Story Finished			Comparables				
HVAC	100% Warmed & Cooled Air			Indicated Value				
Roof Cover	1 Composition Shingle			Value Reconciliation				
Area on Slab	1,562			Selected Approach Cost Approach				
Fixture/RghIn	11 /			Improvements 224,655				
Bed/F/H Bath	3 / 2.0 /			Lot Value 29,817				
Basement Area				Indicated Value 254,472 118.52 Per SqFt				
Garage Type				Agland Value				
Remodel				Site Improvements 16,465				
Year/Eff Age	2010 / 12			Total Value 270,937 126.19 Total Value Per SqFt				
Cost Approach		Manual : 01/2025						
Base Cost	92.10	Total Misc Impr	+ 9,024					
Roofing Adj	+ 3.59	Garage Cost	+ 253,503					
Subfloor Adj	+ -1.68	Total RCN	= 30,420					
Heat/Cool Adj	+ 12.64	Depreciation (12%)	- 1,572					
Plumbing Adj	+ 7.22	Lump Sums	+ 224,655					
Basement Adj	+ 0.00	RCNLD	= 29,817					
Adj Base Cost	= 113.87	Lot Value	+ 254,472					
Total Area	x 2,147	Indicated Value	= 118.52					
Adjusted Cost	= 244,479	Value Per SqFt						
Miscellaneous Improvements								
Code	Description	Sketch ID	Size	Year	Units	Unit Cost	Depr	Value
FPR1	FIREPLACE - RESIDENTIAL 1 STORY	0		1	1	5,615.40		5,615
PRCH	SLAB PORCH - COVERED	48994	15x6		90	26.65		2,399
PATO	SLAB PORCH - OPEN	48995	88		88	11.48		1,010
BALW	BALCONY - WOOD	141824	14x4		56	28.08		1,572



Rogers

Assessment Property Record Card for Tax Year 2026

Data provided by LISA DELOZIER County Assessor

Date 04/17/2026
 Time 14:55:32
 Page 3

Sketch Image

660020041

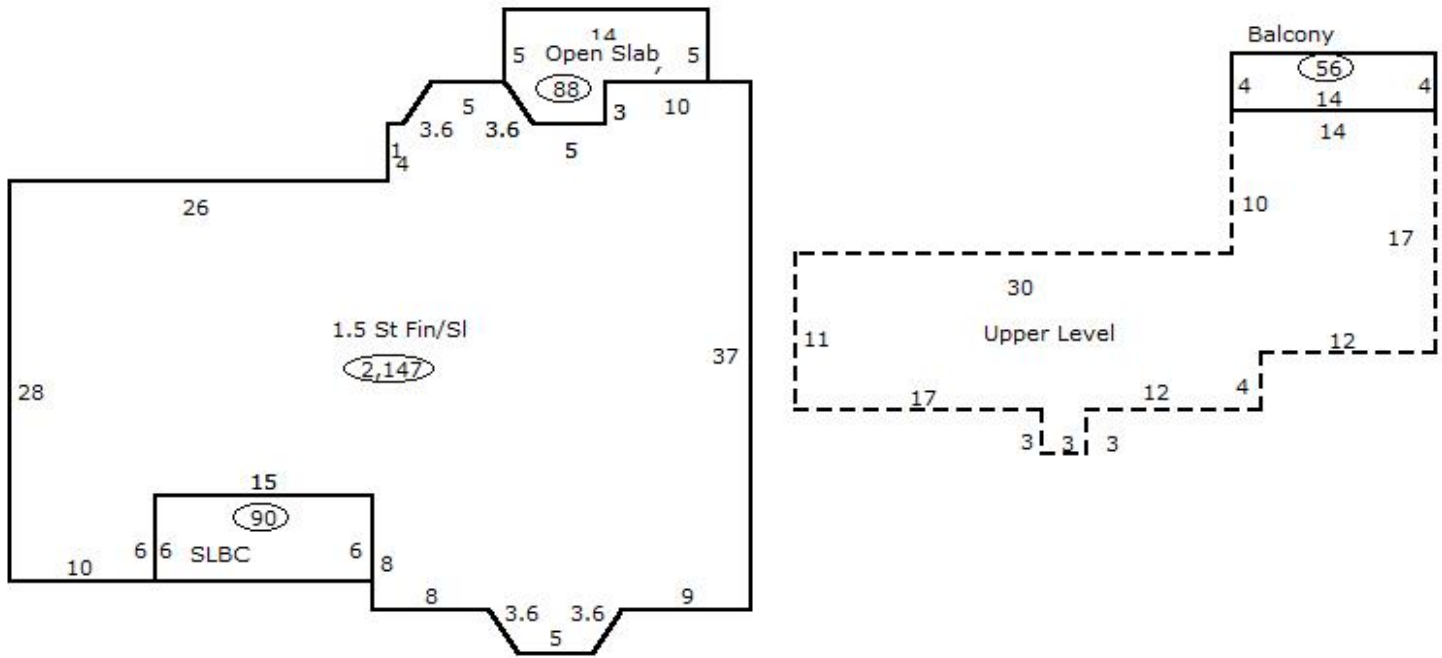

Sketch Vector Information

Sequence	Code	Type	Built Over	Scale	Section Label	Base Area	Multiplier	Total Area
1	R	5	Slab	13	1.5 St Fin/Sl	1,562	1.375	2,147
2	U	^UL	Overhang	13	Upper Level	585	1.000	585
3	M	PRCH		13	SLBC	90	1.000	90
4	M	PATO		13	Open Slab	88	1.000	88
5	M	BALW		13	Balcony	56	1.000	56
Total Building Area						1,562		2,147



Rogers

Assessment Property Record Card for Tax Year 2026

Data provided by LISA DELOZIER County Assessor

Date 04/17/2026
 Time 14:55:32
 Page 4

660020041

Outbuildings/Site Improvements

Building Image	Code	Description	Dimensions	Floor	Roofing	Total Units
	UTIL	Shop Building	25x20x0			500
	Qual	2	Cond	Year	2021	Eff Age
	Valuation Summary		Modifier Total		RCN	Depr (0% Phys/ % Func)
	Base Cost (32.93 x 500)		16,465		16,465	16,465
	STF	STG FAIR	0x0x0			
	Qual	2	Cond	Year		Eff Age
	Valuation Summary		Modifier Total		RCN	Depr (100% Phys/ % Func)
	Base Cost (4.68 x)					
	STF	STG FAIR	0x0x0			
	Qual	2	Cond	Year		Eff Age
	Valuation Summary		Modifier Total		RCN	Depr (100% Phys/ % Func)
	Base Cost (4.68 x)					