



# Rogers

## Assessment Property Record Card for Tax Year 2026

Data provided by LISA DELOZIER County Assessor

Date 04/16/2026  
Time 22:05:48  
Page 1

Assessment Data					Primary Image									
Account	660020336													
Parcel ID	000000-00-0-00294-001-0018													
Cadastral ID	24-21-14-02280													
Property Type	REAL - Real Property													
Property Class	RRP	VI Area 4												
Tax Area	7 - OWASSO/LIMESTONE FIRE													
Name ID	336571													
KIMBALL, KRISTI E & KYLE L DIETERIE														
17713 E 93RD ST N OWASSO OK 74055-0000														
Parcel Location														
Situs	17713 E 93RD ST N													
Subdivision	EASTWOOD LAKE ESTATES													
Lot/Block	0018 / 0001	Parcel Size 1 - Lots												
Sec/Twn/Rng	24 / 21 / 14 / 5													
Neighborhood	1136 - R-V04-SW OWASSO													
School District	S021 - OWASSO SCHOOLS													
Legal Description Lat/Long: 36.28843092 -95.77528076														
LOT 18 BLOCK 1 EASTWOOD LAKE ESTATES														
Building Permits														
<table border="1"> <thead> <tr> <th>Number</th> <th>Description</th> <th>Opened</th> <th>Closed</th> <th>Amount</th> </tr> </thead> <tbody> <tr> <td colspan="5"> </td> </tr> </tbody> </table>					Number	Description	Opened	Closed	Amount					
Number	Description	Opened	Closed	Amount										
Exemptions														
Code	Type	Active	Maximum	Exemption	Sale History									
H	Homestead	Yes	1,000	1,000	Bk/Pg	Grantor	Date	Price	Code					
					/	HEAVENLY FATHER'S PROPERTIES LI	11/18/2021	290,000	YES					
					/	LOCKER, CHARLES R ESTATE	08/05/2021	180,500	YES					
					927/419	TABER, JAMES O	08/31/1993	105,000	Yes					
Parcel Valuation														
Source	REAL		Fair Cash	Capped	Asmnt Level	Assessed	Levy Rate	108.538	Current Tax					
Remove Cap	2022	Land Value	103,800	103,800	11%	11,418	Assessed	28,470	3,090.08					
Year Frozen	2005	Improvements	155,014	155,014		17,052	Penalty	0						
Uncapped Value	0	Mobile Home	0	0		0	Exemption	1,000	-97.00					
TIF Project ID	0	Total Value	258,814	258,814		28,470	Total Taxable	27,470	2,993.00					
Assessment History														
Tax Year	Statement Number	Billed Owner			Tax Area	Total Value	Exemptions	Taxable Value	Billed Tax					
2025	2025-660020336	KIMBALL, KRISTI E &			7	253,826	1000	26,921	2,932.00					
2024	2024-660020336	KIMBALL, KRISTI E &			7	247,421	1000	26,216	2,908.00					
2023	2023-660020336	KIMBALL, KRISTI E &			7	290,000	1000	30,900	3,352.00					
2022	2022-660020336	KIMBALL, KRISTI E &			7	290,000	0	31,900	3,581.00					
2021	2021-660020336	HEAVENLY FATHER'S PROPERTIES LLC			7	182,123	1000	11,333	1,272.00					
2020	2020-660020336	LOCKER, CHARLES R &			7	179,369	1000	11,334	1,271.00					
2019	2019-660020336	LOCKER, CHARLES R &			7	174,709	1000	11,334	1,272.00					
2018	2018-660020336	LOCKER, CHARLES R &			7	179,968	1000	11,334	1,231.00					
2017	2017-660020336	LOCKER, CHARLES R &			7	178,576	1000	11,333	1,242.00					
2016	2016-660020336	LOCKER, CHARLES R &			7	174,285	1000	11,334	1,243.00					
2015	2015-660020336	LOCKER, CHARLES R &			7	169,176	1000	11,334	1,251.00					
2014	2014-660020336	LOCKER, CHARLES R &			7	170,447	1000	11,334	1,261.00					
2013	2013-660020336	LOCKER, CHARLES R &			7	163,871	1000	11,333	1,238.00					



# Rogers

## Assessment Property Record Card for Tax Year 2026

Data provided by LISA DELOZIER County Assessor

Date 04/16/2026  
Time 22:05:48  
Page 2

Lot Data	Square-Foot - NBHD 1136 #1	Primary Image
Lot Size		
Lot Count		
Units Buildable	1	
Non-Ag Acres	1.0441	
Topography		
Street Access		
Utilities		
Amenities	LAND QUALITY	
	0	
	0	
Method	Square-Foot	
Base Lot Value	45,481.00 x 2.28 = 103,800	
Factor Value		
Adjustments	1.0000	
Lot Value	103,800	

Residential Data	
Type	1 Single Family Residence
Condition	2.5 - Fair
Quality	3 - Average
Architecture	
Style	100% One Story
Exterior Wall	100% Veneer, Masonry
Base/Total Area	1,983 / 1,983
Style	100% One Story
HVAC	100% Warmed & Cooled Air
Roof Cover	1 Composition Shingle
Area on Slab	1,983
Fixture/RghIn	14 /
Bed/F/H Bath	3 / 2.5 /
Basement Area	
Garage Type	440 Attached Garage - Unfinished
Remodel	
Year/Eff Age	1979 / 41



\\tsclient\TCASEY\CASEY BOOTH RESIDENTIAL VI\2022-8-15\ 8/16/2022

GRM Approach	
GRM Code	
Gross Rent	0.00
Indicated Value	

Multiple Regression			
MRA Code	1	Test	
Adjusted R	0.8445		
Indicated Value	211,087	106.45	Per SqFt

Direct Comparables			
Selection Model	A	Adam Test	
Adjustment Model	1	2022 Residential	
Comparables	8		
Indicated Value	283,150		Per SqFt

Cost Approach				Manual : 01/2025			
Base Cost	107.68	Total Misc Impr	+	14,897			
Roofing Adj	+ 4.71	Garage Cost	+	14,498			
Subfloor Adj	+ -2.20	Total RCN	=	292,480			
Heat/Cool Adj	+ 12.64	Depreciation ( 47%)	-	137,466			
Plumbing Adj	+ 9.84	Lump Sums	+	0			
Basement Adj	+ 0.00	RCNLD	=	155,014			
Adj Base Cost	= 132.67	Lot Value	+	103,800			
Total Area	x 1,983	Indicated Value	=	258,814			
Adjusted Cost	= 263,085	Value Per SqFt		130.52			

Value Reconciliation			
Selected Approach	Cost Approach		
Improvements	155,014		
Lot Value	103,800		
Indicated Value	258,814	130.52	Per SqFt
Agland Value			
Site Improvements			
Total Value	258,814	130.52	Total Value Per SqFt

Miscellaneous Improvements								
Code	Description	Sketch ID	Size	Year	Units	Unit Cost	Depr	Value
FPR1	FIREPLACE - RESIDENTIAL 1 STORY	0		1	1	5,615.40		5,615
PRCH	SLAB PORCH - COVERED	49633	22x7		154	26.45		4,073
PRCH	SLAB PORCH - COVERED	49634	18x11		198	26.31		5,209



**Rogers**  
**Assessment Property Record Card for Tax Year 2026**

Data provided by LISA DELOZIER County Assessor

Date 04/16/2026  
 Time 22:05:48  
 Page 3

Sketch Image

660020336

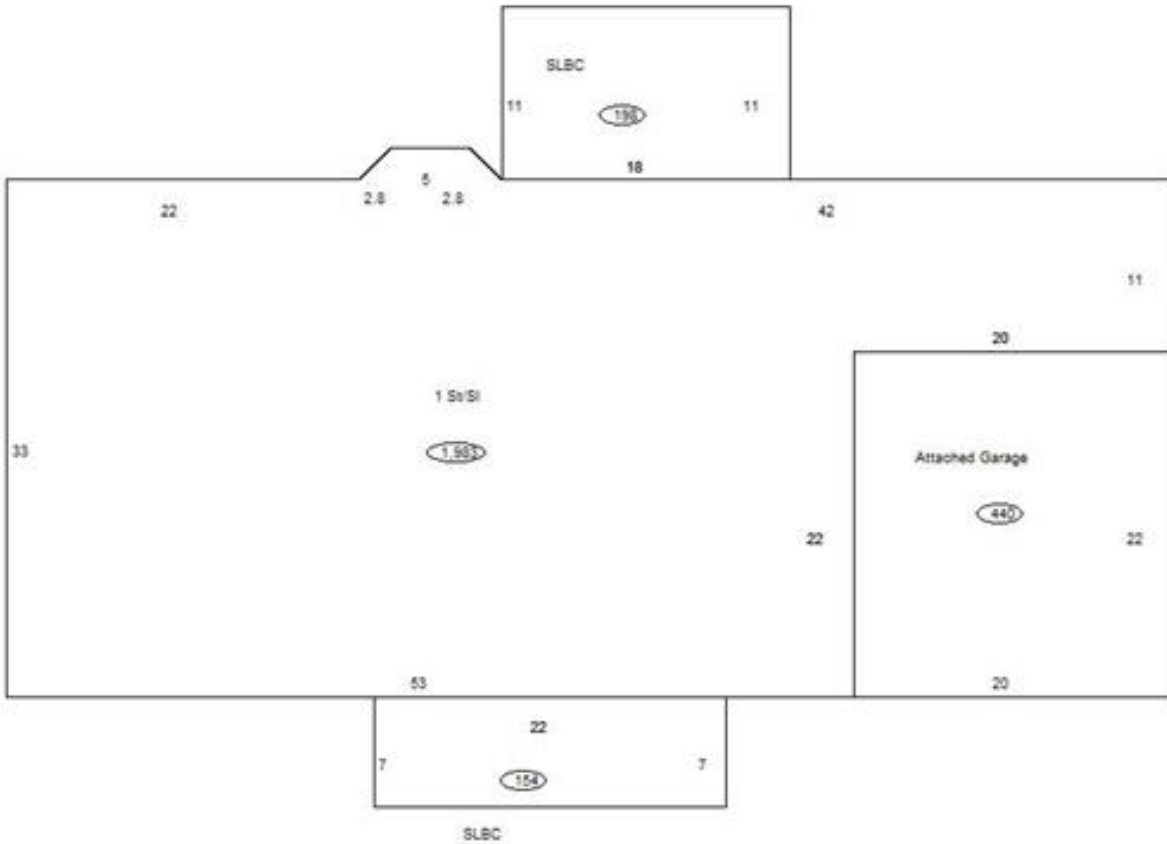

**Sketch Vector Information**

Sequence	Code	Type	Built Over	Scale	Section Label	Base Area	Multiplier	Total Area
1	R	1	Slab	10	1 St/SI	1,983	1.000	1,983
2	G	1		10	Attached Garage	440	1.000	440
3	M	PRCH		10	SLBC	154	1.000	154
4	M	PRCH		10	SLBC	198	1.000	198
<b>Total Building Area</b>						1,983		1,983