



Rogers

Assessment Property Record Card for Tax Year 2026

Data provided by LISA DELOZIER County Assessor

Date 04/16/2026
Time 23:13:23
Page 1

Assessment Data					Primary Image																																																																																																																				
Account 660020416 Parcel ID 000000-00-0-00303-002-0008 Cadastral ID 24-21-14-03080 Property Type REAL - Real Property Property Class RRP VI Area 4 Tax Area 7 - OWASSO/LIMESTONE FIRE Name ID 259556 BUXTON, CHESTER E & LETICIA R 9114 N 184TH E AVE OWASSO OK 74055-0000																																																																																																																									
Parcel Location Situs 09114 N 184TH E AVE Subdivision EASTWOOD LAKE ESTATES 4 Lot/Block 0008 / 0002 Parcel Size 1 - Lots Sec/Twn/Rng 24 / 21 / 14 / 5 Neighborhood 1136 - R-V04-SW OWASSO School District S021 - OWASSO SCHOOLS																																																																																																																									
Legal Description Lat/Long: 36.28639342 -95.76771463 LOT 8 BLOCK 2 EASTWOOD LAKE ESTS. 4					Building Permits <table border="1"> <thead> <tr> <th>Number</th> <th>Description</th> <th>Opened</th> <th>Closed</th> <th>Amount</th> </tr> </thead> <tbody> <tr> <td> </td> <td> </td> <td> </td> <td> </td> <td> </td> </tr> </tbody> </table>					Number	Description	Opened	Closed	Amount																																																																																																											
Number	Description	Opened	Closed	Amount																																																																																																																					
Exemptions <table border="1"> <thead> <tr> <th>Code</th> <th>Type</th> <th>Active</th> <th>Maximum</th> <th>Exemption</th> </tr> </thead> <tbody> <tr> <td>H</td> <td>Homestead</td> <td>Yes</td> <td>1,000</td> <td>1,000</td> </tr> </tbody> </table>					Code	Type	Active	Maximum	Exemption	H	Homestead	Yes	1,000	1,000	Sale History <table border="1"> <thead> <tr> <th>Bk/Pg</th> <th>Grantor</th> <th>Date</th> <th>Price</th> <th>Code</th> </tr> </thead> <tbody> <tr> <td>969/49</td> <td>WILKINSON, FREDRICK A</td> <td>09/20/1994</td> <td>128,000</td> <td>Yes</td> </tr> </tbody> </table>					Bk/Pg	Grantor	Date	Price	Code	969/49	WILKINSON, FREDRICK A	09/20/1994	128,000	Yes																																																																																												
Code	Type	Active	Maximum	Exemption																																																																																																																					
H	Homestead	Yes	1,000	1,000																																																																																																																					
Bk/Pg	Grantor	Date	Price	Code																																																																																																																					
969/49	WILKINSON, FREDRICK A	09/20/1994	128,000	Yes																																																																																																																					
Parcel Valuation <table border="1"> <thead> <tr> <th>Source</th> <th>REAL</th> <th>Fair Cash</th> <th>Capped</th> <th>Asmnt Level</th> <th>Assessed</th> <th>Levy Rate</th> <th>108.538</th> <th>Current Tax</th> </tr> </thead> <tbody> <tr> <td>Remove Cap</td> <td>0</td> <td>Land Value 107,783</td> <td>55,507</td> <td>11%</td> <td>6,106</td> <td>Assessed</td> <td>30,585</td> <td>3,319.63</td> </tr> <tr> <td>Year Frozen</td> <td>0</td> <td>Improvements 239,172</td> <td>222,534</td> <td></td> <td>24,479</td> <td>Penalty</td> <td>0</td> <td></td> </tr> <tr> <td>Uncapped Value</td> <td>0</td> <td>Mobile Home 0</td> <td>0</td> <td></td> <td>0</td> <td>Exemption</td> <td>1,000</td> <td>-98.00</td> </tr> <tr> <td>TIF Project ID</td> <td>0</td> <td>Total Value 346,955</td> <td>278,041</td> <td></td> <td>30,585</td> <td>Total Taxable</td> <td>29,585</td> <td>3,222.00</td> </tr> </tbody> </table>										Source	REAL	Fair Cash	Capped	Asmnt Level	Assessed	Levy Rate	108.538	Current Tax	Remove Cap	0	Land Value 107,783	55,507	11%	6,106	Assessed	30,585	3,319.63	Year Frozen	0	Improvements 239,172	222,534		24,479	Penalty	0		Uncapped Value	0	Mobile Home 0	0		0	Exemption	1,000	-98.00	TIF Project ID	0	Total Value 346,955	278,041		30,585	Total Taxable	29,585	3,222.00																																																																			
Source	REAL	Fair Cash	Capped	Asmnt Level	Assessed	Levy Rate	108.538	Current Tax																																																																																																																	
Remove Cap	0	Land Value 107,783	55,507	11%	6,106	Assessed	30,585	3,319.63																																																																																																																	
Year Frozen	0	Improvements 239,172	222,534		24,479	Penalty	0																																																																																																																		
Uncapped Value	0	Mobile Home 0	0		0	Exemption	1,000	-98.00																																																																																																																	
TIF Project ID	0	Total Value 346,955	278,041		30,585	Total Taxable	29,585	3,222.00																																																																																																																	
Assessment History <table border="1"> <thead> <tr> <th>Tax Year</th> <th>Statement Number</th> <th>Billed Owner</th> <th>Tax Area</th> <th>Total Value</th> <th>Exemptions</th> <th>Taxable Value</th> <th>Billed Tax</th> </tr> </thead> <tbody> <tr><td>2025</td><td>2025-660020416</td><td>BUXTON, CHESTER E &</td><td>7</td><td>338,678</td><td>1000</td><td>28,694</td><td>3,125.00</td></tr> <tr><td>2024</td><td>2024-660020416</td><td>BUXTON, CHESTER E &</td><td>7</td><td>334,260</td><td>1000</td><td>27,829</td><td>3,086.00</td></tr> <tr><td>2023</td><td>2023-660020416</td><td>BUXTON, CHESTER E &</td><td>7</td><td>264,259</td><td>1000</td><td>26,989</td><td>2,929.00</td></tr> <tr><td>2022</td><td>2022-660020416</td><td>BUXTON, CHESTER E &</td><td>7</td><td>252,309</td><td>1000</td><td>26,174</td><td>2,952.00</td></tr> <tr><td>2021</td><td>2021-660020416</td><td>BUXTON, CHESTER E &</td><td>7</td><td>239,842</td><td>1000</td><td>25,383</td><td>2,833.00</td></tr> <tr><td>2020</td><td>2020-660020416</td><td>BUXTON, CHESTER E &</td><td>7</td><td>240,704</td><td>1000</td><td>24,959</td><td>2,782.00</td></tr> <tr><td>2019</td><td>2019-660020416</td><td>BUXTON, CHESTER E &</td><td>7</td><td>229,114</td><td>1000</td><td>24,203</td><td>2,700.00</td></tr> <tr><td>2018</td><td>2018-660020416</td><td>BUXTON, CHESTER E &</td><td>7</td><td>235,558</td><td>1000</td><td>24,911</td><td>2,689.00</td></tr> <tr><td>2017</td><td>2017-660020416</td><td>BUXTON, CHESTER E &</td><td>7</td><td>233,663</td><td>1000</td><td>24,703</td><td>2,691.00</td></tr> <tr><td>2016</td><td>2016-660020416</td><td>BUXTON, CHESTER E &</td><td>7</td><td>227,930</td><td>1000</td><td>24,027</td><td>2,619.00</td></tr> <tr><td>2015</td><td>2015-660020416</td><td>BUXTON, CHESTER E &</td><td>7</td><td>220,894</td><td>1000</td><td>23,298</td><td>2,556.00</td></tr> <tr><td>2014</td><td>2014-660020416</td><td>BUXTON, CHESTER E &</td><td>7</td><td>252,067</td><td>1000</td><td>23,574</td><td>2,608.00</td></tr> <tr><td>2013</td><td>2013-660020416</td><td>BUXTON, CHESTER E &</td><td>7</td><td>237,756</td><td>1000</td><td>22,858</td><td>2,482.00</td></tr> </tbody> </table>										Tax Year	Statement Number	Billed Owner	Tax Area	Total Value	Exemptions	Taxable Value	Billed Tax	2025	2025-660020416	BUXTON, CHESTER E &	7	338,678	1000	28,694	3,125.00	2024	2024-660020416	BUXTON, CHESTER E &	7	334,260	1000	27,829	3,086.00	2023	2023-660020416	BUXTON, CHESTER E &	7	264,259	1000	26,989	2,929.00	2022	2022-660020416	BUXTON, CHESTER E &	7	252,309	1000	26,174	2,952.00	2021	2021-660020416	BUXTON, CHESTER E &	7	239,842	1000	25,383	2,833.00	2020	2020-660020416	BUXTON, CHESTER E &	7	240,704	1000	24,959	2,782.00	2019	2019-660020416	BUXTON, CHESTER E &	7	229,114	1000	24,203	2,700.00	2018	2018-660020416	BUXTON, CHESTER E &	7	235,558	1000	24,911	2,689.00	2017	2017-660020416	BUXTON, CHESTER E &	7	233,663	1000	24,703	2,691.00	2016	2016-660020416	BUXTON, CHESTER E &	7	227,930	1000	24,027	2,619.00	2015	2015-660020416	BUXTON, CHESTER E &	7	220,894	1000	23,298	2,556.00	2014	2014-660020416	BUXTON, CHESTER E &	7	252,067	1000	23,574	2,608.00	2013	2013-660020416	BUXTON, CHESTER E &	7	237,756	1000	22,858	2,482.00
Tax Year	Statement Number	Billed Owner	Tax Area	Total Value	Exemptions	Taxable Value	Billed Tax																																																																																																																		
2025	2025-660020416	BUXTON, CHESTER E &	7	338,678	1000	28,694	3,125.00																																																																																																																		
2024	2024-660020416	BUXTON, CHESTER E &	7	334,260	1000	27,829	3,086.00																																																																																																																		
2023	2023-660020416	BUXTON, CHESTER E &	7	264,259	1000	26,989	2,929.00																																																																																																																		
2022	2022-660020416	BUXTON, CHESTER E &	7	252,309	1000	26,174	2,952.00																																																																																																																		
2021	2021-660020416	BUXTON, CHESTER E &	7	239,842	1000	25,383	2,833.00																																																																																																																		
2020	2020-660020416	BUXTON, CHESTER E &	7	240,704	1000	24,959	2,782.00																																																																																																																		
2019	2019-660020416	BUXTON, CHESTER E &	7	229,114	1000	24,203	2,700.00																																																																																																																		
2018	2018-660020416	BUXTON, CHESTER E &	7	235,558	1000	24,911	2,689.00																																																																																																																		
2017	2017-660020416	BUXTON, CHESTER E &	7	233,663	1000	24,703	2,691.00																																																																																																																		
2016	2016-660020416	BUXTON, CHESTER E &	7	227,930	1000	24,027	2,619.00																																																																																																																		
2015	2015-660020416	BUXTON, CHESTER E &	7	220,894	1000	23,298	2,556.00																																																																																																																		
2014	2014-660020416	BUXTON, CHESTER E &	7	252,067	1000	23,574	2,608.00																																																																																																																		
2013	2013-660020416	BUXTON, CHESTER E &	7	237,756	1000	22,858	2,482.00																																																																																																																		



Rogers

Assessment Property Record Card for Tax Year 2026

Data provided by LISA DELOZIER County Assessor

Date 04/16/2026
 Time 23:13:23
 Page 2

Lot Data		Square-Foot - NBHD 1136 #1	
Lot Size			
Lot Count			
Units Buildable	1		
Non-Ag Acres	1.1203		
Topography			
Street Access			
Utilities			
Amenities	LAND QUALITY	0	
		0	
Method	Square-Foot		
Base Lot Value	48,800.00 x 2.21 = 107,783		
Factor Value			
Adjustments	1.0000		
Lot Value	107,783		

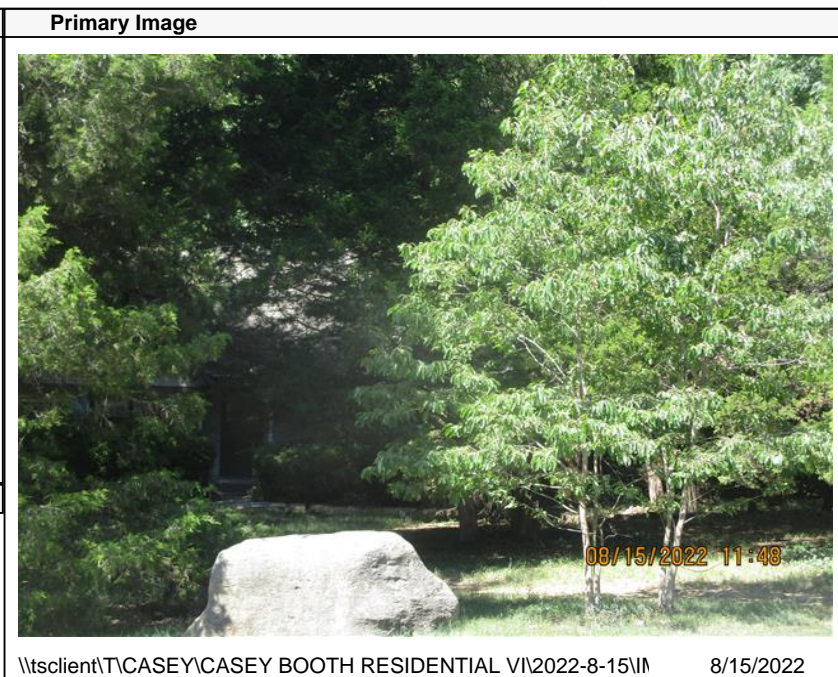

\\tsclient\TCASEY\CASEY BOOTH RESIDENTIAL VI\2022-8-15\ 8/15/2022

Residential Data	
Type	1 Single Family Residence
Condition	3 - Average
Quality	3.5 - Average
Architecture	
Style	100% 1 1/2 Story Finished
Exterior Wall	100% Veneer, Masonry
Base/Total Area	1,983 / 2,527
Style	100% 1 1/2 Story Finished
HVAC	100% Warmed & Cooled Air
Roof Cover	1 Composition Shingle
Area on Slab	1,983
Fixture/RghIn	14 /
Bed/F/H Bath	3 / 2.5 /
Basement Area	
Garage Type	575 Attached Garage - Unfinished
Remodel	
Year/Eff Age	1986 / 30

GRM Approach

GRM Code	
Gross Rent	0.00
Indicated Value	

Multiple Regression

MRA Code	1 Test
Adusted R	0.8445
Indicated Value	301,043 119.13 Per SqFt

Direct Comparables

Selection Model	A Adam Test
Adjustment Model	1 2022 Residential
Comparables	8
Indicated Value	315,500 Per SqFt

Value Reconciliation

Selected Approach	Cost Approach
Improvements	239,172
Lot Value	107,783
Indicated Value	346,955 137.30 Per SqFt
Agland Value	
Site Improvements	
Total Value	346,955 137.30 Total Value Per SqFt

Cost Approach		Manual : 01/2025	
Base Cost	100.94	Total Misc Impr	+ 15,093
Roofing Adj	+ 4.23	Garage Cost	+ 22,172
Subfloor Adj	+ -2.68	Total RCN	= 355,187
Heat/Cool Adj	+ 14.47	Depreciation (37%)	- 131,419
Plumbing Adj	+ 8.85	Lump Sums	+ 15,404
Basement Adj	+ 0.00	RCNLD	= 239,172
Adj Base Cost	= 125.81	Lot Value	+ 107,783
Total Area	x 2,527	Indicated Value	= 346,955
Adjusted Cost	= 317,922	Value Per SqFt	137.30

Miscellaneous Improvements

Code	Description	Sketch ID	Size	Year	Units	Unit Cost	Depr	Value
FPR1	FIREPLACE - RESIDENTIAL 1 STORY	0		1	1	6,429.63		6,430
PRCH	SLAB PORCH - COVERED	50071	22x10		220	28.73		6,321
PRCH	SLAB PORCH - COVERED	50072	16x5		80	29.27		2,342
WODO	WOOD DECK - OPEN	50073	1160		1,160	18.97	30%	15,404



Rogers
Assessment Property Record Card for Tax Year 2026

Data provided by LISA DELOZIER County Assessor

Date 04/16/2026
 Time 23:13:23
 Page 3

Sketch Image

660020416

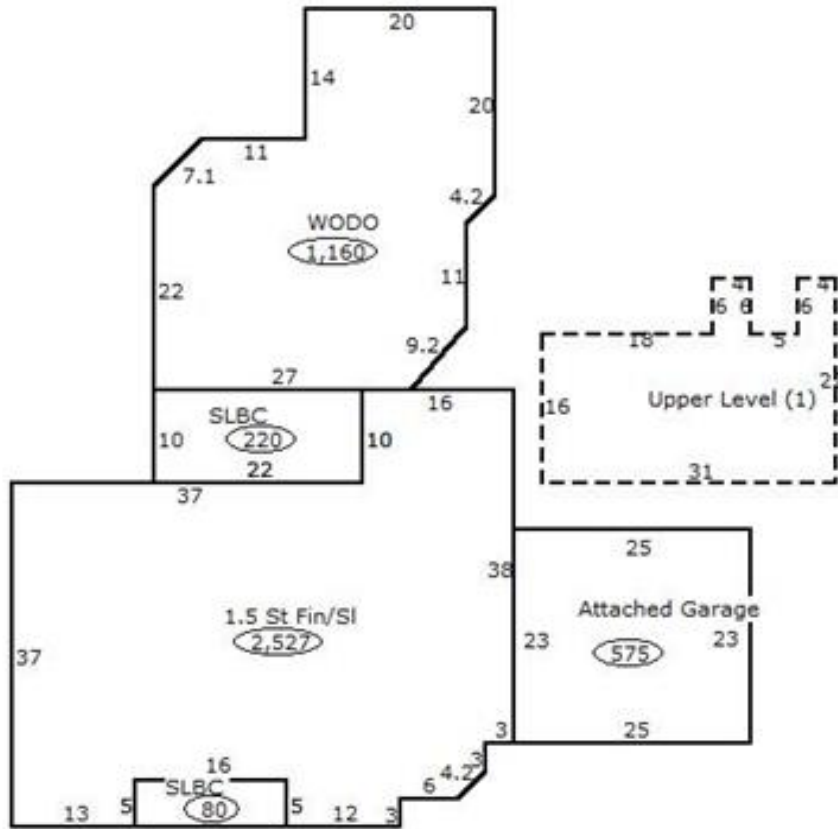

Sketch Vector Information

Sequence	Code	Type	Built Over	Scale	Section Label	Base Area	Multiplier	Total Area
1	R	5	Slab	20	1.5 St Fin/Sl	1,983	1.274	2,527
2	G	1		20	Attached Garage	575	1.000	575
3	M	PRCH		20	SLBC	220	1.000	220
4	M	PRCH		20	SLBC	80	1.000	80
5	M	WODO		20	WODO	1,160	1.000	1,160
6	U	^UL		20	Upper Level (1)	544	1.000	544
Total Building Area						1,983		2,527