



Rogers

Assessment Property Record Card for Tax Year 2026

Data provided by LISA DELOZIER County Assessor

Date 04/16/2026
Time 22:24:52
Page 1

Assessment Data					Primary Image																																																																																																																				
Account 660020417 Parcel ID 000000-00-0-00303-003-0001 Cadastral ID 24-21-14-03090 Property Type REAL - Real Property Property Class RRP VI Area 4 Tax Area 7 - OWASSO/LIMESTONE FIRE Name ID 306407 POND, STEPHEN W-TRUSTEE SWP REVOCABLE TRUST 9115 N 184TH E AVE OWASSO OK 74055-0000 Parcel Location Situs 09115 N 184TH E AVE Subdivision EASTWOOD LAKE ESTATES 4 Lot/Block 0001 / 0003 Parcel Size 1 - Lots Sec/Twn/Rng 24 / 21 / 14 / 5 Neighborhood 1136 - R-V04-SW OWASSO School District S021 - OWASSO SCHOOLS																																																																																																																									
Legal Description Lot/Long: 36.28649868 -95.76673870																																																																																																																									
Building Permits					<table border="1"> <thead> <tr> <th>Number</th> <th>Description</th> <th>Opened</th> <th>Closed</th> <th>Amount</th> </tr> </thead> <tbody> <tr> <td>R22 079</td> <td>R23 NEW DCTH ACC BLDG 32X30</td> <td>03/2022</td> <td>09/2022</td> <td>65,000</td> </tr> </tbody> </table>					Number	Description	Opened	Closed	Amount	R22 079	R23 NEW DCTH ACC BLDG 32X30	03/2022	09/2022	65,000																																																																																																						
Number	Description	Opened	Closed	Amount																																																																																																																					
R22 079	R23 NEW DCTH ACC BLDG 32X30	03/2022	09/2022	65,000																																																																																																																					
Exemptions					Sale History																																																																																																																				
<table border="1"> <thead> <tr> <th>Code</th> <th>Type</th> <th>Active</th> <th>Maximum</th> <th>Exemption</th> </tr> </thead> <tbody> <tr> <td>H</td> <td>Homestead</td> <td>Yes</td> <td>1,000</td> <td>1,000</td> </tr> </tbody> </table>					Code	Type	Active	Maximum	Exemption	H	Homestead	Yes	1,000	1,000	<table border="1"> <thead> <tr> <th>Bk/Pg</th> <th>Grantor</th> <th>Date</th> <th>Price</th> <th>Code</th> </tr> </thead> <tbody> <tr> <td>2624/45</td> <td>POND, STEPHEN &</td> <td>04/05/2017</td> <td>0</td> <td>4</td> </tr> <tr> <td>2227/270</td> <td>YENDES, PAUL B & ANNETTE</td> <td>02/21/2012</td> <td>229,000</td> <td>YES</td> </tr> <tr> <td>1174/370</td> <td>LAND, WILLIAM PAUL</td> <td>05/28/1999</td> <td>182,000</td> <td>No</td> </tr> </tbody> </table>					Bk/Pg	Grantor	Date	Price	Code	2624/45	POND, STEPHEN &	04/05/2017	0	4	2227/270	YENDES, PAUL B & ANNETTE	02/21/2012	229,000	YES	1174/370	LAND, WILLIAM PAUL	05/28/1999	182,000	No																																																																																		
Code	Type	Active	Maximum	Exemption																																																																																																																					
H	Homestead	Yes	1,000	1,000																																																																																																																					
Bk/Pg	Grantor	Date	Price	Code																																																																																																																					
2624/45	POND, STEPHEN &	04/05/2017	0	4																																																																																																																					
2227/270	YENDES, PAUL B & ANNETTE	02/21/2012	229,000	YES																																																																																																																					
1174/370	LAND, WILLIAM PAUL	05/28/1999	182,000	No																																																																																																																					
Parcel Valuation																																																																																																																									
<table border="1"> <thead> <tr> <th>Source</th> <th>REAL</th> <th>Fair Cash</th> <th>Capped</th> <th>Asmnt Level</th> <th>Assessed</th> <th>Levy Rate</th> <th>108.538</th> <th>Current Tax</th> </tr> </thead> <tbody> <tr> <td>Remove Cap</td> <td>2013</td> <td>Land Value</td> <td>107,873</td> <td>65,727</td> <td>11%</td> <td>7,230</td> <td>Assessed</td> <td>35,267</td> <td>3,827.81</td> </tr> <tr> <td>Year Frozen</td> <td>0</td> <td>Improvements</td> <td>301,974</td> <td>254,886</td> <td></td> <td>28,037</td> <td>Penalty</td> <td>0</td> <td></td> </tr> <tr> <td>Uncapped Value</td> <td>0</td> <td>Mobile Home</td> <td>0</td> <td>0</td> <td></td> <td>0</td> <td>Exemption</td> <td>1,000</td> <td>-98.00</td> </tr> <tr> <td>TIF Project ID</td> <td>0</td> <td>Total Value</td> <td>409,847</td> <td>320,613</td> <td></td> <td>35,267</td> <td>Total Taxable</td> <td>34,267</td> <td>3,730.00</td> </tr> </tbody> </table>		Source	REAL	Fair Cash	Capped	Asmnt Level	Assessed	Levy Rate	108.538	Current Tax	Remove Cap	2013	Land Value	107,873	65,727	11%	7,230	Assessed	35,267	3,827.81	Year Frozen	0	Improvements	301,974	254,886		28,037	Penalty	0		Uncapped Value	0	Mobile Home	0	0		0	Exemption	1,000	-98.00	TIF Project ID	0	Total Value	409,847	320,613		35,267	Total Taxable	34,267	3,730.00																																																																							
Source	REAL	Fair Cash	Capped	Asmnt Level	Assessed	Levy Rate	108.538	Current Tax																																																																																																																	
Remove Cap	2013	Land Value	107,873	65,727	11%	7,230	Assessed	35,267	3,827.81																																																																																																																
Year Frozen	0	Improvements	301,974	254,886		28,037	Penalty	0																																																																																																																	
Uncapped Value	0	Mobile Home	0	0		0	Exemption	1,000	-98.00																																																																																																																
TIF Project ID	0	Total Value	409,847	320,613		35,267	Total Taxable	34,267	3,730.00																																																																																																																
Assessment History																																																																																																																									
<table border="1"> <thead> <tr> <th>Tax Year</th> <th>Statement Number</th> <th>Billed Owner</th> <th>Tax Area</th> <th>Total Value</th> <th>Exemptions</th> <th>Taxable Value</th> <th>Billed Tax</th> </tr> </thead> <tbody> <tr><td>2025</td><td>2025-660020417</td><td>POND, STEPHEN W-TRUSTEE</td><td>7</td><td>399,771</td><td>1000</td><td>33,240</td><td>3,618.00</td></tr> <tr><td>2024</td><td>2024-660020417</td><td>POND, STEPHEN W-TRUSTEE</td><td>7</td><td>381,247</td><td>1000</td><td>32,243</td><td>3,573.00</td></tr> <tr><td>2023</td><td>2023-660020417</td><td>POND, STEPHEN W-TRUSTEE</td><td>7</td><td>293,407</td><td>1000</td><td>31,275</td><td>3,392.00</td></tr> <tr><td>2022</td><td>2022-660020417</td><td>POND, STEPHEN W-TRUSTEE</td><td>7</td><td>252,023</td><td>1000</td><td>26,723</td><td>3,014.00</td></tr> <tr><td>2021</td><td>2021-660020417</td><td>POND, STEPHEN W-TRUSTEE</td><td>7</td><td>266,718</td><td>1000</td><td>28,339</td><td>3,161.00</td></tr> <tr><td>2020</td><td>2020-660020417</td><td>POND, STEPHEN</td><td>7</td><td>262,409</td><td>1000</td><td>27,693</td><td>3,085.00</td></tr> <tr><td>2019</td><td>2019-660020417</td><td>POND, STEPHEN</td><td>7</td><td>253,244</td><td>1000</td><td>26,857</td><td>2,994.00</td></tr> <tr><td>2018</td><td>2018-660020417</td><td>POND, STEPHEN</td><td>7</td><td>263,916</td><td>1000</td><td>28,031</td><td>3,024.00</td></tr> <tr><td>2017</td><td>2017-660020417</td><td>POND, STEPHEN</td><td>7</td><td>261,821</td><td>1000</td><td>27,800</td><td>3,026.00</td></tr> <tr><td>2016</td><td>2016-660020417</td><td>POND, STEPHEN &</td><td>7</td><td>255,130</td><td>1000</td><td>27,009</td><td>2,943.00</td></tr> <tr><td>2015</td><td>2015-660020417</td><td>POND, STEPHEN &</td><td>7</td><td>247,210</td><td>1000</td><td>26,193</td><td>2,872.00</td></tr> <tr><td>2014</td><td>2014-660020417</td><td>POND, STEPHEN &</td><td>7</td><td>249,575</td><td>1000</td><td>25,735</td><td>2,845.00</td></tr> <tr><td>2013</td><td>2013-660020417</td><td>POND, STEPHEN &</td><td>7</td><td>235,963</td><td>1000</td><td>24,956</td><td>2,709.00</td></tr> </tbody> </table>										Tax Year	Statement Number	Billed Owner	Tax Area	Total Value	Exemptions	Taxable Value	Billed Tax	2025	2025-660020417	POND, STEPHEN W-TRUSTEE	7	399,771	1000	33,240	3,618.00	2024	2024-660020417	POND, STEPHEN W-TRUSTEE	7	381,247	1000	32,243	3,573.00	2023	2023-660020417	POND, STEPHEN W-TRUSTEE	7	293,407	1000	31,275	3,392.00	2022	2022-660020417	POND, STEPHEN W-TRUSTEE	7	252,023	1000	26,723	3,014.00	2021	2021-660020417	POND, STEPHEN W-TRUSTEE	7	266,718	1000	28,339	3,161.00	2020	2020-660020417	POND, STEPHEN	7	262,409	1000	27,693	3,085.00	2019	2019-660020417	POND, STEPHEN	7	253,244	1000	26,857	2,994.00	2018	2018-660020417	POND, STEPHEN	7	263,916	1000	28,031	3,024.00	2017	2017-660020417	POND, STEPHEN	7	261,821	1000	27,800	3,026.00	2016	2016-660020417	POND, STEPHEN &	7	255,130	1000	27,009	2,943.00	2015	2015-660020417	POND, STEPHEN &	7	247,210	1000	26,193	2,872.00	2014	2014-660020417	POND, STEPHEN &	7	249,575	1000	25,735	2,845.00	2013	2013-660020417	POND, STEPHEN &	7	235,963	1000	24,956	2,709.00
Tax Year	Statement Number	Billed Owner	Tax Area	Total Value	Exemptions	Taxable Value	Billed Tax																																																																																																																		
2025	2025-660020417	POND, STEPHEN W-TRUSTEE	7	399,771	1000	33,240	3,618.00																																																																																																																		
2024	2024-660020417	POND, STEPHEN W-TRUSTEE	7	381,247	1000	32,243	3,573.00																																																																																																																		
2023	2023-660020417	POND, STEPHEN W-TRUSTEE	7	293,407	1000	31,275	3,392.00																																																																																																																		
2022	2022-660020417	POND, STEPHEN W-TRUSTEE	7	252,023	1000	26,723	3,014.00																																																																																																																		
2021	2021-660020417	POND, STEPHEN W-TRUSTEE	7	266,718	1000	28,339	3,161.00																																																																																																																		
2020	2020-660020417	POND, STEPHEN	7	262,409	1000	27,693	3,085.00																																																																																																																		
2019	2019-660020417	POND, STEPHEN	7	253,244	1000	26,857	2,994.00																																																																																																																		
2018	2018-660020417	POND, STEPHEN	7	263,916	1000	28,031	3,024.00																																																																																																																		
2017	2017-660020417	POND, STEPHEN	7	261,821	1000	27,800	3,026.00																																																																																																																		
2016	2016-660020417	POND, STEPHEN &	7	255,130	1000	27,009	2,943.00																																																																																																																		
2015	2015-660020417	POND, STEPHEN &	7	247,210	1000	26,193	2,872.00																																																																																																																		
2014	2014-660020417	POND, STEPHEN &	7	249,575	1000	25,735	2,845.00																																																																																																																		
2013	2013-660020417	POND, STEPHEN &	7	235,963	1000	24,956	2,709.00																																																																																																																		



Rogers

Assessment Property Record Card for Tax Year 2026

Data provided by LISA DELOZIER County Assessor

Date 04/16/2026
 Time 22:24:53
 Page 2

Lot Data	Square-Foot - NBHD 1136 #1	Primary Image
Lot Size		
Lot Count		
Units Buildable	1	
Non-Ag Acres	1.122	
Topography		
Street Access		
Utilities		
Amenities	LAND QUALITY	
	0	
	0	
Method	Square-Foot	
Base Lot Value	48,875.00 x 2.21 = 107,873	
Factor Value		
Adjustments	1.0000	
Lot Value	107,873	

Residential Data	
Type	1 Single Family Residence
Condition	3 - Average
Quality	4 - Good
Architecture	
Style	100% Two Story
Exterior Wall	100% Veneer, Stone
Base/Total Area	1,352 / 2,981
Style	100% Two Story
HVAC	100% Warmed & Cooled Air
Roof Cover	1 Composition Shingle
Area on Slab	1,352
Fixture/RghIn	14 /
Bed/F/H Bath	4 / 2.5 /
Basement Area	
Garage Type	680 Attached Garage - Unfinished
Remodel	
Year/Eff Age	1983 / 32



\\tsclient\TCASEY\CASEY BOOTH RESIDENTIAL VI\2022-8-15\ 8/15/2022

GRM Approach	
GRM Code	
Gross Rent	0.00
Indicated Value	

Multiple Regression			
MRA Code	1	Test	
Adusted R	0.8445		
Indicated Value	422,999	141.90	Per SqFt

Direct Comparables			
Selection Model	A	Adam Test	
Adjustment Model	1	2022 Residential	
Comparables	8		
Indicated Value	376,940		Per SqFt

Cost Approach				Manual : 01/2025			
Base Cost	102.46	Total Misc Impr	+	17,274			
Roofing Adj	+ 2.98	Garage Cost	+	31,151			
Subfloor Adj	+ -2.34	Total RCN	=	429,576			
Heat/Cool Adj	+ 16.31	Depreciation (40%)	-	171,830			
Plumbing Adj	+ 8.45	Lump Sums	+	4,223			
Basement Adj	+ 0.00	RCNLD	=	261,969			
Adj Base Cost	= 127.86	Lot Value	+	107,873			
Total Area	x 2,981	Indicated Value	=	369,842			
Adjusted Cost	= 381,151	Value Per SqFt		124.07			

Value Reconciliation			
Selected Approach	Cost Approach		
Improvements	261,969		
Lot Value	107,873		
Indicated Value	369,842	124.07	Per SqFt
Agland Value			
Site Improvements	40,005		
Total Value	409,847	137.49	Total Value Per SqFt

Miscellaneous Improvements								
Code	Description	Sketch ID	Size	Year	Units	Unit Cost	Depr	Value
FPR1	FIREPLACE - RESIDENTIAL 1 STORY	0		1	1	7,243.87		7,244
PRCH	SLAB PORCH - COVERED	50077	18x10		180	32.38		5,828
PATO	SLAB PORCH - OPEN	50078	388		388	10.83		4,202
BALW	BALCONY - WOOD	50079	12x10		120	35.19		4,223



Sketch Image

660020417

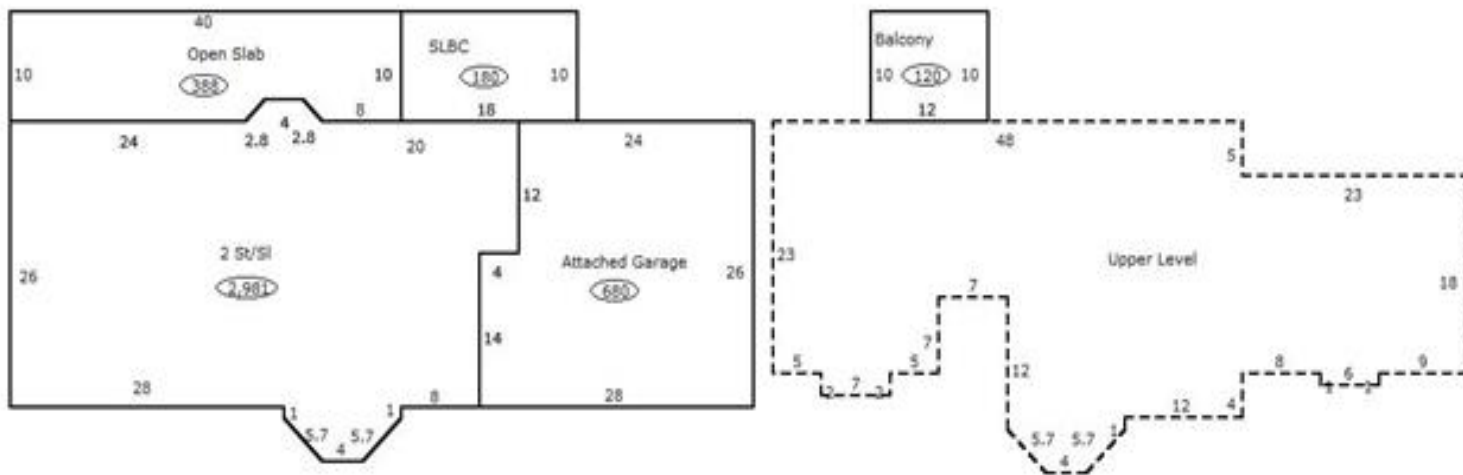

Sketch Vector Information

Sequence	Code	Type	Built Over	Scale	Section Label	Base Area	Multiplier	Total Area
1	R	2	Slab	13	2 St/SI	1,352	2.205	2,981
2	G	1		13	Attached Garage	680	1.000	680
3	M	PRCH		13	SLBC	180	1.000	180
4	M	PATO		13	Open Slab	388	1.000	388
5	M	BALW		13	Balcony	120	1.000	120
6	U	^UL	Overhang	13	Upper Level	1,629	1.000	1,629
Total Building Area						1,352		2,981



Rogers



Assessment Property Record Card for Tax Year 2026

Data provided by LISA DELOZIER County Assessor

Date 04/16/2026
 Time 22:24:53
 Page 4

660020417

Outbuildings/Site Improvements

Building Image	Code	Description	Dimensions	Floor	Roofing	Total Units	
	GRDT	Garage - Detached	32x30x0			960	
	Qual	5	Cond 5	Year 2022	Eff Age 2		
				0			
	Valuation Summary		Modifier Total		RCN	Depr (3% Phys/ % Func)	RCNLD
	Base Cost (42.96 x 960)		41,242		41,242	1,237	40,005
	STF	STG FAIR	12x16x0			192	
	Qual	2	Cond 3	Year	Eff Age 1520		
	Valuation Summary		Modifier Total		RCN	Depr (100% Phys/ % Func)	RCNLD
		Base Cost (4.68 x 192)		899		899	899