



# Rogers

## Assessment Property Record Card for Tax Year 2026

Data provided by LISA DELOZIER County Assessor

Date 04/16/2026  
Time 22:38:35  
Page 1

Assessment Data					Primary Image				
Account	660020432								
Parcel ID	000000-00-0-00306-002-0005								
Cadastral ID	24-21-14-03240								
Property Type	REAL - Real Property								
Property Class	RRP	VI Area 4							
Tax Area	7 - OWASSO/LIMESTONE FIRE								
Name ID	332520								
HOFFMANN, SAMANTHA & ROBERT									
17804 E 92ND ST N OWASSO OK 74055-0000									
Parcel Location									
Situs	17804 E 92ND ST N								
Subdivision	EASTWOOD LAKE ESTATES 5								
Lot/Block	0005 / 0002	Parcel Size 1 - Lots							
Sec/Twn/Rng	24 / 21 / 14 / 5								
Neighborhood	1136 - R-V04-SW OWASSO								
School District	S021 - OWASSO SCHOOLS								
Legal Description Lat/Long: 36.28614635 -95.77414023									
Building Permits									
LOT 5 BLOCK 2 EASTWOOD LAKE ESTS. 5									
Number	Description	Opened	Closed	Amount					
R24 256	NEW DTCH ACC BLDG 30X50	08/2024	12/2024	47,476					
Exemptions									
Code	Type	Active	Maximum	Exemption					
H	Homestead	Yes	1,000	1,000					
Sale History									
Bk/Pg	Grantor	Date	Price	Code					
/	HENDRYX, MARK STEPHEN & SELLER	10/14/2020	257,000	YES					
965/239		07/18/1994	0	No					
Parcel Valuation									
Source	REAL	Fair Cash	Capped	Asmnt Level	Assessed	Levy Rate	108.538	Current Tax	
Remove Cap	2021	Land Value	103,522	59,699	11%	6,567	Assessed	37,404	
Year Frozen	0	Improvements	288,344	280,336		30,837	Penalty	0	
Uncapped Value	0	Mobile Home	0	0		0	Exemption	1,000	
TIF Project ID	0	Total Value	391,866	340,035		37,404	Total Taxable	36,404	
Assessment History									
Tax Year	Statement Number	Billed Owner	Tax Area	Total Value	Exemptions	Taxable Value	Billed Tax		
2025	2025-660020432	HOFFMANN, SAMANTHA &	7	376,185	1000	35,315	3,843.00		
2024	2024-660020432	HOFFMANN, SAMANTHA &	7	356,046	1000	30,779	3,411.00		
2023	2023-660020432	HOFFMANN, SAMANTHA &	7	289,217	1000	29,854	3,239.00		
2022	2022-660020432	HOFFMANN, SAMANTHA &	7	285,508	0	29,955	3,363.00		
2021	2021-660020432	HOFFMANN, SAMANTHA &	7	259,352	0	28,529	3,167.00		
2020	2020-660020432	HENDRYX, MARK STEPHEN &	7	171,219	1000	17,540	1,959.00		
2019	2019-660020432	HENDRYX, MARK STEPHEN &	7	163,634	1000	17,000	1,900.00		
2018	2018-660020432	HENDRYX, MARK STEPHEN &	7	170,083	1000	17,709	1,915.00		
2017	2017-660020432	HENDRYX, MARK STEPHEN &	7	168,776	1000	17,565	1,917.00		
2016	2016-660020432	HENDRYX, MARK STEPHEN &	7	164,860	1000	17,135	1,872.00		
2015	2015-660020432	HENDRYX, MARK STEPHEN &	7	164,107	1000	17,052	1,875.00		
2014	2014-660020432	HENDRYX, MARK STEPHEN &	7	163,552	1000	16,991	1,883.00		
2013	2013-660020432	HENDRYX, MARK STEPHEN &	7	164,410	1000	17,085	1,859.00		



# Rogers

## Assessment Property Record Card for Tax Year 2026

Data provided by LISA DELOZIER County Assessor

Date 04/16/2026  
 Time 22:38:35  
 Page 2

Lot Data	Square-Foot - NBHD 1136 #1	Primary Image
<b>Lot Size</b> <b>Lot Count</b> <b>Units Buildable</b> 1 <b>Non-Ag Acres</b> 1.0388 <b>Topography</b> <b>Street Access</b> <b>Utilities</b> <b>Amenities</b> LAND QUALITY 0 0 <b>Method</b> Square-Foot <b>Base Lot Value</b> 45,249.00 x 2.29 = 103,522 <b>Factor Value</b> <b>Adjustments</b> 1.0000 <b>Lot Value</b> 103,522		

Residential Data	
<b>Type</b>	1 Single Family Residence
<b>Condition</b>	3 - Average
<b>Quality</b>	3 - Average
<b>Architecture</b>	
<b>Style</b>	100% 1 1/2 Story Finished
<b>Exterior Wall</b>	50% Veneer, Masonry 50% Frame, Siding, Wood
<b>Base/Total Area</b>	1,561 / 2,152
<b>Style</b>	100% 1 1/2 Story Finished
<b>HVAC</b>	100% Warmed & Cooled Air
<b>Roof Cover</b>	1 Composition Shingle
<b>Area on Slab</b>	1,561
<b>Fixture/RghIn</b>	14 /
<b>Bed/F/H Bath</b>	3 / 2.5 /
<b>Basement Area</b>	
<b>Garage Type</b>	604 Attached Garage - Unfinished
<b>Remodel</b>	RMA -
<b>Year/Eff Age</b>	1987 / 18



\\tsclient\TCASEY\CASEY BOOTH RESIDENTIAL VI\2022-8-15\ 8/15/2022

GRM Approach	
<b>GRM Code</b>	
<b>Gross Rent</b>	0.00
<b>Indicated Value</b>	

Multiple Regression			
<b>MRA Code</b>	1	Test	
<b>Adusted R</b>	0.8445		
<b>Indicated Value</b>	290,343	134.92	Per SqFt

Direct Comparables			
<b>Selection Model</b>	A	Adam Test	
<b>Adjustment Model</b>	1	2022 Residential	
<b>Comparables</b>	5		
<b>Indicated Value</b>	336,000		Per SqFt

Cost Approach				Manual : 01/2025			
<b>Base Cost</b>	93.51	<b>Total Misc Impr</b>	+ 18,837				
<b>Roofing Adj</b>	+ 3.58	<b>Garage Cost</b>	+ 18,440				
<b>Subfloor Adj</b>	+ -1.67	<b>Total RCN</b>	= 289,341				
<b>Heat/Cool Adj</b>	+ 12.64	<b>Depreciation ( 20%)</b>	- 57,868				
<b>Plumbing Adj</b>	+ 9.07	<b>Lump Sums</b>	+ 12,577				
<b>Basement Adj</b>	+ 0.00	<b>RCNLD</b>	= 244,050				
<b>Adj Base Cost</b>	= 117.13	<b>Lot Value</b>	+ 103,522				
<b>Total Area</b>	x 2,152	<b>Indicated Value</b>	= 347,572				
<b>Adjusted Cost</b>	= 252,064	<b>Value Per SqFt</b>	161.51				

Value Reconciliation			
<b>Selected Approach</b>	Cost Approach		
<b>Improvements</b>	244,050		
<b>Lot Value</b>	103,522		
<b>Indicated Value</b>	347,572	161.51	Per SqFt
<b>Agland Value</b>			
<b>Site Improvements</b>	44,294		
<b>Total Value</b>	391,866	182.09	Total Value Per SqFt

Miscellaneous Improvements								
Code	Description	Sketch ID	Size	Year	Units	Unit Cost	Depr	Value
FPR1	FIREPLACE - RESIDENTIAL 1 STORY	0		1	1	5,615.40		5,615
PRCH	SLAB PORCH - COVERED	50159	522		522	25.33		13,222
WODO	WOOD DECK - OPEN	50160	1499		1,499	16.78	50%	12,577



# Rogers

## Assessment Property Record Card for Tax Year 2026

Data provided by LISA DELOZIER County Assessor

Date 04/16/2026  
 Time 22:38:35  
 Page 3

Sketch Image

660020432

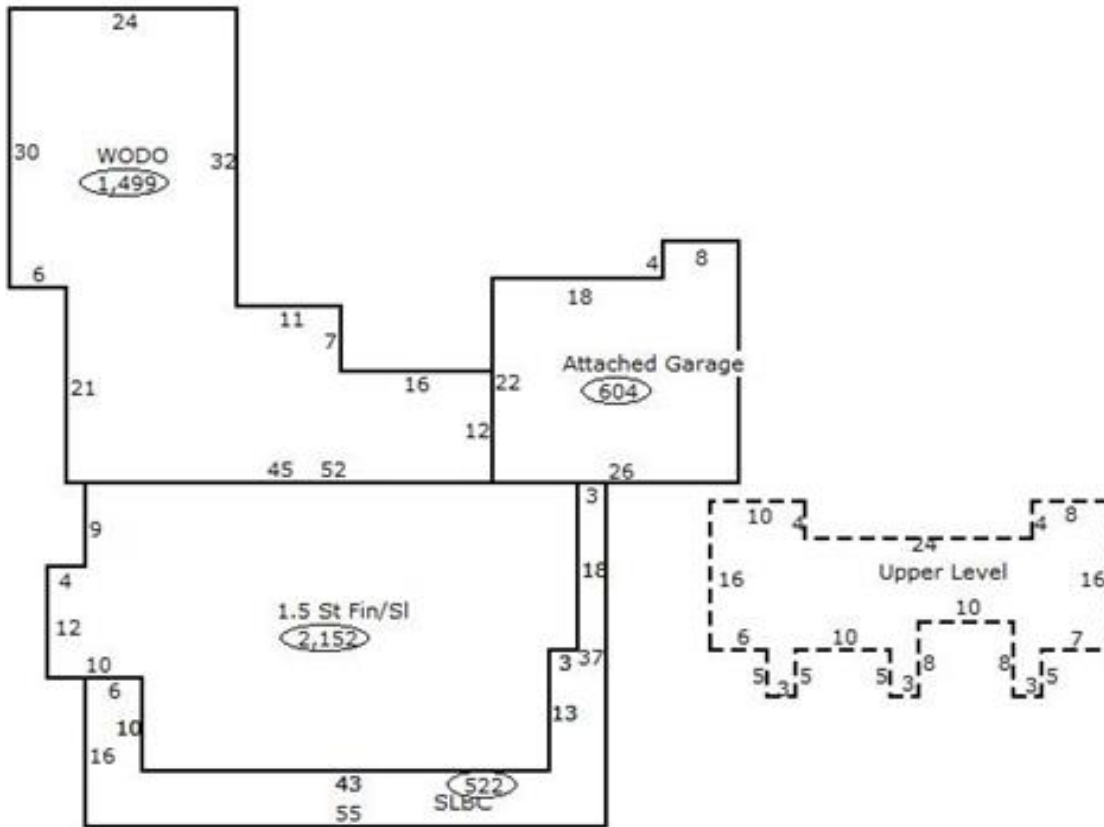

### Sketch Vector Information

Sequence	Code	Type	Built Over	Scale	Section Label	Base Area	Multiplier	Total Area
1	R	5	Slab	20	1.5 St Fin/Sl	1,561	1.379	2,152
2	U	^UL	Overhang	20	Upper Level	591	1.000	591
3	G	1		20	Attached Garage	604	1.000	604
4	M	PRCH		20	SLBC	522	1.000	522
5	M	WODO		20	WODO	1,499	1.000	1,499
<b>Total Building Area</b>						1,561		2,152



# Rogers





## Assessment Property Record Card for Tax Year 2026

Data provided by LISA DELOZIER County Assessor

Date 04/16/2026  
 Time 22:38:35  
 Page 4

660020432

### Outbuildings/Site Improvements

Building Image	Code	Description	Dimensions	Floor	Roofing	Total Units	
	UTIL	Shop Building	30x50x12	Concrete	Formed Metal	1,500	
	Qual	3	Cond 3	Year 2024	Eff Age 2		
	<b>Valuation Summary</b>		<b>Modifier Total</b>	<b>RCN</b>	<b>Depr (3% Phys/ % Func)</b>		<b>RCNLD</b>
	Base Cost (29.64 x 1,500)		44,460		44,460	1,334	43,126
	LT	LEAN-TO	8x50x8	Concrete		400	
	Qual	3	Cond 3	Year 2024	Eff Age		
	<b>Valuation Summary</b>		<b>Modifier Total</b>	<b>RCN</b>	<b>Depr (0% Phys/ % Func)</b>		<b>RCNLD</b>
	Base Cost (2.92 x 400)		1,168		1,168		1,168
	GF	GAZEBO FAIR	16x16x0			1	
	Qual	2	Cond 3	Year	Eff Age		
	<b>Valuation Summary</b>		<b>Modifier Total</b>	<b>RCN</b>	<b>Depr (100% Phys/ % Func)</b>		<b>RCNLD</b>
	Base Cost (2,950.00 x 1)		2,950		2,950	2,950	
	STF	STG FAIR	10x12x0			120	
	Qual	2	Cond 3	Year	Eff Age 1520		
	<b>Valuation Summary</b>		<b>Modifier Total</b>	<b>RCN</b>	<b>Depr (100% Phys/ % Func)</b>		<b>RCNLD</b>
	Base Cost (4.68 x 120)		562		562	562	