



# Rogers

## Assessment Property Record Card for Tax Year 2026

Data provided by LISA DELOZIER County Assessor

Date 04/16/2026  
Time 22:38:46  
Page 1

Assessment Data					Primary Image																																																																																																																				
<b>Account</b> 660020444 <b>Parcel ID</b> 000000-00-0-00306-002-0017 <b>Cadastral ID</b> 24-21-14-03360 <b>Property Type</b> REAL - Real Property <b>Property Class</b> RRP VI Area 4 <b>Tax Area</b> 7 - OWASSO/LIMESTONE FIRE <b>Name ID</b> 336175 PRANGER, STEPHEN W & SHERRY A MORRIS PRANGER  17944 E 93RD ST N OWASSO OK 74055-0000  <b>Parcel Location</b> <b>Situs</b> 17944 E 93RD ST N <b>Subdivision</b> EASTWOOD LAKE ESTATES 5 <b>Lot/Block</b> 0017 / 0002 Parcel Size 1 - Lots <b>Sec/Twn/Rng</b> 24 / 21 / 14 / 5 <b>Neighborhood</b> 1136 - R-V04-SW OWASSO <b>School District</b> S021 - OWASSO SCHOOLS																																																																																																																									
<b>Legal Description</b> Lot/Long: 36.28778017 -95.77239709 LOT 17 BLOCK 2 EASTWOOD LAKE ESTS. 5																																																																																																																									
<b>Exemptions</b> <table border="1"> <thead> <tr> <th>Code</th> <th>Type</th> <th>Active</th> <th>Maximum</th> <th>Exemption</th> </tr> </thead> <tbody> <tr> <td>H</td> <td>Homestead</td> <td>Yes</td> <td>1,000</td> <td>1,000</td> </tr> <tr> <td>H</td> <td>Homestead</td> <td>No</td> <td>1,000</td> <td></td> </tr> </tbody> </table>					Code	Type	Active	Maximum	Exemption	H	Homestead	Yes	1,000	1,000	H	Homestead	No	1,000		<b>Building Permits</b> <table border="1"> <thead> <tr> <th>Number</th> <th>Description</th> <th>Opened</th> <th>Closed</th> <th>Amount</th> </tr> </thead> <tbody> <tr> <td></td> <td></td> <td></td> <td></td> <td></td> </tr> </tbody> </table>					Number	Description	Opened	Closed	Amount																																																																																												
Code	Type	Active	Maximum	Exemption																																																																																																																					
H	Homestead	Yes	1,000	1,000																																																																																																																					
H	Homestead	No	1,000																																																																																																																						
Number	Description	Opened	Closed	Amount																																																																																																																					
<b>Parcel Valuation</b> <table border="1"> <thead> <tr> <th>Source</th> <th>REAL</th> <th>Fair Cash</th> <th>Capped</th> <th>Asmnt Level</th> <th>Assessed</th> <th>Levy Rate</th> <th>108.538</th> <th>Current Tax</th> </tr> </thead> <tbody> <tr> <td>Remove Cap</td> <td>2022</td> <td>Land Value</td> <td>105,976</td> <td>105,976</td> <td>11%</td> <td>11,657</td> <td>Assessed</td> <td>33,707 3,658.49</td> </tr> <tr> <td>Year Frozen</td> <td>0</td> <td>Improvements</td> <td>200,456</td> <td>200,456</td> <td></td> <td>22,050</td> <td>Penalty</td> <td>0</td> </tr> <tr> <td>Uncapped Value</td> <td>0</td> <td>Mobile Home</td> <td>0</td> <td>0</td> <td></td> <td>0</td> <td>Exemption</td> <td>1,000 -97.00</td> </tr> <tr> <td>TIF Project ID</td> <td>0</td> <td>Total Value</td> <td>306,432</td> <td>306,432</td> <td></td> <td>33,707</td> <td>Total Taxable</td> <td>32,707 3,561.00</td> </tr> </tbody> </table>					Source	REAL	Fair Cash	Capped	Asmnt Level	Assessed	Levy Rate	108.538	Current Tax	Remove Cap	2022	Land Value	105,976	105,976	11%	11,657	Assessed	33,707 3,658.49	Year Frozen	0	Improvements	200,456	200,456		22,050	Penalty	0	Uncapped Value	0	Mobile Home	0	0		0	Exemption	1,000 -97.00	TIF Project ID	0	Total Value	306,432	306,432		33,707	Total Taxable	32,707 3,561.00	<b>Sale History</b> <table border="1"> <thead> <tr> <th>Bk/Pg</th> <th>Grantor</th> <th>Date</th> <th>Price</th> <th>Code</th> </tr> </thead> <tbody> <tr> <td>/</td> <td>DUNCAN, DAVID W &amp;</td> <td>10/01/2021</td> <td>319,000</td> <td>YES</td> </tr> <tr> <td>2501/57</td> <td>CURTIS, RONALD G</td> <td>09/18/2015</td> <td>218,000</td> <td>YES</td> </tr> </tbody> </table>					Bk/Pg	Grantor	Date	Price	Code	/	DUNCAN, DAVID W &	10/01/2021	319,000	YES	2501/57	CURTIS, RONALD G	09/18/2015	218,000	YES																																																				
Source	REAL	Fair Cash	Capped	Asmnt Level	Assessed	Levy Rate	108.538	Current Tax																																																																																																																	
Remove Cap	2022	Land Value	105,976	105,976	11%	11,657	Assessed	33,707 3,658.49																																																																																																																	
Year Frozen	0	Improvements	200,456	200,456		22,050	Penalty	0																																																																																																																	
Uncapped Value	0	Mobile Home	0	0		0	Exemption	1,000 -97.00																																																																																																																	
TIF Project ID	0	Total Value	306,432	306,432		33,707	Total Taxable	32,707 3,561.00																																																																																																																	
Bk/Pg	Grantor	Date	Price	Code																																																																																																																					
/	DUNCAN, DAVID W &	10/01/2021	319,000	YES																																																																																																																					
2501/57	CURTIS, RONALD G	09/18/2015	218,000	YES																																																																																																																					
<b>Assessment History</b> <table border="1"> <thead> <tr> <th>Tax Year</th> <th>Statement Number</th> <th>Billed Owner</th> <th>Tax Area</th> <th>Total Value</th> <th>Exemptions</th> <th>Taxable Value</th> <th>Billed Tax</th> </tr> </thead> <tbody> <tr><td>2025</td><td>2025-660020444</td><td>PRANGER, STEPHEN W &amp;</td><td>7</td><td>299,623</td><td>1000</td><td>31,860</td><td>3,469.00</td></tr> <tr><td>2024</td><td>2024-660020444</td><td>PRANGER, STEPHEN W &amp;</td><td>7</td><td>290,031</td><td>1000</td><td>30,903</td><td>3,425.00</td></tr> <tr><td>2023</td><td>2023-660020444</td><td>PRANGER, STEPHEN W &amp;</td><td>7</td><td>319,000</td><td>1000</td><td>34,090</td><td>3,696.00</td></tr> <tr><td>2022</td><td>2022-660020444</td><td>PRANGER, STEPHEN W &amp;</td><td>7</td><td>319,000</td><td>1000</td><td>34,090</td><td>3,841.00</td></tr> <tr><td>2021</td><td>2021-660020444</td><td>DUNCAN, DAVID W &amp;</td><td>7</td><td>232,434</td><td>1000</td><td>24,568</td><td>2,742.00</td></tr> <tr><td>2020</td><td>2020-660020444</td><td>DUNCAN, DAVID W &amp;</td><td>7</td><td>231,039</td><td>1000</td><td>23,988</td><td>2,674.00</td></tr> <tr><td>2019</td><td>2019-660020444</td><td>DUNCAN, DAVID W &amp;</td><td>7</td><td>220,549</td><td>1000</td><td>23,260</td><td>2,595.00</td></tr> <tr><td>2018</td><td>2018-660020444</td><td>DUNCAN, DAVID W &amp;</td><td>7</td><td>226,182</td><td>0</td><td>24,880</td><td>2,671.00</td></tr> <tr><td>2017</td><td>2017-660020444</td><td>DUNCAN, DAVID W &amp;</td><td>7</td><td>224,430</td><td>0</td><td>24,687</td><td>2,675.00</td></tr> <tr><td>2016</td><td>2016-660020444</td><td>DUNCAN, DAVID W &amp;</td><td>7</td><td>219,290</td><td>0</td><td>24,122</td><td>2,615.00</td></tr> <tr><td>2015</td><td>2015-660020444</td><td>DUNCAN, DAVID W &amp;</td><td>7</td><td>197,668</td><td>1000</td><td>20,743</td><td>2,277.00</td></tr> <tr><td>2014</td><td>2014-660020444</td><td>CURTIS, RONALD G</td><td>7</td><td>199,207</td><td>1000</td><td>20,365</td><td>2,254.00</td></tr> <tr><td>2013</td><td>2013-660020444</td><td>CURTIS, RONALD G</td><td>7</td><td>188,572</td><td>1000</td><td>19,743</td><td>2,146.00</td></tr> </tbody> </table>										Tax Year	Statement Number	Billed Owner	Tax Area	Total Value	Exemptions	Taxable Value	Billed Tax	2025	2025-660020444	PRANGER, STEPHEN W &	7	299,623	1000	31,860	3,469.00	2024	2024-660020444	PRANGER, STEPHEN W &	7	290,031	1000	30,903	3,425.00	2023	2023-660020444	PRANGER, STEPHEN W &	7	319,000	1000	34,090	3,696.00	2022	2022-660020444	PRANGER, STEPHEN W &	7	319,000	1000	34,090	3,841.00	2021	2021-660020444	DUNCAN, DAVID W &	7	232,434	1000	24,568	2,742.00	2020	2020-660020444	DUNCAN, DAVID W &	7	231,039	1000	23,988	2,674.00	2019	2019-660020444	DUNCAN, DAVID W &	7	220,549	1000	23,260	2,595.00	2018	2018-660020444	DUNCAN, DAVID W &	7	226,182	0	24,880	2,671.00	2017	2017-660020444	DUNCAN, DAVID W &	7	224,430	0	24,687	2,675.00	2016	2016-660020444	DUNCAN, DAVID W &	7	219,290	0	24,122	2,615.00	2015	2015-660020444	DUNCAN, DAVID W &	7	197,668	1000	20,743	2,277.00	2014	2014-660020444	CURTIS, RONALD G	7	199,207	1000	20,365	2,254.00	2013	2013-660020444	CURTIS, RONALD G	7	188,572	1000	19,743	2,146.00
Tax Year	Statement Number	Billed Owner	Tax Area	Total Value	Exemptions	Taxable Value	Billed Tax																																																																																																																		
2025	2025-660020444	PRANGER, STEPHEN W &	7	299,623	1000	31,860	3,469.00																																																																																																																		
2024	2024-660020444	PRANGER, STEPHEN W &	7	290,031	1000	30,903	3,425.00																																																																																																																		
2023	2023-660020444	PRANGER, STEPHEN W &	7	319,000	1000	34,090	3,696.00																																																																																																																		
2022	2022-660020444	PRANGER, STEPHEN W &	7	319,000	1000	34,090	3,841.00																																																																																																																		
2021	2021-660020444	DUNCAN, DAVID W &	7	232,434	1000	24,568	2,742.00																																																																																																																		
2020	2020-660020444	DUNCAN, DAVID W &	7	231,039	1000	23,988	2,674.00																																																																																																																		
2019	2019-660020444	DUNCAN, DAVID W &	7	220,549	1000	23,260	2,595.00																																																																																																																		
2018	2018-660020444	DUNCAN, DAVID W &	7	226,182	0	24,880	2,671.00																																																																																																																		
2017	2017-660020444	DUNCAN, DAVID W &	7	224,430	0	24,687	2,675.00																																																																																																																		
2016	2016-660020444	DUNCAN, DAVID W &	7	219,290	0	24,122	2,615.00																																																																																																																		
2015	2015-660020444	DUNCAN, DAVID W &	7	197,668	1000	20,743	2,277.00																																																																																																																		
2014	2014-660020444	CURTIS, RONALD G	7	199,207	1000	20,365	2,254.00																																																																																																																		
2013	2013-660020444	CURTIS, RONALD G	7	188,572	1000	19,743	2,146.00																																																																																																																		



# Rogers

## Assessment Property Record Card for Tax Year 2026

Data provided by LISA DELOZIER County Assessor

Date 04/16/2026  
 Time 22:38:47  
 Page 2

Lot Data		Square-Foot - NBHD 1136 #1	
Lot Size			
Lot Count			
Units Buildable	1		
Non-Ag Acres	1.0857		
Topography			
Street Access			
Utilities			
Amenities	LAND QUALITY	0	
		0	
Method	Square-Foot		
Base Lot Value	47,294.00 x 2.24 = 105,976		
Factor Value			
Adjustments	1.0000		
Lot Value	105,976		

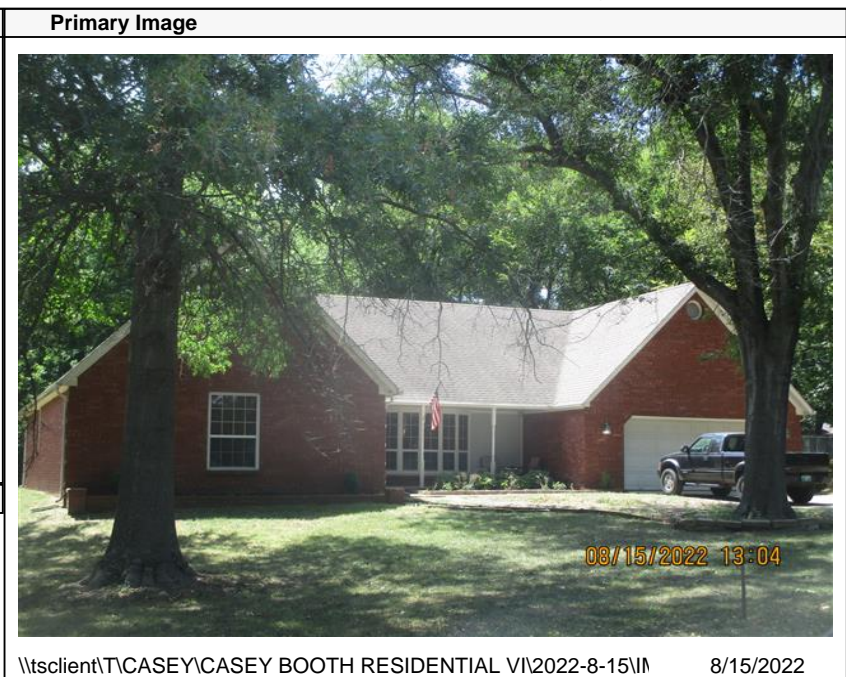

\\tsclient\TCASEY\CASEY BOOTH RESIDENTIAL VI\2022-8-15\ 8/15/2022

Residential Data	
Type	1 Single Family Residence
Condition	3 - Average
Quality	3 - Average
Architecture	
Style	100% 1 1/2 Story Finished
Exterior Wall	100% Veneer, Masonry
Base/Total Area	2,018 / 2,258
Style	100% 1 1/2 Story Finished
HVAC	100% Warmed & Cooled Air
Roof Cover	1 Composition Shingle
Area on Slab	2,018
Fixture/RghIn	14 /
Bed/F/H Bath	3 / 2.5 /
Basement Area	
Garage Type	528 Attached Garage - Unfinished
Remodel	
Year/Eff Age	1987 / 29

### GRM Approach

GRM Code	
Gross Rent	0.00
Indicated Value	

### Multiple Regression

MRA Code	1 Test
Adjusted R	0.8445
Indicated Value	251,272 111.28 Per SqFt

### Direct Comparables

Selection Model	A Adam Test
Adjustment Model	1 2022 Residential
Comparables	8
Indicated Value	319,910 Per SqFt

### Value Reconciliation

Selected Approach	Cost Approach
Improvements	196,244
Lot Value	105,976
Indicated Value	302,220 133.84 Per SqFt
Agland Value	
Site Improvements	4,212
Total Value	306,432 135.71 Total Value Per SqFt

Cost Approach		Manual : 01/2025	
Base Cost	97.66	Total Misc Impr	+ 16,380
Roofing Adj	+ 4.19	Garage Cost	+ 16,627
Subfloor Adj	+ -1.95	Total RCN	= 306,631
Heat/Cool Adj	+ 12.64	Depreciation ( 36%)	- 110,387
Plumbing Adj	+ 8.64	Lump Sums	+ 0
Basement Adj	+ 0.00	RCNLD	= 196,244
Adj Base Cost	= 121.18	Lot Value	+ 105,976
Total Area	x 2,258	Indicated Value	= 302,220
Adjusted Cost	= 273,624	Value Per SqFt	133.84

### Miscellaneous Improvements

Code	Description	Sketch ID	Size	Year	Units	Unit Cost	Depr	Value
FPR1	FIREPLACE - RESIDENTIAL 1 STORY	0		1	1	5,615.40		5,615
PRCH	SLAB PORCH - COVERED	50221	22x7		154	26.45		4,073
EPKS	ENCLOSED PORCH - KNEEWALL SCREEN	50222	21x11		231	28.97		6,692



# Rogers

## Assessment Property Record Card for Tax Year 2026

Data provided by LISA DELOZIER County Assessor

Date 04/16/2026  
 Time 22:38:47  
 Page 3

Sketch Image

660020444

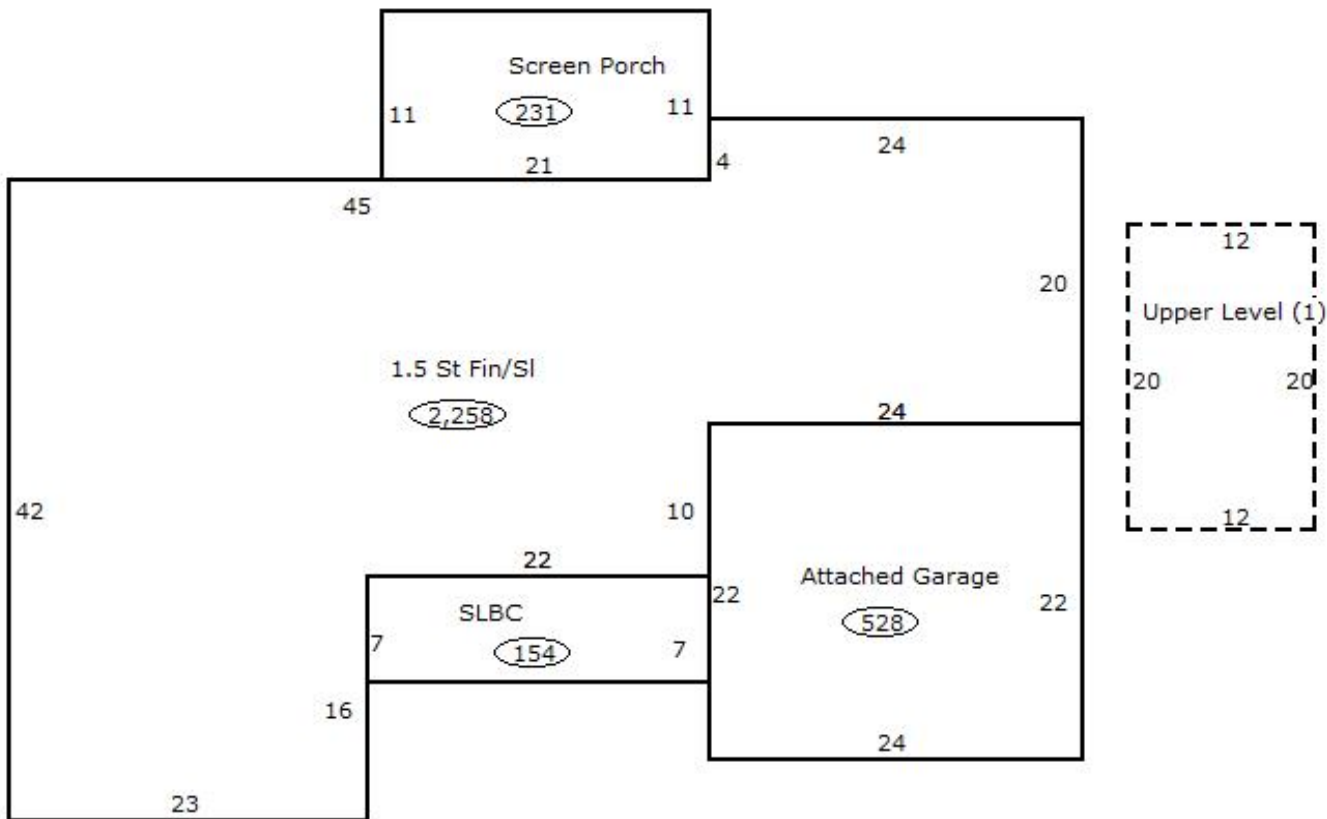

### Sketch Vector Information

Sequence	Code	Type	Built Over	Scale	Section Label	Base Area	Multiplier	Total Area
1	R	5	Slab	13	1.5 St Fin/Sl	2,018	1.119	2,258
2	G	1		13	Attached Garage	528	1.000	528
3	M	PRCH		13	SLBC	154	1.000	154
4	M	EPKS		13	Screen Porch	231	1.000	231
5	U	^UL		13	Upper Level (1)	240	1.000	240
<b>Total Building Area</b>						<b>2,018</b>		<b>2,258</b>



# Rogers

## Assessment Property Record Card for Tax Year 2026

Data provided by LISA DELOZIER County Assessor

Date 04/16/2026  
Time 22:38:47  
Page 4

660020444

### Outbuildings/Site Improvements

Building Image	Code	Description	Dimensions	Floor	Roofing	Total Units	
	STGG	STG GOOD	20x30x0			600	
	Qual	4	Cond 3	Year	Eff Age		
		<b>Valuation Summary</b>	<b>Modifier Total</b>	<b>RCN</b>	<b>Depr (25% Phys/ % Func)</b>	<b>RCNLD</b>	
		Base Cost (9.36 x 600)	5,616		5,616	1,404	4,212