



Rogers

Assessment Property Record Card for Tax Year 2026

Data provided by LISA DELOZIER County Assessor

Date 04/16/2026
Time 22:20:04
Page 1

Assessment Data					Primary Image																																																																																																																				
Account 660020560 Parcel ID 22N15E-24-2-00000-000-0000 Cadastral ID 24-22-15-03200 Property Type REAL - Real Property Property Class RA VI Area 4 Tax Area 10 - OOLOGAH RURAL/NW FIRE Name ID 285788 CRUME, PATRICIA A TRUSTEE 9303 E 445 RD CLAREMORE OK 74017-0000 Parcel Location Situs 09303 E 445 RD Subdivision Lot/Block / Parcel Size 16.52 - Acres Sec/Twn/Rng 24 / 22 / 15 / 2 Neighborhood 6030 - UNPLATTED School District S004 - OOLOGAH SCHOOLS					<p>\\tsclient\T\TOMMY DUNLAP\061721(73)\IMG_0018.JPG 6/17/2022</p>																																																																																																																				
Legal Description Lat/Long: 36.37342733 -95.66162438 SE SE NW & E 88.45' N 161.72' SW SE NW AND S 497.50' E 542.06' SW SE NW.																																																																																																																									
Exemptions <table border="1"> <thead> <tr> <th>Code</th> <th>Type</th> <th>Active</th> <th>Maximum</th> <th>Exemption</th> </tr> </thead> <tbody> <tr> <td>H</td> <td>Homestead</td> <td>Yes</td> <td>1,000</td> <td>1,000</td> </tr> </tbody> </table>					Code	Type	Active	Maximum	Exemption	H	Homestead	Yes	1,000	1,000	Building Permits <table border="1"> <thead> <tr> <th>Number</th> <th>Description</th> <th>Opened</th> <th>Closed</th> <th>Amount</th> </tr> </thead> <tbody> <tr> <td>R18</td> <td>R19-NEW SFR 2100 SQ FT</td> <td>07/2017</td> <td>09/2018</td> <td>188,000</td> </tr> </tbody> </table>					Number	Description	Opened	Closed	Amount	R18	R19-NEW SFR 2100 SQ FT	07/2017	09/2018	188,000																																																																																												
Code	Type	Active	Maximum	Exemption																																																																																																																					
H	Homestead	Yes	1,000	1,000																																																																																																																					
Number	Description	Opened	Closed	Amount																																																																																																																					
R18	R19-NEW SFR 2100 SQ FT	07/2017	09/2018	188,000																																																																																																																					
Parcel Valuation <table border="1"> <thead> <tr> <th>Source</th> <th>REAL</th> <th>Fair Cash</th> <th>Capped</th> <th>Asmnt Level</th> <th>Assessed</th> <th>Levy Rate</th> <th>108.182</th> <th>Current Tax</th> </tr> </thead> <tbody> <tr> <td>Remove Cap</td> <td>0</td> <td>Land Value 3,180</td> <td>2,487</td> <td>11%</td> <td>274</td> <td>Assessed</td> <td>11,290</td> <td>1,221.37</td> </tr> <tr> <td>Year Frozen</td> <td>2005</td> <td>Improvements 128,040</td> <td>100,144</td> <td></td> <td>11,016</td> <td>Penalty</td> <td>0</td> <td></td> </tr> <tr> <td>Uncapped Value</td> <td>0</td> <td>Mobile Home 0</td> <td>0</td> <td></td> <td>0</td> <td>Exemption</td> <td>1,000</td> <td>-94.00</td> </tr> <tr> <td>TIF Project ID</td> <td>0</td> <td>Total Value 131,220</td> <td>102,631</td> <td></td> <td>11,290</td> <td>Total Taxable</td> <td>10,290</td> <td>1,127.00</td> </tr> </tbody> </table>					Source	REAL	Fair Cash	Capped	Asmnt Level	Assessed	Levy Rate	108.182	Current Tax	Remove Cap	0	Land Value 3,180	2,487	11%	274	Assessed	11,290	1,221.37	Year Frozen	2005	Improvements 128,040	100,144		11,016	Penalty	0		Uncapped Value	0	Mobile Home 0	0		0	Exemption	1,000	-94.00	TIF Project ID	0	Total Value 131,220	102,631		11,290	Total Taxable	10,290	1,127.00	Sale History <table border="1"> <thead> <tr> <th>Bk/Pg</th> <th>Grantor</th> <th>Date</th> <th>Price</th> <th>Code</th> </tr> </thead> <tbody> <tr> <td>1585/497</td> <td>CRUME, WILLIAM J &</td> <td>05/05/2004</td> <td></td> <td>0 4</td> </tr> </tbody> </table>					Bk/Pg	Grantor	Date	Price	Code	1585/497	CRUME, WILLIAM J &	05/05/2004		0 4																																																									
Source	REAL	Fair Cash	Capped	Asmnt Level	Assessed	Levy Rate	108.182	Current Tax																																																																																																																	
Remove Cap	0	Land Value 3,180	2,487	11%	274	Assessed	11,290	1,221.37																																																																																																																	
Year Frozen	2005	Improvements 128,040	100,144		11,016	Penalty	0																																																																																																																		
Uncapped Value	0	Mobile Home 0	0		0	Exemption	1,000	-94.00																																																																																																																	
TIF Project ID	0	Total Value 131,220	102,631		11,290	Total Taxable	10,290	1,127.00																																																																																																																	
Bk/Pg	Grantor	Date	Price	Code																																																																																																																					
1585/497	CRUME, WILLIAM J &	05/05/2004		0 4																																																																																																																					
Assessment History <table border="1"> <thead> <tr> <th>Tax Year</th> <th>Statement Number</th> <th>Billed Owner</th> <th>Tax Area</th> <th>Total Value</th> <th>Exemptions</th> <th>Taxable Value</th> <th>Billed Tax</th> </tr> </thead> <tbody> <tr><td>2025</td><td>2025-660020560</td><td>CRUME, PATRICIA A</td><td>10</td><td>104,617</td><td>1000</td><td>10,289</td><td>1,127.00</td></tr> <tr><td>2024</td><td>2024-660020560</td><td>CRUME, PATRICIA A</td><td>10</td><td>110,407</td><td>1000</td><td>10,290</td><td>1,092.00</td></tr> <tr><td>2023</td><td>2023-660020560</td><td>CRUME, PATRICIA A</td><td>10</td><td>209,992</td><td>1000</td><td>10,289</td><td>1,084.00</td></tr> <tr><td>2022</td><td>2022-660020560</td><td>CRUME, PATRICIA A</td><td>10</td><td>208,961</td><td>1000</td><td>10,290</td><td>1,079.00</td></tr> <tr><td>2021</td><td>2021-660020560</td><td>CRUME, PATRICIA A</td><td>10</td><td>166,875</td><td>1000</td><td>10,289</td><td>1,087.00</td></tr> <tr><td>2020</td><td>2020-660020560</td><td>CRUME, PATRICIA A</td><td>10</td><td>163,795</td><td>1000</td><td>10,289</td><td>1,103.00</td></tr> <tr><td>2019</td><td>2019-660020560</td><td>CRUME, PATRICIA A</td><td>10</td><td>155,123</td><td>1000</td><td>10,289</td><td>1,082.00</td></tr> <tr><td>2018</td><td>2018-660020560</td><td>CRUME, PATRICIA A</td><td>10</td><td>162,878</td><td>1000</td><td>10,289</td><td>1,119.00</td></tr> <tr><td>2017</td><td>2017-660020560</td><td>CRUME, PATRICIA A</td><td>10</td><td>161,328</td><td>1000</td><td>10,290</td><td>1,183.00</td></tr> <tr><td>2016</td><td>2016-660020560</td><td>CRUME, PATRICIA A</td><td>10</td><td>155,611</td><td>1000</td><td>10,447</td><td>1,096.00</td></tr> <tr><td>2015</td><td>2015-660020560</td><td>CRUME, PATRICIA A</td><td>10</td><td>149,216</td><td>1000</td><td>10,184</td><td>1,010.00</td></tr> <tr><td>2014</td><td>2014-660020560</td><td>CRUME, PATRICIA A</td><td>10</td><td>157,403</td><td>1000</td><td>10,183</td><td>1,008.00</td></tr> <tr><td>2013</td><td>2013-660020560</td><td>CRUME, PATRICIA A</td><td>10</td><td>151,546</td><td>1000</td><td>10,183</td><td>975.00</td></tr> </tbody> </table>										Tax Year	Statement Number	Billed Owner	Tax Area	Total Value	Exemptions	Taxable Value	Billed Tax	2025	2025-660020560	CRUME, PATRICIA A	10	104,617	1000	10,289	1,127.00	2024	2024-660020560	CRUME, PATRICIA A	10	110,407	1000	10,290	1,092.00	2023	2023-660020560	CRUME, PATRICIA A	10	209,992	1000	10,289	1,084.00	2022	2022-660020560	CRUME, PATRICIA A	10	208,961	1000	10,290	1,079.00	2021	2021-660020560	CRUME, PATRICIA A	10	166,875	1000	10,289	1,087.00	2020	2020-660020560	CRUME, PATRICIA A	10	163,795	1000	10,289	1,103.00	2019	2019-660020560	CRUME, PATRICIA A	10	155,123	1000	10,289	1,082.00	2018	2018-660020560	CRUME, PATRICIA A	10	162,878	1000	10,289	1,119.00	2017	2017-660020560	CRUME, PATRICIA A	10	161,328	1000	10,290	1,183.00	2016	2016-660020560	CRUME, PATRICIA A	10	155,611	1000	10,447	1,096.00	2015	2015-660020560	CRUME, PATRICIA A	10	149,216	1000	10,184	1,010.00	2014	2014-660020560	CRUME, PATRICIA A	10	157,403	1000	10,183	1,008.00	2013	2013-660020560	CRUME, PATRICIA A	10	151,546	1000	10,183	975.00
Tax Year	Statement Number	Billed Owner	Tax Area	Total Value	Exemptions	Taxable Value	Billed Tax																																																																																																																		
2025	2025-660020560	CRUME, PATRICIA A	10	104,617	1000	10,289	1,127.00																																																																																																																		
2024	2024-660020560	CRUME, PATRICIA A	10	110,407	1000	10,290	1,092.00																																																																																																																		
2023	2023-660020560	CRUME, PATRICIA A	10	209,992	1000	10,289	1,084.00																																																																																																																		
2022	2022-660020560	CRUME, PATRICIA A	10	208,961	1000	10,290	1,079.00																																																																																																																		
2021	2021-660020560	CRUME, PATRICIA A	10	166,875	1000	10,289	1,087.00																																																																																																																		
2020	2020-660020560	CRUME, PATRICIA A	10	163,795	1000	10,289	1,103.00																																																																																																																		
2019	2019-660020560	CRUME, PATRICIA A	10	155,123	1000	10,289	1,082.00																																																																																																																		
2018	2018-660020560	CRUME, PATRICIA A	10	162,878	1000	10,289	1,119.00																																																																																																																		
2017	2017-660020560	CRUME, PATRICIA A	10	161,328	1000	10,290	1,183.00																																																																																																																		
2016	2016-660020560	CRUME, PATRICIA A	10	155,611	1000	10,447	1,096.00																																																																																																																		
2015	2015-660020560	CRUME, PATRICIA A	10	149,216	1000	10,184	1,010.00																																																																																																																		
2014	2014-660020560	CRUME, PATRICIA A	10	157,403	1000	10,183	1,008.00																																																																																																																		
2013	2013-660020560	CRUME, PATRICIA A	10	151,546	1000	10,183	975.00																																																																																																																		



Rogers

Assessment Property Record Card for Tax Year 2026

Data provided by LISA DELOZIER County Assessor

Date 04/16/2026
Time 22:20:05
Page 2

Lot Data	Units-Buildable - UNPLATTED (UNITS BUILDABLE)	Primary Image
Lot Size		
Lot Count		
Units Buildable		
Non-Ag Acres	0	
Topography		
Street Access		
Utilities		
Amenities	LAND QUALITY	
Method	Units-Buildable	
Base Lot Value		
Factor Value		
Adjustments		
Lot Value		

Residential Data	
Type	1 Single Family Residence
Condition	3 - Average
Quality	4.5 - Good
Architecture	
Style	100% 1 1/2 Story Finished
Exterior Wall	100% Masonry, Concrete Block
Base/Total Area	3,584 / 4,284
Style	100% 1 1/2 Story Finished
HVAC	100% Warmed & Cooled Air
Roof Cover	1 Composition Shingle
Area on Slab	3,584
Fixture/RghIn	10 /
Bed/F/H Bath	4 / 2.5 /
Basement Area	
Garage Type	296 Attached Garage - Unfinished
Remodel	RMA -
Year/Eff Age	1880 / 110



\\tsclient\T\TOMMY DUNLAP\061721(73)\IMG_0018.JPG 6/17/2022

GRM Approach	
GRM Code	
Gross Rent	0.00
Indicated Value	

Multiple Regression	
MRA Code	
Adjusted R	
Indicated Value	

Direct Comparables	
Selection Model	1 Res
Adjustment Model	A2 AO Test
Comparables	
Indicated Value	

Cost Approach				Manual : 01/2025			
Base Cost	95.25	Total Misc Impr	+ 34,257				
Roofing Adj	+ 4.94	Garage Cost	+ 17,615				
Subfloor Adj	+ -3.60	Total RCN	= 559,612				
Heat/Cool Adj	+ 17.38	Depreciation (80%)	- 447,690				
Plumbing Adj	+ 4.55	Lump Sums	+ 9,667				
Basement Adj	+ 0.00	RCNLD	= 121,589				
Adj Base Cost	= 118.52	Lot Value	+				
Total Area	x 4,284	Indicated Value	= 121,589				
Adjusted Cost	= 507,740	Value Per SqFt	28.38				

Value Reconciliation			
Selected Approach	Cost Approach		
Improvements	121,589		
Lot Value			
Indicated Value	121,589	28.38	Per SqFt
Agland Value	3,180		
Site Improvements	6,451		
Total Value	131,220	30.63	Total Value Per SqFt

Miscellaneous Improvements								
Code	Description	Sketch ID	Size	Year	Units	Unit Cost	Depr	Value
FPR1	FIREPLACE - RESIDENTIAL 1 STORY	0		1	1	7,721.18		7,721
FPR1	FIREPLACE - RESIDENTIAL 1 STORY	0		1	1	7,721.18		7,721
PATO	SLAB PORCH - OPEN	50517		95	95	15.22		1,446
PRCH	SLAB PORCH - COVERED	50518	15x10		150	35.99		5,399
PATO	SLAB PORCH - OPEN	50519		95	95	15.22		1,446
PRCH	SLAB PORCH - COVERED	50520	16x16		256	35.40		9,062
WODO	WOOD DECK - OPEN	50521	18x16		288	23.33	6%	6,316
PRCH	SLAB PORCH - COVERED	50522	8x5		40	36.54		1,462
BALW	BALCONY - WOOD	50523	10x9		90	37.23		3,351



Rogers

Assessment Property Record Card for Tax Year 2026

Data provided by LISA DELOZIER County Assessor

Date 04/16/2026
 Time 22:20:05
 Page 3

Sketch Image

660020560

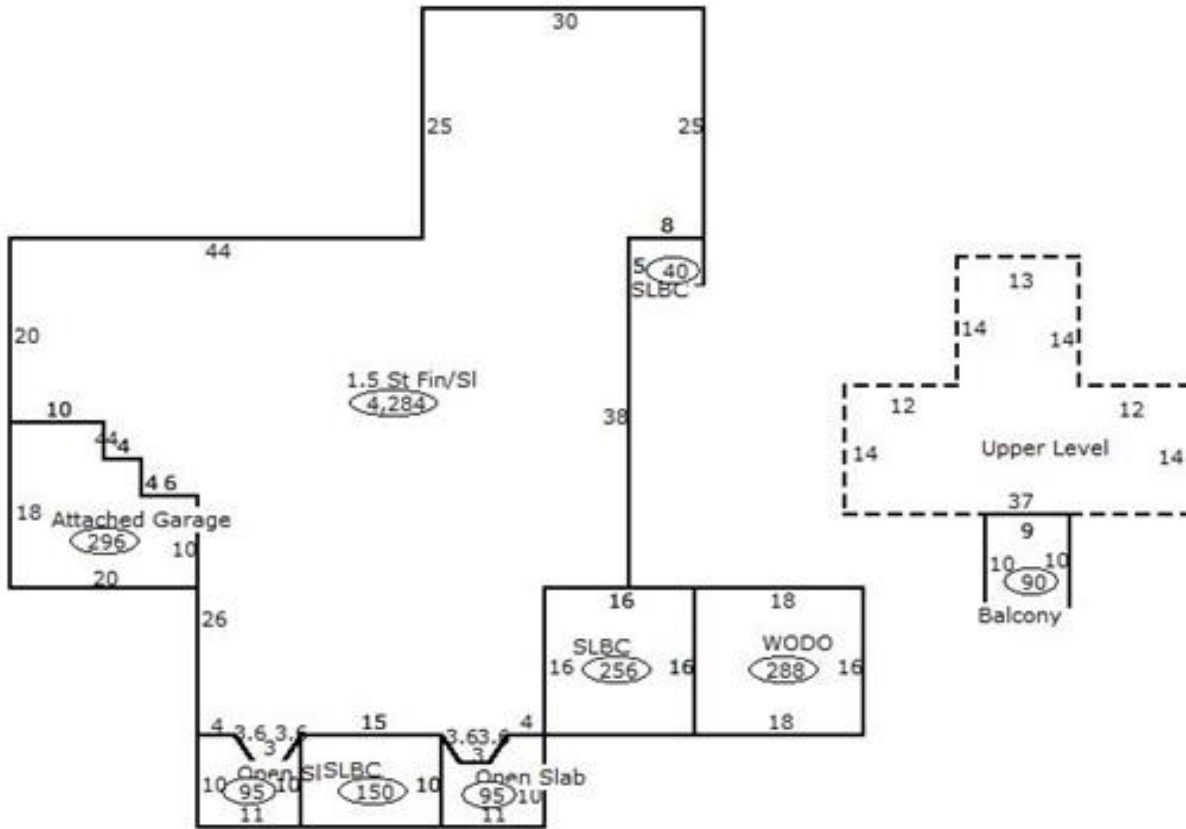

Sketch Vector Information

Sequence	Code	Type	Built Over	Scale	Section Label	Base Area	Multiplier	Total Area
1	R	5	Slab	20	1.5 St Fin/SI	3,584	1.195	4,284
2	G	1		20	Attached Garage	296	1.000	296
3	M	PATO		20	Open Slab	95	1.000	95
4	M	PRCH		20	SLBC	150	1.000	150
5	M	PATO		20	Open Slab	95	1.000	95
6	M	PRCH		20	SLBC	256	1.000	256
7	M	WODO		20	WODO	288	1.000	288
8	M	PRCH		20	SLBC	40	1.000	40
9	M	BALW		20	Balcony	90	1.000	90
10	U	^UL	Overhang	20	Upper Level	700	1.000	700
Total Building Area						3,584		4,284



Rogers

Assessment Property Record Card for Tax Year 2026

Data provided by LISA DELOZIER County Assessor

Date 04/16/2026
Time 22:20:05
Page 4

660020560

Outbuildings/Site Improvements

Building Image	Code	Description	Dimensions	Floor	Roofing	Total Units
	DTGF	DETACHED GARAGE FAIR	0x0x0			672
	Qual 2	Cond 3	Year	Eff Age		
Valuation Summary		Modifier Total	RCN	Depr (40% Phys/ % Func)	RCNLD	
Base Cost (16.00 x 672)		10,752	10,752	4,301	6,451	



Rogers

Assessment Property Record Card for Tax Year 2026

Data provided by LISA DELOZIER County Assessor

Date 04/16/2026
Time 22:20:05
Page 5

Agland Inventory

660020560

Soi	Description	Land Use	LPI	Adj Type	Adj Code	Acres	Use/Acre	Mkt/Acre	Use Value	Market Value
NAB	NEWTONIA SILT LOAM 1-3% S	NTV PST	80			8.430	192	192	1,619	1,619
NTV PST Totals						8.430			1,619	1,619
NAB	NEWTONIA SILT LOAM 1-3% S	IMP PST	80			1.570	224	224	352	352
NAB	NEWTONIA SILT LOAM 1-3% S	IMP PST	80			5.140	224	224	1,151	1,151
SO	SOGN SOILS	IMP PST	15			1.380	42	42	58	58
IMP PST Totals						8.090			1,561	1,561
Total Agland						16.520			3,180	3,180