



# Rogers

## Assessment Property Record Card for Tax Year 2026

Data provided by LISA DELOZIER County Assessor

Date 04/18/2026  
Time 08:13:20  
Page 1

Assessment Data					Primary Image				
Account	660020584								
Parcel ID	22N16E-24-3-00000-000-0000								
Cadastral ID	24-22-16-00900								
Property Type	REAL - Real Property								
Property Class	SCH	VI Area 1							
Tax Area	75 - SEQUOYAH/FOYIL FD								
Name ID	343351								
SEQUOYAH PUBLIC SCHOOLS									
16441 S 4180 RD CLAREMORE OK 74017-0000									
Parcel Location									
Situs	16441 S 4180 RD								
Subdivision									
Lot/Block	/	Parcel Size	104.28 - Acres						
Sec/Twn/Rng	24 / 22 / 16 / 3								
Neighborhood	5558 -								
School District	S006 - SEQUOYAH SCHOOLS								
Legal Description Lat/Long: 36.37468093 -95.55671108									
TR DESC 2023-017191 AS COMM NW/C SEC; N88.3116E 468.99' TO POB; N26.4839E 65'; N72.3155E 100'; N85.2335E 180'; S89.1511E 331 87'; S75.3955E 43.26'; S14.2005W 72.68'; S88.3116W 660.11' TO POB & & THAT PART OF E2 NW LESS N 1188' E 913' THEREOF. & ALL TRACTS CONTAINED IN DESC 2023-017089.									
Building Permits									
Number	Description	Opened	Closed	Amount					
C25 038	REMOVATE ADMIN OFFICE	10/2025	02/2026	650,000					
C25 039	LOCKER ROOM REMODEL	10/2025	02/2026	383,000					
C25 040	REM INDOOR PRACTICE FACILITY	10/2025	02/2026	330,000					
2012-02-2	80 X 60 AG BARN	02/2012	02/2026	70,000					
9872	R7 FOR NEW GYM	01/2006	02/2026	308,569					
9565	R6 FOR NEW VO-AG BLDG	08/2005	10/2005	370,000					
Exemptions									
Code	Type	Active	Maximum	Exemption					
Sale History									
Bk/Pg	Grantor	Date	Price	Code					
/	SCHOOL PROPERTY SEQUOYAH	12/15/2023	0	11					
/	PIERCE, GLORIA J	12/15/2023	0	11					
/	SIXTY-SIX PROPERTIES LLC	11/27/2023	0	11					
1139/210	TIMMONS, GARY KEITH	10/30/1998	26,500	No					
Parcel Valuation									
Source	REAL	Fair Cash	Capped	Asmnt Level	Assessed	Levy Rate	101.310	Current Tax	
Remove Cap	0	Land Value	19,108	0	11%	0	Assessed	0 0.00	
Year Frozen	0	Improvements	30,025,673	0	0	0	Penalty	0 0.00	
Uncapped Value	7,812,753	Mobile Home	0	0	0	0	Exemption	0 0.00	
TIF Project ID	0	Total Value	30,044,781	0	0	0	Total Taxable	0 0.00	
Assessment History									
Tax Year	Statement Number	Billed Owner	Tax Area	Total Value	Exemptions	Taxable Value	Billed Tax		
2025	2025-660020584	SEQUOYAH PUBLIC SCHOOLS	75	19,108	0		.00		
2024	2024-660020584	SEQUOYAH PUBLIC SCHOOLS	75	19,108	0		.00		
2023	2023-660020584	SCHOOL PROPERTY SEQUOYAH	75	51,050	0		.00		
2022	2022-660020584	SCHOOL PROPERTY SEQUOYAH	75	51,050	0		.00		
2021	2021-660020584	SCHOOL PROPERTY SEQUOYAH	75	51,050	0		.00		
2020	2020-660020584	SCHOOL PROPERTY SEQUOYAH	75	51,050	0		.00		
2019	2019-660020584	SCHOOL PROPERTY SEQUOYAH	75	51,050	0		.00		
2018	2018-660020584	SCHOOL PROPERTY SEQUOYAH	75	51,052	0		.00		
2017	2017-660020584	SCHOOL PROPERTY SEQUOYAH	75	51,050	0		.00		
2016	2016-660020584	SCHOOL PROPERTY SEQUOYAH	75	51,052	0		.00		
2015	2015-660020584	SCHOOL PROPERTY SEQUOYAH	75	51,052	0		.00		
2014	2014-660020584	SCHOOL PROPERTY SEQUOYAH	75	51,052	0		.00		
2013	2013-660020584	SCHOOL PROPERTY SEQUOYAH	75	51,052	0		.00		



# Rogers

## Assessment Property Record Card for Tax Year 2026

Data provided by LISA DELOZIER County Assessor

Date 04/18/2026  
 Time 08:13:21  
 Page 2

Lot Data		Units-Buildable - UNPLATTED (UNITS BUILDABLE)		Primary Image				
Lot Size								
Lot Count	0							
Units Buildable	0							
Non-Ag Acres	0							
Topography								
Street Access								
Utilities								
Amenities								
Method	Units-Buildable							
Base Lot Value								
Factor Value								
Adjustments								
Lot Value								
<b>Residential Data</b>								
Type								
Condition	-							
Quality	-							
Architecture								
Style								
Exterior Wall								
Base/Total Area	/			<b>GRM Approach</b>				
Style				GRM Code				
HVAC				Gross Rent	0.00			
Roof Cover				Indicated Value				
Area on Slab				<b>Multiple Regression</b>				
Fixture/RghIn	/			MRA Code				
Bed/F/H Bath	/ /			Adusted R				
Basement Area				Indicated Value				
Garage Type				<b>Direct Comparables</b>				
Remodel				Selection Model				
Year/Eff Age	/			Adjustment Model				
<b>Cost Approach</b>		<b>Manual : 01/2025</b>		Comparables				
Base Cost	0.00	Total Misc Impr	+ 0	Indicated Value				
Roofing Adj	+ 0.00	Garage Cost	+ 0	<b>Value Reconciliation</b>				
Subfloor Adj	+ 0.00	Total RCN	= 0	Selected Approach	Cost Approach			
Heat/Cool Adj	+ 0.00	Depreciation ( 0%)	- 0	Improvements				
Plumbing Adj	+ 0.00	Lump Sums	+ 0	Lot Value				
Basement Adj	+ 0.00	RCNLD	= 0	Indicated Value	0.00 Per SqFt			
Adj Base Cost	= 0.00	Lot Value	+ 0	Agland Value	19,108			
Total Area	x	Indicated Value	= 0	Site Improvements				
Adjusted Cost	= 0	Value Per SqFt	0.00	Total Value	19,108 0.00 Total Value Per SqFt			
<b>Miscellaneous Improvements</b>								
Code	Description	Sketch ID	Size	Year	Units	Unit Cost	Depr	Value



# Rogers

## Assessment Property Record Card for Tax Year 2026

Data provided by LISA DELOZIER County Assessor

Date 04/18/2026  
 Time 08:13:21  
 Page 3

Lot Data		Primary Image	
Lot Size	x		
Lot Count			
Units Buildable			
Non-Ag Acres			
Topography			
Street Access			
Utilities			
Amenities			
Value Model			
Value Method			
Base Lot Value	x .00 =		
Factor Value	0		
Adjustments			
Lot Value			
Cost Approach		Image Information	
Manual Date	01/2025	Image ID	1134847
Total Building Area	201,215	Image Date	1/23/2026
Total Base Value	32,263,327	Name	006.JPG
Modifier Value		Description	660020584_006.JPG
Misc Improvements	130,057		
Replacement Cost New	32,393,384		
Phys/Func Depreciation Loss	()		
RCN Less Phys/Func	27,706,768		
Economic Depreciation			
RCNLD (All Sources)	27,706,768		
Depreciated Improvements			
Outbuilding Value	2,318,905		
Total Improvement Value	30,025,673		
Land Value			
Cost Approach Value	30,025,673	149.22/SqFt	
Income Approach		Value Reconciliation	
Potential Gross Income (PGI)		Selected Valuation Method	Cost Approach
Vacancy & Collection Loss		Total Improvement Value	2,318,905
Miscellaneous Income		Land Value	
Effective Gross Income (EGI)		Total Appraised Value	30,025,673 149.22/SqFt
Total Expenses			
Net Operating Income (NOI)			
Income Capitalization Rate			
Indicated Value	0.00		



# Rogers

## Assessment Property Record Card for Tax Year 2026

Data provided by LISA DELOZIER County Assessor

Date 04/18/2026

Time 08:13:21

Page 4

### Sketch Image

660020584

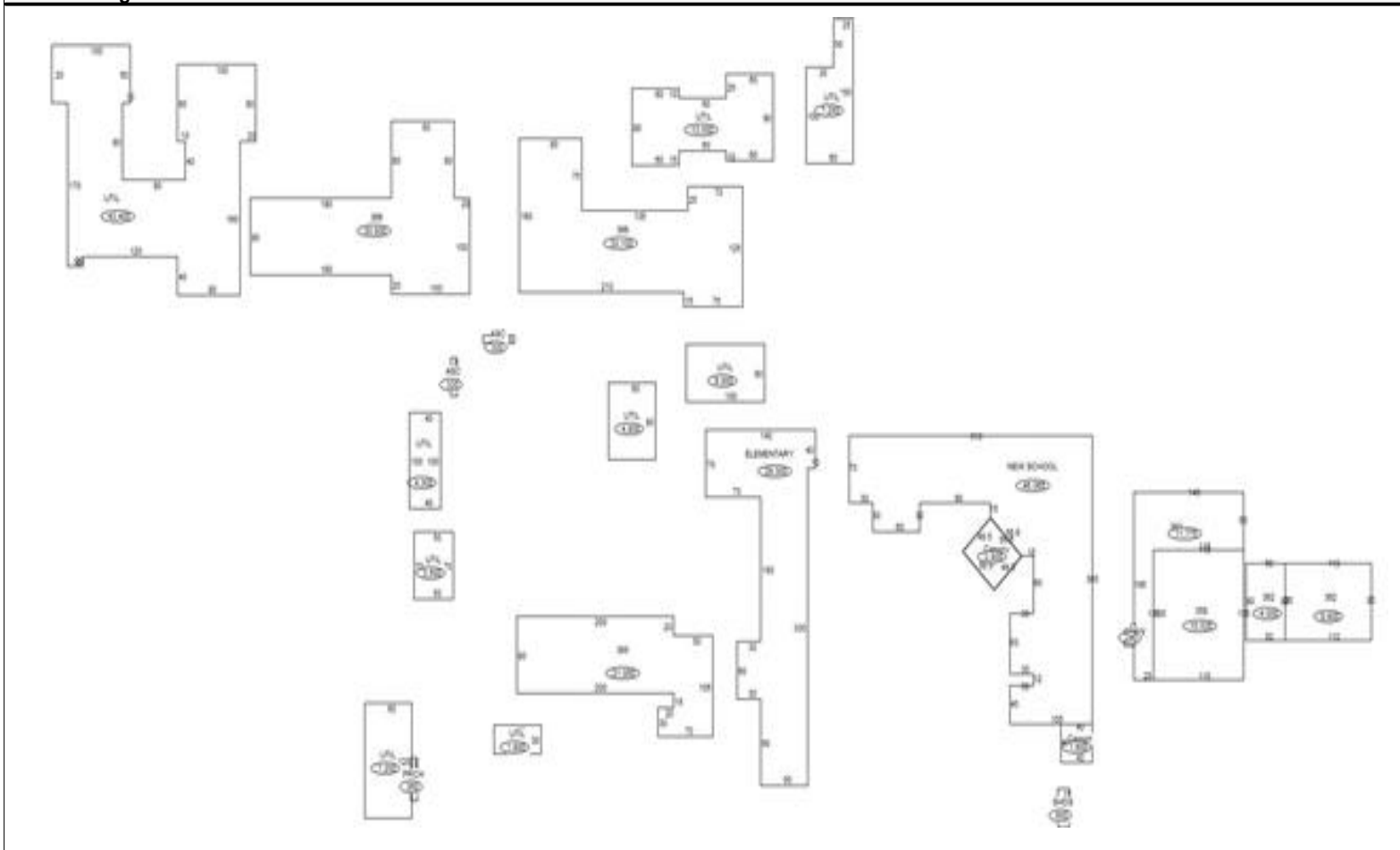

### Sketch Vector Information

Sequence	Code	Type	Built Over	Scale	Section Label	Base Area	Multiplier	Total Area
1	O	UTIL		100	UTIL	4,000	1.000	4,000
2	C	358		100	358	15,525	1.000	15,525
3	C	362		100	362	11,775	1.000	11,775
4	C	362		100	362	4,000	1.000	4,000
5	M	EPSW		100	EPSW	240	1.000	240
6	C	362		100	362	8,800	1.000	8,800
7	C	484		100	NEW SCHOOL	46,065	1.000	46,065
8	M	CNCM		100	Canopy	2,800	1.000	2,800
9	M	CPAT		100	Carport	1,600	1.000	1,600
10	C	365		100	ELEMENTARY	29,300	1.000	29,300
11	C	365		100	365	21,850	1.000	21,850
12	O	UTIL		100	UTIL	6,000	1.000	6,000
13	O	UTIL		100	UTIL	4,800	1.000	4,800
14	O	UTIL		100	UTIL	1,800	1.000	1,800
15	O	SHDS		100	SHDS	600	1.000	600
16	O	UTIL		100	UTIL	7,200	1.000	7,200
17	O	PRCH		100	PRCH	360	1.000	360
18	O	UTIL		100	UTIL	3,500	1.000	3,500
19	O	ASC		100	ASC	320	1.000	320
20	O	ASC		100	ASC	320	1.000	320
21	C	366		100	366	30,800	1.000	30,800
22	C	366		100	366	33,100	1.000	33,100
23	O	UTIL		100	UTIL	7,250	1.000	7,250
24	O	UTIL		100	UTIL	13,500	1.000	13,500
25	O	UTIL		100	UTIL	43,400	1.000	43,400
<b>Total Building Area</b>						<b>201,215</b>		<b>201,215</b>



# Rogers

## Assessment Property Record Card for Tax Year 2026

Data provided by LISA DELOZIER County Assessor

Date 04/18/2026  
Time 08:13:21  
Page 5

Account 660020584  
Parcel ID 22N16E-24-3-00000-000-0000  
Cadastral ID 24-22-16-00900

Tax Area Code 75  
Property Class SCH  
Owners Name SEQUOYAH PUBLIC SCHOOLS

### Building Data

Building ID 5388  
Building Sequence 1  
Occupancy 1 366 Junior High School (Entire) 100%  
Occupancy 2  
Occupancy 3  
Total Floor Area 30,800  
Average Perimeter 920  
Number Of Storys 1.00  
Average Wall Ht 8.00  
Year Built 2000  
Effective Age 13  
Construction Class 2 - Heavier Wood or Steel Stud Frame  
Quality 3 - Average  
Condition 3 - Average  
Exterior Wall 82 - Stud Brick Veneer  
Heating/Cooling 10 - Complete HVAC  
Roof Type Gable  
Roof Cover Metal

Basement Area  
Basement Levels  
Basement Finish  
Finish Code - 1  
Finish Area - 1  
Finish Code - 2  
Finish Area - 2

### Building Image

### Image Information

Image Name  
Image Date  
Image Name  
Description

### Cost Calculations

Appraisal Zone 1  
Zone Description  
Base Cost 121.76  
Wall Cost 13.81  
HVAC Cost 33.77  
Basement Cost 0.00  
Total Base Cost 169.34  
Total Area 30,800  
Base RCN 5,215,672  
Misc Impr Value

Manual Date 01/2025  
Base Year 2026  
Modifier Value  
Total Replacement Cost 5,215,672  
Physical Depreciation 16%  
Functional Depreciation  
Total Depreciation 16% (834,508)  
Total RCNLD 4,381,164  
Lump Sums  
Total Building Value 4,381,164 \$ 142.25 Per SqFt



# Rogers

## Assessment Property Record Card for Tax Year 2026

Data provided by LISA DELOZIER County Assessor

Date 04/18/2026  
Time 08:13:21  
Page 6

Account 660020584  
Parcel ID 22N16E-24-3-00000-000-0000  
Cadastral ID 24-22-16-00900

Tax Area Code 75  
Property Class SCH  
Owners Name SEQUOYAH PUBLIC SCHOOLS

### Building Data

Building ID 5389  
Building Sequence 2  
Occupancy 1 366 Junior High School (Entire) 100%  
Occupancy 2  
Occupancy 3  
Total Floor Area 33,100  
Average Perimeter 970  
Number Of Storys 1.00  
Average Wall Ht 8.00  
Year Built 2000  
Effective Age 13  
Construction Class 2 - Heavier Wood or Steel Stud Frame  
Quality 3 - Average  
Condition 3 - Average  
Exterior Wall 82 - Stud Brick Veneer  
Heating/Cooling 10 - Complete HVAC  
Roof Type Gable  
Roof Cover Metal

Basement Area  
Basement Levels  
Basement Finish  
Finish Code - 1  
Finish Area - 1  
Finish Code - 2  
Finish Area - 2

### Building Image

### Image Information

Image Name  
Image Date  
Image Name  
Description

### Cost Calculations

Appraisal Zone 1  
Zone Description  
Base Cost 121.70  
Wall Cost 13.55  
HVAC Cost 33.77  
Basement Cost 0.00  
Total Base Cost 169.02  
Total Area 33,100  
Base RCN 5,594,562  
Misc Impr Value

Manual Date 01/2025  
Base Year 2026  
Modifier Value  
Total Replacement Cost 5,594,562  
Physical Depreciation 16%  
Functional Depreciation  
Total Depreciation 16% (895,130)  
Total RCNLD 4,699,432  
Lump Sums  
Total Building Value 4,699,432 \$ 141.98 Per SqFt



# Rogers

## Assessment Property Record Card for Tax Year 2026

Data provided by LISA DELOZIER County Assessor

Date 04/18/2026  
 Time 08:13:21  
 Page 7

Account 660020584  
 Parcel ID 22N16E-24-3-00000-000-0000  
 Cadastral ID 24-22-16-00900

Tax Area Code 75  
 Property Class SCH  
 Owners Name SEQUOYAH PUBLIC SCHOOLS

### Building Data

Building ID 5385  
 Building Sequence 3  
 Occupancy 1 365 Elementary School (Entire) 100%  
 Occupancy 2  
 Occupancy 3  
 Total Floor Area 29,300  
 Average Perimeter 1,080  
 Number Of Storys 1.00  
 Average Wall Ht 14.00  
 Year Built 2000  
 Effective Age 13  
 Construction Class 7 - Pre-Engineered Steel Frame  
 Quality 3 - Average  
 Condition 3 - Average  
 Exterior Wall 88 - Stud Metal Siding  
 Heating/Cooling 10 - Complete HVAC  
 Roof Type Gable  
 Roof Cover Metal

Basement Area  
 Basement Levels  
 Basement Finish  
 Finish Code - 1  
 Finish Area - 1  
 Finish Code - 2  
 Finish Area - 2

### Building Image

### Image Information

Image Name  
 Image Date  
 Image Name  
 Description

### Cost Calculations

Appraisal Zone 1  
 Zone Description  
 Base Cost 124.03  
 Wall Cost 10.90  
 HVAC Cost 39.58  
 Basement Cost 0.00  
 Total Base Cost 174.51  
 Total Area 29,300  
 Base RCN 5,113,143  
 Misc Impr Value

Manual Date 01/2025  
 Base Year 2026  
 Modifier Value  
 Total Replacement Cost 5,113,143  
 Physical Depreciation 16%  
 Functional Depreciation  
 Total Depreciation 16% (818,103)  
 Total RCNLD 4,295,040  
 Lump Sums  
 Total Building Value 4,295,040 \$ 146.59 Per SqFt



# Rogers

## Assessment Property Record Card for Tax Year 2026

Data provided by LISA DELOZIER County Assessor

Date 04/18/2026  
Time 08:13:21  
Page 8

Account 660020584  
Parcel ID 22N16E-24-3-00000-000-0000  
Cadastral ID 24-22-16-00900

Tax Area Code 75  
Property Class SCH  
Owners Name SEQUOYAH PUBLIC SCHOOLS

### Building Data

Building ID 5386  
Building Sequence 4  
Occupancy 1 365 Elementary School (Entire) 100%  
Occupancy 2  
Occupancy 3  
Total Floor Area 21,850  
Average Perimeter 790  
Number Of Storys 1.00  
Average Wall Ht 10.00  
Year Built 2000  
Effective Age 13  
Construction Class 7 - Pre-Engineered Steel Frame  
Quality 3 - Average  
Condition 3 - Average  
Exterior Wall 88 - Stud Metal Siding  
Heating/Cooling 10 - Complete HVAC  
Roof Type Gable  
Roof Cover Metal

Basement Area  
Basement Levels  
Basement Finish  
Finish Code - 1  
Finish Area - 1  
Finish Code - 2  
Finish Area - 2

### Building Image

### Image Information

Image Name  
Image Date  
Image Name  
Description

### Cost Calculations

Appraisal Zone 1  
Zone Description  
Base Cost 124.04  
Wall Cost 7.83  
HVAC Cost 39.58  
Basement Cost 0.00  
Total Base Cost 171.45  
Total Area 21,850  
Base RCN 3,746,183  
Misc Impr Value

Manual Date 01/2025  
Base Year 2026  
Modifier Value  
Total Replacement Cost 3,746,183  
Physical Depreciation 16%  
Functional Depreciation  
Total Depreciation 16% (599,389)  
Total RCNLD 3,146,794  
Lump Sums  
Total Building Value 3,146,794 \$ 144.02 Per SqFt





# Rogers

## Assessment Property Record Card for Tax Year 2026

Data provided by LISA DELOZIER County Assessor

Date 04/18/2026  
Time 08:13:21  
Page 10

Account 660020584  
Parcel ID 22N16E-24-3-00000-000-0000  
Cadastral ID 24-22-16-00900

Tax Area Code 75  
Property Class SCH  
Owners Name SEQUOYAH PUBLIC SCHOOLS

### Building Data

Building ID 5381  
Building Sequence 6  
Occupancy 1 358 Gymnasium (School) 100%  
Occupancy 2  
Occupancy 3  
Total Floor Area 15,525  
Average Perimeter 500  
Number Of Storys 1.00  
Average Wall Ht 20.00  
Year Built 2000  
Effective Age 13  
Construction Class 7 - Pre-Engineered Steel Frame  
Quality 2 - Fair  
Condition 3 - Average  
Exterior Wall 88 - Stud Metal Siding  
Heating/Cooling 10 - Complete HVAC  
Roof Type Gable  
Roof Cover Metal

Basement Area  
Basement Levels  
Basement Finish  
Finish Code - 1  
Finish Area - 1  
Finish Code - 2  
Finish Area - 2

### Building Image

### Image Information

Image Name  
Image Date  
Image Name  
Description

### Cost Calculations

Appraisal Zone 1  
Zone Description  
Base Cost 76.52  
Wall Cost 12.02  
HVAC Cost 25.10  
Basement Cost 0.00  
Total Base Cost 113.64  
Total Area 15,525  
Base RCN 1,764,261  
Misc Impr Value

Manual Date 01/2025  
Base Year 2026  
Modifier Value  
Total Replacement Cost 1,764,261  
Physical Depreciation 29%  
Functional Depreciation  
Total Depreciation 29% (511,636)  
Total RCNLD 1,252,625  
Lump Sums  
Total Building Value 1,252,625 \$ 80.68 Per SqFt



# Rogers

## Assessment Property Record Card for Tax Year 2026

Data provided by LISA DELOZIER County Assessor

Date 04/18/2026  
Time 08:13:21  
Page 11

Account 660020584  
Parcel ID 22N16E-24-3-00000-000-0000  
Cadastral ID 24-22-16-00900

Tax Area Code 75  
Property Class SCH  
Owners Name SEQUOYAH PUBLIC SCHOOLS

### Building Data

Building ID 5382  
Building Sequence 7  
Occupancy 1 362 Multi-Purpose Bldg (School) 100%  
Occupancy 2  
Occupancy 3  
Total Floor Area 4,000  
Average Perimeter 260  
Number Of Storys 1.00  
Average Wall Ht 10.00  
Year Built 2000  
Effective Age 13  
Construction Class 7 - Pre-Engineered Steel Frame  
Quality 1.5 - Low  
Condition 3 - Average  
Exterior Wall 88 - Stud Metal Siding  
Heating/Cooling 10 - Complete HVAC  
Roof Type Gable  
Roof Cover Metal

Basement Area  
Basement Levels  
Basement Finish  
Finish Code - 1  
Finish Area - 1  
Finish Code - 2  
Finish Area - 2

### Building Image

### Image Information

Image Name  
Image Date  
Image Name  
Description

### Cost Calculations

Appraisal Zone 1  
Zone Description  
Base Cost 81.94  
Wall Cost 12.24  
HVAC Cost 35.95  
Basement Cost 0.00  
Total Base Cost 130.13  
Total Area 4,000  
Base RCN 520,520  
Misc Impr Value

Manual Date 01/2025  
Base Year 2026  
Modifier Value  
Total Replacement Cost 520,520  
Physical Depreciation 29%  
Functional Depreciation  
Total Depreciation 29% (150,951)  
Total RCNLD 369,569  
Lump Sums  
Total Building Value 369,569 \$ 92.39 Per SqFt



# Rogers

## Assessment Property Record Card for Tax Year 2026

Data provided by LISA DELOZIER County Assessor

Date 04/18/2026  
Time 08:13:21  
Page 12

Account 660020584  
Parcel ID 22N16E-24-3-00000-000-0000  
Cadastral ID 24-22-16-00900

Tax Area Code 75  
Property Class SCH  
Owners Name SEQUOYAH PUBLIC SCHOOLS

### Building Data

Building ID 5383  
Building Sequence 8  
Occupancy 1 362 Multi-Purpose Bldg (School) 100%  
Occupancy 2  
Occupancy 3  
Total Floor Area 8,800  
Average Perimeter 380  
Number Of Storys 1.00  
Average Wall Ht 20.00  
Year Built 2000  
Effective Age 13  
Construction Class 7 - Pre-Engineered Steel Frame  
Quality 1.5 - Low  
Condition 3 - Average  
Exterior Wall 88 - Stud Metal Siding  
Heating/Cooling 10 - Complete HVAC  
Roof Type Gable  
Roof Cover Metal

Basement Area  
Basement Levels  
Basement Finish  
Finish Code - 1  
Finish Area - 1  
Finish Code - 2  
Finish Area - 2

### Building Image

### Image Information

Image Name  
Image Date  
Image Name  
Description

### Cost Calculations

Appraisal Zone 1  
Zone Description  
Base Cost 79.61  
Wall Cost 15.58  
HVAC Cost 35.95  
Basement Cost 0.00  
Total Base Cost 131.14  
Total Area 8,800  
Base RCN 1,154,032  
Misc Impr Value

Manual Date 01/2025  
Base Year 2026  
Modifier Value  
Total Replacement Cost 1,154,032  
Physical Depreciation 29%  
Functional Depreciation  
Total Depreciation 29% (334,669)  
Total RCNLD 819,363  
Lump Sums  
Total Building Value 819,363 \$ 93.11 Per SqFt



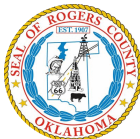

# Rogers

## Assessment Property Record Card for Tax Year 2026

Data provided by LISA DELOZIER County Assessor

Date 04/18/2026

Time 08:13:21

Page 14

660020584

### Outbuildings/Site Improvements

Building Image	Code	Description	Dimensions	Floor	Roofing	Total Units
SHDS	Shed - Small		15x40x10	Concrete	Formed Metal	600
<b>Qual</b>	6	<b>Cond</b> 3	<b>Year</b> 2026	<b>Eff Age</b> 0		
<b>Valuation Summary</b>		<b>Modifier Total</b>		<b>RCN</b>	<b>Depr (% Phys/ % Func)</b>	<b>RCNLD</b>
Base Cost (32.31 x 600)				19,386		19,386
UTIL	Utility Building		60x120x14	Concrete	Formed Metal	7,200
<b>Qual</b>	3	<b>Cond</b> 3	<b>Year</b> 2024	<b>Eff Age</b> 2		
<b>Valuation Summary</b>		<b>Modifier Total</b>		<b>RCN</b>	<b>Depr (% Phys/ % Func)</b>	<b>RCNLD</b>
Base Cost (26.02 x 7,200)				187,344	5,620	181,724
PRCH	Porch		8x45x8	Concrete	Formed Metal	360
<b>Qual</b>	3	<b>Cond</b> 3	<b>Year</b> 2024	<b>Eff Age</b> 2		
<b>Valuation Summary</b>		<b>Modifier Total</b>		<b>RCN</b>	<b>Depr (% Phys/ % Func)</b>	<b>RCNLD</b>
Base Cost (25.80 x 360)				9,288	929	8,359
UTIL	Utility Building		40x100x12	Concrete	Formed Metal	4,000
<b>Qual</b>	3	<b>Cond</b> 3	<b>Year</b> 2020	<b>Eff Age</b> 5		
<b>Valuation Summary</b>		<b>Modifier Total</b>		<b>RCN</b>	<b>Depr (% Phys/ % Func)</b>	<b>RCNLD</b>
Base Cost (25.71 x 4,000)				102,840	9,256	93,584
UTIL	Utility Building		50x70x12	Concrete	Formed Metal	3,500
<b>Qual</b>	3	<b>Cond</b> 3	<b>Year</b> 2020	<b>Eff Age</b> 5		
<b>Valuation Summary</b>		<b>Modifier Total</b>		<b>RCN</b>	<b>Depr (% Phys/ % Func)</b>	<b>RCNLD</b>
Base Cost (26.13 x 3,500)				91,455	8,231	83,224
ASC	Awing/Shelter/Carport		8x40x8	Dirt	Formed Metal	320
<b>Qual</b>	3	<b>Cond</b> 3	<b>Year</b> 2018	<b>Eff Age</b> 6		
<b>Valuation Summary</b>		<b>Modifier Total</b>		<b>RCN</b>	<b>Depr (% Phys/ % Func)</b>	<b>RCNLD</b>
Base Cost (4.56 x 320)				1,459	350	1,109
UTIL	Utility Building		0x0x14	Concrete	Formed Metal	7,250
<b>Qual</b>	3	<b>Cond</b> 3	<b>Year</b> 2018	<b>Eff Age</b> 6		
<b>Valuation Summary</b>		<b>Modifier Total</b>		<b>RCN</b>	<b>Depr (% Phys/ % Func)</b>	<b>RCNLD</b>
Base Cost (22.94 x 7,250)		180,737		347,052	38,176	308,876
Interior Finish (Residential)		Finished Area	Fixture Count			180,737

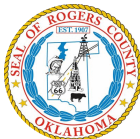

# Rogers

## Assessment Property Record Card for Tax Year 2026

Data provided by LISA DELOZIER County Assessor

Date 04/18/2026  
Time 08:13:21  
Page 15

UTIL	Utility Building FINISHED			0x0x14	Concrete	Formed Metal	13,500
<b>Qual</b>	3	<b>Cond</b>	3	<b>Year</b>	2018	<b>Eff Age</b>	6
Interior Finish (Residential)		Finished Area	500	Fixture Count			186,580

Valuation Summary		Modifier Total	RCN	Depr (% Phys/ % Func)	RCNLD
Base Cost (22.27 x 13,500)		186,580	487,225	53,595	433,630

ASC	Awning/Shelter/Carport			8x40x8	Dirt	Formed Metal	320
<b>Qual</b>	3	<b>Cond</b>	3	<b>Year</b>	2018	<b>Eff Age</b>	6

Valuation Summary		Modifier Total	RCN	Depr (% Phys/ % Func)	RCNLD
Base Cost (4.56 x 320)			1,459	350	1,109

UTIL	Utility Building FINISHED			0x0x14	Concrete	Formed Metal	43,400
<b>Qual</b>	3	<b>Cond</b>	3	<b>Year</b>	2018	<b>Eff Age</b>	6
Interior Finish (Residential)		Finished Area	500	Fixture Count			186,580

Valuation Summary		Modifier Total	RCN	Depr (% Phys/ % Func)	RCNLD
Base Cost (22.27 x 43,400)		186,580	1,153,098	126,841	1,026,257

UTIL	Utility Building			60x100x12	Concrete	Formed Metal	6,000
<b>Qual</b>	3	<b>Cond</b>	3	<b>Year</b>	2000	<b>Eff Age</b>	20

Valuation Summary		Modifier Total	RCN	Depr (% Phys/ % Func)	RCNLD
Base Cost (23.83 x 6,000)			142,980	70,060	72,920

UTIL	Utility Building			60x30x12	Concrete	Formed Metal	1,800
<b>Qual</b>	3	<b>Cond</b>	3	<b>Year</b>	2000	<b>Eff Age</b>	20

Valuation Summary		Modifier Total	RCN	Depr (% Phys/ % Func)	RCNLD
Base Cost (29.96 x 1,800)			53,928	26,425	27,503

UTIL	Utility Building			60x80x12	Concrete	Formed Metal	4,800
<b>Qual</b>	3	<b>Cond</b>	3	<b>Year</b>	2000	<b>Eff Age</b>	20

Valuation Summary		Modifier Total	RCN	Depr (% Phys/ % Func)	RCNLD
Base Cost (25.01 x 4,800)			120,048	58,824	61,224

**Total Site Improvement Value 2,318,905**



# Rogers

## Assessment Property Record Card for Tax Year 2026

Data provided by LISA DELOZIER County Assessor

Date 04/18/2026  
 Time 08:13:21  
 Page 16

### Agland Inventory

660020584

Soi	Description	Land Use	LPI	Adj Type	Adj Code	Acres	Use/Acre	Mkt/Acre	Use Value	Market Value
DBC	DENNIS-BATES COMPLEX 2-5%	NTV PST	60			10.000	144	144	1,440	1,440
DBC	DENNIS-BATES COMPLEX 2-5%	NTV PST	60	0		17.660	144	144	2,543	2,543
DNB	DENNIS SILT LOAM 1-3% SLO	NTV PST	80	0		31.770	192	192	6,100	6,100
DNB	DENNIS SILT LOAM 1-3% SLO	NTV PST	80			1.000	192	192	192	192
DNB	DENNIS SILT LOAM 1-3% SLO	NTV PST	80			1.780	192	192	342	342
DNB	DENNIS SILT LOAM 1-3% SLO	NTV PST	80	0		17.000	192	192	3,264	3,264
OKB	OKEMAH SILTY CLAY LOAM 1-	NTV PST	80	0		.500	192	192	96	96
SUB	SUMMIT SILTY CLAY LOAM 1-	NTV PST	78			10.000	187	187	1,872	1,872
<b>NTV PST Totals</b>						89.710			15,849	15,849
BC	BATES-COLLINSVILLE COMPLE	IMP PST	51	0		.050	143	143	7	7
DNB	DENNIS SILT LOAM 1-3% SLO	IMP PST	80	0		3.720	224	224	833	833
OKB	OKEMAH SILTY CLAY LOAM 1-	IMP PST	80	0		10.800	224	224	2,419	2,419
<b>IMP PST Totals</b>						14.570			3,259	3,259
<b>Total Agland</b>						104.280			19,108	19,108