



# Rogers

## Assessment Property Record Card for Tax Year 2026

Data provided by LISA DELOZIER County Assessor

Date 04/16/2026  
Time 23:05:03  
Page 1

Assessment Data					Primary Image																																																																																																																				
<b>Account</b> 660020631 <b>Parcel ID</b> 000000-00-0-00144-002-0007 <b>Cadastral ID</b> 24-22-17-00860 <b>Property Type</b> REAL - Real Property <b>Property Class</b> RRP VI Area 2 <b>Tax Area</b> 94 - SEQUOYAH/TRI-DISTRICT FI <b>Name ID</b> 267599 MORELAND, HENRY MARCUS &  ANNETTE C 21114 E 440 RD CLAREMORE OK 74017-0000  <b>Parcel Location</b> <b>Situs</b> 21114 E 440 RD <b>Subdivision</b> CEDARCREST <b>Lot/Block</b> 0007 / 0002 <b>Parcel Size</b> 1 - Lots <b>Sec/Twn/Rng</b> 24 / 22 / 17 / 5 <b>Neighborhood</b> 1015 - R-V02-NE SEQUOYAH <b>School District</b> S006 - SEQUOYAH SCHOOLS					<p>\\tsclient\TCASEY\CASEY BOOTH VISUAL INSPECTION\2020-1' 11/19/2020</p>																																																																																																																				
<b>Legal Description</b> Lot/Long: 36.37889197 -95.45064168 LOT 7 BLOCK 2 CEDARCREST																																																																																																																									
<b>Exemptions</b> <table border="1"> <thead> <tr> <th>Code</th> <th>Type</th> <th>Active</th> <th>Maximum</th> <th>Exemption</th> </tr> </thead> <tbody> <tr> <td>H</td> <td>Homestead</td> <td>Yes</td> <td>1,000</td> <td>1,000</td> </tr> </tbody> </table>					Code	Type	Active	Maximum	Exemption	H	Homestead	Yes	1,000	1,000	<b>Building Permits</b> <table border="1"> <thead> <tr> <th>Number</th> <th>Description</th> <th>Opened</th> <th>Closed</th> <th>Amount</th> </tr> </thead> <tbody> <tr> <td>R19</td> <td>R20- NEW SHOP</td> <td>04/2019</td> <td>06/2019</td> <td></td> </tr> </tbody> </table>					Number	Description	Opened	Closed	Amount	R19	R20- NEW SHOP	04/2019	06/2019																																																																																													
Code	Type	Active	Maximum	Exemption																																																																																																																					
H	Homestead	Yes	1,000	1,000																																																																																																																					
Number	Description	Opened	Closed	Amount																																																																																																																					
R19	R20- NEW SHOP	04/2019	06/2019																																																																																																																						
<b>Parcel Valuation</b> <table border="1"> <thead> <tr> <th>Source</th> <th>REAL</th> <th>Fair Cash</th> <th>Capped</th> <th>Asmnt Level</th> <th>Assessed</th> <th>Levy Rate</th> <th>98.320</th> <th>Current Tax</th> </tr> </thead> <tbody> <tr> <td>Remove Cap</td> <td>1999</td> <td>Land Value 41,462</td> <td>31,427</td> <td>11%</td> <td>3,457</td> <td>Assessed</td> <td>16,605</td> <td>1,632.60</td> </tr> <tr> <td>Year Frozen</td> <td>0</td> <td>Improvements 186,404</td> <td>119,526</td> <td></td> <td>13,148</td> <td>Penalty</td> <td>0</td> <td></td> </tr> <tr> <td>Uncapped Value</td> <td>0</td> <td>Mobile Home 0</td> <td>0</td> <td></td> <td>0</td> <td>Exemption</td> <td>1,000</td> <td>-89.00</td> </tr> <tr> <td>TIF Project ID</td> <td>0</td> <td>Total Value 227,866</td> <td>150,953</td> <td></td> <td>16,605</td> <td>Total Taxable</td> <td>15,605</td> <td>1,544.00</td> </tr> </tbody> </table>					Source	REAL	Fair Cash	Capped	Asmnt Level	Assessed	Levy Rate	98.320	Current Tax	Remove Cap	1999	Land Value 41,462	31,427	11%	3,457	Assessed	16,605	1,632.60	Year Frozen	0	Improvements 186,404	119,526		13,148	Penalty	0		Uncapped Value	0	Mobile Home 0	0		0	Exemption	1,000	-89.00	TIF Project ID	0	Total Value 227,866	150,953		16,605	Total Taxable	15,605	1,544.00	<b>Sale History</b> <table border="1"> <thead> <tr> <th>Bk/Pg</th> <th>Grantor</th> <th>Date</th> <th>Price</th> <th>Code</th> </tr> </thead> <tbody> <tr> <td>1097/843</td> <td>MORELAND, SALLY</td> <td>02/06/1998</td> <td></td> <td>0 No</td> </tr> </tbody> </table>					Bk/Pg	Grantor	Date	Price	Code	1097/843	MORELAND, SALLY	02/06/1998		0 No																																																									
Source	REAL	Fair Cash	Capped	Asmnt Level	Assessed	Levy Rate	98.320	Current Tax																																																																																																																	
Remove Cap	1999	Land Value 41,462	31,427	11%	3,457	Assessed	16,605	1,632.60																																																																																																																	
Year Frozen	0	Improvements 186,404	119,526		13,148	Penalty	0																																																																																																																		
Uncapped Value	0	Mobile Home 0	0		0	Exemption	1,000	-89.00																																																																																																																	
TIF Project ID	0	Total Value 227,866	150,953		16,605	Total Taxable	15,605	1,544.00																																																																																																																	
Bk/Pg	Grantor	Date	Price	Code																																																																																																																					
1097/843	MORELAND, SALLY	02/06/1998		0 No																																																																																																																					
<b>Assessment History</b> <table border="1"> <thead> <tr> <th>Tax Year</th> <th>Statement Number</th> <th>Billed Owner</th> <th>Tax Area</th> <th>Total Value</th> <th>Exemptions</th> <th>Taxable Value</th> <th>Billed Tax</th> </tr> </thead> <tbody> <tr><td>2025</td><td>2025-660020631</td><td>MORELAND, HENRY MARCUS &amp;</td><td>94</td><td>212,131</td><td>1000</td><td>15,121</td><td>1,496.00</td></tr> <tr><td>2024</td><td>2024-660020631</td><td>MORELAND, HENRY MARCUS &amp;</td><td>94</td><td>191,645</td><td>1000</td><td>14,652</td><td>1,549.00</td></tr> <tr><td>2023</td><td>2023-660020631</td><td>MORELAND, HENRY MARCUS &amp;</td><td>94</td><td>162,948</td><td>1000</td><td>14,196</td><td>1,532.00</td></tr> <tr><td>2022</td><td>2022-660020631</td><td>MORELAND, HENRY MARCUS &amp;</td><td>94</td><td>164,366</td><td>1000</td><td>13,753</td><td>1,498.00</td></tr> <tr><td>2021</td><td>2021-660020631</td><td>MORELAND, HENRY MARCUS &amp;</td><td>94</td><td>163,033</td><td>1000</td><td>13,324</td><td>1,404.00</td></tr> <tr><td>2020</td><td>2020-660020631</td><td>MORELAND, HENRY MARCUS &amp;</td><td>94</td><td>160,294</td><td>1000</td><td>12,907</td><td>1,356.00</td></tr> <tr><td>2019</td><td>2019-660020631</td><td>MORELAND, HENRY MARCUS &amp;</td><td>94</td><td>128,504</td><td>1000</td><td>9,613</td><td>999.00</td></tr> <tr><td>2018</td><td>2018-660020631</td><td>MORELAND, HENRY MARCUS &amp;</td><td>94</td><td>132,692</td><td>1000</td><td>9,303</td><td>977.00</td></tr> <tr><td>2017</td><td>2017-660020631</td><td>MORELAND, HENRY MARCUS &amp;</td><td>94</td><td>131,739</td><td>1000</td><td>9,003</td><td>934.00</td></tr> <tr><td>2016</td><td>2016-660020631</td><td>MORELAND, HENRY MARCUS &amp;</td><td>94</td><td>128,673</td><td>1000</td><td>8,712</td><td>900.00</td></tr> <tr><td>2015</td><td>2015-660020631</td><td>MORELAND, HENRY MARCUS &amp;</td><td>94</td><td>126,576</td><td>1000</td><td>8,430</td><td>890.00</td></tr> <tr><td>2014</td><td>2014-660020631</td><td>MORELAND, HENRY MARCUS &amp;</td><td>94</td><td>127,471</td><td>1000</td><td>8,155</td><td>844.00</td></tr> <tr><td>2013</td><td>2013-660020631</td><td>MORELAND, HENRY MARCUS &amp;</td><td>94</td><td>120,774</td><td>1000</td><td>7,888</td><td>805.00</td></tr> </tbody> </table>										Tax Year	Statement Number	Billed Owner	Tax Area	Total Value	Exemptions	Taxable Value	Billed Tax	2025	2025-660020631	MORELAND, HENRY MARCUS &	94	212,131	1000	15,121	1,496.00	2024	2024-660020631	MORELAND, HENRY MARCUS &	94	191,645	1000	14,652	1,549.00	2023	2023-660020631	MORELAND, HENRY MARCUS &	94	162,948	1000	14,196	1,532.00	2022	2022-660020631	MORELAND, HENRY MARCUS &	94	164,366	1000	13,753	1,498.00	2021	2021-660020631	MORELAND, HENRY MARCUS &	94	163,033	1000	13,324	1,404.00	2020	2020-660020631	MORELAND, HENRY MARCUS &	94	160,294	1000	12,907	1,356.00	2019	2019-660020631	MORELAND, HENRY MARCUS &	94	128,504	1000	9,613	999.00	2018	2018-660020631	MORELAND, HENRY MARCUS &	94	132,692	1000	9,303	977.00	2017	2017-660020631	MORELAND, HENRY MARCUS &	94	131,739	1000	9,003	934.00	2016	2016-660020631	MORELAND, HENRY MARCUS &	94	128,673	1000	8,712	900.00	2015	2015-660020631	MORELAND, HENRY MARCUS &	94	126,576	1000	8,430	890.00	2014	2014-660020631	MORELAND, HENRY MARCUS &	94	127,471	1000	8,155	844.00	2013	2013-660020631	MORELAND, HENRY MARCUS &	94	120,774	1000	7,888	805.00
Tax Year	Statement Number	Billed Owner	Tax Area	Total Value	Exemptions	Taxable Value	Billed Tax																																																																																																																		
2025	2025-660020631	MORELAND, HENRY MARCUS &	94	212,131	1000	15,121	1,496.00																																																																																																																		
2024	2024-660020631	MORELAND, HENRY MARCUS &	94	191,645	1000	14,652	1,549.00																																																																																																																		
2023	2023-660020631	MORELAND, HENRY MARCUS &	94	162,948	1000	14,196	1,532.00																																																																																																																		
2022	2022-660020631	MORELAND, HENRY MARCUS &	94	164,366	1000	13,753	1,498.00																																																																																																																		
2021	2021-660020631	MORELAND, HENRY MARCUS &	94	163,033	1000	13,324	1,404.00																																																																																																																		
2020	2020-660020631	MORELAND, HENRY MARCUS &	94	160,294	1000	12,907	1,356.00																																																																																																																		
2019	2019-660020631	MORELAND, HENRY MARCUS &	94	128,504	1000	9,613	999.00																																																																																																																		
2018	2018-660020631	MORELAND, HENRY MARCUS &	94	132,692	1000	9,303	977.00																																																																																																																		
2017	2017-660020631	MORELAND, HENRY MARCUS &	94	131,739	1000	9,003	934.00																																																																																																																		
2016	2016-660020631	MORELAND, HENRY MARCUS &	94	128,673	1000	8,712	900.00																																																																																																																		
2015	2015-660020631	MORELAND, HENRY MARCUS &	94	126,576	1000	8,430	890.00																																																																																																																		
2014	2014-660020631	MORELAND, HENRY MARCUS &	94	127,471	1000	8,155	844.00																																																																																																																		
2013	2013-660020631	MORELAND, HENRY MARCUS &	94	120,774	1000	7,888	805.00																																																																																																																		



# Rogers

## Assessment Property Record Card for Tax Year 2026

Data provided by LISA DELOZIER County Assessor

Date 04/16/2026  
 Time 23:05:03  
 Page 2

Lot Data	Square-Foot - NBHD 1015 #1	Primary Image
<b>Lot Size</b> <b>Lot Count</b> <b>Units Buildable</b> 14000 <b>Non-Ag Acres</b> 5.0183 <b>Topography</b> <b>Street Access</b> <b>Utilities</b> <b>Amenities</b> LAND QUALITY 0 0 <b>Method</b> Square-Foot <b>Base Lot Value</b> 218,596.00 x .19 = 41,462 <b>Factor Value</b> <b>Adjustments</b> 1.0000 <b>Lot Value</b> 41,462		<p>11/19/2020 10-23</p> <p>\\tsclient\TCASEY\CASEY BOOTH VISUAL INSPECTION\2020-1' 11/19/2020</p>

Residential Data	
<b>Type</b>	1 Single Family Residence
<b>Condition</b>	3 - Average
<b>Quality</b>	3 - Average
<b>Architecture</b>	TRAD TRADITIONAL
<b>Style</b>	100% One Story
<b>Exterior Wall</b>	100% Frame, Siding, Wood
<b>Base/Total Area</b>	1,374 / 1,374
<b>Style</b>	100% One Story
<b>HVAC</b>	100% Floor Furnace
<b>Roof Cover</b>	1 Composition Shingle
<b>Area on Slab</b>	0
<b>Fixture/RghIn</b>	11 /
<b>Bed/F/H Bath</b>	3 / 2.0 /
<b>Basement Area</b>	
<b>Garage Type</b>	672 Attached Garage - Unfinished
<b>Remodel</b>	
<b>Year/Eff Age</b>	1999 / 20



\\tsclient\TCASEY\CASEY BOOTH VISUAL INSPECTION\2020-1' 11/19/2020

GRM Approach	
<b>GRM Code</b>	
<b>Gross Rent</b>	0.00
<b>Indicated Value</b>	

Multiple Regression			
<b>MRA Code</b>	1	Test	
<b>Adusted R</b>	0.8445		
<b>Indicated Value</b>	252,864	184.03	Per SqFt

Direct Comparables	
<b>Selection Model</b>	A Adam Test
<b>Adjustment Model</b>	1 2022 Residential
<b>Comparables</b>	
<b>Indicated Value</b>	

Cost Approach				Manual : 01/2025	
<b>Base Cost</b>	100.66	<b>Total Misc Impr</b>	+	918	
<b>Roofing Adj</b>	+ 4.76	<b>Garage Cost</b>	+	20,220	
<b>Subfloor Adj</b>	+ 0.00	<b>Total RCN</b>	=	184,287	
<b>Heat/Cool Adj</b>	+ 2.03	<b>Depreciation ( 23%)</b>	-	42,386	
<b>Plumbing Adj</b>	+ 11.29	<b>Lump Sums</b>	+	0	
<b>Basement Adj</b>	+ 0.00	<b>RCNLD</b>	=	141,901	
<b>Adj Base Cost</b>	= 118.74	<b>Lot Value</b>	+	41,462	
<b>Total Area</b>	x 1,374	<b>Indicated Value</b>	=	183,363	
<b>Adjusted Cost</b>	= 163,149	<b>Value Per SqFt</b>		133.45	

Value Reconciliation			
<b>Selected Approach</b>	Cost Approach		
<b>Improvements</b>	141,901		
<b>Lot Value</b>	41,462		
<b>Indicated Value</b>	183,363	133.45	Per SqFt
<b>Agland Value</b>			
<b>Site Improvements</b>	44,503		
<b>Total Value</b>	227,866	165.84	Total Value Per SqFt

Miscellaneous Improvements								
Code	Description	Sketch ID	Size	Year	Units	Unit Cost	Depr	Value
PATO	SLAB PORCH - OPEN	148506	16x5		80	11.48		918



# Rogers

## Assessment Property Record Card for Tax Year 2026

Data provided by LISA DELOZIER County Assessor

Date 04/16/2026

Time 23:05:03

Page 3

### Sketch Image

660020631

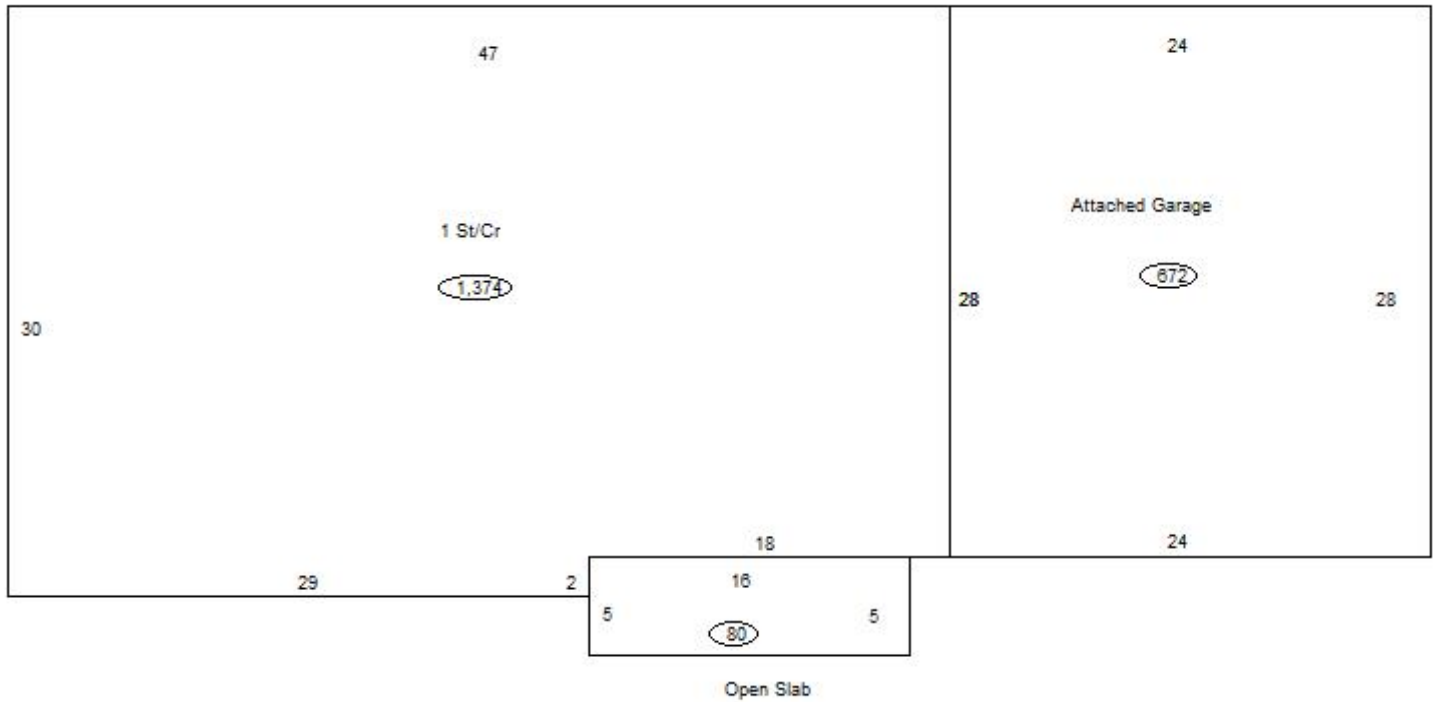

### Sketch Vector Information

Sequence	Code	Type	Built Over	Scale	Section Label	Base Area	Multiplier	Total Area
1	R	1	Crawl	10	1 St/Cr	1,374	1.000	1,374
2	G	1		10	Attached Garage	672	1.000	672
3	M	PATO		10	Open Slab	80	1.000	80
<b>Total Building Area</b>						1,374		1,374



# Rogers





## Assessment Property Record Card for Tax Year 2026

Data provided by LISA DELOZIER County Assessor

Date 04/16/2026  
 Time 23:05:03  
 Page 4

660020631

### Outbuildings/Site Improvements

Building Image	Code	Description	Dimensions	Floor	Roofing	Total Units
	UTIL	Shop Building	40x30x8	Concrete	Galvanized Metal	1,200
	Qual	3.5	Cond 3	Year 2019	Eff Age 5	
	<b>Valuation Summary</b>		<b>Modifier Total</b>	<b>RCN</b>	<b>Depr (9% Phys/ % Func)</b>	
	Base Cost (34.60 x 1,200)		41,520	41,520	3,737	37,783
	LNT0	LEAN-TO	40x10x8	Gravel	Galvanized Metal	400
	Qual	3	Cond 3	Year 2019	Eff Age 5	
	<b>Valuation Summary</b>		<b>Modifier Total</b>	<b>RCN</b>	<b>Depr (31% Phys/ % Func)</b>	
	Base Cost (10.37 x 400)		4,148	4,148	1,286	2,862
	LNT0	LEAN TO - ATTACHED	30x20x8		Galvanized Metal	600
	Qual	3	Cond 3	Year 2019	Eff Age 5	
	<b>Valuation Summary</b>		<b>Modifier Total</b>	<b>RCN</b>	<b>Depr (31% Phys/ % Func)</b>	
	Base Cost (9.32 x 600)		5,592	5,592	1,734	3,858
	CP	CARPORT DIRT	24x10x6	Gravel		240
	Qual	3	Cond 3	Year 2015	Eff Age	
	<b>Valuation Summary</b>		<b>Modifier Total</b>	<b>RCN</b>	<b>Depr (100% Phys/ % Func)</b>	
	Base Cost (3.50 x 240)		840	840	840	