



# Rogers

## Assessment Property Record Card for Tax Year 2026

Data provided by LISA DELOZIER County Assessor

Date 04/18/2026  
Time 05:35:20  
Page 1

Assessment Data					Primary Image																																																																																																																
<b>Account</b> 660021015 <b>Parcel ID</b> 22N16E-25-3-00000-000-0000 <b>Cadastral ID</b> 25-22-16-00500 <b>Property Type</b> REAL - Real Property <b>Property Class</b> RA VI Area 1 <b>Tax Area</b> 94 - SEQUOYAH/TRI-DISTRICT FI <b>Name ID</b> 39804 SMALLEY, MICHAEL P  17611 S 4180 RD CLAREMORE OK 74017-0000  <b>Parcel Location</b> <b>Situs</b> 17611 S 4180 RD <b>Subdivision</b> <b>Lot/Block</b> / <b>Parcel Size</b> 17.5 - Acres <b>Sec/Twn/Rng</b> 25 / 22 / 16 / 3 <b>Neighborhood</b> 2116 - UNPLATTED <b>School District</b> S006 - SEQUOYAH SCHOOLS																																																																																																																					
<b>Legal Description</b> Lat/Long: 36.35724162 -95.55859205																																																																																																																					
<b>Legal Description</b> N2 NW SW LESS AND EXCEPT THE W 521.77', N 208.71', S 238.71', THEREOF.					<b>Building Permits</b>																																																																																																																
					<table border="1"> <thead> <tr> <th>Number</th> <th>Description</th> <th>Opened</th> <th>Closed</th> <th>Amount</th> </tr> </thead> <tbody> <tr> <td>R18</td> <td>R20-POSS. SOMETHING NEW</td> <td>05/2008</td> <td>11/2019</td> <td></td> </tr> </tbody> </table>	Number	Description	Opened	Closed	Amount	R18	R20-POSS. SOMETHING NEW	05/2008	11/2019																																																																																																							
Number	Description	Opened	Closed	Amount																																																																																																																	
R18	R20-POSS. SOMETHING NEW	05/2008	11/2019																																																																																																																		
<b>Exemptions</b>					<b>Sale History</b>																																																																																																																
<table border="1"> <thead> <tr> <th>Code</th> <th>Type</th> <th>Active</th> <th>Maximum</th> <th>Exemption</th> </tr> </thead> <tbody> <tr> <td>H</td> <td>Homestead</td> <td>Yes</td> <td>1,000</td> <td>1,000</td> </tr> </tbody> </table>	Code	Type	Active	Maximum	Exemption	H	Homestead	Yes	1,000	1,000	<table border="1"> <thead> <tr> <th>Bk/Pg</th> <th>Grantor</th> <th>Date</th> <th>Price</th> <th>Code</th> </tr> </thead> <tbody> </tbody> </table>					Bk/Pg	Grantor	Date	Price	Code																																																																																																	
Code	Type	Active	Maximum	Exemption																																																																																																																	
H	Homestead	Yes	1,000	1,000																																																																																																																	
Bk/Pg	Grantor	Date	Price	Code																																																																																																																	
<b>Parcel Valuation</b>																																																																																																																					
<table border="1"> <thead> <tr> <th>Source</th> <th>REAL</th> <th>Fair Cash</th> <th>Capped</th> <th>Asmnt Level</th> <th>Assessed</th> <th>Levy Rate</th> <th>98.320</th> <th>Current Tax</th> </tr> </thead> <tbody> <tr> <td>Remove Cap</td> <td>0</td> <td>Land Value 2,520</td> <td>2,520</td> <td>11%</td> <td>277</td> <td>Assessed</td> <td>20,664</td> <td>2,031.68</td> </tr> <tr> <td>Year Frozen</td> <td>0</td> <td>Improvements 205,885</td> <td>185,339</td> <td></td> <td>20,387</td> <td>Penalty</td> <td>0</td> <td></td> </tr> <tr> <td>Uncapped Value</td> <td>0</td> <td>Mobile Home 0</td> <td>0</td> <td></td> <td>0</td> <td>Exemption</td> <td>1,000</td> <td>-89.00</td> </tr> <tr> <td>TIF Project ID</td> <td>0</td> <td>Total Value 208,405</td> <td>187,859</td> <td></td> <td>20,664</td> <td>Total Taxable</td> <td>19,664</td> <td>1,943.00</td> </tr> </tbody> </table>	Source	REAL	Fair Cash	Capped	Asmnt Level	Assessed	Levy Rate	98.320	Current Tax	Remove Cap	0	Land Value 2,520	2,520	11%	277	Assessed	20,664	2,031.68	Year Frozen	0	Improvements 205,885	185,339		20,387	Penalty	0		Uncapped Value	0	Mobile Home 0	0		0	Exemption	1,000	-89.00	TIF Project ID	0	Total Value 208,405	187,859		20,664	Total Taxable	19,664	1,943.00																																																																								
Source	REAL	Fair Cash	Capped	Asmnt Level	Assessed	Levy Rate	98.320	Current Tax																																																																																																													
Remove Cap	0	Land Value 2,520	2,520	11%	277	Assessed	20,664	2,031.68																																																																																																													
Year Frozen	0	Improvements 205,885	185,339		20,387	Penalty	0																																																																																																														
Uncapped Value	0	Mobile Home 0	0		0	Exemption	1,000	-89.00																																																																																																													
TIF Project ID	0	Total Value 208,405	187,859		20,664	Total Taxable	19,664	1,943.00																																																																																																													
<b>Assessment History</b>																																																																																																																					
<table border="1"> <thead> <tr> <th>Tax Year</th> <th>Statement Number</th> <th>Billed Owner</th> <th>Tax Area</th> <th>Total Value</th> <th>Exemptions</th> <th>Taxable Value</th> <th>Billed Tax</th> </tr> </thead> <tbody> <tr><td>2025</td><td>2025-660021015</td><td>SMALLEY, MICHAEL P</td><td>94</td><td>195,534</td><td>1000</td><td>19,062</td><td>1,885.00</td></tr> <tr><td>2024</td><td>2024-660021015</td><td>SMALLEY, MICHAEL P</td><td>94</td><td>183,172</td><td>1000</td><td>18,478</td><td>1,951.00</td></tr> <tr><td>2023</td><td>2023-660021015</td><td>SMALLEY, MICHAEL P</td><td>94</td><td>171,919</td><td>1000</td><td>17,911</td><td>1,929.00</td></tr> <tr><td>2022</td><td>2022-660021015</td><td>SMALLEY, MICHAEL P</td><td>94</td><td>172,431</td><td>1000</td><td>17,967</td><td>1,952.00</td></tr> <tr><td>2021</td><td>2021-660021015</td><td>SMALLEY, MICHAEL P</td><td>94</td><td>172,801</td><td>1000</td><td>18,008</td><td>1,892.00</td></tr> <tr><td>2020</td><td>2020-660021015</td><td>SMALLEY, MICHAEL P</td><td>94</td><td>169,772</td><td>1000</td><td>17,675</td><td>1,852.00</td></tr> <tr><td>2019</td><td>2019-660021015</td><td>SMALLEY, MICHAEL P</td><td>94</td><td>87,903</td><td>1000</td><td>8,669</td><td>902.00</td></tr> <tr><td>2018</td><td>2018-660021015</td><td>SMALLEY, MICHAEL P</td><td>94</td><td>88,344</td><td>1000</td><td>8,249</td><td>868.00</td></tr> <tr><td>2017</td><td>2017-660021015</td><td>SMALLEY, MICHAEL P</td><td>94</td><td>87,572</td><td>1000</td><td>7,980</td><td>829.00</td></tr> <tr><td>2016</td><td>2016-660021015</td><td>SMALLEY, MICHAEL P</td><td>94</td><td>85,325</td><td>1000</td><td>7,718</td><td>799.00</td></tr> <tr><td>2015</td><td>2015-660021015</td><td>SMALLEY, MICHAEL P</td><td>94</td><td>80,065</td><td>1000</td><td>7,465</td><td>789.00</td></tr> <tr><td>2014</td><td>2014-660021015</td><td>SMALLEY, MICHAEL P</td><td>94</td><td>80,861</td><td>1000</td><td>7,218</td><td>748.00</td></tr> <tr><td>2013</td><td>2013-660021015</td><td>SMALLEY, MICHAEL P</td><td>94</td><td>76,596</td><td>1000</td><td>6,979</td><td>713.00</td></tr> </tbody> </table>	Tax Year	Statement Number	Billed Owner	Tax Area	Total Value	Exemptions	Taxable Value	Billed Tax	2025	2025-660021015	SMALLEY, MICHAEL P	94	195,534	1000	19,062	1,885.00	2024	2024-660021015	SMALLEY, MICHAEL P	94	183,172	1000	18,478	1,951.00	2023	2023-660021015	SMALLEY, MICHAEL P	94	171,919	1000	17,911	1,929.00	2022	2022-660021015	SMALLEY, MICHAEL P	94	172,431	1000	17,967	1,952.00	2021	2021-660021015	SMALLEY, MICHAEL P	94	172,801	1000	18,008	1,892.00	2020	2020-660021015	SMALLEY, MICHAEL P	94	169,772	1000	17,675	1,852.00	2019	2019-660021015	SMALLEY, MICHAEL P	94	87,903	1000	8,669	902.00	2018	2018-660021015	SMALLEY, MICHAEL P	94	88,344	1000	8,249	868.00	2017	2017-660021015	SMALLEY, MICHAEL P	94	87,572	1000	7,980	829.00	2016	2016-660021015	SMALLEY, MICHAEL P	94	85,325	1000	7,718	799.00	2015	2015-660021015	SMALLEY, MICHAEL P	94	80,065	1000	7,465	789.00	2014	2014-660021015	SMALLEY, MICHAEL P	94	80,861	1000	7,218	748.00	2013	2013-660021015	SMALLEY, MICHAEL P	94	76,596	1000	6,979	713.00					
Tax Year	Statement Number	Billed Owner	Tax Area	Total Value	Exemptions	Taxable Value	Billed Tax																																																																																																														
2025	2025-660021015	SMALLEY, MICHAEL P	94	195,534	1000	19,062	1,885.00																																																																																																														
2024	2024-660021015	SMALLEY, MICHAEL P	94	183,172	1000	18,478	1,951.00																																																																																																														
2023	2023-660021015	SMALLEY, MICHAEL P	94	171,919	1000	17,911	1,929.00																																																																																																														
2022	2022-660021015	SMALLEY, MICHAEL P	94	172,431	1000	17,967	1,952.00																																																																																																														
2021	2021-660021015	SMALLEY, MICHAEL P	94	172,801	1000	18,008	1,892.00																																																																																																														
2020	2020-660021015	SMALLEY, MICHAEL P	94	169,772	1000	17,675	1,852.00																																																																																																														
2019	2019-660021015	SMALLEY, MICHAEL P	94	87,903	1000	8,669	902.00																																																																																																														
2018	2018-660021015	SMALLEY, MICHAEL P	94	88,344	1000	8,249	868.00																																																																																																														
2017	2017-660021015	SMALLEY, MICHAEL P	94	87,572	1000	7,980	829.00																																																																																																														
2016	2016-660021015	SMALLEY, MICHAEL P	94	85,325	1000	7,718	799.00																																																																																																														
2015	2015-660021015	SMALLEY, MICHAEL P	94	80,065	1000	7,465	789.00																																																																																																														
2014	2014-660021015	SMALLEY, MICHAEL P	94	80,861	1000	7,218	748.00																																																																																																														
2013	2013-660021015	SMALLEY, MICHAEL P	94	76,596	1000	6,979	713.00																																																																																																														



# Rogers

## Assessment Property Record Card for Tax Year 2026

Data provided by LISA DELOZIER County Assessor

Date 04/18/2026  
 Time 05:35:20  
 Page 2

<b>Lot Data</b>		<b>Primary Image</b>																																					
Lot Size Lot Count Units Buildable Non-Ag Acres 0 Topography Street Access Utilities Amenities LAND QUALITY  Method Base Lot Value Factor Value Adjustments Lot Value																																							
<b>Residential Data</b> Type 1 Single Family Residence Condition 3 - Average Quality 2 - Fair Architecture Style 100% One Story Exterior Wall 100% Frame, Siding, Wood Base/Total Area 2,493 / 2,493 Style 100% One Story HVAC 100% Warmed & Cooled Air Roof Cover 1 Composition Shingle Area on Slab 2,493 Fixture/RghIn 8 / Bed/F/H Bath 3 / 2.0 / Basement Area Garage Type 784 Attached Garage - Unfinished Remodel Year/Eff Age 1989 / 28				\\tsclient\T\LOGAN\LOGAN RESIDENTIAL VI\2022-12-27\IMG_00; 12/27/2022																																			
<b>Cost Approach</b>		<b>GRM Approach</b>																																					
<b>Manual : 01/2025</b> <table border="0"> <tr> <td>Base Cost</td><td>81.54</td> <td>Total Misc Impr</td><td>+ 21,667</td> </tr> <tr> <td>Roofing Adj</td><td>+ 3.68</td> <td>Garage Cost</td><td>+ 17,099</td> </tr> <tr> <td>Subfloor Adj</td><td>+ 0.00</td> <td>Total RCN</td><td>= 286,271</td> </tr> <tr> <td>Heat/Cool Adj</td><td>+ 10.30</td> <td>Depreciation ( 40%)</td><td>- 114,508</td> </tr> <tr> <td>Plumbing Adj</td><td>+ 3.76</td> <td>Lump Sums</td><td>+ 0</td> </tr> <tr> <td>Basement Adj</td><td>+ 0.00</td> <td>RCNLD</td><td>= 171,763</td> </tr> <tr> <td>Adj Base Cost</td><td>= 99.28</td> <td>Lot Value</td><td>+ 171,763</td> </tr> <tr> <td>Total Area</td><td>x 2,493</td> <td>Indicated Value</td><td>= 171,763</td> </tr> <tr> <td>Adjusted Cost</td><td>= 247,505</td> <td>Value Per SqFt</td><td>68.90</td> </tr> </table>		Base Cost	81.54	Total Misc Impr	+ 21,667	Roofing Adj	+ 3.68	Garage Cost	+ 17,099	Subfloor Adj	+ 0.00	Total RCN	= 286,271	Heat/Cool Adj	+ 10.30	Depreciation ( 40%)	- 114,508	Plumbing Adj	+ 3.76	Lump Sums	+ 0	Basement Adj	+ 0.00	RCNLD	= 171,763	Adj Base Cost	= 99.28	Lot Value	+ 171,763	Total Area	x 2,493	Indicated Value	= 171,763	Adjusted Cost	= 247,505	Value Per SqFt	68.90	GRM Code Gross Rent 0.00 Indicated Value	
Base Cost	81.54	Total Misc Impr	+ 21,667																																				
Roofing Adj	+ 3.68	Garage Cost	+ 17,099																																				
Subfloor Adj	+ 0.00	Total RCN	= 286,271																																				
Heat/Cool Adj	+ 10.30	Depreciation ( 40%)	- 114,508																																				
Plumbing Adj	+ 3.76	Lump Sums	+ 0																																				
Basement Adj	+ 0.00	RCNLD	= 171,763																																				
Adj Base Cost	= 99.28	Lot Value	+ 171,763																																				
Total Area	x 2,493	Indicated Value	= 171,763																																				
Adjusted Cost	= 247,505	Value Per SqFt	68.90																																				
<b>Miscellaneous Improvements</b>		<b>Multiple Regression</b>																																					
<table border="0"> <thead> <tr> <th>Code</th><th>Description</th><th>Sketch ID</th><th>Size</th><th>Year</th><th>Units</th><th>Unit Cost</th><th>Depr</th><th>Value</th></tr> </thead> <tbody> <tr> <td>PRCH</td><td>SLAB PORCH - COVERED</td><td>144096</td><td>490</td><td></td><td>490</td><td>20.06</td><td></td><td>9,829</td></tr> <tr> <td>PRCH</td><td>SLAB PORCH - COVERED</td><td>144097</td><td>600</td><td></td><td>600</td><td>19.73</td><td></td><td>11,838</td></tr> </tbody> </table>		Code	Description	Sketch ID	Size	Year	Units	Unit Cost	Depr	Value	PRCH	SLAB PORCH - COVERED	144096	490		490	20.06		9,829	PRCH	SLAB PORCH - COVERED	144097	600		600	19.73		11,838	MRA Code Adjusted R Indicated Value										
Code	Description	Sketch ID	Size	Year	Units	Unit Cost	Depr	Value																															
PRCH	SLAB PORCH - COVERED	144096	490		490	20.06		9,829																															
PRCH	SLAB PORCH - COVERED	144097	600		600	19.73		11,838																															
		<b>Direct Comparables</b>																																					
		Selection Model A Adam Test Adjustment Model NewTest Comparables Indicated Value																																					
		<b>Value Reconciliation</b>																																					
		Selected Approach Cost Approach Improvements 171,763 Lot Value Indicated Value 171,763 68.90 Per SqFt Aground Value 2,520 Site Improvements 34,122 Total Value 208,405 83.60 Total Value Per SqFt																																					



# Rogers

## Assessment Property Record Card for Tax Year 2026

Data provided by LISA DELOZIER County Assessor

Date 04/18/2026  
 Time 05:35:20  
 Page 3

### Sketch Image

660021015

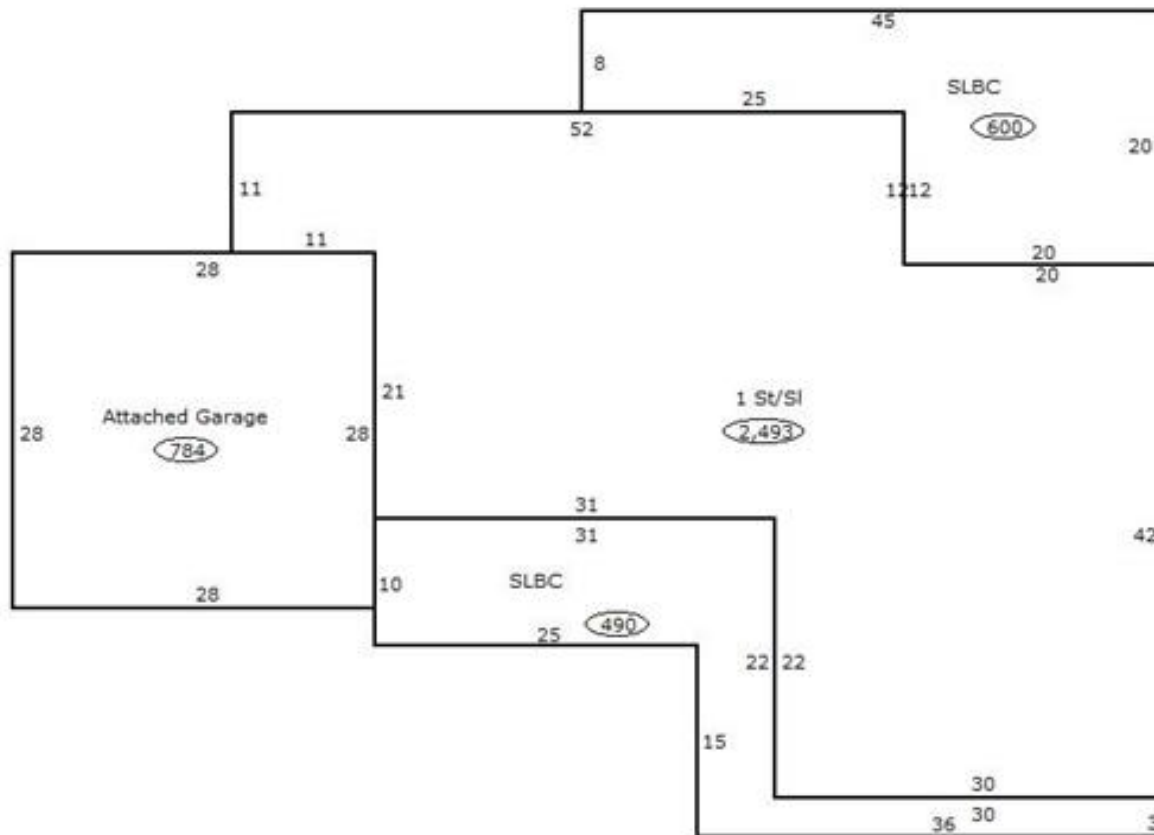

### Sketch Vector Information

Sequence	Code	Type	Built Over	Scale	Section Label	Base Area	Multiplier	Total Area
1	R	1	Slab	13	1 St/SI	2,493	1.000	2,493
2	G	1		13	Attached Garage	784	1.000	784
3	M	PRCH		13	SLBC	490	1.000	490
4	M	PRCH		13	SLBC	600	1.000	600
<b>Total Building Area</b>						2,493		2,493



# Rogers



## Assessment Property Record Card for Tax Year 2026

Data provided by LISA DELOZIER County Assessor

Date 04/18/2026  
 Time 05:35:20  
 Page 4

660021015

### Outbuildings/Site Improvements

Building Image	Code	Description	Dimensions	Floor	Roofing	Total Units	
	CP	Carport Dirt	30x20x0			600	
	Qual	Cond	Year	2018	Eff Age		
	<b>Valuation Summary</b>		<b>Modifier Total</b>	<b>RCN</b>	<b>Depr (0% Phys/ % Func)</b>	<b>RCNLD</b>	
		Base Cost (3.50 x 600)	2,100		2,100	2,100	
	BARN	BARN	0x0x0			440	
	Qual	3	Cond	3	Year	Eff Age	
	<b>Valuation Summary</b>		<b>Modifier Total</b>	<b>RCN</b>	<b>Depr (65% Phys/ % Func)</b>	<b>RCNLD</b>	
		Base Cost (10.48 x 440)	4,611		4,611	2,997	1,614
	UTIL	SHOP BUILDING	0x0x0			1,600	
	Qual	2	Cond	3	Year	Eff Age	
	<b>Valuation Summary</b>		<b>Modifier Total</b>	<b>RCN</b>	<b>Depr (30% Phys/ % Func)</b>	<b>RCNLD</b>	
		Base Cost (27.15 x 1,600)	43,440		43,440	13,032	30,408



# Rogers

## Assessment Property Record Card for Tax Year 2026

Data provided by LISA DELOZIER County Assessor

Date 04/18/2026  
Time 05:35:20  
Page 5

### Agland Inventory

660021015

Soi	Description	Land Use	LPI	Adj Type	Adj Code	Acres	Use/Acre	Mkt/Acre	Use Value	Market Value
DBC	DENNIS-BATES COMPLEX 2-5%	NTV PST	60			17.500	144	144	2,520	2,520
<b>NTV PST Totals</b>						17.500			2,520	2,520
<b>Total Agland</b>						17.500			2,520	2,520