



# Rogers

## Assessment Property Record Card for Tax Year 2026

Data provided by LISA DELOZIER County Assessor

Date 04/16/2026  
Time 23:05:42  
Page 1

Assessment Data					Primary Image																																																																																																															
<b>Account</b> 660021072 <b>Parcel ID</b> 22N17E-25-3-00000-000-0000 <b>Cadastral ID</b> 25-22-17-00400 <b>Property Type</b> REAL - Real Property <b>Property Class</b> RA VI Area 2 <b>Tax Area</b> 94 - SEQUOYAH/TRI-DISTRICT FI <b>Name ID</b> 341741 LEMMINGS, TONY & MARY REVOCABLE TRUST  21205 E 460 RD CLAREMORE OK 74019-0000  <b>Parcel Location</b> <b>Situs</b> 21205 E 460 RD <b>Subdivision</b> <b>Lot/Block</b> / <b>Parcel Size</b> 78 - Acres <b>Sec/Twn/Rng</b> 25 / 22 / 17 / 3 <b>Neighborhood</b> 4070 - FOYIL SEQUOYAH AREA <b>School District</b> S006 - SEQUOYAH SCHOOLS																																																																																																																				
<b>Legal Description</b> Lat/Long: 36.35444180 -95.45116824 W2 SW LESS TR DESC 2025-014487 AS W 350' N 248.91' S 1414.25' W2 SW.																																																																																																																				
<b>Exemptions</b> <table border="1"> <thead> <tr> <th>Code</th> <th>Type</th> <th>Active</th> <th>Maximum</th> <th>Exemption</th> </tr> </thead> <tbody> <tr> <td>H</td> <td>Homestead</td> <td>Yes</td> <td>1,000</td> <td>1,000</td> </tr> </tbody> </table>					Code	Type	Active	Maximum	Exemption	H	Homestead	Yes	1,000	1,000	<b>Building Permits</b> <table border="1"> <thead> <tr> <th>Number</th> <th>Description</th> <th>Opened</th> <th>Closed</th> <th>Amount</th> </tr> </thead> <tbody> <tr> <td colspan="5" style="height: 100px;"> </td> </tr> </tbody> </table>					Number	Description	Opened	Closed	Amount																																																																																												
Code	Type	Active	Maximum	Exemption																																																																																																																
H	Homestead	Yes	1,000	1,000																																																																																																																
Number	Description	Opened	Closed	Amount																																																																																																																
<b>Parcel Valuation</b> <table border="1"> <thead> <tr> <th>Source</th> <th>REAL</th> <th>Fair Cash</th> <th>Capped</th> <th>Asmnt Level</th> <th>Assessed</th> <th>Levy Rate</th> <th>98.320</th> <th>Current Tax</th> </tr> </thead> <tbody> <tr> <td>Remove Cap</td> <td>0</td> <td>Land Value 11,428</td> <td>11,428</td> <td>11%</td> <td>1,257</td> <td>Assessed</td> <td>28,897</td> <td>2,841.15</td> </tr> <tr> <td>Year Frozen</td> <td>0</td> <td>Improvements 327,602</td> <td>251,274</td> <td></td> <td>27,640</td> <td>Penalty</td> <td>0</td> <td></td> </tr> <tr> <td>Uncapped Value</td> <td>0</td> <td>Mobile Home 0</td> <td>0</td> <td></td> <td>0</td> <td>Exemption</td> <td>1,000</td> <td>-88.00</td> </tr> <tr> <td>TIF Project ID</td> <td>0</td> <td>Total Value 339,030</td> <td>262,702</td> <td></td> <td>28,897</td> <td>Total Taxable</td> <td>27,897</td> <td>2,753.00</td> </tr> </tbody> </table>					Source	REAL	Fair Cash	Capped	Asmnt Level	Assessed	Levy Rate	98.320	Current Tax	Remove Cap	0	Land Value 11,428	11,428	11%	1,257	Assessed	28,897	2,841.15	Year Frozen	0	Improvements 327,602	251,274		27,640	Penalty	0		Uncapped Value	0	Mobile Home 0	0		0	Exemption	1,000	-88.00	TIF Project ID	0	Total Value 339,030	262,702		28,897	Total Taxable	27,897	2,753.00	<b>Sale History</b> <table border="1"> <thead> <tr> <th>Bk/Pg</th> <th>Grantor</th> <th>Date</th> <th>Price</th> <th>Code</th> </tr> </thead> <tbody> <tr> <td>/</td> <td>LEMINGS, TONY R &amp; BEAUBIEN, R E JR</td> <td>05/26/2023</td> <td>0</td> <td>4</td> </tr> <tr> <td>879/627</td> <td></td> <td>04/20/1992</td> <td>58,000</td> <td>No</td> </tr> </tbody> </table>					Bk/Pg	Grantor	Date	Price	Code	/	LEMINGS, TONY R & BEAUBIEN, R E JR	05/26/2023	0	4	879/627		04/20/1992	58,000	No																																															
Source	REAL	Fair Cash	Capped	Asmnt Level	Assessed	Levy Rate	98.320	Current Tax																																																																																																												
Remove Cap	0	Land Value 11,428	11,428	11%	1,257	Assessed	28,897	2,841.15																																																																																																												
Year Frozen	0	Improvements 327,602	251,274		27,640	Penalty	0																																																																																																													
Uncapped Value	0	Mobile Home 0	0		0	Exemption	1,000	-88.00																																																																																																												
TIF Project ID	0	Total Value 339,030	262,702		28,897	Total Taxable	27,897	2,753.00																																																																																																												
Bk/Pg	Grantor	Date	Price	Code																																																																																																																
/	LEMINGS, TONY R & BEAUBIEN, R E JR	05/26/2023	0	4																																																																																																																
879/627		04/20/1992	58,000	No																																																																																																																
<b>Assessment History</b> <table border="1"> <thead> <tr> <th>Tax Year</th> <th>Statement Number</th> <th>Billed Owner</th> <th>Tax Area</th> <th>Total Value</th> <th>Exemptions</th> <th>Taxable Value</th> <th>Billed Tax</th> </tr> </thead> <tbody> <tr><td>2025</td><td>2025-660021072</td><td>LEMINGS, TONY &amp; MARY</td><td>94</td><td>328,527</td><td>1000</td><td>27,092</td><td>2,674.00</td></tr> <tr><td>2024</td><td>2024-660021072</td><td>LEMINGS, TONY &amp; MARY</td><td>94</td><td>295,648</td><td>1000</td><td>26,273</td><td>2,766.00</td></tr> <tr><td>2023</td><td>2023-660021072</td><td>LEMINGS, TONY &amp; MARY</td><td>94</td><td>257,576</td><td>1000</td><td>25,479</td><td>2,737.00</td></tr> <tr><td>2022</td><td>2022-660021072</td><td>LEMINGS, TONY R &amp;</td><td>94</td><td>250,407</td><td>1000</td><td>24,707</td><td>2,679.00</td></tr> <tr><td>2021</td><td>2021-660021072</td><td>LEMINGS, TONY R &amp;</td><td>94</td><td>226,899</td><td>1000</td><td>23,959</td><td>2,512.00</td></tr> <tr><td>2020</td><td>2020-660021072</td><td>LEMINGS, TONY R &amp;</td><td>94</td><td>221,136</td><td>1000</td><td>23,325</td><td>2,440.00</td></tr> <tr><td>2019</td><td>2019-660021072</td><td>LEMINGS, TONY R &amp;</td><td>94</td><td>214,857</td><td>1000</td><td>22,634</td><td>2,334.00</td></tr> <tr><td>2018</td><td>2018-660021072</td><td>LEMINGS, TONY R &amp;</td><td>94</td><td>224,144</td><td>1000</td><td>22,848</td><td>2,381.00</td></tr> <tr><td>2017</td><td>2017-660021072</td><td>LEMINGS, TONY R &amp;</td><td>94</td><td>221,695</td><td>1000</td><td>22,153</td><td>2,279.00</td></tr> <tr><td>2016</td><td>2016-660021072</td><td>LEMINGS, TONY R &amp;</td><td>94</td><td>212,123</td><td>1000</td><td>20,262</td><td>2,076.00</td></tr> <tr><td>2015</td><td>2015-660021072</td><td>LEMINGS, TONY R &amp;</td><td>94</td><td>207,039</td><td>1000</td><td>19,642</td><td>2,056.00</td></tr> <tr><td>2014</td><td>2014-660021072</td><td>LEMINGS, TONY R &amp;</td><td>94</td><td>209,039</td><td>1000</td><td>19,041</td><td>1,956.00</td></tr> <tr><td>2013</td><td>2013-660021072</td><td>LEMINGS, TONY R &amp;</td><td>94</td><td>196,290</td><td>1000</td><td>18,457</td><td>1,870.00</td></tr> </tbody> </table>					Tax Year	Statement Number	Billed Owner	Tax Area	Total Value	Exemptions	Taxable Value	Billed Tax	2025	2025-660021072	LEMINGS, TONY & MARY	94	328,527	1000	27,092	2,674.00	2024	2024-660021072	LEMINGS, TONY & MARY	94	295,648	1000	26,273	2,766.00	2023	2023-660021072	LEMINGS, TONY & MARY	94	257,576	1000	25,479	2,737.00	2022	2022-660021072	LEMINGS, TONY R &	94	250,407	1000	24,707	2,679.00	2021	2021-660021072	LEMINGS, TONY R &	94	226,899	1000	23,959	2,512.00	2020	2020-660021072	LEMINGS, TONY R &	94	221,136	1000	23,325	2,440.00	2019	2019-660021072	LEMINGS, TONY R &	94	214,857	1000	22,634	2,334.00	2018	2018-660021072	LEMINGS, TONY R &	94	224,144	1000	22,848	2,381.00	2017	2017-660021072	LEMINGS, TONY R &	94	221,695	1000	22,153	2,279.00	2016	2016-660021072	LEMINGS, TONY R &	94	212,123	1000	20,262	2,076.00	2015	2015-660021072	LEMINGS, TONY R &	94	207,039	1000	19,642	2,056.00	2014	2014-660021072	LEMINGS, TONY R &	94	209,039	1000	19,041	1,956.00	2013	2013-660021072	LEMINGS, TONY R &	94	196,290	1000	18,457	1,870.00
Tax Year	Statement Number	Billed Owner	Tax Area	Total Value	Exemptions	Taxable Value	Billed Tax																																																																																																													
2025	2025-660021072	LEMINGS, TONY & MARY	94	328,527	1000	27,092	2,674.00																																																																																																													
2024	2024-660021072	LEMINGS, TONY & MARY	94	295,648	1000	26,273	2,766.00																																																																																																													
2023	2023-660021072	LEMINGS, TONY & MARY	94	257,576	1000	25,479	2,737.00																																																																																																													
2022	2022-660021072	LEMINGS, TONY R &	94	250,407	1000	24,707	2,679.00																																																																																																													
2021	2021-660021072	LEMINGS, TONY R &	94	226,899	1000	23,959	2,512.00																																																																																																													
2020	2020-660021072	LEMINGS, TONY R &	94	221,136	1000	23,325	2,440.00																																																																																																													
2019	2019-660021072	LEMINGS, TONY R &	94	214,857	1000	22,634	2,334.00																																																																																																													
2018	2018-660021072	LEMINGS, TONY R &	94	224,144	1000	22,848	2,381.00																																																																																																													
2017	2017-660021072	LEMINGS, TONY R &	94	221,695	1000	22,153	2,279.00																																																																																																													
2016	2016-660021072	LEMINGS, TONY R &	94	212,123	1000	20,262	2,076.00																																																																																																													
2015	2015-660021072	LEMINGS, TONY R &	94	207,039	1000	19,642	2,056.00																																																																																																													
2014	2014-660021072	LEMINGS, TONY R &	94	209,039	1000	19,041	1,956.00																																																																																																													
2013	2013-660021072	LEMINGS, TONY R &	94	196,290	1000	18,457	1,870.00																																																																																																													



# Rogers

## Assessment Property Record Card for Tax Year 2026

Data provided by LISA DELOZIER County Assessor

Date 04/16/2026  
Time 23:05:43  
Page 2

<b>Units Buildable - FOYIL SEQUOYAH AREA (UNITS BUILDABLE)</b>	
Lot Size	
Lot Count	
Units Buildable	
Non-Ag Acres	0
Topography	
Street Access	
Utilities	
Amenities	LAND QUALITY
Method	Units-Buildable
Base Lot Value	
Factor Value	
Adjustments	
Lot Value	



\\tsclient\TCASEY\CASEY BOOTH VISUAL INSPECTION\2020-1' 11/19/2020

<b>Residential Data</b>	
Type	1 Single Family Residence
Condition	3 - Average
Quality	3.5 - Average
Architecture	TRAD TRADITIONAL
Style	100% One Story
Exterior Wall	15% Veneer, Masonry 85% Frame, Siding, Wood
Base/Total Area	2,690 / 2,690
Style	100% One Story
HVAC	100% Warmed & Cooled Air
Roof Cover	4 Metal, Preformed
Area on Slab	0
Fixture/RghIn	11 /
Bed/F/H Bath	3 / 2.0 /
Basement Area	
Garage Type	480 Attached Garage - Unfinished
Remodel	
Year/Eff Age	1999 / 20

<b>GRM Approach</b>	
GRM Code	
Gross Rent	0.00
Indicated Value	

<b>Multiple Regression</b>	
MRA Code	
Adusted R	
Indicated Value	

<b>Direct Comparables</b>	
Selection Model	1 Res
Adjustment Model	A2 AO Test
Comparables	
Indicated Value	

<b>Cost Approach</b>		<b>Manual : 01/2025</b>	
Base Cost	100.57	Total Misc Impr	+ 32,028
Roofing Adj	+ 6.01	Garage Cost	+ 19,258
Subfloor Adj	+ 0.00	Total RCN	= 394,691
Heat/Cool Adj	+ 14.47	Depreciation ( 23%)	- 90,779
Plumbing Adj	+ 6.61	Lump Sums	+ 0
Basement Adj	+ 0.00	RCNLD	= 303,912
Adj Base Cost	= 127.66	Lot Value	+ 303,912
Total Area	x 2,690	Indicated Value	= 303,912
Adjusted Cost	= 343,405	Value Per SqFt	112.98

<b>Value Reconciliation</b>			
Selected Approach	Cost Approach		
Improvements	303,912		
Lot Value			
Indicated Value	303,912	112.98	Per SqFt
Agland Value	11,428		
Site Improvements	23,690		
Total Value	642,942	239.01	Total Value Per SqFt

<b>Miscellaneous Improvements</b>								
Code	Description	Sketch ID	Size	Year	Units	Unit Cost	Depr	Value
SHLT	STORM SHELTER	0		1 2017	1	0.00		
PRCH	SLAB PORCH - COVERED	51495	556		556	27.71		15,407
EPSW	ENCLOSED PORCH - SOLID WALL	51496	22x10		220	75.55		16,621



**Rogers**  
**Assessment Property Record Card for Tax Year 2026**

Data provided by LISA DELOZIER County Assessor

Date 04/16/2026  
 Time 23:05:43  
 Page 3

Sketch Image

660021072

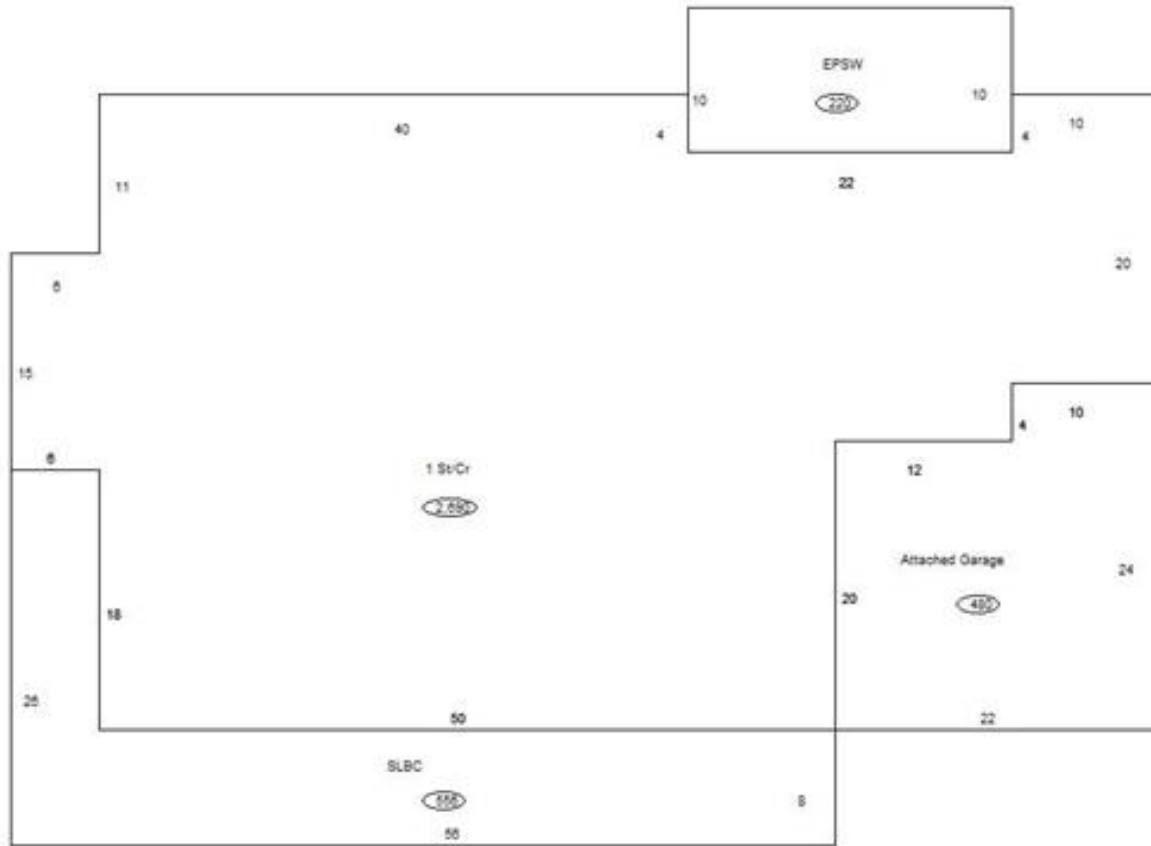

**Sketch Vector Information**

Sequence	Code	Type	Built Over	Scale	Section Label	Base Area	Multiplier	Total Area
1	R	1	Crawl	10	1 St/Cr	2,690	1.000	2,690
2	G	1		10	Attached Garage	480	1.000	480
3	M	PRCH		10	SLBC	556	1.000	556
4	M	EPSW		10	EPSW	220	1.000	220
<b>Total Building Area</b>						2,690		2,690



# Rogers



## Assessment Property Record Card for Tax Year 2026

Data provided by LISA DELOZIER County Assessor

Date 04/16/2026  
 Time 23:05:43  
 Page 4

660021072

### Outbuildings/Site Improvements

Building Image	Code	Description	Dimensions	Floor	Roofing	Total Units
	BARN	BARN	40x60x10	Concrete		2,400
	Qual 3	Cond 3	Year 2016	Eff Age 8		
<b>Valuation Summary</b>		<b>Modifier Total</b>	<b>RCN</b>	<b>Depr (33% Phys/ % Func)</b>		<b>RCNLD</b>
Base Cost (12.52 x 2,400)		30,048		30,048	9,916	20,132
	STF	STG FAIR	16x20x6	Concrete	Galvanized Metal	320
	Qual 3.5	Cond 3	Year 2005	Eff Age		
<b>Valuation Summary</b>		<b>Modifier Total</b>	<b>RCN</b>	<b>Depr (20% Phys/ % Func)</b>		<b>RCNLD</b>
Base Cost (4.68 x 320)		1,498		1,498	300	1,198
	GF	GAZEBO FAIR	20x20x8	Concrete		1
	Qual 3	Cond 3	Year 2005	Eff Age		
<b>Valuation Summary</b>		<b>Modifier Total</b>	<b>RCN</b>	<b>Depr (20% Phys/ % Func)</b>		<b>RCNLD</b>
Base Cost (2,950.00 x 1)		2,950		2,950	590	2,360



# Rogers

## Assessment Property Record Card for Tax Year 2026

Data provided by LISA DELOZIER County Assessor

Date 04/16/2026  
Time 23:05:43  
Page 5

### Agland Inventory

660021072

Soi	Description	Land Use	LPI	Adj Type	Adj Code	Acres	Use/Acre	Mkt/Acre	Use Value	Market Value
BC	BATES-COLLINSVILLE COMPLE	NTV PST	51			2.056	122	122	252	252
BDC2	BATES-DENNIS SOILS 3-5% S	NTV PST	59			10.312	142	142	1,460	1,460
BR	BREAKS-ALLUVIAL LAND COMP	TMBR	30			16.594	54	54	896	896
CO	COLLINSVILLE STONY LOAM	NTV PST	22			1.510	53	53	80	80
DBC	DENNIS-BATES COMPLEX 2-5%	IMP PST	60			16.119	168	168	2,708	2,708
DNB	DENNIS SILT LOAM 1-3% SLO	NTV PST	80			31.313	192	192	6,012	6,012
PAA	PARSONS SILT LOAM 0-1% SL	IMP PST	76			.096	213	213	20	20
<b>IMP PST Totals</b>						78.000			11,428	11,428
<b>Total Agland</b>						78.000			11,428	11,428