



Rogers

Assessment Property Record Card for Tax Year 2026

Data provided by LISA DELOZIER County Assessor

Date 04/16/2026
Time 21:55:43
Page 1

Assessment Data					Primary Image																																																																																																																				
Account	660021110																																																																																																																								
Parcel ID	23N14E-25-2-00000-000-0000																																																																																																																								
Cadastral ID	25-23-14-02100																																																																																																																								
Property Type	REAL - Real Property																																																																																																																								
Property Class	RA	VI Area 2																																																																																																																							
Tax Area	10 - OOLOGAH RURAL/NW FIRE																																																																																																																								
Name ID	210234																																																																																																																								
ALLEN, JEFFERY R &																																																																																																																									
PAULA M																																																																																																																									
3410 E 390 RD																																																																																																																									
OOLOGAH OK 74053-0000																																																																																																																									
Parcel Location					\\tsclient\TCASEY\2020-7-23\IMG_0172.JPG 7/24/2020																																																																																																																				
Situs	03410 E 390 RD				Building Permits																																																																																																																				
Subdivision					<table border="1"> <thead> <tr> <th>Number</th> <th>Description</th> <th>Opened</th> <th>Closed</th> <th>Amount</th> </tr> </thead> <tbody> <tr> <td colspan="5" style="height: 100px;"> </td> </tr> </tbody> </table>					Number	Description	Opened	Closed	Amount																																																																																																											
Number	Description	Opened	Closed	Amount																																																																																																																					
Lot/Block	/	Parcel Size	30.04 - Acres			<table border="1"> <thead> <tr> <th>Code</th> <th>Type</th> <th>Active</th> <th>Maximum</th> <th>Exemption</th> <th>Bk/Pg</th> <th>Grantor</th> <th>Date</th> <th>Price</th> <th>Code</th> </tr> </thead> <tbody> <tr> <td>H</td> <td>Homestead</td> <td>Yes</td> <td>1,000</td> <td>1,000</td> <td>823/780</td> <td></td> <td></td> <td>50,000</td> <td>No</td> </tr> </tbody> </table>					Code	Type	Active	Maximum	Exemption	Bk/Pg	Grantor	Date	Price	Code	H	Homestead	Yes	1,000	1,000	823/780			50,000	No																																																																																											
Code	Type	Active	Maximum	Exemption	Bk/Pg						Grantor	Date	Price	Code																																																																																																											
H	Homestead	Yes	1,000	1,000	823/780								50,000	No																																																																																																											
Sec/Twn/Rng	25 / 23 / 14 / 2																																																																																																																								
Neighborhood	4030 - OOLOGAH RURAL																																																																																																																								
School District	S004 - OOLOGAH SCHOOLS				Sale History																																																																																																																				
Legal Description					<table border="1"> <thead> <tr> <th>Source</th> <th>REAL</th> <th>Fair Cash</th> <th>Capped</th> <th>Asmnt Level</th> <th>Assessed</th> <th>Levy Rate</th> <th>108.182</th> <th>Current Tax</th> </tr> </thead> <tbody> <tr> <td>Remove Cap</td> <td>0</td> <td>Land Value 4,254</td> <td>4,254</td> <td>11%</td> <td>468</td> <td>Assessed</td> <td>14,257</td> <td>1,542.34</td> </tr> <tr> <td>Year Frozen</td> <td>0</td> <td>Improvements 125,354</td> <td>125,354</td> <td></td> <td>13,789</td> <td>Penalty</td> <td>0</td> <td></td> </tr> <tr> <td>Uncapped Value</td> <td>0</td> <td>Mobile Home 0</td> <td>0</td> <td></td> <td>0</td> <td>Exemption</td> <td>1,000</td> <td>-94.00</td> </tr> <tr> <td>TIF Project ID</td> <td>0</td> <td>Total Value 129,608</td> <td>129,608</td> <td></td> <td>14,257</td> <td>Total Taxable</td> <td>13,257</td> <td>1,448.00</td> </tr> </tbody> </table>					Source	REAL	Fair Cash	Capped	Asmnt Level	Assessed	Levy Rate	108.182	Current Tax	Remove Cap	0	Land Value 4,254	4,254	11%	468	Assessed	14,257	1,542.34	Year Frozen	0	Improvements 125,354	125,354		13,789	Penalty	0		Uncapped Value	0	Mobile Home 0	0		0	Exemption	1,000	-94.00	TIF Project ID	0	Total Value 129,608	129,608		14,257	Total Taxable	13,257	1,448.00																																																																			
Source	REAL	Fair Cash	Capped	Asmnt Level	Assessed	Levy Rate	108.182	Current Tax																																																																																																																	
Remove Cap	0	Land Value 4,254	4,254	11%	468	Assessed	14,257	1,542.34																																																																																																																	
Year Frozen	0	Improvements 125,354	125,354		13,789	Penalty	0																																																																																																																		
Uncapped Value	0	Mobile Home 0	0		0	Exemption	1,000	-94.00																																																																																																																	
TIF Project ID	0	Total Value 129,608	129,608		14,257	Total Taxable	13,257	1,448.00																																																																																																																	
E 440' NE NW & E 440' N2 SE NW & E 442.08', S 989.42' W 880' N 1979 55' E2 NW					Assessment History																																																																																																																				
Exemptions					<table border="1"> <thead> <tr> <th>Tax Year</th> <th>Statement Number</th> <th>Billed Owner</th> <th>Tax Area</th> <th>Total Value</th> <th>Exemptions</th> <th>Taxable Value</th> <th>Billed Tax</th> </tr> </thead> <tbody> <tr><td>2025</td><td>2025-660021110</td><td>ALLEN, JEFFERY R &</td><td>10</td><td>127,193</td><td>1000</td><td>12,850</td><td>1,404.00</td></tr> <tr><td>2024</td><td>2024-660021110</td><td>ALLEN, JEFFERY R &</td><td>10</td><td>136,180</td><td>1000</td><td>12,446</td><td>1,317.00</td></tr> <tr><td>2023</td><td>2023-660021110</td><td>ALLEN, JEFFERY R &</td><td>10</td><td>129,537</td><td>1000</td><td>12,055</td><td>1,268.00</td></tr> <tr><td>2022</td><td>2022-660021110</td><td>ALLEN, JEFFERY R &</td><td>10</td><td>132,990</td><td>1000</td><td>11,675</td><td>1,222.00</td></tr> <tr><td>2021</td><td>2021-660021110</td><td>ALLEN, JEFFERY R &</td><td>10</td><td>131,059</td><td>1000</td><td>11,306</td><td>1,192.00</td></tr> <tr><td>2020</td><td>2020-660021110</td><td>ALLEN, JEFFERY R &</td><td>10</td><td>126,996</td><td>1000</td><td>10,947</td><td>1,172.00</td></tr> <tr><td>2019</td><td>2019-660021110</td><td>ALLEN, JEFFERY R &</td><td>10</td><td>122,735</td><td>1000</td><td>10,599</td><td>1,114.00</td></tr> <tr><td>2018</td><td>2018-660021110</td><td>ALLEN, JEFFERY R &</td><td>10</td><td>128,452</td><td>1000</td><td>10,261</td><td>1,116.00</td></tr> <tr><td>2017</td><td>2017-660021110</td><td>ALLEN, JEFFERY R &</td><td>10</td><td>127,184</td><td>1000</td><td>9,934</td><td>1,143.00</td></tr> <tr><td>2016</td><td>2016-660021110</td><td>ALLEN, JEFFERY R &</td><td>10</td><td>124,054</td><td>1000</td><td>9,615</td><td>1,009.00</td></tr> <tr><td>2015</td><td>2015-660021110</td><td>ALLEN, JEFFERY R &</td><td>10</td><td>120,880</td><td>1000</td><td>9,306</td><td>925.00</td></tr> <tr><td>2014</td><td>2014-660021110</td><td>ALLEN, JEFFERY R &</td><td>10</td><td>122,015</td><td>1000</td><td>9,006</td><td>893.00</td></tr> <tr><td>2013</td><td>2013-660021110</td><td>ALLEN, JEFFERY R &</td><td>10</td><td>114,673</td><td>1000</td><td>8,714</td><td>836.00</td></tr> </tbody> </table>					Tax Year	Statement Number	Billed Owner	Tax Area	Total Value	Exemptions	Taxable Value	Billed Tax	2025	2025-660021110	ALLEN, JEFFERY R &	10	127,193	1000	12,850	1,404.00	2024	2024-660021110	ALLEN, JEFFERY R &	10	136,180	1000	12,446	1,317.00	2023	2023-660021110	ALLEN, JEFFERY R &	10	129,537	1000	12,055	1,268.00	2022	2022-660021110	ALLEN, JEFFERY R &	10	132,990	1000	11,675	1,222.00	2021	2021-660021110	ALLEN, JEFFERY R &	10	131,059	1000	11,306	1,192.00	2020	2020-660021110	ALLEN, JEFFERY R &	10	126,996	1000	10,947	1,172.00	2019	2019-660021110	ALLEN, JEFFERY R &	10	122,735	1000	10,599	1,114.00	2018	2018-660021110	ALLEN, JEFFERY R &	10	128,452	1000	10,261	1,116.00	2017	2017-660021110	ALLEN, JEFFERY R &	10	127,184	1000	9,934	1,143.00	2016	2016-660021110	ALLEN, JEFFERY R &	10	124,054	1000	9,615	1,009.00	2015	2015-660021110	ALLEN, JEFFERY R &	10	120,880	1000	9,306	925.00	2014	2014-660021110	ALLEN, JEFFERY R &	10	122,015	1000	9,006	893.00	2013	2013-660021110	ALLEN, JEFFERY R &	10	114,673	1000	8,714	836.00
Tax Year	Statement Number	Billed Owner	Tax Area	Total Value	Exemptions	Taxable Value	Billed Tax																																																																																																																		
2025	2025-660021110	ALLEN, JEFFERY R &	10	127,193	1000	12,850	1,404.00																																																																																																																		
2024	2024-660021110	ALLEN, JEFFERY R &	10	136,180	1000	12,446	1,317.00																																																																																																																		
2023	2023-660021110	ALLEN, JEFFERY R &	10	129,537	1000	12,055	1,268.00																																																																																																																		
2022	2022-660021110	ALLEN, JEFFERY R &	10	132,990	1000	11,675	1,222.00																																																																																																																		
2021	2021-660021110	ALLEN, JEFFERY R &	10	131,059	1000	11,306	1,192.00																																																																																																																		
2020	2020-660021110	ALLEN, JEFFERY R &	10	126,996	1000	10,947	1,172.00																																																																																																																		
2019	2019-660021110	ALLEN, JEFFERY R &	10	122,735	1000	10,599	1,114.00																																																																																																																		
2018	2018-660021110	ALLEN, JEFFERY R &	10	128,452	1000	10,261	1,116.00																																																																																																																		
2017	2017-660021110	ALLEN, JEFFERY R &	10	127,184	1000	9,934	1,143.00																																																																																																																		
2016	2016-660021110	ALLEN, JEFFERY R &	10	124,054	1000	9,615	1,009.00																																																																																																																		
2015	2015-660021110	ALLEN, JEFFERY R &	10	120,880	1000	9,306	925.00																																																																																																																		
2014	2014-660021110	ALLEN, JEFFERY R &	10	122,015	1000	9,006	893.00																																																																																																																		
2013	2013-660021110	ALLEN, JEFFERY R &	10	114,673	1000	8,714	836.00																																																																																																																		
Parcel Valuation																																																																																																																									



Rogers

Assessment Property Record Card for Tax Year 2026

Data provided by LISA DELOZIER County Assessor

Date 04/16/2026
Time 21:55:43
Page 2

Lot Data Units-Buildable - OOLOGAH RURAL (UNITS BUILDABLE)	
Lot Size	
Lot Count	
Units Buildable	
Non-Ag Acres	0
Topography	
Street Access	
Utilities	
Amenities	LAND QUALITY
Method	Units-Buildable
Base Lot Value	
Factor Value	
Adjustments	
Lot Value	



\\tsclient\TCASEY\2020-7-23\IMG_0172.JPG 7/24/2020

Residential Data	
Type	1 Single Family Residence
Condition	2 - Fair
Quality	1 - Low
Architecture	
Style	100% One Story
Exterior Wall	80% Frame, Siding, Wood 20% Veneer, Masonry
Base/Total Area	2,240 / 2,240
Style	100% One Story
HVAC	100% Warmed & Cooled Air
Roof Cover	4 Metal, Preformed
Area on Slab	0
Fixture/RghIn	4 /
Bed/F/H Bath	3 / 1.0 /
Basement Area	
Garage Type	672 Attached Garage - Unfinished
Remodel	
Year/Eff Age	1993 / 33

GRM Approach

GRM Code	
Gross Rent	0.00
Indicated Value	

Multiple Regression

MRA Code	
Adjusted R	
Indicated Value	

Direct Comparables

Selection Model	A Adam Test
Adjustment Model	A2 AO Test
Comparables	
Indicated Value	

Cost Approach Manual : 01/2025

Base Cost	68.54	Total Misc Impr	+	0
Roofing Adj	+ 3.77	Garage Cost	+	13,621
Subfloor Adj	+ 2.15	Total RCN	=	206,261
Heat/Cool Adj	+ 9.48	Depreciation (45%)	-	92,817
Plumbing Adj	+ 2.06	Lump Sums	+	11,910
Basement Adj	+ 0.00	RCNLD	=	125,354
Adj Base Cost	= 86.00	Lot Value	+	
Total Area	x 2,240	Indicated Value	=	125,354
Adjusted Cost	= 192,640	Value Per SqFt		55.96

Value Reconciliation

Selected Approach	Cost Approach		
Improvements	125,354		
Lot Value			
Indicated Value	125,354	55.96	Per SqFt
Agland Value	4,254		
Site Improvements			
Total Value	129,608	57.86	Total Value Per SqFt

Miscellaneous Improvements

Code	Description	Sketch ID	Size	Year	Units	Unit Cost	Depr	Value
WODC	WOOD DECK - COVERED	51602	42x12		504	23.63		11,910



Rogers

Assessment Property Record Card for Tax Year 2026

Data provided by LISA DELOZIER County Assessor

Date 04/16/2026

Time 21:55:43

Page 3

Sketch Image

660021110

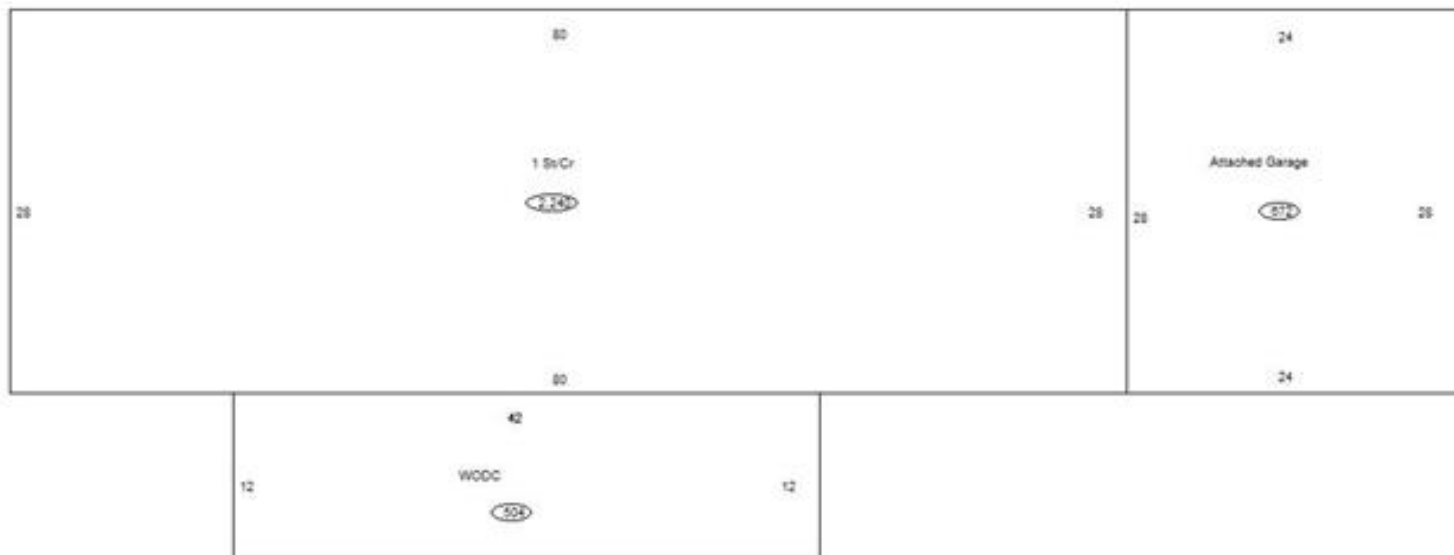

Sketch Vector Information

Sequence	Code	Type	Built Over	Scale	Section Label	Base Area	Multiplier	Total Area
1	R	1	Crawl	10	1 St/Cr	2,240	1.000	2,240
2	G	1		10	Attached Garage	672	1.000	672
3	M	WODC		10	WODC	504	1.000	504
Total Building Area						2,240		2,240



Rogers

Assessment Property Record Card for Tax Year 2026

Data provided by LISA DELOZIER County Assessor

Date 04/16/2026
Time 21:55:43
Page 4

660021110

Outbuildings/Site Improvements

Building Image	Code	Description	Dimensions	Floor	Roofing	Total Units
	BARN	BARN	0x0x0			1,800
	Qual	3	Cond 3	Year	Eff Age	
Valuation Summary		Modifier Total		RCN	Depr (100% Phys/ % Func)	RCNLD
Base Cost (9.39 x 1,800)		16,902		16,902	16,902	



Rogers

Assessment Property Record Card for Tax Year 2026

Data provided by LISA DELOZIER County Assessor

Date 04/16/2026
Time 21:55:43
Page 5

Agland Inventory

660021110

Soi	Description	Land Use	LPI	Adj Type	Adj Code	Acres	Use/Acre	Mkt/Acre	Use Value	Market Value
BDC2	BATES-DENNIS SOILS 3-5% S	NTV PST	59		0	30.040	142	142	4,254	4,254
NTV PST Totals						30.040			4,254	4,254
Total Agland						30.040			4,254	4,254