



# Rogers

## Assessment Property Record Card for Tax Year 2026

Data provided by LISA DELOZIER County Assessor

Date 04/16/2026  
 Time 23:40:54  
 Page 1

Assessment Data					Primary Image				
Account	660021476				<p>660021476_002.JPG 12/16/2024</p>				
Parcel ID	000000-00-0-30010-073-0001								
Cadastral ID	25-24-17-01190								
Property Type	REAL - Real Property								
Property Class	URP	VI Area	2						
Tax Area	29 - CHELSEA OT								
Name ID	337784								
BOGLE, TAMMIE LYNN									
306 W 10TH ST CHELSEA OK 74016-0000									
Parcel Location									
Situs	00306 W 10TH ST								
Subdivision	CHELSEA O T								
Lot/Block	0001 / 0073	Parcel Size	1 - Lots						
Sec/Twn/Rng	25 / 24 / 17 / 5								
Neighborhood	1195 - R-V02-NE CHELSEA								
School District	S003 - CHELSEA SCHOOLS								
Legal Description Lat/Long: 36.53178996 -95.43613015									
Building Permits									
LOT 1 LESS S 10' BLOCK 73 CHELSEA O T									
Exemptions									
Code	Type	Active	Maximum	Exemption	Bk/Pg	Grantor	Date	Price	Code
H	Homestead	Yes	1,000	1,000	/	HAMILTON, JOHN	03/18/2022	103,000	YES
					1407/256	PARKS, ULYSSES LEON &-BETTY MA	09/19/2002	89,000	YES
					955/391	GRIGSBY, GEORGE P TRUSTEE	05/04/1994	0	No
Parcel Valuation									
Source	REAL	Fair Cash	Capped	Asmnt Level	Assessed	Levy Rate	82.750	Current Tax	
Remove Cap	2023	Land Value	14,920	9,312	11%	1,024	Assessed	12,380	1,024.45
Year Frozen	0	Improvements	115,158	103,238		11,356	Penalty	0	
Uncapped Value	0	Mobile Home	0	0		0	Exemption	1,000	-82.00
TIF Project ID	0	Total Value	130,078	112,550		12,380	Total Taxable	11,380	942.00
Assessment History									
Tax Year	Statement Number	Billed Owner	Tax Area	Total Value	Exemptions	Taxable Value	Billed Tax		
2025	2025-660021476	BOGLE, TAMMIE LYNN	29	124,131	1000	11,021	912.00		
2024	2024-660021476	BOGLE, TAMMIE LYNN	29	117,807	1000	10,670	901.00		
2023	2023-660021476	BOGLE, TAMMIE LYNN	29	103,000	1000	10,330	881.00		
2022	2022-660021476	BOGLE, TAMMIE LYNN	29	87,095	0	9,580	811.00		
2021	2021-660021476	HAMILTON, JOHN	29	86,410	0	9,505	806.00		
2020	2020-660021476	HAMILTON, JOHN	29	84,917	0	9,340	792.00		
2019	2019-660021476	HAMILTON, JOHN	29	83,222	0	9,154	786.00		
2018	2018-660021476	HAMILTON, JOHN	29	88,359	0	9,719	830.00		
2017	2017-660021476	HAMILTON, JOHN	29	87,565	0	9,632	826.00		
2016	2016-660021476	HAMILTON, JOHN	29	85,142	0	9,365	816.00		
2015	2015-660021476	HAMILTON, JOHN	29	83,198	0	9,151	788.00		
2014	2014-660021476	HAMILTON, JOHN	29	83,910	0	9,016	803.00		
2013	2013-660021476	HAMILTON, JOHN	29	82,069	8587		.00		



# Rogers

## Assessment Property Record Card for Tax Year 2026

Data provided by LISA DELOZIER County Assessor

Date 04/16/2026  
 Time 23:40:54  
 Page 2

Lot Data	Square-Foot - NBHD 1195 #1	Primary Image
<b>Lot Size</b> <b>Lot Count</b> <b>Units Buildable</b> 1 <b>Non-Ag Acres</b> 0.3114 <b>Topography</b> <b>Street Access</b> <b>Utilities</b> <b>Amenities</b> LAND QUALITY 0 0 <b>Method</b> Square-Foot <b>Base Lot Value</b> 13,564.00 x 1.10 = 14,920 <b>Factor Value</b> <b>Adjustments</b> 1.0000 <b>Lot Value</b> 14,920		

Residential Data	
<b>Type</b>	1 Single Family Residence
<b>Condition</b>	3 - Average
<b>Quality</b>	3 - Average
<b>Architecture</b>	TRAD TRADITIONAL
<b>Style</b>	100% One Story
<b>Exterior Wall</b>	10% Veneer, Stone 90% Frame, Siding, Vinyl
<b>Base/Total Area</b>	1,952 / 1,952
<b>Style</b>	100% One Story
<b>HVAC</b>	100% Warmed & Cooled Air
<b>Roof Cover</b>	1 Composition Shingle
<b>Area on Slab</b>	1,952
<b>Fixture/RghIn</b>	7 /
<b>Bed/F/H Bath</b>	2 / 1.5 /
<b>Basement Area</b>	
<b>Garage Type</b>	800 Attached Garage - Unfinished 2 Stalls
<b>Remodel</b>	
<b>Year/Eff Age</b>	1955 / 53



660021476\_002.JPG 12/16/2024

GRM Approach	
<b>GRM Code</b>	
<b>Gross Rent</b>	0.00
<b>Indicated Value</b>	

Multiple Regression			
<b>MRA Code</b>	1	Test	
<b>Adusted R</b>	0.8445		
<b>Indicated Value</b>	221,467	113.46	Per SqFt

Direct Comparables			
<b>Selection Model</b>	A	Adam Test	
<b>Adjustment Model</b>	1	2022 Residential	
<b>Comparables</b>	5		
<b>Indicated Value</b>	184,100		Per SqFt

Cost Approach				Manual : 01/2025	
<b>Base Cost</b>	100.53	<b>Total Misc Impr</b>	+	6,357	
<b>Roofing Adj</b>	+ 4.72	<b>Garage Cost</b>	+	23,832	
<b>Subfloor Adj</b>	+ -2.22	<b>Total RCN</b>	=	266,147	
<b>Heat/Cool Adj</b>	+ 12.64	<b>Depreciation ( 57%)</b>	-	151,704	
<b>Plumbing Adj</b>	+ 5.21	<b>Lump Sums</b>	+	0	
<b>Basement Adj</b>	+ 0.00	<b>RCNLD</b>	=	114,443	
<b>Adj Base Cost</b>	= 120.88	<b>Lot Value</b>	+	14,920	
<b>Total Area</b>	x 1,952	<b>Indicated Value</b>	=	129,363	
<b>Adjusted Cost</b>	= 235,958	<b>Value Per SqFt</b>		66.27	

Value Reconciliation			
<b>Selected Approach</b>	Cost Approach		
<b>Improvements</b>	114,443		
<b>Lot Value</b>	14,920		
<b>Indicated Value</b>	129,363	66.27	Per SqFt
<b>Agland Value</b>			
<b>Site Improvements</b>	715		
<b>Total Value</b>	130,078	66.64	Total Value Per SqFt

Miscellaneous Improvements								
Code	Description	Sketch ID	Size	Year	Units	Unit Cost	Depr	Value
PRCH	SLAB PORCH - COVERED	52086	14x8		112	26.58		2,977
EPSW	ENCLOSED PORCH - SOLID WALL	52087	8x6		48	70.41		3,380



# Rogers

## Assessment Property Record Card for Tax Year 2026

Data provided by LISA DELOZIER County Assessor

Date 04/16/2026  
 Time 23:40:54  
 Page 3

### Sketch Image

660021476

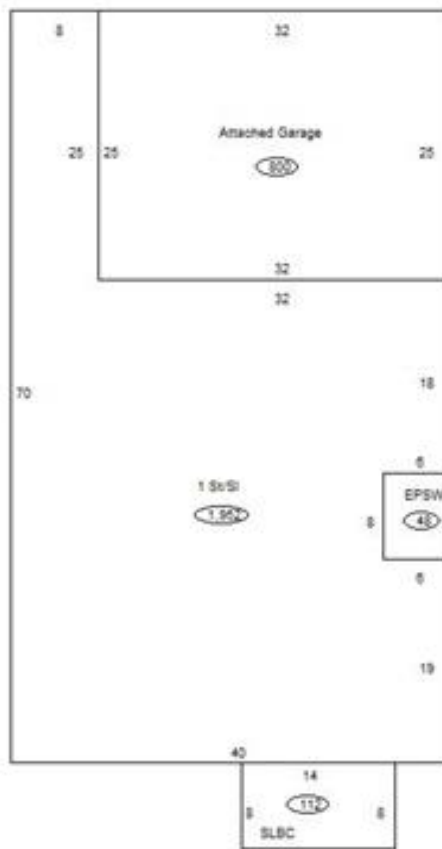

### Sketch Vector Information

Sequence	Code	Type	Built Over	Scale	Section Label	Base Area	Multiplier	Total Area
1	R	1	Slab	13	1 St/SI	1,952	1.000	1,952
2	G	1		13	Attached Garage	800	1.000	800
3	M	PRCH		13	SLBC	112	1.000	112
4	M	EPSW		13	EPSW	48	1.000	48
<b>Total Building Area</b>						<b>1,952</b>		<b>1,952</b>



# Rogers

## Assessment Property Record Card for Tax Year 2026

Data provided by LISA DELOZIER County Assessor

Date 04/16/2026  
Time 23:40:54  
Page 4

660021476

### Outbuildings/Site Improvements

Building Image	Code	Description	Dimensions	Floor	Roofing	Total Units
	SHDS	Shed - Small	10x16x6	Concrete	Composition Shingle	160
	Qual	3	Cond 3	Year 1980	Eff Age 35	
		<b>Valuation Summary</b>	<b>Modifier Total</b>	<b>RCN</b>	<b>Depr (80% Phys/ % Func)</b>	<b>RCNLD</b>
		Base Cost (22.35 x 160)	3,576		3,576	2,861
						715