



Rogers

Assessment Property Record Card for Tax Year 2026

Data provided by LISA DELOZIER County Assessor

Date 04/17/2026
Time 04:32:46
Page 1

| Assessment Data | | | | | Primary Image | | | | |
|--|----------------------------|----------------------|---------------|-------------|---|---------------|---------------|--------------|--|
| Account | 660021776 | | | |  <p>660021776_003.JPG 12/9/2025</p> | | | | |
| Parcel ID | 20N17E-26-1-00000-000-0000 | | | | | | | | |
| Cadastral ID | 26-20-17-01200 | | | | | | | | |
| Property Type | REAL - Real Property | | | | | | | | |
| Property Class | RA | VI Area | 3 | | | | | | |
| Tax Area | 2 - INOLA RURAL | | | | | | | | |
| Name ID | 329453 | | | | | | | | |
| DAY, CARL W & SHALYN | | | | | | | | | |
| 6805 S 427 RD PRYOR OK 74361-0000 | | | | | | | | | |
| Parcel Location | | | | | | | | | |
| Situs | 20582 E 570 RD | | | | | | | | |
| Subdivision | | | | | | | | | |
| Lot/Block | / | Parcel Size | 26.59 - Acres | | | | | | |
| Sec/Twn/Rng | 26 / 20 / 17 / 1 | | | | | | | | |
| Neighborhood | 2017 - UNPLATTED LAND | | | | | | | | |
| School District | S005 - INOLA SCHOOLS | | | | | | | | |
| Legal Description Lat/Long: 36.18919872 -95.46555461 | | | | | | | | | |
| TR DESC AS BEG NW/C NE; S89.5905E 686.07'; S00.1236W 947.98'; S04.0421E 236.78'; N89.2434E 228.92'; S00.0434E 334.45'; S84.5937W 888.58'; N14.2537W 197.14'; N00.1617E 741.18'; N00.1034E 661.88' TO POB | | | | | | | | | |
| Building Permits | | | | | | | | | |
| Number | Description | | Opened | Closed | Amount | | | | |
| R11 | R11 SWIDE | | 06/2010 | 11/2010 | | | | | |
| Exemptions | | | | | | | | | |
| Code | Type | Active | Maximum | Exemption | | | | | |
| H | Homestead | No | 1,000 | | | | | | |
| Sale History | | | | | | | | | |
| Bk/Pg | Grantor | | Date | Price | Code | | | | |
| / | PADGETT, SHANNON M | | 11/21/2019 | 135,000 | YES | | | | |
| 1631/350 | PADGETT, BILLIE R & | | 10/21/2004 | 219,000 | 4 | | | | |
| 893/353 | PADGETT, BONNIE MAY | | 08/18/1992 | 69,500 | No | | | | |
| Parcel Valuation | | | | | | | | | |
| Source | REAL | Fair Cash | Capped | Asmnt Level | Assessed | Levy Rate | 80.060 | Current Tax | |
| Remove Cap | 2020 | Land Value | 5,476 | 5,476 | 11% | 602 | Assessed | 6,676 534.48 | |
| Year Frozen | 0 | Improvements | 65,293 | 55,217 | | 6,074 | Penalty | 0 | |
| Uncapped Value | 0 | Mobile Home | 0 | 0 | | 0 | Exemption | 0 0.00 | |
| TIF Project ID | 0 | Total Value | 70,769 | 60,693 | | 6,676 | Total Taxable | 6,676 534.00 | |
| Assessment History | | | | | | | | | |
| Tax Year | Statement Number | Billed Owner | Tax Area | Total Value | Exemptions | Taxable Value | Billed Tax | | |
| 2025 | 2025-660021776 | DAY, CARL W & SHALYN | 2 | 58,926 | 0 | 6,482 | 519.00 | | |
| 2024 | 2024-660021776 | DAY, CARL W & SHALYN | 2 | 63,359 | 0 | 6,725 | 541.00 | | |
| 2023 | 2023-660021776 | DAY, CARL W & SHALYN | 2 | 59,356 | 0 | 6,529 | 526.00 | | |
| 2022 | 2022-660021776 | DAY, CARL W & SHALYN | 2 | 60,534 | 0 | 6,658 | 540.00 | | |
| 2021 | 2021-660021776 | DAY, CARL W & SHALYN | 2 | 65,761 | 0 | 7,233 | 580.00 | | |
| 2020 | 2020-660021776 | DAY, CARL W & SHALYN | 2 | 66,028 | 0 | 7,263 | 587.00 | | |
| 2019 | 2019-660021776 | PADGETT, BILLIE E & | 2 | 84,587 | 1000 | 7,380 | 610.00 | | |
| 2018 | 2018-660021776 | PADGETT, BILLIE E & | 2 | 111,357 | 1000 | 9,480 | 791.00 | | |
| 2017 | 2017-660021776 | PADGETT, BILLIE E & | 2 | 113,055 | 1000 | 9,174 | 772.00 | | |
| 2016 | 2016-660021776 | PADGETT, BILLIE E & | 2 | 109,045 | 1000 | 8,878 | 755.00 | | |
| 2015 | 2015-660021776 | PADGETT, BILLIE E & | 2 | 109,098 | 1000 | 8,590 | 745.00 | | |
| 2014 | 2014-660021776 | PADGETT, BILLIE E & | 2 | 110,639 | 1000 | 8,311 | 746.00 | | |
| 2013 | 2013-660021776 | PADGETT, BILLIE E & | 2 | 84,437 | 1000 | 8,040 | 677.00 | | |



Rogers

Assessment Property Record Card for Tax Year 2026

Data provided by LISA DELOZIER County Assessor

Date 04/17/2026
Time 04:32:46
Page 2

| Lot Data | Units-Buildable - UNPLATTED LAND (UNITS BUILDABLE) | Primary Image |
|-----------------|--|---------------|
| Lot Size | | |
| Lot Count | | |
| Units Buildable | | |
| Non-Ag Acres | 0 | |
| Topography | | |
| Street Access | | |
| Utilities | | |
| Amenities | LAND QUALITY | |
| Method | Units-Buildable | |
| Base Lot Value | | |
| Factor Value | | |
| Adjustments | | |
| Lot Value | | |

| Residential Data | |
|------------------|---|
| Type | 1 Single Family Residence |
| Condition | 3.5 - Average |
| Quality | 2 - Fair |
| Architecture | TRAD TRADITIONAL |
| Style | 62% 1 1/2 Story Finished 38% One Story |
| Exterior Wall | 50% Veneer, Stone 50% Frame, Siding, Wood |
| Base/Total Area | 1,164 / 1,404 |
| Style | 62% 1 1/2 Story Finished - 38% One Story |
| HVAC | |
| Roof Cover | 1 Composition Shingle |
| Area on Slab | 0 |
| Fixture/RghIn | 4 / |
| Bed/F/H Bath | 2 / 1.0 / |
| Basement Area | |
| Garage Type | |
| Remodel | |
| Year/Eff Age | 1950 / 52 |

| GRM Approach | |
|-----------------|------|
| GRM Code | |
| Gross Rent | 0.00 |
| Indicated Value | |

| Multiple Regression | |
|---------------------|--|
| MRA Code | |
| Adjusted R | |
| Indicated Value | |

| Direct Comparables | |
|--------------------|------------|
| Selection Model | 1 Res |
| Adjustment Model | A2 AO Test |
| Comparables | |
| Indicated Value | |

| Cost Approach | | | | Manual : 01/2025 | | | |
|---------------|-----------|---------------------|-----------|------------------|--|--|--|
| Base Cost | 89.75 | Total Misc Impr | + 12,811 | | | | |
| Roofing Adj | + 3.41 | Garage Cost | + 0 | | | | |
| Subfloor Adj | + 1.95 | Total RCN | = 151,358 | | | | |
| Heat/Cool Adj | + 0.00 | Depreciation (60%) | - 90,815 | | | | |
| Plumbing Adj | + 3.57 | Lump Sums | + 0 | | | | |
| Basement Adj | + 0.00 | RCNLD | = 60,543 | | | | |
| Adj Base Cost | = 98.68 | Lot Value | + 0 | | | | |
| Total Area | x 1,404 | Indicated Value | = 60,543 | | | | |
| Adjusted Cost | = 138,547 | Value Per SqFt | 43.12 | | | | |

| Value Reconciliation | | | |
|----------------------|---------------|-------|----------------------|
| Selected Approach | Cost Approach | | |
| Improvements | 60,543 | | |
| Lot Value | | | |
| Indicated Value | 60,543 | 43.12 | Per SqFt |
| Agland Value | 5,476 | | |
| Site Improvements | 4,750 | | |
| Total Value | 70,769 | 50.41 | Total Value Per SqFt |

| Miscellaneous Improvements | | | | | | | | |
|----------------------------|-----------------------------|-----------|-------|--------|-------|-----------|------|-------|
| Code | Description | Sketch ID | Size | Year | Units | Unit Cost | Depr | Value |
| SHLT | STORM SHELTER | 0 | | 1 2005 | 1 | 0.00 | | |
| EPSW | ENCLOSED PORCH - SOLID WALL | 52550 | 18x10 | | 180 | 54.50 | | 9,810 |
| PRCH | Slab Porch - Covered | 150893 | 24x6 | | 144 | 20.84 | | 3,001 |



Rogers
Assessment Property Record Card for Tax Year 2026

Data provided by LISA DELOZIER County Assessor

Date 04/17/2026
 Time 04:32:46
 Page 3

Sketch Image

660021776

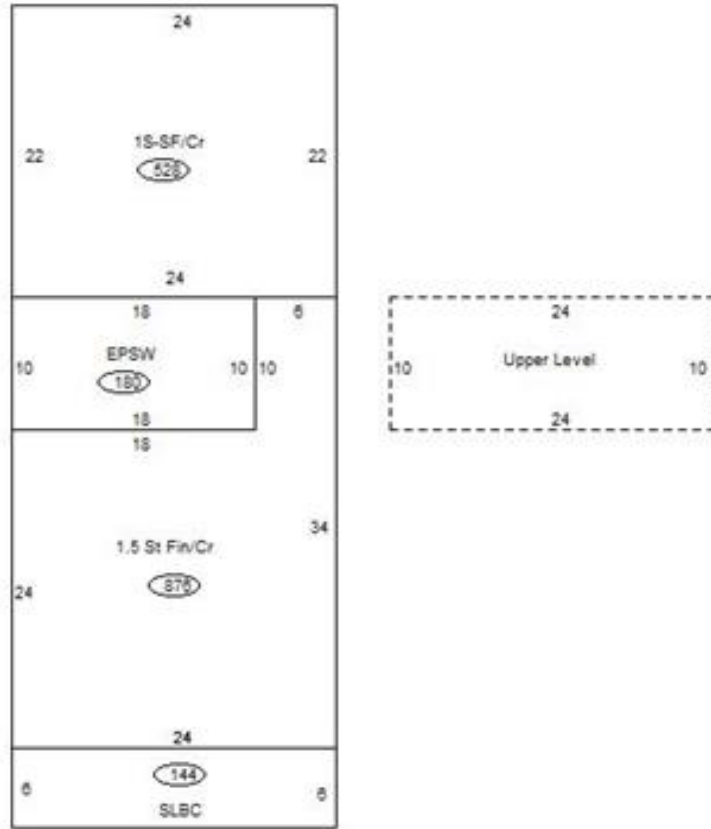

Sketch Vector Information

| Sequence | Code | Type | Built Over | Scale | Section Label | Base Area | Multiplier | Total Area |
|----------------------------|------|------|------------|-------|---------------|--------------|------------|--------------|
| 1 | R | 5 | Crawl | 13 | 1.5 St Fin/Cr | 636 | 1.377 | 876 |
| 2 | U | ^UL | Overhang | 13 | Upper Level | 240 | 1.000 | 240 |
| 3 | M | EPSW | | 13 | EPSW | 180 | 1.000 | 180 |
| 4 | R | 1 | Crawl | 13 | 1S-SF/Cr | 528 | 1.000 | 528 |
| 5 | M | PRCH | | 13 | SLBC | 144 | 1.000 | 144 |
| Total Building Area | | | | | | 1,164 | | 1,404 |



Rogers

Assessment Property Record Card for Tax Year 2026

Data provided by LISA DELOZIER County Assessor

Date 04/17/2026
Time 04:32:46
Page 4

660021776

Outbuildings/Site Improvements

| Building Image | Code | Description | Dimensions | Floor | Roofing | Total Units |
|----------------|--------------------------|--------------------------|-----------------------|------------|---------------------------------|--------------|
| | PCPT | Carport - Portable - NCV | 18x20x8 | Base | Formed Metal | 360 |
| | Qual | 3 | Cond 3 | Year 2015 | Eff Age 8 | |
| | Valuation Summary | | Modifier Total | RCN | Depr (100% Phys/ % Func) | RCNLD |
| | | Base Cost (4.61 x 360) | 1,660 | | 1,660 | 1,660 |
| | SHDS | Shed - Small | 8x8x8 | Plank | Composition Shingle | 64 |
| | Qual | 2 | Cond 2 | Year 2000 | Eff Age 26 | |
| | Valuation Summary | | Modifier Total | RCN | Depr (70% Phys/ % Func) | RCNLD |
| | | Base Cost (26.90 x 64) | 1,722 | | 1,722 | 1,205 |
| | LOAF | LOAFING SHED | 10x16x8 | Dirt | Formed Metal | 160 |
| | Qual | 2 | Cond 2 | Year 1995 | Eff Age 31 | |
| | Valuation Summary | | Modifier Total | RCN | Depr (78% Phys/ % Func) | RCNLD |
| | | Base Cost (6.08 x 160) | 973 | | 973 | 759 |
| | LOAF | LOAFING SHED | 10x16x8 | Dirt | Formed Metal | 160 |
| | Qual | 2 | Cond 2 | Year 1995 | Eff Age 31 | |
| | Valuation Summary | | Modifier Total | RCN | Depr (78% Phys/ % Func) | RCNLD |
| | | Base Cost (6.08 x 160) | 973 | | 973 | 759 |
| | PCPT | Carport - Portable - NCV | 10x15x8 | Dirt | Formed Metal | 150 |
| | Qual | 3 | Cond 3 | Year 1990 | Eff Age 27 | |
| | Valuation Summary | | Modifier Total | RCN | Depr (100% Phys/ % Func) | RCNLD |
| | | Base Cost (4.67 x 150) | 701 | | 701 | 701 |
| | LOAF | LOAFING SHED | 14x24x8 | Dirt | Galvanized Metal | 336 |
| | Qual | 3 | Cond 3 | Year 1990 | Eff Age 27 | |
| | Valuation Summary | | Modifier Total | RCN | Depr (71% Phys/ % Func) | RCNLD |
| | | Base Cost (6.64 x 336) | 2,231 | | 2,231 | 1,584 |
| | PATC | Patio - Covered | 24x8x8 | Concrete | Composition Shingle | 192 |
| | Qual | 3 | Cond 3 | Year 1985 | Eff Age 31 | |
| | Valuation Summary | | Modifier Total | RCN | Depr (79% Phys/ % Func) | RCNLD |
| | | Base Cost (17.67 x 192) | 3,393 | | 3,393 | 2,680 |



Rogers

Assessment Property Record Card for Tax Year 2026

Data provided by LISA DELOZIER County Assessor

Date 04/17/2026
 Time 04:32:47
 Page 5

660021776

Outbuildings/Site Improvements

| Building Image | Code | Description | Dimensions | Floor | Roofing | Total Units |
|--|------|--------------------------|-----------------------|------------|--------------------------------|--------------|
|  | SHDS | Shed - Small | 20x24x8 | Concrete | Composition Shingle | 480 |
| | Qual | 4 | Cond 3 | Year 1985 | Eff Age 31 | |
| | | Valuation Summary | Modifier Total | RCN | Depr (78% Phys/ % Func) | RCNLD |
| | | Base Cost (23.15 x 480) | 11,112 | 11,112 | 8,667 | 2,445 |



Rogers

Assessment Property Record Card for Tax Year 2026

Data provided by LISA DELOZIER County Assessor

Date 04/17/2026
Time 04:32:47
Page 6

Agland Inventory

660021776

| Soi | Description | Land Use | LPI | Adj Type | Adj Code | Acres | Use/Acre | Mkt/Acre | Use Value | Market Value |
|-----------------------|---------------------------|----------|-----|----------|----------|--------|----------|----------|-----------|--------------|
| DNB | DENNIS SILT LOAM 1-3% SLO | NTV PST | 80 | | | 15.000 | 192 | 192 | 2,880 | 2,880 |
| NTV PST Totals | | | | | | 15.000 | | | 2,880 | 2,880 |
| CHB | CHOTEAU SILT LOAM 1-3% SL | IMP PST | 80 | | | 11.590 | 224 | 224 | 2,596 | 2,596 |
| IMP PST Totals | | | | | | 11.590 | | | 2,596 | 2,596 |
| Total Agland | | | | | | 26.590 | | | 5,476 | 5,476 |