



Rogers

Assessment Property Record Card for Tax Year 2026

Data provided by LISA DELOZIER County Assessor

Date 04/16/2026
 Time 21:39:40
 Page 1

Assessment Data					Primary Image																																																																																																																				
Account 660021834 Parcel ID 000000-00-0-00207-003-0006 Cadastral ID 26-21-14-02540 Property Type REAL - Real Property Property Class RRP VI Area 4 Tax Area 3 - OWASSO RURAL/NO FIRE Name ID 127154 HARMON, CHRISTOPHER & PATRICIA REVOCABLE TRUST 16220 E 82ND ST NORTH OWASSO OK 74055-0000 Parcel Location Situs 16220 E 82ND ST N Subdivision COUNTRY BRIER Lot/Block 0006 / 0003 Parcel Size 1 - Lots Sec/Twn/Rng 26 / 21 / 14 / 5 Neighborhood 1212 - R-V04-SW OWASSO School District S021 - OWASSO SCHOOLS					<p>\\tsclient\TCASEY\CASEY BOOTH RESIDENTIAL VI\2022-8-9\IM 8/9/2022</p>																																																																																																																				
Legal Description Lat/Long: 36.27516804 -95.79225606																																																																																																																									
LOT 6 LESS BEG ELY COR, NWLY 205.42' FOR 17', S 52-53-02 W 197 67' TO SLY/C N 57-44-12 E ALG E/BNDRY/L 200' TO POB BLOCK 3 COUNTRY BRIER					Building Permits <table border="1"> <thead> <tr> <th>Number</th> <th>Description</th> <th>Opened</th> <th>Closed</th> <th>Amount</th> </tr> </thead> <tbody> <tr> <td> </td> <td> </td> <td> </td> <td> </td> <td> </td> </tr> </tbody> </table>					Number	Description	Opened	Closed	Amount																																																																																																											
Number	Description	Opened	Closed	Amount																																																																																																																					
Exemptions <table border="1"> <thead> <tr> <th>Code</th> <th>Type</th> <th>Active</th> <th>Maximum</th> <th>Exemption</th> </tr> </thead> <tbody> <tr> <td>H</td> <td>Homestead</td> <td>Yes</td> <td>1,000</td> <td>1,000</td> </tr> </tbody> </table>					Code	Type	Active	Maximum	Exemption	H	Homestead	Yes	1,000	1,000	Sale History <table border="1"> <thead> <tr> <th>Bk/Pg</th> <th>Grantor</th> <th>Date</th> <th>Price</th> <th>Code</th> </tr> </thead> <tbody> <tr> <td> </td> <td> </td> <td> </td> <td> </td> <td> </td> </tr> </tbody> </table>					Bk/Pg	Grantor	Date	Price	Code																																																																																																	
Code	Type	Active	Maximum	Exemption																																																																																																																					
H	Homestead	Yes	1,000	1,000																																																																																																																					
Bk/Pg	Grantor	Date	Price	Code																																																																																																																					
Parcel Valuation <table border="1"> <thead> <tr> <th>Source</th> <th>REAL</th> <th>Fair Cash</th> <th>Capped</th> <th>Asmnt Level</th> <th>Assessed</th> <th>Levy Rate</th> <th>97.960</th> <th>Current Tax</th> </tr> </thead> <tbody> <tr> <td>Remove Cap</td> <td>0</td> <td>Land Value 121,476</td> <td>41,583</td> <td>11%</td> <td>4,574</td> <td>Assessed</td> <td>19,714</td> <td>1,931.18</td> </tr> <tr> <td>Year Frozen</td> <td>0</td> <td>Improvements 172,195</td> <td>137,635</td> <td></td> <td>15,140</td> <td>Penalty</td> <td>0</td> <td></td> </tr> <tr> <td>Uncapped Value</td> <td>0</td> <td>Mobile Home 0</td> <td>0</td> <td></td> <td>0</td> <td>Exemption</td> <td>1,000</td> <td>-98.00</td> </tr> <tr> <td>TIF Project ID</td> <td>0</td> <td>Total Value 293,671</td> <td>179,218</td> <td></td> <td>19,714</td> <td>Total Taxable</td> <td>18,714</td> <td>1,833.00</td> </tr> </tbody> </table>										Source	REAL	Fair Cash	Capped	Asmnt Level	Assessed	Levy Rate	97.960	Current Tax	Remove Cap	0	Land Value 121,476	41,583	11%	4,574	Assessed	19,714	1,931.18	Year Frozen	0	Improvements 172,195	137,635		15,140	Penalty	0		Uncapped Value	0	Mobile Home 0	0		0	Exemption	1,000	-98.00	TIF Project ID	0	Total Value 293,671	179,218		19,714	Total Taxable	18,714	1,833.00																																																																			
Source	REAL	Fair Cash	Capped	Asmnt Level	Assessed	Levy Rate	97.960	Current Tax																																																																																																																	
Remove Cap	0	Land Value 121,476	41,583	11%	4,574	Assessed	19,714	1,931.18																																																																																																																	
Year Frozen	0	Improvements 172,195	137,635		15,140	Penalty	0																																																																																																																		
Uncapped Value	0	Mobile Home 0	0		0	Exemption	1,000	-98.00																																																																																																																	
TIF Project ID	0	Total Value 293,671	179,218		19,714	Total Taxable	18,714	1,833.00																																																																																																																	
Assessment History <table border="1"> <thead> <tr> <th>Tax Year</th> <th>Statement Number</th> <th>Billed Owner</th> <th>Tax Area</th> <th>Total Value</th> <th>Exemptions</th> <th>Taxable Value</th> <th>Billed Tax</th> </tr> </thead> <tbody> <tr><td>2025</td><td>2025-660021834</td><td>HARMON, CHRISTOPHER & PATRICIA</td><td>3</td><td>284,540</td><td>1000</td><td>18,140</td><td>1,777.00</td></tr> <tr><td>2024</td><td>2024-660021834</td><td>HARMON, CHRISTOPHER & PATRICIA</td><td>3</td><td>315,000</td><td>1000</td><td>17,583</td><td>1,689.00</td></tr> <tr><td>2023</td><td>2023-660021834</td><td>HARMON, CHRISTOPHER & PATRICIA</td><td>3</td><td>213,434</td><td>1000</td><td>17,041</td><td>1,597.00</td></tr> <tr><td>2022</td><td>2022-660021834</td><td>HARMON, CHRISTOPHER R</td><td>3</td><td>215,189</td><td>1000</td><td>16,516</td><td>1,618.00</td></tr> <tr><td>2021</td><td>2021-660021834</td><td>HARMON, CHRISTOPHER R</td><td>3</td><td>213,129</td><td>1000</td><td>16,006</td><td>1,548.00</td></tr> <tr><td>2020</td><td>2020-660021834</td><td>HARMON, CHRISTOPHER R</td><td>3</td><td>211,995</td><td>1000</td><td>15,511</td><td>1,498.00</td></tr> <tr><td>2019</td><td>2019-660021834</td><td>HARMON, CHRISTOPHER R</td><td>3</td><td>202,947</td><td>1000</td><td>15,030</td><td>1,453.00</td></tr> <tr><td>2018</td><td>2018-660021834</td><td>HARMON, CHRISTOPHER R</td><td>3</td><td>203,886</td><td>1000</td><td>14,563</td><td>1,356.00</td></tr> <tr><td>2017</td><td>2017-660021834</td><td>HARMON, CHRISTOPHER R</td><td>3</td><td>187,338</td><td>1000</td><td>14,110</td><td>1,327.00</td></tr> <tr><td>2016</td><td>2016-660021834</td><td>HARMON, CHRISTOPHER R</td><td>3</td><td>183,018</td><td>1000</td><td>13,669</td><td>1,287.00</td></tr> <tr><td>2015</td><td>2015-660021834</td><td>HARMON, CHRISTOPHER R</td><td>3</td><td>178,292</td><td>1000</td><td>13,243</td><td>1,256.00</td></tr> <tr><td>2014</td><td>2014-660021834</td><td>HARMON, CHRISTOPHER R</td><td>3</td><td>176,694</td><td>1000</td><td>12,828</td><td>1,228.00</td></tr> <tr><td>2013</td><td>2013-660021834</td><td>HARMON, CHRISTOPHER R</td><td>3</td><td>168,754</td><td>1000</td><td>12,425</td><td>1,164.00</td></tr> </tbody> </table>										Tax Year	Statement Number	Billed Owner	Tax Area	Total Value	Exemptions	Taxable Value	Billed Tax	2025	2025-660021834	HARMON, CHRISTOPHER & PATRICIA	3	284,540	1000	18,140	1,777.00	2024	2024-660021834	HARMON, CHRISTOPHER & PATRICIA	3	315,000	1000	17,583	1,689.00	2023	2023-660021834	HARMON, CHRISTOPHER & PATRICIA	3	213,434	1000	17,041	1,597.00	2022	2022-660021834	HARMON, CHRISTOPHER R	3	215,189	1000	16,516	1,618.00	2021	2021-660021834	HARMON, CHRISTOPHER R	3	213,129	1000	16,006	1,548.00	2020	2020-660021834	HARMON, CHRISTOPHER R	3	211,995	1000	15,511	1,498.00	2019	2019-660021834	HARMON, CHRISTOPHER R	3	202,947	1000	15,030	1,453.00	2018	2018-660021834	HARMON, CHRISTOPHER R	3	203,886	1000	14,563	1,356.00	2017	2017-660021834	HARMON, CHRISTOPHER R	3	187,338	1000	14,110	1,327.00	2016	2016-660021834	HARMON, CHRISTOPHER R	3	183,018	1000	13,669	1,287.00	2015	2015-660021834	HARMON, CHRISTOPHER R	3	178,292	1000	13,243	1,256.00	2014	2014-660021834	HARMON, CHRISTOPHER R	3	176,694	1000	12,828	1,228.00	2013	2013-660021834	HARMON, CHRISTOPHER R	3	168,754	1000	12,425	1,164.00
Tax Year	Statement Number	Billed Owner	Tax Area	Total Value	Exemptions	Taxable Value	Billed Tax																																																																																																																		
2025	2025-660021834	HARMON, CHRISTOPHER & PATRICIA	3	284,540	1000	18,140	1,777.00																																																																																																																		
2024	2024-660021834	HARMON, CHRISTOPHER & PATRICIA	3	315,000	1000	17,583	1,689.00																																																																																																																		
2023	2023-660021834	HARMON, CHRISTOPHER & PATRICIA	3	213,434	1000	17,041	1,597.00																																																																																																																		
2022	2022-660021834	HARMON, CHRISTOPHER R	3	215,189	1000	16,516	1,618.00																																																																																																																		
2021	2021-660021834	HARMON, CHRISTOPHER R	3	213,129	1000	16,006	1,548.00																																																																																																																		
2020	2020-660021834	HARMON, CHRISTOPHER R	3	211,995	1000	15,511	1,498.00																																																																																																																		
2019	2019-660021834	HARMON, CHRISTOPHER R	3	202,947	1000	15,030	1,453.00																																																																																																																		
2018	2018-660021834	HARMON, CHRISTOPHER R	3	203,886	1000	14,563	1,356.00																																																																																																																		
2017	2017-660021834	HARMON, CHRISTOPHER R	3	187,338	1000	14,110	1,327.00																																																																																																																		
2016	2016-660021834	HARMON, CHRISTOPHER R	3	183,018	1000	13,669	1,287.00																																																																																																																		
2015	2015-660021834	HARMON, CHRISTOPHER R	3	178,292	1000	13,243	1,256.00																																																																																																																		
2014	2014-660021834	HARMON, CHRISTOPHER R	3	176,694	1000	12,828	1,228.00																																																																																																																		
2013	2013-660021834	HARMON, CHRISTOPHER R	3	168,754	1000	12,425	1,164.00																																																																																																																		



Rogers

Assessment Property Record Card for Tax Year 2026

Data provided by LISA DELOZIER County Assessor

Date 04/16/2026
Time 21:39:40
Page 2

Lot Data		Square-Foot - NBHD 1212 #1	
Lot Size			
Lot Count	1		
Units Buildable	1		
Non-Ag Acres	1.0845		
Topography			
Street Access			
Utilities			
Amenities	LAND QUALITY	0	
		0	
Method	Square-Foot		
Base Lot Value	47,240.00 x 2.57 = 121,476		
Factor Value			
Adjustments	1.0000		
Lot Value	121,476		



\\tsclient\TCASEY\CASEY BOOTH RESIDENTIAL VI\2022-8-9\IM 8/9/2022

Residential Data	
Type	1 Single Family Residence
Condition	3 - Average
Quality	3 - Average
Architecture	
Style	100% One Story
Exterior Wall	75% Veneer, Masonry 25% Frame, Siding, Wood
Base/Total Area	1,716 / 1,716
Style	100% One Story
HVAC	100% Warmed & Cooled Air
Roof Cover	1 Composition Shingle
Area on Slab	1,716
Fixture/RghIn	11 /
Bed/F/H Bath	3 / 2.0 /
Basement Area	
Garage Type	529 Attached Garage - Unfinished
Remodel	
Year/Eff Age	1982 / 33

GRM Approach

GRM Code	
Gross Rent	0.00
Indicated Value	

Multiple Regression

MRA Code	1 Test
Adjusted R	0.8445
Indicated Value	221,213 128.91 Per SqFt

Direct Comparables

Selection Model	A Adam Test
Adjustment Model	1 2022 Residential
Comparables	5
Indicated Value	305,850 Per SqFt

Value Reconciliation

Selected Approach	Cost Approach
Improvements	153,232
Lot Value	121,476
Indicated Value	274,708 160.09 Per SqFt
Agland Value	
Site Improvements	18,963
Total Value	293,671 171.14 Total Value Per SqFt

Cost Approach		Manual : 01/2025	
Base Cost	106.42	Total Misc Impr	+ 19,102
Roofing Adj	+ 4.74	Garage Cost	+ 16,658
Subfloor Adj	+ -2.33	Total RCN	= 259,715
Heat/Cool Adj	+ 12.64	Depreciation (41%)	- 106,483
Plumbing Adj	+ 9.04	Lump Sums	+ 0
Basement Adj	+ 0.00	RCNLD	= 153,232
Adj Base Cost	= 130.51	Lot Value	+ 121,476
Total Area	x 1,716	Indicated Value	= 274,708
Adjusted Cost	= 223,955	Value Per SqFt	160.09

Miscellaneous Improvements

Code	Description	Sketch ID	Size	Year	Units	Unit Cost	Depr	Value
FPR1	FIREPLACE - RESIDENTIAL 1 STORY	0		1	1	5,615.40		5,615
SHLT	STORM SHELTER	0		1	2018	0.00		
PRCH	SLAB PORCH - COVERED	52775	12x4		48	26.78		1,285
PRCH	SLAB PORCH - COVERED	52776	24x20		480	25.42		12,202



Rogers

Assessment Property Record Card for Tax Year 2026

Data provided by LISA DELOZIER County Assessor

Date 04/16/2026
 Time 21:39:40
 Page 3

Sketch Image

660021834

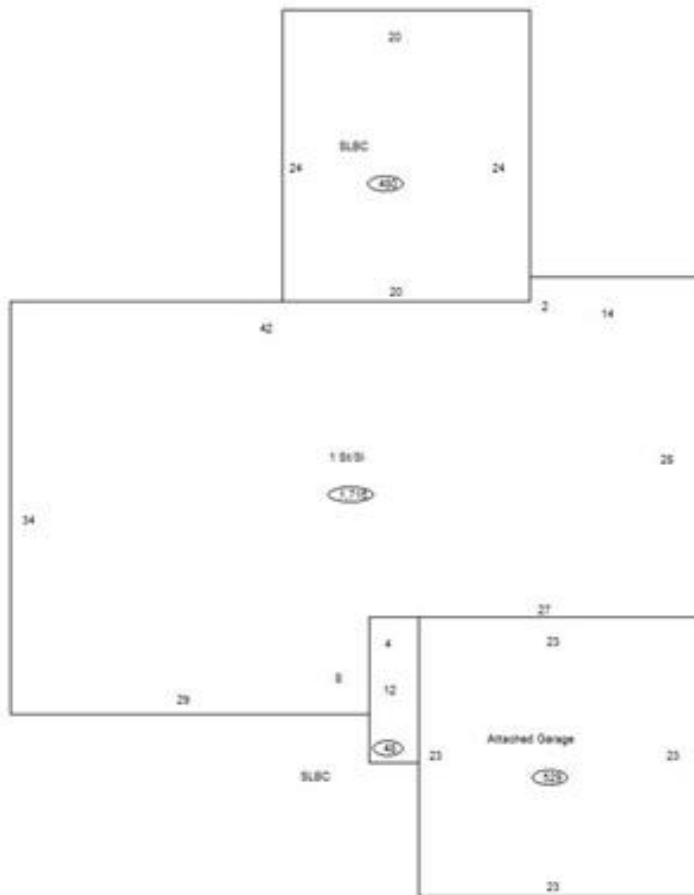

Sketch Vector Information

Sequence	Code	Type	Built Over	Scale	Section Label	Base Area	Multiplier	Total Area
1	R	1	Slab	10	1 St/SI	1,716	1.000	1,716
2	G	1		10	Attached Garage	529	1.000	529
3	M	PRCH		10	SLBC	48	1.000	48
4	M	PRCH		10	SLBC	480	1.000	480
Total Building Area						1,716		1,716



Rogers

Assessment Property Record Card for Tax Year 2026

Data provided by LISA DELOZIER County Assessor

Date 04/16/2026
 Time 21:39:40
 Page 4

660021834

Outbuildings/Site Improvements

Building Image	Code	Description	Dimensions	Floor	Roofing	Total Units
	SV	SWIM VINYL	0x0x0			1
	Qual	3	Cond 3	Year	Eff Age	
	Valuation Summary Base Cost (25,000.00 x 1) 25,000		Modifier Total	RCN 25,000	Depr (75% Phys/ % Func) 18,750	RCNLD 6,250
	UTIL	SHOP BUILDING	30x16x0			480
	Qual	3	Cond 3	Year	Eff Age 1520	
	Valuation Summary Base Cost (31.16 x 480) 14,957		Modifier Total	RCN 14,957	Depr (15% Phys/ % Func) 2,244	RCNLD 12,713