



Rogers

Assessment Property Record Card for Tax Year 2026

Data provided by LISA DELOZIER County Assessor

Date 04/16/2026
Time 21:39:41
Page 1

Assessment Data					Primary Image																																																																																																																				
Account 660021835 Parcel ID 000000-00-0-00207-003-0008 Cadastral ID 26-21-14-02550 Property Type REAL - Real Property Property Class RRP VI Area 4 Tax Area 3 - OWASSO RURAL/NO FIRE Name ID 348141 BAUER, RACHELLE 16236 E 82ND ST N OWASSO OK 74055-0000 Parcel Location Situs 16236 E 82ND ST N Subdivision COUNTRY BRIER Lot/Block 0008 / 0003 Parcel Size 1 - Lots Sec/Twn/Rng 26 / 21 / 14 / 5 Neighborhood 1212 - R-V04-SW OWASSO School District S021 - OWASSO SCHOOLS																																																																																																																									
Legal Description Lot/Long: 36.27424144 -95.79138416																																																																																																																									
Building Permits					<table border="1"> <thead> <tr> <th>Number</th> <th>Description</th> <th>Opened</th> <th>Closed</th> <th>Amount</th> </tr> </thead> <tbody> <tr> <td colspan="5"> </td> </tr> </tbody> </table>					Number	Description	Opened	Closed	Amount																																																																																																											
Number	Description	Opened	Closed	Amount																																																																																																																					
Exemptions					Sale History																																																																																																																				
<table border="1"> <thead> <tr> <th>Code</th> <th>Type</th> <th>Active</th> <th>Maximum</th> <th>Exemption</th> </tr> </thead> <tbody> <tr> <td>H</td> <td>Homestead</td> <td>No</td> <td>1,000</td> <td></td> </tr> </tbody> </table>					Code	Type	Active	Maximum	Exemption	H	Homestead	No	1,000		<table border="1"> <thead> <tr> <th>Bk/Pg</th> <th>Grantor</th> <th>Date</th> <th>Price</th> <th>Code</th> </tr> </thead> <tbody> <tr> <td>/</td> <td>DUCKETT, ANNE ELIZABETH</td> <td>09/11/2025</td> <td>330,000</td> <td>22</td> </tr> <tr> <td>964/612</td> <td>SELLER</td> <td>04/27/1994</td> <td>0</td> <td>No</td> </tr> </tbody> </table>					Bk/Pg	Grantor	Date	Price	Code	/	DUCKETT, ANNE ELIZABETH	09/11/2025	330,000	22	964/612	SELLER	04/27/1994	0	No																																																																																							
Code	Type	Active	Maximum	Exemption																																																																																																																					
H	Homestead	No	1,000																																																																																																																						
Bk/Pg	Grantor	Date	Price	Code																																																																																																																					
/	DUCKETT, ANNE ELIZABETH	09/11/2025	330,000	22																																																																																																																					
964/612	SELLER	04/27/1994	0	No																																																																																																																					
Parcel Valuation																																																																																																																									
<table border="1"> <thead> <tr> <th>Source</th> <th>REAL</th> <th>Fair Cash</th> <th>Capped</th> <th>Asmnt Level</th> <th>Assessed</th> <th>Levy Rate</th> <th>97.960</th> <th>Current Tax</th> </tr> </thead> <tbody> <tr> <td>Remove Cap</td> <td>2026</td> <td>Land Value</td> <td>117,445</td> <td>117,445</td> <td>11%</td> <td>12,919</td> <td>Assessed</td> <td>36,447 3,570.35</td> </tr> <tr> <td>Year Frozen</td> <td>2014</td> <td>Improvements</td> <td>213,894</td> <td>213,894</td> <td></td> <td>23,528</td> <td>Penalty</td> <td>0</td> </tr> <tr> <td>Uncapped Value</td> <td>0</td> <td>Mobile Home</td> <td>0</td> <td>0</td> <td></td> <td>0</td> <td>Exemption</td> <td>0 0.00</td> </tr> <tr> <td>TIF Project ID</td> <td>0</td> <td>Total Value</td> <td>331,339</td> <td>331,339</td> <td></td> <td>36,447</td> <td>Total Taxable</td> <td>36,447 3,570.00</td> </tr> </tbody> </table>		Source	REAL	Fair Cash	Capped	Asmnt Level	Assessed	Levy Rate	97.960	Current Tax	Remove Cap	2026	Land Value	117,445	117,445	11%	12,919	Assessed	36,447 3,570.35	Year Frozen	2014	Improvements	213,894	213,894		23,528	Penalty	0	Uncapped Value	0	Mobile Home	0	0		0	Exemption	0 0.00	TIF Project ID	0	Total Value	331,339	331,339		36,447	Total Taxable	36,447 3,570.00																																																																											
Source	REAL	Fair Cash	Capped	Asmnt Level	Assessed	Levy Rate	97.960	Current Tax																																																																																																																	
Remove Cap	2026	Land Value	117,445	117,445	11%	12,919	Assessed	36,447 3,570.35																																																																																																																	
Year Frozen	2014	Improvements	213,894	213,894		23,528	Penalty	0																																																																																																																	
Uncapped Value	0	Mobile Home	0	0		0	Exemption	0 0.00																																																																																																																	
TIF Project ID	0	Total Value	331,339	331,339		36,447	Total Taxable	36,447 3,570.00																																																																																																																	
Assessment History																																																																																																																									
<table border="1"> <thead> <tr> <th>Tax Year</th> <th>Statement Number</th> <th>Billed Owner</th> <th>Tax Area</th> <th>Total Value</th> <th>Exemptions</th> <th>Taxable Value</th> <th>Billed Tax</th> </tr> </thead> <tbody> <tr><td>2025</td><td>2025-660021835</td><td>BAUER, RACHELLE</td><td>3</td><td>312,954</td><td>1000</td><td>18,934</td><td>1,855.00</td></tr> <tr><td>2024</td><td>2024-660021835</td><td>DUCKETT, ANNE ELIZABETH</td><td>3</td><td>355,482</td><td>1000</td><td>18,933</td><td>1,819.00</td></tr> <tr><td>2023</td><td>2023-660021835</td><td>DUCKETT, ANNE E</td><td>3</td><td>235,580</td><td>1000</td><td>18,934</td><td>1,774.00</td></tr> <tr><td>2022</td><td>2022-660021835</td><td>DUCKETT, ELZA R &</td><td>3</td><td>235,571</td><td>1000</td><td>18,933</td><td>1,855.00</td></tr> <tr><td>2021</td><td>2021-660021835</td><td>DUCKETT, ELZA R &</td><td>3</td><td>240,464</td><td>1000</td><td>18,933</td><td>1,832.00</td></tr> <tr><td>2020</td><td>2020-660021835</td><td>DUCKETT, ELZA R &</td><td>3</td><td>239,130</td><td>1000</td><td>18,934</td><td>1,829.00</td></tr> <tr><td>2019</td><td>2019-660021835</td><td>DUCKETT, ELZA R &</td><td>3</td><td>228,461</td><td>1000</td><td>18,934</td><td>1,830.00</td></tr> <tr><td>2018</td><td>2018-660021835</td><td>DUCKETT, ELZA R &</td><td>3</td><td>235,796</td><td>1000</td><td>18,933</td><td>1,762.00</td></tr> <tr><td>2017</td><td>2017-660021835</td><td>DUCKETT, ELZA R &</td><td>3</td><td>218,808</td><td>1000</td><td>18,933</td><td>1,781.00</td></tr> <tr><td>2016</td><td>2016-660021835</td><td>DUCKETT, ELZA R &</td><td>3</td><td>213,667</td><td>1000</td><td>18,934</td><td>1,783.00</td></tr> <tr><td>2015</td><td>2015-660021835</td><td>DUCKETT, ELZA R &</td><td>3</td><td>207,617</td><td>1000</td><td>18,933</td><td>1,795.00</td></tr> <tr><td>2014</td><td>2014-660021835</td><td>DUCKETT, ELZA R &</td><td>3</td><td>208,911</td><td>1000</td><td>18,934</td><td>1,812.00</td></tr> <tr><td>2013</td><td>2013-660021835</td><td>DUCKETT, ELZA R &</td><td>3</td><td>197,998</td><td>1000</td><td>18,353</td><td>1,719.00</td></tr> </tbody> </table>										Tax Year	Statement Number	Billed Owner	Tax Area	Total Value	Exemptions	Taxable Value	Billed Tax	2025	2025-660021835	BAUER, RACHELLE	3	312,954	1000	18,934	1,855.00	2024	2024-660021835	DUCKETT, ANNE ELIZABETH	3	355,482	1000	18,933	1,819.00	2023	2023-660021835	DUCKETT, ANNE E	3	235,580	1000	18,934	1,774.00	2022	2022-660021835	DUCKETT, ELZA R &	3	235,571	1000	18,933	1,855.00	2021	2021-660021835	DUCKETT, ELZA R &	3	240,464	1000	18,933	1,832.00	2020	2020-660021835	DUCKETT, ELZA R &	3	239,130	1000	18,934	1,829.00	2019	2019-660021835	DUCKETT, ELZA R &	3	228,461	1000	18,934	1,830.00	2018	2018-660021835	DUCKETT, ELZA R &	3	235,796	1000	18,933	1,762.00	2017	2017-660021835	DUCKETT, ELZA R &	3	218,808	1000	18,933	1,781.00	2016	2016-660021835	DUCKETT, ELZA R &	3	213,667	1000	18,934	1,783.00	2015	2015-660021835	DUCKETT, ELZA R &	3	207,617	1000	18,933	1,795.00	2014	2014-660021835	DUCKETT, ELZA R &	3	208,911	1000	18,934	1,812.00	2013	2013-660021835	DUCKETT, ELZA R &	3	197,998	1000	18,353	1,719.00
Tax Year	Statement Number	Billed Owner	Tax Area	Total Value	Exemptions	Taxable Value	Billed Tax																																																																																																																		
2025	2025-660021835	BAUER, RACHELLE	3	312,954	1000	18,934	1,855.00																																																																																																																		
2024	2024-660021835	DUCKETT, ANNE ELIZABETH	3	355,482	1000	18,933	1,819.00																																																																																																																		
2023	2023-660021835	DUCKETT, ANNE E	3	235,580	1000	18,934	1,774.00																																																																																																																		
2022	2022-660021835	DUCKETT, ELZA R &	3	235,571	1000	18,933	1,855.00																																																																																																																		
2021	2021-660021835	DUCKETT, ELZA R &	3	240,464	1000	18,933	1,832.00																																																																																																																		
2020	2020-660021835	DUCKETT, ELZA R &	3	239,130	1000	18,934	1,829.00																																																																																																																		
2019	2019-660021835	DUCKETT, ELZA R &	3	228,461	1000	18,934	1,830.00																																																																																																																		
2018	2018-660021835	DUCKETT, ELZA R &	3	235,796	1000	18,933	1,762.00																																																																																																																		
2017	2017-660021835	DUCKETT, ELZA R &	3	218,808	1000	18,933	1,781.00																																																																																																																		
2016	2016-660021835	DUCKETT, ELZA R &	3	213,667	1000	18,934	1,783.00																																																																																																																		
2015	2015-660021835	DUCKETT, ELZA R &	3	207,617	1000	18,933	1,795.00																																																																																																																		
2014	2014-660021835	DUCKETT, ELZA R &	3	208,911	1000	18,934	1,812.00																																																																																																																		
2013	2013-660021835	DUCKETT, ELZA R &	3	197,998	1000	18,353	1,719.00																																																																																																																		



Rogers

Assessment Property Record Card for Tax Year 2026

Data provided by LISA DELOZIER County Assessor

Date 04/16/2026
Time 21:39:42
Page 2

Lot Data	Square-Foot - NBHD 1212 #1	Primary Image
Lot Size		
Lot Count	1	
Units Buildable	1	
Non-Ag Acres	0.9986	
Topography		
Street Access		
Utilities		
Amenities	LAND QUALITY	
	0	
	0	
Method	Square-Foot	
Base Lot Value	43,498.00 x 2.70 = 117,445	
Factor Value		
Adjustments	1.0000	
Lot Value	117,445	

Residential Data	
Type	1 Single Family Residence
Condition	3 - Average
Quality	3.5 - Average
Architecture	
Style	100% One Story
Exterior Wall	100% Veneer, Masonry
Base/Total Area	2,206 / 2,206
Style	100% One Story
HVAC	100% Warmed & Cooled Air
Roof Cover	1 Composition Shingle
Area on Slab	2,206
Fixture/RghIn	11 /
Bed/F/H Bath	3 / 2.0 /
Basement Area	
Garage Type	884 Attached Garage - Unfinished
Remodel	
Year/Eff Age	1980 / 35

Cost Approach		Manual : 01/2025	
Base Cost	110.38	Total Misc Impr	+ 23,190
Roofing Adj	+ 5.26	Garage Cost	+ 32,894
Subfloor Adj	+ -3.40	Total RCN	= 353,365
Heat/Cool Adj	+ 14.47	Depreciation (43%)	- 151,947
Plumbing Adj	+ 8.05	Lump Sums	+ 0
Basement Adj	+ 0.00	RCNLD	= 201,418
Adj Base Cost	= 134.76	Lot Value	+ 117,445
Total Area	x 2,206	Indicated Value	= 318,863
Adjusted Cost	= 297,281	Value Per SqFt	144.54



\\tsclient\TCASEY\CASEY BOOTH RESIDENTIAL VI\2022-8-9\IM 8/9/2022

GRM Approach	
GRM Code	
Gross Rent	0.00
Indicated Value	

Multiple Regression			
MRA Code	1	Test	
Adusted R	0.8445		
Indicated Value	307,669	139.47	Per SqFt

Direct Comparables	
Selection Model	A Adam Test
Adjustment Model	1 2022 Residential
Comparables	5
Indicated Value	374,130 Per SqFt

Value Reconciliation			
Selected Approach	Cost Approach		
Improvements	201,418		
Lot Value	117,445		
Indicated Value	318,863	144.54	Per SqFt
Agland Value			
Site Improvements	12,476		
Total Value	331,339	150.20	Total Value Per SqFt

Miscellaneous Improvements								
Code	Description	Sketch ID	Size	Year	Units	Unit Cost	Depr	Value
FPR1	FIREPLACE - RESIDENTIAL 1 STORY	0		1	1	6,429.63		6,430
SHLT	STORM SHELTER	0		1	2015	0.00		
PRCH	SLAB PORCH - COVERED	52779	106		106	29.18		3,093
EPSW	ENCLOSED PORCH - SOLID WALL	52780	15x12		180	75.93		13,667



Rogers

Assessment Property Record Card for Tax Year 2026

Data provided by LISA DELOZIER County Assessor

Date 04/16/2026
 Time 21:39:42
 Page 3

Sketch Image

660021835

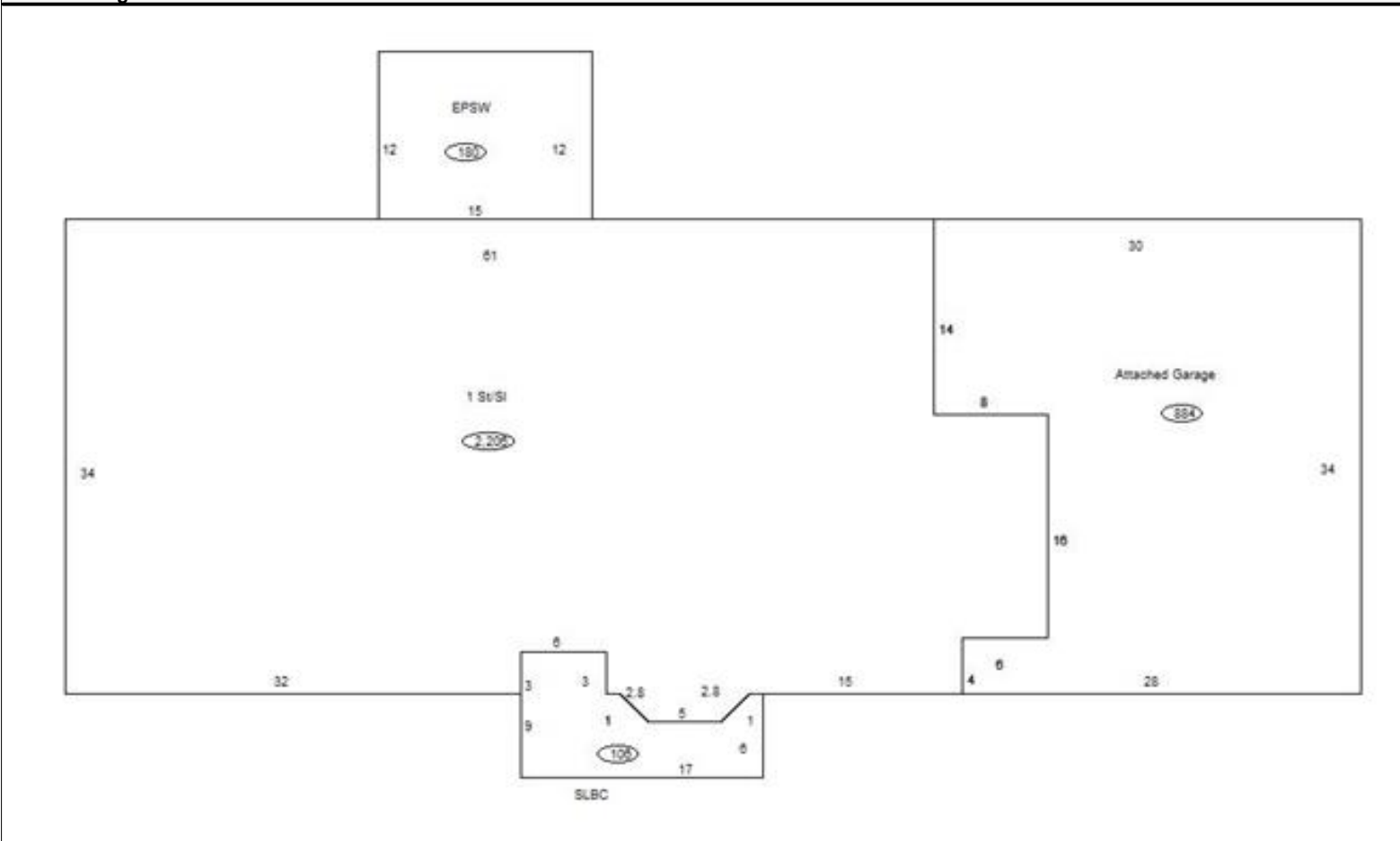

Sketch Vector Information

Sequence	Code	Type	Built Over	Scale	Section Label	Base Area	Multiplier	Total Area
1	R	1	Slab	10	1 St/SI	2,206	1.000	2,206
2	G	1		10	Attached Garage	884	1.000	884
3	M	PRCH		10	SLBC	106	1.000	106
4	M	EPSW		10	EPSW	180	1.000	180
Total Building Area						2,206		2,206



Rogers



Assessment Property Record Card for Tax Year 2026

Data provided by LISA DELOZIER County Assessor

Date 04/16/2026
 Time 21:39:42
 Page 4

660021835

Outbuildings/Site Improvements

Building Image	Code	Description	Dimensions	Floor	Roofing	Total Units	
	GRDT	GARAGE - DETACHED	24x20x0			480	
	Qual	3	Cond 3	Year	Eff Age		
	Valuation Summary		Modifier Total		RCN	Depr (35% Phys/ % Func)	RCNLD
	Base Cost (29.38 x 480)		14,102		14,102	4,936	9,166
	CPDT	CARPORT - DETACHED	13x29x0			377	
	Qual	3	Cond 3	Year	Eff Age 1520		
	Valuation Summary		Modifier Total		RCN	Depr (15% Phys/ % Func)	RCNLD
	Base Cost (10.33 x 377)		3,894		3,894	584	3,310
	STF	STG FAIR	12x12x0			144	
	Qual	2	Cond 3	Year	Eff Age 1520		
	Valuation Summary		Modifier Total		RCN	Depr (100% Phys/ % Func)	RCNLD
	Base Cost (4.68 x 144)		674		674	674	