



Rogers

Assessment Property Record Card for Tax Year 2026

Data provided by LISA DELOZIER County Assessor

Date 04/16/2026
Time 21:40:38
Page 1

Assessment Data					Primary Image																																																																																																																				
Account 660021879 Parcel ID 000000-00-0-00207-006-0015 Cadastral ID 26-21-14-03000 Property Type REAL - Real Property Property Class RRP VI Area 4 Tax Area 3 - OWASSO RURAL/NO FIRE Name ID 128034 THOMPSON, TONY M 16215 E 83RD ST NORTH OWASSO OK 74055-0000 Parcel Location Situs 16215 83RD ST Subdivision COUNTRY BRIER Lot/Block 0015 / 0006 Parcel Size 1 - Lots Sec/Twn/Rng 26 / 21 / 14 / 5 Neighborhood 1212 - R-V04-SW OWASSO School District S021 - OWASSO SCHOOLS																																																																																																																									
Legal Description Lot/Long: 36.27658784 -95.79167654																																																																																																																									
Building Permits					\\tsclient\TCASEY\CASEY BOOTH RESIDENTIAL VI\2022-8-9\IM 8/9/2022																																																																																																																				
Exemptions					Sale History																																																																																																																				
<table border="1"> <thead> <tr> <th>Code</th> <th>Type</th> <th>Active</th> <th>Maximum</th> <th>Exemption</th> </tr> </thead> <tbody> <tr> <td>H</td> <td>Homestead</td> <td>Yes</td> <td>1,000</td> <td>1,000</td> </tr> </tbody> </table>					Code	Type	Active	Maximum	Exemption	H	Homestead	Yes	1,000	1,000	<table border="1"> <thead> <tr> <th>Number</th> <th>Description</th> <th>Opened</th> <th>Closed</th> <th>Amount</th> </tr> </thead> <tbody> <tr> <td> </td> <td> </td> <td> </td> <td> </td> <td> </td> </tr> </tbody> </table>					Number	Description	Opened	Closed	Amount																																																																																																	
Code	Type	Active	Maximum	Exemption																																																																																																																					
H	Homestead	Yes	1,000	1,000																																																																																																																					
Number	Description	Opened	Closed	Amount																																																																																																																					
Parcel Valuation					<table border="1"> <thead> <tr> <th>Source</th> <th>REAL</th> <th>Fair Cash</th> <th>Capped</th> <th>Asmnt Level</th> <th>Assessed</th> <th>Levy Rate</th> <th>97.960</th> <th>Current Tax</th> </tr> </thead> <tbody> <tr> <td>Remove Cap</td> <td>0</td> <td>Land Value 141,533</td> <td>46,309</td> <td>11%</td> <td>5,094</td> <td>Assessed</td> <td>19,072</td> <td>1,868.29</td> </tr> <tr> <td>Year Frozen</td> <td>0</td> <td>Improvements 149,801</td> <td>127,070</td> <td></td> <td>13,978</td> <td>Penalty</td> <td>0</td> <td></td> </tr> <tr> <td>Uncapped Value</td> <td>0</td> <td>Mobile Home 0</td> <td>0</td> <td></td> <td>0</td> <td>Exemption</td> <td>1,000</td> <td>-98.00</td> </tr> <tr> <td>TIF Project ID</td> <td>0</td> <td>Total Value 291,334</td> <td>173,379</td> <td></td> <td>19,072</td> <td>Total Taxable</td> <td>18,072</td> <td>1,770.00</td> </tr> </tbody> </table>					Source	REAL	Fair Cash	Capped	Asmnt Level	Assessed	Levy Rate	97.960	Current Tax	Remove Cap	0	Land Value 141,533	46,309	11%	5,094	Assessed	19,072	1,868.29	Year Frozen	0	Improvements 149,801	127,070		13,978	Penalty	0		Uncapped Value	0	Mobile Home 0	0		0	Exemption	1,000	-98.00	TIF Project ID	0	Total Value 291,334	173,379		19,072	Total Taxable	18,072	1,770.00																																																																			
Source	REAL	Fair Cash	Capped	Asmnt Level	Assessed	Levy Rate	97.960	Current Tax																																																																																																																	
Remove Cap	0	Land Value 141,533	46,309	11%	5,094	Assessed	19,072	1,868.29																																																																																																																	
Year Frozen	0	Improvements 149,801	127,070		13,978	Penalty	0																																																																																																																		
Uncapped Value	0	Mobile Home 0	0		0	Exemption	1,000	-98.00																																																																																																																	
TIF Project ID	0	Total Value 291,334	173,379		19,072	Total Taxable	18,072	1,770.00																																																																																																																	
Assessment History					<table border="1"> <thead> <tr> <th>Tax Year</th> <th>Statement Number</th> <th>Billed Owner</th> <th>Tax Area</th> <th>Total Value</th> <th>Exemptions</th> <th>Taxable Value</th> <th>Billed Tax</th> </tr> </thead> <tbody> <tr><td>2025</td><td>2025-660021879</td><td>THOMPSON, TONY M</td><td>3</td><td>283,710</td><td>1000</td><td>17,517</td><td>1,716.00</td></tr> <tr><td>2024</td><td>2024-660021879</td><td>THOMPSON, TONY M</td><td>3</td><td>317,645</td><td>1000</td><td>16,978</td><td>1,631.00</td></tr> <tr><td>2023</td><td>2023-660021879</td><td>THOMPSON, TONY M</td><td>3</td><td>183,384</td><td>1000</td><td>16,454</td><td>1,542.00</td></tr> <tr><td>2022</td><td>2022-660021879</td><td>THOMPSON, TONY M</td><td>3</td><td>185,589</td><td>1000</td><td>15,945</td><td>1,562.00</td></tr> <tr><td>2021</td><td>2021-660021879</td><td>THOMPSON, TONY M</td><td>3</td><td>192,994</td><td>1000</td><td>15,452</td><td>1,495.00</td></tr> <tr><td>2020</td><td>2020-660021879</td><td>THOMPSON, TONY M</td><td>3</td><td>192,173</td><td>1000</td><td>14,973</td><td>1,446.00</td></tr> <tr><td>2019</td><td>2019-660021879</td><td>THOMPSON, TONY M</td><td>3</td><td>184,258</td><td>1000</td><td>14,508</td><td>1,402.00</td></tr> <tr><td>2018</td><td>2018-660021879</td><td>THOMPSON, TONY M</td><td>3</td><td>188,622</td><td>1000</td><td>14,056</td><td>1,308.00</td></tr> <tr><td>2017</td><td>2017-660021879</td><td>THOMPSON, TONY M</td><td>3</td><td>172,343</td><td>1000</td><td>13,617</td><td>1,281.00</td></tr> <tr><td>2016</td><td>2016-660021879</td><td>THOMPSON, TONY M</td><td>3</td><td>168,362</td><td>1000</td><td>13,191</td><td>1,242.00</td></tr> <tr><td>2015</td><td>2015-660021879</td><td>THOMPSON, TONY M</td><td>3</td><td>163,731</td><td>1000</td><td>12,778</td><td>1,212.00</td></tr> <tr><td>2014</td><td>2014-660021879</td><td>THOMPSON, TONY M</td><td>3</td><td>166,464</td><td>1000</td><td>12,377</td><td>1,185.00</td></tr> <tr><td>2013</td><td>2013-660021879</td><td>THOMPSON, TONY M</td><td>3</td><td>160,060</td><td>1000</td><td>11,988</td><td>1,123.00</td></tr> </tbody> </table>					Tax Year	Statement Number	Billed Owner	Tax Area	Total Value	Exemptions	Taxable Value	Billed Tax	2025	2025-660021879	THOMPSON, TONY M	3	283,710	1000	17,517	1,716.00	2024	2024-660021879	THOMPSON, TONY M	3	317,645	1000	16,978	1,631.00	2023	2023-660021879	THOMPSON, TONY M	3	183,384	1000	16,454	1,542.00	2022	2022-660021879	THOMPSON, TONY M	3	185,589	1000	15,945	1,562.00	2021	2021-660021879	THOMPSON, TONY M	3	192,994	1000	15,452	1,495.00	2020	2020-660021879	THOMPSON, TONY M	3	192,173	1000	14,973	1,446.00	2019	2019-660021879	THOMPSON, TONY M	3	184,258	1000	14,508	1,402.00	2018	2018-660021879	THOMPSON, TONY M	3	188,622	1000	14,056	1,308.00	2017	2017-660021879	THOMPSON, TONY M	3	172,343	1000	13,617	1,281.00	2016	2016-660021879	THOMPSON, TONY M	3	168,362	1000	13,191	1,242.00	2015	2015-660021879	THOMPSON, TONY M	3	163,731	1000	12,778	1,212.00	2014	2014-660021879	THOMPSON, TONY M	3	166,464	1000	12,377	1,185.00	2013	2013-660021879	THOMPSON, TONY M	3	160,060	1000	11,988	1,123.00
Tax Year	Statement Number	Billed Owner	Tax Area	Total Value	Exemptions	Taxable Value	Billed Tax																																																																																																																		
2025	2025-660021879	THOMPSON, TONY M	3	283,710	1000	17,517	1,716.00																																																																																																																		
2024	2024-660021879	THOMPSON, TONY M	3	317,645	1000	16,978	1,631.00																																																																																																																		
2023	2023-660021879	THOMPSON, TONY M	3	183,384	1000	16,454	1,542.00																																																																																																																		
2022	2022-660021879	THOMPSON, TONY M	3	185,589	1000	15,945	1,562.00																																																																																																																		
2021	2021-660021879	THOMPSON, TONY M	3	192,994	1000	15,452	1,495.00																																																																																																																		
2020	2020-660021879	THOMPSON, TONY M	3	192,173	1000	14,973	1,446.00																																																																																																																		
2019	2019-660021879	THOMPSON, TONY M	3	184,258	1000	14,508	1,402.00																																																																																																																		
2018	2018-660021879	THOMPSON, TONY M	3	188,622	1000	14,056	1,308.00																																																																																																																		
2017	2017-660021879	THOMPSON, TONY M	3	172,343	1000	13,617	1,281.00																																																																																																																		
2016	2016-660021879	THOMPSON, TONY M	3	168,362	1000	13,191	1,242.00																																																																																																																		
2015	2015-660021879	THOMPSON, TONY M	3	163,731	1000	12,778	1,212.00																																																																																																																		
2014	2014-660021879	THOMPSON, TONY M	3	166,464	1000	12,377	1,185.00																																																																																																																		
2013	2013-660021879	THOMPSON, TONY M	3	160,060	1000	11,988	1,123.00																																																																																																																		



Rogers

Assessment Property Record Card for Tax Year 2026

Data provided by LISA DELOZIER County Assessor

Date 04/16/2026
Time 21:40:39
Page 2

Lot Data	Square-Foot - NBHD 1212 #1	Primary Image
Lot Size		
Lot Count	1	
Units Buildable	1	
Non-Ag Acres	1.523	
Topography		
Street Access		
Utilities		
Amenities	LAND QUALITY	
	0	
	0	
Method	Square-Foot	
Base Lot Value	66,342.00 x 2.13 = 141,533	
Factor Value		
Adjustments	1.0000	
Lot Value	141,533	

Residential Data	
Type	1 Single Family Residence
Condition	3 - Average
Quality	3 - Average
Architecture	
Style	100% One Story
Exterior Wall	100% Veneer, Stone
Base/Total Area	1,624 / 1,624
Style	100% One Story
HVAC	100% Warmed & Cooled Air
Roof Cover	1 Composition Shingle
Area on Slab	1,624
Fixture/RghIn	11 /
Bed/F/H Bath	3 / 2.0 /
Basement Area	
Garage Type	708 Attached Garage - Unfinished
Remodel	
Year/Eff Age	1978 / 36

Cost Approach				Manual : 01/2025			
Base Cost	115.41	Total Misc Impr	+	14,171			
Roofing Adj	+ 4.79	Garage Cost	+	21,148			
Subfloor Adj	+ -2.31	Total RCN	=	262,809			
Heat/Cool Adj	+ 12.64	Depreciation (43%)	-	113,008			
Plumbing Adj	+ 9.55	Lump Sums	+	0			
Basement Adj	+ 0.00	RCNLD	=	149,801			
Adj Base Cost	= 140.08	Lot Value	+	141,533			
Total Area	x 1,624	Indicated Value	=	291,334			
Adjusted Cost	= 227,490	Value Per SqFt		179.39			



\\tsclient\TCASEY\CASEY BOOTH RESIDENTIAL VI\2022-8-9\IM 8/9/2022

GRM Approach	
GRM Code	
Gross Rent	0.00
Indicated Value	

Multiple Regression			
MRA Code	1	Test	
Adusted R	0.8445		
Indicated Value	207,676	127.88	Per SqFt

Direct Comparables			
Selection Model	A	Adam Test	
Adjustment Model	1	2022 Residential	
Comparables	5		
Indicated Value	301,200		Per SqFt

Value Reconciliation			
Selected Approach	Cost Approach		
Improvements	149,801		
Lot Value	141,533		
Indicated Value	291,334	179.39	Per SqFt
Agland Value			
Site Improvements			
Total Value	291,334	179.39	Total Value Per SqFt

Miscellaneous Improvements								
Code	Description	Sketch ID	Size	Year	Units	Unit Cost	Depr	Value
FPR1	FIREPLACE - RESIDENTIAL 1 STORY	0		1	1	5,615.40		5,615
PRCH	SLAB PORCH - COVERED	52976	16x12		192	26.33		5,055
PRCH	SLAB PORCH - COVERED	52977	33x4		132	26.52		3,501



Rogers

Assessment Property Record Card for Tax Year 2026

Data provided by LISA DELOZIER County Assessor

Date 04/16/2026
 Time 21:40:39
 Page 3

Sketch Image

660021879

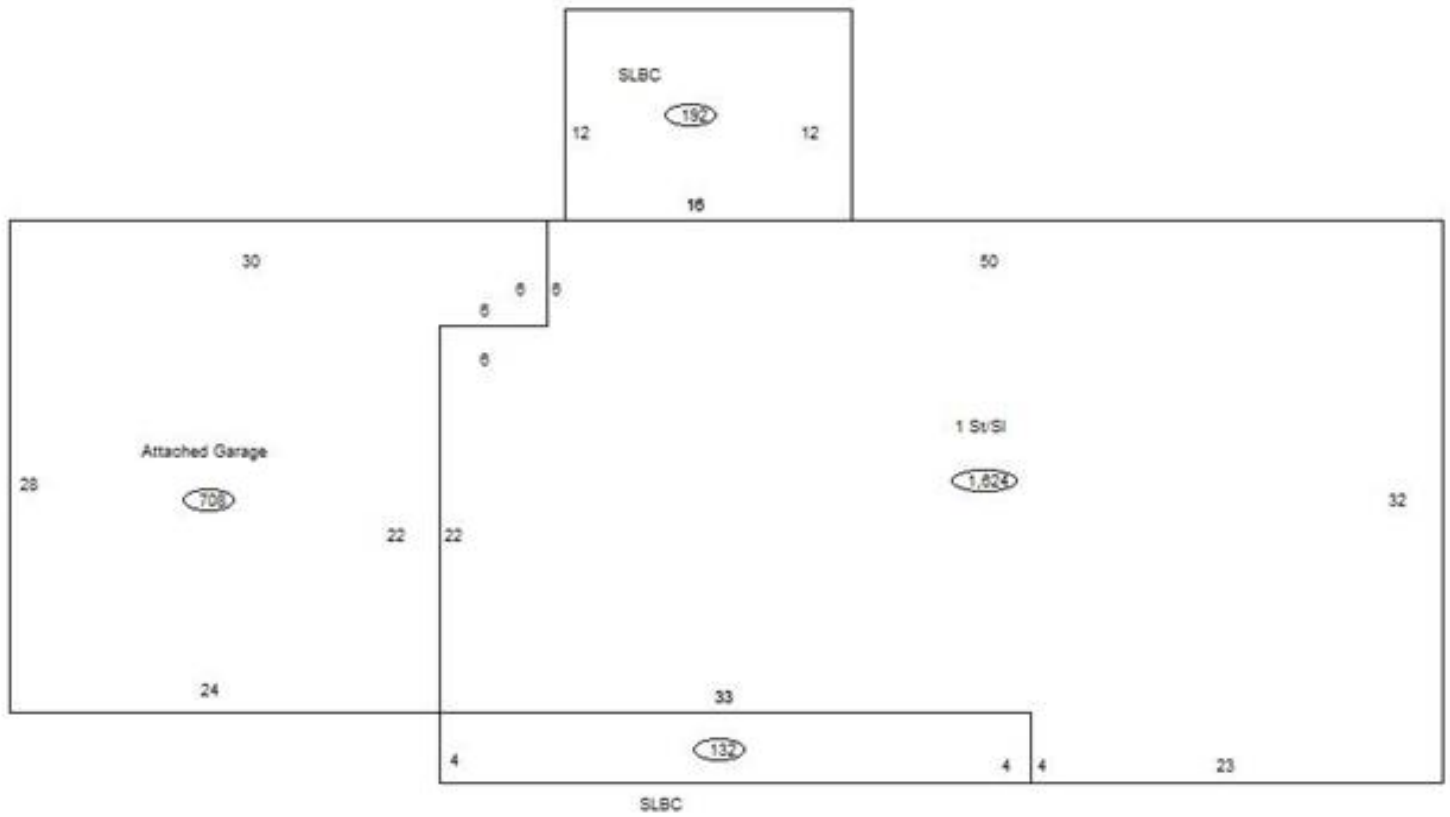

Sketch Vector Information

Sequence	Code	Type	Built Over	Scale	Section Label	Base Area	Multiplier	Total Area
1	R	1	Slab	10	1 St/SI	1,624	1.000	1,624
2	G	1		10	Attached Garage	708	1.000	708
3	M	PRCH		10	SLBC	192	1.000	192
4	M	PRCH		10	SLBC	132	1.000	132
Total Building Area						1,624		1,624



Rogers

Assessment Property Record Card for Tax Year 2026

Data provided by LISA DELOZIER County Assessor

Date 04/16/2026
Time 21:40:39
Page 4

660021879

Outbuildings/Site Improvements

Building Image	Code	Description	Dimensions	Floor	Roofing	Total Units
	STF	STG FAIR	10x12x0			120
	Qual	2	Cond 3	Year	Eff Age 1520	
Valuation Summary		Modifier Total	RCN	Depr (100% Phys/ % Func)		RCNLD
Base Cost (4.68 x 120)		562		562		562