



# Rogers

## Assessment Property Record Card for Tax Year 2026

Data provided by LISA DELOZIER County Assessor

Date 04/16/2026  
Time 21:41:08  
Page 1

Assessment Data					Primary Image																																		
<b>Account</b> 660021898 <b>Parcel ID</b> 000000-00-0-00210-002-0001 <b>Cadastral ID</b> 26-21-14-03190 <b>Property Type</b> REAL - Real Property <b>Property Class</b> RRP VI Area 4 <b>Tax Area</b> 3 - OWASSO RURAL/NO FIRE <b>Name ID</b> 327172 ADAMS, DONNELL RAY & ERICA NICHOLE  8522 N 167TH E AVE OWASSO OK 74055-0000  <b>Parcel Location</b> <b>Situs</b> 08522 N 167TH E AVE <b>Subdivision</b> COUNTRY BRIER II <b>Lot/Block</b> 0001 / 0002 Parcel Size 1 - Lots <b>Sec/Twn/Rng</b> 26 / 21 / 14 / 5 <b>Neighborhood</b> 1212 - R-V04-SW OWASSO <b>School District</b> S021 - OWASSO SCHOOLS																																							
<b>Legal Description</b> Lot/Long: 36.27821420 -95.78705344																																							
<b>Building Permits</b>					\\tsclient\TCASEY\CASEY BOOTH RESIDENTIAL VI\2022-8-9\IM 8/9/2022																																		
<b>Exemptions</b>					<b>Sale History</b>																																		
<table border="1"> <thead> <tr> <th>Code</th> <th>Type</th> <th>Active</th> <th>Maximum</th> <th>Exemption</th> </tr> </thead> <tbody> <tr> <td>H</td> <td>Homestead</td> <td>Yes</td> <td>1,000</td> <td>1,000</td> </tr> </tbody> </table>					Code	Type	Active	Maximum	Exemption	H	Homestead	Yes	1,000	1,000	<table border="1"> <thead> <tr> <th>Number</th> <th>Description</th> <th>Opened</th> <th>Closed</th> <th>Amount</th> </tr> </thead> <tbody> <tr> <td></td> <td></td> <td></td> <td></td> <td></td> </tr> </tbody> </table>					Number	Description	Opened	Closed	Amount															
Code	Type	Active	Maximum	Exemption																																			
H	Homestead	Yes	1,000	1,000																																			
Number	Description	Opened	Closed	Amount																																			
<table border="1"> <thead> <tr> <th>Code</th> <th>Type</th> <th>Active</th> <th>Maximum</th> <th>Exemption</th> <th>Bk/Pg</th> <th>Grantor</th> <th>Date</th> <th>Price</th> <th>Code</th> </tr> </thead> <tbody> <tr> <td>H</td> <td>Homestead</td> <td>Yes</td> <td>1,000</td> <td>1,000</td> <td>/</td> <td>CURTIS, CHARLES B II &amp;</td> <td>03/20/2019</td> <td>223,000</td> <td>YES</td> </tr> <tr> <td></td> <td></td> <td></td> <td></td> <td></td> <td>842/450</td> <td></td> <td></td> <td>106,500</td> <td>No</td> </tr> </tbody> </table>					Code	Type	Active	Maximum	Exemption	Bk/Pg	Grantor	Date	Price	Code	H	Homestead	Yes	1,000	1,000	/	CURTIS, CHARLES B II &	03/20/2019	223,000	YES						842/450			106,500	No					
Code	Type	Active	Maximum	Exemption	Bk/Pg	Grantor	Date	Price	Code																														
H	Homestead	Yes	1,000	1,000	/	CURTIS, CHARLES B II &	03/20/2019	223,000	YES																														
					842/450			106,500	No																														
<b>Parcel Valuation</b>																																							
<b>Source</b>	REAL		<b>Fair Cash</b>	<b>Capped</b>	<b>Asmnt Level</b>	<b>Assessed</b>	<b>Levy Rate</b>	97.960	<b>Current Tax</b>																														
<b>Remove Cap</b>	2020	<b>Land Value</b>	115,579	65,229	11%	7,175	<b>Assessed</b>	28,469	2,788.82																														
<b>Year Frozen</b>	0	<b>Improvements</b>	201,297	193,584		21,294	<b>Penalty</b>	0																															
<b>Uncapped Value</b>	0	<b>Mobile Home</b>	0	0		0	<b>Exemption</b>	1,000	-98.00																														
<b>TIF Project ID</b>	0	<b>Total Value</b>	316,876	258,813		28,469	<b>Total Taxable</b>	27,469	2,691.00																														
<b>Assessment History</b>																																							
<b>Tax Year</b>	<b>Statement Number</b>	<b>Billed Owner</b>			<b>Tax Area</b>	<b>Total Value</b>	<b>Exemptions</b>	<b>Taxable Value</b>	<b>Billed Tax</b>																														
2025	2025-660021898	ADAMS, DONNELL RAY &			3	316,362	1000	26,640	2,610.00																														
2024	2024-660021898	ADAMS, DONNELL RAY &			3	328,089	1000	25,835	2,482.00																														
2023	2023-660021898	ADAMS, DONNELL RAY &			3	236,852	1000	25,054	2,348.00																														
2022	2022-660021898	ADAMS, DONNELL RAY &			3	236,846	1000	24,835	2,433.00																														
2021	2021-660021898	ADAMS, DONNELL RAY &			3	228,026	1000	24,083	2,330.00																														
2020	2020-660021898	ADAMS, DONNELL RAY &			3	228,958	1000	24,185	2,336.00																														
2019	2019-660021898	ADAMS, DONNELL RAY &			3	224,701	1000	20,457	1,978.00																														
2018	2018-660021898	CURTIS, CHARLES B II &			3	217,091	1000	19,832	1,846.00																														
2017	2017-660021898	CURTIS, CHARLES B II &			3	200,479	1000	19,225	1,808.00																														
2016	2016-660021898	CURTIS, CHARLES B II &			3	195,645	1000	18,636	1,755.00																														
2015	2015-660021898	CURTIS, CHARLES B II &			3	190,506	1000	18,064	1,713.00																														
2014	2014-660021898	CURTIS, CHARLES B II &			3	193,705	1000	17,509	1,676.00																														
2013	2013-660021898	CURTIS, CHARLES B II &			3	185,517	1000	16,970	1,590.00																														



# Rogers

## Assessment Property Record Card for Tax Year 2026

Data provided by LISA DELOZIER County Assessor

Date 04/16/2026  
 Time 21:41:08  
 Page 2

Lot Data		Square-Foot - NBHD 1212 #1	
Lot Size			
Lot Count	1		
Units Buildable	1		
Non-Ag Acres	0.9827		
Topography			
Street Access			
Utilities			
Amenities	LAND QUALITY	0	0
Method	Square-Foot		
Base Lot Value	42,807.00 x 2.70 = 115,579		
Factor Value			
Adjustments	1.0000		
Lot Value	115,579		

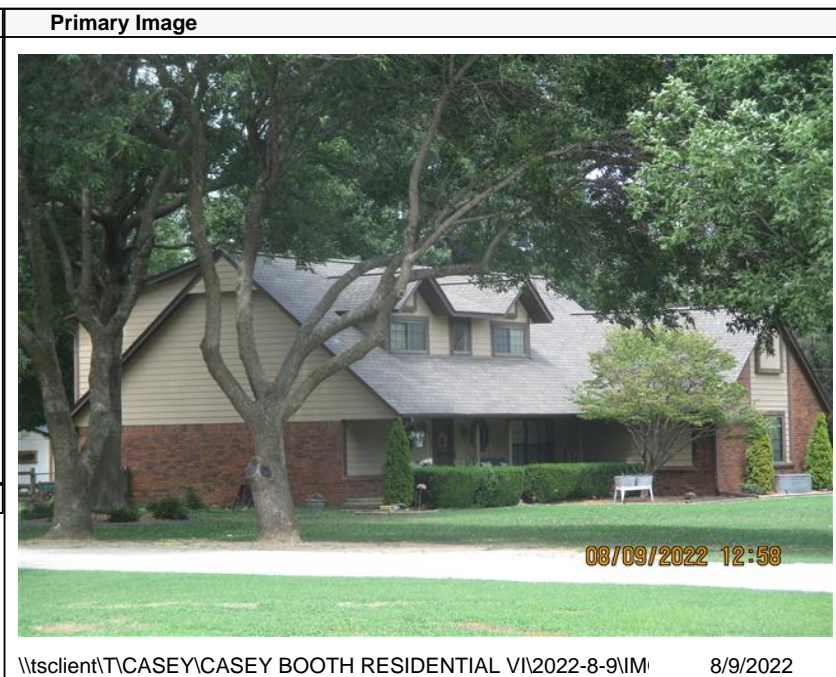

\\tsclient\TCASEY\CASEY BOOTH RESIDENTIAL VI\2022-8-9\IM 8/9/2022

Residential Data	
Type	1 Single Family Residence
Condition	3 - Average
Quality	3.5 - Average
Architecture	
Style	100% 1 1/2 Story Finished
Exterior Wall	60% Veneer, Masonry 40% Frame, Siding, Wood
Base/Total Area	1,420 / 2,460
Style	100% 1 1/2 Story Finished
HVAC	100% Warmed & Cooled Air
Roof Cover	1 Composition Shingle
Area on Slab	1,420
Fixture/RghIn	11 /
Bed/F/H Bath	3 / 2.0 /
Basement Area	
Garage Type	552 Attached Garage - Unfinished
Remodel	
Year/Eff Age	1984 / 32

GRM Approach	
GRM Code	
Gross Rent	0.00
Indicated Value	

Multiple Regression			
MRA Code	1	Test	
Adusted R	0.8445		
Indicated Value	291,222	118.38	Per SqFt

Direct Comparables			
Selection Model	A	Adam Test	
Adjustment Model	1	2022 Residential	
Comparables	3		
Indicated Value	360,170		Per SqFt

Cost Approach		Manual : 01/2025	
Base Cost	97.28	Total Misc Impr	+ 18,456
Roofing Adj	+ 3.34	Garage Cost	+ 21,495
Subfloor Adj	+ -2.16	Total RCN	= 335,495
Heat/Cool Adj	+ 14.47	Depreciation ( 40%)	- 134,198
Plumbing Adj	+ 7.21	Lump Sums	+ 0
Basement Adj	+ 0.00	RCNLD	= 201,297
Adj Base Cost	= 120.14	Lot Value	+ 115,579
Total Area	x 2,460	Indicated Value	= 316,876
Adjusted Cost	= 295,544	Value Per SqFt	128.81

Value Reconciliation			
Selected Approach	Cost Approach		
Improvements	201,297		
Lot Value	115,579		
Indicated Value	316,876	128.81	Per SqFt
Agland Value			
Site Improvements			
Total Value	316,876	128.81	Total Value Per SqFt

Miscellaneous Improvements								
Code	Description	Sketch ID	Size	Year	Units	Unit Cost	Depr	Value
FPR1	FIREPLACE - RESIDENTIAL 1 STORY	0		1	1	6,429.63		6,430
PRCH	SLAB PORCH - COVERED	53063	19x12		228	28.71		6,546
PRCH	SLAB PORCH - COVERED	53064	38x5		190	28.84		5,480



**Rogers**  
**Assessment Property Record Card for Tax Year 2026**

Data provided by LISA DELOZIER County Assessor

Date 04/16/2026  
 Time 21:41:08  
 Page 3

Sketch Image

660021898

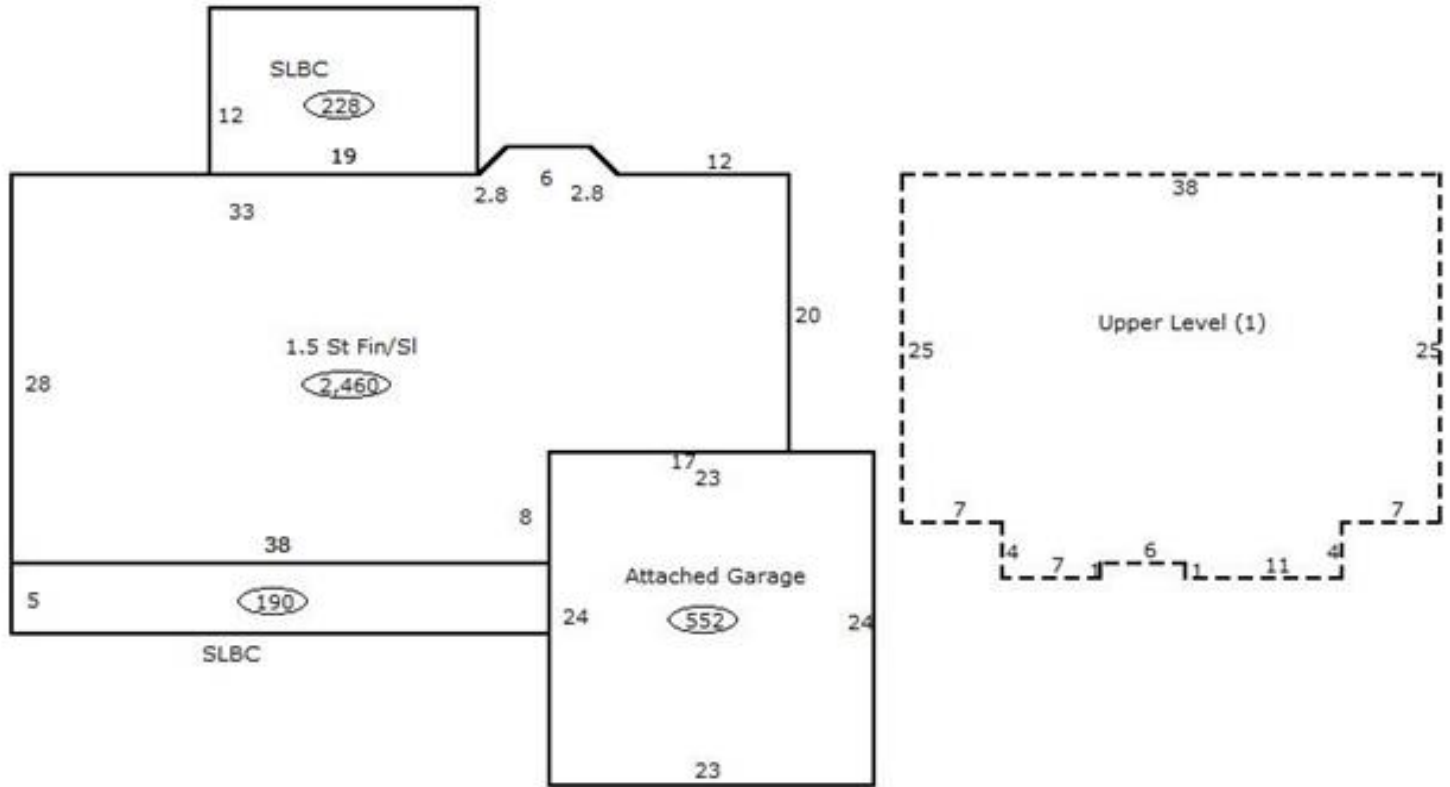

**Sketch Vector Information**

Sequence	Code	Type	Built Over	Scale	Section Label	Base Area	Multiplier	Total Area
1	R	5	Slab	13	1.5 St Fin/Sl	1,420	1.732	2,460
2	G	1		13	Attached Garage	552	1.000	552
3	M	PRCH		13	SLBC	228	1.000	228
4	M	PRCH		13	SLBC	190	1.000	190
5	U	^UL		13	Upper Level (1)	1,040	1.000	1,040
<b>Total Building Area</b>						1,420		2,460