



Rogers

Assessment Property Record Card for Tax Year 2026

Data provided by LISA DELOZIER County Assessor

Date 04/16/2026
Time 21:42:45
Page 1

Assessment Data					Primary Image																																																																																																																				
Account 660021982 Parcel ID 000000-00-0-00210-007-0007 Cadastral ID 26-21-14-04030 Property Type REAL - Real Property Property Class RRP VI Area 4 Tax Area 3 - OWASSO RURAL/NO FIRE Name ID 130304 SCOTT, BRIAN EUGENE & REBECCA REVOCABLE LIVING TRUST 8405 N 170TH E AVE OWASSO OK 74055-0000																																																																																																																									
Parcel Location Situs 08405 N 170TH E AVE Subdivision COUNTRY BRIER II Lot/Block 0007 / 0007 Parcel Size 1 - Lots Sec/Twn/Rng 26 / 21 / 14 / 5 Neighborhood 1212 - R-V04-SW OWASSO School District S021 - OWASSO SCHOOLS																																																																																																																									
Legal Description Lat/Long: 36.27530206 -95.78122868 LOT 7 BLOCK 7 COUNTRY BRIER 2					Building Permits <table border="1"> <thead> <tr> <th>Number</th> <th>Description</th> <th>Opened</th> <th>Closed</th> <th>Amount</th> </tr> </thead> <tbody> <tr> <td colspan="5"> </td> </tr> </tbody> </table>					Number	Description	Opened	Closed	Amount																																																																																																											
Number	Description	Opened	Closed	Amount																																																																																																																					
Exemptions <table border="1"> <thead> <tr> <th>Code</th> <th>Type</th> <th>Active</th> <th>Maximum</th> <th>Exemption</th> </tr> </thead> <tbody> <tr> <td>H</td> <td>Homestead</td> <td>Yes</td> <td>1,000</td> <td>1,000</td> </tr> </tbody> </table>					Code	Type	Active	Maximum	Exemption	H	Homestead	Yes	1,000	1,000	Sale History <table border="1"> <thead> <tr> <th>Bk/Pg</th> <th>Grantor</th> <th>Date</th> <th>Price</th> <th>Code</th> </tr> </thead> <tbody> <tr> <td colspan="5"> </td> </tr> </tbody> </table>					Bk/Pg	Grantor	Date	Price	Code																																																																																																	
Code	Type	Active	Maximum	Exemption																																																																																																																					
H	Homestead	Yes	1,000	1,000																																																																																																																					
Bk/Pg	Grantor	Date	Price	Code																																																																																																																					
Parcel Valuation <table border="1"> <thead> <tr> <th>Source</th> <th>REAL</th> <th>Fair Cash</th> <th>Capped</th> <th>Asmnt Level</th> <th>Assessed</th> <th>Levy Rate</th> <th>97.960</th> <th>Current Tax</th> </tr> </thead> <tbody> <tr> <td>Remove Cap</td> <td>0</td> <td>Land Value 120,713</td> <td>53,225</td> <td>11%</td> <td>5,855</td> <td>Assessed</td> <td>24,227</td> <td>2,373.28</td> </tr> <tr> <td>Year Frozen</td> <td>0</td> <td>Improvements 184,238</td> <td>167,021</td> <td></td> <td>18,372</td> <td>Penalty</td> <td>0</td> <td></td> </tr> <tr> <td>Uncapped Value</td> <td>0</td> <td>Mobile Home 0</td> <td>0</td> <td></td> <td>0</td> <td>Exemption</td> <td>1,000</td> <td>-98.00</td> </tr> <tr> <td>TIF Project ID</td> <td>0</td> <td>Total Value 304,951</td> <td>220,246</td> <td></td> <td>24,227</td> <td>Total Taxable</td> <td>23,227</td> <td>2,275.00</td> </tr> </tbody> </table>										Source	REAL	Fair Cash	Capped	Asmnt Level	Assessed	Levy Rate	97.960	Current Tax	Remove Cap	0	Land Value 120,713	53,225	11%	5,855	Assessed	24,227	2,373.28	Year Frozen	0	Improvements 184,238	167,021		18,372	Penalty	0		Uncapped Value	0	Mobile Home 0	0		0	Exemption	1,000	-98.00	TIF Project ID	0	Total Value 304,951	220,246		24,227	Total Taxable	23,227	2,275.00																																																																			
Source	REAL	Fair Cash	Capped	Asmnt Level	Assessed	Levy Rate	97.960	Current Tax																																																																																																																	
Remove Cap	0	Land Value 120,713	53,225	11%	5,855	Assessed	24,227	2,373.28																																																																																																																	
Year Frozen	0	Improvements 184,238	167,021		18,372	Penalty	0																																																																																																																		
Uncapped Value	0	Mobile Home 0	0		0	Exemption	1,000	-98.00																																																																																																																	
TIF Project ID	0	Total Value 304,951	220,246		24,227	Total Taxable	23,227	2,275.00																																																																																																																	
Assessment History <table border="1"> <thead> <tr> <th>Tax Year</th> <th>Statement Number</th> <th>Billed Owner</th> <th>Tax Area</th> <th>Total Value</th> <th>Exemptions</th> <th>Taxable Value</th> <th>Billed Tax</th> </tr> </thead> <tbody> <tr><td>2025</td><td>2025-660021982</td><td>SCOTT, BRIAN EUGENE &</td><td>3</td><td>301,824</td><td>1000</td><td>22,521</td><td>2,206.00</td></tr> <tr><td>2024</td><td>2024-660021982</td><td>SCOTT, BRIAN E</td><td>3</td><td>338,361</td><td>1000</td><td>21,837</td><td>2,098.00</td></tr> <tr><td>2023</td><td>2023-660021982</td><td>SCOTT, BRIAN E</td><td>3</td><td>215,238</td><td>1000</td><td>21,171</td><td>1,984.00</td></tr> <tr><td>2022</td><td>2022-660021982</td><td>SCOTT, BRIAN E</td><td>3</td><td>217,922</td><td>1000</td><td>20,525</td><td>2,011.00</td></tr> <tr><td>2021</td><td>2021-660021982</td><td>SCOTT, BRIAN E</td><td>3</td><td>228,562</td><td>1000</td><td>19,899</td><td>1,925.00</td></tr> <tr><td>2020</td><td>2020-660021982</td><td>SCOTT, BRIAN E</td><td>3</td><td>225,334</td><td>1000</td><td>19,290</td><td>1,863.00</td></tr> <tr><td>2019</td><td>2019-660021982</td><td>SCOTT, BRIAN E</td><td>3</td><td>217,637</td><td>1000</td><td>18,699</td><td>1,808.00</td></tr> <tr><td>2018</td><td>2018-660021982</td><td>SCOTT, BRIAN E</td><td>3</td><td>225,057</td><td>1000</td><td>18,126</td><td>1,687.00</td></tr> <tr><td>2017</td><td>2017-660021982</td><td>SCOTT, BRIAN E</td><td>3</td><td>208,428</td><td>1000</td><td>17,569</td><td>1,653.00</td></tr> <tr><td>2016</td><td>2016-660021982</td><td>SCOTT, BRIAN E</td><td>3</td><td>203,395</td><td>1000</td><td>17,028</td><td>1,603.00</td></tr> <tr><td>2015</td><td>2015-660021982</td><td>SCOTT, BRIAN E</td><td>3</td><td>197,427</td><td>1000</td><td>16,503</td><td>1,565.00</td></tr> <tr><td>2014</td><td>2014-660021982</td><td>SCOTT, BRIAN E</td><td>3</td><td>199,225</td><td>1000</td><td>15,993</td><td>1,531.00</td></tr> <tr><td>2013</td><td>2013-660021982</td><td>SCOTT, BRIAN E</td><td>3</td><td>188,188</td><td>1000</td><td>15,498</td><td>1,452.00</td></tr> </tbody> </table>										Tax Year	Statement Number	Billed Owner	Tax Area	Total Value	Exemptions	Taxable Value	Billed Tax	2025	2025-660021982	SCOTT, BRIAN EUGENE &	3	301,824	1000	22,521	2,206.00	2024	2024-660021982	SCOTT, BRIAN E	3	338,361	1000	21,837	2,098.00	2023	2023-660021982	SCOTT, BRIAN E	3	215,238	1000	21,171	1,984.00	2022	2022-660021982	SCOTT, BRIAN E	3	217,922	1000	20,525	2,011.00	2021	2021-660021982	SCOTT, BRIAN E	3	228,562	1000	19,899	1,925.00	2020	2020-660021982	SCOTT, BRIAN E	3	225,334	1000	19,290	1,863.00	2019	2019-660021982	SCOTT, BRIAN E	3	217,637	1000	18,699	1,808.00	2018	2018-660021982	SCOTT, BRIAN E	3	225,057	1000	18,126	1,687.00	2017	2017-660021982	SCOTT, BRIAN E	3	208,428	1000	17,569	1,653.00	2016	2016-660021982	SCOTT, BRIAN E	3	203,395	1000	17,028	1,603.00	2015	2015-660021982	SCOTT, BRIAN E	3	197,427	1000	16,503	1,565.00	2014	2014-660021982	SCOTT, BRIAN E	3	199,225	1000	15,993	1,531.00	2013	2013-660021982	SCOTT, BRIAN E	3	188,188	1000	15,498	1,452.00
Tax Year	Statement Number	Billed Owner	Tax Area	Total Value	Exemptions	Taxable Value	Billed Tax																																																																																																																		
2025	2025-660021982	SCOTT, BRIAN EUGENE &	3	301,824	1000	22,521	2,206.00																																																																																																																		
2024	2024-660021982	SCOTT, BRIAN E	3	338,361	1000	21,837	2,098.00																																																																																																																		
2023	2023-660021982	SCOTT, BRIAN E	3	215,238	1000	21,171	1,984.00																																																																																																																		
2022	2022-660021982	SCOTT, BRIAN E	3	217,922	1000	20,525	2,011.00																																																																																																																		
2021	2021-660021982	SCOTT, BRIAN E	3	228,562	1000	19,899	1,925.00																																																																																																																		
2020	2020-660021982	SCOTT, BRIAN E	3	225,334	1000	19,290	1,863.00																																																																																																																		
2019	2019-660021982	SCOTT, BRIAN E	3	217,637	1000	18,699	1,808.00																																																																																																																		
2018	2018-660021982	SCOTT, BRIAN E	3	225,057	1000	18,126	1,687.00																																																																																																																		
2017	2017-660021982	SCOTT, BRIAN E	3	208,428	1000	17,569	1,653.00																																																																																																																		
2016	2016-660021982	SCOTT, BRIAN E	3	203,395	1000	17,028	1,603.00																																																																																																																		
2015	2015-660021982	SCOTT, BRIAN E	3	197,427	1000	16,503	1,565.00																																																																																																																		
2014	2014-660021982	SCOTT, BRIAN E	3	199,225	1000	15,993	1,531.00																																																																																																																		
2013	2013-660021982	SCOTT, BRIAN E	3	188,188	1000	15,498	1,452.00																																																																																																																		



Rogers

Assessment Property Record Card for Tax Year 2026

Data provided by LISA DELOZIER County Assessor

Date 04/16/2026
 Time 21:42:45
 Page 2

Lot Data		Square-Foot - NBHD 1212 #1		Primary Image					
Lot Size									
Lot Count	1								
Units Buildable	1								
Non-Ag Acres	1.0678								
Topography									
Street Access									
Utilities									
Amenities	LAND QUALITY	0							
		0							
Method	Square-Foot								
Base Lot Value	46,513.00 x 2.60 = 120,713			\\tsclient\TCASEY\CASEY BOOTH RESIDENTIAL VI\2022-8-10\ 8/10/2022					
Factor Value					GRM Approach				
Adjustments	1.0000				GRM Code				
Lot Value	120,713				Gross Rent 0.00				
Residential Data				Indicated Value					
Type	1 Single Family Residence			Multiple Regression					
Condition	3 - Average			MRA Code 1 Test					
Quality	3 - Average			Adusted R 0.8445					
Architecture				Indicated Value 252,810 105.87 Per SqFt					
Style	100% One Story			Direct Comparables					
Exterior Wall	100% Veneer, Masonry			Selection Model A Adam Test					
Base/Total Area	2,388 / 2,388			Adjustment Model 1 2022 Residential					
Style	100% One Story			Comparables 5					
HVAC	100% Warmed & Cooled Air			Indicated Value 347,310 Per SqFt					
Roof Cover	1 Composition Shingle			Value Reconciliation					
Area on Slab	2,388			Selected Approach Cost Approach					
Fixture/RghIn	11 /			Improvements 184,238					
Bed/F/H Bath	3 / 2.0 /			Lot Value 120,713					
Basement Area				Indicated Value 304,951 127.70 Per SqFt					
Garage Type	552 Attached Garage - Unfinished			Agland Value					
Remodel				Site Improvements					
Year/Eff Age	1981 / 34			Total Value 304,951 127.70 Total Value Per SqFt					
Cost Approach		Manual : 01/2025							
Base Cost	100.53	Total Misc Impr	+ 6,763						
Roofing Adj	+ 4.38	Garage Cost	+ 17,211						
Subfloor Adj	+ -2.20	Total RCN	= 314,928						
Heat/Cool Adj	+ 12.64	Depreciation (42%)	- 132,270						
Plumbing Adj	+ 6.49	Lump Sums	+ 1,580						
Basement Adj	+ 0.00	RCNLD	= 184,238						
Adj Base Cost	= 121.84	Lot Value	+ 120,713						
Total Area	x 2,388	Indicated Value	= 304,951						
Adjusted Cost	= 290,954	Value Per SqFt	127.70						
Miscellaneous Improvements									
Code	Description	Sketch ID	Size	Year	Units	Unit Cost	Depr	Value	
FPR1	FIREPLACE - RESIDENTIAL 1 STORY	0		1	1	5,615.40		5,615	
WODO	WOOD DECK - OPEN	53450	31x10		310	16.99	70%	1,580	
PATO	SLAB PORCH - OPEN	53451	10x10		100	11.48		1,148	
SHLT	STORM SHELTER(DETACHED)			1 2024	1	0.00			



Rogers
Assessment Property Record Card for Tax Year 2026

Data provided by LISA DELOZIER County Assessor

Date 04/16/2026
 Time 21:42:45
 Page 3

Sketch Image

660021982

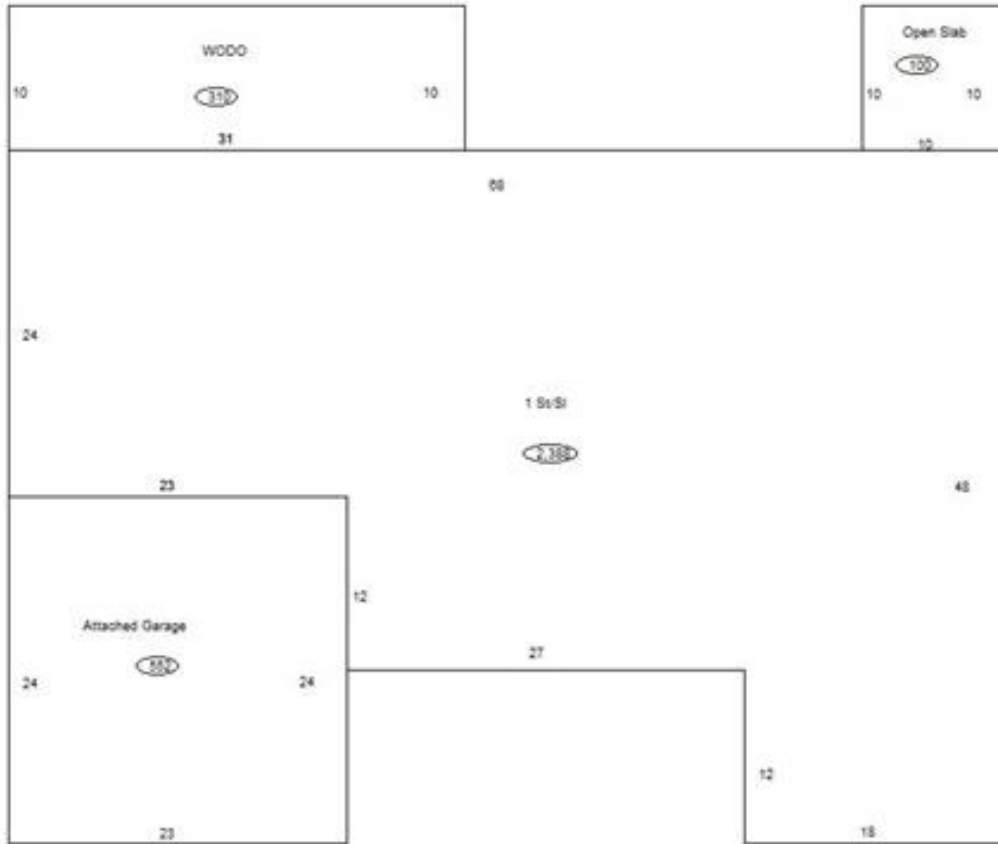

Sketch Vector Information

Sequence	Code	Type	Built Over	Scale	Section Label	Base Area	Multiplier	Total Area
1	R	1	Slab	10	1 St/Sl	2,388	1.000	2,388
2	G	1		10	Attached Garage	552	1.000	552
3	M	WODO		10	WODO	310	1.000	310
4	M	PATO		10	Open Slab	100	1.000	100
Total Building Area						2,388		2,388



Rogers

Assessment Property Record Card for Tax Year 2026

Data provided by LISA DELOZIER County Assessor

Date 04/16/2026
Time 21:42:45
Page 4

660021982

Outbuildings/Site Improvements

Building Image	Code	Description	Dimensions	Floor	Roofing	Total Units
	STF	STG FAIR	12x14x0			168
	Qual	2	Cond 3	Year	Eff Age 1520	
Valuation Summary		Modifier Total	RCN	Depr (100% Phys/ % Func)		RCNLD
Base Cost (4.68 x 168)		786		786		786