



# Rogers

## Assessment Property Record Card for Tax Year 2026

Data provided by LISA DELOZIER County Assessor

Date 04/16/2026  
Time 21:43:00  
Page 1

Assessment Data					Primary Image																																																																																																																				
<b>Account</b> 660021997 <b>Parcel ID</b> 000000-00-0-00426-001-0015 <b>Cadastral ID</b> 26-21-14-04180 <b>Property Type</b> REAL - Real Property <b>Property Class</b> RRP VI Area 4 <b>Tax Area</b> 3 - OWASSO RURAL/NO FIRE <b>Name ID</b> 348219 WAUGH, HUNTER & CHANTELLI  17403 E 78TH ST N OWASSO OK 74055-0000  <b>Parcel Location</b> <b>Situs</b> 17403 E 78TH ST N <b>Subdivision</b> LA STRANGE ACRES 2ND AMD <b>Lot/Block</b> 0015 / 0001 <b>Parcel Size</b> 1 - Lots <b>Sec/Twn/Rng</b> 26 / 21 / 14 / 5 <b>Neighborhood</b> 1056 - R-V04-SW OWASSO <b>School District</b> S021 - OWASSO SCHOOLS																																																																																																																									
<b>Legal Description</b> Lat/Long: 36.26739109 -95.78073059																																																																																																																									
<b>Legal Description</b> LOT 15 BLOCK 1 LA STRANGE ACRES 2ND AMD.					<b>Building Permits</b> <table border="1"> <thead> <tr> <th>Number</th> <th>Description</th> <th>Opened</th> <th>Closed</th> <th>Amount</th> </tr> </thead> <tbody> <tr> <td colspan="5"> </td> </tr> </tbody> </table>					Number	Description	Opened	Closed	Amount																																																																																																											
Number	Description	Opened	Closed	Amount																																																																																																																					
<b>Exemptions</b> <table border="1"> <thead> <tr> <th>Code</th> <th>Type</th> <th>Active</th> <th>Maximum</th> <th>Exemption</th> </tr> </thead> <tbody> <tr> <td>H</td> <td>Homestead</td> <td>No</td> <td>1,000</td> <td></td> </tr> </tbody> </table>					Code	Type	Active	Maximum	Exemption	H	Homestead	No	1,000		<b>Sale History</b> <table border="1"> <thead> <tr> <th>Bk/Pg</th> <th>Grantor</th> <th>Date</th> <th>Price</th> <th>Code</th> </tr> </thead> <tbody> <tr> <td>/</td> <td>GOLDSTEIN, JOSHUA B</td> <td>09/08/2025</td> <td>240,000</td> <td>YES</td> </tr> <tr> <td>/</td> <td>LEWIS, DAVID &amp; ELIZABETH</td> <td>10/11/2019</td> <td>134,000</td> <td>YES</td> </tr> <tr> <td>2373/143</td> <td>COOPER, NALISA &amp;</td> <td>12/11/2013</td> <td>108,000</td> <td>YES</td> </tr> <tr> <td>1733/74</td> <td>HOLDERMAN, GEORGE E &amp;</td> <td>11/22/2005</td> <td>111,500</td> <td>YES</td> </tr> <tr> <td>929/128</td> <td>MILLER, JAMES W &amp;</td> <td>09/16/1993</td> <td>70,500</td> <td>Yes</td> </tr> </tbody> </table>					Bk/Pg	Grantor	Date	Price	Code	/	GOLDSTEIN, JOSHUA B	09/08/2025	240,000	YES	/	LEWIS, DAVID & ELIZABETH	10/11/2019	134,000	YES	2373/143	COOPER, NALISA &	12/11/2013	108,000	YES	1733/74	HOLDERMAN, GEORGE E &	11/22/2005	111,500	YES	929/128	MILLER, JAMES W &	09/16/1993	70,500	Yes																																																																								
Code	Type	Active	Maximum	Exemption																																																																																																																					
H	Homestead	No	1,000																																																																																																																						
Bk/Pg	Grantor	Date	Price	Code																																																																																																																					
/	GOLDSTEIN, JOSHUA B	09/08/2025	240,000	YES																																																																																																																					
/	LEWIS, DAVID & ELIZABETH	10/11/2019	134,000	YES																																																																																																																					
2373/143	COOPER, NALISA &	12/11/2013	108,000	YES																																																																																																																					
1733/74	HOLDERMAN, GEORGE E &	11/22/2005	111,500	YES																																																																																																																					
929/128	MILLER, JAMES W &	09/16/1993	70,500	Yes																																																																																																																					
<b>Parcel Valuation</b> <table border="1"> <thead> <tr> <th>Source</th> <th>REAL</th> <th>Fair Cash</th> <th>Capped</th> <th>Asmnt Level</th> <th>Assessed</th> <th>Levy Rate</th> <th>97.960</th> <th>Current Tax</th> </tr> </thead> <tbody> <tr> <td>Remove Cap</td> <td>2026</td> <td>Land Value</td> <td>129,631</td> <td>129,631</td> <td>11%</td> <td>14,259</td> <td>Assessed</td> <td>26,401 2,586.24</td> </tr> <tr> <td>Year Frozen</td> <td>0</td> <td>Improvements</td> <td>110,379</td> <td>110,379</td> <td></td> <td>12,142</td> <td>Penalty</td> <td>0</td> </tr> <tr> <td>Uncapped Value</td> <td>0</td> <td>Mobile Home</td> <td>0</td> <td>0</td> <td></td> <td>0</td> <td>Exemption</td> <td>0 0.00</td> </tr> <tr> <td>TIF Project ID</td> <td>0</td> <td>Total Value</td> <td>240,010</td> <td>240,010</td> <td></td> <td>26,401</td> <td>Total Taxable</td> <td>26,401 2,586.00</td> </tr> </tbody> </table>										Source	REAL	Fair Cash	Capped	Asmnt Level	Assessed	Levy Rate	97.960	Current Tax	Remove Cap	2026	Land Value	129,631	129,631	11%	14,259	Assessed	26,401 2,586.24	Year Frozen	0	Improvements	110,379	110,379		12,142	Penalty	0	Uncapped Value	0	Mobile Home	0	0		0	Exemption	0 0.00	TIF Project ID	0	Total Value	240,010	240,010		26,401	Total Taxable	26,401 2,586.00																																																																			
Source	REAL	Fair Cash	Capped	Asmnt Level	Assessed	Levy Rate	97.960	Current Tax																																																																																																																	
Remove Cap	2026	Land Value	129,631	129,631	11%	14,259	Assessed	26,401 2,586.24																																																																																																																	
Year Frozen	0	Improvements	110,379	110,379		12,142	Penalty	0																																																																																																																	
Uncapped Value	0	Mobile Home	0	0		0	Exemption	0 0.00																																																																																																																	
TIF Project ID	0	Total Value	240,010	240,010		26,401	Total Taxable	26,401 2,586.00																																																																																																																	
<b>Assessment History</b> <table border="1"> <thead> <tr> <th>Tax Year</th> <th>Statement Number</th> <th>Billed Owner</th> <th>Tax Area</th> <th>Total Value</th> <th>Exemptions</th> <th>Taxable Value</th> <th>Billed Tax</th> </tr> </thead> <tbody> <tr> <td>2025</td> <td>2025-660021997</td> <td>WAUGH, HUNTER &amp; CHANTELLI</td> <td>3</td> <td>145,167</td> <td>0</td> <td>15,739</td> <td>1,542.00</td> </tr> <tr> <td>2024</td> <td>2024-660021997</td> <td>GOLDSTEIN, JOSHUA B &amp;</td> <td>3</td> <td>152,064</td> <td>0</td> <td>14,990</td> <td>1,440.00</td> </tr> <tr> <td>2023</td> <td>2023-660021997</td> <td>GOLDSTEIN, JOSHUA B &amp;</td> <td>3</td> <td>129,778</td> <td>0</td> <td>14,276</td> <td>1,338.00</td> </tr> <tr> <td>2022</td> <td>2022-660021997</td> <td>GOLDSTEIN, JOSHUA B &amp;</td> <td>3</td> <td>129,773</td> <td>0</td> <td>14,275</td> <td>1,399.00</td> </tr> <tr> <td>2021</td> <td>2021-660021997</td> <td>GOLDSTEIN, JOSHUA B &amp;</td> <td>3</td> <td>136,734</td> <td>0</td> <td>15,041</td> <td>1,455.00</td> </tr> <tr> <td>2020</td> <td>2020-660021997</td> <td>GOLDSTEIN, JOSHUA B &amp;</td> <td>3</td> <td>136,195</td> <td>0</td> <td>14,981</td> <td>1,447.00</td> </tr> <tr> <td>2019</td> <td>2019-660021997</td> <td>LEWIS, DAVID &amp; ELIZABETH</td> <td>3</td> <td>135,529</td> <td>0</td> <td>14,908</td> <td>1,441.00</td> </tr> <tr> <td>2018</td> <td>2018-660021997</td> <td>LEWIS, DAVID &amp; ELIZABETH</td> <td>3</td> <td>139,313</td> <td>0</td> <td>15,324</td> <td>1,426.00</td> </tr> <tr> <td>2017</td> <td>2017-660021997</td> <td>LEWIS, DAVID &amp; ELIZABETH</td> <td>3</td> <td>138,267</td> <td>0</td> <td>15,209</td> <td>1,431.00</td> </tr> <tr> <td>2016</td> <td>2016-660021997</td> <td>LEWIS, DAVID &amp; ELIZABETH</td> <td>3</td> <td>134,960</td> <td>0</td> <td>14,846</td> <td>1,398.00</td> </tr> <tr> <td>2015</td> <td>2015-660021997</td> <td>LEWIS, DAVID &amp; ELIZABETH</td> <td>3</td> <td>131,329</td> <td>0</td> <td>14,446</td> <td>1,370.00</td> </tr> <tr> <td>2014</td> <td>2014-660021997</td> <td>LEWIS, DAVID &amp; ELIZABETH</td> <td>3</td> <td>133,630</td> <td>0</td> <td>14,699</td> <td>1,407.00</td> </tr> <tr> <td>2013</td> <td>2013-660021997</td> <td>COOPER, NALISA &amp;</td> <td>3</td> <td>133,691</td> <td>1000</td> <td>12,744</td> <td>1,194.00</td> </tr> </tbody> </table>										Tax Year	Statement Number	Billed Owner	Tax Area	Total Value	Exemptions	Taxable Value	Billed Tax	2025	2025-660021997	WAUGH, HUNTER & CHANTELLI	3	145,167	0	15,739	1,542.00	2024	2024-660021997	GOLDSTEIN, JOSHUA B &	3	152,064	0	14,990	1,440.00	2023	2023-660021997	GOLDSTEIN, JOSHUA B &	3	129,778	0	14,276	1,338.00	2022	2022-660021997	GOLDSTEIN, JOSHUA B &	3	129,773	0	14,275	1,399.00	2021	2021-660021997	GOLDSTEIN, JOSHUA B &	3	136,734	0	15,041	1,455.00	2020	2020-660021997	GOLDSTEIN, JOSHUA B &	3	136,195	0	14,981	1,447.00	2019	2019-660021997	LEWIS, DAVID & ELIZABETH	3	135,529	0	14,908	1,441.00	2018	2018-660021997	LEWIS, DAVID & ELIZABETH	3	139,313	0	15,324	1,426.00	2017	2017-660021997	LEWIS, DAVID & ELIZABETH	3	138,267	0	15,209	1,431.00	2016	2016-660021997	LEWIS, DAVID & ELIZABETH	3	134,960	0	14,846	1,398.00	2015	2015-660021997	LEWIS, DAVID & ELIZABETH	3	131,329	0	14,446	1,370.00	2014	2014-660021997	LEWIS, DAVID & ELIZABETH	3	133,630	0	14,699	1,407.00	2013	2013-660021997	COOPER, NALISA &	3	133,691	1000	12,744	1,194.00
Tax Year	Statement Number	Billed Owner	Tax Area	Total Value	Exemptions	Taxable Value	Billed Tax																																																																																																																		
2025	2025-660021997	WAUGH, HUNTER & CHANTELLI	3	145,167	0	15,739	1,542.00																																																																																																																		
2024	2024-660021997	GOLDSTEIN, JOSHUA B &	3	152,064	0	14,990	1,440.00																																																																																																																		
2023	2023-660021997	GOLDSTEIN, JOSHUA B &	3	129,778	0	14,276	1,338.00																																																																																																																		
2022	2022-660021997	GOLDSTEIN, JOSHUA B &	3	129,773	0	14,275	1,399.00																																																																																																																		
2021	2021-660021997	GOLDSTEIN, JOSHUA B &	3	136,734	0	15,041	1,455.00																																																																																																																		
2020	2020-660021997	GOLDSTEIN, JOSHUA B &	3	136,195	0	14,981	1,447.00																																																																																																																		
2019	2019-660021997	LEWIS, DAVID & ELIZABETH	3	135,529	0	14,908	1,441.00																																																																																																																		
2018	2018-660021997	LEWIS, DAVID & ELIZABETH	3	139,313	0	15,324	1,426.00																																																																																																																		
2017	2017-660021997	LEWIS, DAVID & ELIZABETH	3	138,267	0	15,209	1,431.00																																																																																																																		
2016	2016-660021997	LEWIS, DAVID & ELIZABETH	3	134,960	0	14,846	1,398.00																																																																																																																		
2015	2015-660021997	LEWIS, DAVID & ELIZABETH	3	131,329	0	14,446	1,370.00																																																																																																																		
2014	2014-660021997	LEWIS, DAVID & ELIZABETH	3	133,630	0	14,699	1,407.00																																																																																																																		
2013	2013-660021997	COOPER, NALISA &	3	133,691	1000	12,744	1,194.00																																																																																																																		



# Rogers

## Assessment Property Record Card for Tax Year 2026

Data provided by LISA DELOZIER County Assessor

Date 04/16/2026  
Time 21:43:00  
Page 2

Lot Data	Square-Foot - NBHD 1056 #1	Primary Image
<b>Lot Size</b> <b>Lot Count</b> <b>Units Buildable</b> 1 <b>Non-Ag Acres</b> 0.3831 <b>Topography</b> <b>Street Access</b> <b>Utilities</b> <b>Amenities</b> LAND QUALITY 0 0 <b>Method</b> Square-Foot <b>Base Lot Value</b> 16,690.00 x 3.00 = 50,070 <b>Factor Value</b> <b>Adjustments</b> 2.5890 <b>Lot Value</b> 129,631		

Residential Data	
<b>Type</b>	1 Single Family Residence
<b>Condition</b>	3 - Average
<b>Quality</b>	2.5 - Fair
<b>Architecture</b>	
<b>Style</b>	100% One Story
<b>Exterior Wall</b>	80% Veneer, Stone 20% Frame, Siding, Wood
<b>Base/Total Area</b>	1,428 / 1,428
<b>Style</b>	100% One Story
<b>HVAC</b>	100% Warmed & Cooled Air
<b>Roof Cover</b>	1 Composition Shingle
<b>Area on Slab</b>	1,428
<b>Fixture/RghIn</b>	11 /
<b>Bed/F/H Bath</b>	3 / 2.0 /
<b>Basement Area</b>	
<b>Garage Type</b>	440 Attached Garage - Unfinished
<b>Remodel</b>	
<b>Year/Eff Age</b>	1976 / 38



\\tsclient\TCASEY\CASEY BOOTH RESIDENTIAL VI\2022-8-8\IM 8/9/2022

Cost Approach		Manual : 01/2025	
<b>Base Cost</b>	108.58	<b>Total Misc Impr</b>	+ 5,580
<b>Roofing Adj</b>	+ 4.48	<b>Garage Cost</b>	+ 12,487
<b>Subfloor Adj</b>	+ -1.20	<b>Total RCN</b>	= 208,262
<b>Heat/Cool Adj</b>	+ 11.47	<b>Depreciation ( 47%)</b>	- 97,883
<b>Plumbing Adj</b>	+ 9.86	<b>Lump Sums</b>	+ 0
<b>Basement Adj</b>	+ 0.00	<b>RCNLD</b>	= 110,379
<b>Adj Base Cost</b>	= 133.19	<b>Lot Value</b>	+ 129,631
<b>Total Area</b>	x 1,428	<b>Indicated Value</b>	= 240,010
<b>Adjusted Cost</b>	= 190,195	<b>Value Per SqFt</b>	168.07

GRM Approach	
<b>GRM Code</b>	
<b>Gross Rent</b>	0.00
<b>Indicated Value</b>	

Multiple Regression			
<b>MRA Code</b>	1	Test	
<b>Adusted R</b>	0.8445		
<b>Indicated Value</b>	149,936	105.00	Per SqFt

Direct Comparables	
<b>Selection Model</b>	A Adam Test
<b>Adjustment Model</b>	1 2022 Residential
<b>Comparables</b>	3
<b>Indicated Value</b>	158,330 Per SqFt

Value Reconciliation			
<b>Selected Approach</b>	Cost Approach		
<b>Improvements</b>	110,379		
<b>Lot Value</b>	129,631		
<b>Indicated Value</b>	240,010	168.07	Per SqFt
<b>Agland Value</b>			
<b>Site Improvements</b>			
<b>Total Value</b>	240,010	168.07	Total Value Per SqFt

Miscellaneous Improvements								
Code	Description	Sketch ID	Size	Year	Units	Unit Cost	Depr	Value
FPR1	FIREPLACE - RESIDENTIAL 1 STORY	0		1	1	5,095.98		5,096
PRCH	SLAB PORCH - COVERED	53503	5x4		20	24.21		484



# Rogers

## Assessment Property Record Card for Tax Year 2026

Data provided by LISA DELOZIER County Assessor

Date 04/16/2026

Time 21:43:00

Page 3

### Sketch Image

660021997

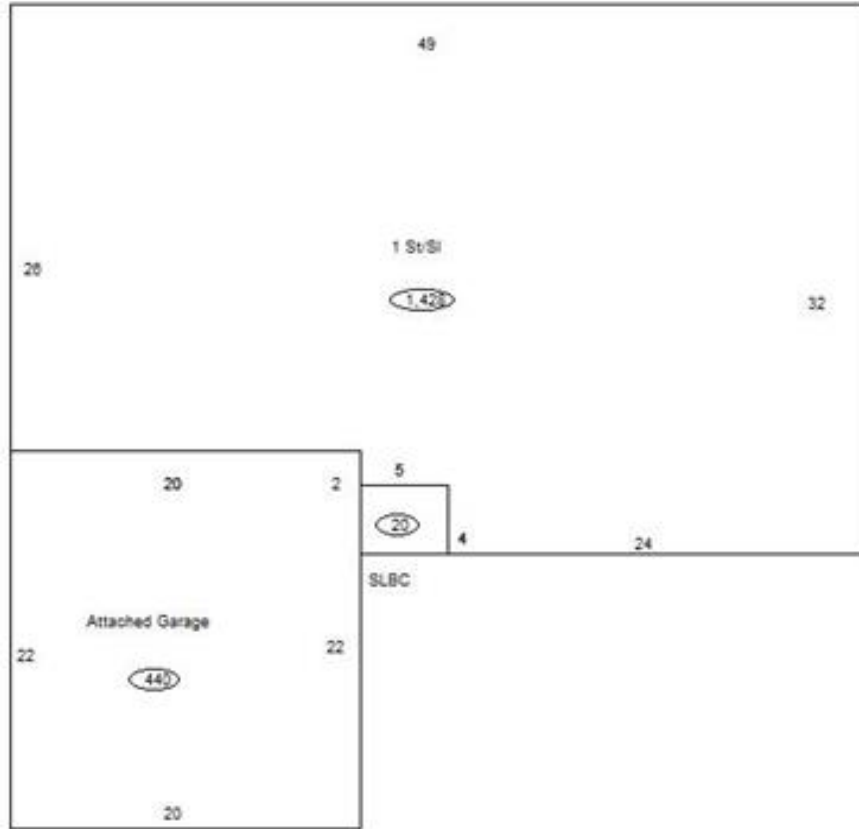

### Sketch Vector Information

Sequence	Code	Type	Built Over	Scale	Section Label	Base Area	Multiplier	Total Area
1	R	1	Slab	10	1 St/SI	1,428	1.000	1,428
2	G	1		10	Attached Garage	440	1.000	440
3	M	PRCH		10	SLBC	20	1.000	20
<b>Total Building Area</b>						1,428		1,428