



Rogers

Assessment Property Record Card for Tax Year 2026

Data provided by LISA DELOZIER County Assessor

Date 04/16/2026
Time 21:43:31
Page 1

Assessment Data					Primary Image																																																																																																																																																												
Account 660022031 Parcel ID 000000-00-0-00426-002-0017 Cadastral ID 26-21-14-04520 Property Type REAL - Real Property Property Class RRP VI Area 4 Tax Area 3 - OWASSO RURAL/NO FIRE Name ID 134794 HICKS, LONNIE G & SHARON M 17306 E 78TH ST N OWASSO OK 74055-0000 Parcel Location Situs 17306 E 78TH ST N Subdivision LA STRANGE ACRES 2ND AMD Lot/Block 0017 / 0002 Parcel Size 1 - Lots Sec/Twn/Rng 26 / 21 / 14 / 5 Neighborhood 1056 - R-V04-SW OWASSO School District S021 - OWASSO SCHOOLS																																																																																																																																																																	
Legal Description Lat/Long: 36.26670617 -95.78130153																																																																																																																																																																	
Building Permits					\\tsclient\TCASEY\CASEY BOOTH RESIDENTIAL VI\2022-8-8\IM 8/8/2022																																																																																																																																																												
Exemptions					Sale History																																																																																																																																																												
LOT 17 BLOCK 2 LA STRANGE ACRES 2ND AMD.					<table border="1"> <thead> <tr> <th>Number</th> <th>Description</th> <th>Opened</th> <th>Closed</th> <th>Amount</th> </tr> </thead> <tbody> <tr> <td> </td> <td> </td> <td> </td> <td> </td> <td> </td> </tr> </tbody> </table>					Number	Description	Opened	Closed	Amount																																																																																																																																																			
Number	Description	Opened	Closed	Amount																																																																																																																																																													
<table border="1"> <thead> <tr> <th>Code</th> <th>Type</th> <th>Active</th> <th>Maximum</th> <th>Exemption</th> </tr> </thead> <tbody> <tr> <td>H</td> <td>Homestead</td> <td>Yes</td> <td>1,000</td> <td>1,000</td> </tr> </tbody> </table>					Code	Type	Active	Maximum	Exemption	H	Homestead	Yes	1,000	1,000	<table border="1"> <thead> <tr> <th>Bk/Pg</th> <th>Grantor</th> <th>Date</th> <th>Price</th> <th>Code</th> </tr> </thead> <tbody> <tr> <td>2505/706</td> <td>HICKS, LONNIE G</td> <td>10/15/2015</td> <td>0</td> <td>4</td> </tr> </tbody> </table>					Bk/Pg	Grantor	Date	Price	Code	2505/706	HICKS, LONNIE G	10/15/2015	0	4																																																																																																																																				
Code	Type	Active	Maximum	Exemption																																																																																																																																																													
H	Homestead	Yes	1,000	1,000																																																																																																																																																													
Bk/Pg	Grantor	Date	Price	Code																																																																																																																																																													
2505/706	HICKS, LONNIE G	10/15/2015	0	4																																																																																																																																																													
Parcel Valuation																																																																																																																																																																	
<table border="1"> <thead> <tr> <th>Source</th> <th>REAL</th> <th>Fair Cash</th> <th>Capped</th> <th>Asmnt Level</th> <th>Assessed</th> <th>Levy Rate</th> <th>97.960</th> <th>Current Tax</th> </tr> </thead> <tbody> <tr> <td>Remove Cap</td> <td>0</td> <td>Land Value 50,925</td> <td>34,902</td> <td>11%</td> <td>3,839</td> <td>Assessed</td> <td>12,146</td> <td>1,189.82</td> </tr> <tr> <td>Year Frozen</td> <td>2014</td> <td>Improvements 110,189</td> <td>75,520</td> <td></td> <td>8,307</td> <td>Penalty</td> <td>0</td> <td></td> </tr> <tr> <td>Uncapped Value</td> <td>0</td> <td>Mobile Home 0</td> <td>0</td> <td></td> <td>0</td> <td>Exemption</td> <td>1,000</td> <td>-98.00</td> </tr> <tr> <td>TIF Project ID</td> <td>0</td> <td>Total Value 161,114</td> <td>110,422</td> <td></td> <td>12,146</td> <td>Total Taxable</td> <td>11,146</td> <td>1,092.00</td> </tr> </tbody> </table>		Source	REAL	Fair Cash	Capped	Asmnt Level	Assessed	Levy Rate	97.960	Current Tax	Remove Cap	0	Land Value 50,925	34,902	11%	3,839	Assessed	12,146	1,189.82	Year Frozen	2014	Improvements 110,189	75,520		8,307	Penalty	0		Uncapped Value	0	Mobile Home 0	0		0	Exemption	1,000	-98.00	TIF Project ID	0	Total Value 161,114	110,422		12,146	Total Taxable	11,146	1,092.00	<table border="1"> <thead> <tr> <th>Tax Year</th> <th>Statement Number</th> <th>Billed Owner</th> <th>Tax Area</th> <th>Total Value</th> <th>Exemptions</th> <th>Taxable Value</th> <th>Billed Tax</th> </tr> </thead> <tbody> <tr><td>2025</td><td>2025-660022031</td><td>HICKS, LONNIE G &</td><td>3</td><td>159,574</td><td>1000</td><td>11,146</td><td>1,092.00</td></tr> <tr><td>2024</td><td>2024-660022031</td><td>HICKS, LONNIE G &</td><td>3</td><td>166,695</td><td>1000</td><td>11,147</td><td>1,071.00</td></tr> <tr><td>2023</td><td>2023-660022031</td><td>HICKS, LONNIE G &</td><td>3</td><td>147,963</td><td>1000</td><td>11,147</td><td>1,045.00</td></tr> <tr><td>2022</td><td>2022-660022031</td><td>HICKS, LONNIE G &</td><td>3</td><td>147,959</td><td>1000</td><td>11,147</td><td>1,092.00</td></tr> <tr><td>2021</td><td>2021-660022031</td><td>HICKS, LONNIE G &</td><td>3</td><td>154,738</td><td>1000</td><td>11,147</td><td>1,078.00</td></tr> <tr><td>2020</td><td>2020-660022031</td><td>HICKS, LONNIE G &</td><td>3</td><td>153,981</td><td>1000</td><td>11,147</td><td>1,077.00</td></tr> <tr><td>2019</td><td>2019-660022031</td><td>HICKS, LONNIE G &</td><td>3</td><td>146,710</td><td>1000</td><td>11,146</td><td>1,077.00</td></tr> <tr><td>2018</td><td>2018-660022031</td><td>HICKS, LONNIE G &</td><td>3</td><td>150,832</td><td>1000</td><td>11,147</td><td>1,038.00</td></tr> <tr><td>2017</td><td>2017-660022031</td><td>HICKS, LONNIE G &</td><td>3</td><td>149,689</td><td>1000</td><td>11,146</td><td>1,048.00</td></tr> <tr><td>2016</td><td>2016-660022031</td><td>HICKS, LONNIE G &</td><td>3</td><td>146,028</td><td>1000</td><td>11,146</td><td>1,049.00</td></tr> <tr><td>2015</td><td>2015-660022031</td><td>HICKS, LONNIE G</td><td>3</td><td>141,984</td><td>1000</td><td>11,146</td><td>1,057.00</td></tr> <tr><td>2014</td><td>2014-660022031</td><td>HICKS, LONNIE G</td><td>3</td><td>144,522</td><td>1000</td><td>11,147</td><td>1,067.00</td></tr> <tr><td>2013</td><td>2013-660022031</td><td>HICKS, LONNIE G</td><td>3</td><td>137,594</td><td>1000</td><td>10,792</td><td>1,011.00</td></tr> </tbody> </table>			Tax Year	Statement Number	Billed Owner	Tax Area	Total Value	Exemptions	Taxable Value	Billed Tax	2025	2025-660022031	HICKS, LONNIE G &	3	159,574	1000	11,146	1,092.00	2024	2024-660022031	HICKS, LONNIE G &	3	166,695	1000	11,147	1,071.00	2023	2023-660022031	HICKS, LONNIE G &	3	147,963	1000	11,147	1,045.00	2022	2022-660022031	HICKS, LONNIE G &	3	147,959	1000	11,147	1,092.00	2021	2021-660022031	HICKS, LONNIE G &	3	154,738	1000	11,147	1,078.00	2020	2020-660022031	HICKS, LONNIE G &	3	153,981	1000	11,147	1,077.00	2019	2019-660022031	HICKS, LONNIE G &	3	146,710	1000	11,146	1,077.00	2018	2018-660022031	HICKS, LONNIE G &	3	150,832	1000	11,147	1,038.00	2017	2017-660022031	HICKS, LONNIE G &	3	149,689	1000	11,146	1,048.00	2016	2016-660022031	HICKS, LONNIE G &	3	146,028	1000	11,146	1,049.00	2015	2015-660022031	HICKS, LONNIE G	3	141,984	1000	11,146	1,057.00	2014	2014-660022031	HICKS, LONNIE G	3	144,522	1000	11,147	1,067.00	2013	2013-660022031	HICKS, LONNIE G	3	137,594	1000	10,792	1,011.00
Source	REAL	Fair Cash	Capped	Asmnt Level	Assessed	Levy Rate	97.960	Current Tax																																																																																																																																																									
Remove Cap	0	Land Value 50,925	34,902	11%	3,839	Assessed	12,146	1,189.82																																																																																																																																																									
Year Frozen	2014	Improvements 110,189	75,520		8,307	Penalty	0																																																																																																																																																										
Uncapped Value	0	Mobile Home 0	0		0	Exemption	1,000	-98.00																																																																																																																																																									
TIF Project ID	0	Total Value 161,114	110,422		12,146	Total Taxable	11,146	1,092.00																																																																																																																																																									
Tax Year	Statement Number	Billed Owner	Tax Area	Total Value	Exemptions	Taxable Value	Billed Tax																																																																																																																																																										
2025	2025-660022031	HICKS, LONNIE G &	3	159,574	1000	11,146	1,092.00																																																																																																																																																										
2024	2024-660022031	HICKS, LONNIE G &	3	166,695	1000	11,147	1,071.00																																																																																																																																																										
2023	2023-660022031	HICKS, LONNIE G &	3	147,963	1000	11,147	1,045.00																																																																																																																																																										
2022	2022-660022031	HICKS, LONNIE G &	3	147,959	1000	11,147	1,092.00																																																																																																																																																										
2021	2021-660022031	HICKS, LONNIE G &	3	154,738	1000	11,147	1,078.00																																																																																																																																																										
2020	2020-660022031	HICKS, LONNIE G &	3	153,981	1000	11,147	1,077.00																																																																																																																																																										
2019	2019-660022031	HICKS, LONNIE G &	3	146,710	1000	11,146	1,077.00																																																																																																																																																										
2018	2018-660022031	HICKS, LONNIE G &	3	150,832	1000	11,147	1,038.00																																																																																																																																																										
2017	2017-660022031	HICKS, LONNIE G &	3	149,689	1000	11,146	1,048.00																																																																																																																																																										
2016	2016-660022031	HICKS, LONNIE G &	3	146,028	1000	11,146	1,049.00																																																																																																																																																										
2015	2015-660022031	HICKS, LONNIE G	3	141,984	1000	11,146	1,057.00																																																																																																																																																										
2014	2014-660022031	HICKS, LONNIE G	3	144,522	1000	11,147	1,067.00																																																																																																																																																										
2013	2013-660022031	HICKS, LONNIE G	3	137,594	1000	10,792	1,011.00																																																																																																																																																										
Assessment History																																																																																																																																																																	



Rogers

Assessment Property Record Card for Tax Year 2026

Data provided by LISA DELOZIER County Assessor

Date 04/16/2026
 Time 21:43:31
 Page 2

Lot Data		Square-Foot - NBHD 1056 #1	
Lot Size			
Lot Count			
Units Buildable	1		
Non-Ag Acres	0.3897		
Topography			
Street Access			
Utilities			
Amenities	LAND QUALITY	0	0
Method	Square-Foot		
Base Lot Value	16,975.00 x 3.00 = 50,925		
Factor Value			
Adjustments	1.0000		
Lot Value	50,925		



\\tsclient\TCASEY\CASEY BOOTH RESIDENTIAL VI\2022-8-8\IM 8/8/2022

Residential Data	
Type	1 Single Family Residence
Condition	3 - Average
Quality	2 - Fair
Architecture	
Style	100% One Story
Exterior Wall	80% Veneer, Stone 20% Frame, Siding, Vinyl
Base/Total Area	1,568 / 1,568
Style	100% One Story
HVAC	100% Warmed & Cooled Air
Roof Cover	1 Composition Shingle
Area on Slab	1,568
Fixture/RghIn	11 /
Bed/F/H Bath	3 / 2.0 /
Basement Area	
Garage Type	400 Attached Garage - Unfinished
Remodel	
Year/Eff Age	1976 / 38

GRM Approach	
GRM Code	
Gross Rent	0.00
Indicated Value	

Multiple Regression			
MRA Code	1	Test	
Adusted R	0.8445		
Indicated Value	135,712	86.55	Per SqFt

Direct Comparables			
Selection Model	A	Adam Test	
Adjustment Model	1	2022 Residential	
Comparables	4		
Indicated Value	177,020		Per SqFt

Cost Approach				Manual : 01/2025			
Base Cost	101.16	Total Misc Impr	+	12,402			
Roofing Adj	+ 4.02	Garage Cost	+	9,944			
Subfloor Adj	+ 0.00	Total RCN	=	216,057			
Heat/Cool Adj	+ 10.30	Depreciation (49%)	-	105,868			
Plumbing Adj	+ 8.06	Lump Sums	+	0			
Basement Adj	+ 0.00	RCNLD	=	110,189			
Adj Base Cost	= 123.54	Lot Value	+	50,925			
Total Area	x 1,568	Indicated Value	=	161,114			
Adjusted Cost	= 193,711	Value Per SqFt		102.75			

Value Reconciliation			
Selected Approach	Cost Approach		
Improvements	110,189		
Lot Value	50,925		
Indicated Value	161,114	102.75	Per SqFt
Agland Value			
Site Improvements			
Total Value	161,114	102.75	Total Value Per SqFt

Miscellaneous Improvements								
Code	Description	Sketch ID	Size	Year	Units	Unit Cost	Depr	Value
FPR1	FIREPLACE - RESIDENTIAL 1 STORY	0		1	1	4,576.55		4,577
PRCH	SLAB PORCH - COVERED	53629		188	188	20.70		3,892
PRCH	SLAB PORCH - COVERED	53630		190	190	20.70		3,933



Rogers

Assessment Property Record Card for Tax Year 2026

Data provided by LISA DELOZIER County Assessor

Date 04/16/2026
 Time 21:43:31
 Page 3

Sketch Image

660022031

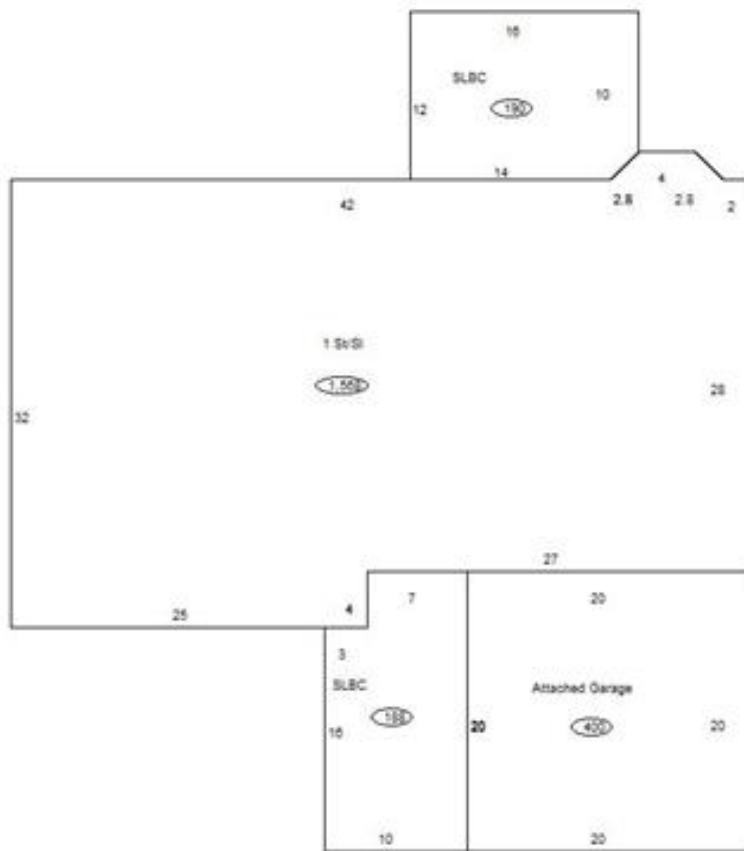

Sketch Vector Information

Sequence	Code	Type	Built Over	Scale	Section Label	Base Area	Multiplier	Total Area
1	R	1	Slab	10	1 St/SI	1,568	1.000	1,568
2	G	1		10	Attached Garage	400	1.000	400
3	M	PRCH		10	SLBC	188	1.000	188
4	M	PRCH		10	SLBC	190	1.000	190
Total Building Area						1,568		1,568



Rogers



Assessment Property Record Card for Tax Year 2026

Data provided by LISA DELOZIER County Assessor

Date 04/16/2026
Time 21:43:31
Page 4

660022031

Outbuildings/Site Improvements

Building Image	Code	Description	Dimensions	Floor	Roofing	Total Units
	CPDT	CARPORT - DETACHED	12x30x0			360
	Qual	2	Cond 3	Year	Eff Age 1520	
	Valuation Summary		Modifier Total		RCN	Depr (100% Phys/ % Func)
	Base Cost (10.84 x 360)		3,902		3,902	3,902
	STF	STG FAIR	12x12x0			144
	Qual	2	Cond 3	Year	Eff Age 1520	
	Valuation Summary		Modifier Total		RCN	Depr (100% Phys/ % Func)
	Base Cost (4.68 x 144)		674		674	674