



# Rogers

## Assessment Property Record Card for Tax Year 2026

Data provided by LISA DELOZIER County Assessor

Date 04/16/2026  
Time 21:44:21  
Page 1

Assessment Data					Primary Image																																																																																																																				
<b>Account</b> 660022086 <b>Parcel ID</b> 000000-00-0-00426-005-0011 <b>Cadastral ID</b> 26-21-14-05080 <b>Property Type</b> REAL - Real Property <b>Property Class</b> RRP VI Area 4 <b>Tax Area</b> 3 - OWASSO RURAL/NO FIRE <b>Name ID</b> 266219 QUEZADA, MANUEL JR & ANGELICA  7609 N 174TH E AVE OWASSO OK 74055-0000  <b>Parcel Location</b> <b>Situs</b> 07609 N 174TH E AVE <b>Subdivision</b> LA STRANGE ACRES 2ND AMD <b>Lot/Block</b> 0011 / 0005 Parcel Size 1 - Lots <b>Sec/Twn/Rng</b> 26 / 21 / 14 / 5 <b>Neighborhood</b> 1056 - R-V04-SW OWASSO <b>School District</b> S021 - OWASSO SCHOOLS																																																																																																																									
<b>Legal Description</b> Lat/Long: 36.26528381 -95.78055200																																																																																																																									
<b>Building Permits</b>					\\tsclient\TCASEY\CASEY BOOTH RESIDENTIAL VI\2022-8-9\IM 8/9/2022																																																																																																																				
<b>Exemptions</b>					<b>Sale History</b>																																																																																																																				
<table border="1"> <thead> <tr> <th>Code</th> <th>Type</th> <th>Active</th> <th>Maximum</th> <th>Exemption</th> </tr> </thead> <tbody> <tr> <td>H</td> <td>Homestead</td> <td>Yes</td> <td>1,000</td> <td>1,000</td> </tr> </tbody> </table>					Code	Type	Active	Maximum	Exemption	H	Homestead	Yes	1,000	1,000	<table border="1"> <thead> <tr> <th>Number</th> <th>Description</th> <th>Opened</th> <th>Closed</th> <th>Amount</th> </tr> </thead> <tbody> <tr> <td>1074/233</td> <td>GUERTIN, KENNETH W JR</td> <td>07/23/1997</td> <td></td> <td>80,500 Yes</td> </tr> </tbody> </table>					Number	Description	Opened	Closed	Amount	1074/233	GUERTIN, KENNETH W JR	07/23/1997		80,500 Yes																																																																																												
Code	Type	Active	Maximum	Exemption																																																																																																																					
H	Homestead	Yes	1,000	1,000																																																																																																																					
Number	Description	Opened	Closed	Amount																																																																																																																					
1074/233	GUERTIN, KENNETH W JR	07/23/1997		80,500 Yes																																																																																																																					
<b>Parcel Valuation</b>					<table border="1"> <thead> <tr> <th>Source</th> <th>REAL</th> <th>Fair Cash</th> <th>Capped</th> <th>Asmnt Level</th> <th>Assessed</th> <th>Levy Rate</th> <th>97.960</th> <th>Current Tax</th> </tr> </thead> <tbody> <tr> <td>Remove Cap</td> <td>1998</td> <td>Land Value 51,333</td> <td>51,333</td> <td>11%</td> <td>5,647</td> <td>Assessed</td> <td>17,522</td> <td>1,716.46</td> </tr> <tr> <td>Year Frozen</td> <td>0</td> <td>Improvements 107,956</td> <td>107,956</td> <td></td> <td>11,875</td> <td>Penalty</td> <td>0</td> <td></td> </tr> <tr> <td>Uncapped Value</td> <td>0</td> <td>Mobile Home 0</td> <td>0</td> <td></td> <td>0</td> <td>Exemption</td> <td>1,000</td> <td>-98.00</td> </tr> <tr> <td>TIF Project ID</td> <td>0</td> <td>Total Value 159,289</td> <td>159,289</td> <td></td> <td>17,522</td> <td>Total Taxable</td> <td>16,522</td> <td>1,618.00</td> </tr> </tbody> </table>					Source	REAL	Fair Cash	Capped	Asmnt Level	Assessed	Levy Rate	97.960	Current Tax	Remove Cap	1998	Land Value 51,333	51,333	11%	5,647	Assessed	17,522	1,716.46	Year Frozen	0	Improvements 107,956	107,956		11,875	Penalty	0		Uncapped Value	0	Mobile Home 0	0		0	Exemption	1,000	-98.00	TIF Project ID	0	Total Value 159,289	159,289		17,522	Total Taxable	16,522	1,618.00																																																																			
Source	REAL	Fair Cash	Capped	Asmnt Level	Assessed	Levy Rate	97.960	Current Tax																																																																																																																	
Remove Cap	1998	Land Value 51,333	51,333	11%	5,647	Assessed	17,522	1,716.46																																																																																																																	
Year Frozen	0	Improvements 107,956	107,956		11,875	Penalty	0																																																																																																																		
Uncapped Value	0	Mobile Home 0	0		0	Exemption	1,000	-98.00																																																																																																																	
TIF Project ID	0	Total Value 159,289	159,289		17,522	Total Taxable	16,522	1,618.00																																																																																																																	
<b>Assessment History</b>					<table border="1"> <thead> <tr> <th>Tax Year</th> <th>Statement Number</th> <th>Billed Owner</th> <th>Tax Area</th> <th>Total Value</th> <th>Exemptions</th> <th>Taxable Value</th> <th>Billed Tax</th> </tr> </thead> <tbody> <tr><td>2025</td><td>2025-660022086</td><td>QUEZADA, MANUEL JR &amp; ANGELICA</td><td>3</td><td>157,908</td><td>1000</td><td>16,370</td><td>1,604.00</td></tr> <tr><td>2024</td><td>2024-660022086</td><td>QUEZADA, MANUEL JR &amp; ANGELICA</td><td>3</td><td>172,995</td><td>1000</td><td>16,448</td><td>1,580.00</td></tr> <tr><td>2023</td><td>2023-660022086</td><td>QUEZADA, MANUEL JR &amp; ANGELICA</td><td>3</td><td>170,100</td><td>1000</td><td>15,939</td><td>1,494.00</td></tr> <tr><td>2022</td><td>2022-660022086</td><td>QUEZADA, MANUEL JR &amp; ANGELICA</td><td>3</td><td>170,094</td><td>1000</td><td>15,446</td><td>1,513.00</td></tr> <tr><td>2021</td><td>2021-660022086</td><td>QUEZADA, MANUEL JR &amp; ANGELICA</td><td>3</td><td>165,612</td><td>1000</td><td>14,967</td><td>1,448.00</td></tr> <tr><td>2020</td><td>2020-660022086</td><td>QUEZADA, MANUEL JR &amp; ANGELICA</td><td>3</td><td>163,014</td><td>1000</td><td>14,502</td><td>1,401.00</td></tr> <tr><td>2019</td><td>2019-660022086</td><td>QUEZADA, MANUEL JR &amp; ANGELICA</td><td>3</td><td>158,157</td><td>1000</td><td>14,051</td><td>1,358.00</td></tr> <tr><td>2018</td><td>2018-660022086</td><td>QUEZADA, MANUEL JR &amp; ANGELICA</td><td>3</td><td>160,920</td><td>1000</td><td>13,612</td><td>1,267.00</td></tr> <tr><td>2017</td><td>2017-660022086</td><td>QUEZADA, MANUEL JR &amp; ANGELICA</td><td>3</td><td>159,658</td><td>1000</td><td>13,187</td><td>1,240.00</td></tr> <tr><td>2016</td><td>2016-660022086</td><td>QUEZADA, MANUEL JR &amp; ANGELICA</td><td>3</td><td>155,680</td><td>1000</td><td>12,774</td><td>1,203.00</td></tr> <tr><td>2015</td><td>2015-660022086</td><td>QUEZADA, MANUEL JR &amp; ANGELICA</td><td>3</td><td>151,636</td><td>1000</td><td>12,373</td><td>1,173.00</td></tr> <tr><td>2014</td><td>2014-660022086</td><td>QUEZADA, MANUEL JR &amp; ANGELICA</td><td>3</td><td>138,686</td><td>1000</td><td>11,077</td><td>1,060.00</td></tr> <tr><td>2013</td><td>2013-660022086</td><td>QUEZADA, MANUEL JR &amp; ANGELICA</td><td>3</td><td>131,155</td><td>1000</td><td>10,725</td><td>1,005.00</td></tr> </tbody> </table>					Tax Year	Statement Number	Billed Owner	Tax Area	Total Value	Exemptions	Taxable Value	Billed Tax	2025	2025-660022086	QUEZADA, MANUEL JR & ANGELICA	3	157,908	1000	16,370	1,604.00	2024	2024-660022086	QUEZADA, MANUEL JR & ANGELICA	3	172,995	1000	16,448	1,580.00	2023	2023-660022086	QUEZADA, MANUEL JR & ANGELICA	3	170,100	1000	15,939	1,494.00	2022	2022-660022086	QUEZADA, MANUEL JR & ANGELICA	3	170,094	1000	15,446	1,513.00	2021	2021-660022086	QUEZADA, MANUEL JR & ANGELICA	3	165,612	1000	14,967	1,448.00	2020	2020-660022086	QUEZADA, MANUEL JR & ANGELICA	3	163,014	1000	14,502	1,401.00	2019	2019-660022086	QUEZADA, MANUEL JR & ANGELICA	3	158,157	1000	14,051	1,358.00	2018	2018-660022086	QUEZADA, MANUEL JR & ANGELICA	3	160,920	1000	13,612	1,267.00	2017	2017-660022086	QUEZADA, MANUEL JR & ANGELICA	3	159,658	1000	13,187	1,240.00	2016	2016-660022086	QUEZADA, MANUEL JR & ANGELICA	3	155,680	1000	12,774	1,203.00	2015	2015-660022086	QUEZADA, MANUEL JR & ANGELICA	3	151,636	1000	12,373	1,173.00	2014	2014-660022086	QUEZADA, MANUEL JR & ANGELICA	3	138,686	1000	11,077	1,060.00	2013	2013-660022086	QUEZADA, MANUEL JR & ANGELICA	3	131,155	1000	10,725	1,005.00
Tax Year	Statement Number	Billed Owner	Tax Area	Total Value	Exemptions	Taxable Value	Billed Tax																																																																																																																		
2025	2025-660022086	QUEZADA, MANUEL JR & ANGELICA	3	157,908	1000	16,370	1,604.00																																																																																																																		
2024	2024-660022086	QUEZADA, MANUEL JR & ANGELICA	3	172,995	1000	16,448	1,580.00																																																																																																																		
2023	2023-660022086	QUEZADA, MANUEL JR & ANGELICA	3	170,100	1000	15,939	1,494.00																																																																																																																		
2022	2022-660022086	QUEZADA, MANUEL JR & ANGELICA	3	170,094	1000	15,446	1,513.00																																																																																																																		
2021	2021-660022086	QUEZADA, MANUEL JR & ANGELICA	3	165,612	1000	14,967	1,448.00																																																																																																																		
2020	2020-660022086	QUEZADA, MANUEL JR & ANGELICA	3	163,014	1000	14,502	1,401.00																																																																																																																		
2019	2019-660022086	QUEZADA, MANUEL JR & ANGELICA	3	158,157	1000	14,051	1,358.00																																																																																																																		
2018	2018-660022086	QUEZADA, MANUEL JR & ANGELICA	3	160,920	1000	13,612	1,267.00																																																																																																																		
2017	2017-660022086	QUEZADA, MANUEL JR & ANGELICA	3	159,658	1000	13,187	1,240.00																																																																																																																		
2016	2016-660022086	QUEZADA, MANUEL JR & ANGELICA	3	155,680	1000	12,774	1,203.00																																																																																																																		
2015	2015-660022086	QUEZADA, MANUEL JR & ANGELICA	3	151,636	1000	12,373	1,173.00																																																																																																																		
2014	2014-660022086	QUEZADA, MANUEL JR & ANGELICA	3	138,686	1000	11,077	1,060.00																																																																																																																		
2013	2013-660022086	QUEZADA, MANUEL JR & ANGELICA	3	131,155	1000	10,725	1,005.00																																																																																																																		



# Rogers

## Assessment Property Record Card for Tax Year 2026

Data provided by LISA DELOZIER County Assessor

Date 04/16/2026  
 Time 21:44:21  
 Page 2

Lot Data	Square-Foot - NBHD 1056 #1	Primary Image
Lot Size		
Lot Count		
Units Buildable	1	
Non-Ag Acres	0.3928	
Topography		
Street Access		
Utilities		
Amenities	LAND QUALITY	
	0	
	0	
Method	Square-Foot	
Base Lot Value	17,111.00 x 3.00 = 51,333	
Factor Value		
Adjustments	1.0000	
Lot Value	51,333	

Residential Data	
Type	1 Single Family Residence
Condition	3 - Average
Quality	2 - Fair
Architecture	
Style	100% One Story
Exterior Wall	80% Veneer, Stone 20% Frame, Siding, Wood
Base/Total Area	1,500 / 1,500
Style	100% One Story
HVAC	100% Warmed & Cooled Air
Roof Cover	1 Composition Shingle
Area on Slab	1,500
Fixture/RghIn	11 /
Bed/F/H Bath	3 / 2.0 /
Basement Area	
Garage Type	546 Attached Garage - Unfinished
Remodel	
Year/Eff Age	1976 / 38

GRM Approach	
GRM Code	
Gross Rent	0.00
Indicated Value	

Multiple Regression	
MRA Code	1 Test
Adjusted R	0.8445
Indicated Value	145,422 96.95 Per SqFt

Direct Comparables	
Selection Model	A Adam Test
Adjustment Model	1 2022 Residential
Comparables	4
Indicated Value	187,340 Per SqFt

Cost Approach				Manual : 01/2025			
Base Cost	97.01	Total Misc Impr	+ 19,706				
Roofing Adj	+ 3.91	Garage Cost	+ 12,498				
Subfloor Adj	+ 0.00	Total RCN	= 211,679				
Heat/Cool Adj	+ 10.30	Depreciation ( 49%)	- 103,723				
Plumbing Adj	+ 8.43	Lump Sums	+ 0				
Basement Adj	+ 0.00	RCNLD	= 107,956				
Adj Base Cost	= 119.65	Lot Value	+ 51,333				
Total Area	x 1,500	Indicated Value	= 159,289				
Adjusted Cost	= 179,475	Value Per SqFt	106.19				

Value Reconciliation	
Selected Approach	Cost Approach
Improvements	107,956
Lot Value	51,333
Indicated Value	159,289 106.19 Per SqFt
Agland Value	
Site Improvements	
Total Value	159,289 106.19 Total Value Per SqFt

Miscellaneous Improvements								
Code	Description	Sketch ID	Size	Year	Units	Unit Cost	Depr	Value
FPR1	FIREPLACE - RESIDENTIAL 1 STORY	0		1	1	4,576.55		4,577
PRCH	SLAB PORCH - COVERED	53831		6x4	24	21.22		509
EPSW	ENCLOSED PORCH - SOLID WALL	122394		17x16	272	53.75		14,620



# Rogers

## Assessment Property Record Card for Tax Year 2026

Data provided by LISA DELOZIER County Assessor

Date 04/16/2026  
 Time 21:44:21  
 Page 3

### Sketch Image

660022086

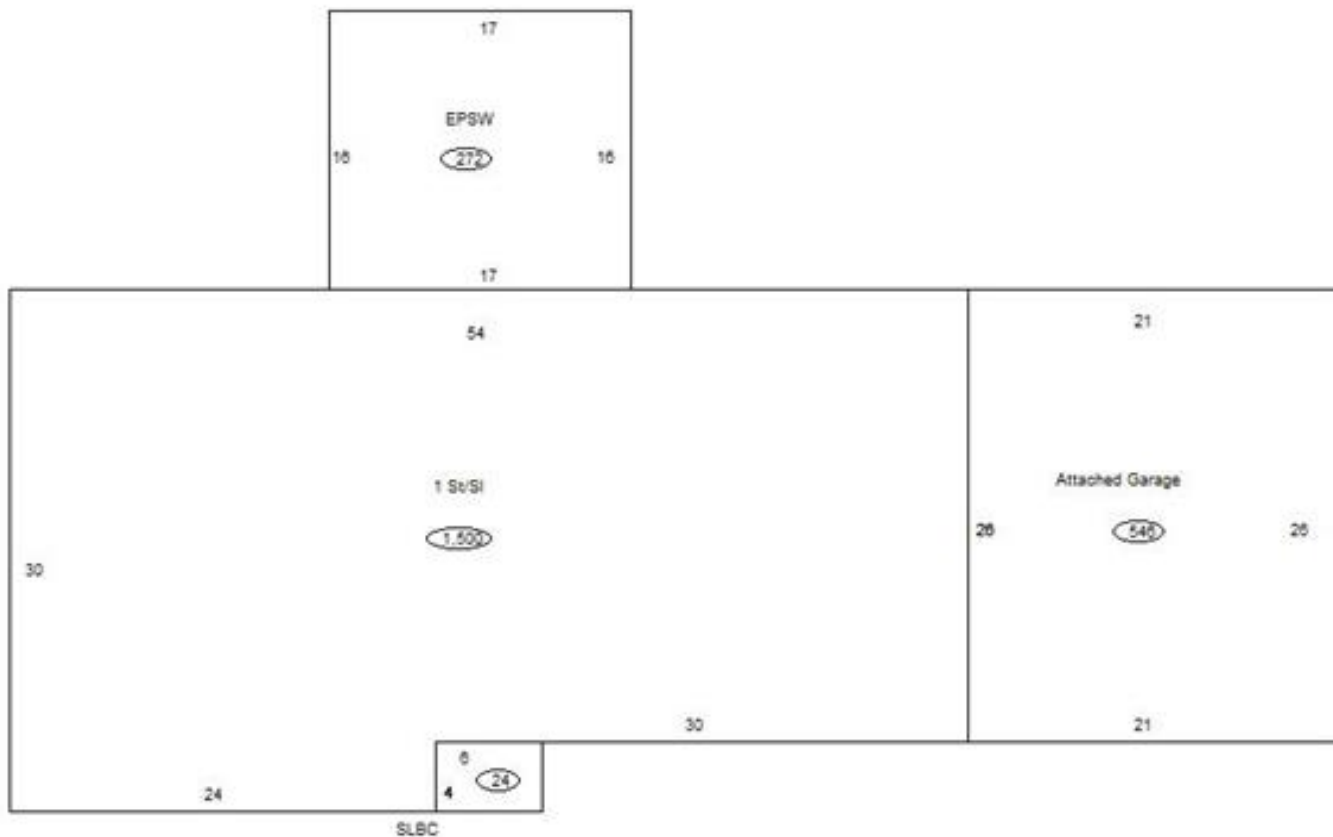

### Sketch Vector Information

Sequence	Code	Type	Built Over	Scale	Section Label	Base Area	Multiplier	Total Area
1	R	1	Slab	10	1 St/SI	1,500	1.000	1,500
2	G	1		10	Attached Garage	546	1.000	546
3	M	PRCH		10	SLBC	24	1.000	24
4	M	EPSW		10	EPSW	272	1.000	272
<b>Total Building Area</b>						<b>1,500</b>		<b>1,500</b>