



# Rogers

## Assessment Property Record Card for Tax Year 2026

Data provided by LISA DELOZIER County Assessor

Date 04/16/2026  
Time 21:44:29  
Page 1

Assessment Data					Primary Image																																																																																																																				
<b>Account</b> 660022093 <b>Parcel ID</b> 000000-00-0-00426-006-0006 <b>Cadastral ID</b> 26-21-14-05150 <b>Property Type</b> REAL - Real Property <b>Property Class</b> RRP VI Area 4 <b>Tax Area</b> 3 - OWASSO RURAL/NO FIRE <b>Name ID</b> 337707 NEWPORT, BRYAN J & MANDIE K NEWPORT  7602 N 174TH E AVE OWASSO OK 74055-0000  <b>Parcel Location</b> <b>Situs</b> 07602 N 174TH E AVE <b>Subdivision</b> LA STRANGE ACRES 2ND AMD <b>Lot/Block</b> 0006 / 0006 Parcel Size 2 - Lots <b>Sec/Twn/Rng</b> 26 / 21 / 14 / 5 <b>Neighborhood</b> 1056 - R-V04-SW OWASSO <b>School District</b> S021 - OWASSO SCHOOLS					<p style="text-align: right; color: orange;">08/09/2022 09:58</p> <p>\\tsclient\TCASEY\CASEY BOOTH RESIDENTIAL VI\2022-8-9\IM 8/9/2022</p>																																																																																																																				
<b>Legal Description</b> Lat/Long: 36.26432979 -95.78133509 LOTS 5 & 6 BLOCK 6 LA STRANGE ACRES 2ND AMD.																																																																																																																									
<b>Exemptions</b> <table border="1"> <thead> <tr> <th>Code</th> <th>Type</th> <th>Active</th> <th>Maximum</th> <th>Exemption</th> </tr> </thead> <tbody> <tr> <td>H</td> <td>Homestead</td> <td>Yes</td> <td>1,000</td> <td>1,000</td> </tr> <tr> <td>H</td> <td>Homestead</td> <td>No</td> <td>1,000</td> <td></td> </tr> <tr> <td>H</td> <td>Homestead</td> <td>No</td> <td>1,000</td> <td></td> </tr> </tbody> </table>					Code	Type	Active	Maximum	Exemption	H	Homestead	Yes	1,000	1,000	H	Homestead	No	1,000		H	Homestead	No	1,000		<b>Building Permits</b> <table border="1"> <thead> <tr> <th>Number</th> <th>Description</th> <th>Opened</th> <th>Closed</th> <th>Amount</th> </tr> </thead> <tbody> <tr> <td></td> <td></td> <td></td> <td></td> <td></td> </tr> </tbody> </table>					Number	Description	Opened	Closed	Amount																																																																																							
Code	Type	Active	Maximum	Exemption																																																																																																																					
H	Homestead	Yes	1,000	1,000																																																																																																																					
H	Homestead	No	1,000																																																																																																																						
H	Homestead	No	1,000																																																																																																																						
Number	Description	Opened	Closed	Amount																																																																																																																					
<b>Parcel Valuation</b> <table border="1"> <thead> <tr> <th>Source</th> <th>REAL</th> <th>Fair Cash</th> <th>Capped</th> <th>Asmnt Level</th> <th>Assessed</th> <th>Levy Rate</th> <th>97.960</th> <th>Current Tax</th> </tr> </thead> <tbody> <tr> <td>Remove Cap</td> <td>2023</td> <td>Land Value 94,859</td> <td>94,859</td> <td>11%</td> <td>10,434</td> <td>Assessed</td> <td>25,843</td> <td>2,531.58</td> </tr> <tr> <td>Year Frozen</td> <td>2006</td> <td>Improvements 142,156</td> <td>140,076</td> <td></td> <td>15,409</td> <td>Penalty</td> <td>0</td> <td></td> </tr> <tr> <td>Uncapped Value</td> <td>0</td> <td>Mobile Home 0</td> <td>0</td> <td></td> <td>0</td> <td>Exemption</td> <td>1,000</td> <td>-98.00</td> </tr> <tr> <td>TIF Project ID</td> <td>0</td> <td>Total Value 237,015</td> <td>234,935</td> <td></td> <td>25,843</td> <td>Total Taxable</td> <td>24,843</td> <td>2,434.00</td> </tr> </tbody> </table>					Source	REAL	Fair Cash	Capped	Asmnt Level	Assessed	Levy Rate	97.960	Current Tax	Remove Cap	2023	Land Value 94,859	94,859	11%	10,434	Assessed	25,843	2,531.58	Year Frozen	2006	Improvements 142,156	140,076		15,409	Penalty	0		Uncapped Value	0	Mobile Home 0	0		0	Exemption	1,000	-98.00	TIF Project ID	0	Total Value 237,015	234,935		25,843	Total Taxable	24,843	2,434.00	<b>Sale History</b> <table border="1"> <thead> <tr> <th>Bk/Pg</th> <th>Grantor</th> <th>Date</th> <th>Price</th> <th>Code</th> </tr> </thead> <tbody> <tr> <td>/</td> <td>BARGFELDT, JOHN E &amp;</td> <td>03/15/2022</td> <td>215,000</td> <td>YES</td> </tr> <tr> <td>2715/502</td> <td>SEHESTED, ROBERT H</td> <td>06/01/2018</td> <td>161,000</td> <td>19</td> </tr> </tbody> </table>					Bk/Pg	Grantor	Date	Price	Code	/	BARGFELDT, JOHN E &	03/15/2022	215,000	YES	2715/502	SEHESTED, ROBERT H	06/01/2018	161,000	19																																																				
Source	REAL	Fair Cash	Capped	Asmnt Level	Assessed	Levy Rate	97.960	Current Tax																																																																																																																	
Remove Cap	2023	Land Value 94,859	94,859	11%	10,434	Assessed	25,843	2,531.58																																																																																																																	
Year Frozen	2006	Improvements 142,156	140,076		15,409	Penalty	0																																																																																																																		
Uncapped Value	0	Mobile Home 0	0		0	Exemption	1,000	-98.00																																																																																																																	
TIF Project ID	0	Total Value 237,015	234,935		25,843	Total Taxable	24,843	2,434.00																																																																																																																	
Bk/Pg	Grantor	Date	Price	Code																																																																																																																					
/	BARGFELDT, JOHN E &	03/15/2022	215,000	YES																																																																																																																					
2715/502	SEHESTED, ROBERT H	06/01/2018	161,000	19																																																																																																																					
<b>Assessment History</b> <table border="1"> <thead> <tr> <th>Tax Year</th> <th>Statement Number</th> <th>Billed Owner</th> <th>Tax Area</th> <th>Total Value</th> <th>Exemptions</th> <th>Taxable Value</th> <th>Billed Tax</th> </tr> </thead> <tbody> <tr><td>2025</td><td>2025-660022093</td><td>NEWPORT, BRYAN J &amp;</td><td>3</td><td>228,297</td><td>1000</td><td>24,091</td><td>2,360.00</td></tr> <tr><td>2024</td><td>2024-660022093</td><td>NEWPORT, BRYAN J &amp;</td><td>3</td><td>249,058</td><td>1000</td><td>23,360</td><td>2,244.00</td></tr> <tr><td>2023</td><td>2023-660022093</td><td>NEWPORT, BRYAN J &amp;</td><td>3</td><td>215,000</td><td>0</td><td>23,650</td><td>2,216.00</td></tr> <tr><td>2022</td><td>2022-660022093</td><td>NEWPORT, BRYAN J &amp;</td><td>3</td><td>187,026</td><td>0</td><td>20,573</td><td>2,016.00</td></tr> <tr><td>2021</td><td>2021-660022093</td><td>BARGFELDT, JOHN E &amp;</td><td>3</td><td>193,720</td><td>0</td><td>21,309</td><td>2,061.00</td></tr> <tr><td>2020</td><td>2020-660022093</td><td>BARGFELDT, JOHN E &amp;</td><td>3</td><td>191,215</td><td>0</td><td>21,034</td><td>2,032.00</td></tr> <tr><td>2019</td><td>2019-660022093</td><td>BARGFELDT, JOHN E &amp;</td><td>3</td><td>185,315</td><td>1000</td><td>19,385</td><td>1,874.00</td></tr> <tr><td>2018</td><td>2018-660022093</td><td>BARGFELDT, JOHN E &amp;</td><td>3</td><td>197,167</td><td>1000</td><td>11,249</td><td>1,047.00</td></tr> <tr><td>2017</td><td>2017-660022093</td><td>SEHESTED, ROBERT H</td><td>3</td><td>195,726</td><td>1000</td><td>11,250</td><td>1,058.00</td></tr> <tr><td>2016</td><td>2016-660022093</td><td>SEHESTED, ROBERT H</td><td>3</td><td>191,780</td><td>1000</td><td>11,250</td><td>1,059.00</td></tr> <tr><td>2015</td><td>2015-660022093</td><td>SEHESTED, ROBERT H</td><td>3</td><td>187,437</td><td>1000</td><td>11,250</td><td>1,067.00</td></tr> <tr><td>2014</td><td>2014-660022093</td><td>SEHESTED, ROBERT H</td><td>3</td><td>189,368</td><td>1000</td><td>11,249</td><td>1,077.00</td></tr> <tr><td>2013</td><td>2013-660022093</td><td>SEHESTED, ROBERT H</td><td>3</td><td>144,668</td><td>1000</td><td>8,418</td><td>789.00</td></tr> </tbody> </table>										Tax Year	Statement Number	Billed Owner	Tax Area	Total Value	Exemptions	Taxable Value	Billed Tax	2025	2025-660022093	NEWPORT, BRYAN J &	3	228,297	1000	24,091	2,360.00	2024	2024-660022093	NEWPORT, BRYAN J &	3	249,058	1000	23,360	2,244.00	2023	2023-660022093	NEWPORT, BRYAN J &	3	215,000	0	23,650	2,216.00	2022	2022-660022093	NEWPORT, BRYAN J &	3	187,026	0	20,573	2,016.00	2021	2021-660022093	BARGFELDT, JOHN E &	3	193,720	0	21,309	2,061.00	2020	2020-660022093	BARGFELDT, JOHN E &	3	191,215	0	21,034	2,032.00	2019	2019-660022093	BARGFELDT, JOHN E &	3	185,315	1000	19,385	1,874.00	2018	2018-660022093	BARGFELDT, JOHN E &	3	197,167	1000	11,249	1,047.00	2017	2017-660022093	SEHESTED, ROBERT H	3	195,726	1000	11,250	1,058.00	2016	2016-660022093	SEHESTED, ROBERT H	3	191,780	1000	11,250	1,059.00	2015	2015-660022093	SEHESTED, ROBERT H	3	187,437	1000	11,250	1,067.00	2014	2014-660022093	SEHESTED, ROBERT H	3	189,368	1000	11,249	1,077.00	2013	2013-660022093	SEHESTED, ROBERT H	3	144,668	1000	8,418	789.00
Tax Year	Statement Number	Billed Owner	Tax Area	Total Value	Exemptions	Taxable Value	Billed Tax																																																																																																																		
2025	2025-660022093	NEWPORT, BRYAN J &	3	228,297	1000	24,091	2,360.00																																																																																																																		
2024	2024-660022093	NEWPORT, BRYAN J &	3	249,058	1000	23,360	2,244.00																																																																																																																		
2023	2023-660022093	NEWPORT, BRYAN J &	3	215,000	0	23,650	2,216.00																																																																																																																		
2022	2022-660022093	NEWPORT, BRYAN J &	3	187,026	0	20,573	2,016.00																																																																																																																		
2021	2021-660022093	BARGFELDT, JOHN E &	3	193,720	0	21,309	2,061.00																																																																																																																		
2020	2020-660022093	BARGFELDT, JOHN E &	3	191,215	0	21,034	2,032.00																																																																																																																		
2019	2019-660022093	BARGFELDT, JOHN E &	3	185,315	1000	19,385	1,874.00																																																																																																																		
2018	2018-660022093	BARGFELDT, JOHN E &	3	197,167	1000	11,249	1,047.00																																																																																																																		
2017	2017-660022093	SEHESTED, ROBERT H	3	195,726	1000	11,250	1,058.00																																																																																																																		
2016	2016-660022093	SEHESTED, ROBERT H	3	191,780	1000	11,250	1,059.00																																																																																																																		
2015	2015-660022093	SEHESTED, ROBERT H	3	187,437	1000	11,250	1,067.00																																																																																																																		
2014	2014-660022093	SEHESTED, ROBERT H	3	189,368	1000	11,249	1,077.00																																																																																																																		
2013	2013-660022093	SEHESTED, ROBERT H	3	144,668	1000	8,418	789.00																																																																																																																		



# Rogers

## Assessment Property Record Card for Tax Year 2026

Data provided by LISA DELOZIER County Assessor

Date 04/16/2026  
Time 21:44:29  
Page 2

Lot Data	Square-Foot - NBHD 1056 #1	Primary Image
Lot Size		
Lot Count	2	
Units Buildable		
Non-Ag Acres	0	
Topography		
Street Access		
Utilities		
Amenities	LAND QUALITY	
	0	
	0	
Method	Square-Foot	
Base Lot Value	36,239.00 x 2.62 = 94,859	
Factor Value		
Adjustments	1.0000	
Lot Value	94,859	

Residential Data	
Type	1 Single Family Residence
Condition	3 - Average
Quality	2 - Fair
Architecture	
Style	100% One Story
Exterior Wall	70% Veneer, Stone 30% Frame, Siding, Vinyl
Base/Total Area	1,731 / 1,731
Style	100% One Story
HVAC	100% Warmed & Cooled Air
Roof Cover	1 Composition Shingle
Area on Slab	1,731
Fixture/RghIn	11 /
Bed/F/H Bath	3 / 2.0 /
Basement Area	
Garage Type	441 Attached Garage - Unfinished
Remodel	
Year/Eff Age	1977 / 37



\\tsclient\TCASEY\CASEY BOOTH RESIDENTIAL VI\2022-8-9\IM 8/9/2022

GRM Approach	
GRM Code	
Gross Rent	0.00
Indicated Value	

Multiple Regression			
MRA Code	1	Test	
Adjusted R	0.8445		
Indicated Value	175,876	101.60	Per SqFt

Direct Comparables			
Selection Model	A	Adam Test	
Adjustment Model	1	2022 Residential	
Comparables	4		
Indicated Value	253,180		Per SqFt

Cost Approach				Manual : 01/2025			
Base Cost	92.49	Total Misc Impr	+	12,626			
Roofing Adj	+ 3.76	Garage Cost	+	10,628			
Subfloor Adj	+ 0.00	Total RCN	=	220,328			
Heat/Cool Adj	+ 10.30	Depreciation ( 48%)	-	105,757			
Plumbing Adj	+ 7.30	Lump Sums	+	0			
Basement Adj	+ 0.00	RCNLD	=	114,571			
Adj Base Cost	= 113.85	Lot Value	+	94,859			
Total Area	x 1,731	Indicated Value	=	209,430			
Adjusted Cost	= 197,074	Value Per SqFt		120.99			

Value Reconciliation			
Selected Approach	Cost Approach		
Improvements	114,571		
Lot Value	94,859		
Indicated Value	209,430	120.99	Per SqFt
Agland Value			
Site Improvements	27,585		
Total Value	237,015	136.92	Total Value Per SqFt

Miscellaneous Improvements								
Code	Description	Sketch ID	Size	Year	Units	Unit Cost	Depr	Value
FPR1	FIREPLACE - RESIDENTIAL 1 STORY	0		1	1	4,576.55		4,577
PRCH	SLAB PORCH - COVERED	53856	41x6		246	20.52		5,048
PRCH	SLAB PORCH - COVERED	53857	12x12		144	20.84		3,001



# Rogers

## Assessment Property Record Card for Tax Year 2026

Data provided by LISA DELOZIER County Assessor

Date 04/16/2026  
 Time 21:44:29  
 Page 3

Sketch Image

660022093

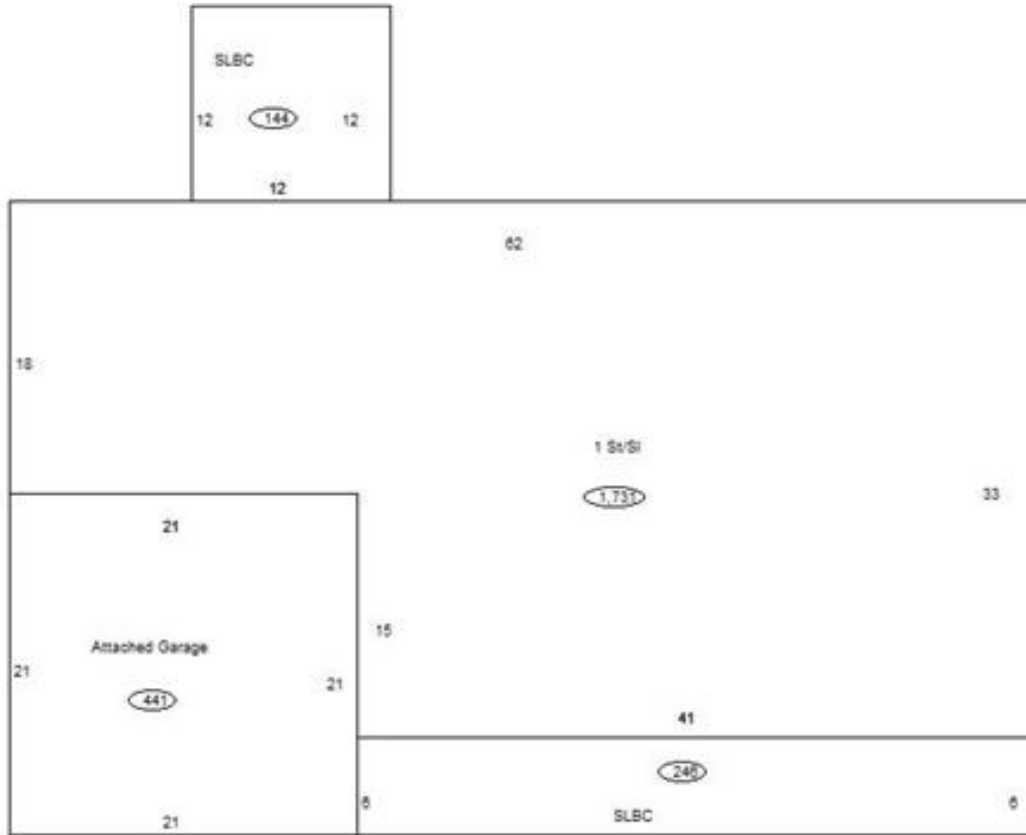

### Sketch Vector Information

Sequence	Code	Type	Built Over	Scale	Section Label	Base Area	Multiplier	Total Area
1	R	1	Slab	10	1 St/SI	1,731	1.000	1,731
2	G	1		10	Attached Garage	441	1.000	441
3	M	PRCH		10	SLBC	246	1.000	246
4	M	PRCH		10	SLBC	144	1.000	144
<b>Total Building Area</b>						<b>1,731</b>		<b>1,731</b>



# Rogers

## Assessment Property Record Card for Tax Year 2026

Data provided by LISA DELOZIER County Assessor

Date 04/16/2026  
 Time 21:44:29  
 Page 4

660022093

### Outbuildings/Site Improvements

Building Image	Code	Description	Dimensions	Floor	Roofing	Total Units
	UTIL	SHOP BUILDING	45x25x0			1,125
	Qual 2	Cond 3	Year	Eff Age		
	<b>Valuation Summary</b> Base Cost (30.64 x 1,125) 34,470		<b>Modifier Total</b>	<b>RCN</b> 34,470	<b>Depr (30% Phys/ % Func)</b> 10,341	<b>RCNLD</b> 24,129
	DTGF	DETACHED GARAGE FAIR	20x18x0			360
	Qual 2	Cond 3	Year	Eff Age		
	<b>Valuation Summary</b> Base Cost (16.00 x 360) 5,760		<b>Modifier Total</b>	<b>RCN</b> 5,760	<b>Depr (40% Phys/ % Func)</b> 2,304	<b>RCNLD</b> 3,456