



Rogers

Assessment Property Record Card for Tax Year 2026

Data provided by LISA DELOZIER County Assessor

Date 04/16/2026
Time 21:45:55
Page 1

Assessment Data					Primary Image																																																																																																																				
Account 660022179 Parcel ID 000000-00-0-00834-004-0006 Cadastral ID 26-21-14-05980 Property Type REAL - Real Property Property Class RRP VI Area 4 Tax Area 3 - OWASSO RURAL/NO FIRE Name ID 341613 NIMAL, ANTHONY J & SAMANTHA E 17621 E 80TH ST N OWASSO OK 74055-0000 Parcel Location Situs 17621 E 80TH ST N Subdivision TURTLE CREEK AMENDED Lot/Block 0006 / 0004 Parcel Size 1 - Lots Sec/Twn/Rng 26 / 21 / 14 / 5 Neighborhood 1212 - R-V04-SW OWASSO School District S021 - OWASSO SCHOOLS																																																																																																																									
Legal Description Lat/Long: 36.27260846 -95.77666887																																																																																																																									
Building Permits					<table border="1"> <thead> <tr> <th>Number</th> <th>Description</th> <th>Opened</th> <th>Closed</th> <th>Amount</th> </tr> </thead> <tbody> <tr> <td colspan="5"> </td> </tr> </tbody> </table>					Number	Description	Opened	Closed	Amount																																																																																																											
Number	Description	Opened	Closed	Amount																																																																																																																					
Exemptions					Sale History																																																																																																																				
<table border="1"> <thead> <tr> <th>Code</th> <th>Type</th> <th>Active</th> <th>Maximum</th> <th>Exemption</th> </tr> </thead> <tbody> <tr> <td>H</td> <td>Homestead</td> <td>No</td> <td>1,000</td> <td></td> </tr> </tbody> </table>					Code	Type	Active	Maximum	Exemption	H	Homestead	No	1,000		<table border="1"> <thead> <tr> <th>Bk/Pg</th> <th>Grantor</th> <th>Date</th> <th>Price</th> <th>Code</th> </tr> </thead> <tbody> <tr> <td>/</td> <td>NIMAL, PAUL FRANCIS</td> <td>05/16/2023</td> <td>250,000</td> <td>YES</td> </tr> <tr> <td>2257/511</td> <td>NIMAL, PAUL F &</td> <td>11/30/2011</td> <td>0</td> <td>4</td> </tr> </tbody> </table>					Bk/Pg	Grantor	Date	Price	Code	/	NIMAL, PAUL FRANCIS	05/16/2023	250,000	YES	2257/511	NIMAL, PAUL F &	11/30/2011	0	4																																																																																							
Code	Type	Active	Maximum	Exemption																																																																																																																					
H	Homestead	No	1,000																																																																																																																						
Bk/Pg	Grantor	Date	Price	Code																																																																																																																					
/	NIMAL, PAUL FRANCIS	05/16/2023	250,000	YES																																																																																																																					
2257/511	NIMAL, PAUL F &	11/30/2011	0	4																																																																																																																					
Parcel Valuation																																																																																																																									
<table border="1"> <thead> <tr> <th>Source</th> <th>REAL</th> </tr> </thead> <tbody> <tr> <td>Remove Cap</td> <td>2024</td> </tr> <tr> <td>Year Frozen</td> <td>0</td> </tr> <tr> <td>Uncapped Value</td> <td>0</td> </tr> <tr> <td>TIF Project ID</td> <td>0</td> </tr> </tbody> </table>		Source	REAL	Remove Cap	2024	Year Frozen	0	Uncapped Value	0	TIF Project ID	0	<table border="1"> <thead> <tr> <th>Fair Cash</th> <th>Capped</th> <th>Asmnt Level</th> <th>Assessed</th> </tr> </thead> <tbody> <tr> <td>Land Value</td> <td>71,403</td> <td>71,403</td> <td>7,854</td> </tr> <tr> <td>Improvements</td> <td>174,093</td> <td>174,093</td> <td>19,150</td> </tr> <tr> <td>Mobile Home</td> <td>0</td> <td>0</td> <td>0</td> </tr> <tr> <td>Total Value</td> <td>245,496</td> <td>245,496</td> <td>27,004</td> </tr> </tbody> </table>			Fair Cash	Capped	Asmnt Level	Assessed	Land Value	71,403	71,403	7,854	Improvements	174,093	174,093	19,150	Mobile Home	0	0	0	Total Value	245,496	245,496	27,004	<table border="1"> <thead> <tr> <th>Levy Rate</th> <th>Current Tax</th> </tr> </thead> <tbody> <tr> <td>97.960</td> <td>2,645.31</td> </tr> <tr> <td>Assessed</td> <td>27,004</td> </tr> <tr> <td>Penalty</td> <td>0</td> </tr> <tr> <td>Exemption</td> <td>0</td> </tr> <tr> <td>Total Taxable</td> <td>27,004</td> </tr> </tbody> </table>		Levy Rate	Current Tax	97.960	2,645.31	Assessed	27,004	Penalty	0	Exemption	0	Total Taxable	27,004																																																																									
Source	REAL																																																																																																																								
Remove Cap	2024																																																																																																																								
Year Frozen	0																																																																																																																								
Uncapped Value	0																																																																																																																								
TIF Project ID	0																																																																																																																								
Fair Cash	Capped	Asmnt Level	Assessed																																																																																																																						
Land Value	71,403	71,403	7,854																																																																																																																						
Improvements	174,093	174,093	19,150																																																																																																																						
Mobile Home	0	0	0																																																																																																																						
Total Value	245,496	245,496	27,004																																																																																																																						
Levy Rate	Current Tax																																																																																																																								
97.960	2,645.31																																																																																																																								
Assessed	27,004																																																																																																																								
Penalty	0																																																																																																																								
Exemption	0																																																																																																																								
Total Taxable	27,004																																																																																																																								
Assessment History																																																																																																																									
<table border="1"> <thead> <tr> <th>Tax Year</th> <th>Statement Number</th> <th>Billed Owner</th> <th>Tax Area</th> <th>Total Value</th> <th>Exemptions</th> <th>Taxable Value</th> <th>Billed Tax</th> </tr> </thead> <tbody> <tr><td>2025</td><td>2025-660022179</td><td>NIMAL, ANTHONY J &</td><td>3</td><td>244,468</td><td>0</td><td>26,891</td><td>2,634.00</td></tr> <tr><td>2024</td><td>2024-660022179</td><td>NIMAL, ANTHONY J &</td><td>3</td><td>250,003</td><td>0</td><td>27,500</td><td>2,642.00</td></tr> <tr><td>2023</td><td>2023-660022179</td><td>NIMAL, ANTHONY J &</td><td>3</td><td>208,278</td><td>1000</td><td>19,089</td><td>1,789.00</td></tr> <tr><td>2022</td><td>2022-660022179</td><td>NIMAL, PAUL FRANCIS</td><td>3</td><td>193,634</td><td>1000</td><td>18,504</td><td>1,813.00</td></tr> <tr><td>2021</td><td>2021-660022179</td><td>NIMAL, PAUL FRANCIS</td><td>3</td><td>187,112</td><td>1000</td><td>17,936</td><td>1,735.00</td></tr> <tr><td>2020</td><td>2020-660022179</td><td>NIMAL, PAUL FRANCIS</td><td>3</td><td>184,331</td><td>1000</td><td>17,384</td><td>1,679.00</td></tr> <tr><td>2019</td><td>2019-660022179</td><td>NIMAL, PAUL FRANCIS</td><td>3</td><td>177,770</td><td>1000</td><td>16,849</td><td>1,629.00</td></tr> <tr><td>2018</td><td>2018-660022179</td><td>NIMAL, PAUL FRANCIS</td><td>3</td><td>183,884</td><td>1000</td><td>16,329</td><td>1,520.00</td></tr> <tr><td>2017</td><td>2017-660022179</td><td>NIMAL, PAUL FRANCIS</td><td>3</td><td>182,458</td><td>1000</td><td>15,825</td><td>1,488.00</td></tr> <tr><td>2016</td><td>2016-660022179</td><td>NIMAL, PAUL FRANCIS</td><td>3</td><td>178,101</td><td>1000</td><td>15,335</td><td>1,444.00</td></tr> <tr><td>2015</td><td>2015-660022179</td><td>NIMAL, PAUL FRANCIS</td><td>3</td><td>174,026</td><td>1000</td><td>14,859</td><td>1,409.00</td></tr> <tr><td>2014</td><td>2014-660022179</td><td>NIMAL, PAUL FRANCIS</td><td>3</td><td>176,863</td><td>1000</td><td>14,397</td><td>1,378.00</td></tr> <tr><td>2013</td><td>2013-660022179</td><td>NIMAL, PAUL FRANCIS</td><td>3</td><td>167,374</td><td>1000</td><td>13,949</td><td>1,307.00</td></tr> </tbody> </table>										Tax Year	Statement Number	Billed Owner	Tax Area	Total Value	Exemptions	Taxable Value	Billed Tax	2025	2025-660022179	NIMAL, ANTHONY J &	3	244,468	0	26,891	2,634.00	2024	2024-660022179	NIMAL, ANTHONY J &	3	250,003	0	27,500	2,642.00	2023	2023-660022179	NIMAL, ANTHONY J &	3	208,278	1000	19,089	1,789.00	2022	2022-660022179	NIMAL, PAUL FRANCIS	3	193,634	1000	18,504	1,813.00	2021	2021-660022179	NIMAL, PAUL FRANCIS	3	187,112	1000	17,936	1,735.00	2020	2020-660022179	NIMAL, PAUL FRANCIS	3	184,331	1000	17,384	1,679.00	2019	2019-660022179	NIMAL, PAUL FRANCIS	3	177,770	1000	16,849	1,629.00	2018	2018-660022179	NIMAL, PAUL FRANCIS	3	183,884	1000	16,329	1,520.00	2017	2017-660022179	NIMAL, PAUL FRANCIS	3	182,458	1000	15,825	1,488.00	2016	2016-660022179	NIMAL, PAUL FRANCIS	3	178,101	1000	15,335	1,444.00	2015	2015-660022179	NIMAL, PAUL FRANCIS	3	174,026	1000	14,859	1,409.00	2014	2014-660022179	NIMAL, PAUL FRANCIS	3	176,863	1000	14,397	1,378.00	2013	2013-660022179	NIMAL, PAUL FRANCIS	3	167,374	1000	13,949	1,307.00
Tax Year	Statement Number	Billed Owner	Tax Area	Total Value	Exemptions	Taxable Value	Billed Tax																																																																																																																		
2025	2025-660022179	NIMAL, ANTHONY J &	3	244,468	0	26,891	2,634.00																																																																																																																		
2024	2024-660022179	NIMAL, ANTHONY J &	3	250,003	0	27,500	2,642.00																																																																																																																		
2023	2023-660022179	NIMAL, ANTHONY J &	3	208,278	1000	19,089	1,789.00																																																																																																																		
2022	2022-660022179	NIMAL, PAUL FRANCIS	3	193,634	1000	18,504	1,813.00																																																																																																																		
2021	2021-660022179	NIMAL, PAUL FRANCIS	3	187,112	1000	17,936	1,735.00																																																																																																																		
2020	2020-660022179	NIMAL, PAUL FRANCIS	3	184,331	1000	17,384	1,679.00																																																																																																																		
2019	2019-660022179	NIMAL, PAUL FRANCIS	3	177,770	1000	16,849	1,629.00																																																																																																																		
2018	2018-660022179	NIMAL, PAUL FRANCIS	3	183,884	1000	16,329	1,520.00																																																																																																																		
2017	2017-660022179	NIMAL, PAUL FRANCIS	3	182,458	1000	15,825	1,488.00																																																																																																																		
2016	2016-660022179	NIMAL, PAUL FRANCIS	3	178,101	1000	15,335	1,444.00																																																																																																																		
2015	2015-660022179	NIMAL, PAUL FRANCIS	3	174,026	1000	14,859	1,409.00																																																																																																																		
2014	2014-660022179	NIMAL, PAUL FRANCIS	3	176,863	1000	14,397	1,378.00																																																																																																																		
2013	2013-660022179	NIMAL, PAUL FRANCIS	3	167,374	1000	13,949	1,307.00																																																																																																																		



Rogers

Assessment Property Record Card for Tax Year 2026

Data provided by LISA DELOZIER County Assessor

Date 04/16/2026
Time 21:45:55
Page 2

Lot Data	Square-Foot - NBHD 1212 #1	Primary Image
Lot Size		
Lot Count	1	
Units Buildable	1	
Non-Ag Acres	1.0523	
Topography		
Street Access		
Utilities		
Amenities	LAND QUALITY	
	0	
	0	
Method	Square-Foot	
Base Lot Value	45,839.00 x 2.62 = 120,005	
Factor Value		
Adjustments	0.5950	
Lot Value	71,403	

Residential Data	
Type	1 Single Family Residence
Condition	3 - Average
Quality	3 - Average
Architecture	
Style	100% One Story
Exterior Wall	40% Veneer, Masonry 60% Frame, Siding, Wood
Base/Total Area	1,896 / 1,896
Style	100% One Story
HVAC	100% Warmed & Cooled Air
Roof Cover	1 Composition Shingle
Area on Slab	1,896
Fixture/RghIn	11 /
Bed/F/H Bath	3 / 2.0 /
Basement Area	
Garage Type	460 Attached Garage - Unfinished
Remodel	
Year/Eff Age	1989 / 28



\\tsclient\TCASEY\CASEY BOOTH RESIDENTIAL VI\2022-8-8\IM 8/8/2022

GRM Approach	
GRM Code	
Gross Rent	0.00
Indicated Value	

Multiple Regression			
MRA Code	1	Test	
Adusted R	0.8445		
Indicated Value	216,424	114.15	Per SqFt

Direct Comparables	
Selection Model	A Adam Test
Adjustment Model	1 2022 Residential
Comparables	5
Indicated Value	298,570 Per SqFt

Cost Approach				Manual : 01/2025			
Base Cost	103.74	Total Misc Impr	+	11,961			
Roofing Adj	+ 4.75	Garage Cost	+	14,968			
Subfloor Adj	+ -2.25	Total RCN	=	267,835			
Heat/Cool Adj	+ 12.64	Depreciation (35%)	-	93,742			
Plumbing Adj	+ 8.18	Lump Sums	+	0			
Basement Adj	+ 0.00	RCNLD	=	174,093			
Adj Base Cost	= 127.06	Lot Value	+	71,403			
Total Area	x 1,896	Indicated Value	=	245,496			
Adjusted Cost	= 240,906	Value Per SqFt		129.48			

Value Reconciliation			
Selected Approach	Cost Approach		
Improvements	174,093		
Lot Value	71,403		
Indicated Value	245,496	129.48	Per SqFt
Agland Value			
Site Improvements			
Total Value	245,496	129.48	Total Value Per SqFt

Miscellaneous Improvements								
Code	Description	Sketch ID	Size	Year	Units	Unit Cost	Depr	Value
FPR1	FIREPLACE - RESIDENTIAL 1 STORY	0		1	1	5,615.40		5,615
PATO	SLAB PORCH - OPEN	54283	10x10		100	11.48		1,148
PATO	SLAB PORCH - OPEN	54284	12x12		144	11.07		1,594
PRCH	SLAB PORCH - COVERED	54285	136		136	26.50		3,604



Rogers

Assessment Property Record Card for Tax Year 2026

Data provided by LISA DELOZIER County Assessor

Date 04/16/2026
 Time 21:45:55
 Page 3

Sketch Image

660022179

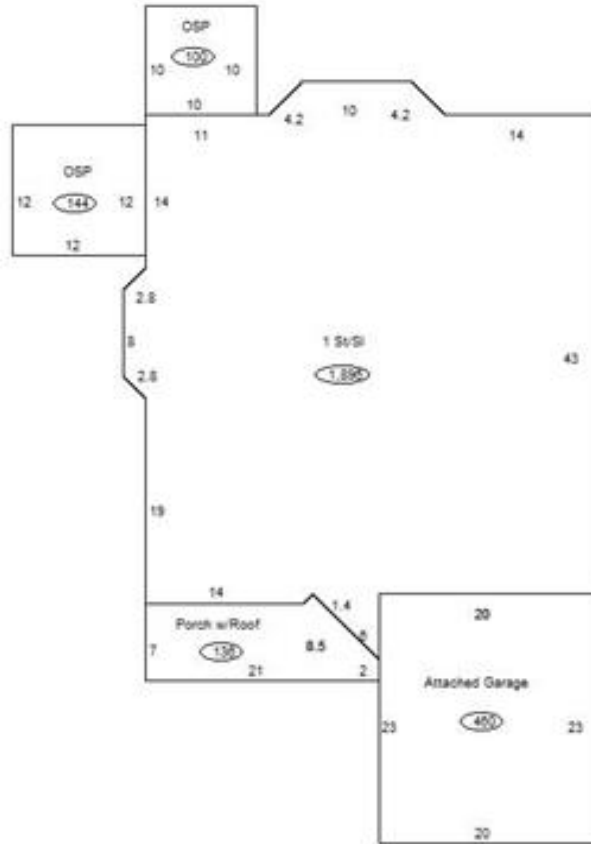

Sketch Vector Information

Sequence	Code	Type	Built Over	Scale	Section Label	Base Area	Multiplier	Total Area
1	R	1	Slab	13	1 St/Sl	1,896	1.000	1,896
2	G	1		13	Attached Garage	460	1.000	460
3	M	PATO		13	Open Slab	100	1.000	100
4	M	PATO		13	Open Slab	144	1.000	144
5	M	PRCH		13	SLBC	136	1.000	136
Total Building Area						1,896		1,896



Rogers

Assessment Property Record Card for Tax Year 2026

Data provided by LISA DELOZIER County Assessor

Date 04/16/2026
Time 21:45:55
Page 4

660022179

Outbuildings/Site Improvements

Building Image	Code	Description	Dimensions	Floor	Roofing	Total Units
	STF	STG FAIR	8x10x0			80
	Qual	2	Cond 3	Year	Eff Age 1520	
Valuation Summary		Modifier Total	RCN	Depr (100% Phys/ % Func)		RCNLD
Base Cost (4.68 x 80)		374		374		374