



# Rogers

## Assessment Property Record Card for Tax Year 2026

Data provided by LISA DELOZIER County Assessor

Date 04/17/2026  
 Time 01:43:53  
 Page 1

Assessment Data					Primary Image																																																																																																																				
<b>Account</b> 660022186 <b>Parcel ID</b> 000000-00-0-00834-004-0013 <b>Cadastral ID</b> 26-21-14-06050 <b>Property Type</b> REAL - Real Property <b>Property Class</b> RRP VI Area 4 <b>Tax Area</b> 3 - OWASSO RURAL/NO FIRE <b>Name ID</b> 283312 YOUNG, JULIE L & TERRENCE P BYRNE  17510 E 84TH ST N OWASSO OK 74055-0000  <b>Parcel Location</b> <b>Situs</b> 17510 E 84TH ST <b>Subdivision</b> TURTLE CREEK AMENDED <b>Lot/Block</b> 0013 / 0004 <b>Parcel Size</b> 1 - Lots <b>Sec/Twn/Rng</b> 26 / 21 / 14 / 5 <b>Neighborhood</b> 1212 - R-V04-SW OWASSO <b>School District</b> S021 - OWASSO SCHOOLS																																																																																																																									
<b>Legal Description</b> Lat/Long: 36.27469113 -95.77808577																																																																																																																									
<b>Building Permits</b>					<table border="1"> <thead> <tr> <th>Number</th> <th>Description</th> <th>Opened</th> <th>Closed</th> <th>Amount</th> </tr> </thead> <tbody> <tr> <td>R25 043</td> <td>NEW DTCH ACC BLDG 24X30</td> <td>02/2025</td> <td>06/2025</td> <td>90,000</td> </tr> </tbody> </table>					Number	Description	Opened	Closed	Amount	R25 043	NEW DTCH ACC BLDG 24X30	02/2025	06/2025	90,000																																																																																																						
Number	Description	Opened	Closed	Amount																																																																																																																					
R25 043	NEW DTCH ACC BLDG 24X30	02/2025	06/2025	90,000																																																																																																																					
<b>Exemptions</b>					<b>Sale History</b>																																																																																																																				
<table border="1"> <thead> <tr> <th>Code</th> <th>Type</th> <th>Active</th> <th>Maximum</th> <th>Exemption</th> </tr> </thead> <tbody> <tr> <td></td> <td></td> <td></td> <td></td> <td></td> </tr> </tbody> </table>					Code	Type	Active	Maximum	Exemption						<table border="1"> <thead> <tr> <th>Bk/Pg</th> <th>Grantor</th> <th>Date</th> <th>Price</th> <th>Code</th> </tr> </thead> <tbody> <tr> <td>2577/779</td> <td>BYRNE, TERRENCE</td> <td>01/08/2016</td> <td>0</td> <td>4</td> </tr> <tr> <td>1509/829</td> <td>ROBERTSON, MARK W &amp; LAURIE-E</td> <td>07/31/2003</td> <td>285,000</td> <td>YES</td> </tr> <tr> <td>1047/608</td> <td>PARAGON/LUCRE CORP</td> <td>11/21/1996</td> <td>198,500</td> <td>No</td> </tr> <tr> <td>1047/607</td> <td>TRECO SALES INC</td> <td>11/08/1996</td> <td>0</td> <td>No</td> </tr> </tbody> </table>					Bk/Pg	Grantor	Date	Price	Code	2577/779	BYRNE, TERRENCE	01/08/2016	0	4	1509/829	ROBERTSON, MARK W & LAURIE-E	07/31/2003	285,000	YES	1047/608	PARAGON/LUCRE CORP	11/21/1996	198,500	No	1047/607	TRECO SALES INC	11/08/1996	0	No																																																																													
Code	Type	Active	Maximum	Exemption																																																																																																																					
Bk/Pg	Grantor	Date	Price	Code																																																																																																																					
2577/779	BYRNE, TERRENCE	01/08/2016	0	4																																																																																																																					
1509/829	ROBERTSON, MARK W & LAURIE-E	07/31/2003	285,000	YES																																																																																																																					
1047/608	PARAGON/LUCRE CORP	11/21/1996	198,500	No																																																																																																																					
1047/607	TRECO SALES INC	11/08/1996	0	No																																																																																																																					
<b>Parcel Valuation</b>																																																																																																																									
<table border="1"> <thead> <tr> <th>Source</th> <th>REAL</th> </tr> </thead> <tbody> <tr> <td>Remove Cap</td> <td>2004</td> </tr> <tr> <td>Year Frozen</td> <td>0</td> </tr> <tr> <td>Uncapped Value</td> <td>36,634</td> </tr> <tr> <td>TIF Project ID</td> <td>0</td> </tr> </tbody> </table>		Source	REAL	Remove Cap	2004	Year Frozen	0	Uncapped Value	36,634	TIF Project ID	0	<table border="1"> <thead> <tr> <th>Fair Cash</th> <th>Capped</th> <th>Asmnt Level</th> <th>Assessed</th> </tr> </thead> <tbody> <tr> <td>Land Value</td> <td>120,691</td> <td>66,527</td> <td>7,318</td> </tr> <tr> <td>Improvements</td> <td>457,653</td> <td>439,066</td> <td>48,297</td> </tr> <tr> <td>Mobile Home</td> <td>0</td> <td>0</td> <td>0</td> </tr> <tr> <td>Total Value</td> <td>578,344</td> <td>505,593</td> <td>55,615</td> </tr> </tbody> </table>			Fair Cash	Capped	Asmnt Level	Assessed	Land Value	120,691	66,527	7,318	Improvements	457,653	439,066	48,297	Mobile Home	0	0	0	Total Value	578,344	505,593	55,615	<table border="1"> <thead> <tr> <th>Levy Rate</th> <th>Current Tax</th> </tr> </thead> <tbody> <tr> <td>97.960</td> <td>5,448.05</td> </tr> <tr> <td>Assessed</td> <td>55,615</td> </tr> <tr> <td>Penalty</td> <td>0</td> </tr> <tr> <td>Exemption</td> <td>0</td> </tr> <tr> <td>Total Taxable</td> <td>55,615</td> </tr> </tbody> </table>		Levy Rate	Current Tax	97.960	5,448.05	Assessed	55,615	Penalty	0	Exemption	0	Total Taxable	55,615																																																																									
Source	REAL																																																																																																																								
Remove Cap	2004																																																																																																																								
Year Frozen	0																																																																																																																								
Uncapped Value	36,634																																																																																																																								
TIF Project ID	0																																																																																																																								
Fair Cash	Capped	Asmnt Level	Assessed																																																																																																																						
Land Value	120,691	66,527	7,318																																																																																																																						
Improvements	457,653	439,066	48,297																																																																																																																						
Mobile Home	0	0	0																																																																																																																						
Total Value	578,344	505,593	55,615																																																																																																																						
Levy Rate	Current Tax																																																																																																																								
97.960	5,448.05																																																																																																																								
Assessed	55,615																																																																																																																								
Penalty	0																																																																																																																								
Exemption	0																																																																																																																								
Total Taxable	55,615																																																																																																																								
<b>Assessment History</b>																																																																																																																									
<table border="1"> <thead> <tr> <th>Tax Year</th> <th>Statement Number</th> <th>Billed Owner</th> <th>Tax Area</th> <th>Total Value</th> <th>Exemptions</th> <th>Taxable Value</th> <th>Billed Tax</th> </tr> </thead> <tbody> <tr><td>2025</td><td>2025-660022186</td><td>YOUNG, JULIE L &amp;</td><td>3</td><td>537,441</td><td>0</td><td>49,128</td><td>4,813.00</td></tr> <tr><td>2024</td><td>2024-660022186</td><td>YOUNG, JULIE L &amp;</td><td>3</td><td>536,832</td><td>0</td><td>46,790</td><td>4,495.00</td></tr> <tr><td>2023</td><td>2023-660022186</td><td>YOUNG, JULIE L &amp;</td><td>3</td><td>431,753</td><td>0</td><td>44,561</td><td>4,176.00</td></tr> <tr><td>2022</td><td>2022-660022186</td><td>YOUNG, JULIE L &amp;</td><td>3</td><td>408,002</td><td>0</td><td>42,440</td><td>4,158.00</td></tr> <tr><td>2021</td><td>2021-660022186</td><td>YOUNG, JULIE L &amp;</td><td>3</td><td>367,444</td><td>0</td><td>40,419</td><td>3,910.00</td></tr> <tr><td>2020</td><td>2020-660022186</td><td>YOUNG, JULIE L &amp;</td><td>3</td><td>364,780</td><td>0</td><td>39,963</td><td>3,860.00</td></tr> <tr><td>2019</td><td>2019-660022186</td><td>YOUNG, JULIE L &amp;</td><td>3</td><td>346,000</td><td>0</td><td>38,060</td><td>3,679.00</td></tr> <tr><td>2018</td><td>2018-660022186</td><td>YOUNG, JULIE L &amp;</td><td>3</td><td>356,842</td><td>0</td><td>39,253</td><td>3,654.00</td></tr> <tr><td>2017</td><td>2017-660022186</td><td>YOUNG, JULIE L &amp;</td><td>3</td><td>353,577</td><td>0</td><td>38,893</td><td>3,658.00</td></tr> <tr><td>2016</td><td>2016-660022186</td><td>YOUNG, JULIE L &amp;</td><td>3</td><td>344,397</td><td>0</td><td>37,884</td><td>3,567.00</td></tr> <tr><td>2015</td><td>2015-660022186</td><td>BYRNE, TERRENCE</td><td>3</td><td>333,410</td><td>0</td><td>36,675</td><td>3,478.00</td></tr> <tr><td>2014</td><td>2014-660022186</td><td>BYRNE, TERRENCE</td><td>3</td><td>342,728</td><td>0</td><td>36,547</td><td>3,498.00</td></tr> <tr><td>2013</td><td>2013-660022186</td><td>BYRNE, TERRENCE</td><td>3</td><td>322,644</td><td>0</td><td>34,806</td><td>3,261.00</td></tr> </tbody> </table>										Tax Year	Statement Number	Billed Owner	Tax Area	Total Value	Exemptions	Taxable Value	Billed Tax	2025	2025-660022186	YOUNG, JULIE L &	3	537,441	0	49,128	4,813.00	2024	2024-660022186	YOUNG, JULIE L &	3	536,832	0	46,790	4,495.00	2023	2023-660022186	YOUNG, JULIE L &	3	431,753	0	44,561	4,176.00	2022	2022-660022186	YOUNG, JULIE L &	3	408,002	0	42,440	4,158.00	2021	2021-660022186	YOUNG, JULIE L &	3	367,444	0	40,419	3,910.00	2020	2020-660022186	YOUNG, JULIE L &	3	364,780	0	39,963	3,860.00	2019	2019-660022186	YOUNG, JULIE L &	3	346,000	0	38,060	3,679.00	2018	2018-660022186	YOUNG, JULIE L &	3	356,842	0	39,253	3,654.00	2017	2017-660022186	YOUNG, JULIE L &	3	353,577	0	38,893	3,658.00	2016	2016-660022186	YOUNG, JULIE L &	3	344,397	0	37,884	3,567.00	2015	2015-660022186	BYRNE, TERRENCE	3	333,410	0	36,675	3,478.00	2014	2014-660022186	BYRNE, TERRENCE	3	342,728	0	36,547	3,498.00	2013	2013-660022186	BYRNE, TERRENCE	3	322,644	0	34,806	3,261.00
Tax Year	Statement Number	Billed Owner	Tax Area	Total Value	Exemptions	Taxable Value	Billed Tax																																																																																																																		
2025	2025-660022186	YOUNG, JULIE L &	3	537,441	0	49,128	4,813.00																																																																																																																		
2024	2024-660022186	YOUNG, JULIE L &	3	536,832	0	46,790	4,495.00																																																																																																																		
2023	2023-660022186	YOUNG, JULIE L &	3	431,753	0	44,561	4,176.00																																																																																																																		
2022	2022-660022186	YOUNG, JULIE L &	3	408,002	0	42,440	4,158.00																																																																																																																		
2021	2021-660022186	YOUNG, JULIE L &	3	367,444	0	40,419	3,910.00																																																																																																																		
2020	2020-660022186	YOUNG, JULIE L &	3	364,780	0	39,963	3,860.00																																																																																																																		
2019	2019-660022186	YOUNG, JULIE L &	3	346,000	0	38,060	3,679.00																																																																																																																		
2018	2018-660022186	YOUNG, JULIE L &	3	356,842	0	39,253	3,654.00																																																																																																																		
2017	2017-660022186	YOUNG, JULIE L &	3	353,577	0	38,893	3,658.00																																																																																																																		
2016	2016-660022186	YOUNG, JULIE L &	3	344,397	0	37,884	3,567.00																																																																																																																		
2015	2015-660022186	BYRNE, TERRENCE	3	333,410	0	36,675	3,478.00																																																																																																																		
2014	2014-660022186	BYRNE, TERRENCE	3	342,728	0	36,547	3,498.00																																																																																																																		
2013	2013-660022186	BYRNE, TERRENCE	3	322,644	0	34,806	3,261.00																																																																																																																		



# Rogers

## Assessment Property Record Card for Tax Year 2026

Data provided by LISA DELOZIER County Assessor

Date 04/17/2026  
Time 01:43:53  
Page 2

Lot Data	Square-Foot - NBHD 1212 #1	Primary Image
<b>Lot Size</b> <b>Lot Count</b> 1 <b>Units Buildable</b> 1 <b>Non-Ag Acres</b> 1.0673 <b>Topography</b> <b>Street Access</b> <b>Utilities</b> <b>Amenities</b> LAND QUALITY 0 0 <b>Method</b> Square-Foot <b>Base Lot Value</b> 46,492.00 x 2.60 = 120,691 <b>Factor Value</b> <b>Adjustments</b> 1.0000 <b>Lot Value</b> 120,691		

Residential Data	
<b>Type</b>	1 Single Family Residence
<b>Condition</b>	3 - Average
<b>Quality</b>	4.5 - Good
<b>Architecture</b>	
<b>Style</b>	100% 1 1/2 Story Finished
<b>Exterior Wall</b>	100% Veneer, Masonry
<b>Base/Total Area</b>	3,175 / 3,839
<b>Style</b>	100% 1 1/2 Story Finished
<b>HVAC</b>	100% Warmed & Cooled Air
<b>Roof Cover</b>	1 Composition Shingle
<b>Area on Slab</b>	3,175
<b>Fixture/RghIn</b>	14 /
<b>Bed/F/H Bath</b>	4 / 3.0 /
<b>Basement Area</b>	
<b>Garage Type</b>	713 Attached Garage - Unfinished
<b>Remodel</b>	
<b>Year/Eff Age</b>	1996 / 23



\\tsclient\TCASEY\CASEY BOOTH RESIDENTIAL VI\2022-8-8\IM 8/8/2022

GRM Approach	
<b>GRM Code</b>	
<b>Gross Rent</b>	0.00
<b>Indicated Value</b>	

Multiple Regression			
<b>MRA Code</b>	1	Test	
<b>Adjusted R</b>	0.8445		
<b>Indicated Value</b>	581,556	151.49	Per SqFt

Direct Comparables	
<b>Selection Model</b>	A Adam Test
<b>Adjustment Model</b>	1 2022 Residential
<b>Comparables</b>	
<b>Indicated Value</b>	

Cost Approach				Manual : 01/2025			
<b>Base Cost</b>	105.06	<b>Total Misc Impr</b>	+	28,929			
<b>Roofing Adj</b>	+ 4.94	<b>Garage Cost</b>	+	34,581			
<b>Subfloor Adj</b>	+ -3.58	<b>Total RCN</b>	=	565,651			
<b>Heat/Cool Adj</b>	+ 17.38	<b>Depreciation ( 28%)</b>	-	158,382			
<b>Plumbing Adj</b>	+ 7.00	<b>Lump Sums</b>	+	0			
<b>Basement Adj</b>	+ 0.00	<b>RCNLD</b>	=	407,269			
<b>Adj Base Cost</b>	= 130.80	<b>Lot Value</b>	+	120,691			
<b>Total Area</b>	x 3,839	<b>Indicated Value</b>	=	527,960			
<b>Adjusted Cost</b>	= 502,141	<b>Value Per SqFt</b>		137.53			

Value Reconciliation			
<b>Selected Approach</b>	Cost Approach		
<b>Improvements</b>	407,269		
<b>Lot Value</b>	120,691		
<b>Indicated Value</b>	527,960	137.53	Per SqFt
<b>Agland Value</b>			
<b>Site Improvements</b>	50,384		
<b>Total Value</b>	578,344	150.65	Total Value Per SqFt

Miscellaneous Improvements								
Code	Description	Sketch ID	Size	Year	Units	Unit Cost	Depr	Value
FPR1	FIREPLACE - RESIDENTIAL 1 STORY	0		1	1	7,721.18		7,721
PRCH	SLAB PORCH - COVERED	54312	10x4		40	36.54		1,462
PRCH	SLAB PORCH - COVERED	54313	20x10		200	35.67		7,134
PATO	SLAB PORCH - OPEN	54314	219		219	13.56		2,970
PRCH	SLAB PORCH - COVERED	54315	273		273	35.32		9,642



# Rogers

## Assessment Property Record Card for Tax Year 2026

Data provided by LISA DELOZIER County Assessor

Date 04/17/2026

Time 01:43:53

Page 3

### Sketch Image

660022186

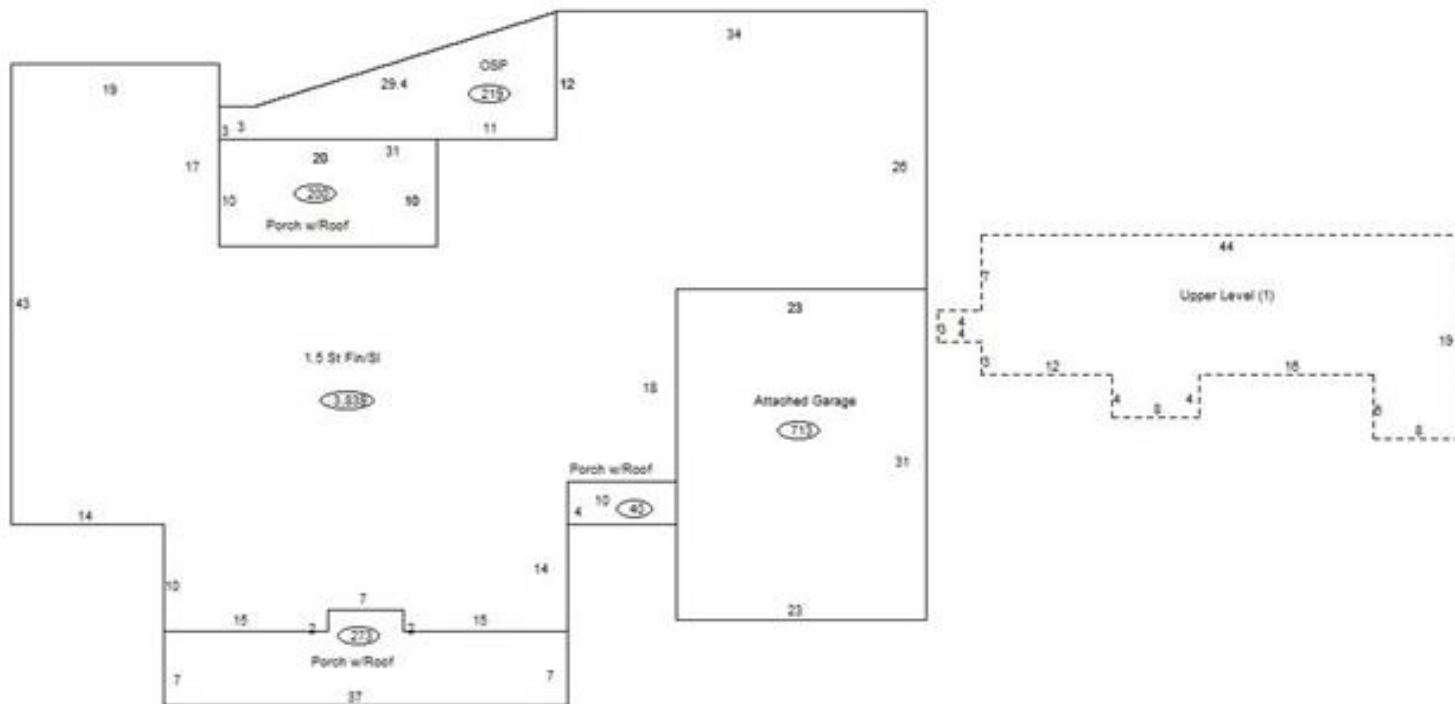

### Sketch Vector Information

Sequence	Code	Type	Built Over	Scale	Section Label	Base Area	Multiplier	Total Area
1	R	5	Slab	13	1.5 St Fin/Sl	3,175	1.209	3,839
2	G	1		13	Attached Garage	713	1.000	713
3	M	PRCH		13	SLBC	40	1.000	40
4	M	PRCH		13	SLBC	200	1.000	200
5	M	PATO		13	Open Slab	219	1.000	219
6	M	PRCH		13	SLBC	273	1.000	273
7	U	^UL		13	Upper Level (1)	664	1.000	664
<b>Total Building Area</b>						<b>3,175</b>		<b>3,839</b>



# Rogers



## Assessment Property Record Card for Tax Year 2026

Data provided by LISA DELOZIER County Assessor

Date 04/17/2026  
Time 01:43:54  
Page 4

660022186

### Outbuildings/Site Improvements

Building Image	Code	Description	Dimensions	Floor	Roofing	Total Units		
	GRDT	Garage - Detached	24x30x18	Concrete	Composition Shingle	720		
	Qual	5	Cond	3	Year	2025	Eff Age	1
	Storage Finish		Area	300			5,808	
	<b>Valuation Summary</b>		<b>Modifier Total</b>		<b>RCN</b>	<b>Depr (1% Phys/ % Func)</b>	<b>RCNLD</b>	
Base Cost (42.96 x 720)		30,931	5,808	36,739	367	36,372		
	PATO	Patio - Open	4x6x0	Concrete		24		
	Qual	3	Cond	3	Year	2025	Eff Age	1
	<b>Valuation Summary</b>		<b>Modifier Total</b>		<b>RCN</b>	<b>Depr (5% Phys/ % Func)</b>	<b>RCNLD</b>	
	Base Cost (11.48 x 24)		276		276	14	262	
	SV	SWIM VINYL	0x0x0			1		
	Qual	3	Cond	3	Year		Eff Age	
	<b>Valuation Summary</b>		<b>Modifier Total</b>		<b>RCN</b>	<b>Depr (45% Phys/ % Func)</b>	<b>RCNLD</b>	
	Base Cost (25,000.00 x 1)		25,000		25,000	11,250	13,750	