



Rogers

Assessment Property Record Card for Tax Year 2026

Data provided by LISA DELOZIER County Assessor

Date 04/17/2026
Time 06:20:53
Page 1

Assessment Data					Primary Image																																																																																																																				
Account 660022401 Parcel ID 23N15E-26-4-00000-000-0000 Cadastral ID 26-23-15-01500 Property Type REAL - Real Property Property Class RR VI Area 2 Tax Area 10 - OOLOGAH RURAL/NW FIRE Name ID 325306 SELF, MICHAEL L & ELIZABETH A-TRUSTEES 15212 E 440 RD CLAREMORE OK 74017-0000 Parcel Location Situs 11541 S 4120 RD Subdivision Lot/Block / Parcel Size 1.63 - Acres Sec/Twn/Rng 26 / 23 / 15 / 4 Neighborhood 4020 - OOLOGAH School District S004 - OOLOGAH SCHOOLS					<p>C:\Users\RLN\Pictures\2016-12-20 12-20-16\12-20-16 001.JPG 12/20/2016</p>																																																																																																																				
Legal Description Lat/Long: 36.44294201 -95.67125570 TR IN W2 NE SE, BEG: ON E/L W2 NE SE 3227.33' S OF N/L SEC 26; S 400.69', N 53-17 W 301.18'; N 236.35', E 250' TO POB																																																																																																																									
Exemptions <table border="1"> <thead> <tr> <th>Code</th> <th>Type</th> <th>Active</th> <th>Maximum</th> <th>Exemption</th> </tr> </thead> <tbody> <tr> <td>H</td> <td>Homestead</td> <td>No</td> <td>1,000</td> <td></td> </tr> </tbody> </table>					Code	Type	Active	Maximum	Exemption	H	Homestead	No	1,000		Building Permits <table border="1"> <thead> <tr> <th>Number</th> <th>Description</th> <th>Opened</th> <th>Closed</th> <th>Amount</th> </tr> </thead> <tbody> <tr> <td></td> <td></td> <td></td> <td></td> <td></td> </tr> </tbody> </table>					Number	Description	Opened	Closed	Amount																																																																																																	
Code	Type	Active	Maximum	Exemption																																																																																																																					
H	Homestead	No	1,000																																																																																																																						
Number	Description	Opened	Closed	Amount																																																																																																																					
Parcel Valuation <table border="1"> <thead> <tr> <th>Source</th> <th>REAL</th> <th>Fair Cash</th> <th>Capped</th> <th>Asmnt Level</th> <th>Assessed</th> <th>Levy Rate</th> <th>108.182</th> <th>Current Tax</th> </tr> </thead> <tbody> <tr> <td>Remove Cap</td> <td>2020</td> <td>Land Value 51,784</td> <td>51,784</td> <td>11%</td> <td>5,696</td> <td>Assessed</td> <td>52,743</td> <td>5,705.82</td> </tr> <tr> <td>Year Frozen</td> <td>2011</td> <td>Improvements 450,793</td> <td>427,695</td> <td></td> <td>47,047</td> <td>Penalty</td> <td>0</td> <td></td> </tr> <tr> <td>Uncapped Value</td> <td>0</td> <td>Mobile Home 0</td> <td>0</td> <td></td> <td>0</td> <td>Exemption</td> <td>0</td> <td>0.00</td> </tr> <tr> <td>TIF Project ID</td> <td>0</td> <td>Total Value 502,577</td> <td>479,479</td> <td></td> <td>52,743</td> <td>Total Taxable</td> <td>52,743</td> <td>5,706.00</td> </tr> </tbody> </table>					Source	REAL	Fair Cash	Capped	Asmnt Level	Assessed	Levy Rate	108.182	Current Tax	Remove Cap	2020	Land Value 51,784	51,784	11%	5,696	Assessed	52,743	5,705.82	Year Frozen	2011	Improvements 450,793	427,695		47,047	Penalty	0		Uncapped Value	0	Mobile Home 0	0		0	Exemption	0	0.00	TIF Project ID	0	Total Value 502,577	479,479		52,743	Total Taxable	52,743	5,706.00	Sale History <table border="1"> <thead> <tr> <th>Bk/Pg</th> <th>Grantor</th> <th>Date</th> <th>Price</th> <th>Code</th> </tr> </thead> <tbody> <tr> <td>/</td> <td>SELF, MICHAEL & ELIZABETH</td> <td>07/17/2019</td> <td>0</td> <td>WB</td> </tr> <tr> <td>/</td> <td>BETHUNE, KAREN V</td> <td>06/03/2019</td> <td>495,000</td> <td>WG</td> </tr> <tr> <td>1010/394</td> <td>GREGORY, LAWRENCE</td> <td>12/01/1995</td> <td>270,000</td> <td>Yes</td> </tr> </tbody> </table>					Bk/Pg	Grantor	Date	Price	Code	/	SELF, MICHAEL & ELIZABETH	07/17/2019	0	WB	/	BETHUNE, KAREN V	06/03/2019	495,000	WG	1010/394	GREGORY, LAWRENCE	12/01/1995	270,000	Yes																																															
Source	REAL	Fair Cash	Capped	Asmnt Level	Assessed	Levy Rate	108.182	Current Tax																																																																																																																	
Remove Cap	2020	Land Value 51,784	51,784	11%	5,696	Assessed	52,743	5,705.82																																																																																																																	
Year Frozen	2011	Improvements 450,793	427,695		47,047	Penalty	0																																																																																																																		
Uncapped Value	0	Mobile Home 0	0		0	Exemption	0	0.00																																																																																																																	
TIF Project ID	0	Total Value 502,577	479,479		52,743	Total Taxable	52,743	5,706.00																																																																																																																	
Bk/Pg	Grantor	Date	Price	Code																																																																																																																					
/	SELF, MICHAEL & ELIZABETH	07/17/2019	0	WB																																																																																																																					
/	BETHUNE, KAREN V	06/03/2019	495,000	WG																																																																																																																					
1010/394	GREGORY, LAWRENCE	12/01/1995	270,000	Yes																																																																																																																					
Assessment History <table border="1"> <thead> <tr> <th>Tax Year</th> <th>Statement Number</th> <th>Billed Owner</th> <th>Tax Area</th> <th>Total Value</th> <th>Exemptions</th> <th>Taxable Value</th> <th>Billed Tax</th> </tr> </thead> <tbody> <tr><td>2025</td><td>2025-660022401</td><td>SELF, MICHAEL L &</td><td>10</td><td>456,647</td><td>0</td><td>50,231</td><td>5,434.00</td></tr> <tr><td>2024</td><td>2024-660022401</td><td>SELF, MICHAEL L &</td><td>10</td><td>479,815</td><td>0</td><td>52,780</td><td>5,528.00</td></tr> <tr><td>2023</td><td>2023-660022401</td><td>SELF, MICHAEL L &</td><td>10</td><td>489,888</td><td>0</td><td>53,888</td><td>5,604.00</td></tr> <tr><td>2022</td><td>2022-660022401</td><td>SELF, MICHAEL L &</td><td>10</td><td>487,879</td><td>0</td><td>52,908</td><td>5,477.00</td></tr> <tr><td>2021</td><td>2021-660022401</td><td>SELF, MICHAEL L &</td><td>10</td><td>458,079</td><td>0</td><td>50,389</td><td>5,253.00</td></tr> <tr><td>2020</td><td>2020-660022401</td><td>SELF, MICHAEL L &</td><td>10</td><td>487,365</td><td>0</td><td>53,610</td><td>5,671.00</td></tr> <tr><td>2019</td><td>2019-660022401</td><td>SELF, MICHAEL L &</td><td>10</td><td>370,563</td><td>1000</td><td>28,206</td><td>2,941.00</td></tr> <tr><td>2018</td><td>2018-660022401</td><td>BETHUNE, KAREN V</td><td>10</td><td>382,484</td><td>1000</td><td>28,206</td><td>3,043.00</td></tr> <tr><td>2017</td><td>2017-660022401</td><td>BETHUNE, KAREN V</td><td>10</td><td>375,201</td><td>1000</td><td>28,205</td><td>3,220.00</td></tr> <tr><td>2016</td><td>2016-660022401</td><td>BETHUNE, KAREN V</td><td>10</td><td>327,827</td><td>1000</td><td>28,206</td><td>2,934.00</td></tr> <tr><td>2015</td><td>2015-660022401</td><td>BETHUNE, KAREN V</td><td>10</td><td>316,638</td><td>1000</td><td>28,205</td><td>2,776.00</td></tr> <tr><td>2014</td><td>2014-660022401</td><td>BETHUNE, KAREN V</td><td>10</td><td>327,266</td><td>1000</td><td>28,205</td><td>2,772.00</td></tr> <tr><td>2013</td><td>2013-660022401</td><td>BETHUNE, KAREN V</td><td>10</td><td>306,512</td><td>1000</td><td>28,206</td><td>2,681.00</td></tr> </tbody> </table>										Tax Year	Statement Number	Billed Owner	Tax Area	Total Value	Exemptions	Taxable Value	Billed Tax	2025	2025-660022401	SELF, MICHAEL L &	10	456,647	0	50,231	5,434.00	2024	2024-660022401	SELF, MICHAEL L &	10	479,815	0	52,780	5,528.00	2023	2023-660022401	SELF, MICHAEL L &	10	489,888	0	53,888	5,604.00	2022	2022-660022401	SELF, MICHAEL L &	10	487,879	0	52,908	5,477.00	2021	2021-660022401	SELF, MICHAEL L &	10	458,079	0	50,389	5,253.00	2020	2020-660022401	SELF, MICHAEL L &	10	487,365	0	53,610	5,671.00	2019	2019-660022401	SELF, MICHAEL L &	10	370,563	1000	28,206	2,941.00	2018	2018-660022401	BETHUNE, KAREN V	10	382,484	1000	28,206	3,043.00	2017	2017-660022401	BETHUNE, KAREN V	10	375,201	1000	28,205	3,220.00	2016	2016-660022401	BETHUNE, KAREN V	10	327,827	1000	28,206	2,934.00	2015	2015-660022401	BETHUNE, KAREN V	10	316,638	1000	28,205	2,776.00	2014	2014-660022401	BETHUNE, KAREN V	10	327,266	1000	28,205	2,772.00	2013	2013-660022401	BETHUNE, KAREN V	10	306,512	1000	28,206	2,681.00
Tax Year	Statement Number	Billed Owner	Tax Area	Total Value	Exemptions	Taxable Value	Billed Tax																																																																																																																		
2025	2025-660022401	SELF, MICHAEL L &	10	456,647	0	50,231	5,434.00																																																																																																																		
2024	2024-660022401	SELF, MICHAEL L &	10	479,815	0	52,780	5,528.00																																																																																																																		
2023	2023-660022401	SELF, MICHAEL L &	10	489,888	0	53,888	5,604.00																																																																																																																		
2022	2022-660022401	SELF, MICHAEL L &	10	487,879	0	52,908	5,477.00																																																																																																																		
2021	2021-660022401	SELF, MICHAEL L &	10	458,079	0	50,389	5,253.00																																																																																																																		
2020	2020-660022401	SELF, MICHAEL L &	10	487,365	0	53,610	5,671.00																																																																																																																		
2019	2019-660022401	SELF, MICHAEL L &	10	370,563	1000	28,206	2,941.00																																																																																																																		
2018	2018-660022401	BETHUNE, KAREN V	10	382,484	1000	28,206	3,043.00																																																																																																																		
2017	2017-660022401	BETHUNE, KAREN V	10	375,201	1000	28,205	3,220.00																																																																																																																		
2016	2016-660022401	BETHUNE, KAREN V	10	327,827	1000	28,206	2,934.00																																																																																																																		
2015	2015-660022401	BETHUNE, KAREN V	10	316,638	1000	28,205	2,776.00																																																																																																																		
2014	2014-660022401	BETHUNE, KAREN V	10	327,266	1000	28,205	2,772.00																																																																																																																		
2013	2013-660022401	BETHUNE, KAREN V	10	306,512	1000	28,206	2,681.00																																																																																																																		



Rogers

Assessment Property Record Card for Tax Year 2026

Data provided by LISA DELOZIER County Assessor

Date 04/17/2026
 Time 06:20:53
 Page 2

Lot Data		Square-Foot - NBHD 4020 #1	
Lot Size			
Lot Count			
Units Buildable	1		
Non-Ag Acres	1.7647		
Topography			
Street Access			
Utilities			
Amenities	LAND QUALITY	0	0
Method	Square-Foot		
Base Lot Value	76,869.00 x .67 = 51,784		
Factor Value			
Adjustments	1.0000		
Lot Value	51,784		



C:\Users\RLN\Pictures\2016-12-20 12-20-16\12-20-16 001.JPG 12/20/2016

Residential Data	
Type	1 Single Family Residence
Condition	3 - Average
Quality	4.5 - Good
Architecture	
Style	100% One Story
Exterior Wall	100% Veneer, Masonry
Base/Total Area	3,323 / 3,323
Style	100% One Story
HVAC	100% Warmed & Cooled Air
Roof Cover	1 Composition Shingle
Area on Slab	0
Fixture/RghIn	16 /
Bed/F/H Bath	3 / 2.0 /
Basement Area	6,465 Total
Garage Type	950 Attached Garage - Unfinished
Remodel	
Year/Eff Age	1980 / 35

GRM Approach

GRM Code	
Gross Rent	0.00
Indicated Value	

Multiple Regression

MRA Code	1 Test
Adusted R	0.8445
Indicated Value	511,723 153.99 Per SqFt

Direct Comparables

Selection Model	1 Res
Adjustment Model	A2 AO Test
Comparables	
Indicated Value	

Value Reconciliation

Selected Approach	Cost Approach
Improvements	417,636
Lot Value	51,784
Indicated Value	469,420 141.26 Per SqFt
Agland Value	
Site Improvements	33,157
Total Value	502,577 151.24 Total Value Per SqFt

Cost Approach		Manual : 01/2025	
Base Cost	112.98	Total Misc Impr	+ 8,746
Roofing Adj	+ 5.95	Garage Cost	+ 45,990
Subfloor Adj	+ 0.00	Total RCN	= 732,694
Heat/Cool Adj	+ 17.38	Depreciation (43%)	- 315,058
Plumbing Adj	+ 9.19	Lump Sums	+ 0
Basement Adj	+ 58.52	RCNLD	= 417,636
Adj Base Cost	= 204.02	Lot Value	+ 51,784
Total Area	x 3,323	Indicated Value	= 469,420
Adjusted Cost	= 677,958	Value Per SqFt	141.26

Miscellaneous Improvements

Code	Description	Sketch ID	Size	Year	Units	Unit Cost	Depr	Value
FPR1	FIREPLACE - RESIDENTIAL 1 STORY	0		1	1	7,721.18		7,721
PRCH	SLAB PORCH - COVERED	54939	7x4		28	36.59		1,025



Rogers

Assessment Property Record Card for Tax Year 2026

Data provided by LISA DELOZIER County Assessor

Date 04/17/2026

Time 06:20:53

Page 3

Sketch Image

660022401

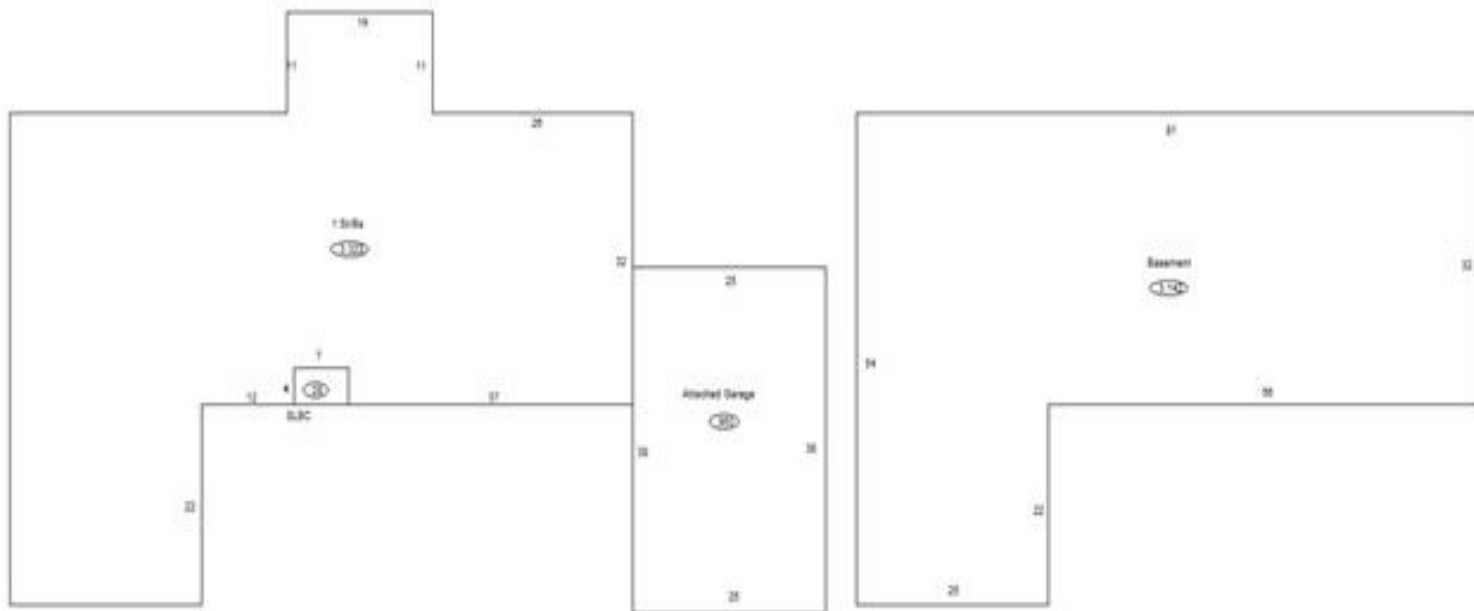

Sketch Vector Information

Sequence	Code	Type	Built Over	Scale	Section Label	Base Area	Multiplier	Total Area
1	R	1	Basement	13	1 St/Bs	3,323	1.000	3,323
2	G	1		13	Attached Garage	950	1.000	950
3	M	PRCH		13	SLBC	28	1.000	28
4	B	1		13	Basement	3,142	1.000	3,142
Total Building Area						3,323		3,323



Rogers



Assessment Property Record Card for Tax Year 2026

Data provided by LISA DELOZIER County Assessor

Date 04/17/2026
Time 06:20:53
Page 4

660022401

Outbuildings/Site Improvements

Building Image	Code	Description	Dimensions	Floor	Roofing	Total Units
	UTIL	SHOP BUILDING	30x30x0			900
	Qual 2	Cond 3	Year 2012	Eff Age	11	
	Valuation Summary		Modifier Total	RCN	Depr (0% Phys/ % Func)	RCNLD
	Base Cost (31.28 x 900)	28,152		28,152		28,152
	UTIL	SHOP BUILDING	16x10x0			160
	Qual 2	Cond 3	Year 2012	Eff Age	11	
	Valuation Summary		Modifier Total	RCN	Depr (0% Phys/ % Func)	RCNLD
	Base Cost (31.28 x 160)	5,005		5,005		5,005