



Rogers

Assessment Property Record Card for Tax Year 2026

Data provided by LISA DELOZIER County Assessor

Date 04/17/2026
Time 00:41:01
Page 1

Assessment Data					Primary Image																																																																																																															
Account 660022460 Parcel ID 23N16E-26-1-00000-000-0000 Cadastral ID 26-23-16-03300 Property Type REAL - Real Property Property Class RR VI Area 2 Tax Area 70 - FOYIL RURAL/FOYIL FIRE Name ID 28804 HUTCHINSON, EDGAR D 14954 E 390 RD CLAREMORE OK 74017-0000 Parcel Location Situs 14954 E 390 RD Subdivision Lot/Block / Parcel Size 5 - Acres Sec/Twn/Rng 26 / 23 / 16 / 1 Neighborhood 4050 - CHELSEA FOYIL RURAL School District S007 - FOYIL SCHOOLS					<p>\\tsclient\C\Users\rln\Pictures\2016-09-23 09-23-16\09-23-16 045.J 9/28/2016</p>																																																																																																															
Legal Description Lat/Long: 36.45197525 -95.56233610 N2 NE NE NE																																																																																																																				
Exemptions <table border="1"> <thead> <tr> <th>Code</th> <th>Type</th> <th>Active</th> <th>Maximum</th> <th>Exemption</th> </tr> </thead> <tbody> <tr> <td>H</td> <td>Homestead</td> <td>Yes</td> <td>1,000</td> <td>1,000</td> </tr> </tbody> </table>					Code	Type	Active	Maximum	Exemption	H	Homestead	Yes	1,000	1,000	Building Permits <table border="1"> <thead> <tr> <th>Number</th> <th>Description</th> <th>Opened</th> <th>Closed</th> <th>Amount</th> </tr> </thead> <tbody> <tr> <td colspan="5"> </td> </tr> </tbody> </table>					Number	Description	Opened	Closed	Amount																																																																																												
Code	Type	Active	Maximum	Exemption																																																																																																																
H	Homestead	Yes	1,000	1,000																																																																																																																
Number	Description	Opened	Closed	Amount																																																																																																																
Parcel Valuation <table border="1"> <thead> <tr> <th>Source</th> <th>REAL</th> <th>Fair Cash</th> <th>Capped</th> <th>Asmnt Level</th> <th>Assessed</th> <th>Levy Rate</th> <th>101.660</th> <th>Current Tax</th> </tr> </thead> <tbody> <tr> <td>Remove Cap</td> <td>0</td> <td>Land Value 54,701</td> <td>33,202</td> <td>11%</td> <td>3,652</td> <td>Assessed</td> <td>11,412</td> <td>1,160.14</td> </tr> <tr> <td>Year Frozen</td> <td>2025</td> <td>Improvements 116,220</td> <td>70,543</td> <td></td> <td>7,760</td> <td>Penalty</td> <td>0</td> <td></td> </tr> <tr> <td>Uncapped Value</td> <td>0</td> <td>Mobile Home 0</td> <td>0</td> <td></td> <td>0</td> <td>Exemption</td> <td>1,000</td> <td>-89.00</td> </tr> <tr> <td>TIF Project ID</td> <td>0</td> <td>Total Value 170,921</td> <td>103,745</td> <td></td> <td>11,412</td> <td>Total Taxable</td> <td>10,412</td> <td>1,071.00</td> </tr> </tbody> </table>					Source	REAL	Fair Cash	Capped	Asmnt Level	Assessed	Levy Rate	101.660	Current Tax	Remove Cap	0	Land Value 54,701	33,202	11%	3,652	Assessed	11,412	1,160.14	Year Frozen	2025	Improvements 116,220	70,543		7,760	Penalty	0		Uncapped Value	0	Mobile Home 0	0		0	Exemption	1,000	-89.00	TIF Project ID	0	Total Value 170,921	103,745		11,412	Total Taxable	10,412	1,071.00	Sale History <table border="1"> <thead> <tr> <th>Bk/Pg</th> <th>Grantor</th> <th>Date</th> <th>Price</th> <th>Code</th> </tr> </thead> <tbody> <tr> <td colspan="5"> </td> </tr> </tbody> </table>					Bk/Pg	Grantor	Date	Price	Code																																																									
Source	REAL	Fair Cash	Capped	Asmnt Level	Assessed	Levy Rate	101.660	Current Tax																																																																																																												
Remove Cap	0	Land Value 54,701	33,202	11%	3,652	Assessed	11,412	1,160.14																																																																																																												
Year Frozen	2025	Improvements 116,220	70,543		7,760	Penalty	0																																																																																																													
Uncapped Value	0	Mobile Home 0	0		0	Exemption	1,000	-89.00																																																																																																												
TIF Project ID	0	Total Value 170,921	103,745		11,412	Total Taxable	10,412	1,071.00																																																																																																												
Bk/Pg	Grantor	Date	Price	Code																																																																																																																
Assessment History <table border="1"> <thead> <tr> <th>Tax Year</th> <th>Statement Number</th> <th>Billed Owner</th> <th>Tax Area</th> <th>Total Value</th> <th>Exemptions</th> <th>Taxable Value</th> <th>Billed Tax</th> </tr> </thead> <tbody> <tr><td>2025</td><td>2025-660022460</td><td>HUTCHINSON, EDGAR D</td><td>70</td><td>177,946</td><td>1000</td><td>10,412</td><td>1,071.00</td></tr> <tr><td>2024</td><td>2024-660022460</td><td>HUTCHINSON, EDGAR D</td><td>70</td><td>169,929</td><td>1000</td><td>10,080</td><td>1,064.00</td></tr> <tr><td>2023</td><td>2023-660022460</td><td>HUTCHINSON, EDGAR D</td><td>70</td><td>139,468</td><td>1000</td><td>9,757</td><td>1,031.00</td></tr> <tr><td>2022</td><td>2022-660022460</td><td>HUTCHINSON, EDGAR D</td><td>70</td><td>108,755</td><td>1000</td><td>9,444</td><td>1,002.00</td></tr> <tr><td>2021</td><td>2021-660022460</td><td>HUTCHINSON, EDGAR D</td><td>70</td><td>101,548</td><td>1000</td><td>9,140</td><td>946.00</td></tr> <tr><td>2020</td><td>2020-660022460</td><td>HUTCHINSON, EDGAR D</td><td>70</td><td>102,297</td><td>1000</td><td>8,844</td><td>953.00</td></tr> <tr><td>2019</td><td>2019-660022460</td><td>HUTCHINSON, EDGAR D</td><td>70</td><td>98,747</td><td>1000</td><td>8,558</td><td>925.00</td></tr> <tr><td>2018</td><td>2018-660022460</td><td>HUTCHINSON, EDGAR D</td><td>70</td><td>103,001</td><td>1000</td><td>8,279</td><td>879.00</td></tr> <tr><td>2017</td><td>2017-660022460</td><td>HUTCHINSON, EDGAR D</td><td>70</td><td>102,376</td><td>1000</td><td>8,009</td><td>854.00</td></tr> <tr><td>2016</td><td>2016-660022460</td><td>HUTCHINSON, EDGAR D</td><td>70</td><td>114,729</td><td>1000</td><td>7,747</td><td>855.00</td></tr> <tr><td>2015</td><td>2015-660022460</td><td>HUTCHINSON, EDGAR D</td><td>70</td><td>112,408</td><td>1000</td><td>7,492</td><td>821.00</td></tr> <tr><td>2014</td><td>2014-660022460</td><td>HUTCHINSON, EDGAR D</td><td>70</td><td>110,663</td><td>1000</td><td>7,245</td><td>783.00</td></tr> <tr><td>2013</td><td>2013-660022460</td><td>HUTCHINSON, EDGAR D</td><td>70</td><td>107,754</td><td>1000</td><td>7,005</td><td>739.00</td></tr> </tbody> </table>					Tax Year	Statement Number	Billed Owner	Tax Area	Total Value	Exemptions	Taxable Value	Billed Tax	2025	2025-660022460	HUTCHINSON, EDGAR D	70	177,946	1000	10,412	1,071.00	2024	2024-660022460	HUTCHINSON, EDGAR D	70	169,929	1000	10,080	1,064.00	2023	2023-660022460	HUTCHINSON, EDGAR D	70	139,468	1000	9,757	1,031.00	2022	2022-660022460	HUTCHINSON, EDGAR D	70	108,755	1000	9,444	1,002.00	2021	2021-660022460	HUTCHINSON, EDGAR D	70	101,548	1000	9,140	946.00	2020	2020-660022460	HUTCHINSON, EDGAR D	70	102,297	1000	8,844	953.00	2019	2019-660022460	HUTCHINSON, EDGAR D	70	98,747	1000	8,558	925.00	2018	2018-660022460	HUTCHINSON, EDGAR D	70	103,001	1000	8,279	879.00	2017	2017-660022460	HUTCHINSON, EDGAR D	70	102,376	1000	8,009	854.00	2016	2016-660022460	HUTCHINSON, EDGAR D	70	114,729	1000	7,747	855.00	2015	2015-660022460	HUTCHINSON, EDGAR D	70	112,408	1000	7,492	821.00	2014	2014-660022460	HUTCHINSON, EDGAR D	70	110,663	1000	7,245	783.00	2013	2013-660022460	HUTCHINSON, EDGAR D	70	107,754	1000	7,005	739.00
Tax Year	Statement Number	Billed Owner	Tax Area	Total Value	Exemptions	Taxable Value	Billed Tax																																																																																																													
2025	2025-660022460	HUTCHINSON, EDGAR D	70	177,946	1000	10,412	1,071.00																																																																																																													
2024	2024-660022460	HUTCHINSON, EDGAR D	70	169,929	1000	10,080	1,064.00																																																																																																													
2023	2023-660022460	HUTCHINSON, EDGAR D	70	139,468	1000	9,757	1,031.00																																																																																																													
2022	2022-660022460	HUTCHINSON, EDGAR D	70	108,755	1000	9,444	1,002.00																																																																																																													
2021	2021-660022460	HUTCHINSON, EDGAR D	70	101,548	1000	9,140	946.00																																																																																																													
2020	2020-660022460	HUTCHINSON, EDGAR D	70	102,297	1000	8,844	953.00																																																																																																													
2019	2019-660022460	HUTCHINSON, EDGAR D	70	98,747	1000	8,558	925.00																																																																																																													
2018	2018-660022460	HUTCHINSON, EDGAR D	70	103,001	1000	8,279	879.00																																																																																																													
2017	2017-660022460	HUTCHINSON, EDGAR D	70	102,376	1000	8,009	854.00																																																																																																													
2016	2016-660022460	HUTCHINSON, EDGAR D	70	114,729	1000	7,747	855.00																																																																																																													
2015	2015-660022460	HUTCHINSON, EDGAR D	70	112,408	1000	7,492	821.00																																																																																																													
2014	2014-660022460	HUTCHINSON, EDGAR D	70	110,663	1000	7,245	783.00																																																																																																													
2013	2013-660022460	HUTCHINSON, EDGAR D	70	107,754	1000	7,005	739.00																																																																																																													



Rogers

Assessment Property Record Card for Tax Year 2026

Data provided by LISA DELOZIER County Assessor

Date 04/17/2026
Time 00:41:02
Page 2

Lot Data	Square-Foot - NBHD 4050 #1	Primary Image
Lot Size		
Lot Count		
Units Buildable	5	
Non-Ag Acres	4.9546	
Topography		
Street Access		
Utilities		
Amenities	LAND QUALITY	
	0	
	0	
Method	Square-Foot	
Base Lot Value	215,824.00 x .25 = 54,701	
Factor Value		
Adjustments	1.0000	
Lot Value	54,701	

Residential Data	
Type	1 Single Family Residence
Condition	2 - Fair
Quality	2.5 - Fair
Architecture	TRAD TRADITIONAL
Style	100% 1 1/2 Story Finished
Exterior Wall	100% Frame, Siding, Vinyl
Base/Total Area	1,120 / 1,288
Style	100% 1 1/2 Story Finished
HVAC	100% Warmed & Cooled Air
Roof Cover	4 Metal, Preformed
Area on Slab	0
Fixture/RghIn	7 /
Bed/F/H Bath	3 / 1.5 /
Basement Area	
Garage Type	
Remodel	
Year/Eff Age	1980 / 46



\\tsclient\C\Users\rln\Pictures\2016-09-23 09-23-16\09-23-16 045.J 9/28/2016

GRM Approach	
GRM Code	
Gross Rent	0.00
Indicated Value	

Multiple Regression			
MRA Code	1	Test	
Adusted R	0.8445		
Indicated Value	145,086	112.64	Per SqFt

Direct Comparables	
Selection Model	1 Res
Adjustment Model	A2 AO Test
Comparables	
Indicated Value	

Cost Approach				Manual : 01/2025			
Base Cost	89.80	Total Misc Impr	+	16,868			
Roofing Adj	+ 4.76	Garage Cost	+				
Subfloor Adj	+ 1.08	Total RCN	=	163,571			
Heat/Cool Adj	+ 11.24	Depreciation (53%)	-	86,693			
Plumbing Adj	+ 7.02	Lump Sums	+	0			
Basement Adj	+ 0.00	RCNLD	=	76,878			
Adj Base Cost	= 113.90	Lot Value	+	54,701			
Total Area	x 1,288	Indicated Value	=	131,579			
Adjusted Cost	= 146,703	Value Per SqFt		102.16			

Value Reconciliation			
Selected Approach	Cost Approach		
Improvements	76,878		
Lot Value	54,701		
Indicated Value	131,579	102.16	Per SqFt
Agland Value			
Site Improvements	39,342		
Total Value	170,921	132.70	Total Value Per SqFt

Miscellaneous Improvements								
Code	Description	Sketch ID	Size	Year	Units	Unit Cost	Depr	Value
FPR1	FIREPLACE - RESIDENTIAL 1 STORY	0		1	1	4,994.06		4,994
PRCH	SLAB PORCH - COVERED	55090	32x12		384	22.62		8,686
PATO	Patio - Open	167208	20x20		400	7.97		3,188



Rogers

Assessment Property Record Card for Tax Year 2026

Data provided by LISA DELOZIER County Assessor

Date 04/17/2026

Time 00:41:02

Page 3

Sketch Image

660022460

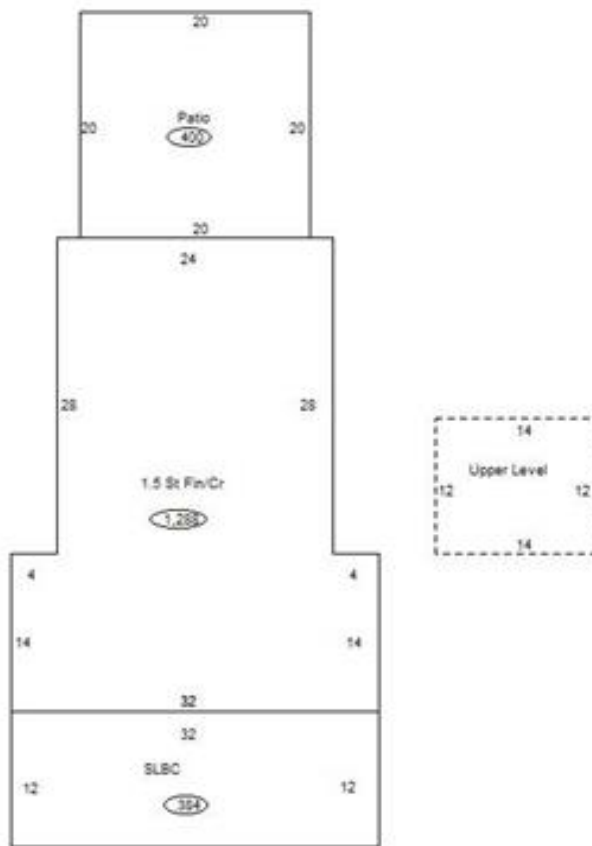

Sketch Vector Information

Sequence	Code	Type	Built Over	Scale	Section Label	Base Area	Multiplier	Total Area
1	R	5	Crawl	13	1.5 St Fin/Cr	1,120	1.150	1,288
2	M	PRCH		13	SLBC	384	1.000	384
3	U	^UL		13	Upper Level	168	1.000	168
4	M	PATO		13	Patio	400	1.000	400
Total Building Area						1,120		1,288



Rogers

Assessment Property Record Card for Tax Year 2026

Data provided by LISA DELOZIER County Assessor

Date 04/17/2026
Time 00:41:02
Page 4

660022460

Outbuildings/Site Improvements

Building Image	Code	Description	Dimensions	Floor	Roofing	Total Units
	UTIL	SHOP BUILDING	50x30x10	Concrete	Formed Metal	1,500
	Qual 2	Cond 3	Year 2018	Eff Age 6		
		Valuation Summary	Modifier Total	RCN	Depr (11% Phys/ % Func)	RCNLD
		Base Cost (29.47 x 1,500)	44,205	44,205	4,863	39,342