



# Rogers

## Assessment Property Record Card for Tax Year 2026

Data provided by LISA DELOZIER County Assessor

Date 04/16/2026  
Time 22:58:09  
Page 1

Assessment Data					Primary Image																																																																																																																				
<b>Account</b> 660022816 <b>Parcel ID</b> 000000-00-0-00186-004-0002 <b>Cadastral ID</b> 27-21-14-02370 <b>Property Type</b> REAL - Real Property <b>Property Class</b> RRP VI Area 4 <b>Tax Area</b> 3 - OWASSO RURAL/NO FIRE <b>Name ID</b> 258778 KOZMA, ROBERT J &  ELAINE 15904 E 80TH ST N OWASSO OK 74055-0000  <b>Parcel Location</b> <b>Situs</b> 15904 E 80TH ST N <b>Subdivision</b> CORNERSTONE ADDITION 2 <b>Lot/Block</b> 0002 / 0004 Parcel Size 1 - Lots <b>Sec/Twn/Rng</b> 27 / 21 / 14 / 5 <b>Neighborhood</b> 1212 - R-V04-SW OWASSO <b>School District</b> S021 - OWASSO SCHOOLS																																																																																																																									
<b>Legal Description</b> Lot/Long: 36.26993791 -95.79638714																																																																																																																									
<b>Legal Description</b> LOT 2 BLOCK 4 CORNERSTONE ADD 2					<b>Building Permits</b> <table border="1"> <thead> <tr> <th>Number</th> <th>Description</th> <th>Opened</th> <th>Closed</th> <th>Amount</th> </tr> </thead> <tbody> <tr> <td> </td> <td> </td> <td> </td> <td> </td> <td> </td> </tr> </tbody> </table>					Number	Description	Opened	Closed	Amount																																																																																																											
Number	Description	Opened	Closed	Amount																																																																																																																					
<b>Exemptions</b> <table border="1"> <thead> <tr> <th>Code</th> <th>Type</th> <th>Active</th> <th>Maximum</th> <th>Exemption</th> </tr> </thead> <tbody> <tr> <td>H</td> <td>Homestead</td> <td>Yes</td> <td>1,000</td> <td>1,000</td> </tr> </tbody> </table>					Code	Type	Active	Maximum	Exemption	H	Homestead	Yes	1,000	1,000	<b>Sale History</b> <table border="1"> <thead> <tr> <th>Bk/Pg</th> <th>Grantor</th> <th>Date</th> <th>Price</th> <th>Code</th> </tr> </thead> <tbody> <tr> <td>960/870</td> <td>VAN WYHE, HARLAN G &amp;</td> <td>06/21/1994</td> <td>125,000</td> <td>Yes</td> </tr> <tr> <td>835/16</td> <td></td> <td></td> <td>94,500</td> <td>No</td> </tr> </tbody> </table>					Bk/Pg	Grantor	Date	Price	Code	960/870	VAN WYHE, HARLAN G &	06/21/1994	125,000	Yes	835/16			94,500	No																																																																																							
Code	Type	Active	Maximum	Exemption																																																																																																																					
H	Homestead	Yes	1,000	1,000																																																																																																																					
Bk/Pg	Grantor	Date	Price	Code																																																																																																																					
960/870	VAN WYHE, HARLAN G &	06/21/1994	125,000	Yes																																																																																																																					
835/16			94,500	No																																																																																																																					
<b>Parcel Valuation</b> <table border="1"> <thead> <tr> <th>Source</th> <th>REAL</th> <th>Fair Cash</th> <th>Capped</th> <th>Asmnt Level</th> <th>Assessed</th> <th>Levy Rate</th> <th>97.960</th> <th>Current Tax</th> </tr> </thead> <tbody> <tr> <td>Remove Cap</td> <td>0</td> <td>Land Value 126,545</td> <td>49,944</td> <td>11%</td> <td>5,494</td> <td>Assessed</td> <td>25,057</td> <td>2,454.58</td> </tr> <tr> <td>Year Frozen</td> <td>0</td> <td>Improvements 201,435</td> <td>177,848</td> <td></td> <td>19,563</td> <td>Penalty</td> <td>0</td> <td></td> </tr> <tr> <td>Uncapped Value</td> <td>0</td> <td>Mobile Home 0</td> <td>0</td> <td></td> <td>0</td> <td>Exemption</td> <td>1,000</td> <td>-98.00</td> </tr> <tr> <td>TIF Project ID</td> <td>0</td> <td>Total Value 327,980</td> <td>227,792</td> <td></td> <td>25,057</td> <td>Total Taxable</td> <td>24,057</td> <td>2,357.00</td> </tr> </tbody> </table>										Source	REAL	Fair Cash	Capped	Asmnt Level	Assessed	Levy Rate	97.960	Current Tax	Remove Cap	0	Land Value 126,545	49,944	11%	5,494	Assessed	25,057	2,454.58	Year Frozen	0	Improvements 201,435	177,848		19,563	Penalty	0		Uncapped Value	0	Mobile Home 0	0		0	Exemption	1,000	-98.00	TIF Project ID	0	Total Value 327,980	227,792		25,057	Total Taxable	24,057	2,357.00																																																																			
Source	REAL	Fair Cash	Capped	Asmnt Level	Assessed	Levy Rate	97.960	Current Tax																																																																																																																	
Remove Cap	0	Land Value 126,545	49,944	11%	5,494	Assessed	25,057	2,454.58																																																																																																																	
Year Frozen	0	Improvements 201,435	177,848		19,563	Penalty	0																																																																																																																		
Uncapped Value	0	Mobile Home 0	0		0	Exemption	1,000	-98.00																																																																																																																	
TIF Project ID	0	Total Value 327,980	227,792		25,057	Total Taxable	24,057	2,357.00																																																																																																																	
<b>Assessment History</b> <table border="1"> <thead> <tr> <th>Tax Year</th> <th>Statement Number</th> <th>Billed Owner</th> <th>Tax Area</th> <th>Total Value</th> <th>Exemptions</th> <th>Taxable Value</th> <th>Billed Tax</th> </tr> </thead> <tbody> <tr><td>2025</td><td>2025-660022816</td><td>KOZMA, ROBERT J &amp;</td><td>3</td><td>324,076</td><td>1000</td><td>23,328</td><td>2,285.00</td></tr> <tr><td>2024</td><td>2024-660022816</td><td>KOZMA, ROBERT J &amp;</td><td>3</td><td>343,592</td><td>1000</td><td>22,618</td><td>2,173.00</td></tr> <tr><td>2023</td><td>2023-660022816</td><td>KOZMA, ROBERT J &amp;</td><td>3</td><td>221,402</td><td>1000</td><td>21,931</td><td>2,055.00</td></tr> <tr><td>2022</td><td>2022-660022816</td><td>KOZMA, ROBERT J &amp;</td><td>3</td><td>202,393</td><td>1000</td><td>21,263</td><td>2,083.00</td></tr> <tr><td>2021</td><td>2021-660022816</td><td>KOZMA, ROBERT J &amp;</td><td>3</td><td>198,526</td><td>1000</td><td>20,731</td><td>2,006.00</td></tr> <tr><td>2020</td><td>2020-660022816</td><td>KOZMA, ROBERT J &amp;</td><td>3</td><td>197,417</td><td>1000</td><td>20,098</td><td>1,941.00</td></tr> <tr><td>2019</td><td>2019-660022816</td><td>KOZMA, ROBERT J &amp;</td><td>3</td><td>188,101</td><td>1000</td><td>19,484</td><td>1,884.00</td></tr> <tr><td>2018</td><td>2018-660022816</td><td>KOZMA, ROBERT J &amp;</td><td>3</td><td>195,057</td><td>1000</td><td>18,887</td><td>1,758.00</td></tr> <tr><td>2017</td><td>2017-660022816</td><td>KOZMA, ROBERT J &amp;</td><td>3</td><td>193,557</td><td>1000</td><td>18,307</td><td>1,722.00</td></tr> <tr><td>2016</td><td>2016-660022816</td><td>KOZMA, ROBERT J &amp;</td><td>3</td><td>188,743</td><td>1000</td><td>17,746</td><td>1,671.00</td></tr> <tr><td>2015</td><td>2015-660022816</td><td>KOZMA, ROBERT J &amp;</td><td>3</td><td>184,322</td><td>1000</td><td>17,200</td><td>1,631.00</td></tr> <tr><td>2014</td><td>2014-660022816</td><td>KOZMA, ROBERT J &amp;</td><td>3</td><td>187,452</td><td>1000</td><td>16,670</td><td>1,596.00</td></tr> <tr><td>2013</td><td>2013-660022816</td><td>KOZMA, ROBERT J &amp;</td><td>3</td><td>177,421</td><td>1000</td><td>16,155</td><td>1,513.00</td></tr> </tbody> </table>										Tax Year	Statement Number	Billed Owner	Tax Area	Total Value	Exemptions	Taxable Value	Billed Tax	2025	2025-660022816	KOZMA, ROBERT J &	3	324,076	1000	23,328	2,285.00	2024	2024-660022816	KOZMA, ROBERT J &	3	343,592	1000	22,618	2,173.00	2023	2023-660022816	KOZMA, ROBERT J &	3	221,402	1000	21,931	2,055.00	2022	2022-660022816	KOZMA, ROBERT J &	3	202,393	1000	21,263	2,083.00	2021	2021-660022816	KOZMA, ROBERT J &	3	198,526	1000	20,731	2,006.00	2020	2020-660022816	KOZMA, ROBERT J &	3	197,417	1000	20,098	1,941.00	2019	2019-660022816	KOZMA, ROBERT J &	3	188,101	1000	19,484	1,884.00	2018	2018-660022816	KOZMA, ROBERT J &	3	195,057	1000	18,887	1,758.00	2017	2017-660022816	KOZMA, ROBERT J &	3	193,557	1000	18,307	1,722.00	2016	2016-660022816	KOZMA, ROBERT J &	3	188,743	1000	17,746	1,671.00	2015	2015-660022816	KOZMA, ROBERT J &	3	184,322	1000	17,200	1,631.00	2014	2014-660022816	KOZMA, ROBERT J &	3	187,452	1000	16,670	1,596.00	2013	2013-660022816	KOZMA, ROBERT J &	3	177,421	1000	16,155	1,513.00
Tax Year	Statement Number	Billed Owner	Tax Area	Total Value	Exemptions	Taxable Value	Billed Tax																																																																																																																		
2025	2025-660022816	KOZMA, ROBERT J &	3	324,076	1000	23,328	2,285.00																																																																																																																		
2024	2024-660022816	KOZMA, ROBERT J &	3	343,592	1000	22,618	2,173.00																																																																																																																		
2023	2023-660022816	KOZMA, ROBERT J &	3	221,402	1000	21,931	2,055.00																																																																																																																		
2022	2022-660022816	KOZMA, ROBERT J &	3	202,393	1000	21,263	2,083.00																																																																																																																		
2021	2021-660022816	KOZMA, ROBERT J &	3	198,526	1000	20,731	2,006.00																																																																																																																		
2020	2020-660022816	KOZMA, ROBERT J &	3	197,417	1000	20,098	1,941.00																																																																																																																		
2019	2019-660022816	KOZMA, ROBERT J &	3	188,101	1000	19,484	1,884.00																																																																																																																		
2018	2018-660022816	KOZMA, ROBERT J &	3	195,057	1000	18,887	1,758.00																																																																																																																		
2017	2017-660022816	KOZMA, ROBERT J &	3	193,557	1000	18,307	1,722.00																																																																																																																		
2016	2016-660022816	KOZMA, ROBERT J &	3	188,743	1000	17,746	1,671.00																																																																																																																		
2015	2015-660022816	KOZMA, ROBERT J &	3	184,322	1000	17,200	1,631.00																																																																																																																		
2014	2014-660022816	KOZMA, ROBERT J &	3	187,452	1000	16,670	1,596.00																																																																																																																		
2013	2013-660022816	KOZMA, ROBERT J &	3	177,421	1000	16,155	1,513.00																																																																																																																		



# Rogers

## Assessment Property Record Card for Tax Year 2026

Data provided by LISA DELOZIER County Assessor

Date 04/16/2026  
Time 22:58:09  
Page 2

Lot Data	Square-Foot - NBHD 1212 #1	Primary Image
<b>Lot Size</b> <b>Lot Count</b> 1 <b>Units Buildable</b> 1 <b>Non-Ag Acres</b> 1.1953 <b>Topography</b> <b>Street Access</b> <b>Utilities</b> <b>Amenities</b> LAND QUALITY 0 0 <b>Method</b> Square-Foot <b>Base Lot Value</b> 52,068.00 x 2.43 = 126,545 <b>Factor Value</b> <b>Adjustments</b> 1.0000 <b>Lot Value</b> 126,545		 <p style="text-align: right; color: orange;">07/27/2022 13:02</p>

Residential Data	
<b>Type</b>	1 Single Family Residence
<b>Condition</b>	3 - Average
<b>Quality</b>	3.5 - Average
<b>Architecture</b>	
<b>Style</b>	100% 1 1/2 Story Finished
<b>Exterior Wall</b>	20% Veneer, Masonry 80% Frame, Siding, Wood
<b>Base/Total Area</b>	1,746 / 2,230
<b>Style</b>	100% 1 1/2 Story Finished
<b>HVAC</b>	100% Warmed & Cooled Air
<b>Roof Cover</b>	1 Composition Shingle
<b>Area on Slab</b>	1,746
<b>Fixture/RghIn</b>	14 /
<b>Bed/F/H Bath</b>	4 / 2.5 /
<b>Basement Area</b>	
<b>Garage Type</b>	690 Attached Garage - Unfinished
<b>Remodel</b>	
<b>Year/Eff Age</b>	1988 / 29

\\tsclient\TCASEY\CASEY BOOTH RESIDENTIAL VI\2022-7-27\ 7/27/2022

GRM Approach	
<b>GRM Code</b>	
<b>Gross Rent</b>	0.00
<b>Indicated Value</b>	

Multiple Regression			
<b>MRA Code</b>	1	Test	
<b>Adusted R</b>	0.8445		
<b>Indicated Value</b>	287,875	129.09	Per SqFt

Direct Comparables			
<b>Selection Model</b>	A	Adam Test	
<b>Adjustment Model</b>	1	2022 Residential	
<b>Comparables</b>	3		
<b>Indicated Value</b>	356,210		Per SqFt

Cost Approach				Manual : 01/2025			
<b>Base Cost</b>	96.45	<b>Total Misc Impr</b>	+ 15,726				
<b>Roofing Adj</b>	+ 4.33	<b>Garage Cost</b>	+ 25,841				
<b>Subfloor Adj</b>	+ -2.78	<b>Total RCN</b>	= 314,742				
<b>Heat/Cool Adj</b>	+ 14.47	<b>Depreciation ( 36%)</b>	- 113,307				
<b>Plumbing Adj</b>	+ 10.03	<b>Lump Sums</b>	+ 0				
<b>Basement Adj</b>	+ 0.00	<b>RCNLD</b>	= 201,435				
<b>Adj Base Cost</b>	= 122.50	<b>Lot Value</b>	+ 126,545				
<b>Total Area</b>	x 2,230	<b>Indicated Value</b>	= 327,980				
<b>Adjusted Cost</b>	= 273,175	<b>Value Per SqFt</b>	147.08				

Value Reconciliation			
<b>Selected Approach</b>	Cost Approach		
<b>Improvements</b>	201,435		
<b>Lot Value</b>	126,545		
<b>Indicated Value</b>	327,980	147.08	Per SqFt
<b>Agland Value</b>			
<b>Site Improvements</b>			
<b>Total Value</b>	327,980	147.08	Total Value Per SqFt

Miscellaneous Improvements								
Code	Description	Sketch ID	Size	Year	Units	Unit Cost	Depr	Value
FPR1	FIREPLACE - RESIDENTIAL 1 STORY	0		1	1	6,429.63		6,430
PRCH	SLAB PORCH - COVERED	55941	156		156	28.98		4,521
PRCH	SLAB PORCH - COVERED	55942	165		165	28.94		4,775



**Rogers**  
**Assessment Property Record Card for Tax Year 2026**

Data provided by LISA DELOZIER County Assessor

Date 04/16/2026  
 Time 22:58:09  
 Page 3

Sketch Image

660022816

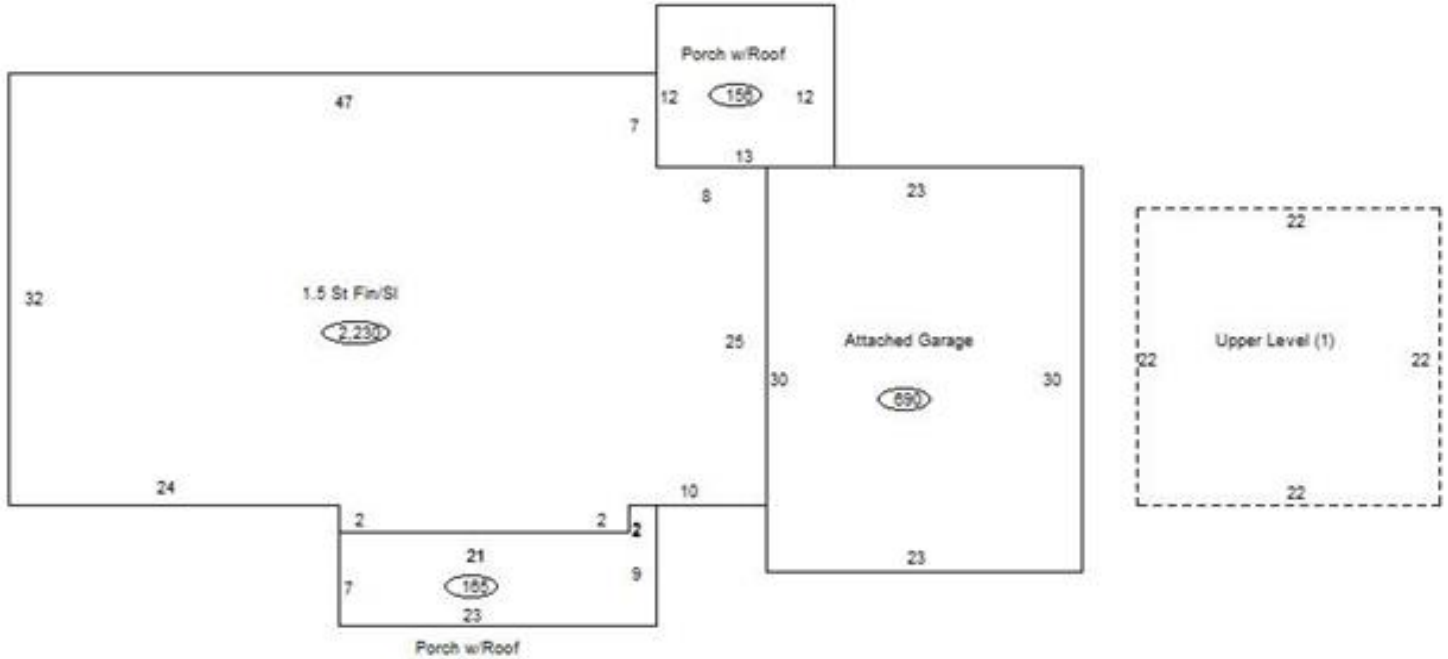

**Sketch Vector Information**

Sequence	Code	Type	Built Over	Scale	Section Label	Base Area	Multiplier	Total Area
1	R	5	Slab	13	1.5 St Fin/Sl	1,746	1.277	2,230
2	G	1		13	Attached Garage	690	1.000	690
3	M	PRCH		13	SLBC	156	1.000	156
4	M	PRCH		13	SLBC	165	1.000	165
5	U	^UL		13	Upper Level (1)	484	1.000	484
<b>Total Building Area</b>						1,746		2,230