



# Rogers

## Assessment Property Record Card for Tax Year 2026

Data provided by LISA DELOZIER County Assessor

Date 04/16/2026  
Time 22:01:24  
Page 1

Assessment Data					Primary Image																																																																																																																				
<b>Account</b> 660022841 <b>Parcel ID</b> 000000-00-0-00186-006-0006 <b>Cadastral ID</b> 27-21-14-02620 <b>Property Type</b> REAL - Real Property <b>Property Class</b> RRP VI Area 4 <b>Tax Area</b> 3 - OWASSO RURAL/NO FIRE <b>Name ID</b> 346149 SWIFT, JOSHUA & ANGELA  15702 E 79TH ST N OWASSO OK 74055-0000  <b>Parcel Location</b> <b>Situs</b> 15702 79TH ST N <b>Subdivision</b> CORNERSTONE ADDITION 2 <b>Lot/Block</b> 0006 / 0006 Parcel Size 1 - Lots <b>Sec/Twn/Rng</b> 27 / 21 / 14 / 5 <b>Neighborhood</b> 1212 - R-V04-SW OWASSO <b>School District</b> S021 - OWASSO SCHOOLS																																																																																																																									
<b>Legal Description</b> Lot/Long: 36.26808523 -95.79853945																																																																																																																									
<b>Legal Description</b> LOT 6 BLOCK 6 CORNERSTONE ADD 2					<b>Building Permits</b> <table border="1"> <thead> <tr> <th>Number</th> <th>Description</th> <th>Opened</th> <th>Closed</th> <th>Amount</th> </tr> </thead> <tbody> <tr> <td></td> <td></td> <td></td> <td></td> <td></td> </tr> </tbody> </table>					Number	Description	Opened	Closed	Amount																																																																																																											
Number	Description	Opened	Closed	Amount																																																																																																																					
<b>Exemptions</b> <table border="1"> <thead> <tr> <th>Code</th> <th>Type</th> <th>Active</th> <th>Maximum</th> <th>Exemption</th> </tr> </thead> <tbody> <tr> <td>H</td> <td>Homestead</td> <td>No</td> <td>1,000</td> <td></td> </tr> </tbody> </table>					Code	Type	Active	Maximum	Exemption	H	Homestead	No	1,000		<b>Sale History</b> <table border="1"> <thead> <tr> <th>Bk/Pg</th> <th>Grantor</th> <th>Date</th> <th>Price</th> <th>Code</th> </tr> </thead> <tbody> <tr> <td>/</td> <td>DISCHNER, LUDWIG A JR &amp; SALLY A</td> <td>12/02/2024</td> <td>334,000</td> <td>YES</td> </tr> <tr> <td>833/893</td> <td></td> <td></td> <td>92,500</td> <td>No</td> </tr> </tbody> </table>					Bk/Pg	Grantor	Date	Price	Code	/	DISCHNER, LUDWIG A JR & SALLY A	12/02/2024	334,000	YES	833/893			92,500	No																																																																																							
Code	Type	Active	Maximum	Exemption																																																																																																																					
H	Homestead	No	1,000																																																																																																																						
Bk/Pg	Grantor	Date	Price	Code																																																																																																																					
/	DISCHNER, LUDWIG A JR & SALLY A	12/02/2024	334,000	YES																																																																																																																					
833/893			92,500	No																																																																																																																					
<b>Parcel Valuation</b> <table border="1"> <thead> <tr> <th>Source</th> <th>REAL</th> <th>Fair Cash</th> <th>Capped</th> <th>Asmnt Level</th> <th>Assessed</th> <th>Levy Rate</th> <th>97.960</th> <th>Current Tax</th> </tr> </thead> <tbody> <tr> <td>Remove Cap</td> <td>2026</td> <td>Land Value 143,492</td> <td>143,492</td> <td>11%</td> <td>15,784</td> <td>Assessed</td> <td>37,136</td> <td>3,637.84</td> </tr> <tr> <td>Year Frozen</td> <td>2023</td> <td>Improvements 194,111</td> <td>194,111</td> <td></td> <td>21,352</td> <td>Penalty</td> <td>0</td> <td></td> </tr> <tr> <td>Uncapped Value</td> <td>0</td> <td>Mobile Home 0</td> <td>0</td> <td></td> <td>0</td> <td>Exemption</td> <td>0</td> <td>0.00</td> </tr> <tr> <td>TIF Project ID</td> <td>0</td> <td>Total Value 337,603</td> <td>337,603</td> <td></td> <td>37,136</td> <td>Total Taxable</td> <td>37,136</td> <td>3,638.00</td> </tr> </tbody> </table>										Source	REAL	Fair Cash	Capped	Asmnt Level	Assessed	Levy Rate	97.960	Current Tax	Remove Cap	2026	Land Value 143,492	143,492	11%	15,784	Assessed	37,136	3,637.84	Year Frozen	2023	Improvements 194,111	194,111		21,352	Penalty	0		Uncapped Value	0	Mobile Home 0	0		0	Exemption	0	0.00	TIF Project ID	0	Total Value 337,603	337,603		37,136	Total Taxable	37,136	3,638.00																																																																			
Source	REAL	Fair Cash	Capped	Asmnt Level	Assessed	Levy Rate	97.960	Current Tax																																																																																																																	
Remove Cap	2026	Land Value 143,492	143,492	11%	15,784	Assessed	37,136	3,637.84																																																																																																																	
Year Frozen	2023	Improvements 194,111	194,111		21,352	Penalty	0																																																																																																																		
Uncapped Value	0	Mobile Home 0	0		0	Exemption	0	0.00																																																																																																																	
TIF Project ID	0	Total Value 337,603	337,603		37,136	Total Taxable	37,136	3,638.00																																																																																																																	
<b>Assessment History</b> <table border="1"> <thead> <tr> <th>Tax Year</th> <th>Statement Number</th> <th>Billed Owner</th> <th>Tax Area</th> <th>Total Value</th> <th>Exemptions</th> <th>Taxable Value</th> <th>Billed Tax</th> </tr> </thead> <tbody> <tr><td>2025</td><td>2025-660022841</td><td>SWIFT, JOSHUA &amp; ANGELA</td><td>3</td><td>334,001</td><td>0</td><td>26,354</td><td>2,582.00</td></tr> <tr><td>2024</td><td>2024-660022841</td><td>DISCHNER, LUDWIG A JR &amp; SALLY A</td><td>3</td><td>349,026</td><td>1000</td><td>24,099</td><td>2,315.00</td></tr> <tr><td>2023</td><td>2023-660022841</td><td>DISCHNER, LUDWIG A JR &amp; SALLY A</td><td>3</td><td>245,067</td><td>1000</td><td>24,099</td><td>2,258.00</td></tr> <tr><td>2022</td><td>2022-660022841</td><td>DISCHNER, LUDWIG A JR &amp; SALLY A</td><td>3</td><td>231,117</td><td>1000</td><td>23,368</td><td>2,289.00</td></tr> <tr><td>2021</td><td>2021-660022841</td><td>DISCHNER, LUDWIG A JR &amp; SALLY A</td><td>3</td><td>215,074</td><td>1000</td><td>22,658</td><td>2,192.00</td></tr> <tr><td>2020</td><td>2020-660022841</td><td>DISCHNER, LUDWIG A JR &amp; SALLY A</td><td>3</td><td>213,797</td><td>1000</td><td>22,116</td><td>2,136.00</td></tr> <tr><td>2019</td><td>2019-660022841</td><td>DISCHNER, LUDWIG A JR &amp; SALLY A</td><td>3</td><td>204,028</td><td>1000</td><td>21,443</td><td>2,073.00</td></tr> <tr><td>2018</td><td>2018-660022841</td><td>DISCHNER, LUDWIG A JR &amp; SALLY A</td><td>3</td><td>211,925</td><td>1000</td><td>20,933</td><td>1,948.00</td></tr> <tr><td>2017</td><td>2017-660022841</td><td>DISCHNER, LUDWIG A JR &amp; SALLY A</td><td>3</td><td>210,129</td><td>1000</td><td>20,295</td><td>1,909.00</td></tr> <tr><td>2016</td><td>2016-660022841</td><td>DISCHNER, LUDWIG A JR &amp; SALLY A</td><td>3</td><td>205,403</td><td>1000</td><td>19,675</td><td>1,852.00</td></tr> <tr><td>2015</td><td>2015-660022841</td><td>DISCHNER, LUDWIG A JR &amp; SALLY A</td><td>3</td><td>201,073</td><td>1000</td><td>19,073</td><td>1,809.00</td></tr> <tr><td>2014</td><td>2014-660022841</td><td>DISCHNER, LUDWIG A JR &amp; SALLY A</td><td>3</td><td>186,770</td><td>1000</td><td>17,596</td><td>1,684.00</td></tr> <tr><td>2013</td><td>2013-660022841</td><td>DISCHNER, LUDWIG A JR &amp; SALLY A</td><td>3</td><td>177,030</td><td>1000</td><td>17,055</td><td>1,598.00</td></tr> </tbody> </table>										Tax Year	Statement Number	Billed Owner	Tax Area	Total Value	Exemptions	Taxable Value	Billed Tax	2025	2025-660022841	SWIFT, JOSHUA & ANGELA	3	334,001	0	26,354	2,582.00	2024	2024-660022841	DISCHNER, LUDWIG A JR & SALLY A	3	349,026	1000	24,099	2,315.00	2023	2023-660022841	DISCHNER, LUDWIG A JR & SALLY A	3	245,067	1000	24,099	2,258.00	2022	2022-660022841	DISCHNER, LUDWIG A JR & SALLY A	3	231,117	1000	23,368	2,289.00	2021	2021-660022841	DISCHNER, LUDWIG A JR & SALLY A	3	215,074	1000	22,658	2,192.00	2020	2020-660022841	DISCHNER, LUDWIG A JR & SALLY A	3	213,797	1000	22,116	2,136.00	2019	2019-660022841	DISCHNER, LUDWIG A JR & SALLY A	3	204,028	1000	21,443	2,073.00	2018	2018-660022841	DISCHNER, LUDWIG A JR & SALLY A	3	211,925	1000	20,933	1,948.00	2017	2017-660022841	DISCHNER, LUDWIG A JR & SALLY A	3	210,129	1000	20,295	1,909.00	2016	2016-660022841	DISCHNER, LUDWIG A JR & SALLY A	3	205,403	1000	19,675	1,852.00	2015	2015-660022841	DISCHNER, LUDWIG A JR & SALLY A	3	201,073	1000	19,073	1,809.00	2014	2014-660022841	DISCHNER, LUDWIG A JR & SALLY A	3	186,770	1000	17,596	1,684.00	2013	2013-660022841	DISCHNER, LUDWIG A JR & SALLY A	3	177,030	1000	17,055	1,598.00
Tax Year	Statement Number	Billed Owner	Tax Area	Total Value	Exemptions	Taxable Value	Billed Tax																																																																																																																		
2025	2025-660022841	SWIFT, JOSHUA & ANGELA	3	334,001	0	26,354	2,582.00																																																																																																																		
2024	2024-660022841	DISCHNER, LUDWIG A JR & SALLY A	3	349,026	1000	24,099	2,315.00																																																																																																																		
2023	2023-660022841	DISCHNER, LUDWIG A JR & SALLY A	3	245,067	1000	24,099	2,258.00																																																																																																																		
2022	2022-660022841	DISCHNER, LUDWIG A JR & SALLY A	3	231,117	1000	23,368	2,289.00																																																																																																																		
2021	2021-660022841	DISCHNER, LUDWIG A JR & SALLY A	3	215,074	1000	22,658	2,192.00																																																																																																																		
2020	2020-660022841	DISCHNER, LUDWIG A JR & SALLY A	3	213,797	1000	22,116	2,136.00																																																																																																																		
2019	2019-660022841	DISCHNER, LUDWIG A JR & SALLY A	3	204,028	1000	21,443	2,073.00																																																																																																																		
2018	2018-660022841	DISCHNER, LUDWIG A JR & SALLY A	3	211,925	1000	20,933	1,948.00																																																																																																																		
2017	2017-660022841	DISCHNER, LUDWIG A JR & SALLY A	3	210,129	1000	20,295	1,909.00																																																																																																																		
2016	2016-660022841	DISCHNER, LUDWIG A JR & SALLY A	3	205,403	1000	19,675	1,852.00																																																																																																																		
2015	2015-660022841	DISCHNER, LUDWIG A JR & SALLY A	3	201,073	1000	19,073	1,809.00																																																																																																																		
2014	2014-660022841	DISCHNER, LUDWIG A JR & SALLY A	3	186,770	1000	17,596	1,684.00																																																																																																																		
2013	2013-660022841	DISCHNER, LUDWIG A JR & SALLY A	3	177,030	1000	17,055	1,598.00																																																																																																																		



# Rogers

## Assessment Property Record Card for Tax Year 2026

Data provided by LISA DELOZIER County Assessor

Date 04/16/2026  
Time 22:01:24  
Page 2

Lot Data	Square-Foot - NBHD 1212 #1	Primary Image
Lot Size		
Lot Count	1	
Units Buildable	1	
Non-Ag Acres	1.1303	
Topography		
Street Access		
Utilities		
Amenities	LAND QUALITY	
	0	
	0	
Method	Square-Foot	
Base Lot Value	49,236.00 x 2.51 = 123,572	
Factor Value		
Adjustments	1.1612	
Lot Value	143,492	

Residential Data	
Type	1 Single Family Residence
Condition	3 - Average
Quality	3 - Average
Architecture	
Style	100% 1 1/2 Story Finished
Exterior Wall	100% Frame, Siding, Vinyl
Base/Total Area	1,534 / 2,154
Style	100% 1 1/2 Story Finished
HVAC	100% Warmed & Cooled Air
Roof Cover	1 Composition Shingle
Area on Slab	1,534
Fixture/RghIn	14 /
Bed/F/H Bath	3 / 2.5 /
Basement Area	
Garage Type	530 Attached Garage - Unfinished
Remodel	
Year/Eff Age	1990 / 27

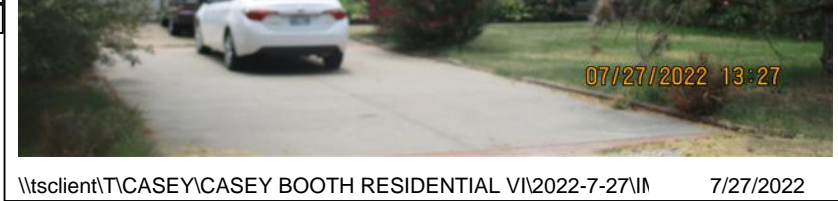

\\tsclient\TCASEY\CASEY BOOTH RESIDENTIAL VI\2022-7-27\ 7/27/2022

GRM Approach	
GRM Code	
Gross Rent	0.00
Indicated Value	

Multiple Regression			
MRA Code	1	Test	
Adjusted R	0.8445		
Indicated Value	249,010	115.60	Per SqFt

Direct Comparables			
Selection Model	A	Adam Test	
Adjustment Model	1	2022 Residential	
Comparables	3		
Indicated Value	342,090		Per SqFt

Value Reconciliation			
Selected Approach	Cost Approach		
Improvements	187,839		
Lot Value	143,492		
Indicated Value	331,331	153.82	Per SqFt
Agland Value			
Site Improvements	6,272		
Total Value	337,603	156.73	Total Value Per SqFt

Cost Approach				Manual : 01/2025			
Base Cost	89.17	Total Misc Impr	+	10,978			
Roofing Adj	+ 3.52	Garage Cost	+	16,679			
Subfloor Adj	+ -1.64	Total RCN	=	270,521			
Heat/Cool Adj	+ 12.64	Depreciation ( 34%)	-	91,977			
Plumbing Adj	+ 9.06	Lump Sums	+	9,295			
Basement Adj	+ 0.00	RCNLD	=	187,839			
Adj Base Cost	= 112.75	Lot Value	+	143,492			
Total Area	x 2,154	Indicated Value	=	331,331			
Adjusted Cost	= 242,864	Value Per SqFt		153.82			

Miscellaneous Improvements								
Code	Description	Sketch ID	Size	Year	Units	Unit Cost	Depr	Value
FPR1	FIREPLACE - RESIDENTIAL 1 STORY	0		1	1	5,615.40		5,615
PRCH	SLAB PORCH - COVERED	56064	34x6		204	26.29		5,363
SOL	Solarium	56065	13x13		169	55.00		9,295



# Rogers

## Assessment Property Record Card for Tax Year 2026

Data provided by LISA DELOZIER County Assessor

Date 04/16/2026

Time 22:01:24

Page 3

### Sketch Image

660022841

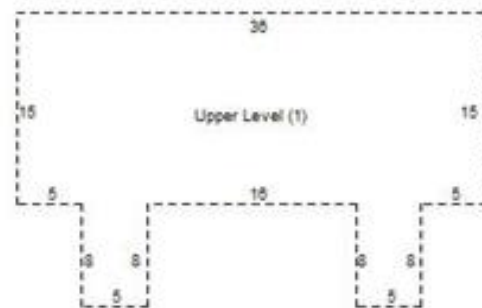
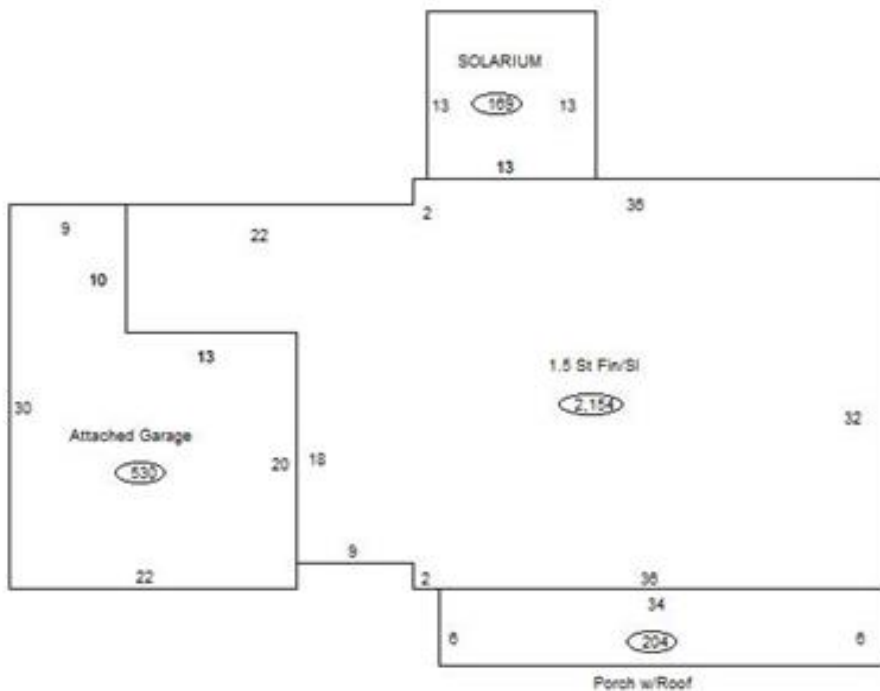

### Sketch Vector Information

Sequence	Code	Type	Built Over	Scale	Section Label	Base Area	Multiplier	Total Area
1	R	5	Slab	13	1.5 St Fin/SI	1,534	1.404	2,154
2	G	1		13	Attached Garage	530	1.000	530
3	M	PRCH		13	SLBC	204	1.000	204
4	M	SOL		13	SOLARIUM	169	1.000	169
5	U	^UL		13	Upper Level (1)	620	1.000	620
<b>Total Building Area</b>						<b>1,534</b>		<b>2,154</b>



# Rogers

## Assessment Property Record Card for Tax Year 2026

Data provided by LISA DELOZIER County Assessor

Date 04/16/2026  
Time 22:01:24  
Page 4

660022841

### Outbuildings/Site Improvements

Building Image	Code	Description	Dimensions	Floor	Roofing	Total Units
	DTGF	DETACHED GARAGE FAIR	0x0x0			560
	Qual 2	Cond 3	Year	Eff Age		
<b>Valuation Summary</b>		<b>Modifier Total</b>	<b>RCN</b>	<b>Depr (30% Phys/ % Func)</b>		<b>RCNLD</b>
Base Cost (16.00 x 560)		8,960		8,960	2,688	6,272