



Rogers

Assessment Property Record Card for Tax Year 2026

Data provided by LISA DELOZIER County Assessor

Date 04/16/2026
Time 21:58:07
Page 1

Assessment Data					Primary Image																																																																																																																				
Account 660022873 Parcel ID 000000-00-0-00192-003-0002 Cadastral ID 27-21-14-02950 Property Type REAL - Real Property Property Class RRP VI Area 4 Tax Area 3 - OWASSO RURAL/NO FIRE Name ID 254698 BURGESS, LEE C & MARISA J-TRUSTEES 7715 N 154TH E AVE OWASSO OK 74055-0000																																																																																																																									
Parcel Location Situs 07715 N 154TH E AVE Subdivision CORNERSTONE ADDITION 4 Lot/Block 0002 / 0003 Parcel Size 1 - Lots Sec/Twn/Rng 27 / 21 / 14 / 5 Neighborhood 1212 - R-V04-SW OWASSO School District S021 - OWASSO SCHOOLS																																																																																																																									
Legal Description Lat/Long: 36.26609028 -95.80149155 LOT 2 BLOCK 3 CORNERSTONE 4					Building Permits <table border="1"> <thead> <tr> <th>Number</th> <th>Description</th> <th>Opened</th> <th>Closed</th> <th>Amount</th> </tr> </thead> <tbody> <tr> <td></td> <td></td> <td></td> <td></td> <td></td> </tr> </tbody> </table>					Number	Description	Opened	Closed	Amount																																																																																																											
Number	Description	Opened	Closed	Amount																																																																																																																					
Exemptions <table border="1"> <thead> <tr> <th>Code</th> <th>Type</th> <th>Active</th> <th>Maximum</th> <th>Exemption</th> </tr> </thead> <tbody> <tr> <td>H</td> <td>Homestead</td> <td>Yes</td> <td>1,000</td> <td>1,000</td> </tr> </tbody> </table>					Code	Type	Active	Maximum	Exemption	H	Homestead	Yes	1,000	1,000	Sale History <table border="1"> <thead> <tr> <th>Bk/Pg</th> <th>Grantor</th> <th>Date</th> <th>Price</th> <th>Code</th> </tr> </thead> <tbody> <tr> <td>894/452</td> <td>DENNY, J B</td> <td>09/24/1992</td> <td>124,500</td> <td>Yes</td> </tr> <tr> <td>882/114</td> <td>CORNERSTONE DEVELOPMENT-INC</td> <td>05/18/1992</td> <td>17,500</td> <td>Yes</td> </tr> </tbody> </table>					Bk/Pg	Grantor	Date	Price	Code	894/452	DENNY, J B	09/24/1992	124,500	Yes	882/114	CORNERSTONE DEVELOPMENT-INC	05/18/1992	17,500	Yes																																																																																							
Code	Type	Active	Maximum	Exemption																																																																																																																					
H	Homestead	Yes	1,000	1,000																																																																																																																					
Bk/Pg	Grantor	Date	Price	Code																																																																																																																					
894/452	DENNY, J B	09/24/1992	124,500	Yes																																																																																																																					
882/114	CORNERSTONE DEVELOPMENT-INC	05/18/1992	17,500	Yes																																																																																																																					
Parcel Valuation <table border="1"> <thead> <tr> <th>Source</th> <th>REAL</th> <th>Fair Cash</th> <th>Capped</th> <th>Asmnt Level</th> <th>Assessed</th> <th>Levy Rate</th> <th>97.960</th> <th>Current Tax</th> </tr> </thead> <tbody> <tr> <td>Remove Cap</td> <td>0</td> <td>Land Value 121,774</td> <td>46,630</td> <td>11%</td> <td>5,129</td> <td>Assessed</td> <td>38,790</td> <td>3,799.87</td> </tr> <tr> <td>Year Frozen</td> <td>0</td> <td>Improvements 347,663</td> <td>306,011</td> <td></td> <td>33,661</td> <td>Penalty</td> <td>0</td> <td></td> </tr> <tr> <td>Uncapped Value</td> <td>0</td> <td>Mobile Home 0</td> <td>0</td> <td></td> <td>0</td> <td>Exemption</td> <td>1,000</td> <td>-98.00</td> </tr> <tr> <td>TIF Project ID</td> <td>0</td> <td>Total Value 469,437</td> <td>352,641</td> <td></td> <td>38,790</td> <td>Total Taxable</td> <td>37,790</td> <td>3,702.00</td> </tr> </tbody> </table>										Source	REAL	Fair Cash	Capped	Asmnt Level	Assessed	Levy Rate	97.960	Current Tax	Remove Cap	0	Land Value 121,774	46,630	11%	5,129	Assessed	38,790	3,799.87	Year Frozen	0	Improvements 347,663	306,011		33,661	Penalty	0		Uncapped Value	0	Mobile Home 0	0		0	Exemption	1,000	-98.00	TIF Project ID	0	Total Value 469,437	352,641		38,790	Total Taxable	37,790	3,702.00																																																																			
Source	REAL	Fair Cash	Capped	Asmnt Level	Assessed	Levy Rate	97.960	Current Tax																																																																																																																	
Remove Cap	0	Land Value 121,774	46,630	11%	5,129	Assessed	38,790	3,799.87																																																																																																																	
Year Frozen	0	Improvements 347,663	306,011		33,661	Penalty	0																																																																																																																		
Uncapped Value	0	Mobile Home 0	0		0	Exemption	1,000	-98.00																																																																																																																	
TIF Project ID	0	Total Value 469,437	352,641		38,790	Total Taxable	37,790	3,702.00																																																																																																																	
Assessment History <table border="1"> <thead> <tr> <th>Tax Year</th> <th>Statement Number</th> <th>Billed Owner</th> <th>Tax Area</th> <th>Total Value</th> <th>Exemptions</th> <th>Taxable Value</th> <th>Billed Tax</th> </tr> </thead> <tbody> <tr><td>2025</td><td>2025-660022873</td><td>BURGESS, LEE C &</td><td>3</td><td>466,605</td><td>1000</td><td>36,661</td><td>3,591.00</td></tr> <tr><td>2024</td><td>2024-660022873</td><td>BURGESS, LEE C &</td><td>3</td><td>482,645</td><td>1000</td><td>35,565</td><td>3,417.00</td></tr> <tr><td>2023</td><td>2023-660022873</td><td>BURGESS, LEE C &</td><td>3</td><td>344,940</td><td>1000</td><td>34,499</td><td>3,233.00</td></tr> <tr><td>2022</td><td>2022-660022873</td><td>BURGESS, LEE C &</td><td>3</td><td>313,320</td><td>1000</td><td>33,465</td><td>3,279.00</td></tr> <tr><td>2021</td><td>2021-660022873</td><td>BURGESS, LEE C &</td><td>3</td><td>306,875</td><td>1000</td><td>32,756</td><td>3,169.00</td></tr> <tr><td>2020</td><td>2020-660022873</td><td>BURGESS, LEE C &</td><td>3</td><td>307,889</td><td>1000</td><td>32,066</td><td>3,098.00</td></tr> <tr><td>2019</td><td>2019-660022873</td><td>BURGESS, LEE C &</td><td>3</td><td>291,841</td><td>1000</td><td>31,103</td><td>3,007.00</td></tr> <tr><td>2018</td><td>2018-660022873</td><td>BURGESS, LEE C &</td><td>3</td><td>301,462</td><td>1000</td><td>32,161</td><td>2,994.00</td></tr> <tr><td>2017</td><td>2017-660022873</td><td>BURGESS, LEE C &</td><td>3</td><td>298,681</td><td>1000</td><td>31,855</td><td>2,996.00</td></tr> <tr><td>2016</td><td>2016-660022873</td><td>BURGESS, LEE C &</td><td>3</td><td>290,687</td><td>1000</td><td>30,976</td><td>2,916.00</td></tr> <tr><td>2015</td><td>2015-660022873</td><td>BURGESS, LEE C &</td><td>3</td><td>282,473</td><td>1000</td><td>30,072</td><td>2,852.00</td></tr> <tr><td>2014</td><td>2014-660022873</td><td>BURGESS, LEE C &</td><td>3</td><td>295,346</td><td>1000</td><td>29,905</td><td>2,863.00</td></tr> <tr><td>2013</td><td>2013-660022873</td><td>BURGESS, LEE C &</td><td>3</td><td>278,773</td><td>1000</td><td>29,005</td><td>2,717.00</td></tr> </tbody> </table>										Tax Year	Statement Number	Billed Owner	Tax Area	Total Value	Exemptions	Taxable Value	Billed Tax	2025	2025-660022873	BURGESS, LEE C &	3	466,605	1000	36,661	3,591.00	2024	2024-660022873	BURGESS, LEE C &	3	482,645	1000	35,565	3,417.00	2023	2023-660022873	BURGESS, LEE C &	3	344,940	1000	34,499	3,233.00	2022	2022-660022873	BURGESS, LEE C &	3	313,320	1000	33,465	3,279.00	2021	2021-660022873	BURGESS, LEE C &	3	306,875	1000	32,756	3,169.00	2020	2020-660022873	BURGESS, LEE C &	3	307,889	1000	32,066	3,098.00	2019	2019-660022873	BURGESS, LEE C &	3	291,841	1000	31,103	3,007.00	2018	2018-660022873	BURGESS, LEE C &	3	301,462	1000	32,161	2,994.00	2017	2017-660022873	BURGESS, LEE C &	3	298,681	1000	31,855	2,996.00	2016	2016-660022873	BURGESS, LEE C &	3	290,687	1000	30,976	2,916.00	2015	2015-660022873	BURGESS, LEE C &	3	282,473	1000	30,072	2,852.00	2014	2014-660022873	BURGESS, LEE C &	3	295,346	1000	29,905	2,863.00	2013	2013-660022873	BURGESS, LEE C &	3	278,773	1000	29,005	2,717.00
Tax Year	Statement Number	Billed Owner	Tax Area	Total Value	Exemptions	Taxable Value	Billed Tax																																																																																																																		
2025	2025-660022873	BURGESS, LEE C &	3	466,605	1000	36,661	3,591.00																																																																																																																		
2024	2024-660022873	BURGESS, LEE C &	3	482,645	1000	35,565	3,417.00																																																																																																																		
2023	2023-660022873	BURGESS, LEE C &	3	344,940	1000	34,499	3,233.00																																																																																																																		
2022	2022-660022873	BURGESS, LEE C &	3	313,320	1000	33,465	3,279.00																																																																																																																		
2021	2021-660022873	BURGESS, LEE C &	3	306,875	1000	32,756	3,169.00																																																																																																																		
2020	2020-660022873	BURGESS, LEE C &	3	307,889	1000	32,066	3,098.00																																																																																																																		
2019	2019-660022873	BURGESS, LEE C &	3	291,841	1000	31,103	3,007.00																																																																																																																		
2018	2018-660022873	BURGESS, LEE C &	3	301,462	1000	32,161	2,994.00																																																																																																																		
2017	2017-660022873	BURGESS, LEE C &	3	298,681	1000	31,855	2,996.00																																																																																																																		
2016	2016-660022873	BURGESS, LEE C &	3	290,687	1000	30,976	2,916.00																																																																																																																		
2015	2015-660022873	BURGESS, LEE C &	3	282,473	1000	30,072	2,852.00																																																																																																																		
2014	2014-660022873	BURGESS, LEE C &	3	295,346	1000	29,905	2,863.00																																																																																																																		
2013	2013-660022873	BURGESS, LEE C &	3	278,773	1000	29,005	2,717.00																																																																																																																		



Rogers

Assessment Property Record Card for Tax Year 2026

Data provided by LISA DELOZIER County Assessor

Date 04/16/2026
Time 21:58:07
Page 2

Lot Data	Square-Foot - NBHD 1212 #1	Primary Image
Lot Size		
Lot Count	1	
Units Buildable	1	
Non-Ag Acres	1.091	
Topography		
Street Access		
Utilities		
Amenities	LAND QUALITY	
	0	
	0	
Method	Square-Foot	
Base Lot Value	47,524.00 x 2.56 = 121,774	
Factor Value		
Adjustments	1.0000	
Lot Value	121,774	

Residential Data	
Type	1 Single Family Residence
Condition	3 - Average
Quality	4 - Good
Architecture	
Style	100% 1 1/2 Story Finished
Exterior Wall	50% Veneer, Masonry 50% Frame, Siding, Wood
Base/Total Area	2,262 / 3,229
Style	100% 1 1/2 Story Finished
HVAC	100% Warmed & Cooled Air
Roof Cover	1 Composition Shingle
Area on Slab	2,262
Fixture/RghIn	16 /
Bed/F/H Bath	4 / 3.5 /
Basement Area	
Garage Type	1,366 Attached Garage - Unfinished
Remodel	
Year/Eff Age	1992 / 26

Cost Approach		Manual : 01/2025	
Base Cost	97.53	Total Misc Impr	+ 29,836
Roofing Adj	+ 4.13	Garage Cost	+ 62,044
Subfloor Adj	+ -3.23	Total RCN	= 491,049
Heat/Cool Adj	+ 16.31	Depreciation (32%)	- 157,136
Plumbing Adj	+ 8.88	Lump Sums	+ 0
Basement Adj	+ 0.00	RCNLD	= 333,913
Adj Base Cost	= 123.62	Lot Value	+ 121,774
Total Area	x 3,229	Indicated Value	= 455,687
Adjusted Cost	= 399,169	Value Per SqFt	141.12

GRM Approach	
GRM Code	
Gross Rent	0.00
Indicated Value	

Multiple Regression			
MRA Code	1	Test	
Adusted R	0.8445		
Indicated Value	491,749	152.29	Per SqFt

Direct Comparables			
Selection Model	A	Adam Test	
Adjustment Model	1	2022 Residential	
Comparables	1		
Indicated Value	187,690		Per SqFt

Value Reconciliation			
Selected Approach	Cost Approach		
Improvements	333,913		
Lot Value	121,774		
Indicated Value	455,687	141.12	Per SqFt
Agland Value			
Site Improvements	13,750		
Total Value	469,437	145.38	Total Value Per SqFt

Miscellaneous Improvements								
Code	Description	Sketch ID	Size	Year	Units	Unit Cost	Depr	Value
FPR1	FIREPLACE - RESIDENTIAL 1 STORY	0		1	1	7,243.87		7,244
PRCH	SLAB PORCH - COVERED	56221		465	465	31.42		14,610
PRCH	SLAB PORCH - COVERED	56222	10x10		100	32.88		3,288
PRCH	SLAB PORCH - COVERED	56226	18x8		144	32.60		4,694



Rogers
Assessment Property Record Card for Tax Year 2026
 Data provided by LISA DELOZIER County Assessor

Date 04/16/2026
 Time 21:58:08
 Page 3

Sketch Image

660022873

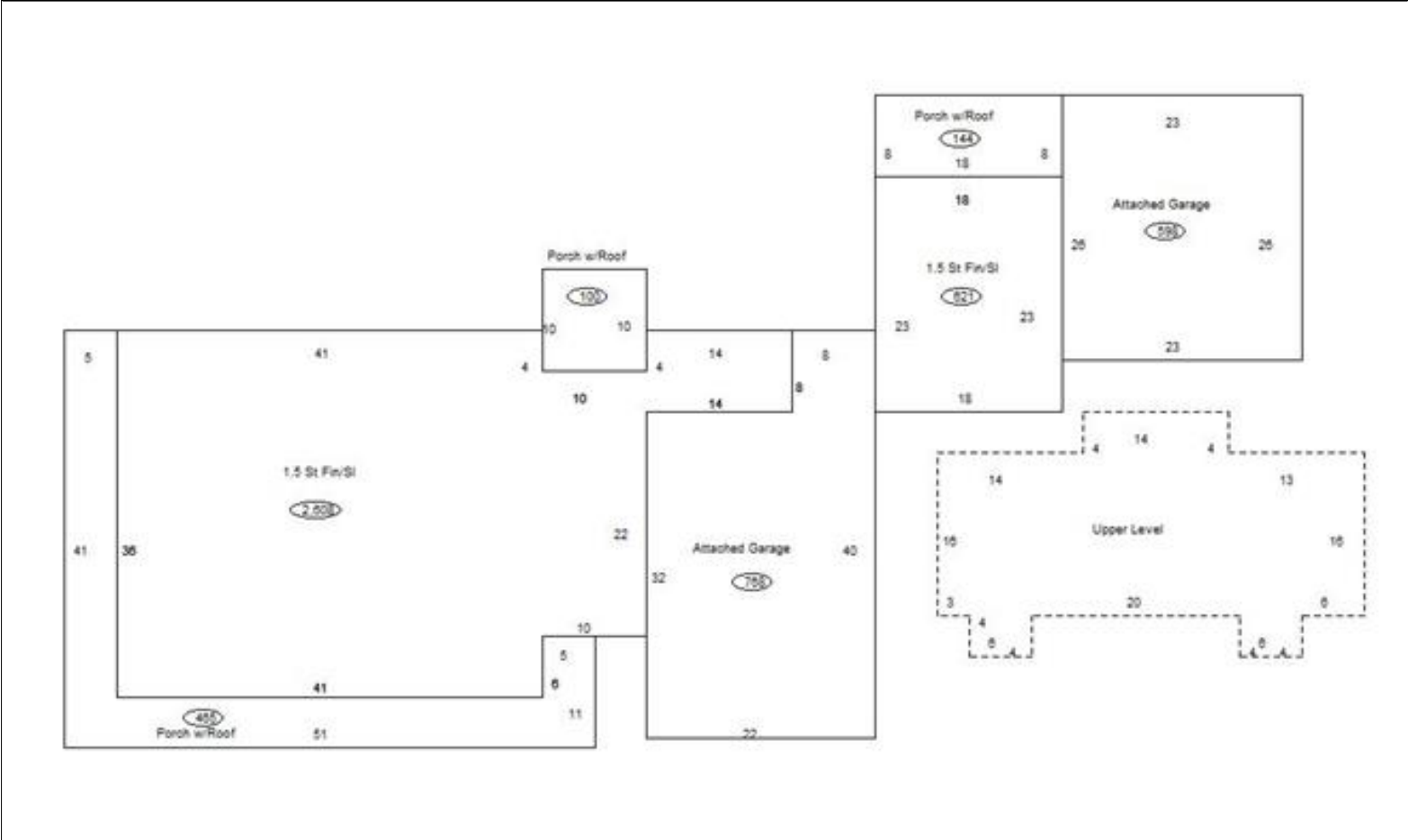

Sketch Vector Information

Sequence	Code	Type	Built Over	Scale	Section Label	Base Area	Multiplier	Total Area
1	R	5	Slab	13	1.5 St Fin/SI	1,848	1.411	2,608
2	G	1		13	Attached Garage	768	1.000	768
3	M	PRCH		13	SLBC	465	1.000	465
4	M	PRCH		13	SLBC	100	1.000	100
5	U	^UL		13	Upper Level	760	1.000	760
6	G	1		13	Attached Garage	598	1.000	598
7	R	5	Slab	13	1.5 St Fin/SI	414	1.500	621
8	M	PRCH		13	SLBC	144	1.000	144
Total Building Area						2,262		3,229



Rogers

Assessment Property Record Card for Tax Year 2026

Data provided by LISA DELOZIER County Assessor

Date 04/16/2026
Time 21:58:08
Page 4

660022873

Outbuildings/Site Improvements

Building Image	Code	Description	Dimensions	Floor	Roofing	Total Units
	SV	SWIM VINYL	0x0x0			1
	Qual	3	Cond 3	Year 1999	Eff Age	
		Valuation Summary	Modifier Total	RCN	Depr (45% Phys/ % Func)	RCNLD
		Base Cost (25,000.00 x 1)	25,000	25,000	11,250	13,750