



Rogers

Assessment Property Record Card for Tax Year 2026

Data provided by LISA DELOZIER County Assessor

Date 04/16/2026
Time 23:10:05
Page 1

Assessment Data					Primary Image																																																																																																																				
Account 660022918 Parcel ID 000000-00-0-00198-004-0001 Cadastral ID 27-21-14-03400 Property Type REAL - Real Property Property Class RRP VI Area 4 Tax Area 3 - OWASSO RURAL/NO FIRE Name ID 320369 BUY, B DALE & CAROLE E 14612 E 77TH ST N OWASSO OK 74055-0000 Parcel Location Situs 14612 77TH STREET Subdivision CORNERSTONE WEST Lot/Block 0001 / 0004 Parcel Size 1 - Lots Sec/Twn/Rng 27 / 21 / 14 / 5 Neighborhood 1212 - R-V04-SW OWASSO School District S021 - OWASSO SCHOOLS																																																																																																																									
Legal Description Lot/Long: 36.26446238 -95.81029177																																																																																																																									
Legal Description LOT 1 BLOCK 4 CORNERSTONE WEST					Building Permits <table border="1"> <thead> <tr> <th>Number</th> <th>Description</th> <th>Opened</th> <th>Closed</th> <th>Amount</th> </tr> </thead> <tbody> <tr> <td> </td> <td> </td> <td> </td> <td> </td> <td> </td> </tr> </tbody> </table>					Number	Description	Opened	Closed	Amount																																																																																																											
Number	Description	Opened	Closed	Amount																																																																																																																					
Exemptions <table border="1"> <thead> <tr> <th>Code</th> <th>Type</th> <th>Active</th> <th>Maximum</th> <th>Exemption</th> </tr> </thead> <tbody> <tr> <td>H</td> <td>Homestead</td> <td>Yes</td> <td>1,000</td> <td>1,000</td> </tr> <tr> <td>H</td> <td>Homestead</td> <td>No</td> <td>1,000</td> <td> </td> </tr> </tbody> </table>					Code	Type	Active	Maximum	Exemption	H	Homestead	Yes	1,000	1,000	H	Homestead	No	1,000		Sale History <table border="1"> <thead> <tr> <th>Bk/Pg</th> <th>Grantor</th> <th>Date</th> <th>Price</th> <th>Code</th> </tr> </thead> <tbody> <tr> <td>2602/855</td> <td>SCHAFFER, JEFFREY R &</td> <td>12/13/2016</td> <td>242,000</td> <td>YES</td> </tr> <tr> <td>1077/681</td> <td>MORTON HOMES, INC</td> <td>08/13/1997</td> <td>145,013</td> <td>Yes</td> </tr> <tr> <td>1058/559</td> <td>SOKOLOSKY, D M &</td> <td>03/13/1997</td> <td>20,500</td> <td>No</td> </tr> </tbody> </table>					Bk/Pg	Grantor	Date	Price	Code	2602/855	SCHAFFER, JEFFREY R &	12/13/2016	242,000	YES	1077/681	MORTON HOMES, INC	08/13/1997	145,013	Yes	1058/559	SOKOLOSKY, D M &	03/13/1997	20,500	No																																																																													
Code	Type	Active	Maximum	Exemption																																																																																																																					
H	Homestead	Yes	1,000	1,000																																																																																																																					
H	Homestead	No	1,000																																																																																																																						
Bk/Pg	Grantor	Date	Price	Code																																																																																																																					
2602/855	SCHAFFER, JEFFREY R &	12/13/2016	242,000	YES																																																																																																																					
1077/681	MORTON HOMES, INC	08/13/1997	145,013	Yes																																																																																																																					
1058/559	SOKOLOSKY, D M &	03/13/1997	20,500	No																																																																																																																					
Parcel Valuation <table border="1"> <thead> <tr> <th>Source</th> <th>REAL</th> <th>Fair Cash</th> <th>Capped</th> <th>Asmnt Level</th> <th>Assessed</th> <th>Levy Rate</th> <th>97.960</th> <th>Current Tax</th> </tr> </thead> <tbody> <tr> <td>Remove Cap</td> <td>2017</td> <td>Land Value</td> <td>118,478</td> <td>51,939</td> <td>11%</td> <td>5,713</td> <td>Assessed</td> <td>31,391 3,075.06</td> </tr> <tr> <td>Year Frozen</td> <td>0</td> <td>Improvements</td> <td>257,368</td> <td>233,433</td> <td> </td> <td>25,678</td> <td>Penalty</td> <td>0</td> </tr> <tr> <td>Uncapped Value</td> <td>0</td> <td>Mobile Home</td> <td>0</td> <td>0</td> <td> </td> <td>0</td> <td>Exemption</td> <td>1,000 -98.00</td> </tr> <tr> <td>TIF Project ID</td> <td>0</td> <td>Total Value</td> <td>375,846</td> <td>285,372</td> <td> </td> <td>31,391</td> <td>Total Taxable</td> <td>30,391 2,977.00</td> </tr> </tbody> </table>										Source	REAL	Fair Cash	Capped	Asmnt Level	Assessed	Levy Rate	97.960	Current Tax	Remove Cap	2017	Land Value	118,478	51,939	11%	5,713	Assessed	31,391 3,075.06	Year Frozen	0	Improvements	257,368	233,433		25,678	Penalty	0	Uncapped Value	0	Mobile Home	0	0		0	Exemption	1,000 -98.00	TIF Project ID	0	Total Value	375,846	285,372		31,391	Total Taxable	30,391 2,977.00																																																																			
Source	REAL	Fair Cash	Capped	Asmnt Level	Assessed	Levy Rate	97.960	Current Tax																																																																																																																	
Remove Cap	2017	Land Value	118,478	51,939	11%	5,713	Assessed	31,391 3,075.06																																																																																																																	
Year Frozen	0	Improvements	257,368	233,433		25,678	Penalty	0																																																																																																																	
Uncapped Value	0	Mobile Home	0	0		0	Exemption	1,000 -98.00																																																																																																																	
TIF Project ID	0	Total Value	375,846	285,372		31,391	Total Taxable	30,391 2,977.00																																																																																																																	
Assessment History <table border="1"> <thead> <tr> <th>Tax Year</th> <th>Statement Number</th> <th>Billed Owner</th> <th>Tax Area</th> <th>Total Value</th> <th>Exemptions</th> <th>Taxable Value</th> <th>Billed Tax</th> </tr> </thead> <tbody> <tr><td>2025</td><td>2025-660022918</td><td>BUY, B DALE & CAROLE E</td><td>3</td><td>372,930</td><td>1000</td><td>29,477</td><td>2,888.00</td></tr> <tr><td>2024</td><td>2024-660022918</td><td>BUY, B DALE & CAROLE E</td><td>3</td><td>390,652</td><td>1000</td><td>28,589</td><td>2,747.00</td></tr> <tr><td>2023</td><td>2023-660022918</td><td>BUY, B DALE & CAROLE E</td><td>3</td><td>261,158</td><td>1000</td><td>27,728</td><td>2,598.00</td></tr> <tr><td>2022</td><td>2022-660022918</td><td>BUY, B DALE & CAROLE E</td><td>3</td><td>263,963</td><td>1000</td><td>27,701</td><td>2,714.00</td></tr> <tr><td>2021</td><td>2021-660022918</td><td>BUY, B DALE & CAROLE E</td><td>3</td><td>253,314</td><td>1000</td><td>26,865</td><td>2,599.00</td></tr> <tr><td>2020</td><td>2020-660022918</td><td>BUY, B DALE & CAROLE E</td><td>3</td><td>249,344</td><td>1000</td><td>26,160</td><td>2,527.00</td></tr> <tr><td>2019</td><td>2019-660022918</td><td>BUY, B DALE & CAROLE E</td><td>3</td><td>239,714</td><td>1000</td><td>25,369</td><td>2,452.00</td></tr> <tr><td>2018</td><td>2018-660022918</td><td>BUY, B DALE & CAROLE E</td><td>3</td><td>245,956</td><td>1000</td><td>26,056</td><td>2,425.00</td></tr> <tr><td>2017</td><td>2017-660022918</td><td>BUY, B DALE & CAROLE E</td><td>3</td><td>244,017</td><td>1000</td><td>25,842</td><td>2,431.00</td></tr> <tr><td>2016</td><td>2016-660022918</td><td>SCHAFFER, JEFFREY R &</td><td>3</td><td>215,736</td><td>1000</td><td>22,698</td><td>2,137.00</td></tr> <tr><td>2015</td><td>2015-660022918</td><td>SCHAFFER, JEFFREY R &</td><td>3</td><td>209,163</td><td>1000</td><td>22,008</td><td>2,087.00</td></tr> <tr><td>2014</td><td>2014-660022918</td><td>SCHAFFER, JEFFREY R &</td><td>3</td><td>210,819</td><td>1000</td><td>21,520</td><td>2,060.00</td></tr> <tr><td>2013</td><td>2013-660022918</td><td>SCHAFFER, JEFFREY R &</td><td>3</td><td>198,763</td><td>1000</td><td>20,864</td><td>1,955.00</td></tr> </tbody> </table>										Tax Year	Statement Number	Billed Owner	Tax Area	Total Value	Exemptions	Taxable Value	Billed Tax	2025	2025-660022918	BUY, B DALE & CAROLE E	3	372,930	1000	29,477	2,888.00	2024	2024-660022918	BUY, B DALE & CAROLE E	3	390,652	1000	28,589	2,747.00	2023	2023-660022918	BUY, B DALE & CAROLE E	3	261,158	1000	27,728	2,598.00	2022	2022-660022918	BUY, B DALE & CAROLE E	3	263,963	1000	27,701	2,714.00	2021	2021-660022918	BUY, B DALE & CAROLE E	3	253,314	1000	26,865	2,599.00	2020	2020-660022918	BUY, B DALE & CAROLE E	3	249,344	1000	26,160	2,527.00	2019	2019-660022918	BUY, B DALE & CAROLE E	3	239,714	1000	25,369	2,452.00	2018	2018-660022918	BUY, B DALE & CAROLE E	3	245,956	1000	26,056	2,425.00	2017	2017-660022918	BUY, B DALE & CAROLE E	3	244,017	1000	25,842	2,431.00	2016	2016-660022918	SCHAFFER, JEFFREY R &	3	215,736	1000	22,698	2,137.00	2015	2015-660022918	SCHAFFER, JEFFREY R &	3	209,163	1000	22,008	2,087.00	2014	2014-660022918	SCHAFFER, JEFFREY R &	3	210,819	1000	21,520	2,060.00	2013	2013-660022918	SCHAFFER, JEFFREY R &	3	198,763	1000	20,864	1,955.00
Tax Year	Statement Number	Billed Owner	Tax Area	Total Value	Exemptions	Taxable Value	Billed Tax																																																																																																																		
2025	2025-660022918	BUY, B DALE & CAROLE E	3	372,930	1000	29,477	2,888.00																																																																																																																		
2024	2024-660022918	BUY, B DALE & CAROLE E	3	390,652	1000	28,589	2,747.00																																																																																																																		
2023	2023-660022918	BUY, B DALE & CAROLE E	3	261,158	1000	27,728	2,598.00																																																																																																																		
2022	2022-660022918	BUY, B DALE & CAROLE E	3	263,963	1000	27,701	2,714.00																																																																																																																		
2021	2021-660022918	BUY, B DALE & CAROLE E	3	253,314	1000	26,865	2,599.00																																																																																																																		
2020	2020-660022918	BUY, B DALE & CAROLE E	3	249,344	1000	26,160	2,527.00																																																																																																																		
2019	2019-660022918	BUY, B DALE & CAROLE E	3	239,714	1000	25,369	2,452.00																																																																																																																		
2018	2018-660022918	BUY, B DALE & CAROLE E	3	245,956	1000	26,056	2,425.00																																																																																																																		
2017	2017-660022918	BUY, B DALE & CAROLE E	3	244,017	1000	25,842	2,431.00																																																																																																																		
2016	2016-660022918	SCHAFFER, JEFFREY R &	3	215,736	1000	22,698	2,137.00																																																																																																																		
2015	2015-660022918	SCHAFFER, JEFFREY R &	3	209,163	1000	22,008	2,087.00																																																																																																																		
2014	2014-660022918	SCHAFFER, JEFFREY R &	3	210,819	1000	21,520	2,060.00																																																																																																																		
2013	2013-660022918	SCHAFFER, JEFFREY R &	3	198,763	1000	20,864	1,955.00																																																																																																																		



Rogers

Assessment Property Record Card for Tax Year 2026

Data provided by LISA DELOZIER County Assessor

Date 04/16/2026
Time 23:10:05
Page 2

Lot Data	Square-Foot - NBHD 1212 #1	Primary Image
Lot Size Lot Count Units Buildable 1 Non-Ag Acres 1.019 Topography Street Access Utilities Amenities LAND QUALITY 0 0 Method Square-Foot Base Lot Value 44,385.00 x 2.67 = 118,478 Factor Value Adjustments 1.0000 Lot Value 118,478		

Residential Data	
Type	1 Single Family Residence
Condition	3 - Average
Quality	3.5 - Average
Architecture	
Style	100% One Story
Exterior Wall	100% Veneer, Masonry
Base/Total Area	2,163 / 2,163
Style	100% One Story
HVAC	100% Warmed & Cooled Air
Roof Cover	1 Composition Shingle
Area on Slab	2,163
Fixture/RghIn	14 /
Bed/F/H Bath	3 / 2.5 /
Basement Area	
Garage Type	940 Attached Garage - Unfinished
Remodel	
Year/Eff Age	1997 / 22



\\tsclient\TCASEY\CASEY BOOTH RESIDENTIAL VI\2022-7-26\ 7/26/2022

GRM Approach	
GRM Code	
Gross Rent	0.00
Indicated Value	

Multiple Regression			
MRA Code	1	Test	
Adjusted R	0.8445		
Indicated Value	314,499	145.40	Per SqFt

Direct Comparables			
Selection Model	A	Adam Test	
Adjustment Model	1	2022 Residential	
Comparables	3		
Indicated Value	341,640		Per SqFt

Cost Approach				Manual : 01/2025	
Base Cost	110.83	Total Misc Impr	+	15,361	
Roofing Adj	+ 5.28	Garage Cost	+	34,977	
Subfloor Adj	+ -3.40	Total RCN	=	347,794	
Heat/Cool Adj	+ 14.47	Depreciation (26%)	-	90,426	
Plumbing Adj	+ 10.34	Lump Sums	+	0	
Basement Adj	+ 0.00	RCNLD	=	257,368	
Adj Base Cost	= 137.52	Lot Value	+	118,478	
Total Area	x 2,163	Indicated Value	=	375,846	
Adjusted Cost	= 297,456	Value Per SqFt		173.76	

Value Reconciliation			
Selected Approach	Cost Approach		
Improvements	257,368		
Lot Value	118,478		
Indicated Value	375,846	173.76	Per SqFt
Agland Value			
Site Improvements			
Total Value	375,846	173.76	Total Value Per SqFt

Miscellaneous Improvements								
Code	Description	Sketch ID	Size	Year	Units	Unit Cost	Depr	Value
FPR1	FIREPLACE - RESIDENTIAL 1 STORY	0		1	1	6,429.63		6,430
PRCH	SLAB PORCH - COVERED	56445	5x5		25	29.45		736
PRCH	SLAB PORCH - COVERED	56446	271		271	28.57		7,742
PATO	SLAB PORCH - OPEN	56447	7x5		35	12.93		453



Rogers
Assessment Property Record Card for Tax Year 2026

Data provided by LISA DELOZIER County Assessor

Date 04/16/2026
 Time 23:10:05
 Page 3

Sketch Image

660022918

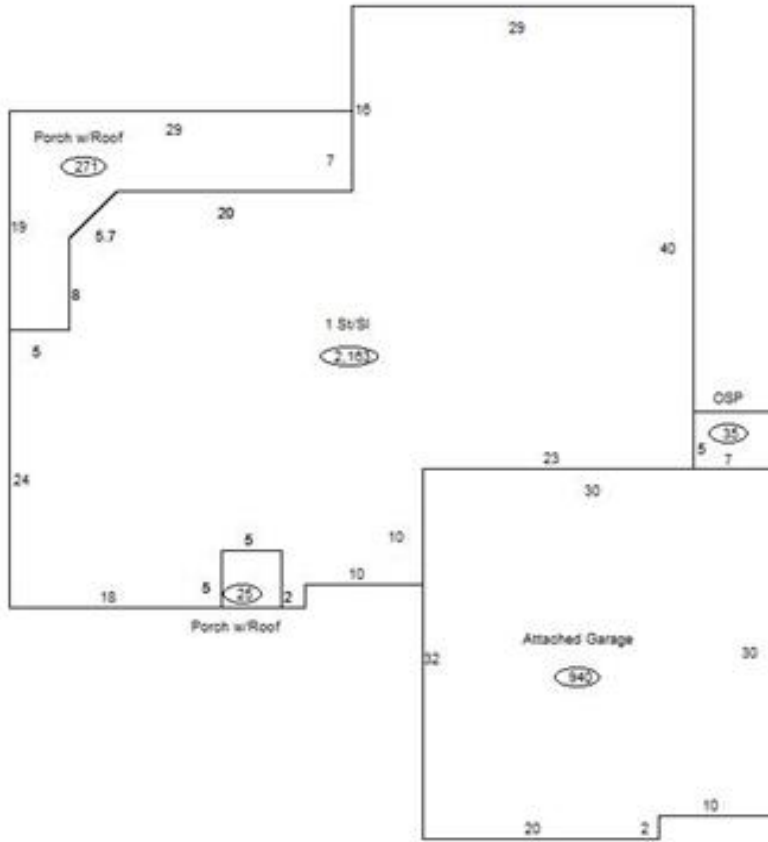

Sketch Vector Information

Sequence	Code	Type	Built Over	Scale	Section Label	Base Area	Multiplier	Total Area
1	R	1	Slab	13	1 St/Sl	2,163	1.000	2,163
2	G	1		13	Attached Garage	940	1.000	940
3	M	PRCH		13	SLBC	25	1.000	25
4	M	PRCH		13	SLBC	271	1.000	271
5	M	PATO		13	Open Slab	35	1.000	35
Total Building Area						2,163		2,163



Rogers

Assessment Property Record Card for Tax Year 2026

Data provided by LISA DELOZIER County Assessor

Date 04/16/2026
Time 23:10:05
Page 4

660022918

Outbuildings/Site Improvements

Building Image	Code	Description	Dimensions	Floor	Roofing	Total Units
	STF	STG FAIR	12x24x0			288
	Qual	2	Cond 3	Year	Eff Age 1520	
		Valuation Summary	Modifier Total	RCN	Depr (100% Phys/ % Func)	RCNLD
		Base Cost (4.68 x 288)	1,348		1,348	1,348