



# Rogers

## Assessment Property Record Card for Tax Year 2026

Data provided by LISA DELOZIER County Assessor

Date 04/17/2026  
 Time 00:42:58  
 Page 1

Assessment Data					Primary Image																																																																																																																				
<b>Account</b> 660023023 <b>Parcel ID</b> 21N16E-27-1-00000-000-0000 <b>Cadastral ID</b> 27-21-16-01900 <b>Property Type</b> REAL - Real Property <b>Property Class</b> RR VI Area 1 <b>Tax Area</b> 5 - JUSTUS RURAL/NO FIRE <b>Name ID</b> 273111 WASHINGTON, SHERRI  13956 E 510 RD CLAREMORE OK 74019-0000  <b>Parcel Location</b> <b>Situs</b> 13956 E 510 RD <b>Subdivision</b> <b>Lot/Block</b> / <b>Parcel Size</b> 10.21 - Acres <b>Sec/Twn/Rng</b> 27 / 21 / 16 / 1 <b>Neighborhood</b> 2116 - UNPLATTED <b>School District</b> S009 - JUSTUS-TIAWAH SCHOOLS					<p>\\tsclient\T\TOMMY DUNLAP\New folder (137)\IMG_0001.JPG 1/26/2023</p>																																																																																																																				
<b>Legal Description</b> Lat/Long: 36.27653952 -95.57979843 NE NE E OF RY, LESS N 209', E 209' NE NE, & LESS TR BEG: 408' W NE/C NE, S 209', W 153' S 601.24', N 43-07 W 1118.22' ALG RR ROW TO N/L NE, E 919.48 TO POB																																																																																																																									
<b>Exemptions</b>					<b>Building Permits</b>																																																																																																																				
<table border="1"> <thead> <tr> <th>Code</th> <th>Type</th> <th>Active</th> <th>Maximum</th> <th>Exemption</th> </tr> </thead> <tbody> <tr> <td></td> <td></td> <td></td> <td></td> <td></td> </tr> </tbody> </table>					Code	Type	Active	Maximum	Exemption						<table border="1"> <thead> <tr> <th>Number</th> <th>Description</th> <th>Opened</th> <th>Closed</th> <th>Amount</th> </tr> </thead> <tbody> <tr> <td></td> <td></td> <td></td> <td></td> <td></td> </tr> </tbody> </table>					Number	Description	Opened	Closed	Amount																																																																																																	
Code	Type	Active	Maximum	Exemption																																																																																																																					
Number	Description	Opened	Closed	Amount																																																																																																																					
<table border="1"> <thead> <tr> <th>Code</th> <th>Type</th> <th>Active</th> <th>Maximum</th> <th>Exemption</th> </tr> </thead> <tbody> <tr> <td></td> <td></td> <td></td> <td></td> <td></td> </tr> </tbody> </table>					Code	Type	Active	Maximum	Exemption						<b>Sale History</b> <table border="1"> <thead> <tr> <th>Bk/Pg</th> <th>Grantor</th> <th>Date</th> <th>Price</th> <th>Code</th> </tr> </thead> <tbody> <tr> <td>1210/649</td> <td>WASHINGTON, WAYNE &amp;</td> <td>01/21/2000</td> <td>0</td> <td>No</td> </tr> <tr> <td>959/60</td> <td>KNIGHT, JANA KAY</td> <td>06/08/1994</td> <td>22,000</td> <td>Yes</td> </tr> <tr> <td>953/583</td> <td>KNIGHT, TROY LEONARD</td> <td>03/25/1994</td> <td>0</td> <td>No</td> </tr> </tbody> </table>					Bk/Pg	Grantor	Date	Price	Code	1210/649	WASHINGTON, WAYNE &	01/21/2000	0	No	959/60	KNIGHT, JANA KAY	06/08/1994	22,000	Yes	953/583	KNIGHT, TROY LEONARD	03/25/1994	0	No																																																																																		
Code	Type	Active	Maximum	Exemption																																																																																																																					
Bk/Pg	Grantor	Date	Price	Code																																																																																																																					
1210/649	WASHINGTON, WAYNE &	01/21/2000	0	No																																																																																																																					
959/60	KNIGHT, JANA KAY	06/08/1994	22,000	Yes																																																																																																																					
953/583	KNIGHT, TROY LEONARD	03/25/1994	0	No																																																																																																																					
<b>Parcel Valuation</b> <table border="1"> <thead> <tr> <th>Source</th> <th>REAL</th> <th>Fair Cash</th> <th>Capped</th> <th>Asmnt Level</th> <th>Assessed</th> <th>Levy Rate</th> <th>83.050</th> <th>Current Tax</th> </tr> </thead> <tbody> <tr> <td>Remove Cap</td> <td>2001</td> <td>Land Value 149,927</td> <td>81,661</td> <td>11%</td> <td>8,983</td> <td>Assessed</td> <td>13,236</td> <td>1,099.25</td> </tr> <tr> <td>Year Frozen</td> <td>0</td> <td>Improvements 43,594</td> <td>38,662</td> <td></td> <td>4,253</td> <td>Penalty</td> <td>0</td> <td></td> </tr> <tr> <td>Uncapped Value</td> <td>0</td> <td>Mobile Home 0</td> <td>0</td> <td></td> <td>0</td> <td>Exemption</td> <td>0</td> <td>0.00</td> </tr> <tr> <td>TIF Project ID</td> <td>0</td> <td>Total Value 193,521</td> <td>120,323</td> <td></td> <td>13,236</td> <td>Total Taxable</td> <td>13,236</td> <td>1,099.00</td> </tr> </tbody> </table>										Source	REAL	Fair Cash	Capped	Asmnt Level	Assessed	Levy Rate	83.050	Current Tax	Remove Cap	2001	Land Value 149,927	81,661	11%	8,983	Assessed	13,236	1,099.25	Year Frozen	0	Improvements 43,594	38,662		4,253	Penalty	0		Uncapped Value	0	Mobile Home 0	0		0	Exemption	0	0.00	TIF Project ID	0	Total Value 193,521	120,323		13,236	Total Taxable	13,236	1,099.00																																																																			
Source	REAL	Fair Cash	Capped	Asmnt Level	Assessed	Levy Rate	83.050	Current Tax																																																																																																																	
Remove Cap	2001	Land Value 149,927	81,661	11%	8,983	Assessed	13,236	1,099.25																																																																																																																	
Year Frozen	0	Improvements 43,594	38,662		4,253	Penalty	0																																																																																																																		
Uncapped Value	0	Mobile Home 0	0		0	Exemption	0	0.00																																																																																																																	
TIF Project ID	0	Total Value 193,521	120,323		13,236	Total Taxable	13,236	1,099.00																																																																																																																	
<b>Assessment History</b> <table border="1"> <thead> <tr> <th>Tax Year</th> <th>Statement Number</th> <th>Billed Owner</th> <th>Tax Area</th> <th>Total Value</th> <th>Exemptions</th> <th>Taxable Value</th> <th>Billed Tax</th> </tr> </thead> <tbody> <tr><td>2025</td><td>2025-660023023</td><td>WASHINGTON, SHERRI</td><td>5</td><td>191,298</td><td>0</td><td>12,605</td><td>1,047.00</td></tr> <tr><td>2024</td><td>2024-660023023</td><td>WASHINGTON, SHERRI</td><td>5</td><td>194,392</td><td>0</td><td>12,006</td><td>1,002.00</td></tr> <tr><td>2023</td><td>2023-660023023</td><td>WASHINGTON, SHERRI</td><td>5</td><td>103,941</td><td>0</td><td>11,434</td><td>952.00</td></tr> <tr><td>2022</td><td>2022-660023023</td><td>WASHINGTON, SHERRI</td><td>5</td><td>104,826</td><td>0</td><td>11,531</td><td>959.00</td></tr> <tr><td>2021</td><td>2021-660023023</td><td>WASHINGTON, SHERRI</td><td>5</td><td>102,622</td><td>0</td><td>11,288</td><td>958.00</td></tr> <tr><td>2020</td><td>2020-660023023</td><td>WASHINGTON, SHERRI</td><td>5</td><td>98,832</td><td>0</td><td>10,871</td><td>920.00</td></tr> <tr><td>2019</td><td>2019-660023023</td><td>WASHINGTON, SHERRI</td><td>5</td><td>104,650</td><td>0</td><td>11,511</td><td>997.00</td></tr> <tr><td>2018</td><td>2018-660023023</td><td>WASHINGTON, SHERRI</td><td>5</td><td>109,438</td><td>0</td><td>12,038</td><td>1,044.00</td></tr> <tr><td>2017</td><td>2017-660023023</td><td>WASHINGTON, SHERRI</td><td>5</td><td>108,782</td><td>0</td><td>11,966</td><td>976.00</td></tr> <tr><td>2016</td><td>2016-660023023</td><td>WASHINGTON, SHERRI</td><td>5</td><td>107,661</td><td>0</td><td>11,462</td><td>978.00</td></tr> <tr><td>2015</td><td>2015-660023023</td><td>WASHINGTON, SHERRI</td><td>5</td><td>99,242</td><td>0</td><td>10,916</td><td>922.00</td></tr> <tr><td>2014</td><td>2014-660023023</td><td>WASHINGTON, SHERRI</td><td>5</td><td>101,452</td><td>0</td><td>10,788</td><td>926.00</td></tr> <tr><td>2013</td><td>2013-660023023</td><td>WASHINGTON, SHERRI</td><td>5</td><td>100,713</td><td>0</td><td>10,275</td><td>895.00</td></tr> </tbody> </table>										Tax Year	Statement Number	Billed Owner	Tax Area	Total Value	Exemptions	Taxable Value	Billed Tax	2025	2025-660023023	WASHINGTON, SHERRI	5	191,298	0	12,605	1,047.00	2024	2024-660023023	WASHINGTON, SHERRI	5	194,392	0	12,006	1,002.00	2023	2023-660023023	WASHINGTON, SHERRI	5	103,941	0	11,434	952.00	2022	2022-660023023	WASHINGTON, SHERRI	5	104,826	0	11,531	959.00	2021	2021-660023023	WASHINGTON, SHERRI	5	102,622	0	11,288	958.00	2020	2020-660023023	WASHINGTON, SHERRI	5	98,832	0	10,871	920.00	2019	2019-660023023	WASHINGTON, SHERRI	5	104,650	0	11,511	997.00	2018	2018-660023023	WASHINGTON, SHERRI	5	109,438	0	12,038	1,044.00	2017	2017-660023023	WASHINGTON, SHERRI	5	108,782	0	11,966	976.00	2016	2016-660023023	WASHINGTON, SHERRI	5	107,661	0	11,462	978.00	2015	2015-660023023	WASHINGTON, SHERRI	5	99,242	0	10,916	922.00	2014	2014-660023023	WASHINGTON, SHERRI	5	101,452	0	10,788	926.00	2013	2013-660023023	WASHINGTON, SHERRI	5	100,713	0	10,275	895.00
Tax Year	Statement Number	Billed Owner	Tax Area	Total Value	Exemptions	Taxable Value	Billed Tax																																																																																																																		
2025	2025-660023023	WASHINGTON, SHERRI	5	191,298	0	12,605	1,047.00																																																																																																																		
2024	2024-660023023	WASHINGTON, SHERRI	5	194,392	0	12,006	1,002.00																																																																																																																		
2023	2023-660023023	WASHINGTON, SHERRI	5	103,941	0	11,434	952.00																																																																																																																		
2022	2022-660023023	WASHINGTON, SHERRI	5	104,826	0	11,531	959.00																																																																																																																		
2021	2021-660023023	WASHINGTON, SHERRI	5	102,622	0	11,288	958.00																																																																																																																		
2020	2020-660023023	WASHINGTON, SHERRI	5	98,832	0	10,871	920.00																																																																																																																		
2019	2019-660023023	WASHINGTON, SHERRI	5	104,650	0	11,511	997.00																																																																																																																		
2018	2018-660023023	WASHINGTON, SHERRI	5	109,438	0	12,038	1,044.00																																																																																																																		
2017	2017-660023023	WASHINGTON, SHERRI	5	108,782	0	11,966	976.00																																																																																																																		
2016	2016-660023023	WASHINGTON, SHERRI	5	107,661	0	11,462	978.00																																																																																																																		
2015	2015-660023023	WASHINGTON, SHERRI	5	99,242	0	10,916	922.00																																																																																																																		
2014	2014-660023023	WASHINGTON, SHERRI	5	101,452	0	10,788	926.00																																																																																																																		
2013	2013-660023023	WASHINGTON, SHERRI	5	100,713	0	10,275	895.00																																																																																																																		



# Rogers

## Assessment Property Record Card for Tax Year 2026

Data provided by LISA DELOZIER County Assessor

Date 04/17/2026  
 Time 00:42:58  
 Page 2

Lot Data		Square-Foot - NBHD 2116 #1	
Lot Size			
Lot Count			
Units Buildable	1		
Non-Ag Acres	12.6093		
Topography			
Street Access			
Utilities			
Amenities	LAND QUALITY	0	0
Method	Square-Foot		
Base Lot Value	549,259.00 x .27 = 149,927		
Factor Value			
Adjustments	1.0000		
Lot Value	149,927		

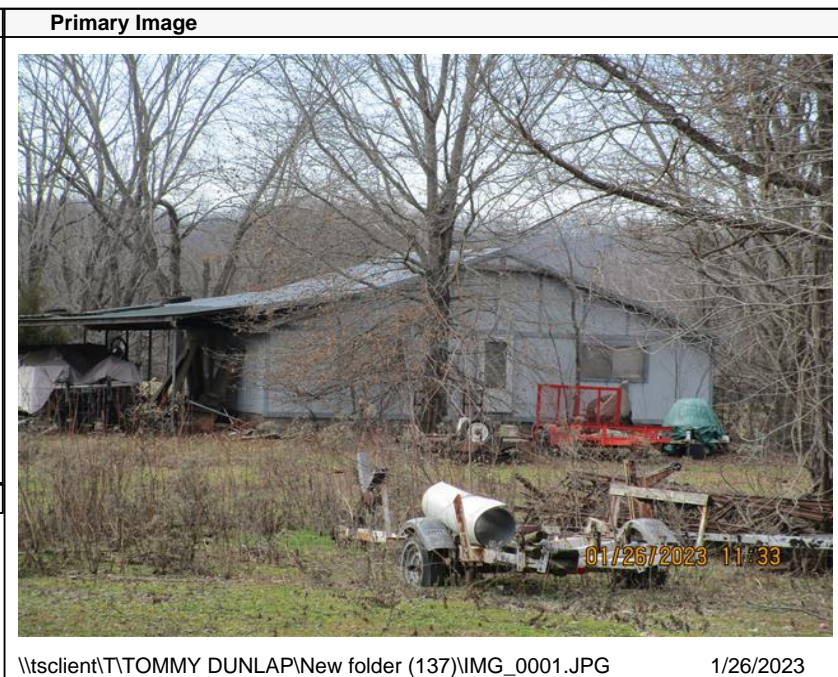

\\tsclient\T\TOMMY DUNLAP\New folder (137)\IMG\_0001.JPG 1/26/2023

Residential Data	
Type	1 Single Family Residence
Condition	1 - Low
Quality	1.5 - Low
Architecture	
Style	100% One Story
Exterior Wall	100% Frame, Siding, Wood
Base/Total Area	960 / 960
Style	100% One Story
HVAC	100% Warmed & Cooled Air
Roof Cover	1 Composition Shingle
Area on Slab	0
Fixture/RghIn	7 /
Bed/F/H Bath	2 / 1.5 /
Basement Area	
Garage Type	
Remodel	
Year/Eff Age	1985 / 57

### GRM Approach

GRM Code	
Gross Rent	0.00
Indicated Value	

### Multiple Regression

MRA Code	1 Test
Adusted R	0.8445
Indicated Value	71,467 74.44 Per SqFt

### Direct Comparables

Selection Model	A Adam Test
Adjustment Model	NewTest
Comparables	
Indicated Value	

### Value Reconciliation

Selected Approach	Cost Approach
Improvements	39,076
Lot Value	149,927
Indicated Value	189,003 196.88 Per SqFt
Agland Value	
Site Improvements	4,518
Total Value	193,521 201.58 Total Value Per SqFt

Cost Approach		Manual : 01/2025	
Base Cost	89.38	Total Misc Impr	+ 2,110
Roofing Adj	+ 4.11	Garage Cost	+ 0
Subfloor Adj	+ 2.44	Total RCN	= 111,646
Heat/Cool Adj	+ 9.89	Depreciation ( 65%)	- 72,570
Plumbing Adj	+ 8.28	Lump Sums	+ 0
Basement Adj	+ 0.00	RCNLD	= 39,076
Adj Base Cost	= 114.10	Lot Value	+ 149,927
Total Area	x 960	Indicated Value	= 189,003
Adjusted Cost	= 109,536	Value Per SqFt	196.88

### Miscellaneous Improvements

Code	Description	Sketch ID	Size	Year	Units	Unit Cost	Depr	Value
LTP	LEAN-TO PORCH	125771	30x24		720	2.93		2,110



# Rogers

## Assessment Property Record Card for Tax Year 2026

Data provided by LISA DELOZIER County Assessor

Date 04/17/2026

Time 00:42:58

Page 3

### Sketch Image

660023023

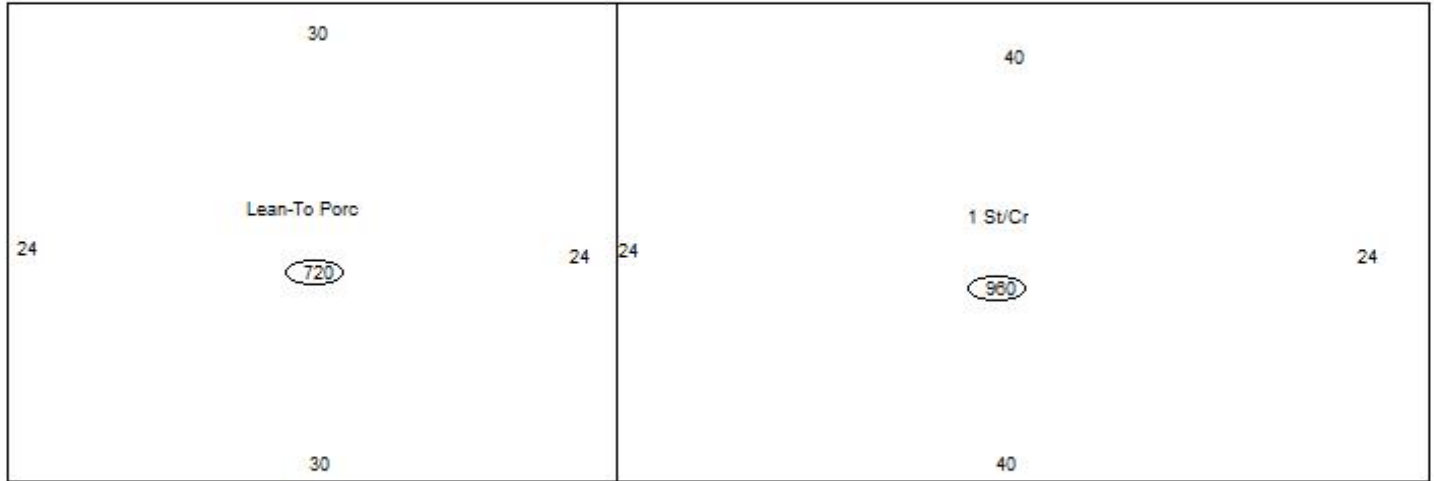

### Sketch Vector Information

Sequence	Code	Type	Built Over	Scale	Section Label	Base Area	Multiplier	Total Area
1	R	1	Crawl	10	1 St/Cr	960	1.000	960
2	M	LTP		10	Lean-To Porc	720	1.000	720
<b>Total Building Area</b>						960		960



# Rogers

## Assessment Property Record Card for Tax Year 2026

Data provided by LISA DELOZIER County Assessor

Date 04/17/2026  
 Time 00:42:58  
 Page 4

660023023

### Outbuildings/Site Improvements

Building Image	Code	Description	Dimensions	Floor	Roofing	Total Units
	BARN BARN Qual 3	Cond 3	Year	0x0x0	Eff Age	660
<b>Valuation Summary</b>		<b>Modifier Total</b>	<b>RCN</b>	<b>Depr (100% Phys/ % Func)</b>		<b>RCNLD</b>
Base Cost (10.48 x 660)		6,917		6,917	6,917	
	BARN BARN Qual 3	Cond 3	Year	0x0x0	Eff Age	288
<b>Valuation Summary</b>		<b>Modifier Total</b>	<b>RCN</b>	<b>Depr (100% Phys/ % Func)</b>		<b>RCNLD</b>
Base Cost (10.48 x 288)		3,018		3,018	3,018	
	HS HAY SHED Qual 3	Cond 3	Year	0x0x0	Eff Age	240
<b>Valuation Summary</b>		<b>Modifier Total</b>	<b>RCN</b>	<b>Depr (100% Phys/ % Func)</b>		<b>RCNLD</b>
Base Cost (4.68 x 240)		1,123		1,123	1,123	
	HS HAY SHED Qual 3	Cond 3	Year	0x0x0	Eff Age	360
<b>Valuation Summary</b>		<b>Modifier Total</b>	<b>RCN</b>	<b>Depr (100% Phys/ % Func)</b>		<b>RCNLD</b>
Base Cost (4.68 x 360)		1,685		1,685	1,685	
	GRDT GARAGE - DETACHED Qual 3	Cond 3	Year	10x30x0	Eff Age 1520	300
<b>Valuation Summary</b>		<b>Modifier Total</b>	<b>RCN</b>	<b>Depr (100% Phys/ % Func)</b>		<b>RCNLD</b>
Base Cost (33.67 x 300)		10,101		10,101	10,101	
	STF STG FAIR Qual 2	Cond	Year	30x10x0	Eff Age	
<b>Valuation Summary</b>		<b>Modifier Total</b>	<b>RCN</b>	<b>Depr (100% Phys/ % Func)</b>		<b>RCNLD</b>
Base Cost (4.68 x )						
	LNT0 Lean To - Attached Qual 2	Cond 2	Year	30x20x0	Eff Age 2026	600
<b>Valuation Summary</b>		<b>Modifier Total</b>	<b>RCN</b>	<b>Depr (0% Phys/ % Func)</b>		<b>RCNLD</b>
Base Cost (7.53 x 600)		4,518		4,518		4,518