



Rogers

Assessment Property Record Card for Tax Year 2026

Data provided by LISA DELOZIER County Assessor

Date 04/16/2026
Time 22:20:40
Page 1

Assessment Data					Primary Image																																																																																																															
Account 660023065 Parcel ID 22N14E-27-3-00000-000-0000 Cadastral ID 27-22-14-02400 Property Type REAL - Real Property Property Class RR VI Area 2 Tax Area 27 - COLLINSVILLE/COLL FIRE Name ID 347348 POWELL, JUNE 13865 N 152ND E AVE COLLINSVILLE OK 74021-0000 Parcel Location Situs 13865 N 152ND E AVE Subdivision Lot/Block / Parcel Size 1.51 - Acres Sec/Twn/Rng 27 / 22 / 14 / 3 Neighborhood 4010 - 22-14 School District S026 - COLLINSVILLE SCHOOLS					<p>\\tsclient\TCASEY\CASEY BOOTH VISUAL INSPECTION\2020-9- 9/3/2020</p>																																																																																																															
Legal Description Lat/Long: 36.35689848 -95.80402316 W 200' OF N 329.9' OF S 2309.3 OF E2 E2 E2 SW																																																																																																																				
Exemptions <table border="1"> <thead> <tr> <th>Code</th> <th>Type</th> <th>Active</th> <th>Maximum</th> <th>Exemption</th> </tr> </thead> <tbody> <tr> <td>H</td> <td>Homestead</td> <td>Yes</td> <td>1,000</td> <td>1,000</td> </tr> </tbody> </table>					Code	Type	Active	Maximum	Exemption	H	Homestead	Yes	1,000	1,000	Building Permits <table border="1"> <thead> <tr> <th>Number</th> <th>Description</th> <th>Opened</th> <th>Closed</th> <th>Amount</th> </tr> </thead> <tbody> <tr> <td></td> <td></td> <td></td> <td></td> <td></td> </tr> </tbody> </table>					Number	Description	Opened	Closed	Amount																																																																																												
Code	Type	Active	Maximum	Exemption																																																																																																																
H	Homestead	Yes	1,000	1,000																																																																																																																
Number	Description	Opened	Closed	Amount																																																																																																																
Parcel Valuation <table border="1"> <thead> <tr> <th>Source</th> <th>REAL</th> <th>Fair Cash</th> <th>Capped</th> <th>Asmnt Level</th> <th>Assessed</th> <th>Levy Rate</th> <th>102.120</th> <th>Current Tax</th> </tr> </thead> <tbody> <tr> <td>Remove Cap</td> <td>2000</td> <td>Land Value 68,719</td> <td>43,479</td> <td>11%</td> <td>4,783</td> <td>Assessed</td> <td>17,319</td> <td>1,768.62</td> </tr> <tr> <td>Year Frozen</td> <td>2010</td> <td>Improvements 180,127</td> <td>113,968</td> <td></td> <td>12,536</td> <td>Penalty</td> <td>0</td> <td></td> </tr> <tr> <td>Uncapped Value</td> <td>0</td> <td>Mobile Home 0</td> <td>0</td> <td></td> <td>0</td> <td>Exemption</td> <td>1,000</td> <td>-103.00</td> </tr> <tr> <td>TIF Project ID</td> <td>0</td> <td>Total Value 248,846</td> <td>157,447</td> <td></td> <td>17,319</td> <td>Total Taxable</td> <td>16,319</td> <td>1,666.00</td> </tr> </tbody> </table>					Source	REAL	Fair Cash	Capped	Asmnt Level	Assessed	Levy Rate	102.120	Current Tax	Remove Cap	2000	Land Value 68,719	43,479	11%	4,783	Assessed	17,319	1,768.62	Year Frozen	2010	Improvements 180,127	113,968		12,536	Penalty	0		Uncapped Value	0	Mobile Home 0	0		0	Exemption	1,000	-103.00	TIF Project ID	0	Total Value 248,846	157,447		17,319	Total Taxable	16,319	1,666.00	Sale History <table border="1"> <thead> <tr> <th>Bk/Pg</th> <th>Grantor</th> <th>Date</th> <th>Price</th> <th>Code</th> </tr> </thead> <tbody> <tr> <td>/</td> <td>DEL SORDO, ELLEN</td> <td>06/18/2025</td> <td>0</td> <td>4</td> </tr> <tr> <td>1191/521</td> <td>GIFFORD, THOMAS L &</td> <td>09/03/1999</td> <td>165,000</td> <td>Yes</td> </tr> </tbody> </table>					Bk/Pg	Grantor	Date	Price	Code	/	DEL SORDO, ELLEN	06/18/2025	0	4	1191/521	GIFFORD, THOMAS L &	09/03/1999	165,000	Yes																																															
Source	REAL	Fair Cash	Capped	Asmnt Level	Assessed	Levy Rate	102.120	Current Tax																																																																																																												
Remove Cap	2000	Land Value 68,719	43,479	11%	4,783	Assessed	17,319	1,768.62																																																																																																												
Year Frozen	2010	Improvements 180,127	113,968		12,536	Penalty	0																																																																																																													
Uncapped Value	0	Mobile Home 0	0		0	Exemption	1,000	-103.00																																																																																																												
TIF Project ID	0	Total Value 248,846	157,447		17,319	Total Taxable	16,319	1,666.00																																																																																																												
Bk/Pg	Grantor	Date	Price	Code																																																																																																																
/	DEL SORDO, ELLEN	06/18/2025	0	4																																																																																																																
1191/521	GIFFORD, THOMAS L &	09/03/1999	165,000	Yes																																																																																																																
Assessment History <table border="1"> <thead> <tr> <th>Tax Year</th> <th>Statement Number</th> <th>Billed Owner</th> <th>Tax Area</th> <th>Total Value</th> <th>Exemptions</th> <th>Taxable Value</th> <th>Billed Tax</th> </tr> </thead> <tbody> <tr><td>2025</td><td>2025-660023065</td><td>POWELL, JUNE</td><td>27</td><td>240,125</td><td>1000</td><td>16,319</td><td>1,666.00</td></tr> <tr><td>2024</td><td>2024-660023065</td><td>DEL SORDO, ELLEN</td><td>27</td><td>261,833</td><td>1000</td><td>16,320</td><td>1,635.00</td></tr> <tr><td>2023</td><td>2023-660023065</td><td>DEL SORDO, ELLEN</td><td>27</td><td>252,884</td><td>1000</td><td>16,319</td><td>1,605.00</td></tr> <tr><td>2022</td><td>2022-660023065</td><td>DELSORDO, MICHEL A & ELLEN</td><td>27</td><td>200,149</td><td>1000</td><td>16,319</td><td>1,594.00</td></tr> <tr><td>2021</td><td>2021-660023065</td><td>DELSORDO, MICHEL A & ELLEN</td><td>27</td><td>193,287</td><td>1000</td><td>16,319</td><td>1,619.00</td></tr> <tr><td>2020</td><td>2020-660023065</td><td>DELSORDO, MICHEL A & ELLEN</td><td>27</td><td>194,608</td><td>1000</td><td>16,319</td><td>1,623.00</td></tr> <tr><td>2019</td><td>2019-660023065</td><td>DELSORDO, MICHEL A & ELLEN</td><td>27</td><td>179,794</td><td>1000</td><td>16,319</td><td>1,605.00</td></tr> <tr><td>2018</td><td>2018-660023065</td><td>DELSORDO, MICHEL A & ELLEN</td><td>27</td><td>187,010</td><td>1000</td><td>16,319</td><td>1,623.00</td></tr> <tr><td>2017</td><td>2017-660023065</td><td>DELSORDO, MICHEL A & ELLEN</td><td>27</td><td>184,782</td><td>1000</td><td>16,319</td><td>1,597.00</td></tr> <tr><td>2016</td><td>2016-660023065</td><td>DELSORDO, MICHEL A & ELLEN</td><td>27</td><td>175,519</td><td>1000</td><td>16,319</td><td>1,557.00</td></tr> <tr><td>2015</td><td>2015-660023065</td><td>DELSORDO, MICHEL A & ELLEN</td><td>27</td><td>171,606</td><td>1000</td><td>16,319</td><td>1,575.00</td></tr> <tr><td>2014</td><td>2014-660023065</td><td>DELSORDO, MICHEL A & ELLEN</td><td>27</td><td>174,712</td><td>1000</td><td>16,319</td><td>1,528.00</td></tr> <tr><td>2013</td><td>2013-660023065</td><td>DELSORDO, MICHEL A & ELLEN</td><td>27</td><td>166,214</td><td>1000</td><td>16,319</td><td>1,524.00</td></tr> </tbody> </table>					Tax Year	Statement Number	Billed Owner	Tax Area	Total Value	Exemptions	Taxable Value	Billed Tax	2025	2025-660023065	POWELL, JUNE	27	240,125	1000	16,319	1,666.00	2024	2024-660023065	DEL SORDO, ELLEN	27	261,833	1000	16,320	1,635.00	2023	2023-660023065	DEL SORDO, ELLEN	27	252,884	1000	16,319	1,605.00	2022	2022-660023065	DELSORDO, MICHEL A & ELLEN	27	200,149	1000	16,319	1,594.00	2021	2021-660023065	DELSORDO, MICHEL A & ELLEN	27	193,287	1000	16,319	1,619.00	2020	2020-660023065	DELSORDO, MICHEL A & ELLEN	27	194,608	1000	16,319	1,623.00	2019	2019-660023065	DELSORDO, MICHEL A & ELLEN	27	179,794	1000	16,319	1,605.00	2018	2018-660023065	DELSORDO, MICHEL A & ELLEN	27	187,010	1000	16,319	1,623.00	2017	2017-660023065	DELSORDO, MICHEL A & ELLEN	27	184,782	1000	16,319	1,597.00	2016	2016-660023065	DELSORDO, MICHEL A & ELLEN	27	175,519	1000	16,319	1,557.00	2015	2015-660023065	DELSORDO, MICHEL A & ELLEN	27	171,606	1000	16,319	1,575.00	2014	2014-660023065	DELSORDO, MICHEL A & ELLEN	27	174,712	1000	16,319	1,528.00	2013	2013-660023065	DELSORDO, MICHEL A & ELLEN	27	166,214	1000	16,319	1,524.00
Tax Year	Statement Number	Billed Owner	Tax Area	Total Value	Exemptions	Taxable Value	Billed Tax																																																																																																													
2025	2025-660023065	POWELL, JUNE	27	240,125	1000	16,319	1,666.00																																																																																																													
2024	2024-660023065	DEL SORDO, ELLEN	27	261,833	1000	16,320	1,635.00																																																																																																													
2023	2023-660023065	DEL SORDO, ELLEN	27	252,884	1000	16,319	1,605.00																																																																																																													
2022	2022-660023065	DELSORDO, MICHEL A & ELLEN	27	200,149	1000	16,319	1,594.00																																																																																																													
2021	2021-660023065	DELSORDO, MICHEL A & ELLEN	27	193,287	1000	16,319	1,619.00																																																																																																													
2020	2020-660023065	DELSORDO, MICHEL A & ELLEN	27	194,608	1000	16,319	1,623.00																																																																																																													
2019	2019-660023065	DELSORDO, MICHEL A & ELLEN	27	179,794	1000	16,319	1,605.00																																																																																																													
2018	2018-660023065	DELSORDO, MICHEL A & ELLEN	27	187,010	1000	16,319	1,623.00																																																																																																													
2017	2017-660023065	DELSORDO, MICHEL A & ELLEN	27	184,782	1000	16,319	1,597.00																																																																																																													
2016	2016-660023065	DELSORDO, MICHEL A & ELLEN	27	175,519	1000	16,319	1,557.00																																																																																																													
2015	2015-660023065	DELSORDO, MICHEL A & ELLEN	27	171,606	1000	16,319	1,575.00																																																																																																													
2014	2014-660023065	DELSORDO, MICHEL A & ELLEN	27	174,712	1000	16,319	1,528.00																																																																																																													
2013	2013-660023065	DELSORDO, MICHEL A & ELLEN	27	166,214	1000	16,319	1,524.00																																																																																																													



Rogers

Assessment Property Record Card for Tax Year 2026

Data provided by LISA DELOZIER County Assessor

Date 04/16/2026
 Time 22:20:40
 Page 2

Lot Data	Square-Foot - NBHD 4010 #1	Primary Image
Lot Size		
Lot Count		
Units Buildable	14590	
Non-Ag Acres	1.504	
Topography		
Street Access		
Utilities		
Amenities	LAND QUALITY	
	0	
	0	
Method	Square-Foot	
Base Lot Value	65,512.00 x 1.05 = 68,719	
Factor Value		
Adjustments	1.0000	
Lot Value	68,719	

Residential Data	
Type	1 Single Family Residence
Condition	3 - Average
Quality	3 - Average
Architecture	TRAD TRADITIONAL
Style	100% One Story
Exterior Wall	15% Veneer, Masonry 85% Frame, Siding, Vinyl
Base/Total Area	1,774 / 1,774
Style	100% One Story
HVAC	100% Warmed & Cooled Air
Roof Cover	1 Composition Shingle
Area on Slab	1,774
Fixture/RghIn	11 /
Bed/F/H Bath	3 / 2.0 /
Basement Area	
Garage Type	440 Attached Garage - Unfinished
Remodel	
Year/Eff Age	1990 / 27



\\tsclient\TCASEY\CASEY BOOTH VISUAL INSPECTION\2020-9- 9/3/2020

GRM Approach	
GRM Code	
Gross Rent	0.00
Indicated Value	

Multiple Regression			
MRA Code	1	Test	
Adjusted R	0.8445		
Indicated Value	224,025	126.28	Per SqFt

Direct Comparables	
Selection Model	1 Res
Adjustment Model	A2 AO Test
Comparables	
Indicated Value	

Cost Approach				Manual : 01/2025	
Base Cost	102.46	Total Misc Impr	+	8,059	
Roofing Adj	+ 4.82	Garage Cost	+	14,498	
Subfloor Adj	+ -2.31	Total RCN	=	246,702	
Heat/Cool Adj	+ 12.64	Depreciation (34%)	-	83,879	
Plumbing Adj	+ 8.74	Lump Sums	+	0	
Basement Adj	+ 0.00	RCNLD	=	162,823	
Adj Base Cost	= 126.35	Lot Value	+	68,719	
Total Area	x 1,774	Indicated Value	=	231,542	
Adjusted Cost	= 224,145	Value Per SqFt		130.52	

Value Reconciliation			
Selected Approach	Cost Approach		
Improvements	162,823		
Lot Value	68,719		
Indicated Value	231,542	130.52	Per SqFt
Agland Value			
Site Improvements	17,304		
Total Value	248,846	140.27	Total Value Per SqFt

Miscellaneous Improvements								
Code	Description	Sketch ID	Size	Year	Units	Unit Cost	Depr	Value
PRCH	SLAB PORCH - COVERED	56946	19x10		190	26.33		5,003
PRCH	SLAB PORCH - COVERED	56947	23x5		115	26.57		3,056



Rogers

Assessment Property Record Card for Tax Year 2026

Data provided by LISA DELOZIER County Assessor

Date 04/16/2026
 Time 22:20:40
 Page 3

Sketch Image

660023065

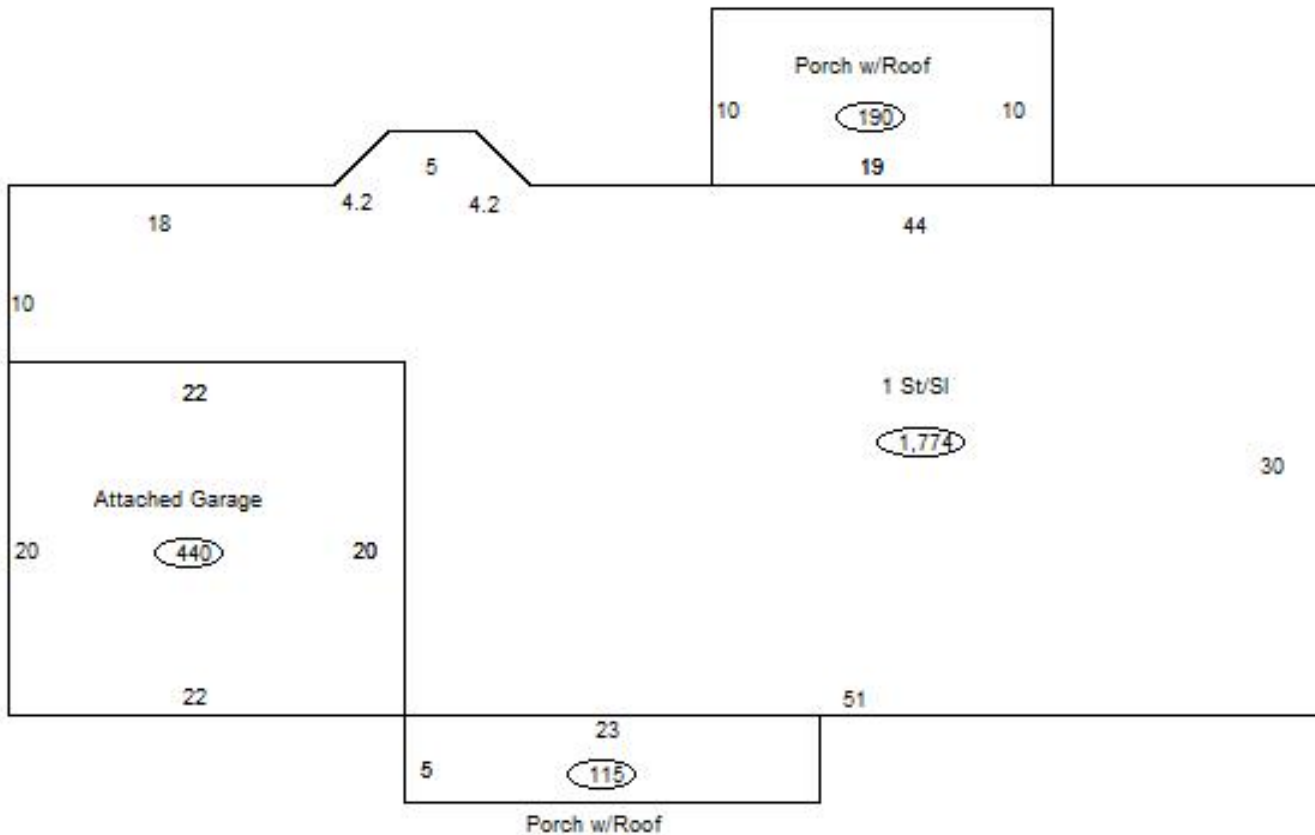

Sketch Vector Information

Sequence	Code	Type	Built Over	Scale	Section Label	Base Area	Multiplier	Total Area
1	R	1	Slab	13	1 St/Sl	1,774	1.000	1,774
2	G	1		13	Attached Garage	440	1.000	440
3	M	PRCH		13	SLBC	190	1.000	190
4	M	PRCH		13	SLBC	115	1.000	115
Total Building Area						1,774		1,774



Rogers

Assessment Property Record Card for Tax Year 2026

Data provided by LISA DELOZIER County Assessor

Date 04/16/2026
Time 22:20:40
Page 4

660023065

Outbuildings/Site Improvements

Building Image	Code	Description	Dimensions	Floor	Roofing	Total Units
	UTIL	SHOP BUILDING	50x30x10	Concrete	Galvanized Metal	1,500
	Qual 3	Cond 3	Year 2005	Eff Age		
		Valuation Summary	Modifier Total	RCN	Depr (60% Phys/ % Func)	RCNLD
		Base Cost (28.84 x 1,500)	43,260	43,260	25,956	17,304