



# Rogers

## Assessment Property Record Card for Tax Year 2026

Data provided by LISA DELOZIER County Assessor

Date 04/16/2026  
Time 22:00:41  
Page 1

Assessment Data	Primary Image																									
<b>Account</b> 660023084 <b>Parcel ID</b> 22N14E-27-4-00000-000-0000 <b>Cadastral ID</b> 27-22-14-04100 <b>Property Type</b> REAL - Real Property <b>Property Class</b> RA VI Area 2 <b>Tax Area</b> 27 - COLLINSVILLE/COLL FIRE <b>Name ID</b> 322830 CLOPP, TIM & DARLA JOINT TRUST  13905 N 155TH E AVE COLLINSVILLE OK 74021-5600  <b>Parcel Location</b> <b>Situs</b> 13905 N 155TH E AVE <b>Subdivision</b> <b>Lot/Block</b> / <b>Parcel Size</b> 10 - Acres <b>Sec/Twn/Rng</b> 27 / 22 / 14 / 4 <b>Neighborhood</b> 4010 - 22-14 <b>School District</b> S026 - COLLINSVILLE SCHOOLS	<p>\\tsclient\TCASEY\CASEY BOOTH VISUAL INSPECTION\2020-9- 9/16/2020</p>																									
<b>Legal Description</b> Lat/Long: 36.35735318 -95.79987499 NE NW SE LESS & EXCEPT W 20' FOR ROAD	<b>Building Permits</b> <table border="1"> <thead> <tr> <th>Number</th> <th>Description</th> <th>Opened</th> <th>Closed</th> <th>Amount</th> </tr> </thead> <tbody> <tr> <td> </td> <td> </td> <td> </td> <td> </td> <td> </td> </tr> </tbody> </table>	Number	Description	Opened	Closed	Amount																				
Number	Description	Opened	Closed	Amount																						
<b>Exemptions</b> <table border="1"> <thead> <tr> <th>Code</th> <th>Type</th> <th>Active</th> <th>Maximum</th> <th>Exemption</th> </tr> </thead> <tbody> <tr> <td>H</td> <td>Homestead</td> <td>Yes</td> <td>1,000</td> <td>1,000</td> </tr> </tbody> </table>	Code	Type	Active	Maximum	Exemption	H	Homestead	Yes	1,000	1,000	<b>Sale History</b> <table border="1"> <thead> <tr> <th>Bk/Pg</th> <th>Grantor</th> <th>Date</th> <th>Price</th> <th>Code</th> </tr> </thead> <tbody> <tr> <td>/</td> <td>CLOPP, TIMOTHY LEE &amp;</td> <td>10/08/2019</td> <td>0</td> <td>4</td> </tr> <tr> <td>2668/182</td> <td>JOBE, LEE ROY-TRUST</td> <td>10/13/2017</td> <td>190,000</td> <td>YES</td> </tr> </tbody> </table>	Bk/Pg	Grantor	Date	Price	Code	/	CLOPP, TIMOTHY LEE &	10/08/2019	0	4	2668/182	JOBE, LEE ROY-TRUST	10/13/2017	190,000	YES
Code	Type	Active	Maximum	Exemption																						
H	Homestead	Yes	1,000	1,000																						
Bk/Pg	Grantor	Date	Price	Code																						
/	CLOPP, TIMOTHY LEE &	10/08/2019	0	4																						
2668/182	JOBE, LEE ROY-TRUST	10/13/2017	190,000	YES																						

Parcel Valuation									
Source	REAL	Fair Cash	Capped	Asmnt Level	Assessed	Levy Rate	102.120	Current Tax	
Remove Cap	2018	Land Value 1,644	1,644	11%	181	Assessed	9,311	950.84	
Year Frozen	2008	Improvements 88,630	82,999		9,130	Penalty	0		
Uncapped Value	0	Mobile Home 0	0		0	Exemption	1,000	-102.00	
TIF Project ID	0	Total Value 90,274	84,643		9,311	Total Taxable	8,311	849.00	

Assessment History								
Tax Year	Statement Number	Billed Owner	Tax Area	Total Value	Exemptions	Taxable Value	Billed Tax	
2025	2025-660023084	CLOPP, TIM & DARLA	27	82,178	1000	8,039	821.00	
2024	2024-660023084	CLOPP, TIMOTHY LEE	27	90,770	1000	8,017	803.00	
2023	2023-660023084	CLOPP, TIMOTHY LEE	27	83,932	1000	7,755	763.00	
2022	2022-660023084	CLOPP, TIMOTHY LEE	27	80,418	1000	7,500	733.00	
2021	2021-660023084	CLOPP, TIMOTHY LEE	27	75,020	1000	7,252	719.00	
2020	2020-660023084	CLOPP, TIMOTHY LEE	27	76,259	1000	7,192	715.00	
2019	2019-660023084	CLOPP, TIMOTHY LEE &	27	72,300	1000	6,953	684.00	
2018	2018-660023084	CLOPP, TIMOTHY LEE &	27	76,521	1000	7,417	737.00	
2017	2017-660023084	JOBE, LEE ROY	27	122,999	2000	6,627	648.00	
2016	2016-660023084	JOBE, LEE ROY	27	111,912	2000	6,628	632.00	
2015	2015-660023084	JOBE, LEE ROY	27	110,132	2000	6,628	640.00	
2014	2014-660023084	JOBE, LEE ROY	27	112,083	2000	6,628	621.00	
2013	2013-660023084	JOBE, LEE ROY	27	109,276	2000	6,627	619.00	



# Rogers

## Assessment Property Record Card for Tax Year 2026

Data provided by LISA DELOZIER County Assessor

Date 04/16/2026  
Time 22:00:41  
Page 2

Lot Data	Square-Foot - NBHD 4010 #1	Primary Image
<b>Lot Size</b> <b>Lot Count</b> <b>Units Buildable</b> 10 <b>Non-Ag Acres</b> 0 <b>Topography</b> <b>Street Access</b> <b>Utilities</b> <b>Amenities</b> LAND QUALITY  <b>Method</b> Square-Foot <b>Base Lot Value</b> <b>Factor Value</b> <b>Adjustments</b> <b>Lot Value</b>		

Residential Data	
<b>Type</b>	1 Single Family Residence
<b>Condition</b>	2.5 - Fair
<b>Quality</b>	2.5 - Fair
<b>Architecture</b>	
<b>Style</b>	100% One Story
<b>Exterior Wall</b>	100% Veneer, Masonry
<b>Base/Total Area</b>	1,040 / 1,040
<b>Style</b>	100% One Story
<b>HVAC</b>	100% Warmed & Cooled Air
<b>Roof Cover</b>	1 Composition Shingle
<b>Area on Slab</b>	0
<b>Fixture/RghIn</b>	4 /
<b>Bed/F/H Bath</b>	2 / 1.0 /
<b>Basement Area</b>	
<b>Garage Type</b>	
<b>Remodel</b>	
<b>Year/Eff Age</b>	1970 / 49



\\tsclient\TCASEY\CASEY BOOTH VISUAL INSPECTION\2020-9- 9/16/2020

GRM Approach	
<b>GRM Code</b>	
<b>Gross Rent</b>	0.00
<b>Indicated Value</b>	

Multiple Regression	
<b>MRA Code</b>	
<b>Adusted R</b>	
<b>Indicated Value</b>	

Direct Comparables	
<b>Selection Model</b>	1 Res
<b>Adjustment Model</b>	A2 AO Test
<b>Comparables</b>	
<b>Indicated Value</b>	

Cost Approach				Manual : 01/2025			
<b>Base Cost</b>	110.21	<b>Total Misc Impr</b>	+ 11,912				
<b>Roofing Adj</b>	+ 4.66	<b>Garage Cost</b>	+ 0				
<b>Subfloor Adj</b>	+ 1.21	<b>Total RCN</b>	= 150,149				
<b>Heat/Cool Adj</b>	+ 11.47	<b>Depreciation ( 56%)</b>	- 84,083				
<b>Plumbing Adj</b>	+ 5.37	<b>Lump Sums</b>	+ 0				
<b>Basement Adj</b>	+ 0.00	<b>RCNLD</b>	= 66,066				
<b>Adj Base Cost</b>	= 132.92	<b>Lot Value</b>	+ 0				
<b>Total Area</b>	x 1,040	<b>Indicated Value</b>	= 66,066				
<b>Adjusted Cost</b>	= 138,237	<b>Value Per SqFt</b>	63.53				

Value Reconciliation			
<b>Selected Approach</b>	Cost Approach		
<b>Improvements</b>	66,066		
<b>Lot Value</b>			
<b>Indicated Value</b>	66,066	63.53	Per SqFt
<b>Agland Value</b>	1,644		
<b>Site Improvements</b>	22,564		
<b>Total Value</b>	90,274	86.80	Total Value Per SqFt

Miscellaneous Improvements								
Code	Description	Sketch ID	Size	Year	Units	Unit Cost	Depr	Value
SHLT	STORM SHELTER	0		1 2013	1	0.00		
EPSW	ENCLOSED PORCH - SOLID WALL	56983	24x8		192	62.04		11,912



# Rogers

## Assessment Property Record Card for Tax Year 2026

Data provided by LISA DELOZIER County Assessor

Date 04/16/2026

Time 22:00:41

Page 3

### Sketch Image

660023084

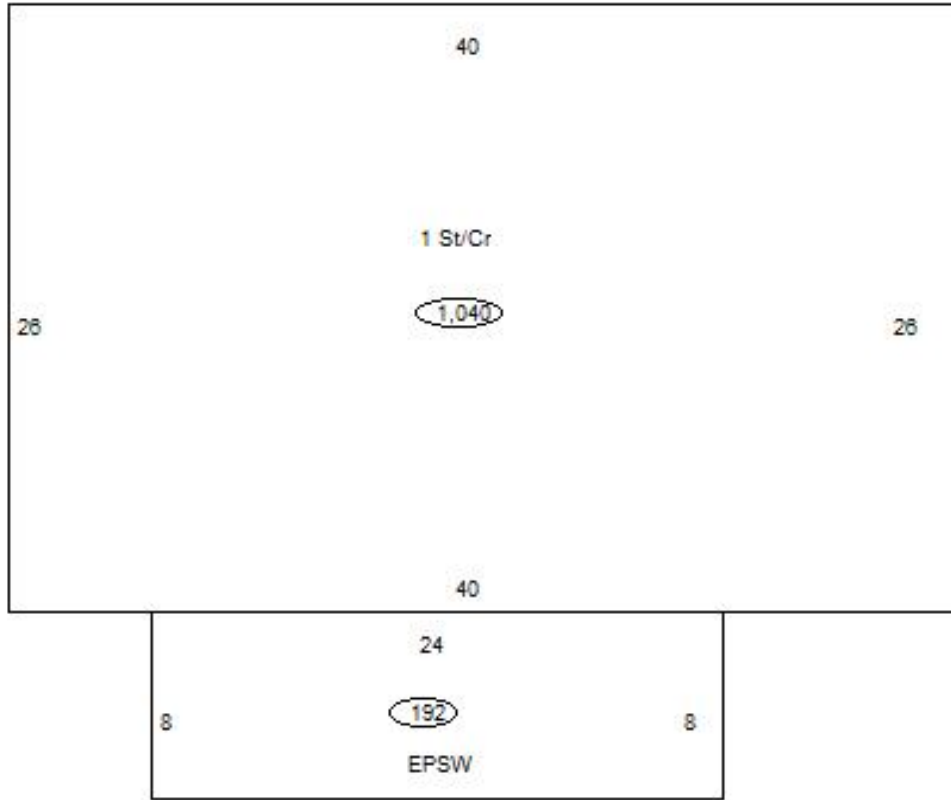

### Sketch Vector Information

Sequence	Code	Type	Built Over	Scale	Section Label	Base Area	Multiplier	Total Area
1	R	1	Crawl	10	1 St/Cr	1,040	1.000	1,040
2	M	EPSW		10	EPSW	192	1.000	192
<b>Total Building Area</b>						1,040		1,040



# Rogers



## Assessment Property Record Card for Tax Year 2026

Data provided by LISA DELOZIER County Assessor

Date 04/16/2026  
 Time 22:00:41  
 Page 4

660023084

### Outbuildings/Site Improvements

Building Image	Code	Description	Dimensions	Floor	Roofing	Total Units	
	LNT0	Lean To - Attached	12x50x10	Dirt	Formed Metal	600	
	Qual	2.5	Cond 3	Year 1995	Eff Age		
	<b>Valuation Summary</b>		<b>Modifier Total</b>		<b>RCN</b>	<b>Depr (55% Phys/ % Func)</b>	<b>RCNLD</b>
	Base Cost (7.27 x 600)		4,362		4,362	2,399	1,963
	UTIL	SHOP BUILDING	34x50x10	Concrete	Galvanized Metal	1,700	
	Qual	2	Cond 3	Year 1990	Eff Age		
	<b>Valuation Summary</b>		<b>Modifier Total</b>		<b>RCN</b>	<b>Depr (55% Phys/ % Func)</b>	<b>RCNLD</b>
	Base Cost (26.93 x 1,700)		45,781		45,781	25,180	20,601
	BNGP	Barn - General Purpose	20x30x8	Dirt	Formed Metal	600	
	Qual	3	Cond 3	Year 1960	Eff Age		
	<b>Valuation Summary</b>		<b>Modifier Total</b>		<b>RCN</b>	<b>Depr (100% Phys/ % Func)</b>	<b>RCNLD</b>
	Base Cost (21.86 x 600)		13,116		13,116	13,116	



# Rogers

## Assessment Property Record Card for Tax Year 2026

Data provided by LISA DELOZIER County Assessor

Date 04/16/2026  
Time 22:00:41  
Page 5

### Agland Inventory

660023084

Soi	Description	Land Use	LPI	Adj Type	Adj Code	Acres	Use/Acre	Mkt/Acre	Use Value	Market Value
BR	BREAKS-ALLUVIAL LAND COMP	IMP PST	30			2.130	84	84	179	179
DBC	DENNIS-BATES COMPLEX 2-5%	IMP PST	60			.670	168	168	113	113
DBC	DENNIS-BATES COMPLEX 2-5%	IMP PST	60			4.650	168	168	781	781
DNB	DENNIS SILT LOAM 1-3% SLO	IMP PST	80			2.550	224	224	571	571
<b>IMP PST Totals</b>						10.000			1,644	1,644
<b>Total Agland</b>						10.000			1,644	1,644