



Rogers

Assessment Property Record Card for Tax Year 2026

Data provided by LISA DELOZIER County Assessor

Date 04/16/2026
Time 22:08:46
Page 1

Assessment Data					Primary Image																																																																																																																				
Account 660023112 Parcel ID 000000-00-0-00651-001-0003 Cadastral ID 27-22-14-04470 Property Type REAL - Real Property Property Class RRP VI Area 2 Tax Area 27 - COLLINSVILLE/COLL FIRE Name ID 187334 CADE, JOHN H 14925 E 136 ST N COLLINSVILLE OK 74021-0000 Parcel Location Situs 14925 E 136TH ST N Subdivision RANCLAND ESTATES Lot/Block 0003 / 0001 Parcel Size 1 - Lots Sec/Twn/Rng 27 / 22 / 14 / 5 Neighborhood 1096 - R-V02-NW COLLINSVILLE School District S026 - COLLINSVILLE SCHOOLS																																																																																																																									
Legal Description Lot/Long: 36.35142048 -95.80605785																																																																																																																									
Building Permits					<table border="1"> <thead> <tr> <th>Number</th> <th>Description</th> <th>Opened</th> <th>Closed</th> <th>Amount</th> </tr> </thead> <tbody> <tr> <td colspan="5"> </td> </tr> </tbody> </table>					Number	Description	Opened	Closed	Amount																																																																																																											
Number	Description	Opened	Closed	Amount																																																																																																																					
Exemptions					Sale History																																																																																																																				
<table border="1"> <thead> <tr> <th>Code</th> <th>Type</th> <th>Active</th> <th>Maximum</th> <th>Exemption</th> </tr> </thead> <tbody> <tr> <td>H</td> <td>Homestead</td> <td>Yes</td> <td>1,000</td> <td>1,000</td> </tr> </tbody> </table>					Code	Type	Active	Maximum	Exemption	H	Homestead	Yes	1,000	1,000	<table border="1"> <thead> <tr> <th>Bk/Pg</th> <th>Grantor</th> <th>Date</th> <th>Price</th> <th>Code</th> </tr> </thead> <tbody> <tr> <td colspan="5"> </td> </tr> </tbody> </table>					Bk/Pg	Grantor	Date	Price	Code																																																																																																	
Code	Type	Active	Maximum	Exemption																																																																																																																					
H	Homestead	Yes	1,000	1,000																																																																																																																					
Bk/Pg	Grantor	Date	Price	Code																																																																																																																					
Parcel Valuation																																																																																																																									
<table border="1"> <thead> <tr> <th>Source</th> <th>REAL</th> <th>Fair Cash</th> <th>Capped</th> <th>Asmnt Level</th> <th>Assessed</th> <th>Levy Rate</th> <th>102.120</th> <th>Current Tax</th> </tr> </thead> <tbody> <tr> <td>Remove Cap</td> <td>0</td> <td>Land Value 100,979</td> <td>53,476</td> <td>11%</td> <td>5,882</td> <td>Assessed</td> <td>14,943</td> <td>1,525.98</td> </tr> <tr> <td>Year Frozen</td> <td>2014</td> <td>Improvements 155,553</td> <td>82,376</td> <td></td> <td>9,061</td> <td>Penalty</td> <td>0</td> <td></td> </tr> <tr> <td>Uncapped Value</td> <td>0</td> <td>Mobile Home 0</td> <td>0</td> <td></td> <td>0</td> <td>Exemption</td> <td>1,000</td> <td>-102.00</td> </tr> <tr> <td>TIF Project ID</td> <td>0</td> <td>Total Value 256,532</td> <td>135,852</td> <td></td> <td>14,943</td> <td>Total Taxable</td> <td>13,943</td> <td>1,424.00</td> </tr> </tbody> </table>		Source	REAL	Fair Cash	Capped	Asmnt Level	Assessed	Levy Rate	102.120	Current Tax	Remove Cap	0	Land Value 100,979	53,476	11%	5,882	Assessed	14,943	1,525.98	Year Frozen	2014	Improvements 155,553	82,376		9,061	Penalty	0		Uncapped Value	0	Mobile Home 0	0		0	Exemption	1,000	-102.00	TIF Project ID	0	Total Value 256,532	135,852		14,943	Total Taxable	13,943	1,424.00																																																																											
Source	REAL	Fair Cash	Capped	Asmnt Level	Assessed	Levy Rate	102.120	Current Tax																																																																																																																	
Remove Cap	0	Land Value 100,979	53,476	11%	5,882	Assessed	14,943	1,525.98																																																																																																																	
Year Frozen	2014	Improvements 155,553	82,376		9,061	Penalty	0																																																																																																																		
Uncapped Value	0	Mobile Home 0	0		0	Exemption	1,000	-102.00																																																																																																																	
TIF Project ID	0	Total Value 256,532	135,852		14,943	Total Taxable	13,943	1,424.00																																																																																																																	
Assessment History																																																																																																																									
<table border="1"> <thead> <tr> <th>Tax Year</th> <th>Statement Number</th> <th>Billed Owner</th> <th>Tax Area</th> <th>Total Value</th> <th>Exemptions</th> <th>Taxable Value</th> <th>Billed Tax</th> </tr> </thead> <tbody> <tr><td>2025</td><td>2025-660023112</td><td>CADE, JOHN H</td><td>27</td><td>248,833</td><td>1000</td><td>13,943</td><td>1,424.00</td></tr> <tr><td>2024</td><td>2024-660023112</td><td>CADE, JOHN H</td><td>27</td><td>285,158</td><td>1000</td><td>13,944</td><td>1,397.00</td></tr> <tr><td>2023</td><td>2023-660023112</td><td>CADE, JOHN H</td><td>27</td><td>174,330</td><td>1000</td><td>13,944</td><td>1,371.00</td></tr> <tr><td>2022</td><td>2022-660023112</td><td>CADE, JOHN H</td><td>27</td><td>175,518</td><td>1000</td><td>13,944</td><td>1,362.00</td></tr> <tr><td>2021</td><td>2021-660023112</td><td>CADE, JOHN H</td><td>27</td><td>179,711</td><td>1000</td><td>13,944</td><td>1,383.00</td></tr> <tr><td>2020</td><td>2020-660023112</td><td>CADE, JOHN H</td><td>27</td><td>177,350</td><td>1000</td><td>13,944</td><td>1,387.00</td></tr> <tr><td>2019</td><td>2019-660023112</td><td>CADE, JOHN H</td><td>27</td><td>171,272</td><td>1000</td><td>13,944</td><td>1,371.00</td></tr> <tr><td>2018</td><td>2018-660023112</td><td>CADE, JOHN H</td><td>27</td><td>175,929</td><td>1000</td><td>13,943</td><td>1,386.00</td></tr> <tr><td>2017</td><td>2017-660023112</td><td>CADE, JOHN H</td><td>27</td><td>174,626</td><td>1000</td><td>13,944</td><td>1,364.00</td></tr> <tr><td>2016</td><td>2016-660023112</td><td>CADE, JOHN H</td><td>27</td><td>170,781</td><td>1000</td><td>13,944</td><td>1,330.00</td></tr> <tr><td>2015</td><td>2015-660023112</td><td>CADE, JOHN H</td><td>27</td><td>166,640</td><td>1000</td><td>13,944</td><td>1,346.00</td></tr> <tr><td>2014</td><td>2014-660023112</td><td>CADE, JOHN H</td><td>27</td><td>167,937</td><td>1000</td><td>13,943</td><td>1,305.00</td></tr> <tr><td>2013</td><td>2013-660023112</td><td>CADE, JOHN H</td><td>27</td><td>159,391</td><td>1000</td><td>13,509</td><td>1,261.00</td></tr> </tbody> </table>										Tax Year	Statement Number	Billed Owner	Tax Area	Total Value	Exemptions	Taxable Value	Billed Tax	2025	2025-660023112	CADE, JOHN H	27	248,833	1000	13,943	1,424.00	2024	2024-660023112	CADE, JOHN H	27	285,158	1000	13,944	1,397.00	2023	2023-660023112	CADE, JOHN H	27	174,330	1000	13,944	1,371.00	2022	2022-660023112	CADE, JOHN H	27	175,518	1000	13,944	1,362.00	2021	2021-660023112	CADE, JOHN H	27	179,711	1000	13,944	1,383.00	2020	2020-660023112	CADE, JOHN H	27	177,350	1000	13,944	1,387.00	2019	2019-660023112	CADE, JOHN H	27	171,272	1000	13,944	1,371.00	2018	2018-660023112	CADE, JOHN H	27	175,929	1000	13,943	1,386.00	2017	2017-660023112	CADE, JOHN H	27	174,626	1000	13,944	1,364.00	2016	2016-660023112	CADE, JOHN H	27	170,781	1000	13,944	1,330.00	2015	2015-660023112	CADE, JOHN H	27	166,640	1000	13,944	1,346.00	2014	2014-660023112	CADE, JOHN H	27	167,937	1000	13,943	1,305.00	2013	2013-660023112	CADE, JOHN H	27	159,391	1000	13,509	1,261.00
Tax Year	Statement Number	Billed Owner	Tax Area	Total Value	Exemptions	Taxable Value	Billed Tax																																																																																																																		
2025	2025-660023112	CADE, JOHN H	27	248,833	1000	13,943	1,424.00																																																																																																																		
2024	2024-660023112	CADE, JOHN H	27	285,158	1000	13,944	1,397.00																																																																																																																		
2023	2023-660023112	CADE, JOHN H	27	174,330	1000	13,944	1,371.00																																																																																																																		
2022	2022-660023112	CADE, JOHN H	27	175,518	1000	13,944	1,362.00																																																																																																																		
2021	2021-660023112	CADE, JOHN H	27	179,711	1000	13,944	1,383.00																																																																																																																		
2020	2020-660023112	CADE, JOHN H	27	177,350	1000	13,944	1,387.00																																																																																																																		
2019	2019-660023112	CADE, JOHN H	27	171,272	1000	13,944	1,371.00																																																																																																																		
2018	2018-660023112	CADE, JOHN H	27	175,929	1000	13,943	1,386.00																																																																																																																		
2017	2017-660023112	CADE, JOHN H	27	174,626	1000	13,944	1,364.00																																																																																																																		
2016	2016-660023112	CADE, JOHN H	27	170,781	1000	13,944	1,330.00																																																																																																																		
2015	2015-660023112	CADE, JOHN H	27	166,640	1000	13,944	1,346.00																																																																																																																		
2014	2014-660023112	CADE, JOHN H	27	167,937	1000	13,943	1,305.00																																																																																																																		
2013	2013-660023112	CADE, JOHN H	27	159,391	1000	13,509	1,261.00																																																																																																																		



Rogers

Assessment Property Record Card for Tax Year 2026

Data provided by LISA DELOZIER County Assessor

Date 04/16/2026
Time 22:08:47
Page 2

Lot Data	Square-Foot - NBHD 1096 #1	Primary Image
Lot Size		
Lot Count		
Units Buildable	1	
Non-Ag Acres	2.2359	
Topography		
Street Access		
Utilities		
Amenities	LAND QUALITY	
	0	
	0	
Method	Square-Foot	
Base Lot Value	97,395.00 x 1.04 = 100,979	
Factor Value		
Adjustments	1.0000	
Lot Value	100,979	

Residential Data	
Type	1 Single Family Residence
Condition	3 - Average
Quality	2.5 - Fair
Architecture	TRAD TRADITIONAL
Style	100% One Story
Exterior Wall	50% Veneer, Stone 50% Frame, Siding, Vinyl
Base/Total Area	1,922 / 1,922
Style	100% One Story
HVAC	100% Warmed & Cooled Air
Roof Cover	1 Composition Shingle
Area on Slab	1,922
Fixture/RghIn	11 /
Bed/F/H Bath	4 / 2.0 /
Basement Area	
Garage Type	528 Attached Garage - Unfinished
Remodel	
Year/Eff Age	1977 / 37

Cost Approach		Manual : 01/2025	
Base Cost	96.63	Total Misc Impr	+ 10,469
Roofing Adj	+ 4.20	Garage Cost	+ 14,325
Subfloor Adj	+ -1.21	Total RCN	= 252,397
Heat/Cool Adj	+ 11.47	Depreciation (46%)	- 116,103
Plumbing Adj	+ 7.33	Lump Sums	+ 0
Basement Adj	+ 0.00	RCNLD	= 136,294
Adj Base Cost	= 118.42	Lot Value	+ 100,979
Total Area	x 1,922	Indicated Value	= 237,273
Adjusted Cost	= 227,603	Value Per SqFt	123.45

GRM Approach	
GRM Code	
Gross Rent	0.00
Indicated Value	

Multiple Regression			
MRA Code	1	Test	
Adusted R	0.8445		
Indicated Value	208,280	108.37	Per SqFt

Direct Comparables	
Selection Model	A Adam Test
Adjustment Model	1 2022 Residential
Comparables	2
Indicated Value	364,880 Per SqFt

Value Reconciliation			
Selected Approach	Cost Approach		
Improvements	136,294		
Lot Value	100,979		
Indicated Value	237,273	123.45	Per SqFt
Agland Value			
Site Improvements	19,259		
Total Value	256,532	133.47	Total Value Per SqFt

Miscellaneous Improvements								
Code	Description	Sketch ID	Size	Year	Units	Unit Cost	Depr	Value
FPR1	FIREPLACE - RESIDENTIAL 1 STORY	0		1	1	5,095.98		5,096
PRCH	SLAB PORCH - COVERED	57008	21x6		126	23.85		3,005
PATO	SLAB PORCH - OPEN	57009	12x10		120	10.68		1,282
PATO	SLAB PORCH - OPEN	57010	10x10		100	10.86		1,086



Rogers

Assessment Property Record Card for Tax Year 2026

Data provided by LISA DELOZIER County Assessor

Date 04/16/2026
 Time 22:08:47
 Page 3

Sketch Image

660023112

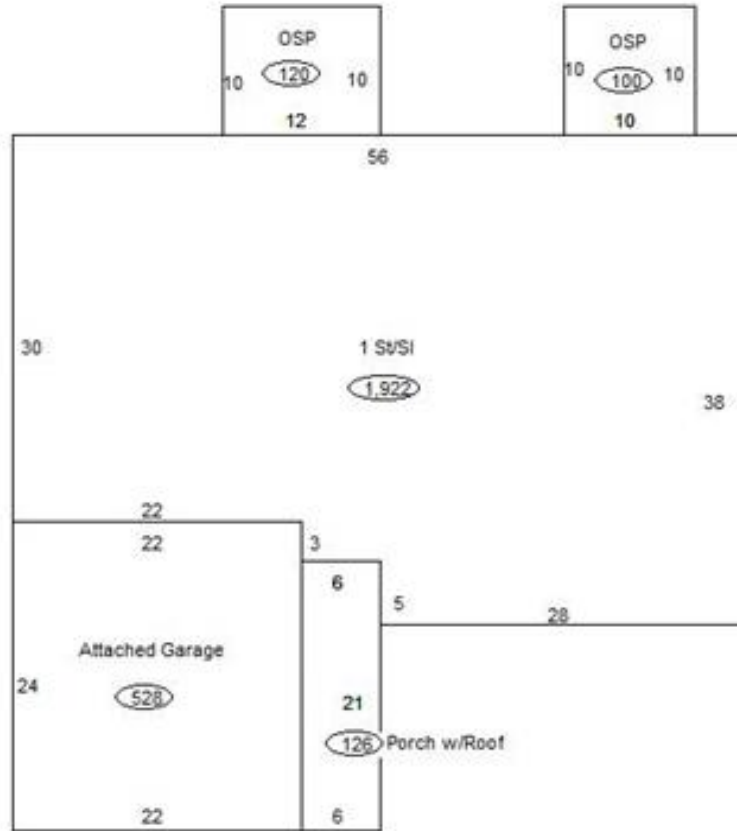

Sketch Vector Information

Sequence	Code	Type	Built Over	Scale	Section Label	Base Area	Multiplier	Total Area
1	R	1	Slab	13	1 St/SI	1,922	1.000	1,922
2	G	1		13	Attached Garage	528	1.000	528
3	M	PRCH		13	SLBC	126	1.000	126
4	M	PATO		13	Open Slab	120	1.000	120
5	M	PATO		13	Open Slab	100	1.000	100
Total Building Area						1,922		1,922



Rogers

Assessment Property Record Card for Tax Year 2026

Data provided by LISA DELOZIER County Assessor

Date 04/16/2026
Time 22:08:47
Page 4

660023112

Outbuildings/Site Improvements

Building Image	Code	Description	Dimensions	Floor	Roofing	Total Units
	UTIL	SHOP BUILDING	24x30x10	Concrete	Galvanized Metal	720
	Qual 3	Cond 3	Year 2016	Eff Age		
		Valuation Summary	Modifier Total	RCN	Depr (15% Phys/ % Func)	RCNLD
		Base Cost (31.47 x 720)	22,658	22,658	3,399	19,259