



Rogers

Assessment Property Record Card for Tax Year 2026

Data provided by LISA DELOZIER County Assessor

Date 04/16/2026
Time 22:08:58
Page 1

Assessment Data					Primary Image																																																																																																																				
Account 660023120 Parcel ID 000000-00-0-00651-001-0010 Cadastral ID 27-22-14-04550 Property Type REAL - Real Property Property Class RRP VI Area 2 Tax Area 27 - COLLINSVILLE/COLL FIRE Name ID 347267 PRATER, SANDRA LEE 14920 E 140TH ST N COLLINSVILLE OK 74021-0000 Parcel Location Situs 14920 E 140TH ST N Subdivision RANCLAND ESTATES Lot/Block 0010 / 0001 Parcel Size 1 - Lots Sec/Twn/Rng 27 / 22 / 14 / 5 Neighborhood 1096 - R-V02-NW COLLINSVILLE School District S026 - COLLINSVILLE SCHOOLS																																																																																																																									
Legal Description Lot/Long: 36.35593294 -95.80604557																																																																																																																									
Building Permits					<table border="1"> <thead> <tr> <th>Number</th> <th>Description</th> <th>Opened</th> <th>Closed</th> <th>Amount</th> </tr> </thead> <tbody> <tr> <td colspan="5"> </td> </tr> </tbody> </table>					Number	Description	Opened	Closed	Amount																																																																																																											
Number	Description	Opened	Closed	Amount																																																																																																																					
Exemptions					Sale History																																																																																																																				
<table border="1"> <thead> <tr> <th>Code</th> <th>Type</th> <th>Active</th> <th>Maximum</th> <th>Exemption</th> </tr> </thead> <tbody> <tr> <td>H</td> <td>Homestead</td> <td>Yes</td> <td>1,000</td> <td>1,000</td> </tr> </tbody> </table>					Code	Type	Active	Maximum	Exemption	H	Homestead	Yes	1,000	1,000	<table border="1"> <thead> <tr> <th>Bk/Pg</th> <th>Grantor</th> <th>Date</th> <th>Price</th> <th>Code</th> </tr> </thead> <tbody> <tr> <td>/</td> <td>PRATER, BOBBY EUGENE &</td> <td>05/30/2025</td> <td>0</td> <td>4</td> </tr> <tr> <td>2604/527</td> <td>PRATER, BOBBY & SANDRA</td> <td>12/08/2016</td> <td>0</td> <td>4</td> </tr> <tr> <td>2435/147</td> <td>FREEMAN, KATHRYN L TRUST</td> <td>10/22/2014</td> <td>140,000</td> <td>YES</td> </tr> </tbody> </table>					Bk/Pg	Grantor	Date	Price	Code	/	PRATER, BOBBY EUGENE &	05/30/2025	0	4	2604/527	PRATER, BOBBY & SANDRA	12/08/2016	0	4	2435/147	FREEMAN, KATHRYN L TRUST	10/22/2014	140,000	YES																																																																																		
Code	Type	Active	Maximum	Exemption																																																																																																																					
H	Homestead	Yes	1,000	1,000																																																																																																																					
Bk/Pg	Grantor	Date	Price	Code																																																																																																																					
/	PRATER, BOBBY EUGENE &	05/30/2025	0	4																																																																																																																					
2604/527	PRATER, BOBBY & SANDRA	12/08/2016	0	4																																																																																																																					
2435/147	FREEMAN, KATHRYN L TRUST	10/22/2014	140,000	YES																																																																																																																					
Parcel Valuation																																																																																																																									
<table border="1"> <thead> <tr> <th>Source</th> <th>REAL</th> <th>Fair Cash</th> <th>Capped</th> <th>Asmnt Level</th> <th>Assessed</th> <th>Levy Rate</th> <th>102.120</th> <th>Current Tax</th> </tr> </thead> <tbody> <tr> <td>Remove Cap</td> <td>2015</td> <td>Land Value</td> <td>100,607</td> <td>63,491</td> <td>11%</td> <td>6,984</td> <td>Assessed</td> <td>17,031</td> <td>1,739.21</td> </tr> <tr> <td>Year Frozen</td> <td>2015</td> <td>Improvements</td> <td>144,725</td> <td>91,332</td> <td></td> <td>10,047</td> <td>Penalty</td> <td>0</td> <td></td> </tr> <tr> <td>Uncapped Value</td> <td>0</td> <td>Mobile Home</td> <td>0</td> <td>0</td> <td></td> <td>0</td> <td>Exemption</td> <td>1,000</td> <td>-102.00</td> </tr> <tr> <td>TIF Project ID</td> <td>0</td> <td>Total Value</td> <td>245,332</td> <td>154,823</td> <td></td> <td>17,031</td> <td>Total Taxable</td> <td>16,031</td> <td>1,637.00</td> </tr> </tbody> </table>		Source	REAL	Fair Cash	Capped	Asmnt Level	Assessed	Levy Rate	102.120	Current Tax	Remove Cap	2015	Land Value	100,607	63,491	11%	6,984	Assessed	17,031	1,739.21	Year Frozen	2015	Improvements	144,725	91,332		10,047	Penalty	0		Uncapped Value	0	Mobile Home	0	0		0	Exemption	1,000	-102.00	TIF Project ID	0	Total Value	245,332	154,823		17,031	Total Taxable	16,031	1,637.00																																																																							
Source	REAL	Fair Cash	Capped	Asmnt Level	Assessed	Levy Rate	102.120	Current Tax																																																																																																																	
Remove Cap	2015	Land Value	100,607	63,491	11%	6,984	Assessed	17,031	1,739.21																																																																																																																
Year Frozen	2015	Improvements	144,725	91,332		10,047	Penalty	0																																																																																																																	
Uncapped Value	0	Mobile Home	0	0		0	Exemption	1,000	-102.00																																																																																																																
TIF Project ID	0	Total Value	245,332	154,823		17,031	Total Taxable	16,031	1,637.00																																																																																																																
Assessment History																																																																																																																									
<table border="1"> <thead> <tr> <th>Tax Year</th> <th>Statement Number</th> <th>Billed Owner</th> <th>Tax Area</th> <th>Total Value</th> <th>Exemptions</th> <th>Taxable Value</th> <th>Billed Tax</th> </tr> </thead> <tbody> <tr><td>2025</td><td>2025-660023120</td><td>PRATER, SANDRA LEE</td><td>27</td><td>242,321</td><td>1000</td><td>16,031</td><td>1,637.00</td></tr> <tr><td>2024</td><td>2024-660023120</td><td>PRATER, BOBBY EUGENE &</td><td>27</td><td>279,438</td><td>1000</td><td>16,031</td><td>1,606.00</td></tr> <tr><td>2023</td><td>2023-660023120</td><td>PRATER, BOBBY EUGENE &</td><td>27</td><td>154,824</td><td>1000</td><td>16,031</td><td>1,577.00</td></tr> <tr><td>2022</td><td>2022-660023120</td><td>PRATER, BOBBY EUGENE &</td><td>27</td><td>157,521</td><td>1000</td><td>16,139</td><td>1,577.00</td></tr> <tr><td>2021</td><td>2021-660023120</td><td>PRATER, BOBBY EUGENE &</td><td>27</td><td>166,107</td><td>1000</td><td>16,139</td><td>1,601.00</td></tr> <tr><td>2020</td><td>2020-660023120</td><td>PRATER, BOBBY EUGENE &</td><td>27</td><td>153,473</td><td>1000</td><td>14,973</td><td>1,489.00</td></tr> <tr><td>2019</td><td>2019-660023120</td><td>PRATER, BOBBY EUGENE &</td><td>27</td><td>148,153</td><td>1000</td><td>14,973</td><td>1,472.00</td></tr> <tr><td>2018</td><td>2018-660023120</td><td>PRATER, BOBBY EUGENE &</td><td>27</td><td>160,145</td><td>1000</td><td>14,973</td><td>1,489.00</td></tr> <tr><td>2017</td><td>2017-660023120</td><td>PRATER, BOBBY EUGENE &</td><td>27</td><td>158,919</td><td>1000</td><td>15,617</td><td>1,528.00</td></tr> <tr><td>2016</td><td>2016-660023120</td><td>PRATER, BOBBY & SANDRA</td><td>27</td><td>149,464</td><td>1000</td><td>14,973</td><td>1,428.00</td></tr> <tr><td>2015</td><td>2015-660023120</td><td>PRATER, BOBBY & SANDRA</td><td>27</td><td>145,209</td><td>1000</td><td>14,973</td><td>1,445.00</td></tr> <tr><td>2014</td><td>2014-660023120</td><td>FREEMAN, KATHRYN L - TRUSTEE</td><td>27</td><td>157,190</td><td>1000</td><td>8,227</td><td>770.00</td></tr> <tr><td>2013</td><td>2013-660023120</td><td>FREEMAN, KATHRYN L - TRUSTEE</td><td>27</td><td>149,710</td><td>1000</td><td>8,227</td><td>768.00</td></tr> </tbody> </table>										Tax Year	Statement Number	Billed Owner	Tax Area	Total Value	Exemptions	Taxable Value	Billed Tax	2025	2025-660023120	PRATER, SANDRA LEE	27	242,321	1000	16,031	1,637.00	2024	2024-660023120	PRATER, BOBBY EUGENE &	27	279,438	1000	16,031	1,606.00	2023	2023-660023120	PRATER, BOBBY EUGENE &	27	154,824	1000	16,031	1,577.00	2022	2022-660023120	PRATER, BOBBY EUGENE &	27	157,521	1000	16,139	1,577.00	2021	2021-660023120	PRATER, BOBBY EUGENE &	27	166,107	1000	16,139	1,601.00	2020	2020-660023120	PRATER, BOBBY EUGENE &	27	153,473	1000	14,973	1,489.00	2019	2019-660023120	PRATER, BOBBY EUGENE &	27	148,153	1000	14,973	1,472.00	2018	2018-660023120	PRATER, BOBBY EUGENE &	27	160,145	1000	14,973	1,489.00	2017	2017-660023120	PRATER, BOBBY EUGENE &	27	158,919	1000	15,617	1,528.00	2016	2016-660023120	PRATER, BOBBY & SANDRA	27	149,464	1000	14,973	1,428.00	2015	2015-660023120	PRATER, BOBBY & SANDRA	27	145,209	1000	14,973	1,445.00	2014	2014-660023120	FREEMAN, KATHRYN L - TRUSTEE	27	157,190	1000	8,227	770.00	2013	2013-660023120	FREEMAN, KATHRYN L - TRUSTEE	27	149,710	1000	8,227	768.00
Tax Year	Statement Number	Billed Owner	Tax Area	Total Value	Exemptions	Taxable Value	Billed Tax																																																																																																																		
2025	2025-660023120	PRATER, SANDRA LEE	27	242,321	1000	16,031	1,637.00																																																																																																																		
2024	2024-660023120	PRATER, BOBBY EUGENE &	27	279,438	1000	16,031	1,606.00																																																																																																																		
2023	2023-660023120	PRATER, BOBBY EUGENE &	27	154,824	1000	16,031	1,577.00																																																																																																																		
2022	2022-660023120	PRATER, BOBBY EUGENE &	27	157,521	1000	16,139	1,577.00																																																																																																																		
2021	2021-660023120	PRATER, BOBBY EUGENE &	27	166,107	1000	16,139	1,601.00																																																																																																																		
2020	2020-660023120	PRATER, BOBBY EUGENE &	27	153,473	1000	14,973	1,489.00																																																																																																																		
2019	2019-660023120	PRATER, BOBBY EUGENE &	27	148,153	1000	14,973	1,472.00																																																																																																																		
2018	2018-660023120	PRATER, BOBBY EUGENE &	27	160,145	1000	14,973	1,489.00																																																																																																																		
2017	2017-660023120	PRATER, BOBBY EUGENE &	27	158,919	1000	15,617	1,528.00																																																																																																																		
2016	2016-660023120	PRATER, BOBBY & SANDRA	27	149,464	1000	14,973	1,428.00																																																																																																																		
2015	2015-660023120	PRATER, BOBBY & SANDRA	27	145,209	1000	14,973	1,445.00																																																																																																																		
2014	2014-660023120	FREEMAN, KATHRYN L - TRUSTEE	27	157,190	1000	8,227	770.00																																																																																																																		
2013	2013-660023120	FREEMAN, KATHRYN L - TRUSTEE	27	149,710	1000	8,227	768.00																																																																																																																		



Rogers

Assessment Property Record Card for Tax Year 2026

Data provided by LISA DELOZIER County Assessor

Date 04/16/2026
Time 22:08:58
Page 2

Lot Data	Square-Foot - NBHD 1096 #1	Primary Image
Lot Size Lot Count Units Buildable 1 Non-Ag Acres 2.1932 Topography Street Access Utilities Amenities LAND QUALITY 0 0 Method Square-Foot Base Lot Value 95,537.00 x 1.05 = 100,607 Factor Value Adjustments 1.0000 Lot Value 100,607		

Residential Data	
Type	1 Single Family Residence
Condition	3 - Average
Quality	2.5 - Fair
Architecture	TRAD TRADITIONAL
Style	100% One Story
Exterior Wall	100% Veneer, Masonry
Base/Total Area	1,712 / 1,712
Style	100% One Story
HVAC	100% Warmed & Cooled Air
Roof Cover	1 Composition Shingle
Area on Slab	1,712
Fixture/RghIn	11 /
Bed/F/H Bath	3 / 2.0 /
Basement Area	
Garage Type	536 Attached Garage - Unfinished
Remodel	
Year/Eff Age	1976 / 38

\\tsclient\TCASEY\CASEY BOOTH VISUAL INSPECTION\2020-9- 9/2/2020

GRM Approach	
GRM Code	
Gross Rent	0.00
Indicated Value	

Multiple Regression			
MRA Code	1	Test	
Adusted R	0.8445		
Indicated Value	188,998	110.40	Per SqFt

Direct Comparables			
Selection Model	A	Adam Test	
Adjustment Model	1	2022 Residential	
Comparables	2		
Indicated Value	354,590		Per SqFt

Cost Approach				Manual : 01/2025			
Base Cost	104.08	Total Misc Impr	+	16,462			
Roofing Adj	+ 4.40	Garage Cost	+	14,488			
Subfloor Adj	+ -1.15	Total RCN	=	248,425			
Heat/Cool Adj	+ 11.47	Depreciation (47%)	-	116,760			
Plumbing Adj	+ 8.23	Lump Sums	+	0			
Basement Adj	+ 0.00	RCNLD	=	131,665			
Adj Base Cost	= 127.03	Lot Value	+	100,607			
Total Area	x 1,712	Indicated Value	=	232,272			
Adjusted Cost	= 217,475	Value Per SqFt		135.67			

Value Reconciliation			
Selected Approach	Cost Approach		
Improvements	131,665		
Lot Value	100,607		
Indicated Value	232,272	135.67	Per SqFt
Agland Value			
Site Improvements	13,060		
Total Value	245,332	143.30	Total Value Per SqFt

Miscellaneous Improvements								
Code	Description	Sketch ID	Size	Year	Units	Unit Cost	Depr	Value
FPR1	FIREPLACE - RESIDENTIAL 1 STORY	0		1	1	5,095.98		5,096
PRCH	SLAB PORCH - COVERED	57042		117	117	23.89		2,795
PRCH	SLAB PORCH - COVERED	57043	26x10		260	23.38		6,079
GENR	Generator - Residential Standby			1	1	2,492.00		2,492



Rogers

Assessment Property Record Card for Tax Year 2026

Data provided by LISA DELOZIER County Assessor

Date 04/16/2026
 Time 22:08:58
 Page 3

Sketch Image

660023120

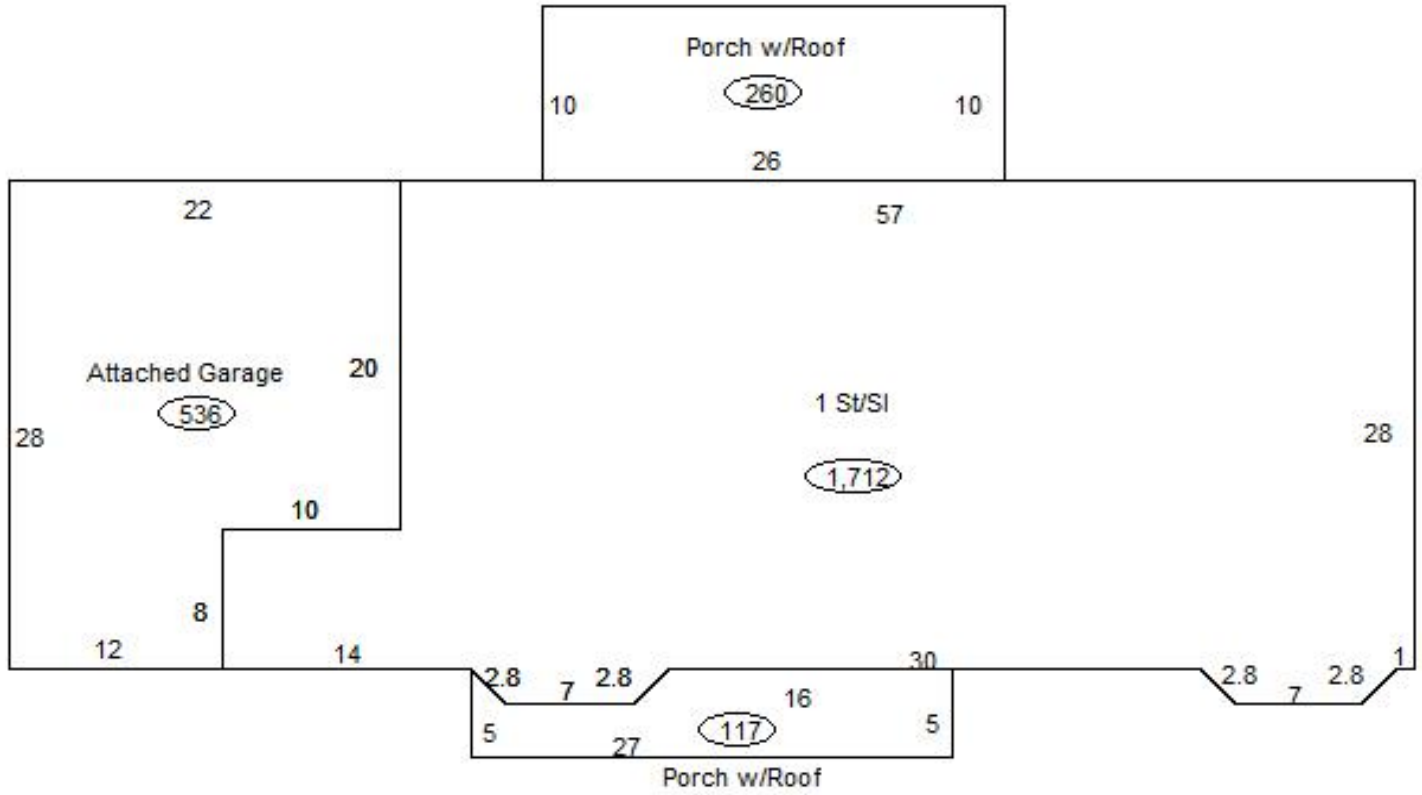

Sketch Vector Information

Sequence	Code	Type	Built Over	Scale	Section Label	Base Area	Multiplier	Total Area
1	R	1	Slab	13	1 St/SI	1,712	1.000	1,712
2	G	1		13	Attached Garage	536	1.000	536
3	M	PRCH		13	SLBC	117	1.000	117
4	M	PRCH		13	SLBC	260	1.000	260
Total Building Area						1,712		1,712



Rogers

Assessment Property Record Card for Tax Year 2026

Data provided by LISA DELOZIER County Assessor

Date 04/16/2026
Time 22:08:58
Page 4

660023120

Outbuildings/Site Improvements

Building Image	Code	Description	Dimensions	Floor	Roofing	Total Units
	SHDS	Shed - Small	8x10x6	Plank	Galvanized Metal	80
	Qual	2	Cond 3	Year 2022	Eff Age 3	

Valuation Summary	Modifier Total	RCN	Depr (14% Phys/ % Func)	RCNLD
Base Cost (26.82 x 80)	2,146		2,146	300
				1,846



SHDS	Shed - Small	40x10x8	Plank	Composition Shingle	400
Qual	5	Cond 3	Year 2021	Eff Age 4	

Valuation Summary	Modifier Total	RCN	Depr (19% Phys/ % Func)	RCNLD
Base Cost (23.71 x 400)	9,484		9,484	1,802
				7,682

SHDS	Shed - Small	12x20x8	Plank	Galvanized Metal	240
Qual	3	Cond 3	Year 2021	Eff Age 4	

Valuation Summary	Modifier Total	RCN	Depr (100% Phys/ % Func)	RCNLD
Base Cost (24.40 x 240)	5,856		5,856	5,856



CPDT	CARPORT - DETACHED	20x22x8	Paved-Asphalt	Galvanized Metal	440
Qual	2.5	Cond 3	Year 2016	Eff Age 8	

Valuation Summary	Modifier Total	RCN	Depr (5% Phys/ % Func)	RCNLD
Base Cost (8.45 x 440)	3,718		3,718	186
				3,532

FLV	GENERATOR	0x0x0			
Qual	Cond	Year	Eff Age		

Valuation Summary	Modifier Total	RCN	Depr (0% Phys/ % Func)	RCNLD
Base Cost (1.00 x)				