



Rogers

Assessment Property Record Card for Tax Year 2026

Data provided by LISA DELOZIER County Assessor

Date 04/16/2026
Time 23:07:06
Page 1

Assessment Data					Primary Image																																																																																																																				
Account 660023213 Parcel ID 22N17E-27-4-00000-000-0000 Cadastral ID 27-22-17-00200 Property Type REAL - Real Property Property Class RA VI Area 2 Tax Area 94 - SEQUOYAH/TRI-DISTRICT FI Name ID 33524 KELLEHAN, SIDNEY N & ROSETTA M 19601 E 456 RD CLAREMORE OK 74017-0000 Parcel Location Situs 19601 E 456 RD Subdivision Lot/Block / Parcel Size 55 - Acres Sec/Twn/Rng 27 / 22 / 17 / 4 Neighborhood 4070 - FOYIL SEQUOYAH AREA School District S006 - SEQUOYAH SCHOOLS																																																																																																																									
Legal Description Lat/Long: 36.35731130 -95.47783895 S2 SW NE & N2 NW SE & SW NW SE & NW NE SE LESS E2 SE SW NE																																																																																																																									
					Building Permits <table border="1"> <thead> <tr> <th>Number</th> <th>Description</th> <th>Opened</th> <th>Closed</th> <th>Amount</th> </tr> </thead> <tbody> <tr> <td>R18</td> <td>R18-POSS NEW CONSTRUCTION PER</td> <td>11/2016</td> <td>12/2016</td> <td></td> </tr> </tbody> </table>					Number	Description	Opened	Closed	Amount	R18	R18-POSS NEW CONSTRUCTION PER	11/2016	12/2016																																																																																																							
Number	Description	Opened	Closed	Amount																																																																																																																					
R18	R18-POSS NEW CONSTRUCTION PER	11/2016	12/2016																																																																																																																						
Exemptions <table border="1"> <thead> <tr> <th>Code</th> <th>Type</th> <th>Active</th> <th>Maximum</th> <th>Exemption</th> </tr> </thead> <tbody> <tr> <td>H</td> <td>Homestead</td> <td>Yes</td> <td>1,000</td> <td>1,000</td> </tr> </tbody> </table>					Code	Type	Active	Maximum	Exemption	H	Homestead	Yes	1,000	1,000	Sale History <table border="1"> <thead> <tr> <th>Bk/Pg</th> <th>Grantor</th> <th>Date</th> <th>Price</th> <th>Code</th> </tr> </thead> <tbody> </tbody> </table>					Bk/Pg	Grantor	Date	Price	Code																																																																																																	
Code	Type	Active	Maximum	Exemption																																																																																																																					
H	Homestead	Yes	1,000	1,000																																																																																																																					
Bk/Pg	Grantor	Date	Price	Code																																																																																																																					
Parcel Valuation <table border="1"> <thead> <tr> <th>Source</th> <th>REAL</th> <th>Fair Cash</th> <th>Capped</th> <th>Asmnt Level</th> <th>Assessed</th> <th>Levy Rate</th> <th>98.320</th> <th>Current Tax</th> </tr> </thead> <tbody> <tr> <td>Remove Cap</td> <td>0</td> <td>Land Value 8,039</td> <td>3,052</td> <td>11%</td> <td>336</td> <td>Assessed</td> <td>8,069</td> <td>793.34</td> </tr> <tr> <td>Year Frozen</td> <td>2005</td> <td>Improvements 185,195</td> <td>70,300</td> <td></td> <td>7,733</td> <td>Penalty</td> <td>0</td> <td></td> </tr> <tr> <td>Uncapped Value</td> <td>0</td> <td>Mobile Home 0</td> <td>0</td> <td></td> <td>0</td> <td>Exemption</td> <td>1,000</td> <td>-88.00</td> </tr> <tr> <td>TIF Project ID</td> <td>0</td> <td>Total Value 193,234</td> <td>73,352</td> <td></td> <td>8,069</td> <td>Total Taxable</td> <td>7,069</td> <td>705.00</td> </tr> </tbody> </table>										Source	REAL	Fair Cash	Capped	Asmnt Level	Assessed	Levy Rate	98.320	Current Tax	Remove Cap	0	Land Value 8,039	3,052	11%	336	Assessed	8,069	793.34	Year Frozen	2005	Improvements 185,195	70,300		7,733	Penalty	0		Uncapped Value	0	Mobile Home 0	0		0	Exemption	1,000	-88.00	TIF Project ID	0	Total Value 193,234	73,352		8,069	Total Taxable	7,069	705.00																																																																			
Source	REAL	Fair Cash	Capped	Asmnt Level	Assessed	Levy Rate	98.320	Current Tax																																																																																																																	
Remove Cap	0	Land Value 8,039	3,052	11%	336	Assessed	8,069	793.34																																																																																																																	
Year Frozen	2005	Improvements 185,195	70,300		7,733	Penalty	0																																																																																																																		
Uncapped Value	0	Mobile Home 0	0		0	Exemption	1,000	-88.00																																																																																																																	
TIF Project ID	0	Total Value 193,234	73,352		8,069	Total Taxable	7,069	705.00																																																																																																																	
Assessment History <table border="1"> <thead> <tr> <th>Tax Year</th> <th>Statement Number</th> <th>Billed Owner</th> <th>Tax Area</th> <th>Total Value</th> <th>Exemptions</th> <th>Taxable Value</th> <th>Billed Tax</th> </tr> </thead> <tbody> <tr><td>2025</td><td>2025-660023213</td><td>KELLEHAN, SIDNEY N &</td><td>94</td><td>219,235</td><td>1000</td><td>7,068</td><td>705.00</td></tr> <tr><td>2024</td><td>2024-660023213</td><td>KELLEHAN, SIDNEY N &</td><td>94</td><td>164,832</td><td>1000</td><td>7,069</td><td>756.00</td></tr> <tr><td>2023</td><td>2023-660023213</td><td>KELLEHAN, SIDNEY N &</td><td>94</td><td>154,257</td><td>1000</td><td>7,069</td><td>771.00</td></tr> <tr><td>2022</td><td>2022-660023213</td><td>KELLEHAN, SIDNEY N &</td><td>94</td><td>154,685</td><td>1000</td><td>7,069</td><td>778.00</td></tr> <tr><td>2021</td><td>2021-660023213</td><td>KELLEHAN, SIDNEY N &</td><td>94</td><td>149,186</td><td>1000</td><td>7,069</td><td>752.00</td></tr> <tr><td>2020</td><td>2020-660023213</td><td>KELLEHAN, SIDNEY N &</td><td>94</td><td>146,545</td><td>1000</td><td>7,069</td><td>749.00</td></tr> <tr><td>2019</td><td>2019-660023213</td><td>KELLEHAN, SIDNEY N &</td><td>94</td><td>142,771</td><td>1000</td><td>7,069</td><td>738.00</td></tr> <tr><td>2018</td><td>2018-660023213</td><td>KELLEHAN, SIDNEY N &</td><td>94</td><td>148,920</td><td>1000</td><td>7,068</td><td>746.00</td></tr> <tr><td>2017</td><td>2017-660023213</td><td>KELLEHAN, SIDNEY N &</td><td>94</td><td>147,536</td><td>1000</td><td>7,068</td><td>736.00</td></tr> <tr><td>2016</td><td>2016-660023213</td><td>KELLEHAN, SIDNEY N &</td><td>94</td><td>145,640</td><td>1000</td><td>7,069</td><td>733.00</td></tr> <tr><td>2015</td><td>2015-660023213</td><td>KELLEHAN, SIDNEY N &</td><td>94</td><td>140,514</td><td>1000</td><td>7,069</td><td>748.00</td></tr> <tr><td>2014</td><td>2014-660023213</td><td>KELLEHAN, SIDNEY N &</td><td>94</td><td>141,916</td><td>1000</td><td>7,068</td><td>733.00</td></tr> <tr><td>2013</td><td>2013-660023213</td><td>KELLEHAN, SIDNEY N &</td><td>94</td><td>133,275</td><td>1000</td><td>7,069</td><td>722.00</td></tr> </tbody> </table>										Tax Year	Statement Number	Billed Owner	Tax Area	Total Value	Exemptions	Taxable Value	Billed Tax	2025	2025-660023213	KELLEHAN, SIDNEY N &	94	219,235	1000	7,068	705.00	2024	2024-660023213	KELLEHAN, SIDNEY N &	94	164,832	1000	7,069	756.00	2023	2023-660023213	KELLEHAN, SIDNEY N &	94	154,257	1000	7,069	771.00	2022	2022-660023213	KELLEHAN, SIDNEY N &	94	154,685	1000	7,069	778.00	2021	2021-660023213	KELLEHAN, SIDNEY N &	94	149,186	1000	7,069	752.00	2020	2020-660023213	KELLEHAN, SIDNEY N &	94	146,545	1000	7,069	749.00	2019	2019-660023213	KELLEHAN, SIDNEY N &	94	142,771	1000	7,069	738.00	2018	2018-660023213	KELLEHAN, SIDNEY N &	94	148,920	1000	7,068	746.00	2017	2017-660023213	KELLEHAN, SIDNEY N &	94	147,536	1000	7,068	736.00	2016	2016-660023213	KELLEHAN, SIDNEY N &	94	145,640	1000	7,069	733.00	2015	2015-660023213	KELLEHAN, SIDNEY N &	94	140,514	1000	7,069	748.00	2014	2014-660023213	KELLEHAN, SIDNEY N &	94	141,916	1000	7,068	733.00	2013	2013-660023213	KELLEHAN, SIDNEY N &	94	133,275	1000	7,069	722.00
Tax Year	Statement Number	Billed Owner	Tax Area	Total Value	Exemptions	Taxable Value	Billed Tax																																																																																																																		
2025	2025-660023213	KELLEHAN, SIDNEY N &	94	219,235	1000	7,068	705.00																																																																																																																		
2024	2024-660023213	KELLEHAN, SIDNEY N &	94	164,832	1000	7,069	756.00																																																																																																																		
2023	2023-660023213	KELLEHAN, SIDNEY N &	94	154,257	1000	7,069	771.00																																																																																																																		
2022	2022-660023213	KELLEHAN, SIDNEY N &	94	154,685	1000	7,069	778.00																																																																																																																		
2021	2021-660023213	KELLEHAN, SIDNEY N &	94	149,186	1000	7,069	752.00																																																																																																																		
2020	2020-660023213	KELLEHAN, SIDNEY N &	94	146,545	1000	7,069	749.00																																																																																																																		
2019	2019-660023213	KELLEHAN, SIDNEY N &	94	142,771	1000	7,069	738.00																																																																																																																		
2018	2018-660023213	KELLEHAN, SIDNEY N &	94	148,920	1000	7,068	746.00																																																																																																																		
2017	2017-660023213	KELLEHAN, SIDNEY N &	94	147,536	1000	7,068	736.00																																																																																																																		
2016	2016-660023213	KELLEHAN, SIDNEY N &	94	145,640	1000	7,069	733.00																																																																																																																		
2015	2015-660023213	KELLEHAN, SIDNEY N &	94	140,514	1000	7,069	748.00																																																																																																																		
2014	2014-660023213	KELLEHAN, SIDNEY N &	94	141,916	1000	7,068	733.00																																																																																																																		
2013	2013-660023213	KELLEHAN, SIDNEY N &	94	133,275	1000	7,069	722.00																																																																																																																		



Rogers

Assessment Property Record Card for Tax Year 2026

Data provided by LISA DELOZIER County Assessor

Date 04/16/2026
 Time 23:07:06
 Page 2

Units Buildable - FOYIL SEQUOYAH AREA (UNITS BUILDABLE)	
Lot Size	
Lot Count	
Units Buildable	
Non-Ag Acres	0
Topography	
Street Access	
Utilities	
Amenities	LAND QUALITY
Method	Units-Buildable
Base Lot Value	
Factor Value	
Adjustments	
Lot Value	



\\tsclient\C\TOMS PC PICS\2016-09-28 09-28-2016\09-28-2016 04 9/29/2016

Residential Data	
Type	1 Single Family Residence
Condition	3 - Average
Quality	3 - Average
Architecture	TRAD TRADITIONAL
Style	100% 1 1/2 Story Finished
Exterior Wall	100% Veneer, Stone
Base/Total Area	1,044 / 1,620
Style	100% 1 1/2 Story Finished
HVAC	100% Warmed & Cooled Air
Roof Cover	1 Composition Shingle
Area on Slab	0
Fixture/RghIn	11 /
Bed/F/H Bath	3 / 2.0 /
Basement Area	
Garage Type	576 Attached Garage - Finished
Remodel	
Year/Eff Age	1987 / 29

GRM Approach	
GRM Code	
Gross Rent	0.00
Indicated Value	

Multiple Regression	
MRA Code	
Adusted R	
Indicated Value	

Direct Comparables	
Selection Model	1 Res
Adjustment Model	A2 AO Test
Comparables	
Indicated Value	

Cost Approach		Manual : 01/2025	
Base Cost	107.37	Total Misc Impr	+ 17,049
Roofing Adj	+ 3.52	Garage Cost	+ 22,280
Subfloor Adj	+ 0.00	Total RCN	= 254,951
Heat/Cool Adj	+ 12.64	Depreciation (36%)	- 91,782
Plumbing Adj	+ 9.57	Lump Sums	+ 0
Basement Adj	+ 0.00	RCNLD	= 163,169
Adj Base Cost	= 133.10	Lot Value	+ 163,169
Total Area	x 1,620	Indicated Value	= 163,169
Adjusted Cost	= 215,622	Value Per SqFt	100.72

Value Reconciliation			
Selected Approach	Cost Approach		
Improvements	163,169		
Lot Value			
Indicated Value	163,169	100.72	Per SqFt
Agland Value	8,039		
Site Improvements	22,026		
Total Value	356,403	220.00	Total Value Per SqFt

Miscellaneous Improvements								
Code	Description	Sketch ID	Size	Year	Units	Unit Cost	Depr	Value
FPR1	FIREPLACE - RESIDENTIAL 1 STORY	0		1	1	5,615.40		5,615
PRCH	SLAB PORCH - COVERED	57291	34x6		204	26.29		5,363
EPKS	ENCLOSED PORCH - KNEEWALL SCREEN	57292	19x11		209	29.05		6,071



Rogers

Assessment Property Record Card for Tax Year 2026

Data provided by LISA DELOZIER County Assessor

Date 04/16/2026
 Time 23:07:06
 Page 3

Sketch Image

660023213

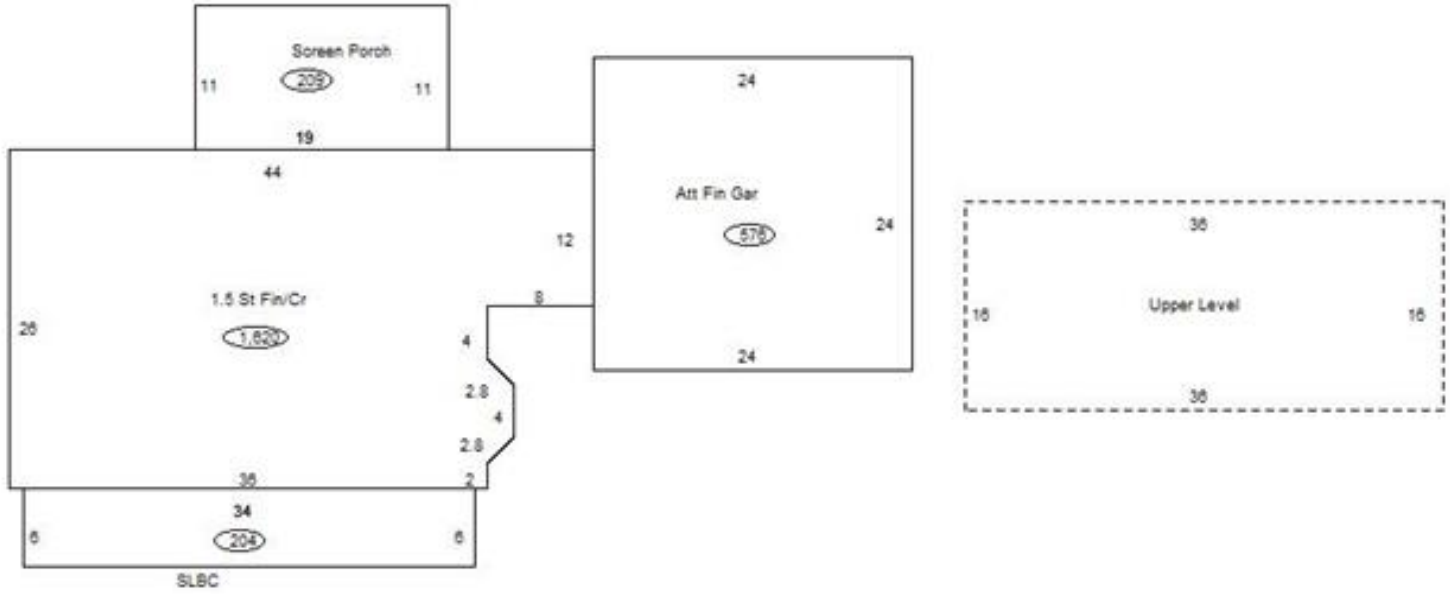

Sketch Vector Information

Sequence	Code	Type	Built Over	Scale	Section Label	Base Area	Multiplier	Total Area
1	R	5	Crawl	13	1.5 St Fin/Cr	1,044	1.552	1,620
2	G	5		13	Att Fin Gar	576	1.000	576
3	M	PRCH		13	SLBC	204	1.000	204
4	M	EPKS		13	Screen Porch	209	1.000	209
5	U	^UL	Overhang	13	Upper Level	576	1.000	576
Total Building Area						1,044		1,620



Rogers



Assessment Property Record Card for Tax Year 2026

Data provided by LISA DELOZIER County Assessor

Date 04/16/2026
 Time 23:07:06
 Page 4

660023213

Outbuildings/Site Improvements

Building Image	Code	Description	Dimensions	Floor	Roofing	Total Units
	UTIL	SHOP BUILDING	18x38x14	Dirt	Formed Metal	684
	Qual 2	Cond 3	Year 2010	Eff Age 12		
	Valuation Summary		Modifier Total	RCN	Depr (25% Phys/ % Func)	RCNLD
	Base Cost (26.73 x 684)		18,283	18,283	4,571	13,712
	BNGP	BARN	24x30x10	Dirt	Galvanized Metal	720
	Qual 3	Cond 3	Year 1980	Eff Age 35		
	Valuation Summary		Modifier Total	RCN	Depr (61% Phys/ % Func)	RCNLD
	Base Cost (24.74 x 720)		17,813	17,813	10,866	6,947
	HAYS	HAY SHED	24x30x8	Dirt	Formed Metal	720
	Qual 2	Cond 3	Year 1980	Eff Age 35		
	Valuation Summary		Modifier Total	RCN	Depr (74% Phys/ % Func)	RCNLD
	Base Cost (7.30 x 720)		5,256	5,256	3,889	1,367



Rogers

Assessment Property Record Card for Tax Year 2026

Data provided by LISA DELOZIER County Assessor

Date 04/16/2026
Time 23:07:06
Page 5

Agland Inventory

660023213

Soi	Description	Land Use	LPI	Adj Type	Adj Code	Acres	Use/Acre	Mkt/Acre	Use Value	Market Value
DBC	DENNIS-BATES COMPLEX 2-5%	IMP PST	60			40.824	168	168	6,858	6,858
HC	HECTOR STONY SANDY LOAM	TMBR	20			.350	36	36	13	13
HLC	HECTOR-LINKER FINE SANDY	TMBR	35			.063	63	63	4	4
VF	VERDIGRIS SOILS FREQUENTL	TMBR	47			13.763	85	85	1,164	1,164
TMBR Totals						55.000			8,039	8,039
Total Agland						55.000			8,039	8,039